

TRANSWESTERN GAS SUPPLY COMPANY
 No.2 Pronghorn Federal
 NW¼SW¼ Sec.31-4S-22E
 Chaves County, N.M.

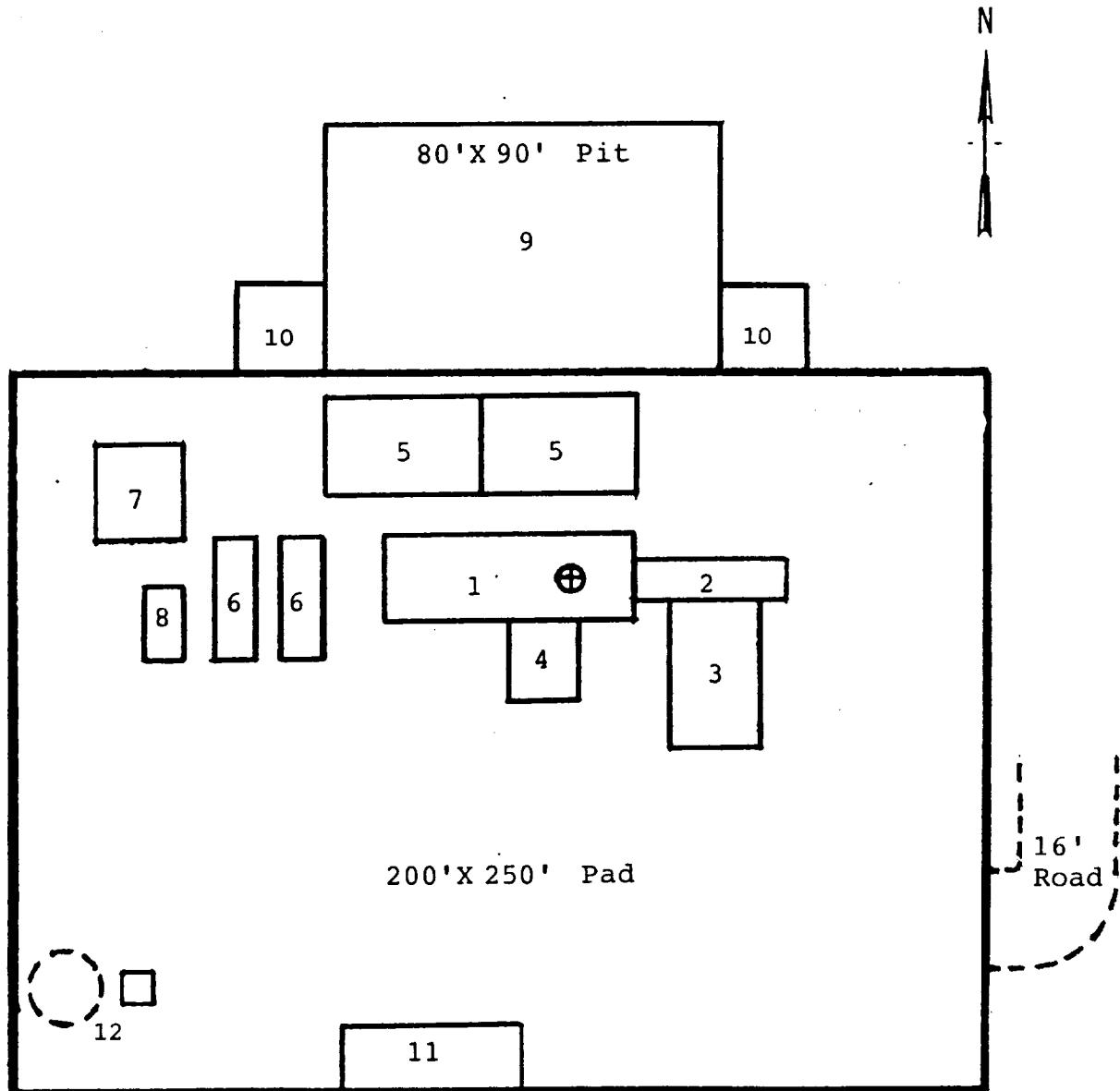

RIG LAYOUT

- | | |
|-----------------|---------------------------|
| 1. Substructure | 7. Water Tank |
| 2. Catwalk | 8. Light Plant |
| 3. Pipe Rack | 9. Reserve Pit |
| 4. Doghouse | 10. Trash Pit |
| 5. Mud Pits | 11. Trailer House |
| 6. Mud Pumps | 12. Production Facilities |