

30-005-62391

Form 9-331 NM Oil Cons. Commi ON
(May 1983) Drawer DDSUBMIT IN 1 LIGATE*
(Other instructions on
reverse side)Form approved.
Budget Bureau No. 42-B1425.

Artesia, NM 88210

UNITED STATES DEPARTMENT OF THE INTERIOR
BUREAU OF LAND MANAGEMENT
GEOLOGIC SURVEY

APPLICATION FOR PERMIT TO DRILL DEEPEN OR PLUG BACK

1a. TYPE OF WORK

DRILL ☒PLUG BACK ☐

b. TYPE OF WELL

OIL
WELL ☐GAS
WELL ☒OTHER ☐SINGLE
ZONE ☒MULTIPLE
ZONE ☐

2. NAME OF OPERATOR

McKay Oil Corporation

3. ADDRESS OF OPERATOR

P.O. Box 2014, Roswell, New Mexico 88202

4. LOCATION OF WELL (Report location clearly and in accordance with any State requirements.)*

At surface
660FNL-460FEL
At proposed prod. zone

RECEIVED BY

JAN -7 1987

O. C. D.
ARTESIA, OFFICE

5. LEASE DESIGNATION AND SERIAL NO.

NM -32311

6. IF INDIAN, ALLOTTEE OR TRIBE NAME

7. UNIT AGREEMENT NAME

8. FARM OR LEASE NAME

Inexco Fed.

9. WELL NO.

5

10. FIELD AND POOL, OR WILDCAT

Ind. W. Pecos Slope Abo

11. SEC., T., R., N., OR BLK.
AND SURVEY OR AREA

Sec. 25-5S-21E

14. DISTANCE IN MILES AND DIRECTION FROM NEAREST TOWN OR POST OFFICE*

28 Miles Northwest of Roswell, NM

15. DISTANCE FROM PROPOSED*

LOCATION TO NEAREST
PROPERTY OR LEASE LINE, FT.
(Also to nearest drlg. unit line, if any)

460'

16. NO. OF ACRES IN LEASE

1598.64'

17. NO. OF ACRES ASSIGNED
TO THIS WELL

160.0

18. DISTANCE FROM PROPOSED LOCATION*
TO NEAREST WELL, DRILLING, COMPLETED,
OR APPLIED FOR, ON THIS LEASE, FT.

None

19. PROPOSED DEPTH

3,400'

20. ROTARY OR CABLE TOOLS

Rotary

21. ELEVATIONS (Show whether DF, RT, GR, etc.)

4267GL

22. APPROX. DATE WORK WILL START*

ASAP

23.

PROPOSED CASING AND CEMENTING PROGRAM

SIZE OF HOLE	SIZE OF CASING	WEIGHT PER FOOT	SETTING DEPTH	QUANTITY OF CEMENT
12 1/4"	8 5/8"	24.0 J-55	900±	850 cf cement circulated
7 7/8"	4 1/2"	9.5 J-55	TD	1200 cf cement including
				480 cf to tie in 4 1/2" to
				8 5/8" from 1500' to 800'.

We propose to drill and test the Abo formation. Approximately 900' of surface casing will be set and cemented to surface. If commercial, 4 1/2" production casing will be run and cemented with adequate cover, perforated and stimulated as needed for production.

MUD PROGRAM: See Supplemental Drilling Data Which is Attached.

BOP PROGRAM: BOP will be installed on 8 5/8" casing and tested daily.

Gas is not dedicated.

Posted IDI
NL, API
1-16-87

IN ABOVE SPACE DESCRIBE PROPOSED PROGRAM: If proposal is to deepen or plug back, give data on present productive zone and proposed new productive zone. If proposal is to drill or deepen directionally, give pertinent data on subsurface locations and measured and true vertical depths. Give blowout preventer program, if any.

24.

X X

SIGNED

TITLE Landman

DATE

12-16-86

(This space for Federal or State office use)

PERMIT NO.

APPROVAL DATE

APPROVED BY S/Phil Kirk

TITLE Area Manager

DATE

DEC 30 1986

CONDITIONS OF APPROVAL, IF ANY:

APPROVAL OF THIS APPLICATION DOES NOT WARRANT OR CERTIFY THAT THE APPLICANT HOLDS LEGAL OR EQUITABLE TITLE TO THOSE RIGHTS IN THE SUBJECT LEASE WHICH WOULD ENTITLE THE APPLICANT TO CONDUCT OPERATIONS THEREON.

All distances must be from the outer boundaries of the Section.

Operator McKay Oil Corporation		Lease Inexco Federal		Well No. #5
Unit Letter A	Section 25	Township 5 South	Range 21 East	County Chaves
Actual Footage Location of Well: 460 feet East line and 660 feet feet from the North line				
Ground Level Elev. 4267	Producing Formation ABO	Pool W. Pecos Slope ABO	Dedicated Acreage 160 Acres	

1. Outline the acreage dedicated to the subject well by colored pencil or hatchure marks on the plat below.
2. If more than one lease is dedicated to the well, outline each and identify the ownership thereof (both as to working interest and royalty).
3. If more than one lease of different ownership is dedicated to the well, have the interests of all owners been consolidated by communitization, unitization, force-pooling, etc?

☐ Yes ☐ No

If answer is "yes," type of consolidation

If answer is "no," list the owners and tract descriptions which have actually been consolidated. (Use reverse side of this form if necessary.)

No allowable will be assigned to the well until all interests have been consolidated (by communitization, unitization, forced-pooling, or otherwise) or until a non-standard unit, eliminating such interests, has been approved by the Division.

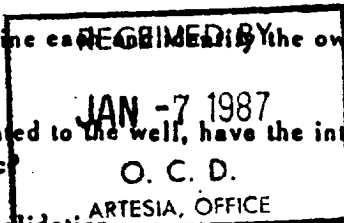

		660'	
		460'	
		NM-32311	

CERTIFICATION

I hereby certify that the information contained herein is true and complete to the best of my knowledge and belief.

Name

Sam L. Shackelford

Position

Agent

Company

McKay Oil Corp.

Date

12-15-86

I hereby certify that the well location shown on this plat was plotted from field notes of actual surveys made by me or under my supervision, and that the same is true and correct to the best of my knowledge and belief.

December 15, 1986

Date Surveyed

John D. Jaques, P.E. & L.S.

Registered Professional Engineer and/or Land Surveyor

#6290

Certificate No.

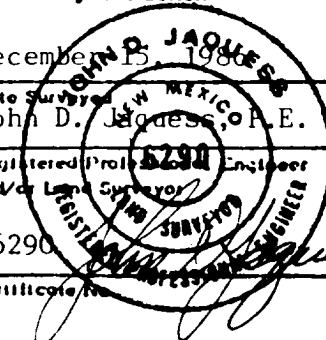

0 330 660 990 1320 1650 1980 2310 2640 2970 3300 3630 3960 4290 4620 4950 5280 5610 5940 6270 6600 6930 7260 7590 7920 8250 8580 8910 9240 9570 9900 0

McKay Oil Corporation
 Inexco Federal #5
 NE $\frac{1}{4}$ NE $\frac{1}{4}$ Sec. 25-5S-21E
 Chaves County, New Mexico

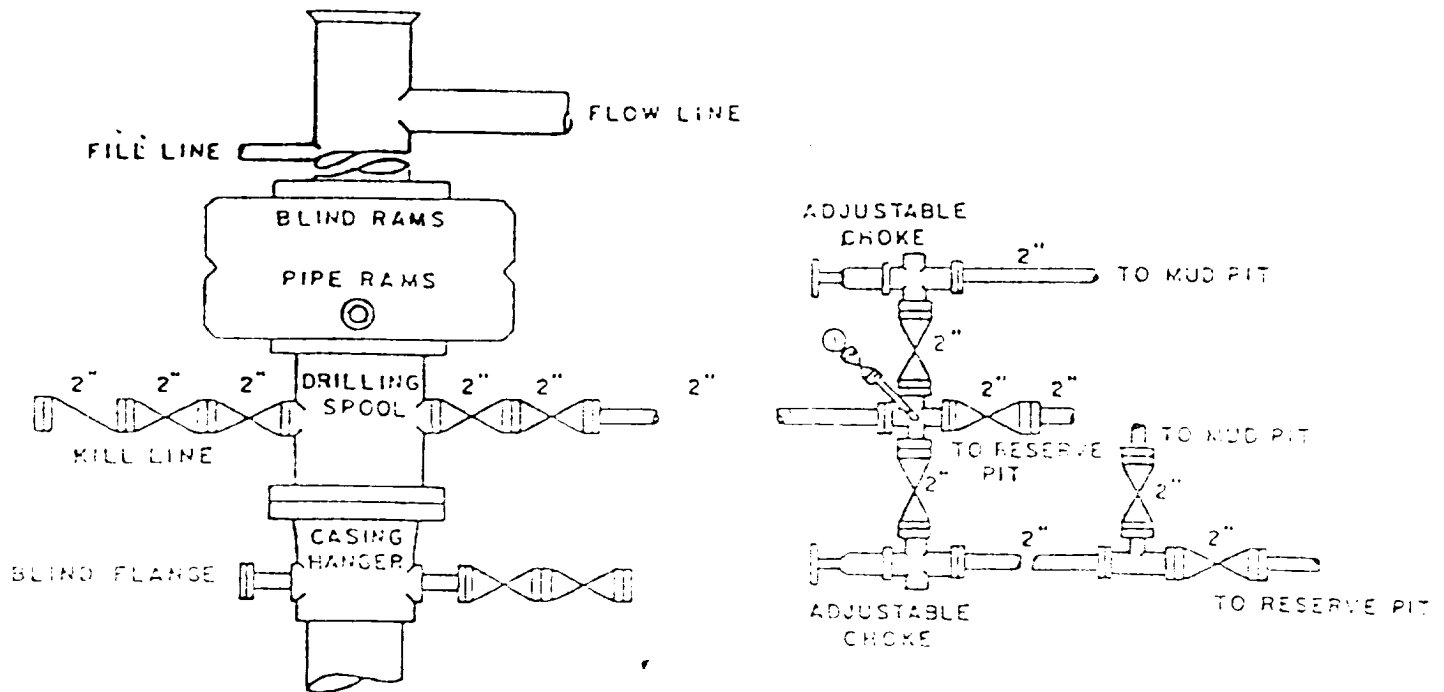

BOP DIAGRAM

3000# Working Pressure
 Rams Operated Daily

EXHIBIT D

SUPPLEMENTAL DRILLING DATA

McKAY OIL CORPORATION
Inexco Federal #5
NE1/4NE1/4 Sec. 25-5S-21E
Chaves County, N.M.

NM 32311



The following items supplement Form 9-331C in accordance with instructions contained in NTL-6.

1. SURFACE FORMATION: San Andres
2. ESTIMATED TOPS OF GEOLOGIC MARKERS:
Yeso - 818'
Tubb - 2348'
Abo - 3028'
3. ESTIMATED DEPTHS TO WATER, OIL OR GAS FORMATION:
Fresh water - In surface formations above 600'
Gas - In Abo formation below 3028'
4. PROPOSED CASING PROGRAM: See Form 9-331C
5. PRESSURE CONTROL EQUIPMENT: Blowout preventer stack will consist of at least a double-ram blowout preventer rated to 3000#WP. A sketch of the BOP is attached.
6. CIRCULATING MEDIUM:
0'- 600' Lime and gel, spud mud, viscosity 32 to 34 seconds.
600'- 2928 Fresh water
2928'- TD Start mudding up at 2928'; viscosity 36 to 38 seconds; water loss 10 cc or less; 3-5% Diesel; 2 KCL
Mud additives will be used to control water loss.
7. AUXILIARY EQUIPMENT: full-opening drill string safety valve fit the drill string in use, will be kept on the rig floor at all times.

McKay Oil Corporation
Inexco Federal #5
NE 1/4 NE 1/4 Sec. 25-5S-21E
Chaves County, New Mexico

Wells Tank
Middle
Pipes to South Inexco #26
INEXCO #460
INEXCO #53
INEXCO #51
INEXCO #52
EXHIBIT B
MILLER FED. #2

Existing Access--

MILLER FED. #2

McKay Oil Corporation
 Inexco Federal #5
 NE¼NE¼ Sec. 25-5S-21E
 Chaves County, New Mexico

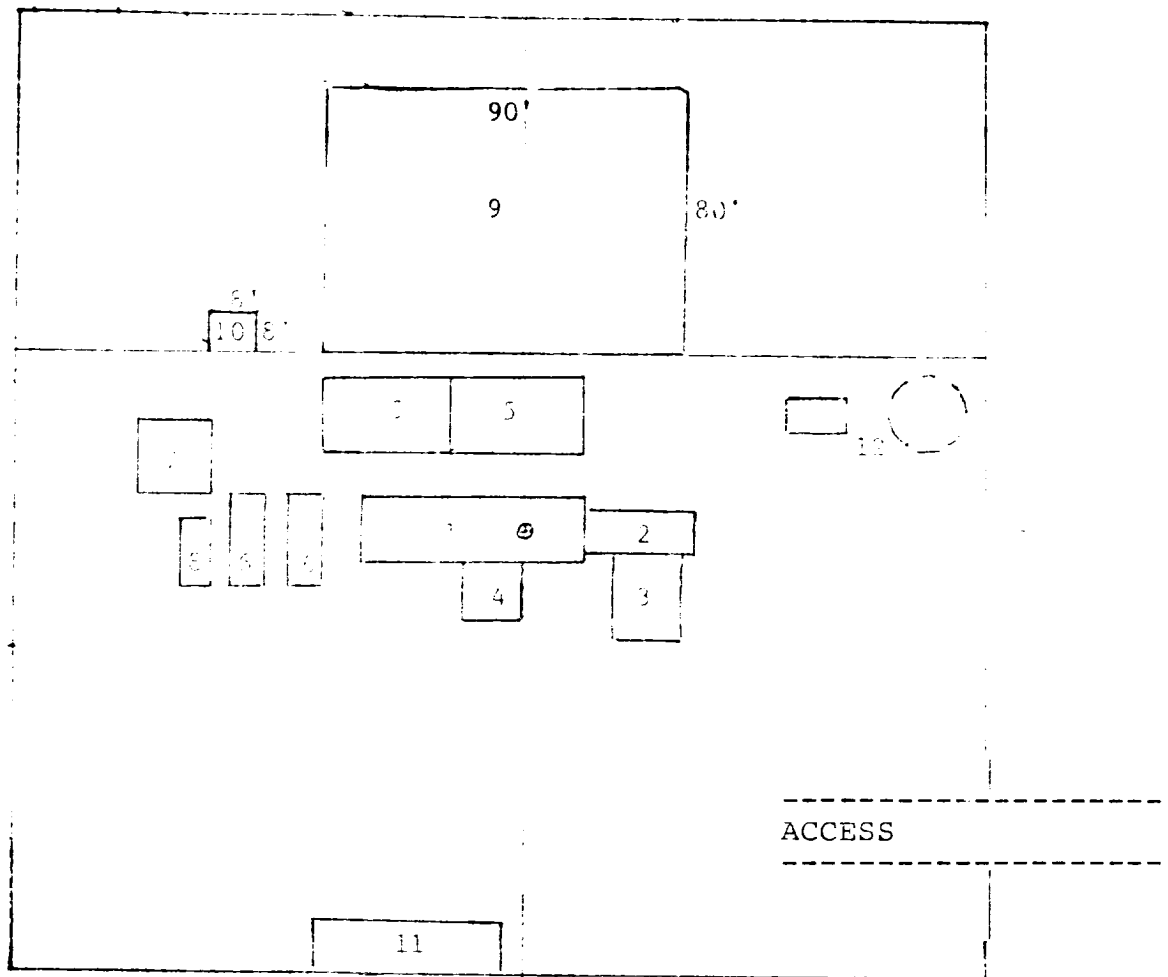

RIG LAYOUT

- | | |
|-----------------|---------------------------|
| 1. Substructure | 7. Water Tank |
| 2. Catwalk | 8. Light Plant |
| 3. Pipe Rack | 9. Reserve Pit |
| 4. Doghouse | 10. Trash Pit |
| 5. Mud Pits | 11. Trailer House |
| 6. Mud Pumps | 12. Production Facilities |