

Operator Exxon Corporation			Lease NEW MEXICO "DQ" STATE. D.			Well No. 1		
Unit Letter F	Section 36	Township 20S	Range 28E	County ARTESIA, OFFICE EDDY				
Actual Footage Location of Well: 2130 feet from the NORTH line and 1980 feet from the WEST line								
Ground Level Elev:		Producing Formation DELAWARE		Pool WILDCAT		Dedicated Acreage: 40 Acres		

1. Outline the acreage dedicated to the subject well by colored pencil or hachure marks on the plat below.
2. If more than one lease is dedicated to the well, outline each and identify the ownership thereof (both as to working interest and royalty).
3. If more than one lease of different ownership is dedicated to the well, have the interests of all owners been consolidated by communitization, unitization, force-pooling, etc?
☐ Yes ☐ No If answer is "yes," type of consolidation _____

If answer is "no," list the owners and tract descriptions which have actually been consolidated. (Use reverse side of this form if necessary.) _____

No allowable will be assigned to the well until all interests have been consolidated (by communitization, unitization, forced-pooling, or otherwise) or until a non-standard unit, eliminating such interests, has been approved by the Commission.

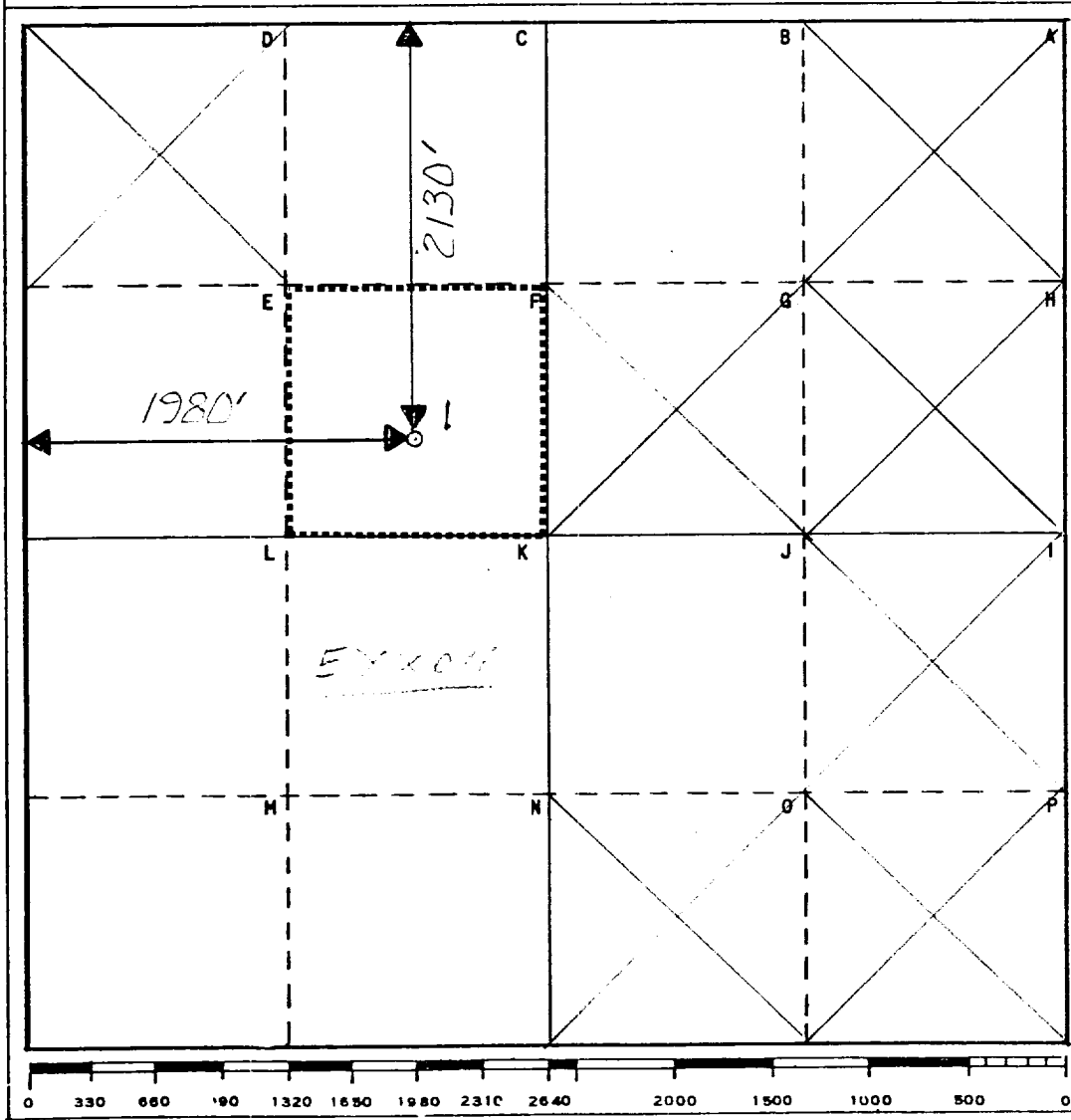

CERTIFICATION	
I hereby certify that the information contained herein is true and complete to the best of my knowledge and belief.	
Name <i>Edgar Runkel</i>	Position UNIT HEAD
Company Exxon Corporation Box 1600 Midland, Texas	
Date 6-21-83	
I hereby certify that the well location shown on this plat was plotted from field notes of actual surveys made by me or under my supervision and that the same is true and correct to the best of my knowledge and belief.	
Date Surveyed 6-14-83	
Registered Professional Engineer and/or Land Surveyor <i>W.S. Fulmard</i>	
Certificate No. 6157	