

ENERGY AND MINERALS DEPARTMENT

NO. OF COPIES RECEIVED	
DISTRIBUTION	
SANTA FE	<input checked="" type="checkbox"/>
FILE	<input checked="" type="checkbox"/>
U.S.G.S.	
LAND OFFICE	<input checked="" type="checkbox"/>
OPERATOR	<input checked="" type="checkbox"/>

OIL CONSERVATION DIVISION

P. O. BOX 2088

SANTA FE, NEW MEXICO 87501

O. C. D.
ARTESIA, OFFICE

Form C-103
Revised 10-1-78

SUNDRY NOTICES AND REPORTS ON WELLS

DO NOT USE THIS FORM FOR PROPOSALS TO DRILL OR TO DEEPEN OR PLUG BACK TO A DIFFERENT RESERVOIR.
USE "APPLICATION FOR PERMIT" (FORM C-101) FOR SUCH PROPOSALS.

1. <input checked="" type="checkbox"/> OIL WELL <input type="checkbox"/> GAS WELL <input type="checkbox"/> OTHER-		5a. Indicate Type of Lease State <input checked="" type="checkbox"/> Fee <input type="checkbox"/>
2. Name of Operator Gulf Oil Corp. ✓		5. State Oil & Gas Lease No.
3. Address of Operator P. O. Box 670, Hobbs, NM 88240		7. Unit Agreement Name
4. Location of Well * UNIT LETTER <u>N</u> <u>667</u> FEET FROM THE <u>South</u> LINE AND <u>1672</u> FEET FROM THE <u>West</u> LINE, SECTION <u>16</u> TOWNSHIP <u>23S</u> RANGE <u>28E</u> NMPM.		8. Farm or Lease Name Eddy "HR" State
15. Elevation (Show whether DF, RT, GR, etc.) 3022.7' GL		9. Well No. 3
		10. Field and Pool, or Wildcat and, otherwise J. K. W. G.
		12. County Eddy

Check Appropriate Box To Indicate Nature of Notice, Report or Other Data

NOTICE OF INTENTION TO:

SUBSEQUENT REPORT OF:

PERFORM REMEDIAL WORK <input type="checkbox"/>	PLUG AND ABANDON <input type="checkbox"/>	REMEDIAL WORK <input type="checkbox"/>	ALTERING CASING <input type="checkbox"/>
TEMPORARILY ABANDON <input type="checkbox"/>	CHANGE PLANS <input type="checkbox"/>	COMMENCE DRILLING OPNS. <input type="checkbox"/>	PLUG AND ABANDONMENT <input type="checkbox"/>
PULL OR ALTER CASING <input type="checkbox"/>	OTHER <input type="checkbox"/>	CASING TEST AND CEMENT JOBS <input type="checkbox"/>	
		OTHER <u>*Change Location</u> <input checked="" type="checkbox"/>	

17. Describe Proposed or Completed Operations (Clearly state all pertinent details, and give pertinent dates, including estimated date of starting any proposed work) SEE RULE 1103.

This well will be drilled at above location instead
of location submitted on APD of 6-5-84.

18. I hereby certify that the information above is true and complete to the best of my knowledge and belief.

SIGNED

RDPite

TITLE

AREA ENGINEER

DATE

11-6-84

APPROVED BY

TITLE

Original Signed By
Leslie A. Clements
Supervisor District II

DATE

NOV 08 1984

CONDITIONS OF APPROVAL, IF ANY:

NE MEXICO OIL CONSERVATION COMMISSION
WELL LOCATION AND ACREAGE DEDICATION PLAT

Form C-102
Supersedes C-128
Effective 1-1-65

All distances must be from the outer boundaries of the Section.

Operator Gulf Oil Corp.			Lease Eddy GR State			Well No. 3		
Unit Letter N	Section 16	Township 23 South		Range 28 East	County Eddy			
Actual Footage Location of Well: 667 feet from the south line and 1672 feet from the west line								
Ground Level Elev. 3022.7		Producing Formation Delaware		Pool Undis Delaware J. Loring		Dedicated Acreage: 40 Acres		

1. Outline the acreage dedicated to the subject well by colored pencil or hachure marks on the plat below.
2. If more than one lease is dedicated to the well, outline each and identify the ownership thereof (both as to working interest and royalty).
3. If more than one lease of different ownership is dedicated to the well, have the interests of all owners been consolidated by communitization, unitization, force-pooling, etc?

☐ Yes ☐ No If answer is "yes," type of consolidation _____

If answer is "no," list the owners and tract descriptions which have actually been consolidated. (Use reverse side of this form if necessary.) _____

No allowable will be assigned to the well until all interests have been consolidated (by communitization, unitization, forced-pooling, or otherwise) or until a non-standard unit, eliminating such interests, has been approved by the Commission.

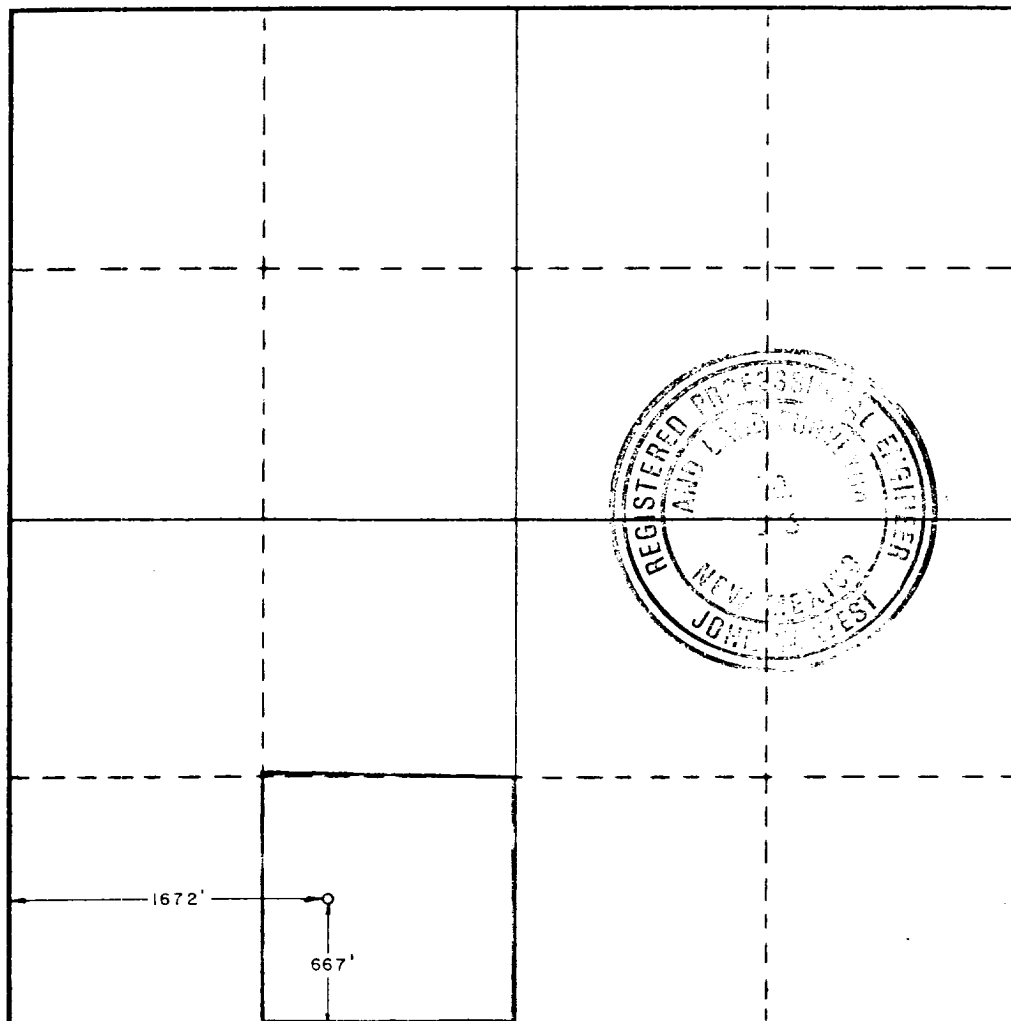

CERTIFICATION

I hereby certify that the information contained herein is true and complete to the best of my knowledge and belief.

R.D. Pitre

Name
R.D. PITRE
Position
AREA ENGINEER
Company
GULF OIL CORP
Date
11-6-84

I hereby certify that the well location shown on this plat was plotted from field notes of actual surveys made by me or under my supervision, and that the same is true and correct to the best of my knowledge and belief.

Date Surveyed
November 2, 1984
Registered Professional Engineer
and/or Land Surveyor

Ronald J. Eidson
Certificate No. JOHN W. WEST, 676
RONALD J. EIDSON, 3239

