

STATE OF NEW MEXICO
ENERGY AND MINERALS DEPARTMENT

IL CONSERVATION DIVISION

P. O. BOX 2088
SANTA FE, NEW MEXICO 87501

RECEIVED BY

JAN 9 1985

RECEIVED BY

DEC 27 1984

O. C. D.

ARTESIA, OFFICE

Form C-101

30-015-25162

5A. Indicate Type of Lease

STATE ☒ FEE ☐

5. State Oil & Gas Lease No.

B-8096

7. Unit Agreement Name

N/A

8. Farm or Lease Name

Conoco -7- State

9. Well No.

14

10. Field and Pool, or Wildcat

East Millman - 8-6

12. County

Eddy

19. Proposed Depth

3500'

19A. Formation

Grayburg

20. Rotary or C.T.

Rotary

21. Elevations (show whether DF, RT, etc.)

3380' G. L.

21A. Kind & Status Plug. Bond

Active Blanket

21B. Drilling Contractor

Unknown

22. Approx. Date Work will start

3-1-85

23.

PROPOSED CASING AND CEMENT PROGRAM

SIZE OF HOLE	SIZE OF CASING	WEIGHT PER FOOT	SETTING DEPTH	SACKS OF CEMENT	EST. TOP
11"	8 5/8"	24#	350'	200	Surface
7 7/8"	5 1/2"	14#	3500'	365	Surface

This well will be spudded with an 11" hole and drilled to a depth of 350'. Surface casing will be run and cement circulated to the surface. Casing will be tested to 1000 psi before drilling out of the surface casing. BOP's will be pressure tested a minimum of once every 10 days. A 7 7/8" hole will be drilled to a total depth of 3500'. If the well is determined to be productive, 5 1/2" casing will be run and cemented to the surface with 365 sacks.

IN ABOVE SPACE DESCRIBE PROPOSED PROGRAM; IF PROPOSAL IS TO DEEPEN OR PLUG BACK, GIVE DATA ON PRESENT PRODUCTIVE ZONE AND PROPOSED NEW PRODUCTIVE ZONE. GIVE BLOWOUT PREVENTER PROGRAM, IF ANY.

I hereby certify that the information above is true and complete to the best of my knowledge and belief.

Signed Bill G. Spencer Bill G. Spencer Title Sr. Regulatory Affairs Coord. Date December 20, 1984

(This space for State Use)

Original Signed By

Mike Williams

TITLE

Oil & Gas Inspector

APPROVED BY

DATE JAN 14 1985

CONDITIONS OF APPROVAL, IF ANY:

All distances must be from the outer boundaries of the Section.

Operator Mitchell Energy			Lease Conoco Seven State			Well No. #14
Unit Letter 0	Section 7	Township 19 South	Range 29 East	County Eddy		
Actual Footage Location of Well 560 feet from the South line and 1980 feet from the East line						
Ground Level Elev. 3380	Producing Formation Grayburg		Paul East Millman		Dedicated Acreage 40	

1. Outline the acreage dedicated to the subject well by colored pencil or hatchure marks on the plat below.
2. If more than one lease is dedicated to the well, outline each and identify the ownership thereof (both as to working interest and royalty).
3. If more than one lease of different ownership is dedicated to the well, have the interests of all owners been consolidated by communitization, unitization, force-pooling, etc?

☒ Yes ☐ No If answer is "yes," type of consolidation Communitization (Joint Operating Agreement)

If answer is "no," list the owners and tract descriptions which have actually been consolidated. (Use reverse side of this form if necessary.)

No allowable will be assigned to the well until all interests have been consolidated (by communitization, unitization, forced-pooling, or otherwise) or until a non-standard unit, eliminating such interests, has been approved by the Division

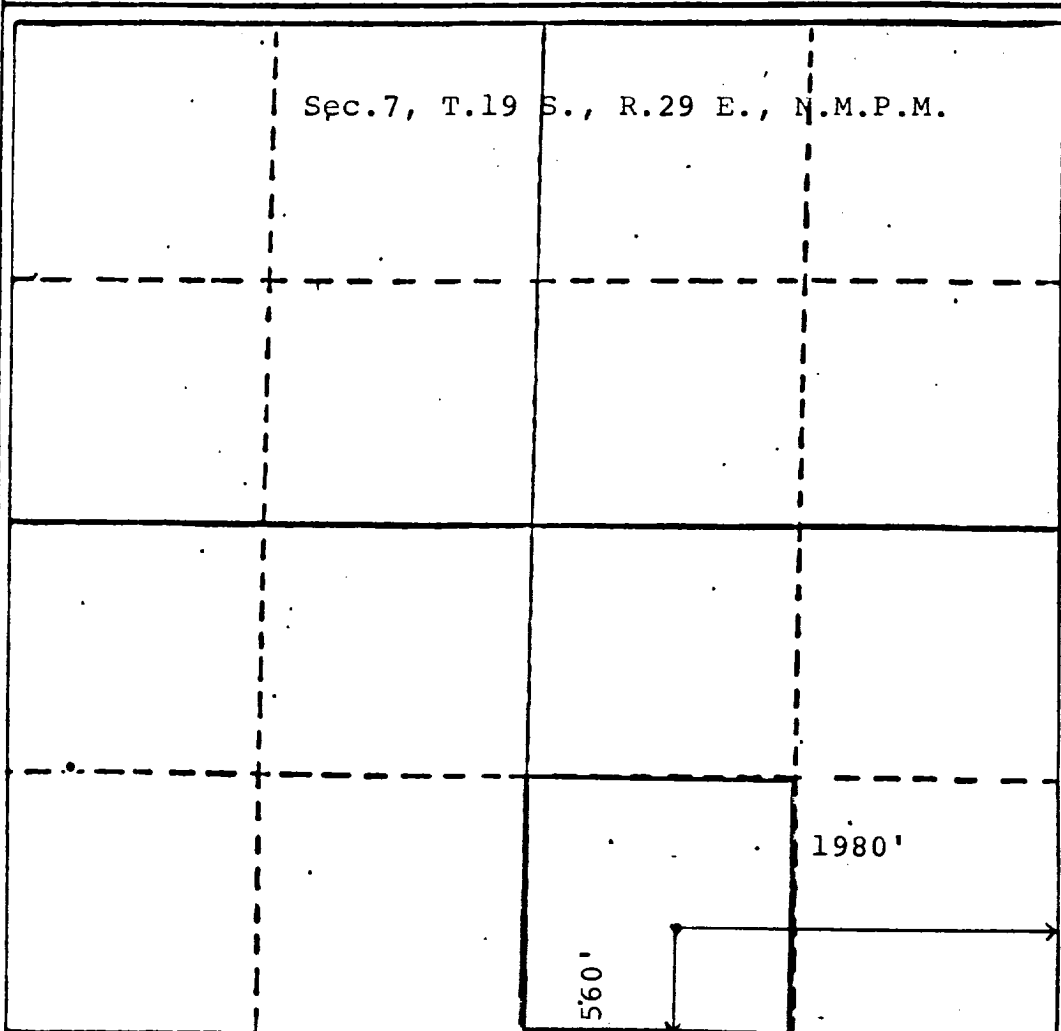

CERTIFICATION

I hereby certify that the information contained herein is true and complete to the best of my knowledge and belief.

Name
Bill G Spencer
Position
Sr Regulatory Affairs Coord.

Company
Mitchell Energy Corp

Date
December 20, 1984

I hereby certify that the well location shown on this plat was plotted from field notes of actual surveys made by me or under my supervision, and that the same is true and correct to the best of my knowledge and belief.

Date Surveyed
December 13, 1984

Division of Geological Resources and Land Conservation

John D. Jaques, P.E. & L.S.

Certification No. **6290**
PROFESSIONAL ENGINEER

3000 LB. W.P. B.O.P.
 10" CAMERON TYPE-SS HYDRAULIC B.O.P. 3000 P.S.I.
 12" G.K. HYDRILL 3000 W.P.
 80 GALLON- STATION KOOMEY ACCUMULATOR
 3000 LB. W.P. CHOKE MANIFOLD

London's Whitting Company

