

Submit to Appropriate
District Office
State Lease - 6 copies
Fee Lease - 5 copies

State of New Mexico
Energy, Minerals and Natural Resources Department

Santa Fe	
Land Office	
Operator	

Form C-101
Revised 1-1-89

OIL CONSERVATION DIVISION

P.O. Box 2088
Santa Fe, New Mexico 87501-2088

DISTRICT I
P.O. Box 1980, Hobbs, NM 88240

DISTRICT II
P.O. Drawer DD, Artesia, NM 88210

DISTRICT III
1000 Rio Brazos Rd., Aztec, NM 87410

MAR 23 '89

API NO. (assigned by OCD on New Wells)

30-115-26128

5. Indicate Type of Lease

STATE ☒

FEE ☐

6. State Oil & Gas Lease No.

E-379-4

7. Lease Name or Unit Agreement Name

South Red Lake Grayburg

8. Well No.

48

9. Pool name or Wildcat

Red Lake Queen G-4-SA

APPLICATION FOR PERMIT TO DRILL, DEEPEN, OR PLUG BACK

1a. Type of Work:

DRILL ☒

RE-ENTER ☐

DEEPEN ☐

ARTESIA, OFFICE
PLUG BACK ☐

b. Type of Well:

OIL
WELL ☒

GAS
WELL ☐

OTHER ☐

SINGLE
ZONE ☒

MULTIPLE
ZONE ☐

2. Name of Operator

S & J Operating Company

3. Address of Operator

P. O. Box 2249, Wichita Falls, Texas 76307

4. Well Location

Unit Letter M : 1010 Feet From The West Line and 240 Feet From The South Line

Section 36 Township 17S Range 27E NMPM Eddy County

10. Proposed Depth
1900'

11. Formation

Grayburg

12. Rotary or C.T.

Rotary

13. Elevations (Show whether DF, RT, GR, etc.)

3637'

14. Kind & Status Plug Bond

\$50,000 Blanket Bond

15. Drilling Contractor

N/A

16. Approx. Date Work will start

5-1-89

17. PROPOSED CASING AND CEMENT PROGRAM

SIZE OF HOLE	SIZE OF CASING	WEIGHT PER FOOT	SETTING DEPTH	SACKS OF CEMENT	EST. TOP
12 1/4	8 5/8	23#	350	280 sx.	Surface
7 7/8	5 1/2	15.5#	1900	150 sx.	1300'

S & J Operating Company proposes to drill a development well in the secondary recovery project known as the South Red Lake Grayburg Unit. This well is needed to obtain production which has been swept to this area by injection wells. No zones of high or unknown pressure will be encountered, therefore, blowout preventers are not necessary.

Foot ID-1
N/A & API
6-2-89

APPROVAL VALID FOR 180 DAYS
PERMIT EXPIRES 12-1-89
UNLESS DRILLING UNDERWAY.

IN ABOVE SPACE DESCRIBE PROPOSED PROGRAM: IF PROPOSAL IS TO DEEPEN OR PLUG BACK, GIVE DATA ON PRESENT PRODUCTIVE ZONE AND PROPOSED NEW PRODUCTIVE ZONE. GIVE BLOWOUT PREVENTER PROGRAM, IF ANY.

I hereby certify that the information above is true and complete to the best of my knowledge and belief.

SIGNATURE Sandy Robertson TITLE Petroleum Engineer DATE 3-21-89

TYPE OR PRINT NAME

TELEPHONE NO. 817-723-2166

(This space for State Use)

APPROVED BY Jimmy Robinson TITLE OIL AND GAS INSPECTOR DATE JUN 01 1989

CONDITIONS OF APPROVAL, IF ANY:

N/A - 2654
APPV. 5-18-89

Notify N.E.L.O. for sufficient

85/8

N MEXICO OIL CONSERVATION COMMISS
WELL LOCATION AND ACREAGE DEDICATION PLAT

Form C-102
 Supersedes C-128
 Effective 1-1-65

All distances must be from the outer boundaries of the Section.

Operator S & J OPERATING COMPANY			Lease South Redlake Grayburg Unit		Well No. 48
Unit Letter M	Section 36	Township 17 South	Range 27 East	County Eddy County, N.M.	
Actual Footage Location of Well: 1010 feet from the West line and 240 feet from the South line					
Ground Level Elev. 3637.	Producing Formation Grayburg	Pool Red Lake Queen G8-SA		Dedicated Acreage: 40	Acres

1. Outline the acreage dedicated to the subject well by colored pencil or hachure marks on the plat below.
2. If more than one lease is dedicated to the well, outline each and identify the ownership thereof (both as to working interest and royalty).
3. If more than one lease of different ownership is dedicated to the well, have the interests of all owners been consolidated by communitization, unitization, force-pooling, etc?

☐ Yes ☐ No If answer is "yes," type of consolidation Not Applicable

If answer is "no," list the owners and tract descriptions which have actually been consolidated. (Use reverse side of this form if necessary.) _____

No allowable will be assigned to the well until all interests have been consolidated (by communitization, unitization, forced-pooling, or otherwise) or until a non-standard unit, eliminating such interests, has been approved by the Commission.

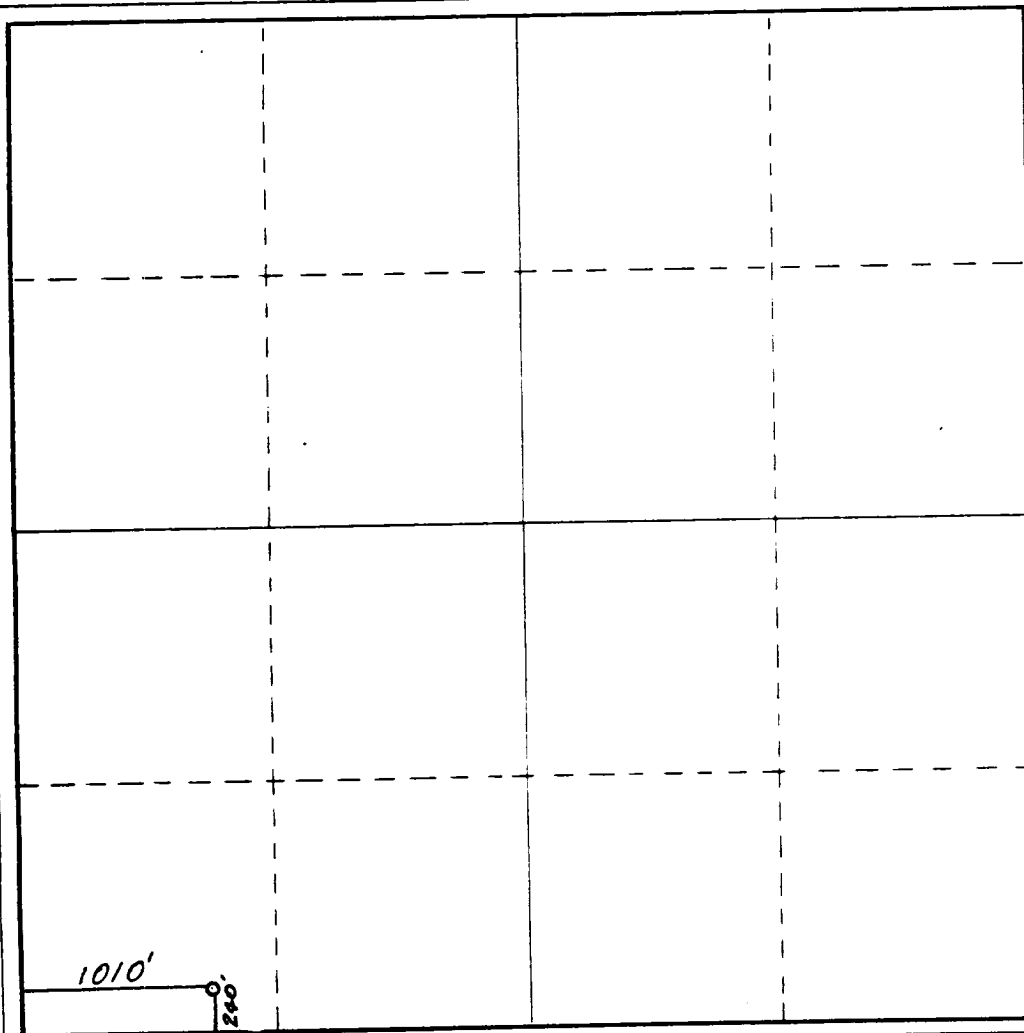

CERTIFICATION

I hereby certify that the information contained herein is true and complete to the best of my knowledge and belief.

Sandy Robertson

Name

Petroleum Engineer

Position

S & J Operating Company

Company

March 21, 1989

Date

Sandy Robertson

Date Surveyed

March 10, 1989

Registered Professional Engineer
 and/or Land Surveyor

Juan R. Reddy

Certificate No.

NM PE&LS NO. 5412

RECEIVED

MAY - 8 '89

O. C. D.
ARTESIA, OFFICE

April 12, 1989

WAIVER

CHEVRON U.S.A. (FORMERLY GULF OIL CORPORATION) HAS NO OBJECTION TO S & J OPERATING COMPANY DRILLING THE SOUTH RED LAKE GRAYBURG UNIT WELL NO. 48 AS AN UNORTHODOX DRILLING LOCATION. WE UNDERSTAND THAT THEY PROPOSE TO DRILL THIS WELL IN T17S, R27E, SECTION 36, 1010' FWL AND 240' FSL.

Alan W. Bohling
Signature
Division Production Engineer
Chevron U.S.A. Inc.

May 4, 1989
Date