

N.M. OIL CONS COMMISSION
P.O. BOX 1800
HOBBES, NEW MEXICO 88240
UNITED STATES
DEPARTMENT OF THE INTERIOR
BUREAU OF LAND MANAGEMENT

SUBMIT IN TWO COPIES
(Other instructions on reverse side)

FORM APPROVED
OMB NO. 1004-0136
Expires: February 28, 1995

APPLICATION FOR PERMIT TO DRILL OR DEEPEN

1a. TYPE OF WORK

DRILL ☒

DEEPEN ☐

b. TYPE OF WELL

OIL WELL ☒

GAS WELL ☐

OTHER

SINGLE ZONE ☒

MULTIPLE ZONE ☐

2. NAME OF OPERATOR

Nearburg Producing Company

3. ADDRESS AND TELEPHONE NO.

P. O. Box 823085, Dallas, TX 75382 214-739-1778

4. LOCATION OF WELL (Report location clearly and in accordance with any State requirements.)*

At surface

990' FNL and 990' FWL

At proposed prod. zone

14. DISTANCE IN MILES AND DIRECTION FROM NEAREST TOWN OR POST OFFICE*

10 Air Miles east of Carlsbad, New Mexico

15. DISTANCE FROM PROPOSED*

LOCATION TO NEAREST PROPERTY OR LEASE LINE, FT. (Also to nearest drlg. unit line, if any)

330'

16. NO. OF ACRES IN LEASE

40 acres/320 acres in unit

17. DISTANCE FROM PROPOSED LOCATION*

TO NEAREST WELL, DRILLING, COMPLETED, Yates Petro or APPLIED FOR, ON THIS LEASE, FT. Hickory W/2 17,

18. PROPOSED DEPTH:

8,000'

19. NO. OF ACRES ASSIGNED TO THIS WELL

320

20. ROTARY OR CABLE TOOLS

Rotary

21. ELEVATIONS (Show whether DF, RT, GR, etc.) 22S, 24E

3997' GR.

22. APPROX. DATE WORK WILL START*

8-20-93

PROPOSED CASING AND CEMENTING PROGRAM

SIZE OF HOLE	GRADE SIZE OF CASING	WEIGHT PER FOOT	SETTING DEPTH	QUANTITY OF CEMENT
12-1/4"	9-5/8"	36#	0 - 1,300'	775 sx Circulate
8-3/4"	7"	23# K-55	0 - 5,000'	950 sx Circulate
		26# K-55	5,000' - 8,000'	

Propose to drill the well to sufficient depth to evaluate the Cisco/Canyon formation. After reaching TD, logs will be run and casing set if the evaluation is positive. Perforate, test and stimulate as necessary to establish production.

Notice of Staking was filed 7-19-93 by Scott Kimbrough. Original Notice of Staking was 660' FNL and 660' FWL. It was necessary to move the location 140' South and 330' East because of drainage areas.

IN ABOVE SPACE DESCRIBE PROPOSED PROGRAM: If proposal is to deepen, give data on present productive zone and proposed new productive zone. If proposal is to drill or deepen directionally, give pertinent data on subsurface locations and measured and true vertical depths. Give blowout preventer program, if any.

SIGNED: Scott Kimbrough TITLE: Manager of Drilling Prod DATE: 7/21/93

(This space for Federal or State office use)

APPROVAL SUBJECT TO
GENERAL REQUIREMENTS AND
SPECIAL STIPULATIONS
ATTACHED

PERMIT NO. _____ APPROVAL DATE _____

Application approval does not warrant or certify that the applicant holds legal or equitable title to those rights in the subject lease which would entitle the applicant to production thereon.

CONDITIONS OF APPROVAL, IF ANY:

(ORIG. SGD.) RICHARD L. MANUS

AREA MANAGER

APPROVED BY _____ TITLE _____ DATE _____

AUG 30 1993

*See Instructions On Reverse Side

Title 18 U.S.C. Section 1001, makes it a crime for any person knowingly and willfully to make to any department or agency of the United States any false, fictitious or fraudulent statements or representations as to any matter within its jurisdiction.

RECEIVED

JUN 12 1993

U.S. DEPARTMENT OF
ENERGY

Submit to Appropriate
District Office
State Lease - 4 copies
Fee Lease - 3 copies

State of New Mexico
Energy, Minerals and Natural Resources Department

Form C-102
Revised 1-1-89

OIL CONSERVATION DIVISION

P.O. Box 2088
Santa Fe, New Mexico 87504-2088

DISTRICT I
P.O. Box 1980, Hobbs, NM 88240

DISTRICT II
P.O. Drawer DD, Artesia, NM 88210

DISTRICT III
1000 Rio Brazos Rd., Aztec, NM 87410

WELL LOCATION AND ACREAGE DEDICATION PLAT
All Distances must be from the outer boundaries of the section

Operator Nearburg Producing Company			Lease Red Walt Federal 10		Well No. 1
Unit Letter D	Section 10	Township 22 - S	Range 24 - E	County Eddy	
Actual Footage Location of Well: 990 feet from the North line and 990 feet from the West line					
Ground level Elev. 4002		Producing Formation CLAY	Pool SALT WATER (SEED)	Dedicated Acreage: 3.25 Acres	

- Outline the acreage dedicated to the subject well by colored pencil or hatchure marks on the plat below.
- If more than one lease is dedicated to the well, outline each and identify the ownership thereof (both as to working interest and royalty).
- If more than one lease of different ownership is dedicated to the well, have the interest of all owners been consolidated by communitization, unitization, force-pooling, etc?
☐ Yes ☐ No If answer is "yes" type of consolidation _____
If answer is "no" list the owners and tract descriptions which have actually been consolidated. (Use reverse side of this form if necessary.) _____
No allowable will be assigned to the well until all interests have been consolidated (by communitization, unitization, forced-pooling, or otherwise) or until a non-standard unit, eliminating such interest, has been approved by the Division.

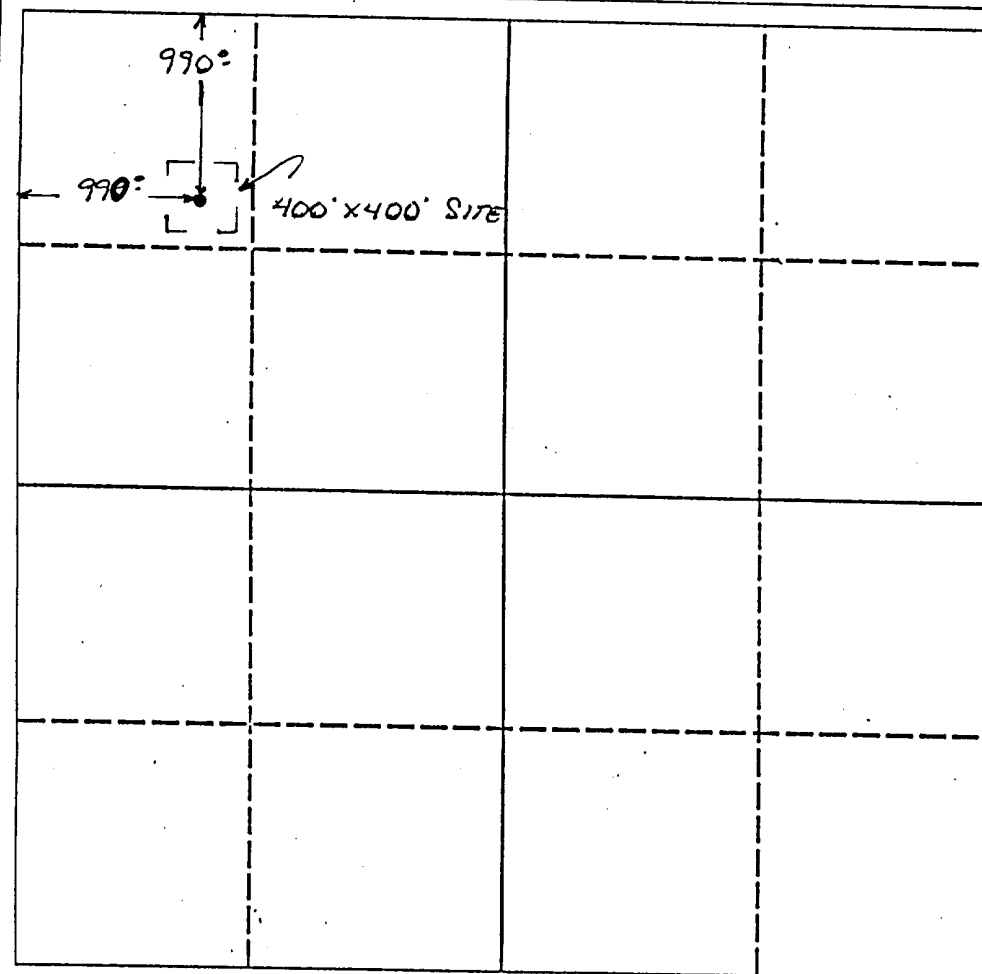

OPERATOR CERTIFICATION

I hereby certify that the information contained herein is true and complete to the best of my knowledge and belief.

Signature
[Signature]
Printed Name
H. L. WILLIS
Position
DRILL FULT
Company
NEARBURG PRODUCING CO.
Date
7/30/93

SURVEYOR CERTIFICATION

I hereby certify that the well location shown on this plat was plotted from field notes of actual surveys made by me or under my supervision, and that the same is true and correct to the best of my knowledge and belief.

Date Surveyed
July 30, 1993
Signature & Seal of Professional Surveyor
[Signature]
Certificate No.
2126

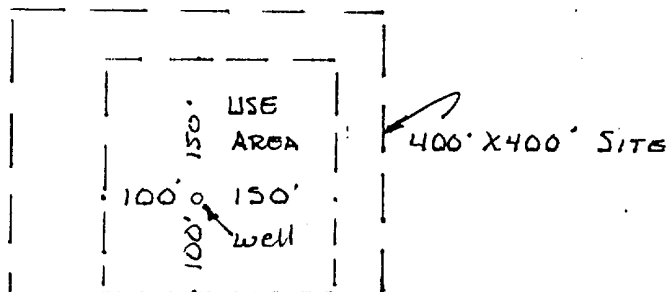
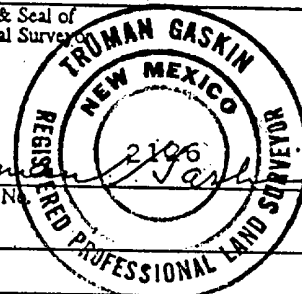

RECEIVED

APR 14 1993

U.S.
DEPT. OF JUSTICE

SURFACE USE AND OPERATIONS PLAN FOR
DRILLING, COMPLETION, AND PRODUCING

NEARBURG PRODUCING COMPANY
RED WALT 10 FEDERAL WELL NO. 1

~~800'~~ FNL and 990' FWL, SECTION 10-T22S-R24E
330' EDDY COUNTY, NEW MEXICO

(535)

LOCATED:

10 Air miles east of Carlsbad, New Mexico

OIL & GAS LEASE:

NMNM - ~~3000~~ 9000

RECORD LESSEE:

Nearburg Exploration Company

BOND COVERAGE:

\$25,000 statewide bond of Nearburg Producing Company.

ACRES IN LEASE:

40 acres/320 acres in unit.

GRAZING LEASE:

Dan Gregory
617 Queens Road
Carlsbad, NM 88220

POOL:

Cisco Wildcat

EXHIBITS:

- A. Area Road Map
- B. Drilling Rig Layout
- C. Vicinity Oil & Gas Map
- D. Topographic & Location Verification Map
- E. Well Location & Acreage Dedication Plat

This well will be drilled to a depth of approximately 8,000'.

1. **EXISTING ROADS:**

- A. Exhibit "A" is a portion of a section map showing the location of the proposed well as staked.
- B. Exhibit "C" is a plat showing existing roads in the vicinity of the proposed well site.

2. **ACCESS ROADS:**

A. **Length and Width:**

The access road will be approximately 12' wide and about 1550' long, and is shown on exhibit "D".

B. **Surface Material:**

Existing

C. **Maximum Grade:**

Less than two percent.

D. **Turnouts:**

None necessary.

E. **Drainage Design:**

Existing

F. **Culverts:**

None necessary.

G. **Gates and Cattle Guards:**

None necessary.

3. **LOCATION OF EXISTING WELLS:**

- A. Existing wells in the immediate area are shown on Exhibit "C".

4. **LOCATION OF EXISTING AND/OR PROPOSED FACILITIES:**

- A. Necessary production facilities for this well will be located on the well pad.

5. **LOCATION AND TYPE OF WATER SUPPLY:**

- A. It is not contemplated that a water well will be drilled. Water necessary for drilling will be purchased and hauled to the site over existing roads shown on Exhibit "D".

6. METHODS OF HANDLING WASTE DISPOSAL:

- A. Drilling fluids will be allowed to evaporate in the drilling pits until the pits are dry.
- B. Water produced during tests will be disposed of in the drilling pits.
- C. Oil produced during tests will be stored in test tanks.
- D. Trash, waste paper, garbage and junk will be ~~buried in a separate trash pit and covered with a minimum of 24 inches of dirt.~~ All waste material will be contained to prevent scattering by the wind. Location of the trash pit is shown on Exhibit "B". Not Authorized
- E. All trash and debris will be ~~buried or~~ removed from the well site within 30 days after finishing drilling and/or completion operations. N/A SJS

7. ANCILLARY FACILITIES:

- A. None required.

8. WELL SITE LAYOUT:

- A. Exhibit "B" shows the relative location and dimensions of the well pad, mud pits, reserve pit, and trash pit, and the location of major rig components.

9. PLANS FOR RESTORATION OF THE SURFACE:

- A. After completion of drilling and/or completion operations, all equipment and other material not needed for operations will be removed. The well site will be cleaned of all trash and junk to leave the site in an as aesthetically pleasing condition as possible.
- B. After abandonment, all equipment, trash, and junk will be removed and the site will be clean.

10. OTHER INFORMATION:

A. Topography:

The land surface at the well site is rolling native grass with a regional slope being to the east.

B. Soil:

Top soil at the well site is sandy soil.

C. Flora and Faunal:

The location is in an area sparsely covered with mesquite and range grasses.

RECEIVED

JUN 12 1983

NEW HAVEN
YCT 108

10. OTHER INFORMATION: (CONTINUED)

D. Ponds and Streams:

There are no rivers, lakes, ponds, or streams in the area.

E. Residences and Other Structures:

There are no occupied dwellings or other structures within a mile of the proposed well site.

F. Archaeological, Historical, and Cultural Sites:

None observed in area.

G. Land Use:

Grazing.

H. Surface Ownership: — BLM

(Grazing Lease)

Dan Gregory

617 Queens Road

Carlsbad, New Mexico 88220

11. OPERATOR'S REPRESENTATIVE:

E. Scott Kimbrough

419 W. Cain

Hobbs, New Mexico 88240

Office: (505) 397-4186

Home: (505) 392-2707

12. CERTIFICATION:

I hereby certify that I, or persons under my direct supervision, have inspected the proposed drill site and access route; that I am familiar with the conditions which presently exist; that the statements made in this plan are, to the best of my knowledge, true and correct; and, that the work associated with the operations proposed herein will be performed by Nearburg Producing Company and its contractors and subcontractors in conformity with this plan and the terms and conditions under which it is approve.

Date

7/21/93

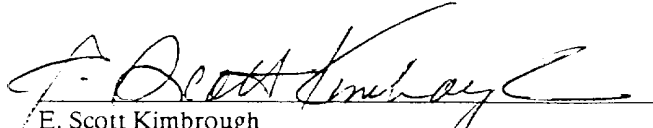
E. Scott Kimbrough
Manager of Drilling and Production

RECEIVED

APR 2 1983

LIBRARY
MICHIGAN STATE UNIVERSITY

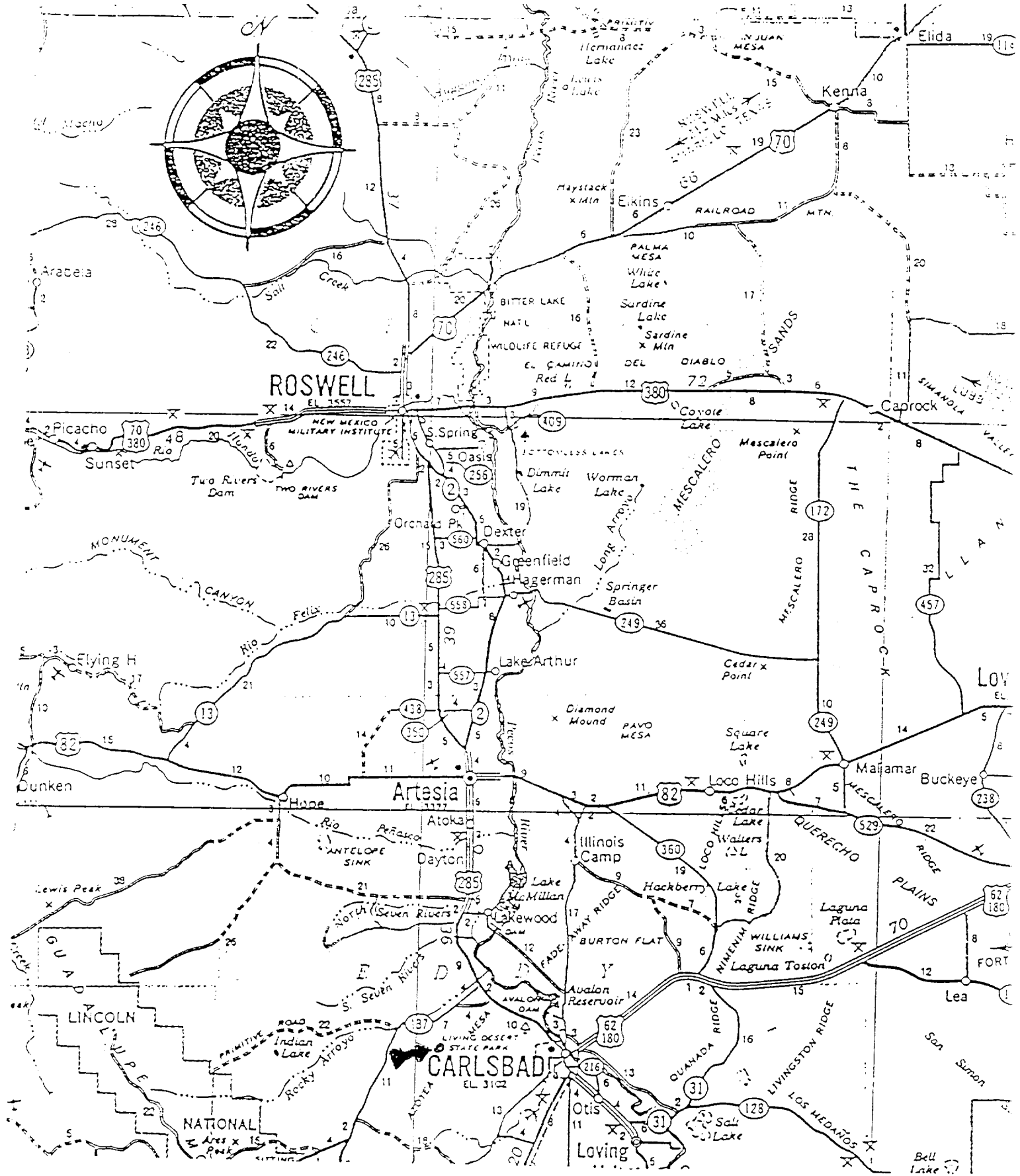

EXHIBIT A
AREA ROAD MAP

RECEIVED

1993

1993

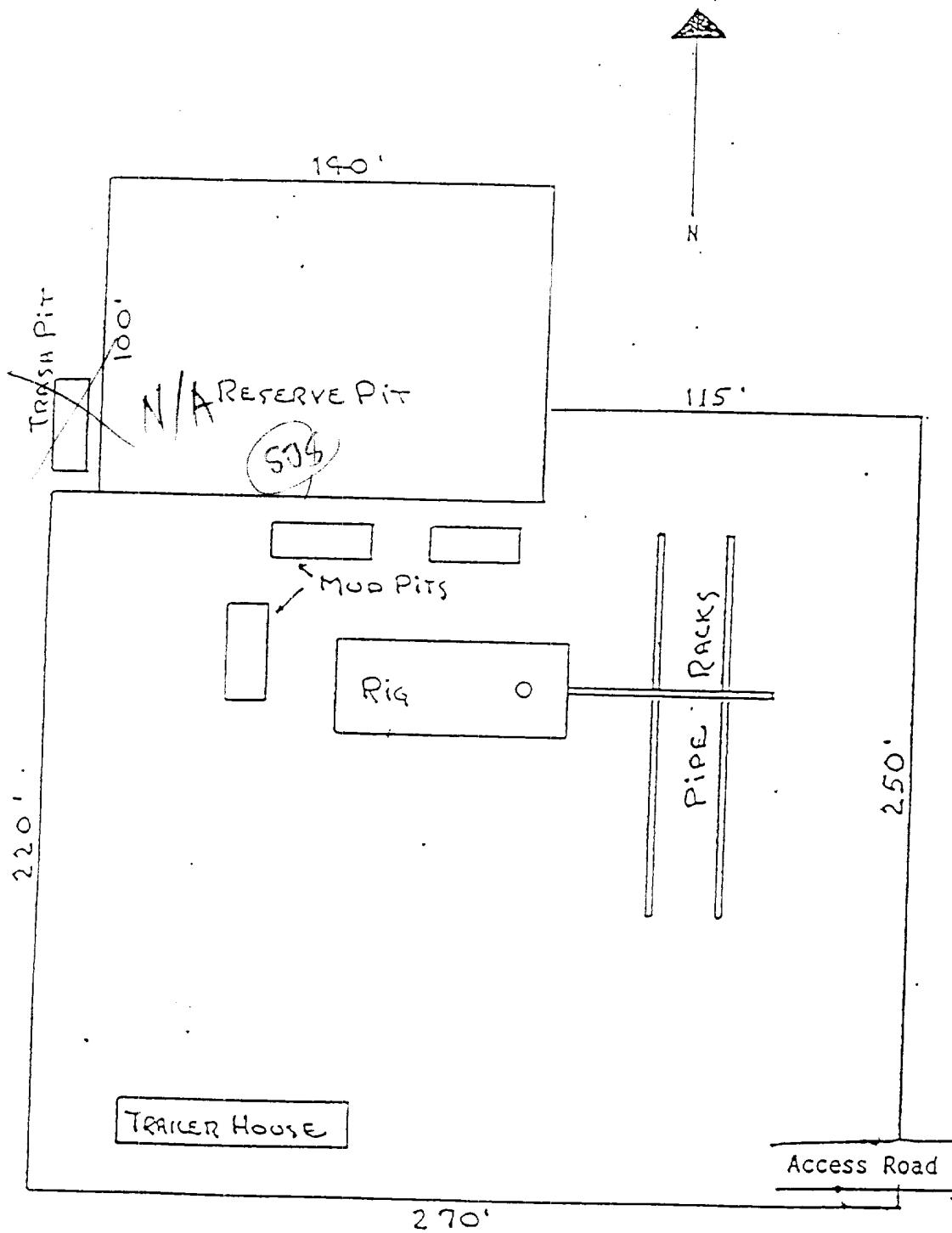
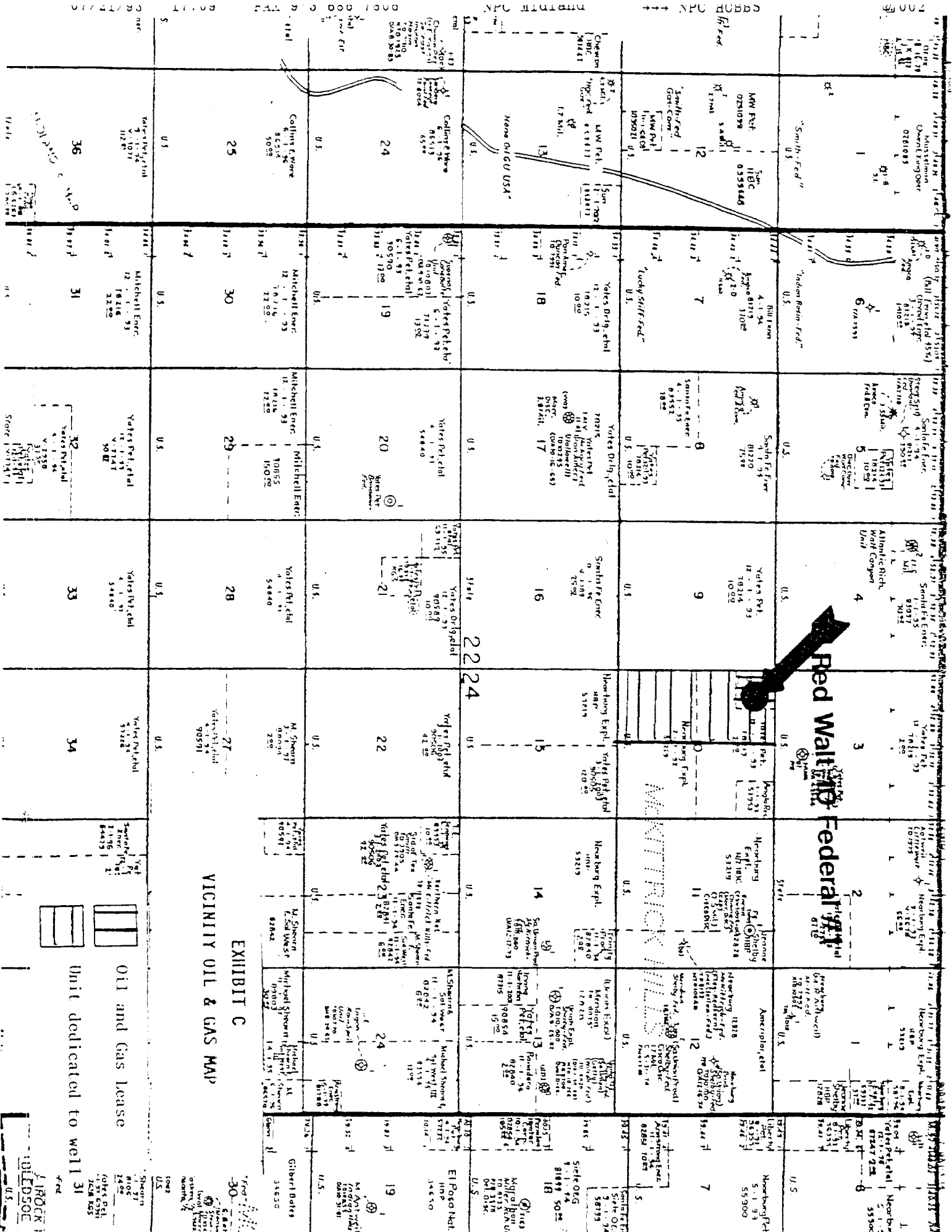

EXHIBIT B
 DRILLING RIG LAYOUT
 NEARBURG PRODUCING COMPANY
 RED WALT 10 FEDERAL #1
 SCALE 1" = 50

RECEIVED

APR 14 1988

U.S. DEPARTMENT OF
ENERGY



RECEIVED

1993

OFFICE

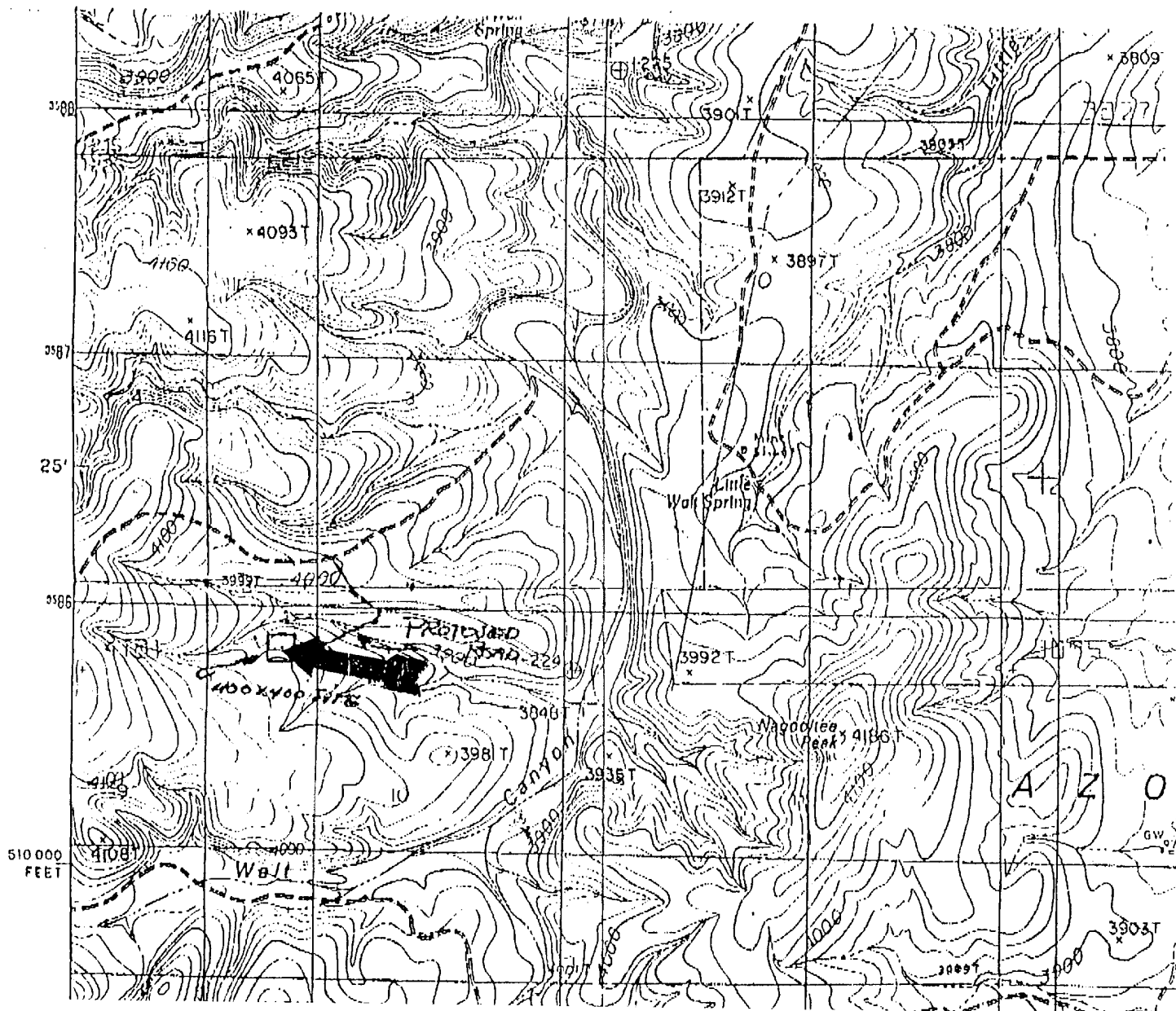

RECEIVED
 JUN 10 1993
 000 000 000
 000 000 000

OIL CONSERVATION DIVISION

EXHIBIT E

DISTRICT I
P.O. Box 1980, Hobbs, NM 88240

P.O. Box 2088
Santa Fe, New Mexico 87504-2088

DISTRICT II
P.O. Drawer DD, Artesia, NM 88210

DISTRICT III
1000 Rio Brazos Rd., Aztec, NM 87410

WELL LOCATION AND ACREAGE DEDICATION PLAT

All Distances must be from the outer boundaries of the section

Operator Nearburg Producing Company			Lease Red Walt 10 Federal		Well No. 1
Unit Letter D	Section 1N	Township 22 - S	Range 24 - E	County NMNM	Feddy
Actual Footage Location of Well					
990 feet from the West line and		800 feet from the North line			
Ground level Elev. 3997	Producing Formation Cisco/Canyon	Pool Cisco Wildcat	Dedicated Acreage 320 Acres		

1. Outline the acreage dedicated to the subject well by colored pencil or hatchure marks on the plat below.
2. If more than one lease is dedicated to the well, outline each and identify the ownership thereof (both as to working interest and royalty).
3. If more than one lease of different ownership is dedicated to the well, have the interest of all owners been consolidated by communitization, unitization, force-pooling, etc?
☐ Yes ☒ No If answer is "yes" type of consolidation _____
 If answer is "no" list the owners and tract descriptions which have actually been consolidated. (Use reverse side of this form if necessary. See attached
 No allowable will be assigned to the well until all interests have been consolidated (by communitization, unitization, forced-pooling, or otherwise) or until a non-standard unit, eliminating such interest, has been approved by the Division.

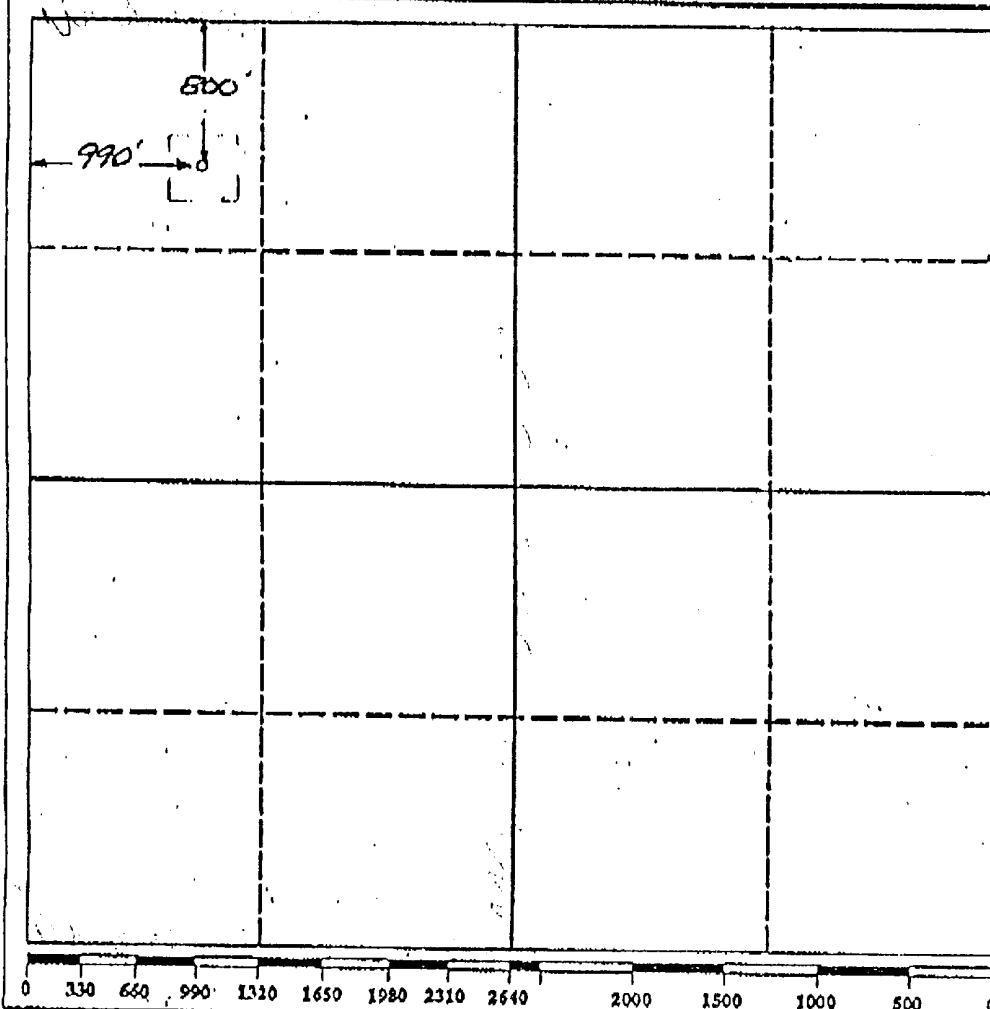

OPERATOR CERTIFICATION
I hereby certify that the information contained herein is true and complete to the best of my knowledge and belief.

Signature
E. Scott Kimbrough
Printed Name
E. Scott Kimbrough
Position
Manager of Drilling & Production Company
Nearburg Producing Company
Date
7/21/93

SURVEYOR CERTIFICATION

I hereby certify that the well location shown on this plat was plotted from field notes, actual surveys made by me or under my supervision, and that the same is true and correct to the best of my knowledge and belief.

Date Surveyed
July 21, 1993

Signature & Seal of Professional Engineer

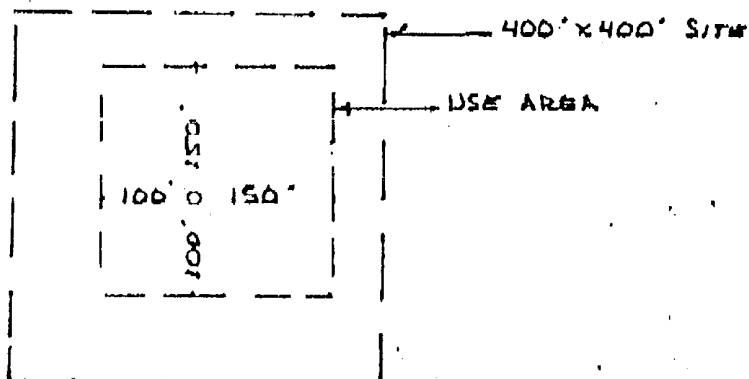
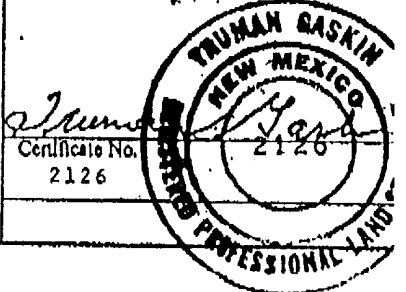

Nearburg Producing Company

Exploration and Production
419 W. Cain
Hobbs, New Mexico 88240
505-397-4186
FAX 505-397-3998

HYDROGEN SULFIDE DRILLING OPERATIONS PLAN
NEARBURG PRODUCING COMPANY
RED WALT 10 FEDERAL WELL NO. 1

I. HYDROGEN SULFIDE TRAINING

- A. All regularly assigned personnel, contracted or employed by Nearburg Producing Company, will receive training from a qualified instructor in the following areas prior to commencing drilling potential hydrogen sulfide bearing formations in this well:
 - 1. The hazards and characteristics of hydrogen sulfide (H₂S).
 - 2. The proper use and maintenance of personal protective equipment and life support systems.
 - 3. The proper use of H₂S detectors, alarms, warning systems, briefing areas, evacuation procedures, and prevailing winds.
 - 4. The proper techniques for first aid and rescue procedures.
- B. In addition, supervisory personnel will be trained in the following areas:
 - 1. The effects of H₂S on metal components. If high tensile tubulars are to be used, personnel will be trained in their special maintenance requirements.
 - 2. Corrective action and shut-in procedures when drilling or reworking a well and blowout prevention and well control procedures.
 - 3. The contents and requirements of the H₂S Drilling Operations Plan.
- C. There will be an initial training session just prior to encountering a known or probable H₂S zone (within 3 days or 500 feet) and weekly H₂S and well control drills for all personnel in each crew. The initial training session shall include a review of the site specific H₂S Drilling Operations Plan. This plan shall be available at the well site. All personnel will be required to carry documentation that they have received the proper training.

RECEIVED

APR 2 1983

NEW HAVEN
OFFICE

II. H2S SAFETY EQUIPMENT AND SYSTEMS

Note: All H2S safety equipment and systems will be installed, tested, and operational when drilling reaches a depth of 500 feet above, or three days prior to penetrating the first zone containing or reasonably expected to contain H2S.

A. Well Control Equipment:

1. Flare line with continuous pilot.
2. Choke manifold with a minimum of one remote choke.
3. Blind rams and pipe rams to accommodate all pipe sizes with properly sized closing unit.
4. Auxiliary equipment to include: annular preventer, mud-gas separator, rotating head, and flare gun with flares.

B. Protective Equipment for Essential Personnel:

1. Mark II Surviveair 30-minute units located in the dog house and at briefing areas, as indicated on well site diagram.

C. H2S Detection and Monitoring Equipment:

1. Two portable H2S monitors positioned on location for best coverage and response. These units have warning lights and audible sirens when H2S levels of 20 ppm are reached.
2. One portable SO2 monitor positioned near flare line.

D. Visual Warning Systems:

1. Wind direction indicators as shown on well site diagram.
2. Caution/Danger signs shall be posted on roads providing direct access to location. Signs will be painted a high visibility yellow with black lettering of sufficient size to be readable at a reasonable distance from the immediate location. Bilingual signs will be used when appropriate. See example attached.

E. Mud Program:

1. The Mud Program has been designed to minimize the volume of H2S circulated to the surface. Proper mud weights, safe drilling practices, and the use of H2S scavengers will minimize hazards when penetrating H2S bearing zones.
2. A mud-gas separator will be utilized.

RECEIVED

NOV 1993

LIBRARY
UNIVERSITY OF CALIFORNIA

F. Metallurgy:

1. All drill strings, casings, tubing, wellhead, blowout preventers, drilling spool, kill lines, choke manifold and lines, and valves shall be suitable for H₂S service.

G. Communication:

1. Cellular telephone communications in company vehicles and mud logging trailer.
2. Land line (telephone) communications at area office.

H. Well Testing:

1. Drill stem testing will be performed with a minimum number of personnel in the immediate vicinity which are necessary to safely and adequately conduct the test. The drill stem testing in an H₂S environment will be conducted during the daylight hours.

RECEIVED

APR 2 1983

U.S. DEPARTMENT OF
ENERGY

WARNING

YOU ARE ENTERING AN H₂S
AREA - AUTHORIZED PERSONNEL ONLY

1. *BEARDS OR CONTACT LENSES NOT ALLOWED*
2. *HARD HATS REQUIRED*
3. *SMOKING IN DESIGNATED AREAS ONLY*
4. *BE WIND CONSCIOUS AT ALL TIMES*
5. *CHECK WITH NEARBURG SUPERINTENDENT AT MAIN OFFICE*

NEARBURG PRODUCING COMPANY

1-505-397-4186

RECEIVED

JUN 13 1993

LIBRARY OF
CONGRESS

Flare Line and Pit

Reserve Pit

Mud Circulating Tanks

M

W

Mud Pumps

Fuel

Water

Oil

Substructure and Doghouse

M

B

Mud Logger

Pipe Racks

Slide

B

Co. Trailer

Parking

Location Entrance Warning Sign

Prevailing Wind Directions: Summer – South / Southwest
Winter – North / Northwest

RECEIVED

JUN 12 1993

U.S. DEPARTMENT OF
ENERGY

SUPPLEMENTAL DRILLING DATA
NEARBURG PRODUCING COMPANY
RED WALT 10 FEDERAL WELL NO. 1

1. SURFACE FORMATION:

Yates Formation of Permian Age.

2. ESTIMATED TOPS OF GEOLOGIC MARKERS:

San Andres.....	800'	Bottom Dolomite.....	7,936'
Glorieta.....	1,400'	TD.....	8,000'
Bone Springs.....	6,000'		
Wolfcamp	7,280'		
Cisco/Canyon.....	7,860'		
Top Dolomite.....	7,868'		

3. ANTICIPATED POSSIBLE HYDROCARBON BEARING ZONES:

Cisco/Canyon Dolomite.....7868'

4. CASING AND CEMENTING PROGRAM:

<u>Casing Size</u>	<u>Setting Depth</u> <u>From To</u>	<u>Weight</u>	<u>Grade</u>	<u>Joint</u>
9-5/8"	0' 1,300'	36#	J-55	ST&C
7"	0' 8,000'	23# & 26	J-55 & N-80	ST&C & LT&C

Equivalent or adequate grades and weights of casing may be substituted at time casing is run, depending on availability.

We plan to drill a 12-1/4" hole to equal 1,300'.

9-5/8" casing will be cemented with 775 sx or volume necessary to tie back to surface.

7" production casing will be cemented with approximately 950 sx of Class "H" 50/50 POZ.

5. PRESSURE CONTROL EQUIPMENT:

The BOP stack will consist of a 3,000 psi working pressure, dual ram type preventer *& Annular* *975*

A BOP sketch is attached.

RECEIVED

JUN 03 1993

LIBRARY
JUN 03

6. CIRCULATING MEDIUM:

Surface to 8,000':

Spud and drill to 4,500' with fresh water mud, weight 8.9 to 9.1 ppg, viscosity 32 to 38. Below 4,500', add brine to bring chlorides up to at least 60,000 ppm. Use starch for water loss of 8-10 cc, viscosity 35-38, mud weight 9.2 to 9.7 ppg.

7. AUXILLARY EQUIPMENT:

None required.

8. TESTING, LOGGING, AND CORING PROGRAM:

Electric logging is planned, drill stem tests possible.

9. ABNORMAL PRESSURES, TEMPERATURES, OR HYDROGEN SULFIDE GAS:

None anticipated.

10. ANTICIPATED STARTING DATE:

It is planned that operations will commence on August 20, 1993, with drilling and completion operations lasting about 45 days.

RECEIVED

SEP 13 1993

U.S. MARSHALS
OFFICE

BLOWOUT PREVENTER SKETCH
Nearburg Producing Company
Red Walt 10 Federal #1

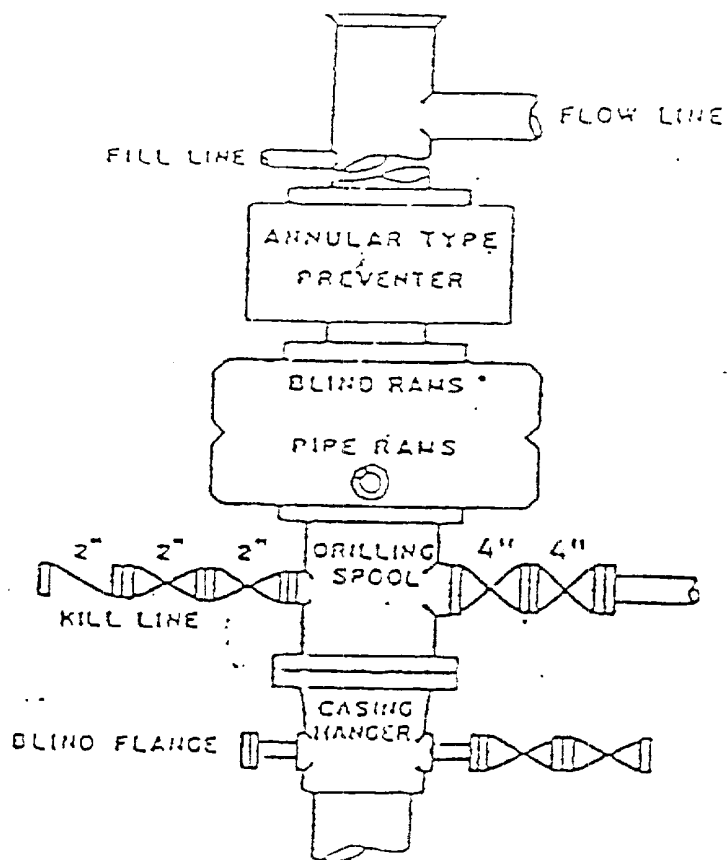

900 SERIES

RECEIVED

SEP 11 1993

ADOLPHUS
1993

DRILLING OPERATIO
CHOKE MANIFOLD
2M AND 3M SERVICE
RED WALT 10 FEDERAL #1

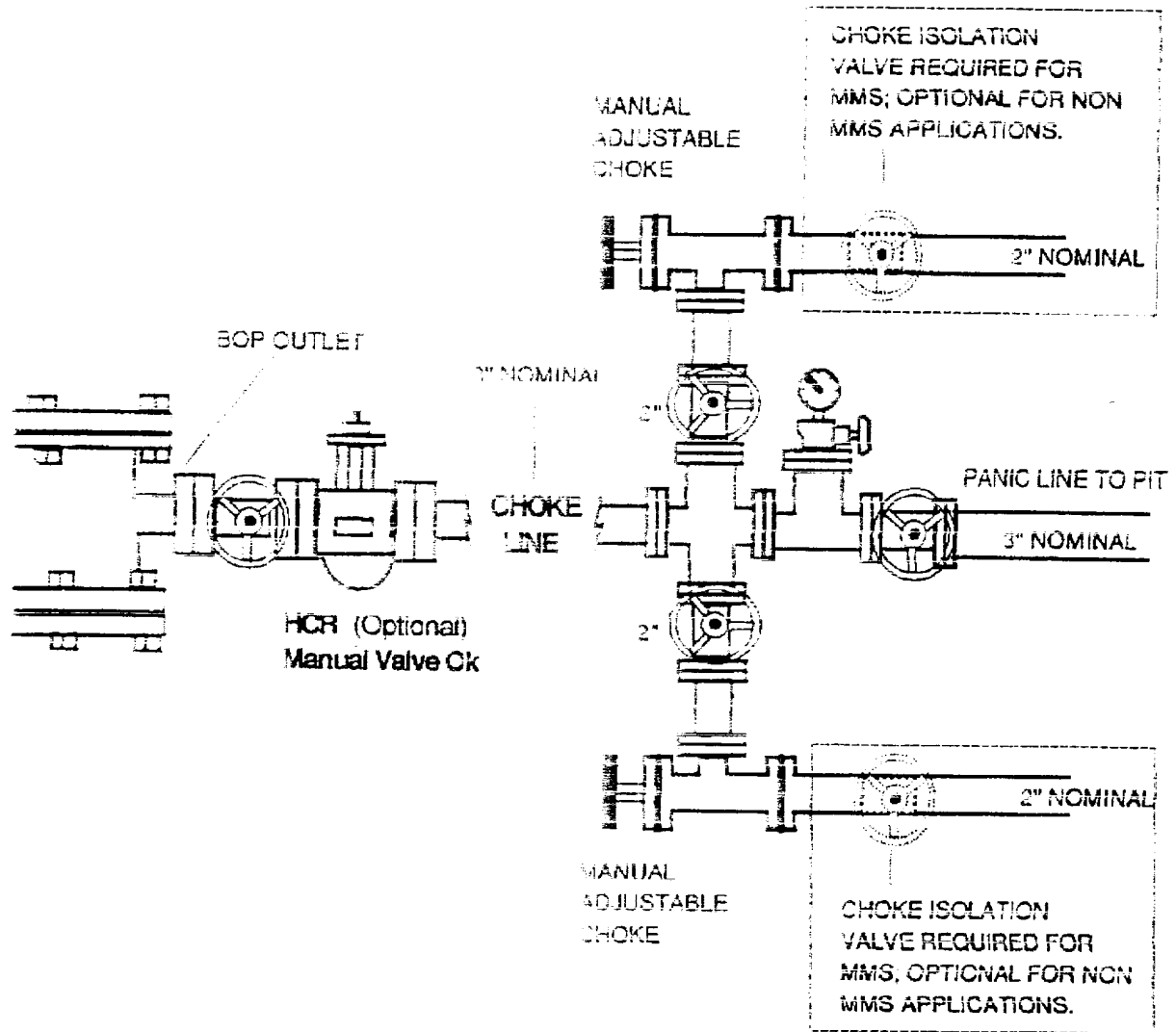

RECEIVED

JUL 9 1993

JOHN HENRY
OFFICE

UNITED STATES
DEPARTMENT OF THE INTERIOR
BUREAU OF LAND MANAGEMENT

FORM APPROVED
Budget Bureau No. 1004-0135
Expires: March 31, 1993

SUNDRY NOTICES AND REPORTS ON WELLS

Do not use this form for proposals to drill or to deepen or reentry to a different reservoir.
Use "APPLICATION FOR PERMIT—" for such proposals

SUBMIT IN TRIPLICATE

1. Type of Well

☒ Oil Well ☐ Gas Well ☐ Other

2. Name of Operator

Nearburg Producing Company

3. Address and Telephone No.

P. O. Box 823085, Dallas, TX 75382 214-739-1778

4. Location of Well (Footage, Sec., T., R., M., or Survey Description)

990' FNL and 990' FWL, Section 10, T22S, R24E

GROUND LEVEL ELEV → 4002'

5. Lease Designation and Serial No.

NM 90505

6. If Indian, Allottee or Tribe Name

7. If Unit or CA, Agreement Designation

8. Well Name and No.

Red Walt 10 Fed #1

9. API Well No.

10. Field and Pool, or Exploratory Area

Cisco Wildcat

11. County or Parish, State

Eddy County, NM

CHECK APPROPRIATE BOX(S) TO INDICATE NATURE OF NOTICE, REPORT, OR OTHER DATA

TYPE OF SUBMISSION

- ☒ Notice of Intent
☐ Subsequent Report
☐ Final Abandonment Notice

TYPE OF ACTION

- ☐ Abandonment
☐ Recompletion
☐ Plugging Back
☐ Casing Repair
☐ Altering Casing
☒ Other *Surface Location Change*
☐ Change of Plans
☐ New Construction
☐ Non-Routine Fracturing
☐ Water Shut-Off
☐ Conversion to Injection
☐ Dispose Water

(Note: Report results of multiple completion on Well Completion or Recompletion Report and Log form.)

13. Describe Proposed or Completed Operations. Clearly state all pertinent details, and give pertinent dates, including estimated date of starting any proposed work. If well is directionally drilled, give subsurface locations and measured and true vertical depths for all markers and zones pertinent to this work.

This Sundry Notice is submitted to change location 190' south per BLM request (drainage problem).

14. I hereby certify that the foregoing is true and correct

Signed *[Signature]*

Title Drilling Supt.

Date 07/29/93

(This space for Federal or State office use)

Approved by (ORIG. SGD) RICHARD L. MANUS
Conditions of approval, if any.

Title AREA MANAGER

Date AUG 30 1993

Title 18 U.S.C. Section 1001, makes it a crime for any person knowingly and willfully to make to any department or agency of the United States any false, fictitious or fraudulent statements or representations as to any matter within its jurisdiction.

*See Instruction on Reverse Side

RECEIVED

APR 11 1903

U.S. HOUSE
OF REPRESENTATIVES