

NM OIL & GAS COMMISSION  
DRAWN: DD  
ARTESIA UNITS DISTRICTS  
DEPARTMENT OF THE INTERIOR  
BUREAU OF LAND MANAGEMENT

SUBMIT IN TRIPLICATE\*  
(Other instructions on  
reverse side)

FORM APPROVED  
OMB NO. 1004-0136  
Expires: February 28, 1995

APPLICATION FOR PERMIT TO DRILL OR DEEPEN

1a. TYPE OF WORK DRILL <input checked="" type="checkbox"/> DEEPEN <input type="checkbox"/>			5. LEASE DESIGNATION AND SERIAL NO. NM-57525		
b. TYPE OF WELL OIL WELL <input checked="" type="checkbox"/> GAS WELL <input type="checkbox"/> OTHER <input type="checkbox"/>			6. IF INDIAN, ALLOTTEE OR TRIBE NAME		
2. NAME OF OPERATOR YATES PETROLEUM CORPORATION			7. UNIT AGREEMENT NAME		
3. ADDRESS AND TELEPHONE NO. 105 South Fourth Street, Artesia, New Mexico 88210			8. FARM OR LEASE NAME, WELL NO. Colonel "AOE" Federal #1		
4. LOCATION OF WELL (Report location clearly and in accordance with any State requirements.)* At surface Unit Letter I; 1980' FSL and 660' FSL At proposed prod. zone Same			9. API WELL NO. 30-015-27923		
14. DISTANCE IN MILES AND DIRECTION FROM NEAREST TOWN OR POST OFFICE* 26 miles Southeast of Malaga, New Mexico			10. FIELD AND POOL, OR WILDCAT Wildcat Bone Spring 96037		
15. DISTANCE FROM PROPOSED* LOCATION TO NEAREST PROPERTY OR LEASE LINE, FT. (Also to nearest drg. unit line, if any) 1980'		16. NO. OF ACRES IN LEASE 1200	17. NO. OF ACRES ASSIGNED TO THIS WELL 40		
18. DISTANCE FROM PROPOSED LOCATION* TO NEAREST WELL, DRILLING, COMPLETED, OR APPLIED FOR, ON THIS LEASE, FT.		19. PROPOSED DEPTH 9200'	20. ROTARY OR CABLE TOOLS Rotary		
21. ELEVATIONS (Show whether DF, RT, GR, etc.) 2940 GR			22. APPROX. DATE WORK WILL START* ASAP		

PROPOSED CASING AND CEMENTING PROGRAM

SIZE OF HOLE	GRADE SIZE OF CASING	WEIGHT PER FOOT	SETTING DEPTH	QUANTITY OF CEMENT
17 1/2"	13 3/8" J-55	48#	1450'	1000 sacks CIRCULATE
12 1/4"	8 5/8" J-55	32#	2900'	1200 sacks [TIE BACK INTO 13 3/8"]
7 7/8"	5 1/2" J-55 & N-80	15.50# & 17#	TD	1150 sacks [TIE BACK INTO 8 5/8"]

Yates Petroleum Corporation proposes to drill and test the Bone Spring and Intermediate formations. Approximately 1450' of surface casing will be set and cement circulated. Approximately 2900' of intermediate casing will be set and cement circulated. If determined to be commercial production casing will be set and cemented with adequate cover, perforated and stimulated as needed for production.

MUD PROGRAM: FW/Spud Mud to 1450'; Brine to 2900'; Cut Brine to TD.

BOPE PROGRAM: BOPE will be installed on the 13 3/8" casing and tested daily for operational.

IN ABOVE SPACE DESCRIBE PROPOSED PROGRAM: If proposal is to deepen, give data on present productive zone and proposed new productive zone. If proposal is to drill or deepen directionally, give pertinent data on subsurface locations and measured and true vertical depths. Give blowout preventer program, if any.

SIGNED Clifton R. May TITLE Permit Agent DATE 1/24/94

(This space for Federal or State office use)

PERMIT NO. \_\_\_\_\_ APPROVAL DATE \_\_\_\_\_  
APPROVAL SUBJECT TO GENERAL REQUIREMENTS AND SPECIAL STIPULATIONS ATTACHED

APPROVED BY 151 Ron Duntun TITLE (for) AREA MANAGER DATE 4-20-94

\*See Instructions On Reverse Side

U.S.C. Section 1001, makes it a crime for any person knowingly and willfully to make to any department or agency of the

UNITED STATES  
DEPARTMENT OF THE INTERIOR  
BUREAU OF LAND MANAGEMENT

FORM APPROVED  
Budget Bureau No. 1004-0135  
Expires: March 31, 1993

**SUNDRY NOTICES AND REPORTS ON WELLS**

Do not use this form for proposals to drill or to deepen or reentry to a different reservoir.  
Use "APPLICATION FOR PERMIT—" for such proposals

5. Lease Designation and Serial No.

NM-57525

6. If Indian, Allottee or Tribe Name

7. If Unit or CA, Agreement Designation

8. Well Name and No.

Colonel "AOE" Federal #1

9. API Well No.

10. Field and Pool, or Exploratory Area

Wildcat Bone Spring

11. County or Parish, State

Eddy County, New Mexico

**SUBMIT IN TRIPLICATE**

1. Type of Well

☒ Oil Well ☐ Gas Well ☐ Other

2. Name of Operator

YATES PETROLEUM CORPORATION

3. Address and Telephone No.

105 South Fourth Street, Artesia, New Mexico 88210

4. Location of Well (Footage, Sec., T., R., M., or Survey Description)

Unit Letter I; 1780' FSL and 710' FEL  
Section 33-T24S-R29E

**CHECK APPROPRIATE BOX(s) TO INDICATE NATURE OF NOTICE, REPORT, OR OTHER DATA**

**TYPE OF SUBMISSION**

- ☐ Notice of Intent  
☐ Subsequent Report  
☐ Final Abandonment Notice

**TYPE OF ACTION**

- ☐ Abandonment  
☐ Recompletion  
☐ Plugging Back  
☐ Casing Repair  
☐ Altering Casing  
☐ Other

- ☒ Change of Plans  
☐ New Construction  
☐ Non-Routine Fracturing  
☐ Water Shut-Off  
☐ Conversion to Injection  
☐ Dispose Water

(Note: Report results of multiple completion on Well Completion or Recompletion Report and Log form.)

13. Describe Proposed or Completed Operations (Clearly state all pertinent details, and give pertinent dates, including estimated date of starting any proposed work. If well is directionally drilled, give subsurface locations and measured and true vertical depths for all markers and zones pertinent to this work.)\*

Yates Petroleum Corporation was instructed by the Bureau of Land Management to move this location from 1980' FSL and 660' FEL, South at least 200' and adjust it to the West because of archaeological sites discovered. Attached are a new plat showing the move along with new maps and certain pages to replace the old ones in the original APD.

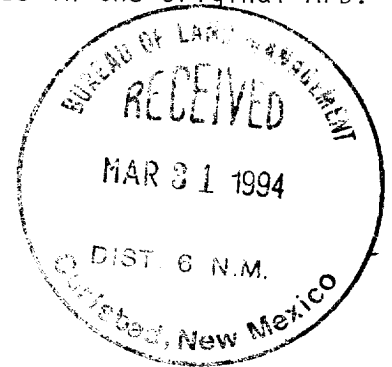

14. I hereby certify that the foregoing is true and correct

Signed Clifton R. May

Title Permit Agent

Date 3/30/94

(This space for Federal or State office use)

Approved by Bob Dunton

Title (for) AREA MANAGER

Date 4-20-94

Title 18 U.S.C. Section 1001, makes it a crime for any person knowingly and willfully to make to any department or agency of the United States any false, fictitious or fraudulent statements or representations as to any matter within its jurisdiction.

\*See Instruction on Reverse Side

Submit to Appropriate  
District Office  
State Lease - 4 copies  
Fee Lease - 3 copies

State of New Mexico  
Energy, Minerals and Natural Resources Department

Form C-102  
Revised 1-1-89

OIL CONSERVATION DIVISION

P.O. Box 2088  
Santa Fe, New Mexico 87504-2088

DISTRICT I  
P.O. Box 1980, Hobbs, NM 88240

DISTRICT II  
P.O. Drawer DD, Artesia, NM 88210

DISTRICT III  
1000 Rio Brazos Rd., Aztec, NM 87410

WELL LOCATION AND ACREAGE DEDICATION PLAT

All Distances must be from the outer boundaries of the section

Operator <b>YATES PETROLEUM CORPORATION</b>			Lease <b>COLONEL "AOE" FEDERAL</b>		Well No. <b>1</b>
Unit Letter <b>I</b>	Section <b>33</b>	Township <b>24 SOUTH</b>	Range <b>29 EAST</b>	County <b>EDDY COUNTY, NM</b>	
Actual Footage Location of Well: <b>1780</b> feet from the <b>SOUTH</b> line and <b>710</b> feet from the <b>EAST</b> line					
Ground level Elev. <b>2940.</b>	Producing Formation <b>BONE SPRING</b>	Pool <b>WILDCAT BONE SPRING</b>	Dedicated Acreage: <b>40</b> Acres		

- Outline the acreage dedicated to the subject well by colored pencil or hatchure marks on the plat below.
- If more than one lease is dedicated to the well, outline each and identify the ownership thereof (both as to working interest and royalty).
- If more than one lease of different ownership is dedicated to the well, have the interest of all owners been consolidated by communitization, unitization, force-pooling, etc.?  
☐ Yes ☐ No If answer is "yes" type of consolidation \_\_\_\_\_  
If answer is "no" list the owners and tract descriptions which have actually been consolidated. (Use reverse side of this form if necessary). \_\_\_\_\_  
No allowable will be assigned to the well until all interests have been consolidated (by communitization, unitization, forced-pooling, or otherwise) or until a non-standard unit, eliminating such interest, has been approved by the Division.

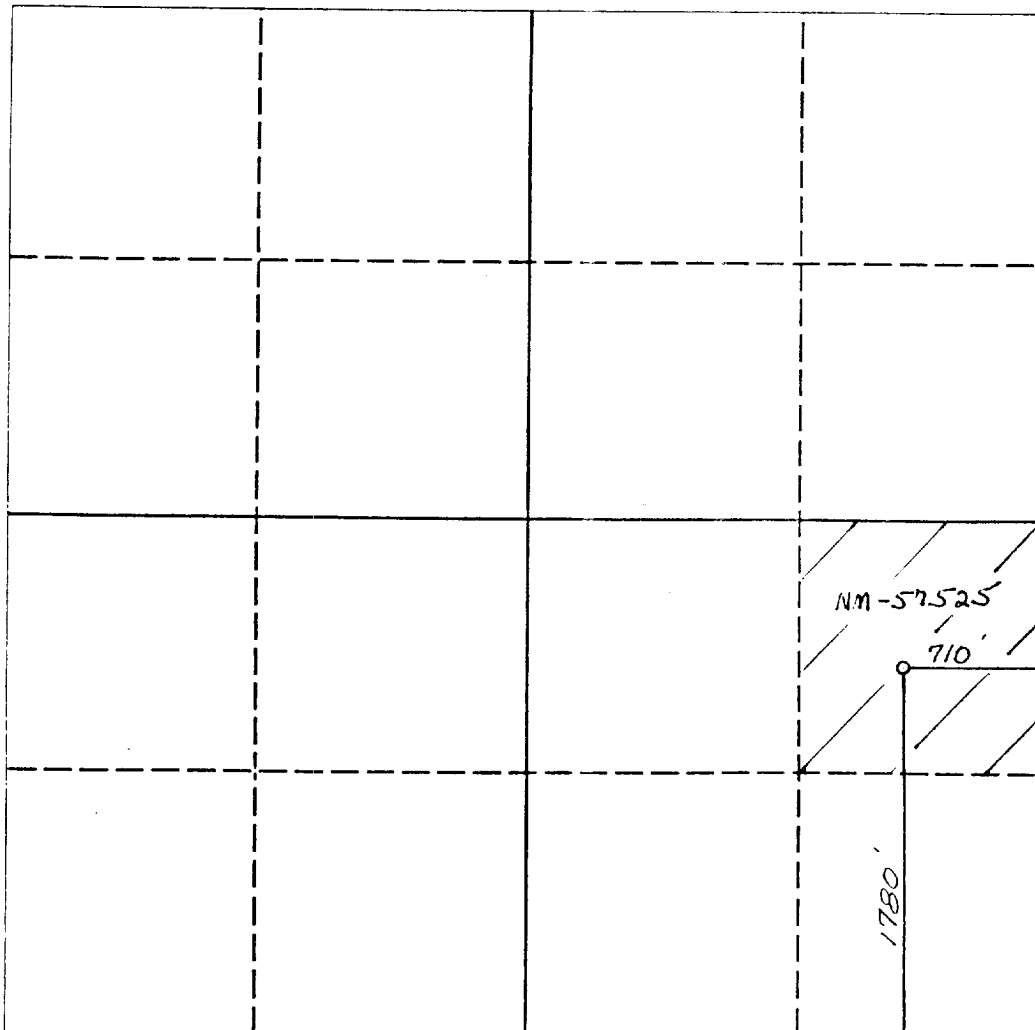

OPERATOR CERTIFICATION

I hereby certify that the information contained herein is true and complete to the best of my knowledge and belief.

Signature: *Clifton R. May*  
Printed Name: **CLIFTON R. MAY**  
Position: **PERMIT AGENT**  
Company: **YATES PETROLEUM CORPORATION**  
Date: **MARCH 30, 1994**

SURVEYOR CERTIFICATION

I hereby certify that the well location shown on this plat was plotted from field notes of actual surveys made by me or under my supervision, and that the same is true and correct to the best of my knowledge and belief.

Date Surveyed:  
**MARCH 21, 1994**

Signature & Seal of Professional Surveyor

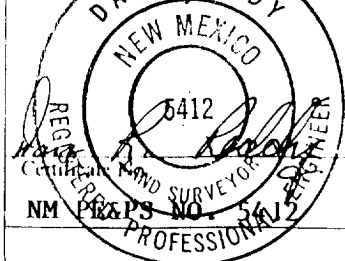

0 330 660 990 1320 1650 1980 2310 2640 2000 1500 1000 500 0

# YATES PETROLEUM CORPORATION

**Yates Petroleum Corporation**

105 SOUTH 4th STREET  
ARTESIA, NEW MEXICO 88210

COLONEL "AOE" FEDERAL #1  
1780' FSL and 710' FEL  
Section 33-T24S-R29E  
Eddy County, New Mexico

EXHIBIT B

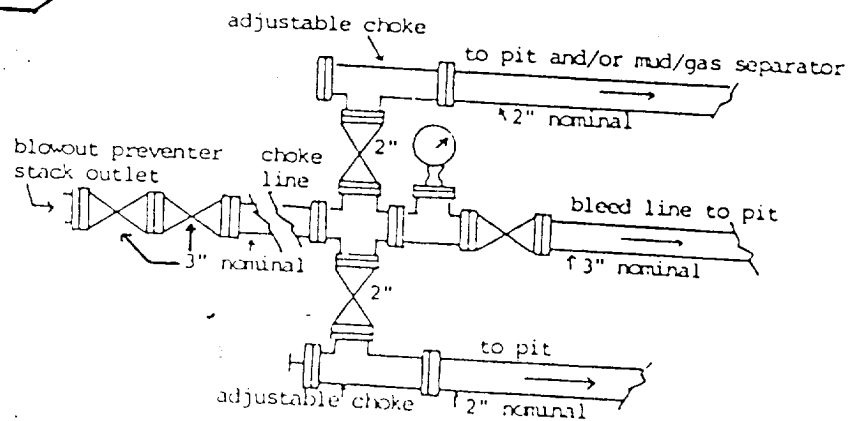
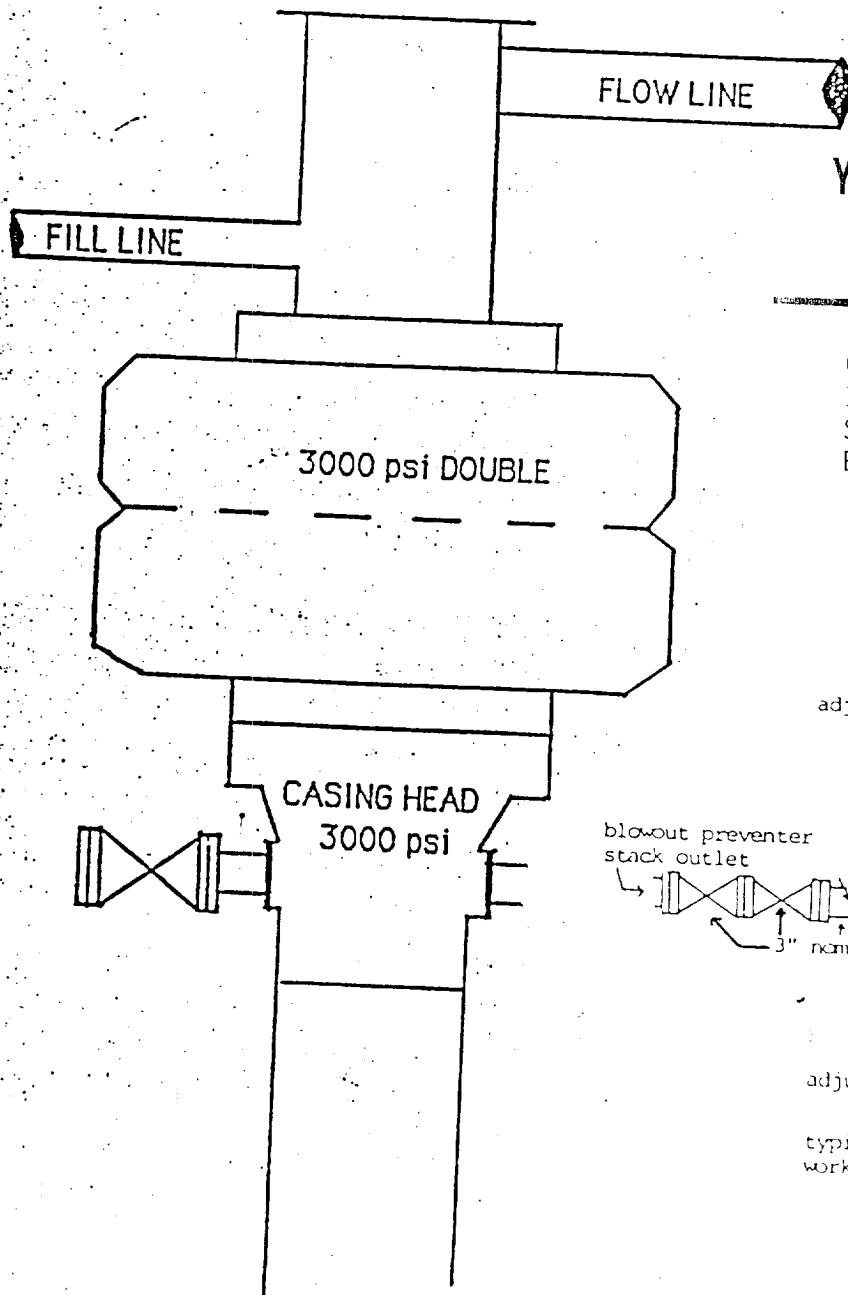

typical choke manifold assembly for 3M rated  
working pressure service-surface installation

**BLOWOUT PREVENTER  
3M SYSTEM**