

District I
PO Box 1980, Hobbs, NM 88241-1980
District II
PO Drawer DD, Artesia, NM 88211-0719
District III
1000 Rio Brazos Rd., Aztec, NM 87410
District IV
PO Box 2088, Santa Fe, NM 87504-2088

State of New Mexico
Energy, Minerals & Natural Resources Department

OIL CONSERVATION DIVISION
PO Box 2088
Santa Fe, NM 87504-2088

Form C-101
Revised February 10, 1994
Instructions on back
Submit to Appropriate District Office
State Lease - 6 Copies
Fee Lease - 5 Copies

☐ AMENDED REPORT

APPLICATION FOR PERMIT TO DRILL, RE-ENTER, DEEPEN, PLUGBACK, OR ADD A ZONE

Operator Name and Address. Pogo Producing Company P.O. Box 10340 Midland, Texas 79702		OGRID Number 017891
		API Number 30-015-28688
Property Code 17563	Gaines "21" Property Name	Well No. 2

Surface Location

UL or lot no.	Section	Township	Range	Lot Ida	Feet from the	North/South line	Feet from the	East/West line	County
N	21	24S	29E		990	South	2310	West	Eddy

Proposed Bottom Hole Location If Different From Surface

UL or lot no.	Section	Township	Range	Lot Ida	Feet from the	North/South line	Feet from the	East/West line	County

Proposed Pool 1 50371 Unders Pierce Crossing; Bone Springs	Proposed Pool 2
--	-----------------

Work Type Code N	Well Type Code O	Cable/Rotary R	Lease Type Code S	Ground Level Elevation 2939'
Multiple S	Proposed Depth 7800'	Formation Bone Springs	Contractor To be selected	Spud Date Upon Approval

Proposed Casing and Cement Program

Hole Size	Casing Size	Casing weight/foot	Setting Depth	Sacks of Cement	Estimated TOC
17 1/2"	13 3/8"	54.5#	500'	500sx	Surface
12 1/4"	8 5/8"	24 & 32#	2900'	900sx	Surface
7 7/8"	5 1/2"	17#	7800'	1100	2000'

Describe the proposed program. If this application is to DEEPEN or PLUG BACK give the data on the present productive zone and proposed new productive zone. Describe the blowout prevention program, if any. Use additional sheets if necessary.

This proposed well is a Delaware/Bone Springs Test.

B.O.P. Sketch is attached.

Post ID-1

10-13-95

New Loc & API

RECEIVED

OCT 00 1995

OIL CON. DIV.
DIST. 2

I hereby certify that the information given above is true and complete to the best of my knowledge and belief.

Signature:

Printed name:

James M.C. Ritchie, Jr.

Title:

Agent

Date:

10/04/95

Phone:

(915) 682-6601

OIL CONSERVATION DIVISION

Approved by:

ORIGINAL SIGNED BY TIM W. GUM

Title:

DISTRICT II SUPERVISOR

Approval Date:

10/10/95

Expiration Date:

9/10/95

Conditions of Approval:

Attached ☐

DISTRICT I
P.O. Box 1980, Hobbs, NM 88241-1980

DISTRICT II
P.O. Drawer DD, Artesia, NM 88211-0719

DISTRICT III
1000 Rio Brazos Rd., Aztec, NM 87410

DISTRICT IV
P.O. BOX 2068, SANTA FE, N.M. 87504-2068

State of New Mexico
Energy, Minerals and Natural Resources Department

Form C-102
Revised February 10, 1994
Submit to Appropriate District Office
State Lease - 4 Copies
Fee Lease - 3 Copies

OIL CONSERVATION DIVISION

P.O. Box 2088
Santa Fe, New Mexico 87504-2088

☐ AMENDED REPORT

WELL LOCATION AND ACREAGE DEDICATION PLAT

API Number 30-CIS-28688	Pool Code SO 371	Under Pierce Cross Pool Name Bone Springs WILDCAT (BONE SPRINGS)
Property Code	Property Name GAINES "21"	Well Number 2
OGRID No. 017891	Operator Name POGO PRODUCING COMPANY	Elevation 2939

Surface Location

UL or lot No. N	Section 21	Township 24 S	Range 29 E	Lot Idn	Feet from the 990	North/South line SOUTH	Feet from the 2310	East/West line WEST	County EDDY
--------------------	---------------	------------------	---------------	---------	----------------------	---------------------------	-----------------------	------------------------	----------------

Bottom Hole Location If Different From Surface

UL or lot No.	Section	Township	Range	Lot Idn	Feet from the	North/South line	Feet from the	East/West line	County
Dedicated Acres 40	Joint or Infill	Consolidation Code	Order No.						

NO ALLOWABLE WILL BE ASSIGNED TO THIS COMPLETION UNTIL ALL INTERESTS HAVE BEEN CONSOLIDATED
OR A NON-STANDARD UNIT HAS BEEN APPROVED BY THE DIVISION

				OPERATOR CERTIFICATION I hereby certify the the information contained herein is true and complete to the best of my knowledge and belief. Signature James M.C. Ritchie, Jr. Printed Name AGENT Title OCT. 4, 1995 Date	
				SURVEYOR CERTIFICATION I hereby certify that the well location shown on this plat was plotted from field notes of actual surveys made by me or under my supervision, and that the same is true and correct to the best of my belief. SEPTEMBER 25, 1995 Date Surveyed Signature & Seal of Professional Surveyor Professional Surveyor Certificate No. 1523-95 676 3239 12641	

VICINITY MAP

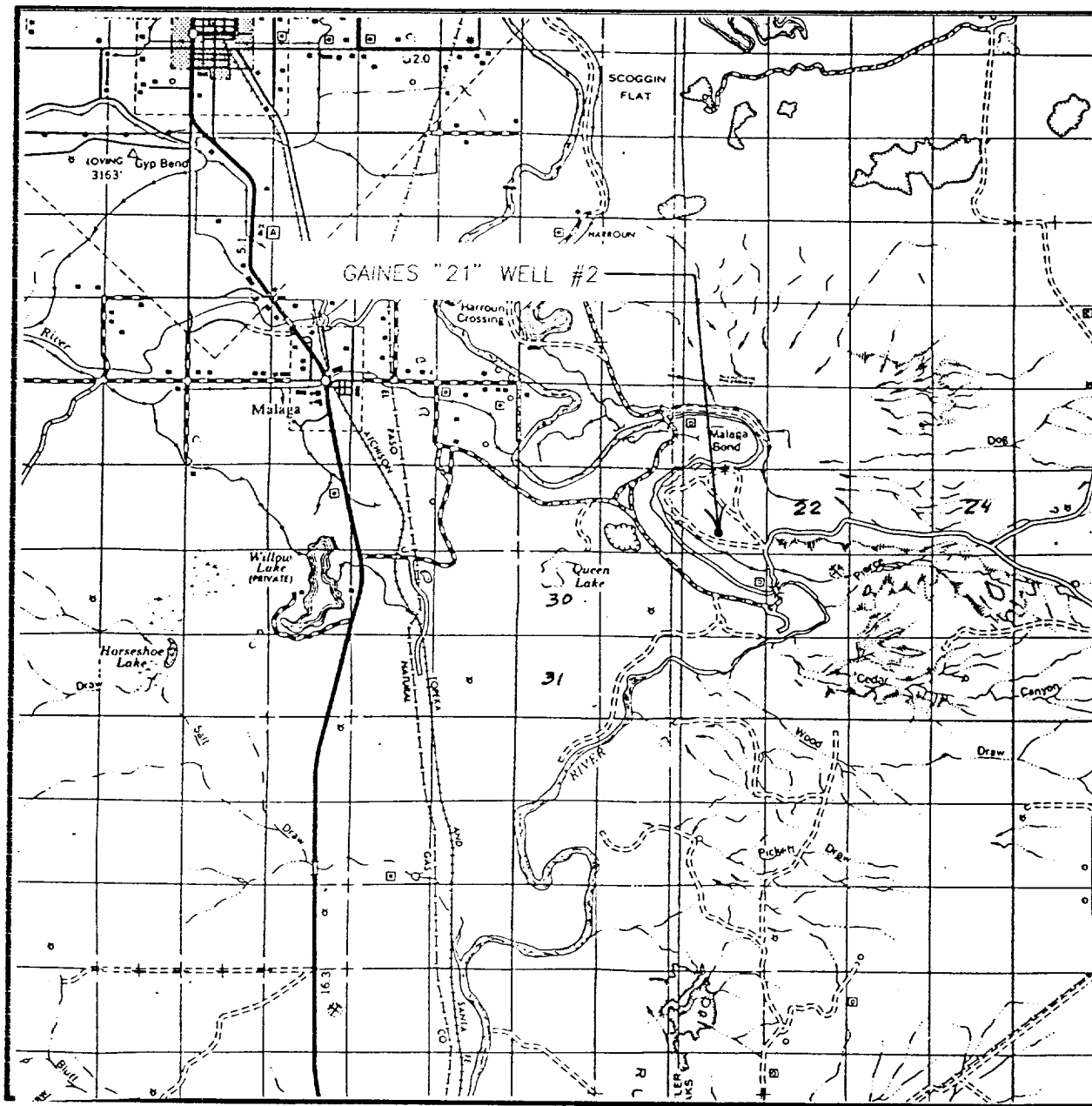

SCALE: 1" = 2 MILES

SEC. 21 TWP. 24-S RGE. 29-E

SURVEY _____ N.M.P.M.

COUNTY _____ EDDY _____

DESCRIPTION 990' FSL & 2310' FWL

ELEVATION 2939

OPERATOR POGO PRODUCING COMPANY

LEASE _____ GAINES "21"

**JOHN WEST ENGINEERING
HOBBS, NEW MEXICO
(505) 393-3117**

(505) 393-3117

LOCAT. ON VERIFICATION MAP

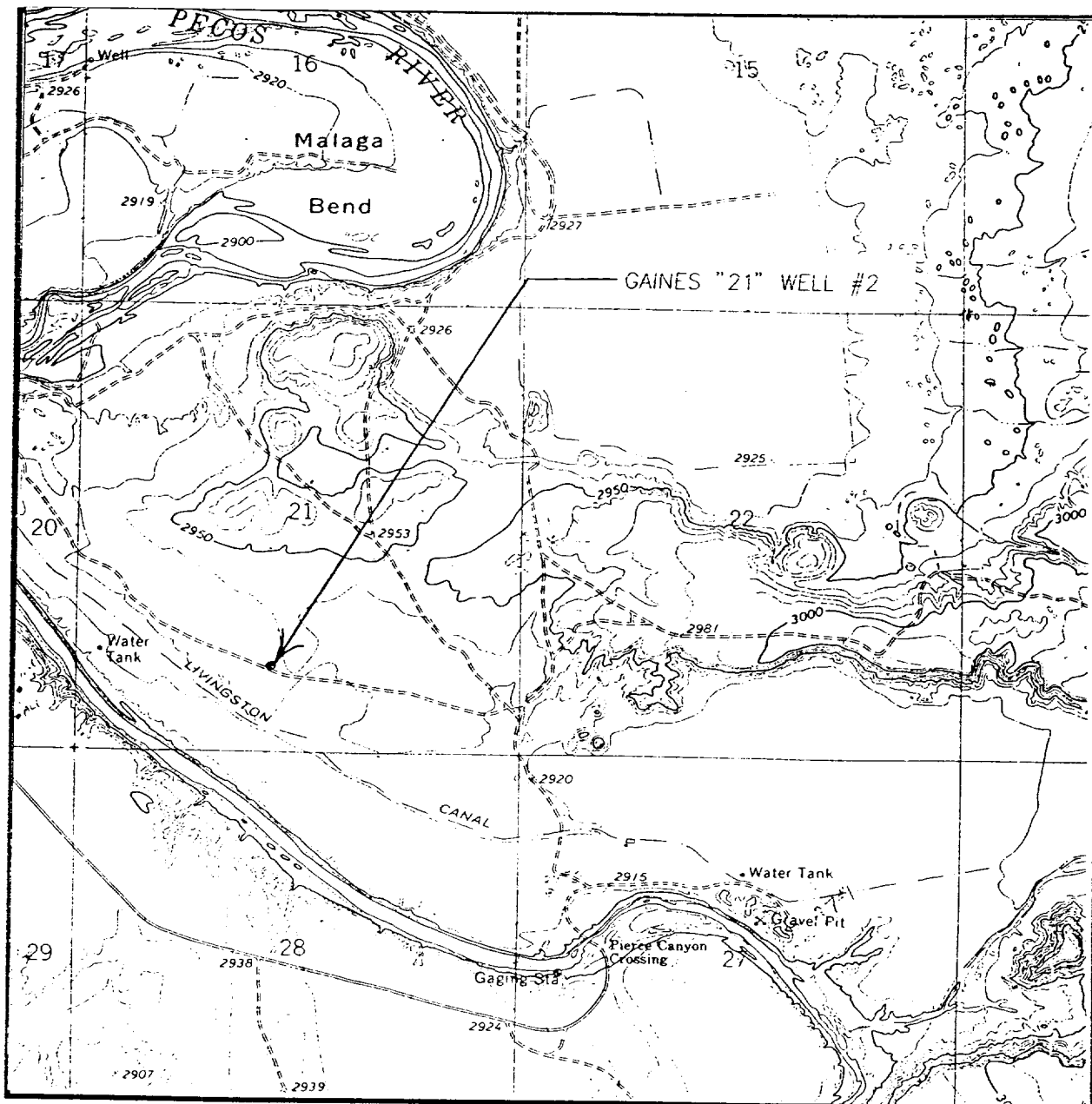

SCALE: 1" = 2000'

CONTOUR INTERVAL - 10'

SEC. 21 TWP. 24-S RGE. 29-E

SURVEY N.M.P.M.

COUNTY EDDY

DESCRIPTION 990' FSL & 2310' FWL

ELEVATION 2939

OPERATOR POGO PRODUCING COMPANY

LEASE GAINES "21"

U.S.G.S. TOPOGRAPHIC MAP

PIERCE CANYON, N.M.

JOHN WEST ENGINEERING
HOBBS, NEW MEXICO
(505) 393-3117

DRILLING CONTROL **CONDITION III-B 3000 PSI WP**

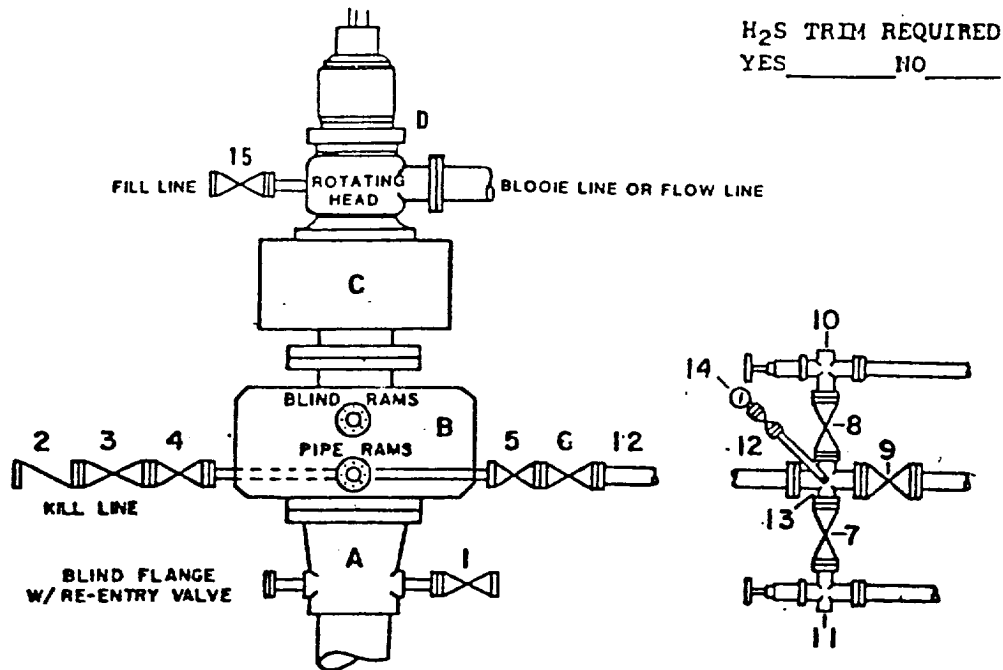

H₂S TRIM REQUIRED
 YES _____ NO _____

DRILLING CONTROL

MATERIAL LIST - CONDITION III - B

- | | |
|----------------|---|
| A | Wellhead |
| B | 3000# W.P. Dual ram type preventer, hydraulic operated with 1" steel, 3000# W.P. control lines (where sub-structure height is adequate, 2 - 3000# W.P. single ram preventers may be utilized with 3000# W.P. drilling spool with 2" minimum flanged outlet for kill line and 3" minimum flanged outlet for choke line. The drilling spool is to be installed below the single ram type preventers). |
| C | 3000# W.P. Annular Preventer with 1" steel, 3000# W.P. control lines. |
| D | Rotating Head with fill up outlet and extended Bloop line. |
| 1,3,4,
7,8, | 2" minimum 3000# W.P. flanged full opening steel gate valve, or Halliburton Lo Torc Plug valve. |
| 2 | 2" minimum 3000# W.P. back pressure valve. |
| 5,6,9 | 3" minimum 3000# W.P. flanged full opening steel gate valve, or Halliburton Lo Torc Plug valve. |
| 12 | 3" minimum Schedule 80, Grade B, seamless line pipe. |
| 13 | 2" minimum x 3" minimum 3000# W.P. flanged cross. |
| 10,11 | 2" minimum 3000# W.P. adjustable choke bodies. |
| 14 | Cameron Mud Gauge or equivalent (location optional in Choke line). |
| 15 | 2" minimum 3000# W.P. flanged or threaded full opening steel gate valve, or Halliburton Lo Torc Plug valve. |

SCALE	DATE	EST. NO.	DRG. NO.
DRAWN BY			
CHECKED BY			
APPROVED BY			

EXHIBIT E