

731603
DISTRICT II
1625 N. French Dr., Hobbs, N.M. 88240

DISTRICT II
811 South First, Artesia, N.M. 88210

DISTRICT III
1000 Rio Brazos Rd., Aztec, N.M. 87410

DISTRICT IV
2040 South Pacheco, Santa Fe, NM 87506

State of New Mexico
Energy, Minerals & Natural Resources Department

OIL CONSERVATION DIVISION
2040 South Pacheco
Santa Fe, NM 87506

Form C-102
Revised August 15, 2000

Submit to Appropriate District Office
State Lease - 4 Copies
Fee Lease - 3 Copies

☐ AMENDED REPORT

31141 WELL LOCATION AND ACREAGE DEDICATION PLAT

*API Number 30.045 31141		*Pool Code 71629	*Pool Name BASIN FRUITLAND COAL
*Property Code .	*Property Name FULLERTON FEDERAL		*Well Number 111
*OGRID No. 193195	*Operator Name MARKWEST RESOURCES, INC.		*Elevation 6004'

10 Surface Location

Ul or lot no.	Section	Township	Range	Lot Idn	Feet from the	North/South line	Feet from the	East/West line	County
. 1	. 11	. 27-N	. 11-W		. 1635'	. SOUTH	. 1020'	. EAST	SAN JUAN

11 Bottom Hole Location If Different From Surface

Ul or lot no.	Section	Township	Range	Lot Idn	Feet from the	North/South line	Feet from the	East/West line	County
*Dedicated Acres 320					*Joint or Infill	*Consolidation Code	*Order No.		

NO ALLOWABLE WILL BE ASSIGNED TO THIS COMPLETION UNTIL ALL INTERESTS HAVE BEEN CONSOLIDATED
OR A NON-STANDARD UNIT HAS BEEN APPROVED BY THE DIVISION

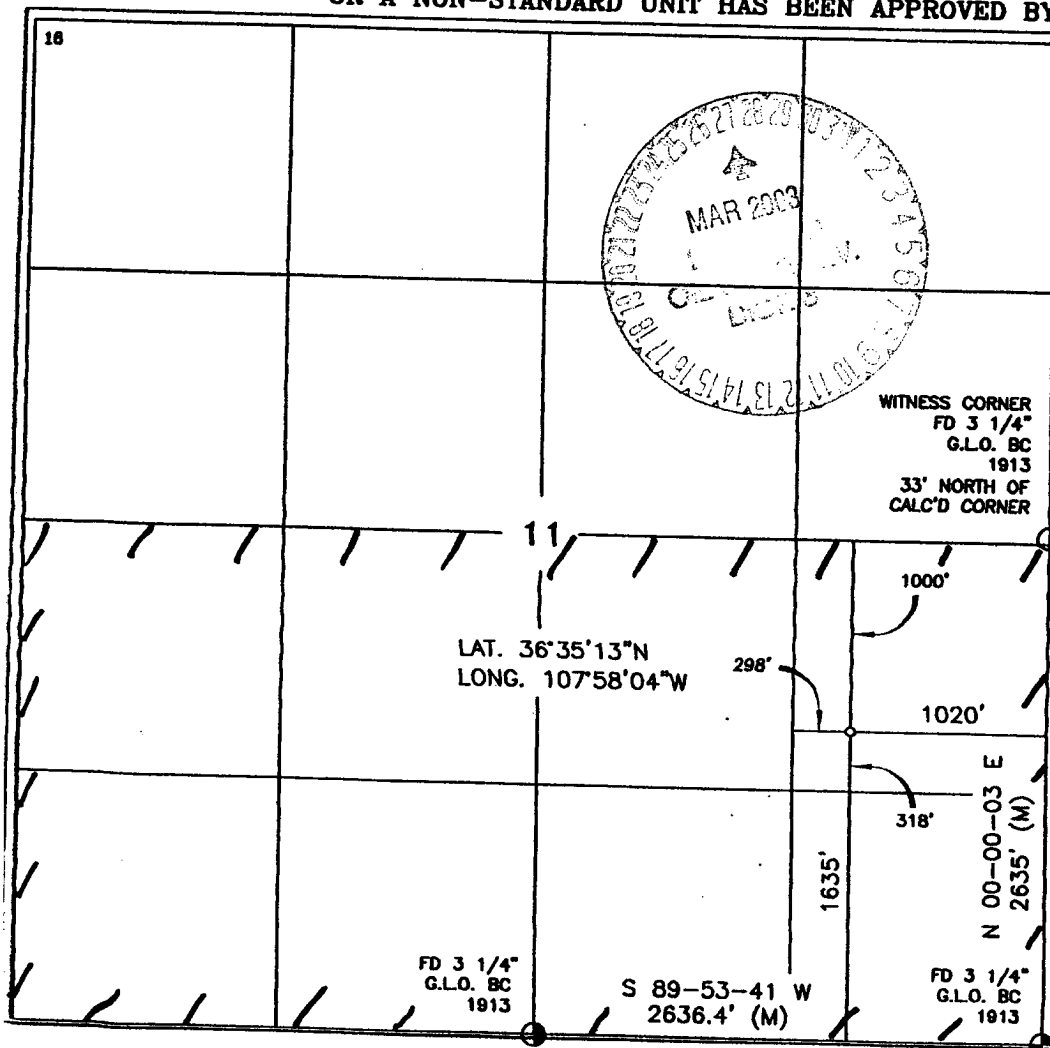

17 OPERATOR CERTIFICATION

I hereby certify that the information contained herein
is true and complete to the best of my knowledge and
belief.

Brian Wood
Signature

Printed Name

BRIAN WOOD

Title

CONSULTANT

Date

JULY 1, 2002

18 SURVEYOR CERTIFICATION

I hereby certify that the well location shown on this plat
was plotted from field notes of actual surveys made by
me or under my supervision, and that the same is true
and correct to the best of my belief.

APRIL 10, 2002
Date of Survey
Signature and Seal of Professional Surveyor
14827
Certificate Number

731603
DISTRICT I
1625 N. French Dr., Hobbs, N.M. 88240

DISTRICT II
811 South First, Artesia, N.M. 88210

DISTRICT III
1000 Rio Brazos Rd., Aztec, N.M. 87410

DISTRICT IV
2040 South Pacheco, Santa Fe, NM 87505

State of New Mexico
Energy, Minerals & Natural Resources Department

OIL CONSERVATION DIVISION
2040 South Pacheco
Santa Fe, NM 87505

Form C-102
Revised August 15, 2000

Submit to Appropriate District Office
State Lease - 4 Copies
Fee Lease - 3 Copies

☐ AMENDED REPORT

WELL LOCATION AND ACREAGE DEDICATION PLAT

*API Number 30-045-31141		*Pool Code 71629	*Pool Name BASIN FRUITLAND COAL
*Property Code .	*Property Name FULLERTON FEDERAL		*Well Number 111
*OGRID No. 193195	*Operator Name MARKWEST RESOURCES, INC.		*Elevation 6004'

¹⁰ Surface Location

UL or lot no. . 1	Section 11	Township 27-N	Range 11-W	Lot Idn	Feet from the 1635'	North/South line SOUTH	Feet from the 1020'	East/West line EAST	County SAN JUAN
----------------------	---------------	------------------	---------------	---------	------------------------	---------------------------	------------------------	------------------------	--------------------

¹¹ Bottom Hole Location If Different From Surface

UL or lot no.	Section	Township	Range	Lot Idn	Feet from the	North/South line	Feet from the	East/West line	County
*Dedicated Acres 320		*Joint or Infill		*Consolidation Code		*Order No.			

NO ALLOWABLE WILL BE ASSIGNED TO THIS COMPLETION UNTIL ALL INTERESTS HAVE BEEN CONSOLIDATED
OR A NON-STANDARD UNIT HAS BEEN APPROVED BY THE DIVISION

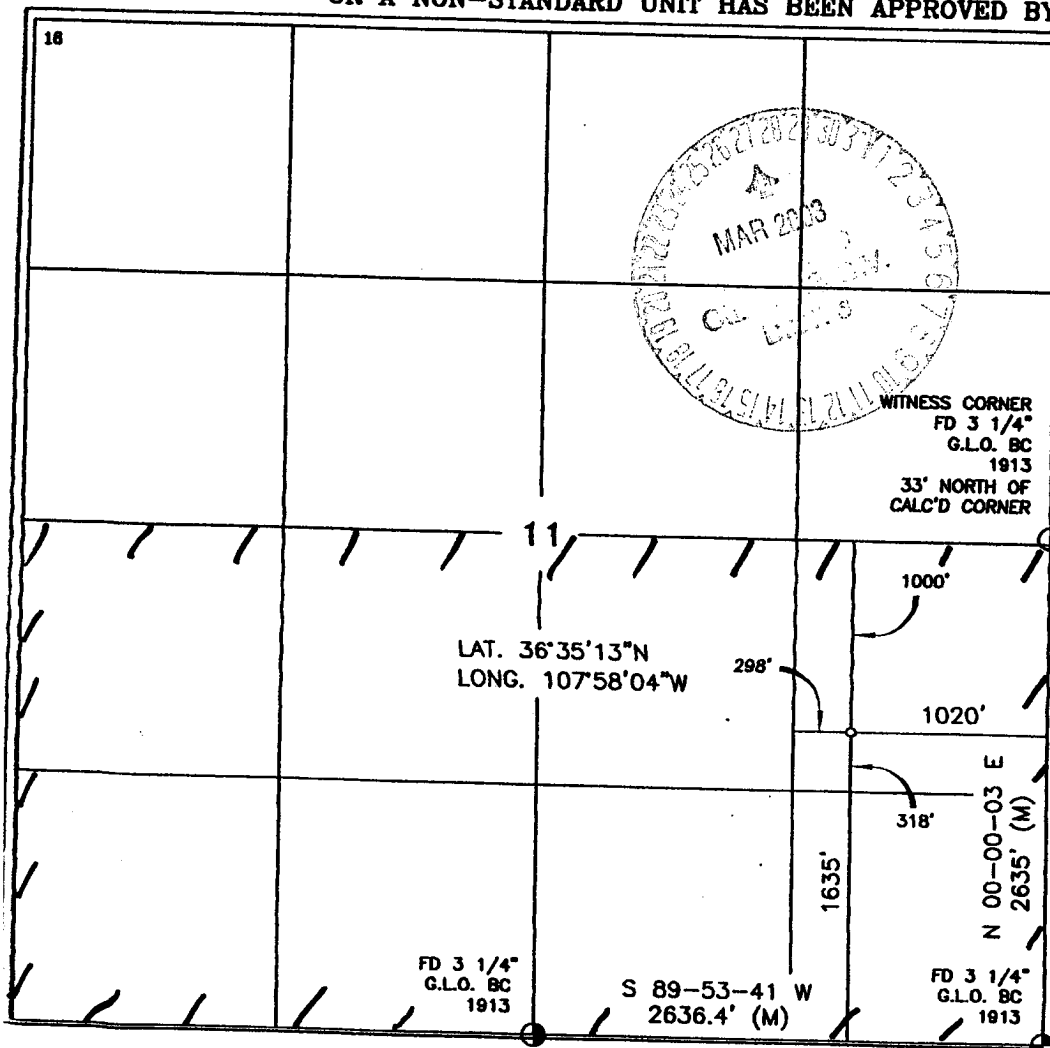

17 OPERATOR CERTIFICATION

I hereby certify that the information contained herein is true and complete to the best of my knowledge and belief.

Brian Wood
Signature

Printed Name

BRIAN WOOD

Title

CONSULTANT

Date

JULY 1, 2002

18 SURVEYOR CERTIFICATION

I hereby certify that the well location shown on this plat was plotted from field notes of actual surveys made by me or under my supervision, and that the same is true and correct to the best of my belief.

APRIL 2002
Date of Survey

Signature and Seal of Professional Surveyor

14827
Certificate Number