

UNITED STATES
DEPARTMENT OF THE INTERIOR
BUREAU OF LAND MANAGEMENT

FORM APPROVED
OMB No. 1004-0136
Expires November 30, 2000

APPLICATION FOR PERMIT TO DRILL OR REENTER

1a. Type of Work: <input checked="" type="checkbox"/> DRILL <input type="checkbox"/> REENTER		5. Lease Serial No. SF - 079319
1b. Type of Well: <input type="checkbox"/> Oil Well <input checked="" type="checkbox"/> Gas Well <input type="checkbox"/> Other <input type="checkbox"/> Single Zone <input checked="" type="checkbox"/> Multiple Zone		6. If Indian, Allottee or Tribe Name
2. Name of Operator BP AMERICA PRODUCTION COMPANY		7. If Unit or CA Agreement, Name and No.
3a. Address P.O. BOX 3092 HOUSTON, TX 77253-3092		8. Lease Name and Well No. SCHWERDTFEGER A 4M
3b. Phone No. (include area code) Ph: 281.366.4081 Fx: 281.366.0700		9. API Well No. 30045-32364
4. Location of Well (Report location clearly and in accordance with any State requirements. *) At surface SWNE 1780FNL 1500FEL 36.37200 N Lat, 107.43100 W Lon At proposed prod. zone SWNE 2130FNL 1500FEL		10. Field and Pool, or Exploratory BASIN DAKOTA & BLANCO MESAVERI
14. Distance in miles and direction from nearest town or post office* 27 MILES S/E FROM BLOOMFIELD		11. Sec., T., R., M., or Blk. and Survey or Area Sec 31 T28N R8W Mer NMP G
15. Distance from proposed location to nearest property or lease line, ft. (Also to nearest drig. unit line, if any) 1500'	16. No. of Acres in Lease	12. County or Parish SAN JUAN
18. Distance from proposed location to nearest well, drilling, completed, applied for, on this lease, ft. 75'	19. Proposed Depth 7242 MD 7197 TVD	13. State NM
21. Elevations (Show whether DF, KB, RT, GL, etc.) 6383 GL	22. Approximate date work will start 07/15/2004	17. Spacing Unit dedicated to this well 304.80 E/P
24. Attachments		20. BLM/BIA Bond No. on file WY2924
25. Signature (Electronic Submission)		23. Estimated duration 7 DAYS

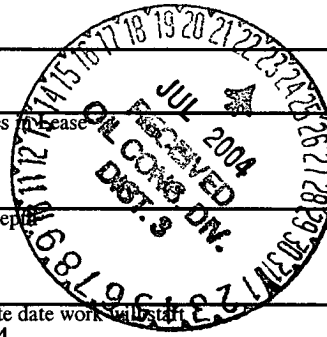

The following, completed in accordance with the requirements of Onshore Oil and Gas Order No. 1, shall be attached to this form:

- 1. Well plat certified by a registered surveyor.
- 2. A Drilling Plan.
- 3. A Surface Use Plan (if the location is on National Forest System Lands, the SUPO shall be filed with the appropriate Forest Service Office).
- 4. Bond to cover the operations unless covered by an existing bond on file (see Item 20 above).
- 5. Operator certification
- 6. Such other site specific information and/or plans as may be required by the authorized officer.

25. Signature (Electronic Submission)		Name (Printed/Typed) CHERRY HLAVA	Date 05/19/2004
Title REGULATORY ANALYST			
Approved by (Signature) <i>[Signature]</i>		Name (Printed/Typed)	Date 7-15-04
Title AFM		Office FFO	

Application approval does not warrant or certify the applicant holds legal or equitable title to those rights in the subject lease which would entitle the applicant to conduct operations thereon.
Conditions of approval, if any, are attached.

Title 18 U.S.C. Section 1001 and Title 43 U.S.C. Section 1212, make it a crime for any person knowingly and willfully to make to any department or agency of the United States any false, fictitious or fraudulent statements or representations as to any matter within its jurisdiction.

Additional Operator Remarks (see next page)

**Electronic Submission #30917 verified by the BLM Well Information System
For BP AMERICA PRODUCTION COMPANY, sent to the Farmington**

and appeal pursuant to 43 CFR 3165.3 and appeal pursuant to 43 CFR 3165.4

DRILLING OPERATIONS AUTHORIZED ARE
SUBJECT TO COMPLIANCE WITH ATTACHED
"GENERAL REQUIREMENTS".

HOLD C104 FOR Directional Survey

**** OPERATOR-SUBMITTED ** OPERATOR-SUBMITTED ** OPERATOR-SUBMITTED ****

NMOCGD

District I
 PO Box 1980, Hobbs NM 88241-1980
 District II
 PO Drawer KK, Artesia, NM 87211-0719
 District III
 1000 Rio Brazos Rd., Aztec, NM 87410
 District IV
 PO Box 2088, Santa Fe, NM 87504-2088

State of New Mexico
 Energy, Minerals & Natural Resources Department

Form C-102
 Revised February 21, 1994
 Instructions on back
 Submit to Appropriate District Office
 State Lease - 4 Copies
 Fee Lease - 3 Copies

OIL CONSERVATION DIVISION
 PO Box 2088
 Santa Fe, NM 87504-2088

AMENDED REPORT

WELL LOCATION AND ACREAGE DEDICATION PLAT

¹ API Number 30-045-32364		² Pool Code 71599; 72319		³ Pool Name Basin Dakota; Blanco Mesaverde	
⁴ Property Code 001031		⁵ Property Name Schwerdtfeger A			⁶ Well Number # 4M
⁷ OGRID No. 000778		⁸ Operator Name BP AMERICA PRODUCTION COMPANY			⁹ Elevation 6383

¹⁰ Surface Location

UL or Lot No.	Section	Township	Range	Lot Idn	Feet from the	North/South line	Feet from the	East/West line	County
G	31	28 N	8 W		1780	NORTH	1500	EAST	SAN JUAN

¹¹ Bottom Hole Location If Different From Surface

UL or lot no.	Section	Township	Range	Lot Idn	Feet from the	North/South line	Feet from the	East/West line	County
G	31	28 N	8 W		2130	NORTH	1500	EAST	SAN JUAN

¹² Dedicated Acres 304.8	¹³ Joint or Infill	¹⁴ Consolidation Code	¹⁵ Order No.
--	-------------------------------	----------------------------------	-------------------------

NO ALLOWABLE WILL BE ASSIGNED TO THIS COMPLETION UNTIL ALL INTERESTS HAVE BEEN CONSOLIDATED OR A NON-STANDARD UNIT HAS BEEN APPROVED BY THE DIVISION

<p>¹⁶</p>	<p>¹⁷ OPERATOR CERTIFICATION</p> <p>I hereby certify that the information contained herein is true and complete to the best of my knowledge and belief.</p> <p><i>Cherry Hlava</i> Signature Cherry Hlava Printed Name Regulatory Analyst Title 3-25-04 Date</p>
	<p>¹⁸ SURVEYOR CERTIFICATION</p> <p>I hereby certify that the well location shown on this plat was plotted from field notes of actual surveys made by me or under my supervision, and that the same is true and correct to the best of my belief.</p> <p>July 22, 2003 Date of Survey</p> <p>Signature and Seal of Professional Surveyor</p> <p>7016 Certificate Number</p>
	<p>5173 (R)</p> <p>4991 (R)</p> <p>5176 (R)</p>
	<p>(R) - GLO Record</p>

Submit 3 Copies To Appropriate District
 Office
 District I
 1625 N. French Dr., Hobbs, NM 88240
 District II
 1301 W. Grand Ave., Artesia, NM 88210
 District III
 1000 Rio Brazos Rd., Aztec, NM 87410
 District IV
 1220 S. St. Francis Dr., Santa Fe, NM
 87505

State of New Mexico
 Energy, Minerals and Natural Resources

Form C-103
 March 4, 2004

OIL CONSERVATION DIVISION
 1220 South St. Francis Dr.
 Santa Fe, NM 87505

WELL API NO.	
NEW WELL	
5. Indicate Type of Lease STATE <input type="checkbox"/> FEE <input type="checkbox"/>	
6. State Oil & Gas Lease No.	
7. Lease Name or Unit Agreement Name Schwerdtfeger A (APD filed with BLM SF 079319)	
8. Well Number 4 M	
9. OGRID Number	
10. Pool name or Wildcat Basin Dakota & Blanco Mesaverde	

SUNDRY NOTICES AND REPORTS ON WELLS
 (DO NOT USE THIS FORM FOR PROPOSALS TO DRILL OR TO DEEPEN OR PLUG BACK TO A DIFFERENT RESERVOIR. USE "APPLICATION FOR PERMIT" (FORM C-101) FOR SUCH PROPOSALS.)

1. Type of Well:
 Oil Well Gas Well Other

2. Name of Operator
 BP AMERICA PRODUCTION CO

3. Address of Operator
 P.O. BOX 3092 HOUSTON, TX 77079-2064

4. Well Location
 Unit Letter G : 1780 feet from the NORTH line and 1500 feet from the EAST line
 Section 31 Township 28N Range 08W NMPM SAN JUAN County

11. Elevation (Show whether DR, RKB, RT, GR, etc.)
 6383'

Pit or Below-grade Tank Application (For pit or below-grade tank closures, a form C-144 must be attached)

Pit Location: UL G Sect 31 Twp 28N Rng 08W Pit type Drilling Depth to Groundwater >100' Distance from nearest fresh water well >1000'
 Distance from nearest surface water >1000' Below-grade Tank Location UL G Sect 31 Twp 28N Rng 08W ;
1690 feet from the NORTH line and 1615 feet from the EAST line PLEASE SEE ATTACHED PAD LAYOUT

12. Check Appropriate Box to Indicate Nature of Notice, Report or Other Data

NOTICE OF INTENTION TO:		SUBSEQUENT REPORT OF:	
PERFORM REMEDIAL WORK <input type="checkbox"/>	PLUG AND ABANDON <input type="checkbox"/>	REMEDIAL WORK <input type="checkbox"/>	ALTERING CASING <input type="checkbox"/>
TEMPORARILY ABANDON <input type="checkbox"/>	CHANGE PLANS <input type="checkbox"/>	COMMENCE DRILLING OPNS. <input type="checkbox"/>	PLUG AND ABANDONMENT <input type="checkbox"/>
PULL OR ALTER CASING <input type="checkbox"/>	MULTIPLE COMPLETION <input type="checkbox"/>	CASING TEST AND CEMENT JOB <input type="checkbox"/>	
OTHER: PIT PERMIT <input type="checkbox"/>		OTHER: <input type="checkbox"/>	

13. Describe proposed or completed operations. (Clearly state all pertinent details, and give pertinent dates, including estimated date of starting any proposed work). SEE RULE 1103. For Multiple Completions: Attach wellbore diagram of proposed completion or recompletion.

Please reference BP America's San Juan Basin Drilling/Workover Pit Construction Plan on file with the NMOCD. Pit construction Plan issued date of 04/15/2004. Pit will be closed according to closure plan on file.

I hereby certify that the information above is true and complete to the best of my knowledge and belief. I further certify that any pit or below-grade tank has been/will be constructed or closed according to NMOCD guidelines , a general permit or an (attached) alternative OCD-approved plan .

SIGNATURE _____ TITLE Regulatory Analyst DATE 5/20/04

Type or print name Cherry Hlava E-mail address: hlavacl@bp.com Telephone No. 281-366-4081

(This space for State use)

APPROVED BY  TITLE DEPUTY OIL & GAS INSPECTOR, DIST. 4 DATE MAY 23 2004

Conditions of approval, if any:

PAD LAYOUT PLAN & PROFILE
BP AMERICA PRODUCTION COMPANY
Schwerdtfeger A # 4M
1780' F/NL 1500' F/EL
SEC. 31, T28N, R8W, N.M.P.M.
SAN JUAN COUNTY, NEW MEXICO

Lat: 36°37'13"
 Long: 107°43'07"

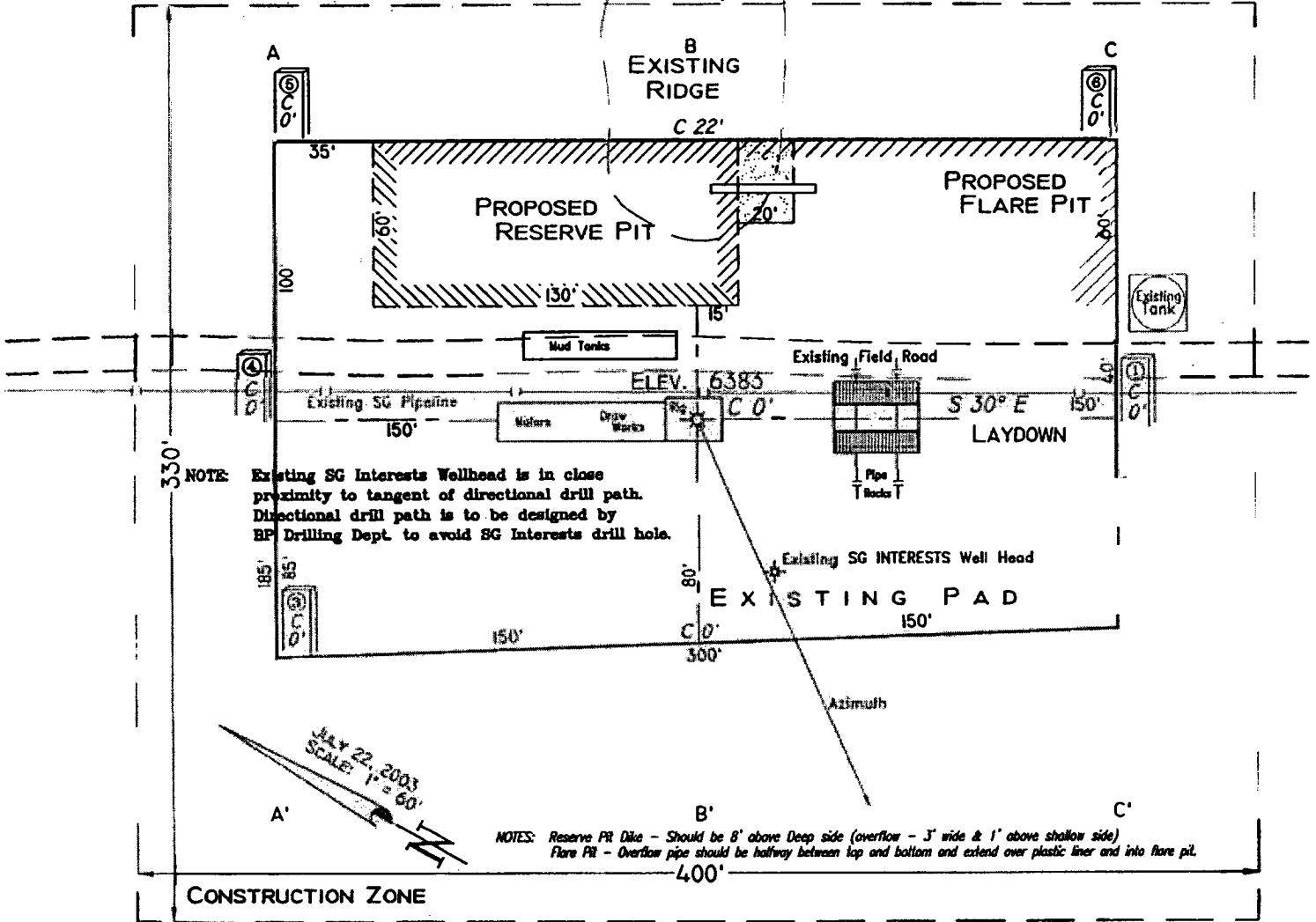

NOTES: Reserve Pit Dike - Should be 8' above Deep side (overflow - 3' wide & 1' above shallow side)
 Flare Pit - Overflow pipe should be halfway between top and bottom and extend over plastic liner and into flare pit.

Area of Construction Zone - 330'x400' or .103 acres, more or less.

SCALE: 1"=60'-HORIZ.
 1"=40'-VERT.

A-A'		CL			
6390					
6380					
6370					
6360					
B-B'					
6390					
6380					
6370					
6360					
C-C'					
6390					
6380					
6370					
6360					

NOTE: Contractor should call One-Call for location of any marked or unmarked buried pipelines or cables on well pad and/or access road at least two (2) working days prior to construction.

Cuts and fills shown are approximate - final finished elevation is to be adjusted so earthwork will balance. Corner stakes are approximate and do not include additional areas needed for sideslopes and drainages. Final Pad Dimensions are to be verified by Contractor.

VANN SURVEYS
 P. O. Box 1306
 Farmington, NM

**BP AMERICA PRODUCTION COMPANY
DRILLING AND COMPLETION PROGRAM**

Prospect Name: Schwerdtfeger A
Lease: Schwerdtfeger A
County: San Juan
State: New Mexico
Date: May 14, 2004

Well No: 4 M
Surface Location: 31-28N-8W, 1780 FNL, 1500 FEL
BHL: 31-28N-8W, 2130 FNL, 1500 FEL
Field: Blanco Mesaverde/Basin Dakota

OBJECTIVE: Drill 240' below the top of the Two Wells; set 4 1/2" production casing, Stimulate CH, MF, PL and DK intervals

METHOD OF DRILLING		APPROXIMATE DEPTHS OF GEOLOGICAL MARKER			
TYPE OF TOOLS	DEPTH OF DRILLING	Estimated GL: 6383'		Estimated KB: 6397'	
Rotary	0 - TD	MARKER	MD	SS	TVD.
LOG PROGRAM		Ojo Alamo	1642'	4755'	1642'
		Kirkland	1721'	4676'	1721'
		Fruitland	2085'	4314'	2083'
		Fruitland Coal	* 2353'	4053'	2344'
		Pictured Cliffs	* 2584'	3826'	2571'
		Lewis Shale	# 2795'	3626'	2771'
		Cliff House	# 3980'	2462'	3935'
		Menefee Shale	# 4367'	2075'	4322'
		Point Lookout	# 4936'	1506'	4891'
		Mancos	5197'	1149'	5152'
		Greenhorn	6869'	-427'	6824'
		Bentonite Marker	6933'	-491'	6888'
		Two Wells	# 7002'	-560'	6957'
		Paguate	# 7061'	-619'	7016'
		Cubero Upper	# 7110'	-668'	7065'
		Cubero Lower	# 7142'	-700'	7097'
		Encinal Canyon	# 7199'	-757'	7154'
		TOTAL DEPTH		-800'	7197'
		# Probable completion interval		* Possible Pay	
SPECIAL TESTS		DRILL CUTTING SAMPLES		DRILLING TIME	
TYPE		FREQUENCY	DEPTH	FREQUENCY	DEPTH
None		10'	2871' -TD	Geograph	0-TD
REMARKS:					

MUD PROGRAM:					
Approx. Interval	Type Mud	Weight, #/ga	Vis, sec/qt	W/L cc's/30 min	Other Specification
0 - 120	Spud	8.6-9.2			
120 - 2902 (1)	Water/LSND	8.6-9.2		<6	
2902 - 7242	Gas/Air/N2/Mist	Volume sufficient to maintain a stable and clean wellbore			

REMARKS:
(1) The hole will require sweeps to keep unloaded while fresh water drilling. Let hole conditions dictate frequency.

CASING PROGRAM: (Normally, tubular goods allocation letter specifies casing sizes to be used. Hole sizes will be governed by Contract)						
Casing String	Estimated Depth	Casing Size	Grade	Weight	Hole Size	Landing Pt, Cmt, Etc.
Surface/Conductor	120	9 5/8"	H-40 ST&C	32#	13.5"	1
Intermediate 1	2902	7"	J/K-55 ST&C	20#	8.75"	1,2
Production	7242	4 1/2"	J-55	11.6#	6.25"	3

REMARKS:
(1) Circulate Cement to Surface
(2) Set casing 100' into Lewis Shale
(3) Bring cement 100' above 7" shoe

CORING PROGRAM:
None

COMPLETION PROGRAM:
Rigless, 3-4 Stage Limited Entry Hydraulic Frac

GENERAL REMARKS:
Notify BLM/NMOCD 24 hours prior to Spud, BOP testing, and Casing and Cementing.

Form 46 Reviewed by: _____ Logging program reviewed by: N/A

PREPARED BY: HGJ/JL/JMP	APPROVED:	DATE: May 14, 2004 Version 1.1
-----------------------------------	------------------	---

BOP Test Pressure

BP America Production Company BOP Pressure Testing Requirements

Well Name: Schwerdtfeger A
County: San Juan

4 M
State: New Mexico

Formation	MD	Anticipated Bottom Hole Pressure	Maximum Anticipated Surface Pressure **
Ojo Alamo	1642		
Fruitland Coal	2353		
PC	2584		
Lewis Shale	2795		
Cliff House	3980	500	0
Menefee Shale	4367		
Point Lookout	4936	600	0
Mancos	5197		
Dakota	7002	2600	1449

** Note: Determined using the following formula: $ABHP - (.22 * TVD) = ASP$

Requested BOP Pressure Test Exception: 1500 psi

**SAN JUAN BASIN
Dakota/MV Formation
Pressure Control Equipment**

Background

The objective Dakota formation maximum surface pressure is anticipated to be less than 1000 psi, based on shut-in surface pressures from adjacent wells. Pressure control equipment working pressure minimum requirements are therefore 2000 psi. Equipment to be used will conform to API RP-53 (Figure 2.C.2) for a 2000 psi system per Federal Onshore Order No. 2. Due to available conventional equipment within the area, 3000 psi rated pressure control equipment will typically be utilized in a double ram type arrangement. Regional drilling rights to be utilized have substructure height limitations which exclude the use of annular preventers; therefore a rotating head will be installed above these rams. This pressure control equipment will be utilized for conventional drilling below conductor to total depth in the Basin Dakota. No abnormal temperature, pressure, or H2S anticipated.

Equipment Specification

Interval

BOP Equipment

Below conductor casing to total depth 11" nominal or 7 1/16", 3000 psi double ram preventer with rotating head.

All ram type preventers and related control equipment will be hydraulically tested to 250 psi (low pressure) and 2000 psi (high pressure), upon installation, following any repairs or equipment replacements, or at 30 day intervals. Accessories to BOP equipment will include kelly cock, upper kelly cock with a handle available, floor safety valves and choke manifold which will also be tested to equivalent pressure.

Cementing Program

Well Name: Schwertfeger A4M	Field: Blanco Mesaverde / Basin Dakota
Location: 31 - 28N - 08W, 1780 FNL, 1500 FEL	API No.
County: San Juan	Well Flac
State: New Mexico	Formation: Blanco Mesaverde/Basin Dakota
	KB Elev (est) 6397
	GL Elev. (est) 6383

Casing Program:

Casing String	Est. Depth (ft.)	Hole Size (in.)	Casing Size (in.)	Thread	TOC (ft.)	Stage Tool Or TOL (ft.)	Cmt Cir. Out (bbl.)
Surface	120	13.5	9.625	ST&C	Surface	NA	
Intermediate	2902	8.75	7	LT&C	Surface	NA	
Production -	7242	6.25	4.5	ST&C	2802	NA	

Casing Properties:

(No Safety Factor Included)									
Casing String	Size (in.)	Weight (lb/ft)	Grade	Burst (psi.)	Collapse (psi.)	Joint St. (1000 lbs.)	Capacity (bbl/ft.)	Drift (in.)	
Surface		9.625	32 H-40	3370		1400	254	0.0787	8.845
Intermediate		7	20 K-55	3740		2270	234	0.0405	6.456
Production -		4.5	11.6 J-55	5350		4960	154	0.0155	3.875

Mud Program

Apx. Interval (ft.)	Mud Type	Mud Weight	<u>Recommended Mud Properties Prio Cementing:</u>	
			PV	<20
			YP	<10
0 - SCP	Water/Spud	8.6-9.2	Fluid Lost <15	
SCP - ICP	Water/LSND	8.6-9.2		
ICP - ICP2	Gas/Air Mist	NA		
ICP2 - TD	LSND	8.6 - 9.2		

Cementing Program:

	Surface	Intermediate	Production
Excess %, Lead	100	75	40
Excess %, Tail	NA	0	40
BHST (est deg. F)	75	120	183
Special Instructions	1,6,7	1,6,8	2,4,6

1. Do not wash pumps and lines.
2. Wash pumps and lines.
3. Reverse out
4. Run Blend Test on Cement
5. Record Rate, Pressure, and Density on 3.5" disk
6. Confirm densitometer with pressurized mud scales
7. 1" cement to surface if cement is not circulated.
8. If cement is not circulated to surface, run temp. survey 10-12 hr. after landing plug.

Notes:

*Do not wash up on top of plug. Wash lines before displacing production cement job to minimize drillout.

Surface:

Preflush	20 bbl.	FreshWater	
Slurry 1	100 sx Class C Cement		117 cuft
TOC@Surface	+ 2% CaCl ₂ (accelerator)		
			0.4887 cuft/ft OH

Slurry Properties:

	Density (lb/gal)	Yield (ft ³ /sk)	Water (gal/sk)
Slurry 1	15.2	1.27	5.8

Cementing Program

Casing Equipment: 9-5/8", 8R, ST&C
 1 Guide Shoe
 1 Top Wooden Plug
 1 Autofill insert float valve
 Centralizers, 1 per joint except top joint
 1 Stop Ring
 1 Thread Lock Compound

Intermediate:

Fresh Water	20 bbl	fresh water	
Lead Slurry 1 TOC@Surface		240 sx Class "G" Cement + 3% D79 extender + 1/4 #/sk. Cellophane Flake + 5 lb/sk Gilsonite	621 cuft
Tail Slurry 2 500 ft fill		60 sx 50/50 Class "G"/Poz + 2% gel (extender) + 1/4 #/sk. Cellophane Flake + 2% CaCl2 (accelerator) + 5 lb/sk Gilsonite	75 cuft 0.1503 cuft/ft OH 0.1746 cuft/ft csg ann

Slurry Properties:	Density (lb/gal)	Yield (ft3/sk)	Water (gal/sk)
Slurry 1	11.4	2.63	15.8
Slurry 2	13.5	1.27	5.72

Casing Equipment: 7", 8R, ST&C
 1 Float Shoe (autofill with minimal LCM in mud)
 1 Float Collar (autofill with minimal LCM in mud)
 1 Stop Ring
 Centralizers one in middle of first joint, then every third collar
 1 Top Rubber Plug
 1 Thread Lock Compound

Production:

Fresh Water	10 bbl	CW100	
Lead Slurry 1 TOC, 400' above 7" shoe		190 LiteCrete D961 / D124 / D154 + 0.03 gps D47 antifoam + 0.5% D112 fluid loss + 0.11% D65 TIC	467 cuft
Tail Slurry 2 1545 ft fill		160 sx 50/50 Class "G"/Poz + 5% D20 gel (extender) + 0.1% D46 antifoam + 1/4 #/sk. Cellophane Flake + 0.25% D167 Fluid Loss + 5 lb/sk Gilsonite	222 cuft

Cementing Program

+0.1% d800, retarder
+0.15% D65, dispersant

0.1026 cuft/ft OH

Slurry Properties:

	Density (lb/gal)	Yield (ft ³ /sk)	Water (gal/sk)	
Slurry 1	9.5	2.52	6.38	0.1169 cuft/ft csg ann
Slurry 2	13	1.44	6.5	Top of Mancos 5197

Casing Equipment:

- 4-1/2", 8R, ST&C
- 1 Float Shoe (autofill with minimal LCM in mud)
- 1 Float Collar (autofill with minimal LCM in mud)
- 1 Stop Ring
- Centralizers, every 4th joint in mud drilled holes, none in air drilled holes.
- 1 Top Rubber Plug
- 1 Thread Lock Compound

BP American Production Company
Well Control Equipment Schematic



BOP Stack

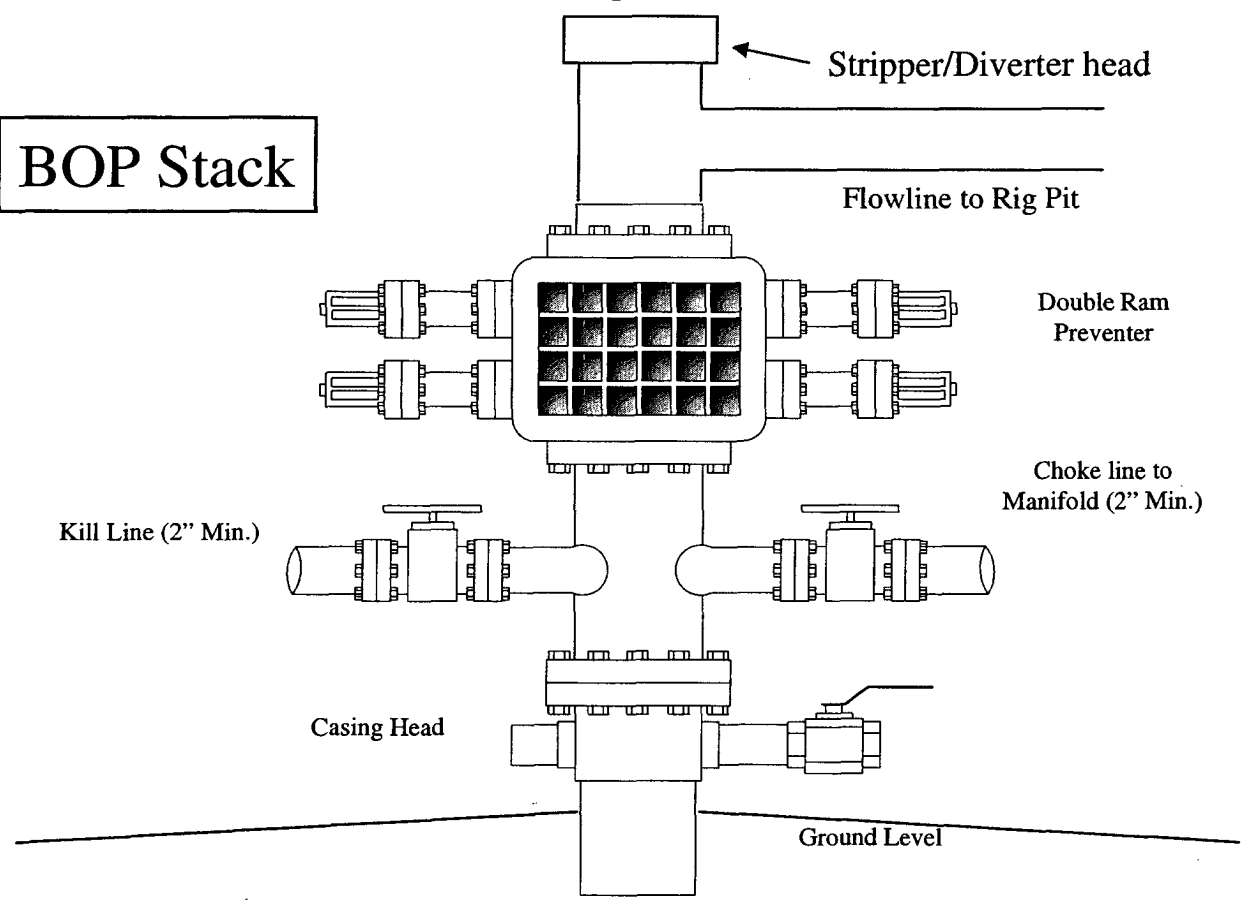

Choke & Kill Manifold

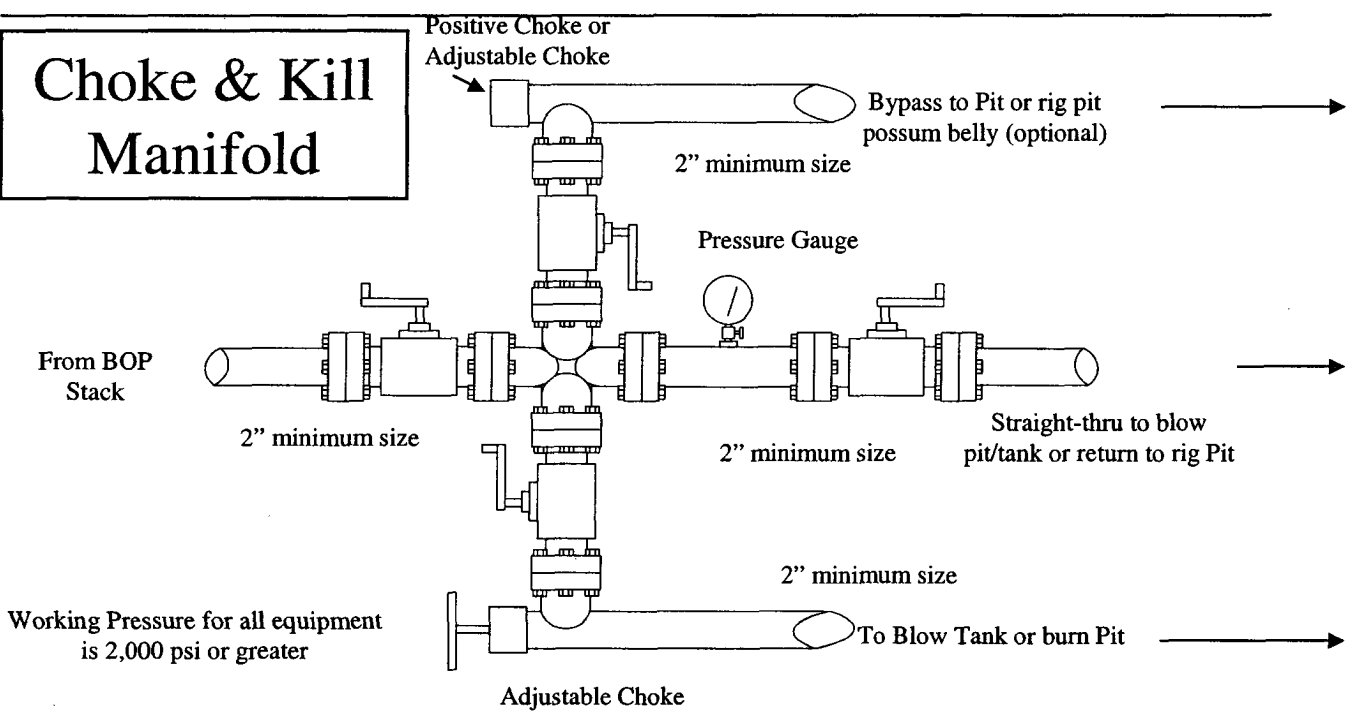



WELL Schwerdtfeger A 4M	FIELD San Juan County, New Mexico	STRUCTURE BP 31-28N-08W
-----------------------------------	---	-----------------------------------

Magnetic Parameters Model	Dep. Mag Dec.	Date FS	Surface Location Lat Lon	Nothing Easting	NAD83 New Mexico State Plane, Western Zone, US Feet Orig Conv: Scale Factor 1.0075480907	Miscellaneous Sta: Plan:	Schwerdtfeger A 4M Schwerdtfeger A 4M RD	TVD Ref: RFB (5397.00 ft above MSL) Srvy Date: June 14, 2004
------------------------------	------------------	------------	--------------------------------	--------------------	--	--------------------------------	---	---

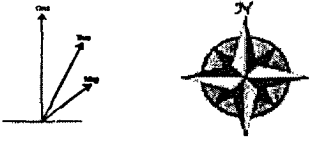

Proposal

<<< W Scale = 1(in):150(ft) E >>>

-150 0 150

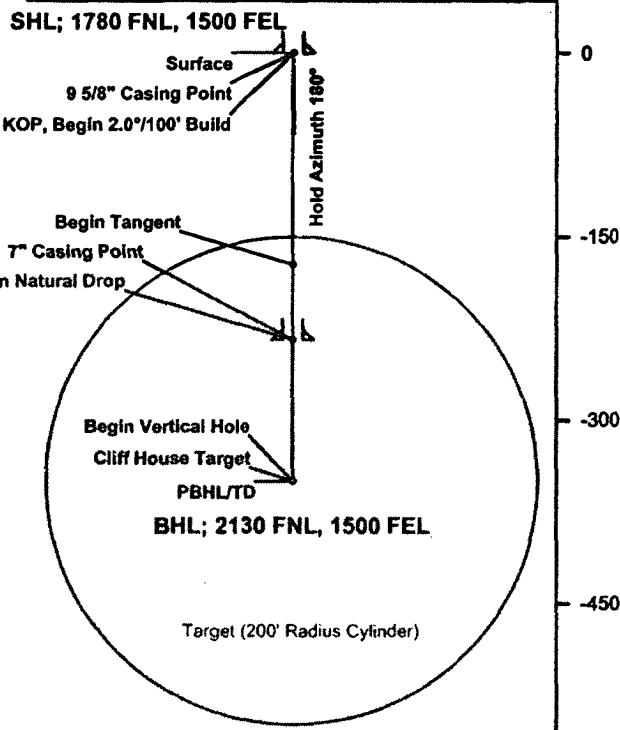

<<< S Scale = 1(in):150(ft) N >>>

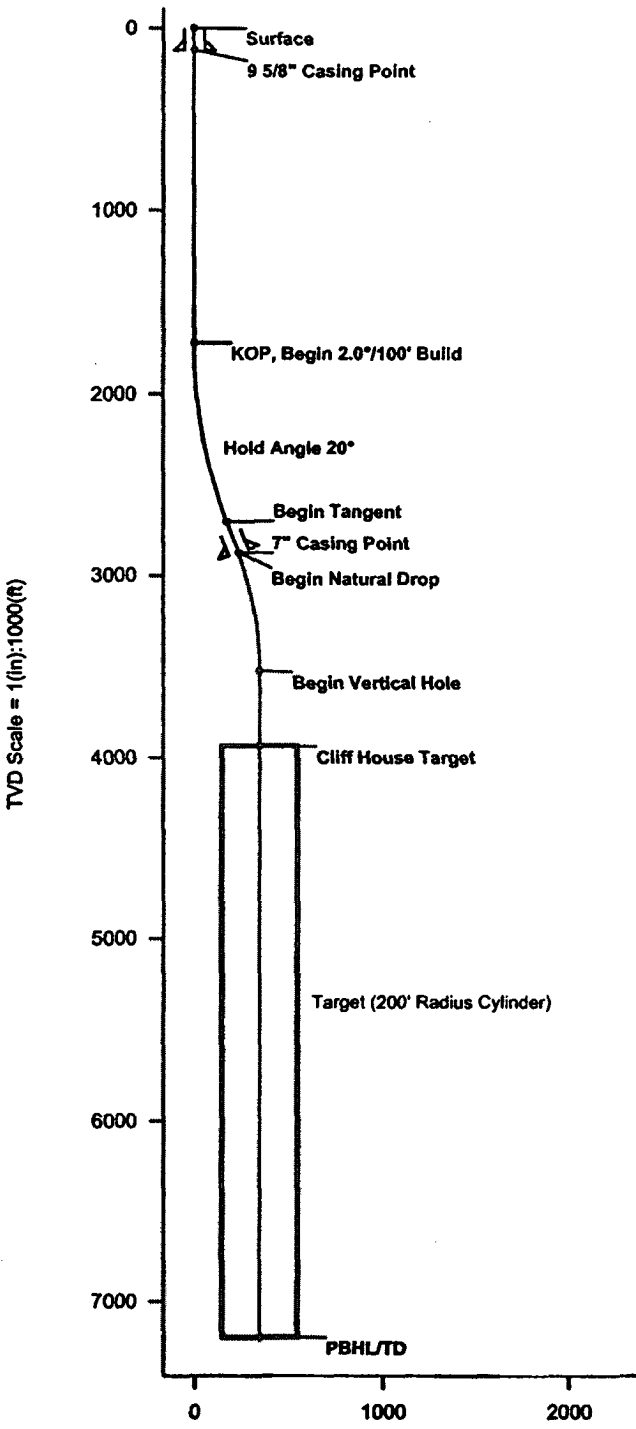

Target Description		Grid Coord		Local Coord				
Target Name	Shape	Major Axis	N(+)S(-)	E(+)W(-)	TVD	YSec	N(+)S(-)	E(+)W(-)
Schwerdtfeger A 4M Target (200' Radius Cylinder)	Circle	400.00	4101861.17	140416.48	3935.00	350.00	-350.00	0.00

Critical Points									
Critical Point	MD	INCL	AZIM	TVD	YSEC	N(+)S(-)	E(+)W(-)	DLS	
Surface	0.00	0.00	180.00	0.00	0.00	0.00	0.00	0.00	
9 5/8" Casing Point	120.00	0.00	180.00	120.00	0.00	0.00	0.00	0.00	
KOP, Begin 2.0"/100' Build	1721.00	0.00	180.00	1721.00	0.00	0.00	0.00	0.00	
Begin Tangent	2721.08	20.00	180.00	2700.89	172.80	-172.80	0.00	2.00	
7" Casing Point	2902.11	20.00	180.00	2871.00	234.72	-234.72	0.00	0.00	
Begin Natural Drop	2902.36	20.00	180.00	2871.24	234.80	-234.80	0.00	0.00	
Begin Vertical Hole	3569.08	0.00	180.00	3524.50	350.00	-350.00	0.00	3.00	
Cliff House Target	3979.58	0.00	180.00	3935.00	350.00	-350.00	0.00	0.00	
PBHL/TD	7241.58	0.00	180.00	7197.00	350.00	-350.00	0.00	0.00	

Quality Control
 Date Drawn: Fri 10:53 AM May 14, 2004
 Drawn by: Dana Crossland
 Checked by: Jim Wimberg
 Client OK: