

UNITED STATES
DEPARTMENT OF THE INTERIOR
BUREAU OF LAND MANAGEMENT

APPLICATION FOR PERMIT TO DRILL, DEEPEN, OR PLUG BACK

RECEIVED
2004 APR 28 PM 2:53
FARMINGTON, NM

1a. Type of Work DRILL	5. Lease Number NMSF-080711A Unit Reporting Number	
1b. Type of Well GAS	6. If Indian, All. or Tribe	
2. Operator BURLINGTON RESOURCES OIL & GAS COMPANY LP	7. Unit Agreement Name San Juan 30-6 Unit	
3. Address & Phone No. of Operator PO Box 4289, Farmington, NM 87499 (505) 326-9700	8. Farm or Lease Name San Juan 30-6 Unit 9. Well Number 481S	
4. Location of Well 720' FNL, 1620' FWL Latitude 36° 47.2, Longitude 107° 30.26	10. Field, Pool, Wildcat Basin Fruitland Coal 11. Sec., Twn, Rge, Mer. (NMPM) Sec. 30, T-30-N, R-6-W API # 30-039- 27712	
14. Distance in Miles from Nearest Town 12 miles from Navajo City	12. County Rio Arriba	13. State NM
15. Distance from Proposed Location to Nearest Property or Lease Line 720'	17. Acres Assigned to Well 320 W/2	
16. Acres in Lease	18. Distance from Proposed Location to Nearest Well, Drig, Compl, or Applied for on this Lease 20'	
19. Proposed Depth 3206'	20. Rotary or Cable Tools Rotary	
21. Elevations (DF, FT, GR, Etc.) 6249' GR	22. Approx. Date Work will Start	
23. Proposed Casing and Cementing Program See Operations Plan attached		
24. Authorized by: <u>Nancy Altmann</u> Senior Staff Specialist	<u>9-22-03</u> Date	

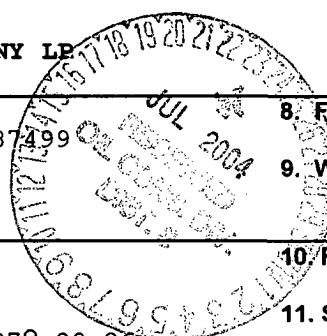

PERMIT NO. _____ APPROVAL DATE _____
APPROVED BY [Signature] TITLE AFM DATE 7-16-04

Archaeological Report attached
Threatened and Endangered Species Report submitted for the San Juan 30-6 Unit #57A
NOTE: This format is issued in lieu of U.S. BLM Form 3160-3
Title 18 U.S.C. Section 1001, makes it a crime for any person knowingly and willfully to make to any department or agency of the United States any false, fictitious or fraudulent statements or presentations as to any matter within its jurisdiction.

No notification required under Order R-8768-F

DRILLING OPERATIONS AUTHORIZED ARE
SUBJECT TO COMPLIANCE WITH ATTACHED
"GENERAL REQUIREMENTS".

NMOCOD

This action is subject to technical and
procedural review pursuant to 43 CFR 3165.3
and appeal pursuant to 43 CFR 3165.4

District I
PO Box 1980, Hobbs, NM 88241-1980

State of New Mexico
Energy, Minerals & Natural Resources Department

Form C-102
Revised February 21, 1994

District II
PO Drawer DD, Artesia, NM 88211-0719

OIL CONSERVATION DIVISION
PO Box 2088
Santa Fe, NM 87504-2088

Submit to Appropriate District Office
State Lease - 4 Copies
Fee Lease - 3 Copies

District III
1000 Rio Brazos Rd., Aztec, NM 87410

District IV
PO Box 2088, Santa Fe, NM 87504-2088

AMENDED REPORT
2004 APR 28 PM 2:53

WELL LOCATION AND ACREAGE CERTIFICATION PLAT

¹ API Number 30-039-27712	² Pool Code 71629	³ Pool Name Basin Fruitland Coal
⁴ Property Code 7469	⁵ Property Name SAN JUAN 30-6 UNIT	
⁷ GRID No. 14538	⁶ Operator Name BURLINGTON RESOURCES OIL & GAS COMPANY, LP	⁸ Well Number 481S
		⁹ Elevation 6249'

¹⁰ Surface Location

UL or lot no.	Section	Township	Range	Lot Idn	Feet from the	North/South line	Feet from the	East/West line	County
C	30	30N	6W		720	NORTH	1620	WEST	RIO ARRIBA

¹¹ Bottom Hole Location If Different From Surface

UL or lot no.	Section	Township	Range	Lot Idn	Feet from the	North/South line	Feet from the	East/West line	County

¹² Dedicated Acres 320	¹³ Joint or Infill	¹⁴ Consolidation Code	¹⁵ Order No.
--------------------------------------	-------------------------------	----------------------------------	-------------------------

NO ALLOWABLE WILL BE ASSIGNED TO THIS COMPLETION UNTIL ALL INTERESTS HAVE BEEN CONSOLIDATED OR A NON-STANDARD UNIT HAS BEEN APPROVED BY THE DIVISION

¹⁶

LAT: 36°47.3332' N
LONG: 107°30.4290' W
DATUM: NAD27

5280.00'

1620'

720'

1015'

1420'

30

USA SF-080711-A

5273.40'

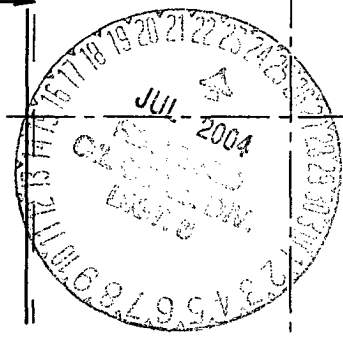

¹⁷ OPERATOR CERTIFICATION

I hereby certify that the information contained herein is true and complete to the best of my knowledge and belief

Nancy Oltmanns
Signature

Nancy Oltmanns
Printed Name

Senior Staff Specialist
Title

9-22-03
Date

¹⁸ SURVEYOR CERTIFICATION

I hereby certify that the well location shown on this plat was plotted from field notes of actual surveys made by me or under my supervision, and that the same is true and correct to the best of my belief.

Date of Survey: JULY 29, 2003

Signature and Seal of Professional Surveyor



JASON C. EDWARDS
Certificate Number 15269

OPERATIONS PLAN

Well Name: San Juan 30-6 Unit #481S
Location: 720' FNL, 1620' FWL, Section 30, T-30-N, R-6-W
Latitude 36° 47.20, Longitude 107° 30.26
Rio Arriba County, NM
Formation: Basin Fruitland Coal
Elevation: 6249' GR

Formation:	Top	Bottom	Contents
Surface	San Jose	2268'	
Ojo Alamo	2268'	2369'	aquifer
Kirtland	2369'	2747'	gas
Fruitland	2747'	2931'	gas
Intermediate casing	2832'		
Top of Coal	2931'	3121'	
Base of Coal	3121'		
Pictured Cliffs	3185'		
Total Depth	3206'		

Logging Program:
Open hole - GR/RHOB from TD to 2832'
Mud log - TD to 2832'

Coring Program: none

Mud Program:

<u>Interval</u>	<u>Type</u>	<u>Weight</u>	<u>Vis.</u>	<u>Fluid Loss</u>
0- 120'	Spud/Air/Air Mist	8.4-9.0	40-50	no control
120-2832'	Non-dispersed	8.4-9.0	30-60	no control
2832-3206'	Air/Mist			no control

Casing Program (as listed, the equivalent, or better):

<u>Hole Size</u>	<u>Depth Interval</u>	<u>Csg. Size</u>	<u>Wt.</u>	<u>Grade</u>
12 1/4"	0' - 120'	9 5/8"	32.3#	H-40
8 3/4"	0' - 2832'	7"	20.0#	J-55
6 1/4"	2832' - 3206'	open hole		

Alternate Casing Program (as listed, the equivalent, or better):

<u>Hole Size</u>	<u>Depth Interval</u>	<u>Csg. Size</u>	<u>Wt.</u>	<u>Grade</u>
12 1/4"	0' - 120'	9 5/8"	32.3#	H-40
8 3/4"	0' - 2832'	7"	20.0#	J-55
6 1/4"	2792' - 3206'	5 1/2"	15.5#	J-55

Tubing Program:

0' - 3206' 2 3/8" 4.7# J-55

Float Equipment: 9 5/8" surface casing - saw tooth guide shoe. Centralizers will be run in accordance with Onshore Order #2.

7" intermediate casing - guide shoe and self-fill float collar. Standard centralizers run every other joint above shoe. Two turbolizing type centralizers - one below and one into the base of the Ojo Alamo @ 2369'. Standard centralizers thereafter every fourth joint up to the base of the surface pipe.

Wellhead Equipment: 9 5/8" x 7" x 2 3/8" x 11" 2000 psi xmas tree assembly.

Cementing:

9 5/8" surface casing -

Pre-Set Drilled Cement with 23 sx Type I, II cement with 20% flyash mixed at 14.5 ppg, 1.61 cu ft per sack yield. (37 cu ft of slurry, bring cement to surface) Wait on cement for 24 hours for pre-set holes before pressure testing or drilling out from under surface.

Conventionally Drilled:

Cement with 88 sx Type III cement with 0.25 pps Celloflake, 3% calcium chloride (113 cu ft of slurry, 200% excess, bring cement to surface) Wait on cement for 8 hrs for conventionally set holes before pressure testing or drilling out from under surface.

Wait on cement until cement establishes 250 psi compressive strength prior to nipple up of BOP.

7" intermediate casing - lead w/241 sacks Premium Lite cement with 3% calcium chloride, 0.25 pps Celloflake, 5 pps LCM-1, 0.4% fluid loss, 0.4% sodium metasilicate. Tail with 90 sacks Type III cement with 1% calcium chloride, 0.25 pps Celloflake, 0.2% fluid loss (638 cu.ft., 50% excess to circulate to surface).

5 1/2" liner - will not be cemented if run.

Note: If open hole logs are run, cement volumes will be based on 25% excess over caliper volumes.

BOP and tests:

Surface to intermediate TD - 11" 2000 psi (minimum) double gate BOP stack (Reference Figure #1). Prior to drilling out surface casing, test BOPE to 600 psi for 30 min.

Intermediate TD to Total Depth - 7 1/6" 2000 psi (minimum) completion BOP stack (Reference Figure #2). Prior to drilling out intermediate casing, test BOPE and casing to 1500 psi for 30 minutes.

From surface to 7" TD - a choke manifold will be installed in accordance with Onshore Order No. 2 (Reference Figure #3). When the cavitation completion rig drills the production hole, the completion rig configuration will be used (Reference Figure #4).

Pipe rams will be actuated at least once each day and blind rams actuated once each trip to test proper functioning. An upper kelly cock valve with handle and drill string safety valves to fit each drill string will be maintained and available on the rig floor.

Additional information:

- The Fruitland Coal formation will be completed.
- Anticipated pore pressure for the Fruitland is 500 psi.
- This gas is dedicated.
- The west half of Section 30 is dedicated to this well.

Drilling Engineer:

Jim McMclauthy

Date:

4-21-04

Completion/Workover Rig
BOP Configuration
2,000 psi System

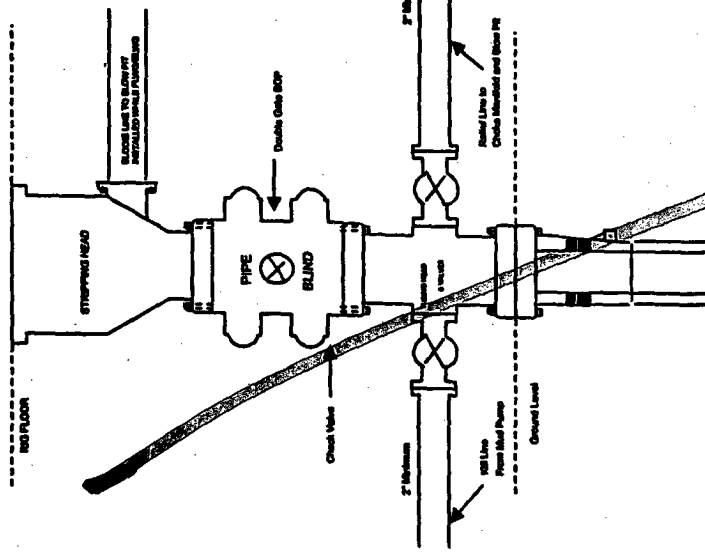

Minimum BOP installation for all Completion/Workover Operations. 7-1/16" bore, 2000 psi minimum working pressure double gate BOP to be equipped with blind and pipe rams. A stripping head to be installed on the top of the BOP. All BOP equipment is 2000 psi working pressure or greater excluding 500 psi stripping head.

Figure #2

Drilling Rig
Choke Manifold Configuration
2000 psi System

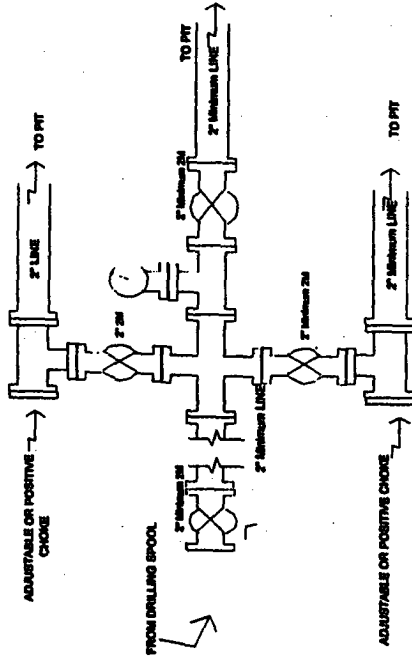

Choke manifold installation from Surface Casing Point to Total Depth. 2,000psi working pressure equipment with two chokes.

Figure #3

Drilling Rig
2000 psi System

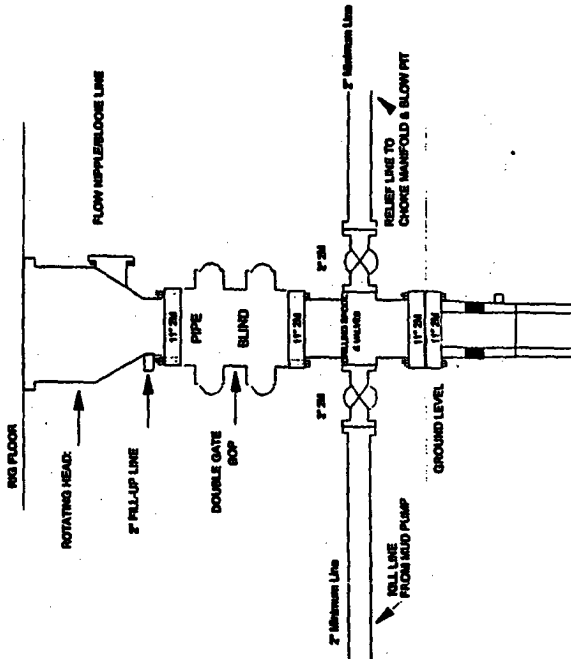

BOP installation from Surface Casing Point to Total Depth. 1 1/2" Bore 10' Nominal, 2000 psi working pressure double gate BOP to be equipped with blind and pipe rams. 500 psi working head on top of ram preventer. All BOP equipment is 2,000 psi working pressure.

Figure #1

BURLINGTON RESOURCES

FIGURE #4

Cavitation Rig BOP Configuration 2,000 psi Minimum System

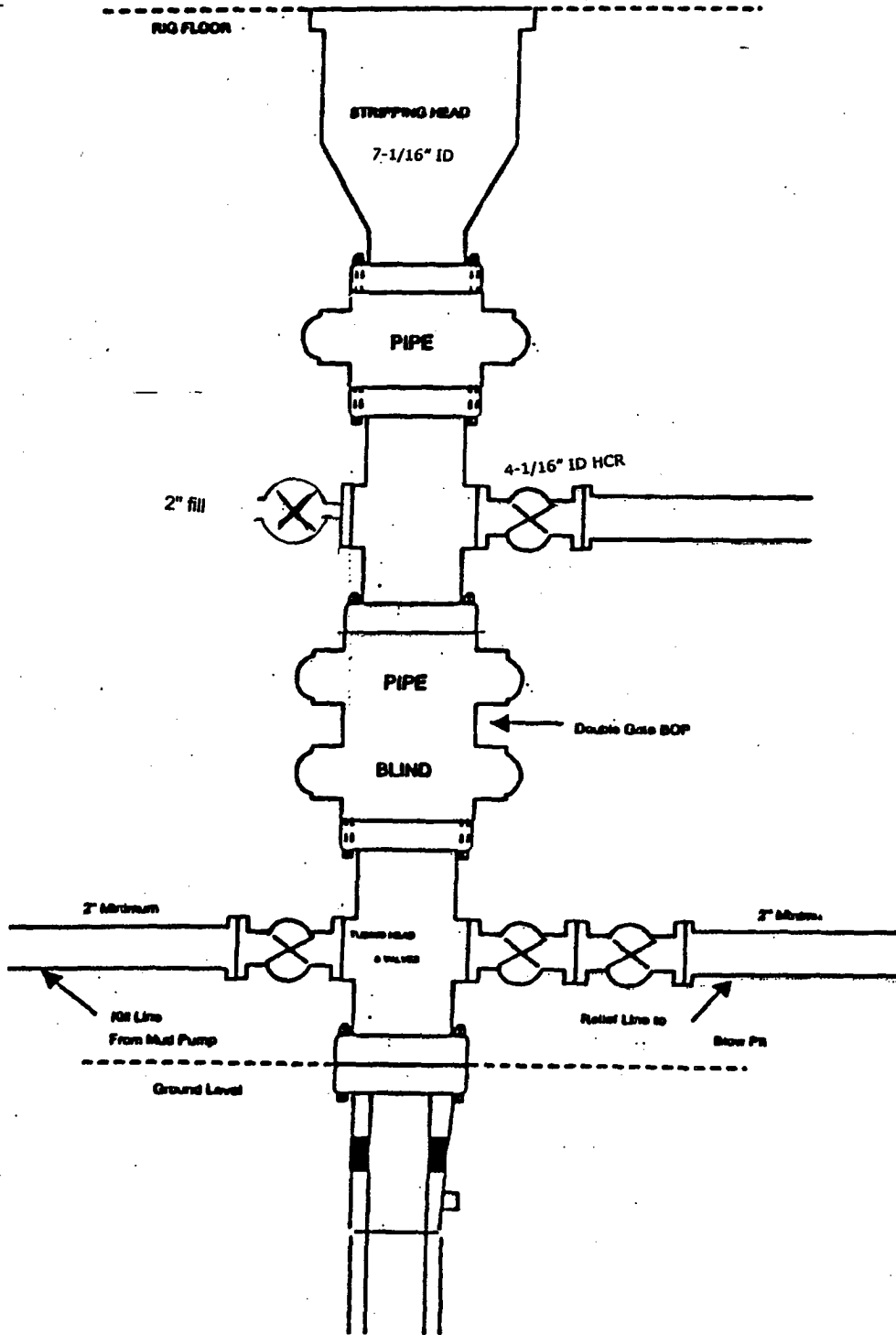

Submit 3 Copies To Appropriate District Office
 District I
 1625 N. French Dr., Hobbs, NM 88240
 District II
 1301 W. Grand Ave., Artesia, NM 88210
 District III
 1000 Rio Brazos Rd., Aztec, NM 87410
 District IV
 1220 S. St. Francis Dr., Santa Fe, NM 87505

State of New Mexico
 Energy, Minerals and Natural Resources

Form C-103
 March 4, 2004

OIL CONSERVATION DIVISION
 1220 South St. Francis Dr.
 Santa Fe, NM 87505

WELL API NO. 30-039-
5. Indicate Type of Lease STATE <input type="checkbox"/> FEE <input type="checkbox"/>
6. State Oil & Gas Lease No. NMSF-080711A
7. Lease Name or Unit Agreement Name San Juan 30-6 Unit
8. Well Number #481S
9. OGRID Number 14538
10. Pool name or Wildcat Basin Fruitland Coal

SUNDRY NOTICES AND REPORTS ON WELLS
 (DO NOT USE THIS FORM FOR PROPOSALS TO DRILL OR TO DEEPEN OR PLUG BACK TO A DIFFERENT RESERVOIR. USE "APPLICATION FOR PERMIT" (FORM C-101) FOR SUCH PROPOSALS.)

1. Type of Well:
 Oil Well Gas Well Other

2. Name of Operator
 Burlington Resources Oil & Gas Company LP

3. Address of Operator
 3401 E. 30th Street, Farmington, NM 87402

4. Well Location
 Unit Letter C : 720 feet from the North line and 1620 feet from the West line
 Section 30 Township 30N Range 6W NMPM Rio Arriba County, NM

11. Elevation (Show whether DR, RKB, RT, GR, etc.)

Pit or Below-grade Tank Application (For pit or below-grade tank closures, a form C-144 must be attached)

Pit Location: UL Sect Twp Rng Pit type Depth to Groundwater > 100' Distance from nearest fresh water well > 1000' Distance from nearest surface water > 1000' Below-grade Tank Location UL Sect Twp Rng ;
 feet from the line and feet from the line

12. Check Appropriate Box to Indicate Nature of Notice, Report or Other Data
 NOTICE OF INTENTION TO: SUBSEQUENT REPORT OF:

PERFORM REMEDIAL WORK <input type="checkbox"/>	PLUG AND ABANDON <input type="checkbox"/>	REMEDIAL WORK <input type="checkbox"/>	ALTERING CASING <input type="checkbox"/>
TEMPORARILY ABANDON <input type="checkbox"/>	CHANGE PLANS <input type="checkbox"/>	COMMENCE DRILLING OPNS. <input type="checkbox"/>	PLUG AND ABANDONMENT <input type="checkbox"/>
PULL OR ALTER CASING <input type="checkbox"/>	MULTIPLE COMPLETION <input type="checkbox"/>	CASING TEST AND CEMENT JOB <input type="checkbox"/>	
OTHER: New Drill Pit <input checked="" type="checkbox"/>		OTHER: <input type="checkbox"/>	

13. Describe proposed or completed operations. (Clearly state all pertinent details, and give pertinent dates, including estimated date of starting any proposed work). SEE RULE 1103. For Multiple Completions: Attach wellbore diagram of proposed completion or recompletion.

Burlington Resources proposes to construct a new drill pit. The new drill pit will be an unlined pit as detailed in Burlington's general pit construction plan dated April 26, 2004 on file at the NMOCD office.

I hereby certify that the information above is true and complete to the best of my knowledge and belief. I further certify that any pit or below-grade tank has been/will be constructed or closed according to NMOCD guidelines , a general permit or an (attached) alternative OCD-approved plan .

SIGNATURE Nancy Oltmanns TITLE Regulatory Specialist DATE 4/28/04

Type or print name Nancy Oltmanns E-mail address: noltmanns@br-inc.com Telephone No. 326-9700

(This space for State use)

APPROVED BY [Signature] TITLE DEPUTY OIL & GAS INSPECTOR, DIST. #3 DATE JUL 23 2004
 Conditions of approval, if any:

BURLINGTON RESOURCES OIL & GAS COMPANY SAN JUAN 30-6 UNIT #4613
 720' FNL & 1620' FWL, SECTION 30, T30N, R6W, NMPM, RIO ARriba COUNTY, NM
 GROUND ELEVATION: 6249' DATE: JULY 29, 2003

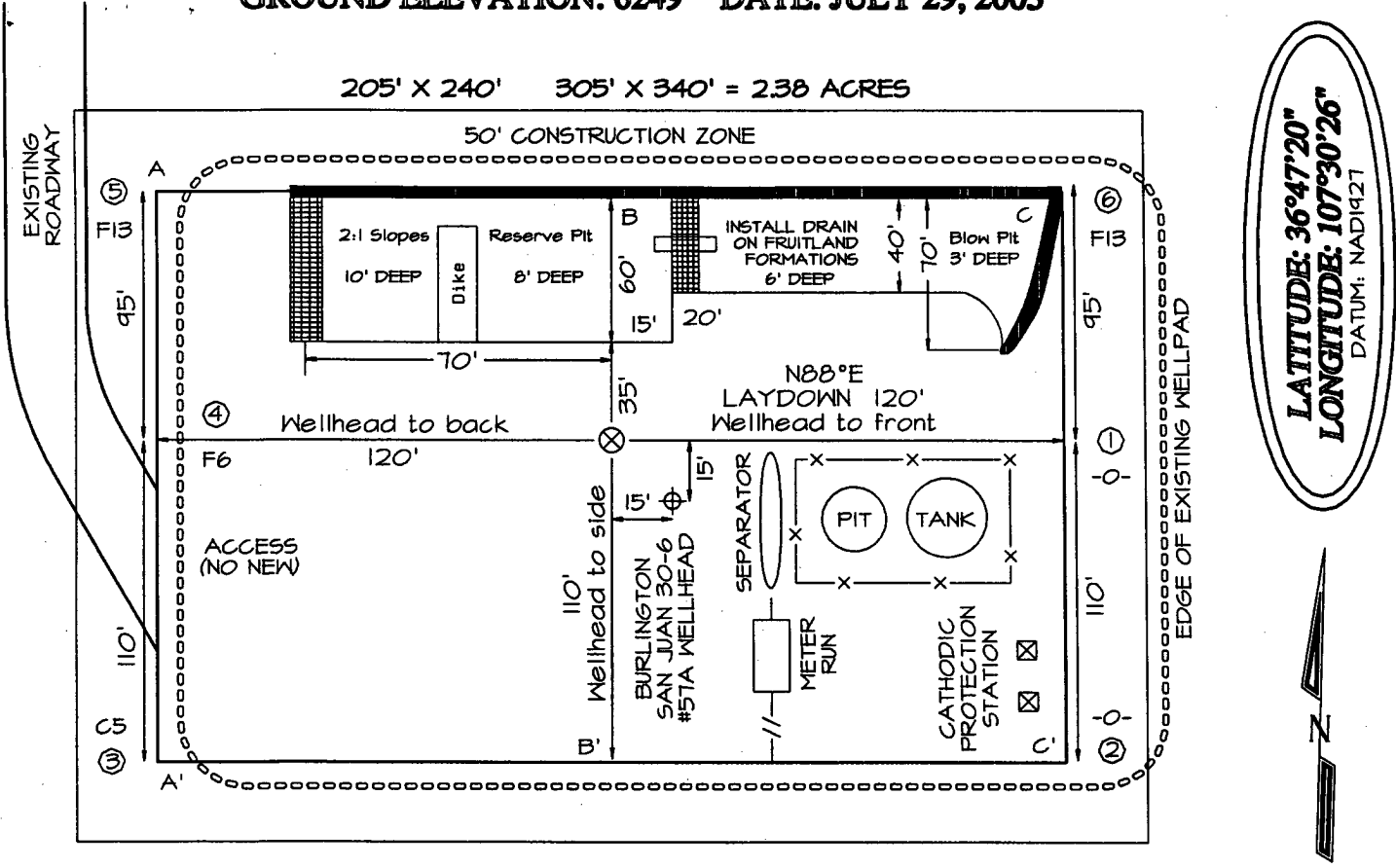

Reserve Pit Dike: to be 8' above Deep side (overflow - 3' wide and 1' above shallow side).
 Blow Pit: overflow pipe halfway between top and bottom and to extend over plastic liner and into blow pit.

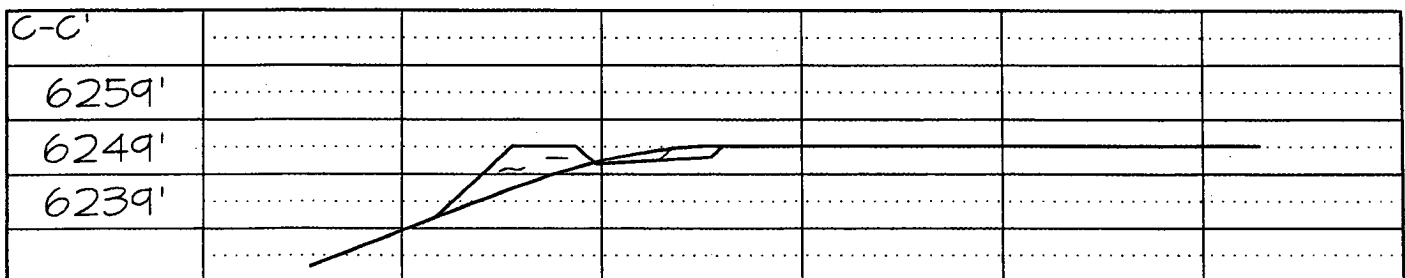
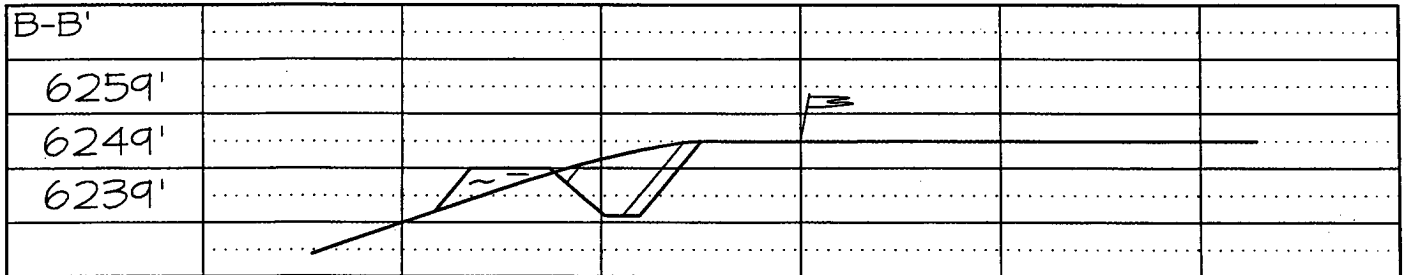
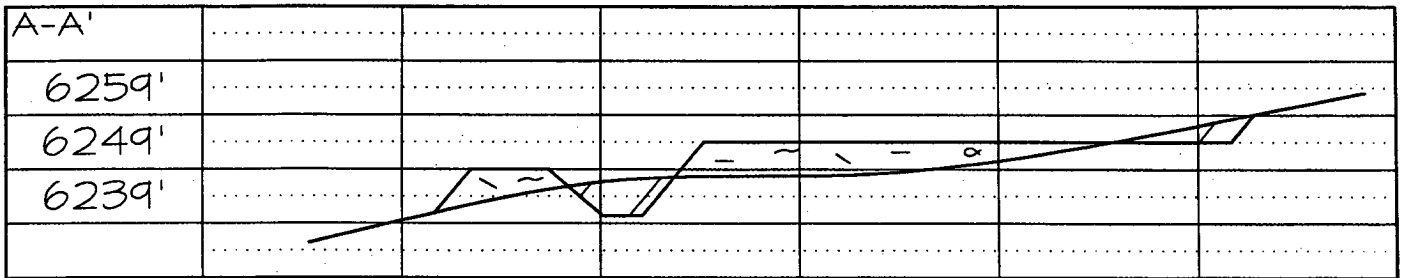

Note: Contractor should call One-Call for location of any marked or unmarked buried pipelines or cables on well pad and/or access road at least two (2) working days prior to construction