

UNITED STATES
DEPARTMENT OF THE INTERIOR
BUREAU OF LAND MANAGEMENT

FORM APPROVED
OMB No. 1004-0136
Expires November 30, 2000

APPLICATION FOR PERMIT TO DRILL OR REENTER

1a. Type of Work: <input checked="" type="checkbox"/> DRILL <input type="checkbox"/> REENTER		5. Lease Serial No. NM 03358
1b. Type of Well: <input type="checkbox"/> Oil Well <input checked="" type="checkbox"/> Gas Well <input type="checkbox"/> Other <input checked="" type="checkbox"/> Single Zone <input type="checkbox"/> Multiple Zone		6. If Indian, Allottee or Tribe Name
2. Name of Operator DEVON ENERGY CORP.		7. If Unit or CA Agreement, Name and No.
Contact: CHARLES MUZZY E-Mail: charles.muzzy@devon.com		8. Lease Name and Well No. NEBU 498A
3a. Address 20 NORTH BOARDWAY OKLAHOMA CITY, OK 73102	3b. Phone No. (include area code) Ph: 405.552.7955 Fx: 405.552.4553	9. API Well No. 3004532413
4. Location of Well (Report location clearly and in accordance with any State requirements) At surface NWNW Lot D 1085FNL 770FWL At proposed prod. zone NWNW Lot D 1085FNL 770FWL		10. Field and Pool, or Exploratory BASIN FRUITLAND COAL
14. Distance in miles and direction from nearest town or post office* APPROXIMATELY 23 MILES SOUTHEAST OF IGNACIO, CO		11. Sec., T., R., M., or Blk. and Survey or Area 0 Sec 13 T31N R7W Mer NMP SME: BLM
15. Distance from proposed location to nearest property or lease line, ft. (Also to nearest drig. unit line, if any) 770	16. No. of Acres in Lease 2396.77	12. County or Parish SAN JUAN
18. Distance from proposed location to nearest well, drilling, completed, applied for, on this lease, ft.	19. Proposed Depth 3451 MD	13. State NM
21. Elevations (Show whether DF, KB, RT, GL, etc.) 6525 GL	22. Approximate date work will start	17. Spacing Unit dedicated to this well 320.00 W/2
		20. BLM/BIA Bond No. on file
		23. Estimated duration 20 DAYS

24. Attachments

The following, completed in accordance with the requirements of Onshore Oil and Gas Order No. 1, shall be attached to this form:

1. Well plat certified by a registered surveyor.
2. A Drilling Plan.
3. A Surface Use Plan (if the location is on National Forest System Lands, the SUPO shall be filed with the appropriate Forest Service Office).
4. Bond to cover the operations unless covered by an existing bond on file (see Item 20 above).
5. Operator certification
6. Such other site specific information and/or plans as may be required by the authorized officer.

25. Signature (Electronic Submission)	Name (Printed/Typed) CHARLES MUZZY	Date 06/08/2004
Title SR. OPERATIONS TECH		
Approved by (Signature) <i>[Signature]</i>	Name (Printed/Typed)	Date 7-16-04
Title AFM	Office FFO	

Application approval does not warrant or certify the applicant holds legal or equitable title to those rights in the subject lease which would entitle the applicant to conduct operations thereon.
Conditions of approval, if any, are attached.

Title 18 U.S.C. Section 1001 and Title 43 U.S.C. Section 1212, make it a crime for any person knowingly and willfully to make to any department or agency of the United States any false, fictitious or fraudulent statements or representations as to any matter within its jurisdiction.

Additional Operator Remarks (see next page)

Electronic Submission #31625 verified by the BLM Well Information System
For DEVON ENERGY CORP., sent to the Farmington

This action is subject to technical and procedural review pursuant to 43 CFR 3165.3 and appeal pursuant to 43 CFR 3165.4

DRILLING OPERATIONS AUTHORIZED ARE
SUBJECT TO COMPLIANCE WITH ATTACHED
"GENERAL REQUIREMENTS".

** OPERATOR-SUBMITTED ** OPERATOR-SUBMITTED ** OPERATOR-SUBMITTED **

BLM

District I
PO Box 1980, Hobbs NM 88241-1980
District II
PO Drawer KK, Artesia, NM 87211-0719
District III
1000 Rio Brazos Rd., Aztec, NM 87410
District IV
PO Box 2088, Santa Fe, NM 87504-2088

State of New Mexico
Energy, Minerals & Natural Resources Department

OIL CONSERVATION DIVISION
PO Box 2088
Santa Fe, NM 87504-2088

Form C-102
Revised February 21, 1994
Instructions on back
Submit to Appropriate District Office
State Lease - 4 Copies
Fee Lease - 3 Copies

☐ AMENDED REPORT

WELL LOCATION AND ACREAGE DEDICATION PLAT

API Number 30-045-32413		Pool Code 71629	Pool Name Basin Fruitland Coal
Property Code 19641	Property Name NEBU		Well Number # 498A
GRID No. 6137	Operator Name Devon Energy Production Company, L.P.		Elevation 6525

10 Surface Location

UL or Lot No.	Section	Township	Range	Lot Idn	Feet from the	North/South line	Feet from the	East/West line	County
D	13	31 N	7 W		1085	NORTH	770	WEST	SAN JUAN

11 Bottom Hole Location If Different From Surface

UL or lot no.	Section	Township	Range	Lot Idn	Feet from the	North/South line	Feet from the	East/West line	County
Dedicated Acres 320		Joint or Infill		Consolidation Code		Order No.			

NO ALLOWABLE WILL BE ASSIGNED TO THIS COMPLETION UNTIL ALL INTERESTS HAVE BEEN CONSOLIDATED
OR A NON-STANDARD UNIT HAS BEEN APPROVED BY THE DIVISION

	17 OPERATOR CERTIFICATION I hereby certify that the information contained herein is true and complete to the best of my knowledge and belief. Signature <u>Charles Muezy</u> Printed Name <u>Charles Muezy</u> Title <u>Sr. Operations Tech</u> Date <u>6-7-04</u>
	18 SURVEYOR CERTIFICATION I hereby certify that the well location shown on this plat was plotted from field notes of actual surveys made by me or under my supervision, and that the same is true and correct to the best of my belief. Date of Survey <u>March 12, 2004</u> Signature and Seal of Professional Surveyor Certificate Number <u>7016</u>

• **Additional Operator Remarks:**

The referenced well is located inside the High Productivity Area of the Basin Fruitland Coal Pool. The subject well is in the participating area of the Northeast Blanco Unit. No notification is required per R-8768-F.

Submit 3 Copies To Appropriate District Office
District I
1625 N. French Dr., Hobbs, NM 88240
District II
1301 W. Grand Ave., Artesia, NM 88210
District III
1000 Rio Brazos Rd., Aztec, NM 87410
District IV
1220 S. St. Francis Dr., Santa Fe, NM 87505

State of New Mexico
Energy, Minerals and Natural Resources

Form C-103
March 4, 2004

OIL CONSERVATION DIVISION
1220 South St. Francis Dr.
Santa Fe, NM 87505

WELL API NO. 30-045-
5. Indicate Type of Lease STATE <input type="checkbox"/> FEE <input type="checkbox"/>
6. State Oil & Gas Lease No. <i>Federal SF-079010</i>
7. Lease Name or Unit Agreement Name NORTHEAST BLANCO UNIT
8. Well Number <i>498A</i>
9. OGRID Number 6137
10. Pool name or Wildcat <i>Basin Fruitland Coal</i>

SUNDRY NOTICES AND REPORTS ON WELLS
(DO NOT USE THIS FORM FOR PROPOSALS TO DRILL OR TO DEEPEN OR PLUG BACK TO A DIFFERENT RESERVOIR. USE "APPLICATION FOR PERMIT" (FORM C-101) FOR SUCH PROPOSALS.)

1. Type of Well:
Oil Well ☐ Gas Well ☒ Other

2. Name of Operator
DEVON ENERGY CORP.

3. Address of Operator
20 NORTH BROADWAY, OKLAHOMA CITY, OK 73102

4. Well Location
Unit Letter D : 1,085 feet from the North line and 770 feet from the West line
Section 13 Township 31N Range 7W NMPM County - SAN JUAN

11. Elevation (Show whether DR, RKB, RT, GR, etc.)
GR 6,525'

Pit or Below-grade Tank Application (For pit or below-grade tank closures, a form C-144 must be attached)

Pit Location: UL D Sect 13 Twp 31N Rng 7W Pit type Drilling Depth to Groundwater >100' Distance from nearest fresh water well >1000'
Distance from nearest surface water >1000' Below-grade Tank Location UL _____ Sect _____ Twp _____ Rng _____ ;
_____ feet from the _____ line and _____ feet from the _____ line

12. Check Appropriate Box to Indicate Nature of Notice, Report or Other Data	
NOTICE OF INTENTION TO:	SUBSEQUENT REPORT OF:
PERFORM REMEDIAL WORK <input type="checkbox"/> PLUG AND ABANDON <input type="checkbox"/>	REMEDIAL WORK <input type="checkbox"/> ALTERING CASING <input type="checkbox"/>
TEMPORARILY ABANDON <input type="checkbox"/> CHANGE PLANS <input type="checkbox"/>	COMMENCE DRILLING OPNS. <input type="checkbox"/> PLUG AND ABANDONMENT <input type="checkbox"/>
PULL OR ALTER CASING <input type="checkbox"/> MULTIPLE COMPLETION <input type="checkbox"/>	CASING TEST AND CEMENT JOB <input type="checkbox"/>
OTHER: CONSTRUCT DRILLING PIT <input checked="" type="checkbox"/>	OTHER: <input type="checkbox"/>

13. Describe proposed or completed operations. (Clearly state all pertinent details, and give pertinent dates, including estimated date of starting any proposed work). SEE RULE 1103. For Multiple Completions: Attach wellbore diagram of proposed completion or recompletion.

14.
DEVON ENERGY WILL BE CONSTRUCTING A LINED DRILLING PIT AND WE ANTICIPATE THE CLOSURE OF THE SAME PIT IN ACCORDANCE WITH OUR GENERAL PLAN SUBMITTED ON JUNE 4, 2004.

I hereby certify that the information above is true and complete to the best of my knowledge and belief. I further certify that any pit or below-grade tank has been/will be constructed or closed according to NMOCD guidelines ☒, a general permit ☒ or an (attached) alternative OCD-approved plan ☐.

SIGNATURE Charles Muzzy TITLE Sr. Operations Tech DATE 6-7-04

Type or print name Charles Muzzy E-mail address: charles.muzzy@dvn.com Telephone No. 405.552.7955

(This space for State use)

APPROVED BY [Signature] TITLE DEPUTY OIL & GAS INSPECTOR, DIST. 28 DATE JUL 23 2004
Conditions of approval, if any:

PAD LAYOUT PLAN & PROFILE
DEVON ENERGY PRODUCTION COMPANY, L.P.

NEBU # 498A
 1085' F/NL 770' F/WL
 SEC. 13, T31N, R7W, N.M.P.M.
 SAN JUAN COUNTY, NEW MEXICO

Lat: 36°54'13"
 Long: 107°31'43"

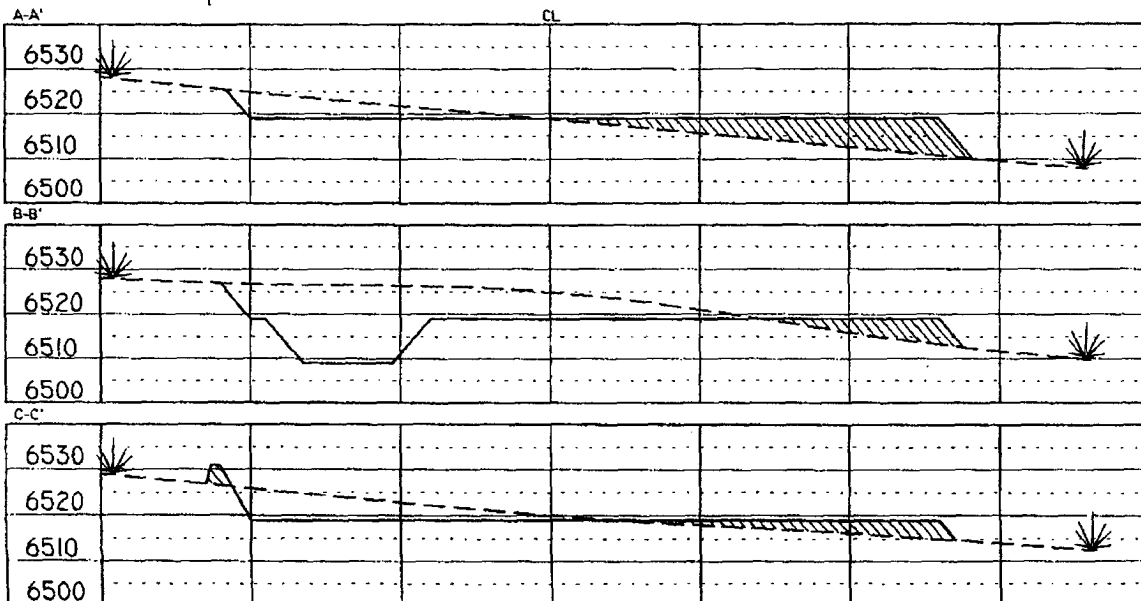
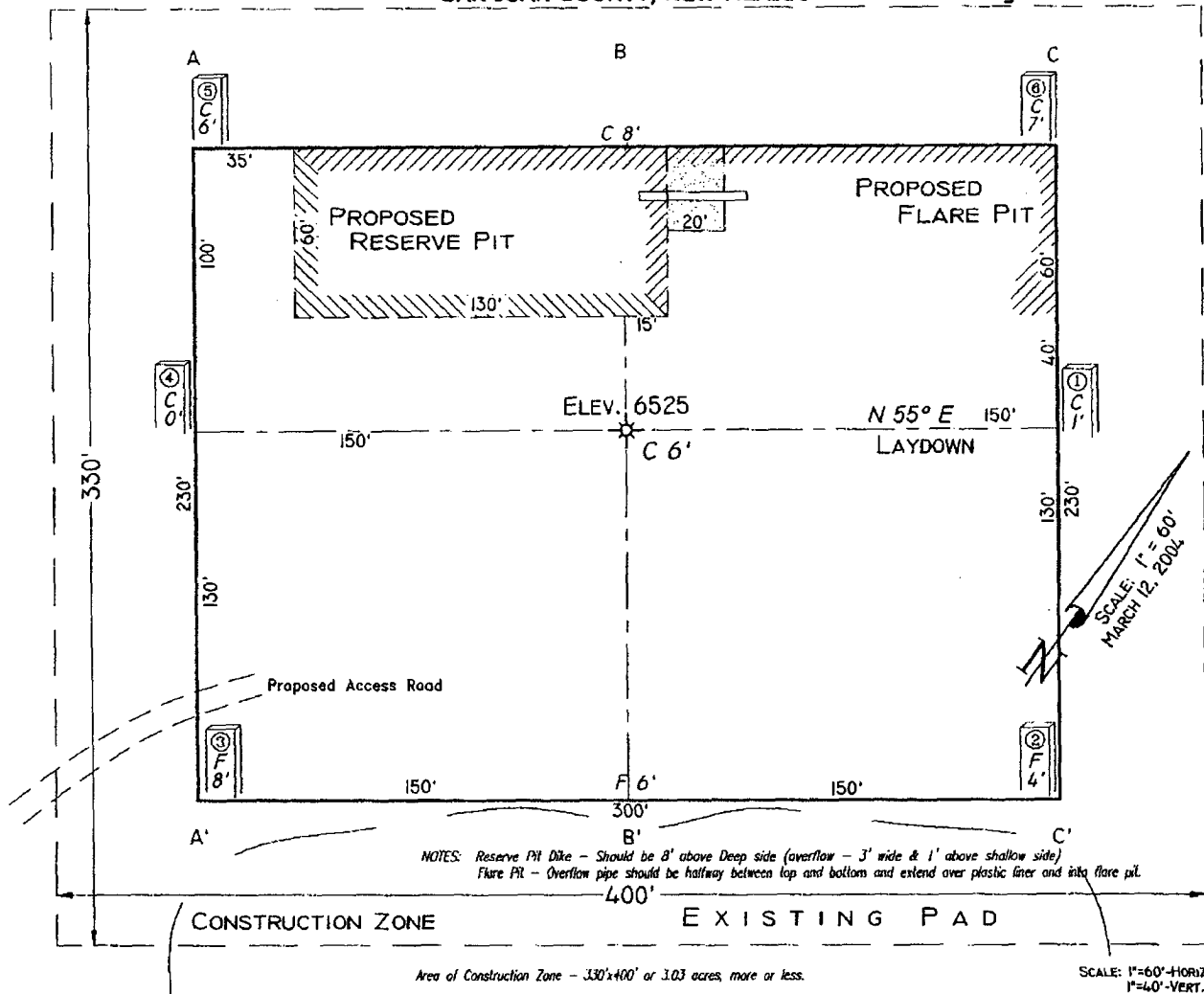

NOTE: Contractor should call One-Call for location of any marked or unmarked buried pipelines or cables on well pad and/or access road at least two (2) working days prior to construction.

Cuts and fills shown are approximate - final finished elevation is to be adjusted so earthwork will balance. Corner stakes are approximate and do not include additional areas needed for sideslopes and drainages. Final Pad Dimensions are to be verified by Contractor.

VANN SURVEYS
 P. O. Box 1306
 Farmington, NM

**NEBU 498A
Unit D 13-31N-7W
San Juan Co., NM**

DRILLING PLAN

1. ESTIMATED TOPS OF IMPORTANT GEOLOGIC MARKERS & ANTICIPATED WATER, OIL, GAS OR MINERAL FORMATIONS:

Formation	TVD (ft)	Hydrocarbon/Water Bearing Zones
San Jose	Surface	
Ojo Alamo	2405	Aquifer
Kirtland	2529	
Fruitland	2971	Gas
Pictured Cliffs	3351	Gas
PTD	3451	

All shows of fresh water and minerals will be adequately protected and reported. A 100' sump will be drilled into the Picture cliffs. A mud logger will be on location collecting samples and measuring gas levels. Should the Picture Cliffs interval appear to be productive the sump will be filled with cuttings and abandoned

2. PRESSURE CONTROL EQUIPMENT:

All well control equipment shall be in accordance with Onshore Order #2 for 2M systems.

The minimum specifications for pressure control equipment that will be provided are included on the attached schematic diagram, which shows the size, and pressure ratings.

- 2000# BOP With Pipe Rams and 2000# BOP With Blind Rams

Auxiliary equipment to be used:

- Upper kelly cock with handle available.

The manifold includes appropriate valves and adjustable chokes. The kill line will have one check valve. Ram type preventers will be pressure tested to full working pressure (utilizing a test plug) or 70% of the internal yield pressure (without a test plug) at:

- Initial installation
- Whenever any seal subject to test pressure is broken
- Following related repairs
- At 30 day intervals

Pipe and blind rams shall be activated each trip.

A BOPE pit level drill will be conducted weekly for each drilling crew.
All tests and drills will be recorded in the drilling log.

The accumulator will have sufficient capacity to close all rams and retain 200 psi above pre-charge pressure without the use of closing unit pumps.

Master controls will be at the accumulator. Anticipated bottom hole pressure is 300 psi.

3. **CASING & CEMENTING PROGRAM:**

A. The proposed casing program will be as follows:

TVD	Hole Size	Size	Grade	Weight	Thread	Condition
0-285	12-1/4"	9-5/8"	H-40	32#	STC	New
0-2971	8-3/4"	7"	J-55	23#	LTC	New
0- TD	6-1/4"	5-1/2"*	J-55	15.5 #	LTC	New

The 9-5/8" surface pipe will be tested to 750 psi. All casing strings below the surface shoe shall be pressure tested to 0.22 psi/ft. of casing string length or 1500 psi, whichever is greater, but not to exceed 70% minimum internal yield.

Surface: The bottom three joints of the surface casing will have a minimum of one centralizer per joint and one centralizer every joint thereafter (Total 5 centralizers estimated)

7" Casing: The bottom three joints of the 7" casing will have a minimum of one centralizer per joint and one centralizer every fifth joint thereafter to above Ojo Alamo with turbolizers below and throughout the Ojo Alamo. (Total 12 centralizers, 3 turbolizers estimated).

B. The proposed cementing program will be as follows:

Surface String: 9-5/8" Surface cemented in a 12-1/4" hole at 285'.
32.3# H-40 ST&C 8 Rnd
Saw tooth guide shoe
Cemented with 200 sacks Class B mixed at 15.6 ppg w/.25 pps
Celloflake, 2% calcium chloride. Yeild 1.19 ft3/sx ,cement
Designed to circulate to surface.

Production String: 7" Production casing cemented in an 8-3/4" hole
23# J-55 LT&C 8 Rnd
Float collar
Joint

Float Shoe

Cement with 500 sacks Class B 50/50 POZ, 3% gel, 5# gilsonite, 1/4"# Flocele, .1% CFR 3, .2% Halad 344, yield 1.47 ft³/sx. *

Cement designed to circulate to surface.

Pending hole conditions, cement baskets may be installed above TD

*** Minor variations possible due to existing hole conditions.**

Liner:

5-1/2" liner*

15.5# J-55 LT&C 8 Rnd

Shoe

Not Cemented

* May not be run pending hole conditions.

If well does not respond to proposed to completion, the 5 1/2 " liner will be cemented using class B 50/50 POZ, 3% gel, 5# gilsonite, 1/4"# Flocele, .1% CFR 3, .2% Halad 344, yield 1.47 ft³/sx. **

**** Minor variations possible due to existing hole conditions**

4. DRILLING FLUIDS PROGRAM:

TVD	Type	Weight (ppg)	Viscosity	pH	Water Loss	Remarks
0-285	Spud	8.4-9.0	29-70	8.0	NC	FW gel,
285-2971	LSND	8.4-9.0	29-70	8.0	10-12	LCM as needed
2971- TD	Air					Foam as needed

NC = no control

Sufficient quantities of mud material will be maintained on site or be readily accessible for the purpose of assuring well control. SPR will be recorded on daily drilling report after mudding up. Visual mud monitoring will be conducted during operations.

5. EVALUATION PROGRAM:

Wireline Logs: None

Mud Logs: mud logging in Fruitland Coal.

Survey: Deviation surveys will be taken every 500' from 0-TD of 8 3/4" hole or first succeeding bit change.

Cores: None anticipated.

DST's: None anticipated.

Well Control Equipment
2,000 psi Configuration

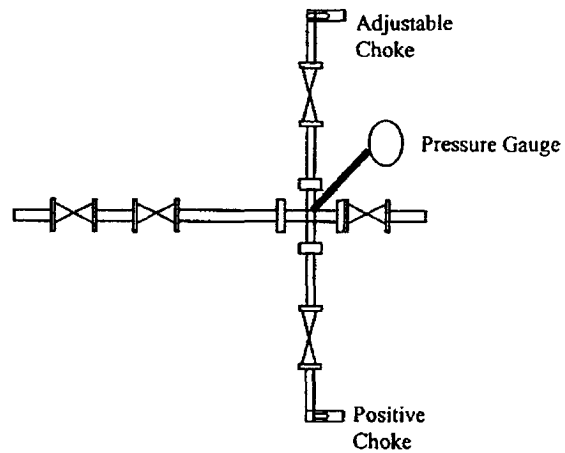
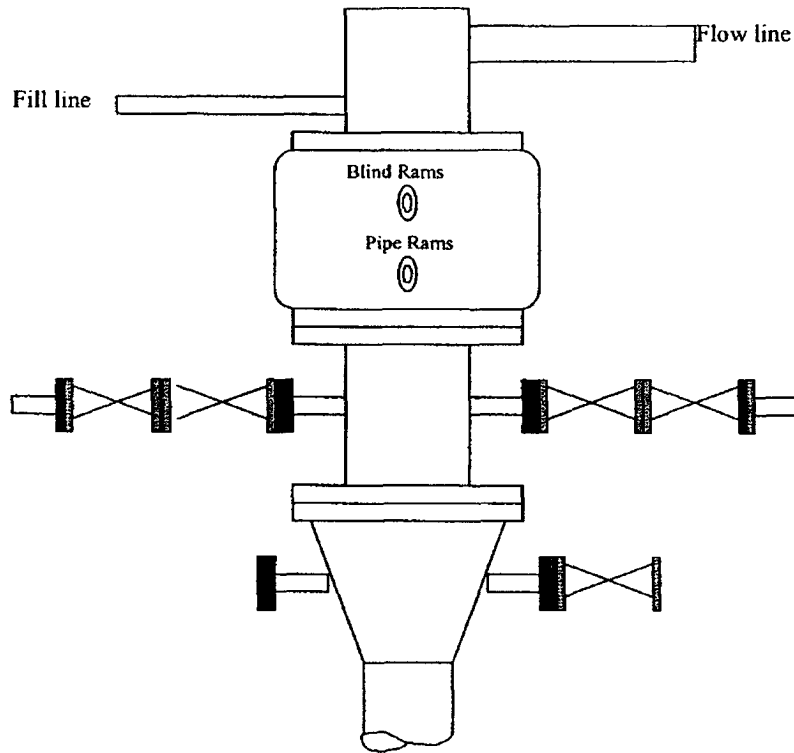

All well control equipment designed to meet or exceed the Onshore Oil and Gas Order No. 2, BLM 43 CFR 3160 requirements for 2M systems.