

UNITED STATES  
DEPARTMENT OF THE INTERIOR  
BUREAU OF LAND MANAGEMENT

APPLICATION FOR PERMIT TO DRILL, DEEPEN, OR PLUG BACK

RECEIVED

1a. Type of Work DRILL	5. Lease Number NMSF-079367
1b. Type of Well GAS	Unit Reporting Number MV-891000950A DK-89100950
2. Operator <b>BURLINGTON</b> RESOURCES OIL & GAS COMPANY, LP	6. If Indian, All. or Tribe
3. Address & Phone No. of Operator PO Box 4289, Farmington, NM 87499 (505) 326-9700	7. Unit Agreement Name San Juan 27-5 Unit
4. Location of Well 1540' FNL, 2000' FWL Latitude 36° 32.0356, Longitude 107° 24.1523	8. Farm or Lease Name San Juan 27-5 Unit
14. Distance in Miles from Nearest Town 48 miles from Blanco	9. Well Number 97N
15. Distance from Proposed Location to Nearest Property or Lease Line 1540'	10. Field, Pool, Wildcat Blanco MV/Basin DK
16. Acres in Lease	11. Sec., Twn, Rge, Mer. (NMPM) F Sec. 31, T-27-N, R-5-W API # 30-039-27757
18. Distance from Proposed Location to Nearest Well, Drlg, Compl, or Applied for on this Lease 1150'	12. County Rio Arriba
19. Proposed Depth 7678'	13. State NM
21. Elevations (DF, FT, GR, Etc.) 6581' GR	17. Acres Assigned to Well 319.08 W/2
23. Proposed Casing and Cementing Program See Operations Plan attached	20. Rotary or Cable Tools Rotary
24. Authorized by: <u>Nancy Oltnans</u> Senior Staff Specialist	22. Approx. Date Work will Start 2-28-04

PERMIT NO.

APPROVAL DATE

APPROVED BY

TITLE

DATE

Archaeological Report attached

Threatened and Endangered Species Report attached

NOTE: This format is issued in lieu of U.S. BLM Form 3160-3

Title 18 U.S.C. Section 1001, makes it a crime for any person knowingly and willfully to make to any department or agency of the United States any false, fictitious or fraudulent statements or presentations as to any matter within its jurisdiction.

NMOCD

DISTRICT I  
1625 N. French Dr., Hobbs, N.M. 88240

State of New Mexico  
Energy, Minerals & Natural Resources Department

Form C-102  
Revised August 15, 2000

DISTRICT II  
811 South First, Artesia, N.M. 88210

DISTRICT III  
1000 Rio Brazos Rd., Aztec, N.M. 87410

DISTRICT IV  
2040 South Pacheco, Santa Fe, NM 87505

OIL CONSERVATION DIVISION  
2040 South Pacheco  
Santa Fe, NM 87505

Submit to Appropriate District Office  
State Lease - 4 Copies  
Fee Lease - 3 Copies

☐ AMENDED REPORT

WELL LOCATION AND ACREAGE DEDICATION PLAT

<sup>1</sup> API Number 30-039- <b>27757</b>	<sup>2</sup> Pool Code 72319/71599	<sup>3</sup> Pool Name Blanco Mesaverde/Basin Dakota
<sup>4</sup> Property Code 7454	<sup>5</sup> Property Name SAN JUAN 27-5 UNIT	<sup>6</sup> Well Number 97N
<sup>7</sup> OGRID No. 14538	<sup>8</sup> Operator Name BURLINGTON RESOURCES OIL AND GAS COMPANY LP	<sup>9</sup> Elevation 6581'

<sup>10</sup> Surface Location

UL or lot no.	Section	Township	Range	Lot Idn	Feet from the	North/South line	Feet from the	East/West line	County
F	31	27-N	5-W		1540'	NORTH	2000'	WEST	RIO ARRIBA

<sup>11</sup> Bottom Hole Location If Different From Surface

UL or lot no.	Section	Township	Range	Lot Idn	Feet from the	North/South line	Feet from the	East/West line	County
<sup>12</sup> Dedicated Acres MV-W/319.08 DK-W/319.08			<sup>13</sup> Joint or Infill		<sup>14</sup> Consolidation Code		<sup>15</sup> Order No.		

NO ALLOWABLE WILL BE ASSIGNED TO THIS COMPLETION UNTIL ALL INTERESTS HAVE BEEN CONSOLIDATED  
OR A NON-STANDARD UNIT HAS BEEN APPROVED BY THE DIVISION

16

FD 3 1/4" S 89-43-37 E B.L.M. BC 2723.29' (M) 1955 LOT 1	1540'	FD 3 1/4" B.L.M. BC 1957
2000'		
LOT 2 USA SF-079367		
31		
FD 3 1/4" B.L.M. BC 1955 LOT 3		
LOT 4		

SEP 2004

RECEIVED

81 Z MAY 18 PM 2:18

070 Farmington, NM

17 OPERATOR CERTIFICATION

I hereby certify that the information contained herein is true and complete to the best of my knowledge and belief

*Nancy Oltmanns*  
Signature  
Nancy Oltmanns  
Printed Name  
Senior Staff Specialist  
Title  
2-24-04  
Date

18 SURVEYOR CERTIFICATION

I hereby certify that the well location shown on this plat was plotted from field notes of actual surveys made by me or under my supervision, and that the same is true and correct to the best of my belief.

9-  
Date of Survey  
Signature and Seal of Professional Surveyor  
14827  
14827  
Certificate Number

Submit 3 Copies To Appropriate District Office.  
District I  
1625 N. French Dr., Hobbs, NM 88240  
District II  
1301 W. Grand Ave., Artesia, NM 88210  
District III  
1000 Rio Brazos Rd., Aztec, NM 87410  
District IV  
1220 S. St. Francis Dr., Santa Fe, NM 87505

State of New Mexico  
Energy, Minerals and Natural Resources

Form C-103  
March 4, 2004

OIL CONSERVATION DIVISION  
1220 South St. Francis Dr.  
Santa Fe, NM 87505

WELL API NO.  
30-039-

5. Indicate Type of Lease  
STATE ☐ FEE ☐

6. State Oil & Gas Lease No.

7. Lease Name or Unit Agreement Name  
San Juan 27-5 Unit

8. Well Number  
97N

9. OGRID Number  
14538

10. Pool name or Wildcat  
Blanco Mesaverde/Basin Dakota

SUNDRY NOTICES AND REPORTS ON WELLS  
(DO NOT USE THIS FORM FOR PROPOSALS TO DRILL OR TO DEEPEN OR PLUG BACK TO A DIFFERENT RESERVOIR. USE "APPLICATION FOR PERMIT" (FORM C-101) FOR SUCH PROPOSALS.)

1. Type of Well:  
Oil Well ☐ Gas Well ☒ Other

2. Name of Operator  
Burlington Resources Oil & Gas Company LP

3. Address of Operator  
3401 E. 30<sup>th</sup> Street, Farmington, NM 87402

4. Well Location

Unit Letter F : 1540 feet from the North line and 2000 feet from the West line

Section 31 Township 27N Range 5W NMPM Rio Arriba County, NM

11. Elevation (Show whether DR, RKB, RT, GR, etc.)

Pit or Below-grade Tank Application (For pit or below-grade tank closures, a form C-144 must be attached)

Pit Location: UL F Sect 31 Twp 27N Rng 5W Pit type New Depth to Groundwater >100' Distance from nearest fresh water well >1000' Distance from nearest surface water >1000' Below-grade Tank Location UL  Sect  Twp  Rng  ;  
feet from the  line and  feet from the  line

12. Check Appropriate Box to Indicate Nature of Notice, Report or Other Data

NOTICE OF INTENTION TO:

PERFORM REMEDIAL WORK ☐ PLUG AND ABANDON ☐

TEMPORARILY ABANDON ☐ CHANGE PLANS ☐

PULL OR ALTER CASING ☐ MULTIPLE COMPLETION ☐

OTHER: New Drill Pit ☒

SUBSEQUENT REPORT OF:

REMEDIAL WORK ☐ ALTERING CASING ☐

COMMENCE DRILLING OPNS. ☐ PLUG AND ABANDONMENT ☐

CASING TEST AND CEMENT JOB ☐

OTHER: ☐

13. Describe proposed or completed operations. (Clearly state all pertinent details, and give pertinent dates, including estimated date of starting any proposed work). SEE RULE 1103. For Multiple Completions: Attach wellbore diagram of proposed completion or recompletion.

Burlington Resources proposes to construct a new drill pit. The new drill pit will be an unlined pit as detailed in Burlington's general pit construction plan dated April 26, 2004 on file at the NMOCD office.

I hereby certify that the information above is true and complete to the best of my knowledge and belief. I further certify that any pit or below-grade tank has been/will be constructed or closed according to NMOCD guidelines ☐ a general permit ☒ or an (attached) alternative OCD-approved plan ☐.

SIGNATURE Cassady Harraden TITLE Regulatory Specialist DATE 5/10/04

Type or print name Cassady Harraden E-mail address: charraden@br-inc.com Telephone No. 326-9700

(This space for State use)

APPROVED BY [Signature] TITLE UNIT OIL & GAS INSPECTOR DATE SEP 20 2004  
Conditions of approval, if any:

BURLINGTON RESOURCES OIL & GAS COMPANY LP  
 SAN JUAN 27-5 UNIT No. 97N, 1540 FNL 2000 FWL  
 SECTION 31, T-27-N, R-5-W, N.M.P.M., RIO ARriba COUNTY, NEW MEXICO  
 GROUND ELEVATION: 6581, DATE: SEPTEMBER 12, 2003

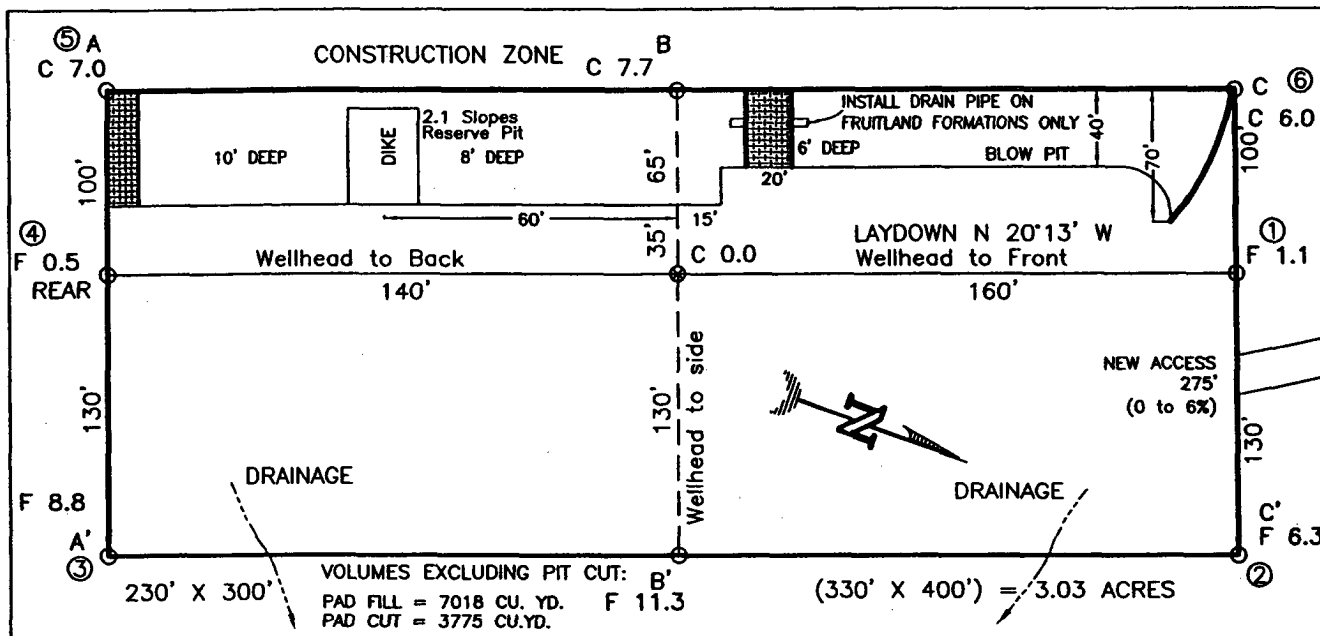

RESERVE PIT DIKE: TO BE 8' ABOVE DEEP SIDE (OVERFLOW - 3' WIDE AND 1' ABOVE SHALLOW SIDE).  
 BLOW PIT: OVERFLOW PIPE HALFWAY BETWEEN TOP AND BOTTOM AND TO EXTEND OVER PLASTIC LINER AND INTO BLOW PIT.

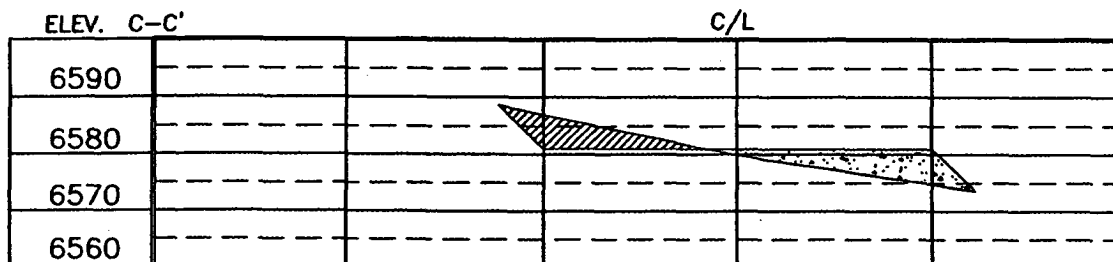
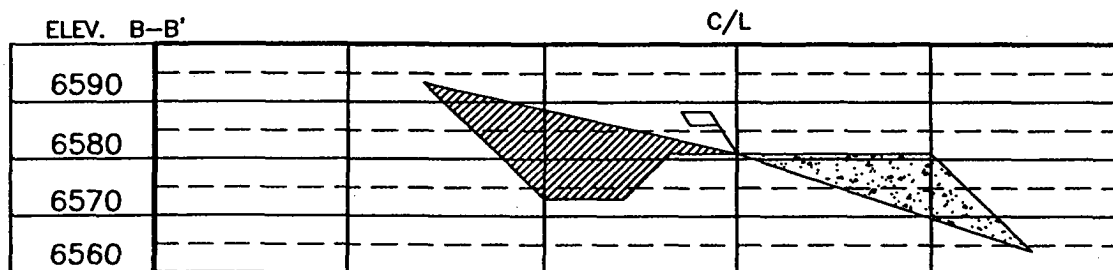
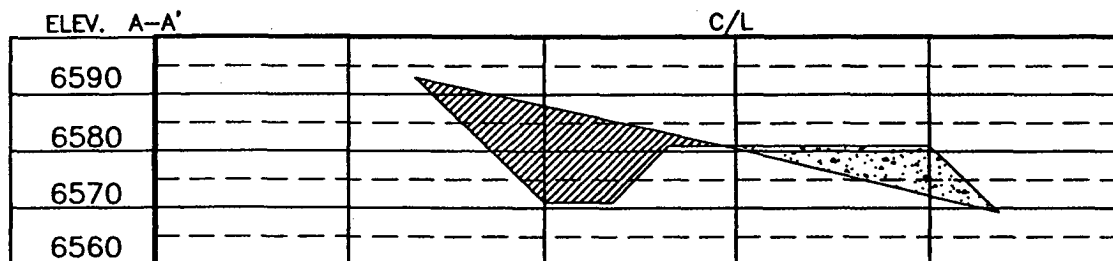

NOTE: CONTRACTOR SHOULD CALL ONE-CALL FOR LOCATION OF ANY MARKED OR UNMARKED BURIED PIPELINES OR CABLES ON WELL PAD AND OR ACCESS ROAD AT LEAST TWO (2) WORKING DAYS PRIOR TO CONSTRUCTION.

DRAWN BY: A.G. ROW#: BR468 CADFILE: BR468CF8 DATE: 09/22/03

Daggett Enterprises, Inc.  
 Surveying and Oil Field Services  
 P. O. Box 15068 Farmington, NM 87401  
 Phone (505) 326-1772 Fax (505) 326-6019

## OPERATIONS PLAN

Well Name: San Juan 27-5 Unit #97N  
Location: 1540' FNL, 2000' FWL, Sec 31, T-27-N, R-5-W  
Rio Arriba County, NM  
Latitude 36° 32.0356, Longitude 107° 24.1523  
Formation: Blanco Mesaverde/Basin Dakota

Total Depth: 7678'

Logging Program: See San Juan 27-5 Unit Master Operations Plan

Mud Program: See San Juan 27-5 Unit Master Operations Plan

Casing Program (as listed, the equivalent, or better):

<u>Hole Size</u>	<u>Depth Interval</u>	<u>Csg. Size</u>	<u>Wt.</u>	<u>Grade</u>	<u>Cement</u>
12 1/4"	0' - 120'	9 5/8"	32.3#	H-40	113 cu.ft.
8 3/4"	0' - 3428'	7"	20.0#	J-55	767 cu.ft.
6 1/4"	0' - 7678'	4 1/2"	10.5#	J-55	579 cu.ft.

Tubing Program: See San Juan 27-5 Unit Master Operations Plan

- The Mesaverde and Dakota formations will be completed and commingled.
- The west half of Section 31 is dedicated to the Mesaverde and the Dakota formations in this well.
- Gas is dedicated.

Sean Corrigan  
Drilling Engineer

February 25, 2004  
Date

**MULTI-POINT SURFACE USE PLAN**

**San Juan 27-5 Unit #97N**

**See San Juan 27-5 Unit Master Multi-point Surface Use Plan**

- Anticipated pipeline facilities as shown on the attached plat from Williams Field Services.
- Approximately 275' of new road will be built.
- Candelaria Water Hole located SE/4 Section 29, T-27-N, R-5-W, New Mexico.
- Surface Ownership: Bureau of Land Management
- Slope will be build at a 3 to 1 slope.
- Build a diversion ditch between corner #5 and #6 above the cut slope.
- Install a culvert where access enters pad.
- Archaeological Resources: See Archaeological Survey technical report #2003-SJC-205 from San Juan College.

Nancy Ottmanns  
Senior Staff Specialist

5-18-04  
Date