

UNITED STATES  
DEPARTMENT OF THE INTERIOR  
BUREAU OF LAND MANAGEMENT

FORM APPROVED  
OMB NO. 1004-0135  
Expires: November 30, 2000

**SUNDRY NOTICES AND REPORTS ON WELLS**  
**Do not use this form for proposals to drill or to re-enter an abandoned well. Use form 3160-3 (APD) for such proposals.**

5. Lease Serial No.  
NMSF075794

6. If Indian, Allottee or Tribe Name

**SUBMIT IN TRIPLICATE - Other instructions on reverse side.**

7. If Unit or CA/Agreement, Name and/or No.  
NNNM75845

1. Type of Well  
☐ Oil Well ☒ Gas Well ☐ Other

8. Well Name and No.  
OHIO AZTEC B 1

2. Name of Operator  
XTO ENERGY INC  
Contact: HOLLY PERKINS  
E-Mail: Regulatory@xtoenergy.com

9. API Well No.  
30-045-21516-00-D1

3a. Address  
2700 FARMINGTON AVE., BLDG K, SUITE 1  
FARMINGTON, NM 87401

3b. Phone No. (include area code)  
Ph: 505.324.1090 Ext: 4020  
Fx: 505.564.6700

10. Field and Pool, or Exploratory  
FULCHER KUTZ PC  
KUTZ FRUITLAND SAND

4. Location of Well (Footage, Sec., T., R., M., or Survey Description)

Sec 23 T28N R11W NENW 1060FNL 1890FWL  
36.65202 N Lat, 107.97517 W Lon

11. County or Parish, and State

SAN JUAN COUNTY, NM

**12. CHECK APPROPRIATE BOX(ES) TO INDICATE NATURE OF NOTICE, REPORT, OR OTHER DATA**

TYPE OF SUBMISSION	TYPE OF ACTION			
<input checked="" type="checkbox"/> Notice of Intent	<input type="checkbox"/> Acidize	<input type="checkbox"/> Deepen	<input type="checkbox"/> Production (Start/Resume)	<input type="checkbox"/> Water Shut-Off
<input type="checkbox"/> Subsequent Report	<input type="checkbox"/> Alter Casing	<input type="checkbox"/> Fracture Treat	<input type="checkbox"/> Reclamation	<input type="checkbox"/> Well Integrity
<input type="checkbox"/> Final Abandonment Notice	<input type="checkbox"/> Casing Repair	<input type="checkbox"/> New Construction	<input type="checkbox"/> Recomplete	<input checked="" type="checkbox"/> Other
	<input type="checkbox"/> Change Plans	<input type="checkbox"/> Plug and Abandon	<input type="checkbox"/> Temporarily Abandon	Subsurface Commingling
	<input type="checkbox"/> Convert to Injection	<input type="checkbox"/> Plug Back	<input type="checkbox"/> Water Disposal	

13. Describe Proposed or Completed Operation (clearly state all pertinent details, including estimated starting date of any proposed work and approximate duration thereof. If the proposal is to deepen directionally or recompleat horizontally, give subsurface locations and measured and true vertical depths of all pertinent markers and zones. Attach the Bond under which the work will be performed or provide the Bond No. on file with BLM/BIA. Required subsequent reports shall be filed within 30 days following completion of the involved operations. If the operation results in a multiple completion or recompleat in a new interval, a Form 3160-4 shall be filed once testing has been completed. Final Abandonment Notices shall be filed only after all requirements, including reclamation, have been completed, and the operator has determined that the site is ready for final inspection.)

XTO Energy Inc. requests permission to downhole commingling this well per the attached documents.

**CONDITIONS OF APPROVAL**  
Adhere to previously issued stipulations.

DHC 3148

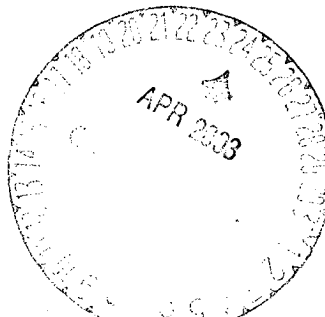

14. I hereby certify that the foregoing is true and correct.

Electronic Submission #20640 verified by the BLM Well Information System  
For XTO ENERGY INC, sent to the Farmington  
Committed to AFMSS for processing by Matthew Halbert on 04/22/2003 (03MXH0714SE)

Name (Printed/Typed) DARRIN STEED

Title REGULATORY SUPERVISOR

Signature (Electronic Submission)

Date 04/15/2003

**THIS SPACE FOR FEDERAL OR STATE OFFICE USE**

Approved By /s/ Jim Lovato

Title

Date APR 22 2003

Conditions of approval, if any, are attached. Approval of this notice does not warrant or certify that the applicant holds legal or equitable title to those rights in the subject lease which would entitle the applicant to conduct operations thereon.

Office

Title 18 U.S.C. Section 1001 and Title 43 U.S.C. Section 1212, make it a crime for any person knowingly and willfully to make to any department or agency of the United States any false, fictitious or fraudulent statements or representations as to any matter within its jurisdiction.

District I  
1625 N. French Drive, Hobbs, NM 88240

District II  
1301 W. Grand Avenue, Artesia, NM 88210

District III  
1009 Rio Brazos Road, Aztec, NM 87410

District IV  
1220 S. St. Francis Dr., Santa Fe, NM 87505

State of New Mexico  
Energy, Minerals and Natural Resources Department

Oil Conservation Division  
1220 South St. Francis Dr.  
Santa Fe, New Mexico 87505

Form C-107A  
Revised May 15, 2000

APPLICATION TYPE  
☒ Single Well  
Establish Pre-Approved Pools  
EXISTING WELLBORE  
☒ Yes ☐ No

APPLICATION FOR DOWNHOLE COMMINGLING

XTO Energy Inc. 2700 Farmington Ave., Bldg. K, Ste 1, Farmington, NM 87401  
Operator Address

Ohlo B Aztec 1 C-23-T28N-R11W San Juan  
Lease Well No. Unit Letter-Section-Township-Range County

OGRID No. 167067 Property Code API No. 30-045-21516 Lease Type: ☒ Federal ☐ State ☐ Fee

DATA ELEMENT	UPPER ZONE	INTERMEDIATE ZONE	LOWER ZONE
Pool Name	Kutz Fruitland Sand		Fulcher-Kutz Pictured Cliffs
Pool Code	79600		77200
Top and Bottom of Pay Section (Perforated or Open-Hole Interval)	1,399' - 1,496' (Perforated)		1,696' - 1,726' (Perforated)
Method of Production (Flowing or Artificial Lift)	Flowing		Flowing
Bottomhole Pressure (Note: Pressure data will not be required if the bottom perforation in the lower zone is within 150% of the depth of the top perforation in the upper zone)	NA		NA
Oil Gravity or Gas BTU (Degree API or Gas BTU)	1194 BTU		1162 BTU
Producing, Shut-In or New Zone	Producing		Producing
Date and Oil/Gas/Water Rates of Last Production. (Note: For new zones with no production history, applicant shall be required to attach production estimates and supporting data.)	Date: Jan - Nov 2002 Rates: 0 BOPD 0 BWPD 87 MCFPD	Date: Rates:	Date: Jan - Nov 2002 Rates: 0 BOPD 0.2 BWPD 61 MCFPD
Fixed Allocation Percentage (Note: If allocation is based upon something other than current or past production, supporting data or explanation will be required.)	Oil Water Gas 0 % 0 % 61 %	Oil Water Gas % % %	Oil Water Gas 0 % 100 % 39 %

ADDITIONAL DATA

Are all working, royalty and overriding royalty interests identical in all commingled zones?  
If not, have all working, royalty and overriding royalty interest owners been notified by certified mail? Yes ☒ No ☐  
Yes ☐ No ☐

Are all produced fluids from all commingled zones compatible with each other? Yes ☒ No ☐

Will commingling decrease the value of production? Yes ☐ No ☒

If this well is on, or communitized with, state or federal lands, has either the Commissioner of Public Lands or the United States Bureau of Land Management been notified in writing of this application? Yes ☒ No ☐

NMOCD Reference Case No. applicable to this well:

Attachments:

- C-102 for each zone to be commingled showing its spacing unit and acreage dedication.
- Production curve for each zone for at least one year. (If not available, attach explanation.)
- For zones with no production history, estimated production rates and supporting data.
- Data to support allocation method or formula.
- Notification list of working, royalty and overriding royalty interests for uncommon interest cases.
- Any additional statements, data or documents required to support commingling.

PRE-APPROVED POOLS

If application is to establish Pre-Approved Pools, the following additional information will be required:

- List of other orders approving downhole commingling within the proposed Pre-Approved Pools
- List of all operators within the proposed Pre-Approved Pools
- Proof that all operators within the proposed Pre-Approved Pools were provided notice of this application.
- Bottomhole pressure data.

I hereby certify that the information above is true and complete to the best of my knowledge and belief.

SIGNATURE Darrin Steed TITLE Regulatory Supervisor DATE April 15, 2003

TYPE OR PRINT NAME Darrin Steed TELEPHONE NO. ( 505 ) 324-1090

# WELL LOCATION AND ACREAGE DEDICATION PLAT

Supersedes C-128  
Effective 1-1-65

All distances must be from the outer boundaries of the Section.

Operator <b>MARATHON OIL COMPANY</b>			Lease <b>Ohio "B" Aztec</b>		Well No. <b>1</b>
Unit Letter <b>C</b>	Section <b>23</b>	Township <b>28 North</b>	Range <b>11 West</b>	County <b>San Juan</b>	
Actual Footage Location of Well: <b>1060</b> feet from the <b>North</b> line and <b>1890</b> feet from the <b>West</b> line					
Ground Level Elev. <b>5707</b>	Producing Formation <b>Pictured Cliffs Sand</b>		Pool <b>Kutz Pictured Cliffs</b>	Dedicated Acreage: <b>160</b> Acres	

1. Outline the acreage dedicated to the subject well by colored pencil or hatchure marks on the plat below.
2. If more than one lease is dedicated to the well, outline each and identify the ownership thereof (both as to working interest and royalty).
3. If more than one lease of different ownership is dedicated to the well, have the interests of all owners been consolidated by communitization, unitization, force-pooling, etc?

☒ Yes ☐ No If answer is "yes," type of consolidation Communitization

If answer is "no," list the owners and tract descriptions which have actually been consolidated. (Use reverse side of this form if necessary.)

No allowable will be assigned to the well until all interests have been consolidated (by communitization, unitization, forced-pooling, or otherwise) or until a non-standard unit, eliminating such interests, has been approved by the Commission.

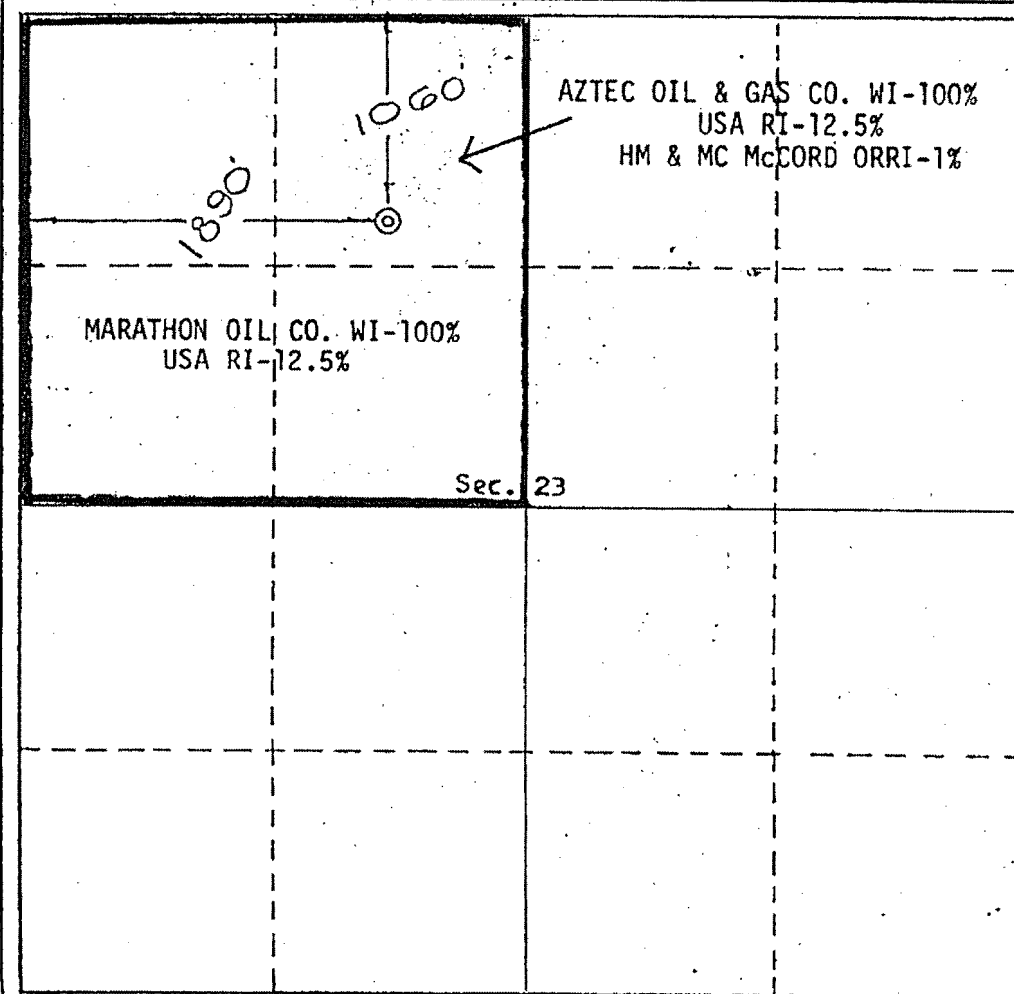

## CERTIFICATION

I hereby certify that the information contained herein is true and complete to the best of my knowledge and belief.

*Carl M. Morris*

Name

**Carl M. Morris**

Position

**District Operations Manager**

Company

**Marathon Oil Company**

Date

**6-12-74**

STATE OF NEW MEXICO  
I hereby certify that the well location shown on this plat was plotted from field notes of a registered survey made by me or under my supervision, and that the same is true and correct to the best of my knowledge and belief.  
No. 3602  
REGISTERED LAND SURVEYOR

Date Surveyed

**May 17, 1974**

Registered Professional Engineer and/or Land Surveyor

*E.V. Echolaw*

Certificate No. 3602

**E.V. Echolaw LS**

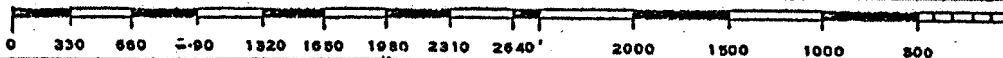

# LOCATION AND ACREAGE DEDICATION PLAT

Supersedes C-12  
Effective 1-1-65

distances must be from the outer boundaries of the section.

Operator: <b>MARATHON OIL COMPANY</b>		Lease <b>Ohio "B" Aztec</b>		Well No. <b>1</b>
Unit Letter <b>C</b>	Section <b>23</b>	Township <b>28 North</b>	Range <b>11 West</b>	County <b>San Juan</b>

Actual Footage Location of Well:

<b>1060</b>	feet from the	<b>North</b>	line and	<b>1890</b>	feet from the	<b>West</b>	line	
Ground Level Elev. <b>5707</b>	Producing Formation <b>Fruitland Sand</b>		Pool <b>Kutz Fruitland</b>		Dedicated Acreage: <b>160</b>			Acres

1. Outline the acreage dedicated to the subject well by colored pencil or hatchure marks on the plat below.
2. If more than one lease is dedicated to the well, outline each and identify the ownership thereof (both as to working interest and royalty).
3. If more than one lease of different ownership is dedicated to the well, have the interests of all owners been consolidated by communitization, unitization, force-pooling, etc?

☒ Yes ☐ No If answer is "yes," type of consolidation Communitization

If answer is "no," list the owners and tract descriptions which have actually been consolidated. (Use reverse side of this form if necessary.)

No allowable will be assigned to the well until all interests have been consolidated (by communitization, unitization, forced-pooling, or otherwise) or until a non-standard unit, eliminating such interests, has been approved by the Commission.

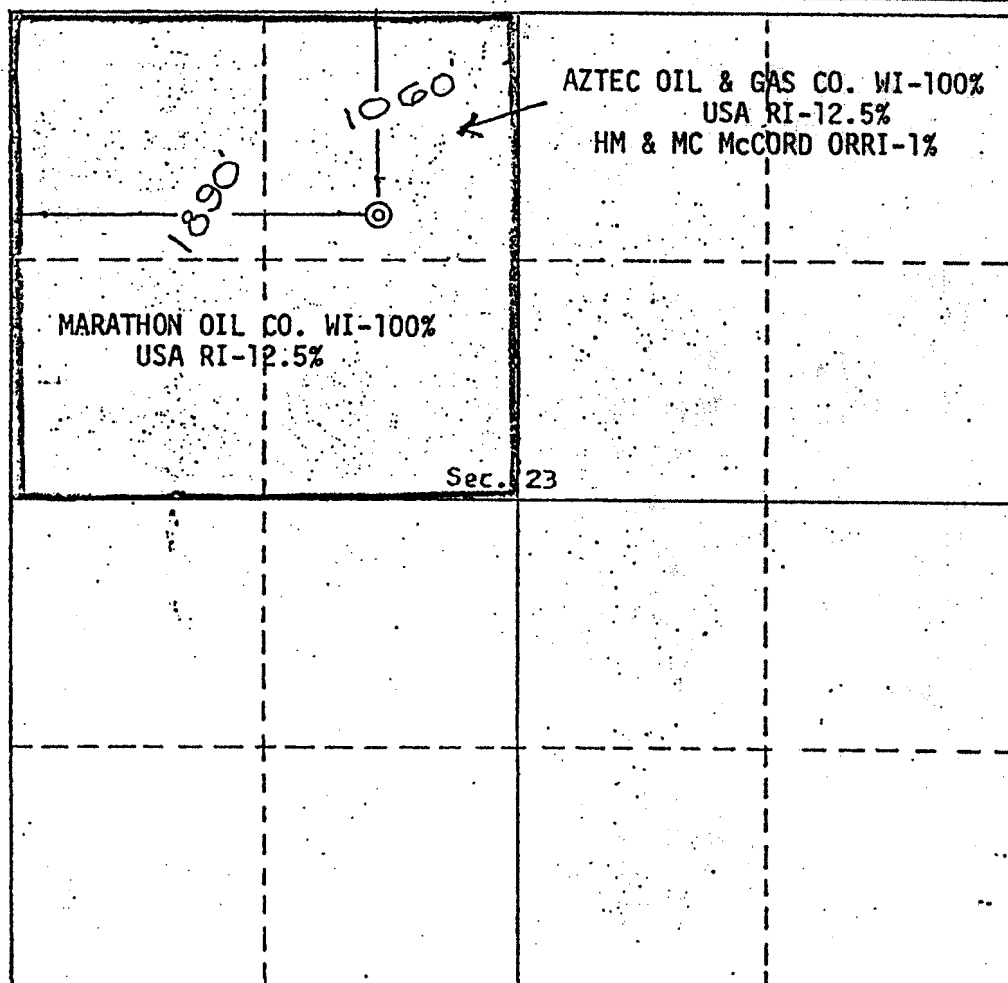

## CERTIFICATION

I hereby certify that the information contained herein is true and complete to the best of my knowledge and belief.

*Carl M. Morris*

Name  
**Carl M. Morris**  
Position  
**District Operations Manager**  
Company  
**Marathon Oil Company**  
Date  
**6-12-74**

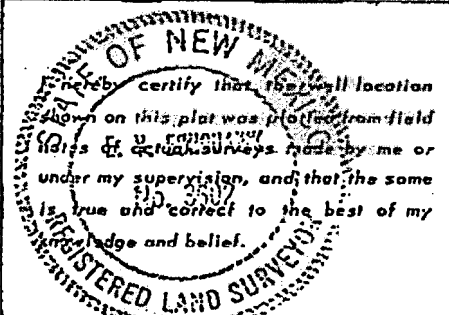

Date Surveyed  
**May 17, 1974**  
Registered Professional Engineer and/or Land Surveyor  
*E.V. Ech Hawk*  
Certificate No. **3602**  
**E.V. Ech Hawk LS**

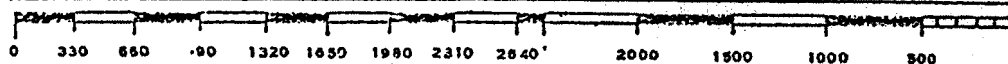

Well: OHIO B AZTEC No.: 1  
 Operator: XTO ENERGY, INC. API: 3004521516  
 Township: 28.0N Range: 11W  
 Section: 23 Unit: C  
 Land Type: F County: San Juan  
 Total Acres: 320  
 Number of: 2

Accumulated:  
 Oil: 0 (BBLs) Gas: 1540567 (MCF)  
 Water: 452 (BBLs) Days Prod: 11661 (Days)

Year: 1999

Pool Name FULCHER KUTZ PICTURED CLIFFS (GAS)

Month	Oil(BBLS)	Gas(MCF)	Water(BBL)	Days Prod	Accum. Oil	Accum. Gas(MCF)
January	0	2668	0	31	0	2668
February	0	3477	0	28	0	6145
March	0	3971	0	31	0	10116
April	0	3862	0	30	0	13978
May	0	3988	0	31	0	17966
June	0	3215	0	30	0	21181
July	0	3763	0	31	0	24944
August	0	4243	0	31	0	29187
September	0	2684	0	30	0	31871
October	0	2854	0	31	0	34725
November	0	2948	0	30	0	37673
December	0	2855	31	31	0	40528
Total	0	40528	31	365		

Pool Name: KUTZ FRUITLAND SAND (GAS)

Month	Oil(BBLS)	Gas(MCF)	Water(BBL)	Days Prod	Accum. Oil	Accum. Gas(MCF)
January	0	2574	0	31	0	43102
February	0	3293	0	28	0	46395
March	0	3365	0	31	0	49760
April	0	3069	15	30	0	52829
May	0	3557	16	31	0	56386
June	0	2826	15	30	0	59212
July	0	3405	16	31	0	62617
August	0	3858	16	31	0	66475
September	0	3488	15	30	0	69963
October	0	3318	16	31	0	73281
November	0	3245	15	30	0	76526
December	0	3388	47	31	0	79914
Total	0	39386	171	365		

Year: 2000

Pool Name FULCHER KUTZ PICTURED CLIFFS (GAS)

Month	Oil(BBLS)	Gas(MCF)	Water(BBL)	Days Prod	Accum. Oil	Accum. Gas(MCF)
January	0	2013	0	31	0	81927
February	0	2545	0	29	0	84472
March	0	2194	0	31	0	86666
April	0	1594	0	30	0	88260
May	0	1846	0	31	0	90106

June	0	1512	0	30	0	91618
July	0	1456	0	31	0	93074
August	0	1708	0	31	0	94782
September	0	1511	0	30	0	96293
October	0	1586	0	31	0	97879
November	0	1860	0	30	0	99739
December	0	1981	9	31	0	101720
Total	0	21806	9	366		

Pool Name: KUTZ FRUITLAND SAND (GAS)

Month	Oil(BBLS)	Gas(MCF)	Water(BBL)	Days Prod	Accum. Oil	Accum. Gas(MCF)
January	0	2985	0	31	0	104705
February	0	2981	0	29	0	107686
March	0	3401	0	31	0	111087
April	0	3203	0	30	0	114290
May	0	3210	0	31	0	117500
June	0	3244	0	30	0	120744
July	0	3313	0	31	0	124057
August	0	3184	0	31	0	127241
September	0	3131	0	30	0	130372
October	0	3180	0	31	0	133552
November	0	3229	0	30	0	136781
December	0	3032	0	31	0	139813
Total	0	38093	0	366		

Year: 2001

Pool Name FULCHER KUTZ PICTURED CLIFFS (GAS)

Month	Oil(BBLS)	Gas(MCF)	Water(BBL)	Days Prod	Accum. Oil	Accum. Gas(MCF)
January	0	1968	9	31	0	141781
February	0	1898	8	28	0	143679
March	0	1850	9	31	0	145529
April	0	2250	9	30	0	147779
May	0	1877	9	31	0	149656
June	0	2044	8	27	0	151700
July	0	2173	9	31	0	153873
August	0	2100	9	31	0	155973
September	0	2044	9	30	0	158017
October	0	1624	9	31	0	159641
November	0	1617	9	30	0	161258
December	0	1806	9	31	0	163064
Total	0	23251	106	362		

Pool Name: KUTZ FRUITLAND SAND (GAS)

Month	Oil(BBLS)	Gas(MCF)	Water(BBL)	Days Prod	Accum. Oil	Accum. Gas(MCF)
January	0	2984	0	31	0	166048
February	0	2524	0	28	0	168572
March	0	3200	0	31	0	171772
April	0	2861	0	30	0	174633
May	0	2911	0	31	0	177544
June	0	2611	0	28	0	180155
July	0	2995	0	31	0	183150
August	0	2988	0	31	0	186138
September	0	2808	0	30	0	188946
October	0	2899	0	31	0	191845

November	0	2796	0	30	0	194641
December	0	2799	0	31	0	197440
Total	0	34376	0	363		

Year: 2002

Pool Name FULCHER KUTZ PICTURED CLIFFS (GAS)

Month	Oil(BBLS)	Gas(MCF)	Water(BBL)	Days Prod	Accum. Oil	Accum. Gas(MCF)
January	0	1646	9	31	0	199086
February	0	1594	8	28	0	200680
March	0	1531	9	31	0	202211
April	0	1125	9	30	0	203336
May	0	1529	9	31	0	204865
June	0	1726	9	30	0	206591
July	0	1926	0	31	0	208517
August	0	2258	0	18	0	210775
September	0	1978	0	27	0	212753
October	0	2186	0	31	0	214939
November	0	1799	0	30	0	216738
December	0	0	0	0	0	216738
Total	0	19298	53	318		

Pool Name: KUTZ FRUITLAND SAND (GAS)

Month	Oil(BBLS)	Gas(MCF)	Water(BBL)	Days Prod	Accum. Oil	Accum. Gas(MCF)
January	0	2610	0	31	0	219348
February	0	2259	0	28	0	221607
March	0	2596	0	31	0	224203
April	0	2458	0	30	0	226661
May	0	2535	0	31	0	229196
June	0	2666	0	30	0	231862
July	0	2572	0	31	0	234434
August	0	2651	0	18	0	237085
September	0	2393	0	27	0	239478
October	0	2566	0	31	0	242044
November	0	2362	0	30	0	244406
Total	0	27668	0	318		

Gas Allocation

$$F S = \left[ \frac{27668}{27668 + 19298} \right] = 58.91 \% \quad 2002$$

$$F S = \left[ \frac{34376}{34376 + 23251} \right] = 59.65 \% \quad 2001$$

$$F S = \left[ \frac{38093}{38093 + 21806} \right] = 63.60 \% \quad 2000$$

$$\bar{X} = 60.72\% \Rightarrow 61\% \text{ for Kutz Fruitland Sand}$$

39% for Fulcher Kutz Pictured Cliffs