

UNITED STATES
DEPARTMENT OF THE INTERIOR
BUREAU OF LAND MANAGEMENT

2004 MAY 28 AM 9:56

FORM APPROVED
OMB No. 1004-0136
Expires November 30, 2000

APPLICATION FOR PERMIT TO DRILL OR REENTER

1a. Type of Work: ☒ DRILL ☐ REENTER

b. Type of Well: ☐ Oil Well ☒ Gas Well ☐ Other ☒ Single Zone ☐ Multiple Zone

2. Name of Operator

Kukui Operating Company

3a. Address

c/o Walsh Engineering, 7415 E. Main, Farmington, NM 87402

3b. Phone No. (include area code)

(505) 327-4892

4. Location of Well (Report location clearly and in accordance with any State requirements. *)

At surface 2600' FSL and 1975' FEL

At proposed prod. Zone 3200 660

14. Distance in miles and direction from nearest town or post office*

10 miles southeast of Bloomfield, NM

15. Distance from proposed* location to nearest property or lease line, ft. (Also to nearest drig. unit line, if any)

660'

16. No. of Acres in lease

320+

17. Spacing Unit dedicated to this well

320 acres E/2

18. Distance from proposed location* to nearest well, drilling, completed, applied for, on this lease, ft.

1400'

19. Proposed Depth

1990' +/-

20. BLM/BIA Bond No. on file

21. Elevations (Show whether DF, KDB, RT, GL, etc.)

6028' GL

22. Approximate date work will start*

July 15, 2004

23. Estimated duration

1 week

24. Attachments

The following, completed in accordance with the requirements of Onshore Oil and Gas Order No. 1, shall be attached to this form:

- Well plat certified by a registered surveyor.
- A Drilling Plan.
- A Surface Use Plan (if the location is on National Forest System Lands, the SUPO shall be filed with the appropriate Forest Service Office.
- Bond to cover the operations unless covered by an existing bond on file (see Item 20 above).
- Operator certification.
- Such other site specific information and/or plans as may be required by the authorized office.

25. Signature *Robert J. Voorhees*

Name (Printed/Typed) Robert J. Voorhees

Date 5/29/04

Title Vice President of Engineering and Development

Approved by (Signature) *Wayne Townsend*

Name (Printed/Typed) Wayne Townsend

Date 10/26/07

Title Acting AFM

Office FFO

Application approval does not warrant or certify that the applicant holds legal or equitable title to those rights in the subject lease which would entitle the applicant to conduct operations thereon.

Conditions of approval, if any, are attached.

Title 18 U.S.C. Section 1001 and Title 43 U.S.C. Section 1212, make it a crime for any person knowingly and willfully to make to any department or agency of the United States any false, fictitious or fraudulent statements or representations as to any matter within its jurisdiction.

*(Instructions on reverse)

District I
PO Box 1980, Hobbs, NM 88241-1980

District II
PO Drawer 00, Artesia, NM 88211-0719

District III
1000 Rio Brazos Rd., Aztec, NM 87410

District IV
PO Box 2088, Santa Fe, NM 87504-2088

State of New Mexico
Energy, Minerals & Natural Resources Department

OIL CONSERVATION DIVISION
PO Box 2088
Santa Fe, NM 87504-2088

Form C-102
Revised February 21, 1994
Instructions on back
Submit to Appropriate District Office
State Lease - 4 Copies
Fee Lease - 3 Copies

☐ AMENDED REPORT

WELL LOCATION AND ACREAGE DEDICATION PLAT

*API Number 30-045-32387		*Pool Code 71629	*Pool Name BASIN FRUITLAND COAL
*Property Code 32690	*Property Name ANGEL PEAK 16		*Well Number 19S
*GRID No. 149678	*Operator Name KUKUI OPERATING COMPANY		*Elevation 6067'

¹⁰ Surface Location

UL or lot no.	Section	Township	Range	Lot Idh	Feet from the	North/South line	Feet from the	East/West line	County
I	16	27N	10W		2200	SOUTH	660	EAST	SAN JUAN

¹¹ Bottom Hole Location If Different From Surface

UL or lot no.	Section	Township	Range	Lot Idh	Feet from the	North/South line	Feet from the	East/West line	County
¹² Dedicated Acres 320.0 Acres - (E/2)					¹³ Joint or Infill		¹⁴ Consolidation Code		¹⁵ Order No.

NO ALLOWABLE WILL BE ASSIGNED TO THIS COMPLETION UNTIL ALL INTERESTS HAVE BEEN CONSOLIDATED
OR A NON-STANDARD UNIT HAS BEEN APPROVED BY THE DIVISION

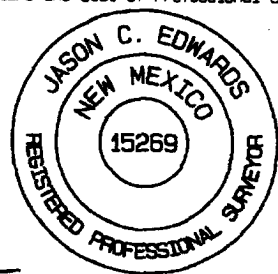
<div>16</div> <div>5282.64'</div> <div>SF-077382</div> <div>16</div> <div>5280.00'</div> <div>5266.80'</div> <div>2200'</div> <div>660'</div> <div>5280.00'</div>	<div>¹⁷ OPERATOR CERTIFICATION I hereby certify that the information contained herein is true and complete to the best of my knowledge and belief. <i>Paul C. Thompson</i> Signature Paul C. Thompson Printed Name Agent Title 11/04/04 Date</div> <div>¹⁸ SURVEYOR CERTIFICATION I hereby certify that the well location shown on this plat was plotted from field notes of actual surveys made by me or under my supervision, and that the same is true and correct to the best of my belief. Revised: SEPTEMBER 22, 2004 Date of Survey: APRIL 7, 2004 Signature and Seal of Professional Surveyor  <i>JASON C. EDWARDS</i> Certificate Number 15269</div>
---	--

PLAT #2

LATITUDE: 36°34'30"
LONGITUDE: 107°53'53"
DATUM: NAD1927

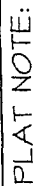

SURFACE OWNER
Bureau of Land
Management

C-C'						
6038'						
6028'	<hr/>					
6018'						

Note: Contractor should call One-Call for location of any marked or unmarked buried pipelines or cables on well pad and/or access road at least two (2) working days prior to construction

March, 2003
John Thompson

Plat #3

Location Diagram

Location Dimensions 150' X 105'

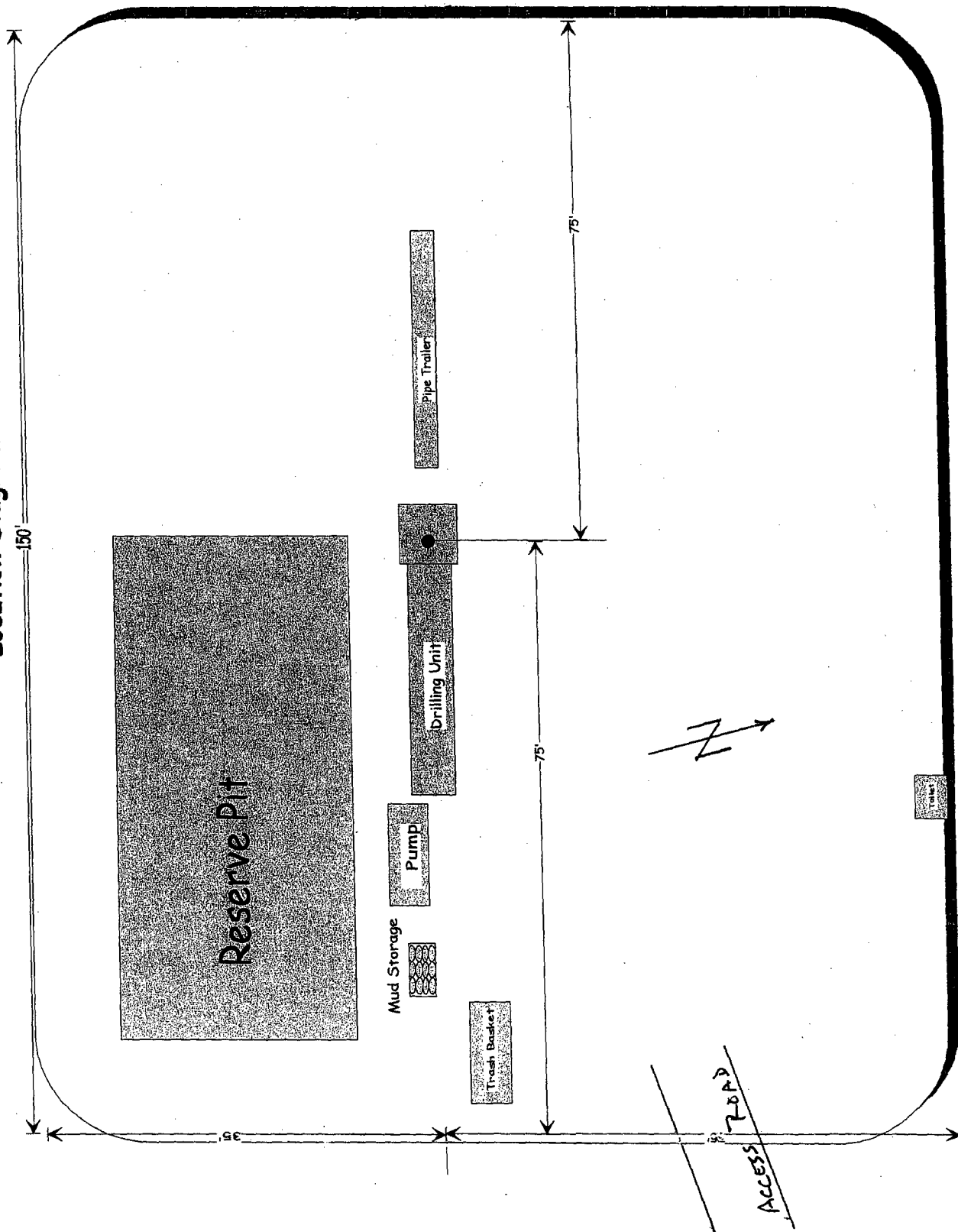

Kukui Operating Company
Typical Location Layout

Kukui Operating Company
OPERATIONS PLAN
Angel Peak 16 #19S

I. Location: 2600' FSL & 1975' FEL
Sec 5 T27N R10W
San Juan County, NM

Date: May 11, 2004

Field: Basin Fruitland Coal
Surface: BLM
Minerals: SF - 077382

Elev: GL 6028'

II. Geology: Surface formation _ Nacimiento

A. Formation Tops	Depths
Ojo Alamo	1220'
Kirtland	1300'
Fruitland Coal	1640'
Pictured Cliffs	1792'
Total Depth	1990'

Estimated depths of anticipated water, oil, gas, and other mineral bearing formations which are expected to be encountered:

Water and gas - 1640' and 1792'.

B. Logging Program: Induction/GR and neutron/density logs at TD.

C. No over pressured zones are expected in this well. No H₂S zones will be penetrated in this well. Max. BHP = 500 psig.

III. Drilling

A. Contractor:

B. Mud Program:

The surface hole will be drilled with a fresh water mud.

The production hole will be drilled with a fresh water polymer mud. The weighting material will be drill solids or if conditions dictate, barite. The maximum mud weight expected is 8.5 ppg.

C. Minimum Blowout Control Specifications:

Double ram type or annular type 2000 psi working pressure BOP with a rotating head. See the attached exhibits (#1 and #2) for details on the BOP equipment. All ram type preventers and related equipment will be hydraulically tested at nipple-up and after any use under pressure to 600 psi.

C. Cont.

The blind rams will be hydraulically activated and checked for operational readiness each time pipe is pulled out of the hole. All checks of the BOP stack and equipment will be noted on the daily drilling report. The BOP equipment will include a floor safety valve and choke manifold all rated to 2000 psi. The length of the Kelly does not allow enough room for a Kelly cock.

IV. Materials

A. Casing Program:

Hole Size	Depth	Casing Size	Wt. & Grade
8-3/4"	120'	7"	20# K-55
6-1/4"	1990'	4-1/2"	10.5# K-55

B. Float Equipment:

a) Surface Casing: None

b) Production Casing: 4-1/2" cement guide shoe and self fill insert float collar. Place float one joint above shoe. Five centralizers spaced every other joint above shoe and five turbolizers every fifth joint from the top of the well.

V. Cementing:

Surface casing: 7" - Use 30 sx (36 cu. ft.) of Cl "B" with 2% CaCl_2 (Yield = 1.18 cu. ft./sk; slurry weight = 15.6 PPG). 100% excess to circulate cement to surface. WOC 12 hours. Pressure test surface casing to 600 psi for 30 min.

Production Casing: 4-1/2" - Before cementing circulate hole with at least 1-1/2 hole volumes of mud. Precede cement with 30 bbls of fresh water. Lead with 145 sx (299 cu.ft) of Cl "B" with 2% SMS, 1/4#/sk. celloflake. (Yield = 2.06 cu.ft./sk; slurry weight = 12.5 PPG). Tail with 100 sx (118 cu.ft.) of Cl "B" with 2% CaCl_2 , and 1/4#/sk. celloflake/sk. (Yield = 1.18 cu. ft./sk; slurry weight = 15.6 PPG) Total cement volume is 417 cu.ft. (100% excess to circulate cement to surface).

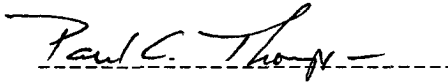

Paul C. Thompson, P.E.

Kukui Operating Company

Well Control Equipment Schematic for 2M Service

Attachment to Drilling Technical Program

Typical BOP setup

EXHIBIT #1

Location: San Juan Basin, New Mexico

Date: August 20, 2001

By: John Thompson (Walsh E&P)

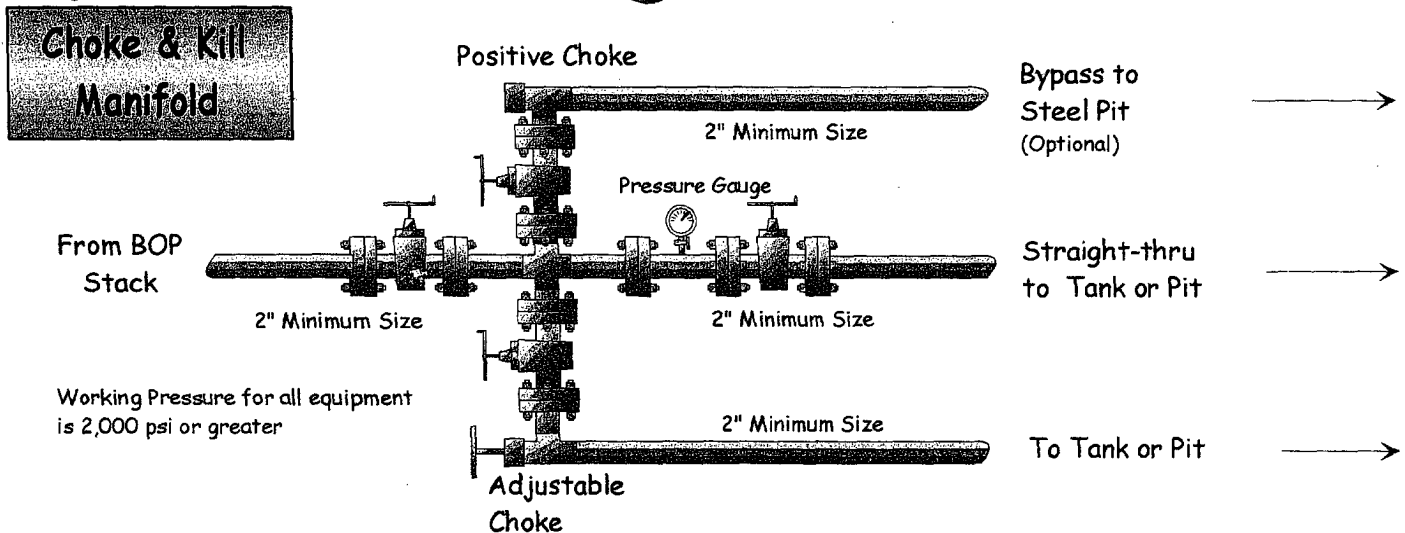
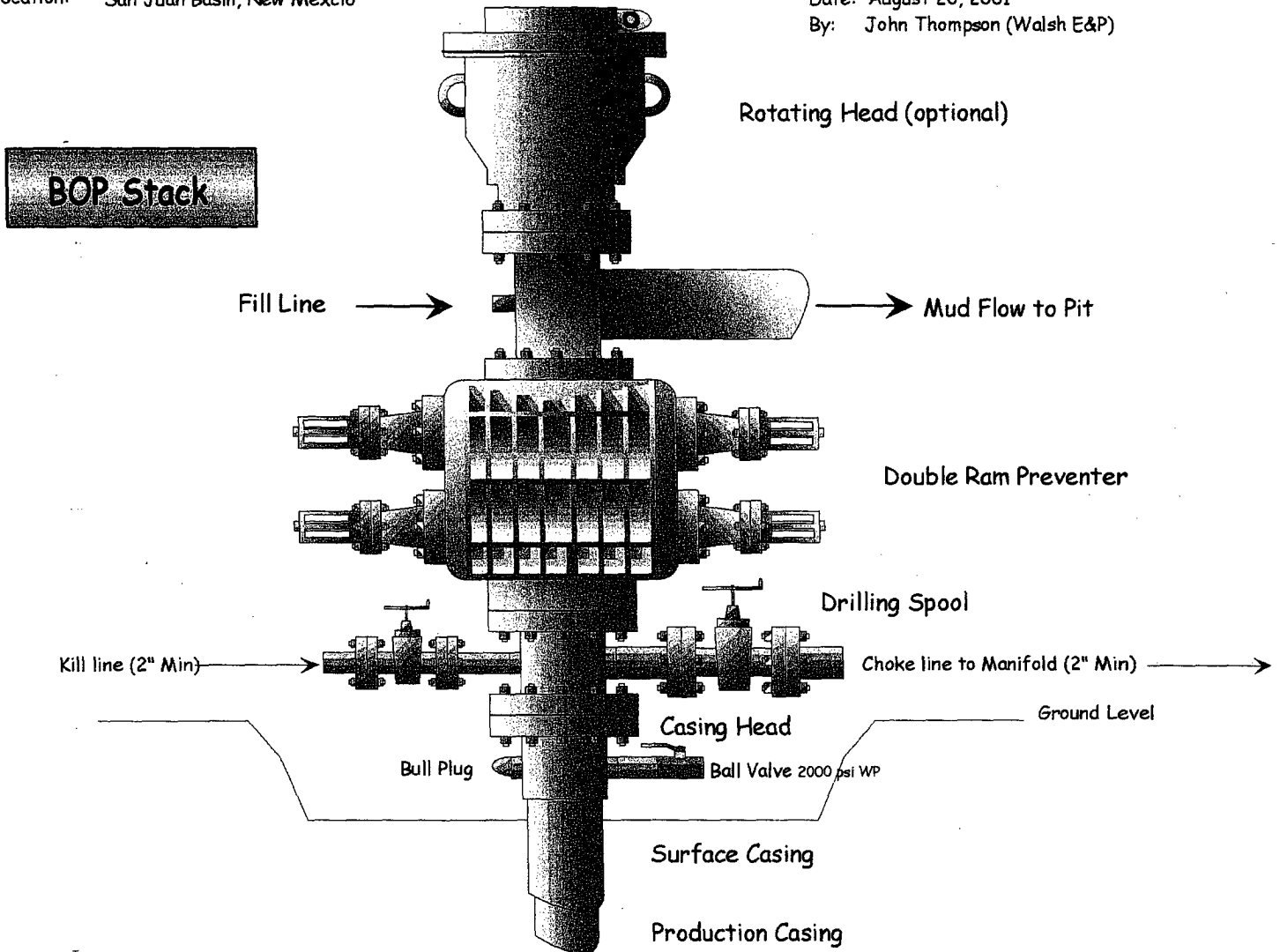

BLOW OUT PREVENTER (B.O.P.)

Notes:

1. Length of Kelly does not allow enough room for a Kelly Cock.
2. All Fittings will be screw on fitting types. (Valves, Nipples, and T's)
3. All Fittings, this B.O.P., or equivalent, & Surface Casing will be pressure tested to 600 psi prior to drilling from surface pipe.

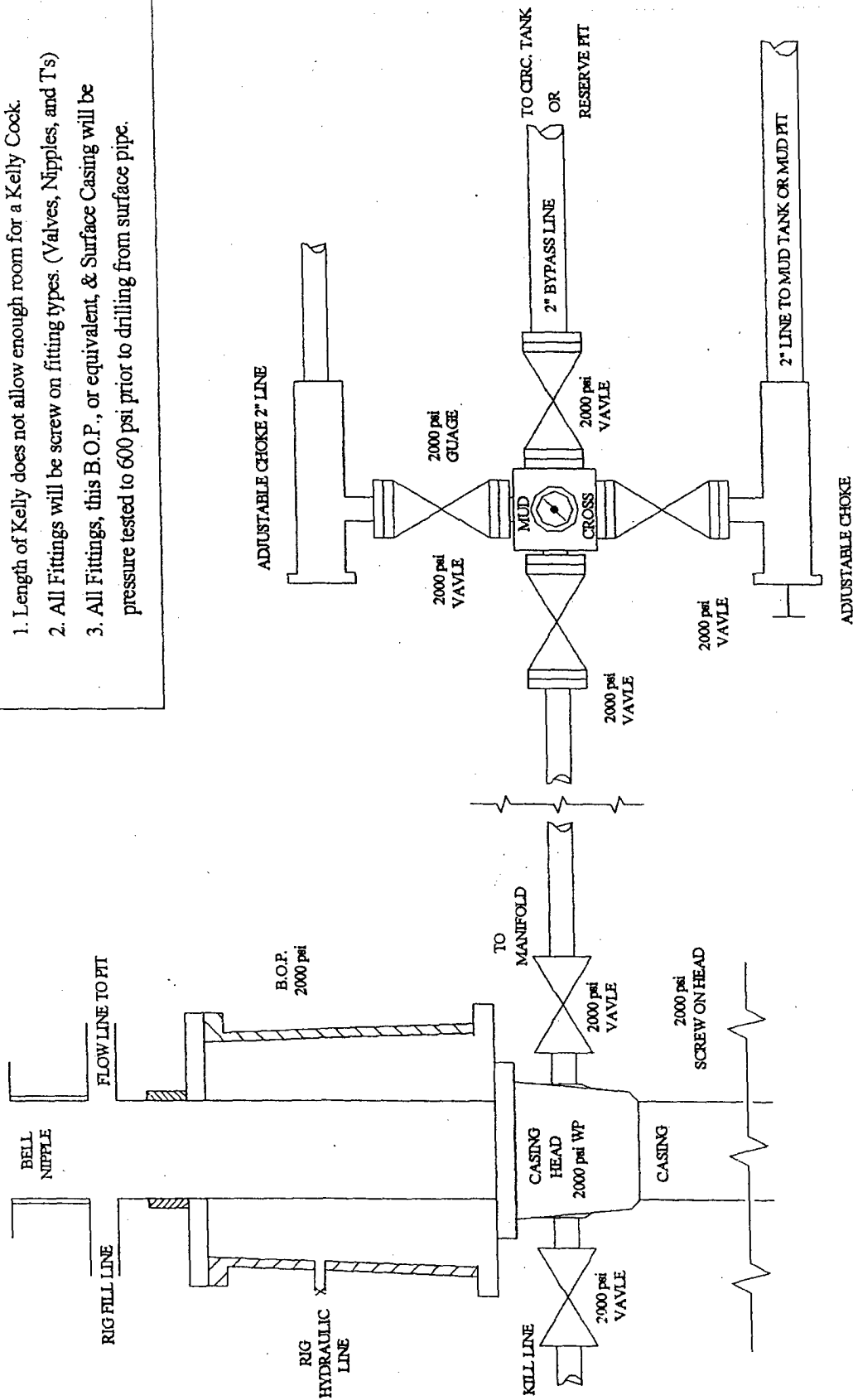

** 2000 psi Rubber hose will be used from Well Head to Manifold
& from Well Head to Kill Line.