

District I  
1625 N. French Dr., Hobbs, NM 88240  
District II  
1301 W. Grand Avenue, Artesia, NM 88210  
District III  
1000 Rio Brazos Road, Aztec, NM 87410  
District IV  
1220 S. St. Francis Dr., Santa Fe, NM 87505

State of New Mexico  
Energy Minerals and Natural Resources

Form C-144  
June 1, 2004

Oil Conservation Division  
1220 South St. Francis Dr.  
Santa Fe, NM 87505

For drilling and production facilities, submit to appropriate NMOCD District Office.  
For downstream facilities, submit to Santa Fe office

Pit or Below-Grade Tank Registration or Closure

Is pit or below-grade tank covered by a "general plan"? Yes ☐ No ☒

Type of action: Registration of a pit or below-grade tank ☐ Closure of a pit or below-grade tank ☒

Operator: ConocoPhillips Company Telephone: (505)599-3419 e-mail address: juanita.r.farrell@conocophillips.com  
Address: 5525 Highway 64 Farmington, NM 87401  
Facility or well name: SAN JUAN 32-8 UNIT 236A API#: 30-045-32331 U/I or Qtr/Qtr O Sec 22 T 31N R 8W  
County: SAN JUAN Latitude \_\_\_\_\_ Longitude \_\_\_\_\_ NAD: 1927 ☐ 1983 ☐ Surface Owner Federal ☒ State ☐ Private ☐ Indian ☐

**Pit**

Type: Drilling ☒ Production ☐ Disposal ☐  
Workover ☐ Emergency ☐  
Lined ☒ Unlined ☐  
Liner type: Synthetic ☒ Thickness 12 mil Clay ☐  
Pit Volume \_\_\_\_\_ bbl

**Below-grade tank**

Volume: \_\_\_\_\_ bbl Type of fluid: \_\_\_\_\_  
Construction material: \_\_\_\_\_  
Double-walled, with leak detection? Yes ☐ If not, explain why not. \_\_\_\_\_

Depth to ground water (vertical distance from bottom of pit to seasonal high water elevation of ground water.)	Less than 50 feet	(20 points)
	50 feet or more, but less than 100 feet	(10 points)
	100 feet or more	(0 points)
Wellhead protection area: (Less than 200 feet from a private domestic water source, or less than 1000 feet from all other water sources.)	Yes	(20 points)
	No	(0 points)
Distance to surface water: (horizontal distance to all wetlands, playas, irrigation canals, ditches, and perennial and ephemeral watercourses.)	Less than 200 feet	(20 points)
	200 feet or more, but less than 1000 feet	(10 points)
	1000 feet or more	(0 points)
Ranking Score (Total Points)		

**If this is a pit closure:** (1) attach a diagram of the facility showing the pit's relationship to other equipment and tanks. (2) Indicate disposal location: (check the onsite box if you are burying in place) onsite ☒ offsite ☐ If offsite, name of facility \_\_\_\_\_ (3) Attach a general description of remedial action taken including remediation start date and end date. (4) Groundwater encountered: No ☒ Yes ☐ If yes, show depth below ground surface \_\_\_\_\_ ft. and attach sample results. (5) Attach soil sample results and a diagram of sample locations and excavations.

Additional Comments:

This drill pit was closed on 10/06/2004 in accordance with Rule 50 and as per the November 1, 2004 Guidelines.

GW: > 100' WHP: > 1000' SW: > 1000'

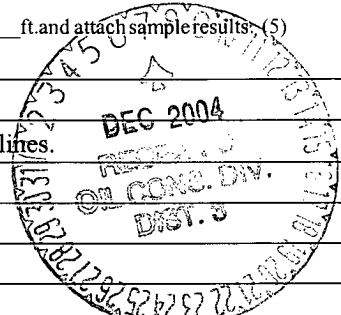

I hereby certify that the information above is true and complete to the best of my knowledge and belief. I further certify that the above-described pit or below-grade tank has been/will be constructed or closed according to NMOCD guidelines ☒, a general permit ☐, or an (attached) alternative OCD-approved plan ☐.  
Date: 11/26/2004

Printed Name/Title Juanita Farrell Regulatory Analyst

Signature Juanita Farrell

Your certification and NMOCD approval of this application/closure does not relieve the operator of liability should the contents of the pit or tank contaminate ground water or otherwise endanger public health or the environment. Nor does it relieve the operator of its responsibility for compliance with any other federal, state, or local laws and/or regulations.

Approval:

**DEPUTY OIL & GAS INSPECTOR, DIST. 3**

Printed Name/Title \_\_\_\_\_

Signature Wendy Faust

Date: DEC - 7 2004

**CONOCOPHILLIPS COMPANY SAN JUAN 32-8 UNIT #236A**  
**760' FSL & 1530' FEL, SECTION 22, T31N, R8W, NMPM**  
**SAN JUAN COUNTY, NEW MEXICO ELEVATION: 6462'**

**LATITUDE: 36.87792° N**  
**LONGITUDE: 107.65849° W**  
 DATUM: NAD1983

**PLAT NOTE:**

**\*SURFACE OWNER:**  
 Bureau of Land  
 Management

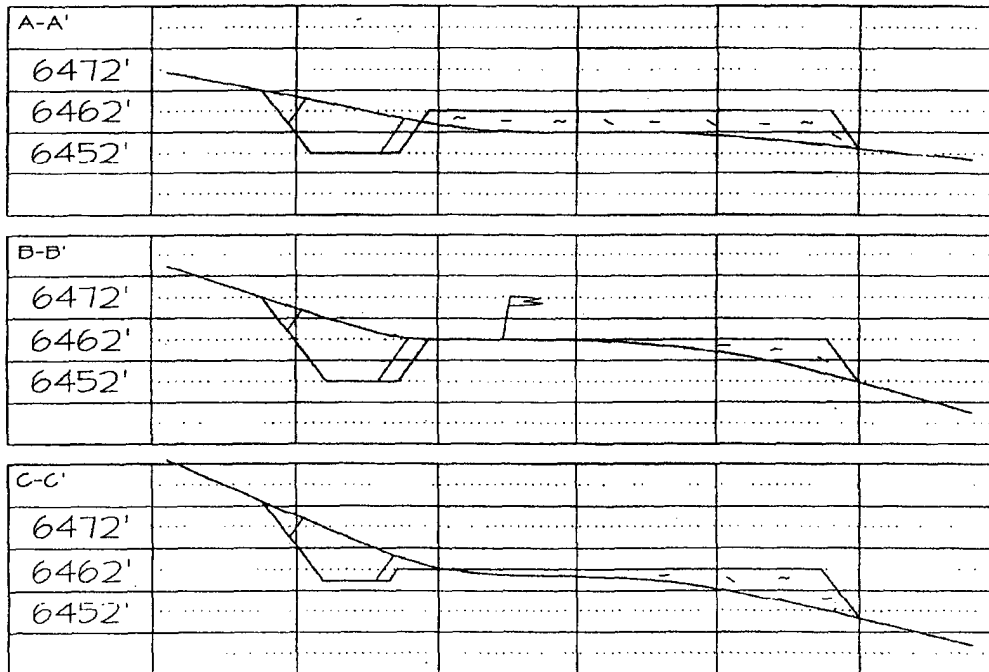
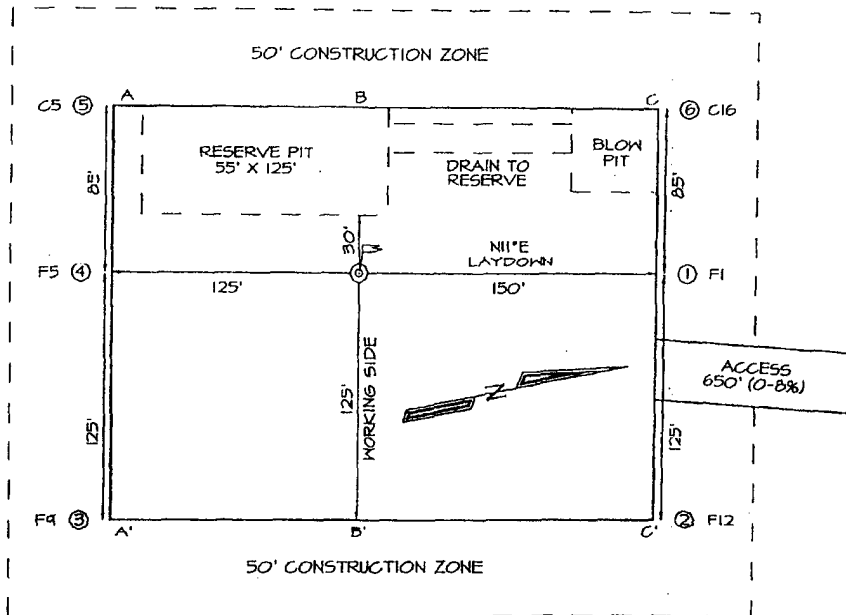

FILENAME: 318220T

SHEET 2 OF 6

NCE SURVEYS, INC.

DRAWN BY: EDO

CHECKED BY: JCE