

Submit 3 Copies To Appropriate District  
Office  
District I  
1625 N. French Dr., Hobbs, NM 88240  
District II  
1301 W. Grand Ave., Artesia, NM 88210  
District III  
1000 Rio Brazos Rd., Aztec, NM 87410  
District IV  
1220 S. St. Francis Dr., Santa Fe, NM  
87505

State of New Mexico  
Energy, Minerals and Natural Resources

Form C-103  
May 27, 2004

OIL CONSERVATION DIVISION  
1220 South St. Francis Dr.  
Santa Fe, NM 87505

WELL API NO.  
30-045-31820

5. Indicate Type of Lease  
STATE ☐ FEE ☐

6. State Oil & Gas Lease No.

7. Lease Name or Unit Agreement Name  
TRUE GRIT

8. Well Number  
#02

9. OGRID Number 173252

10. Pool name or Wildcat  
BASIN FRUITLAND COAL

SUNDRY NOTICES AND REPORTS ON WELLS

(DO NOT USE THIS FORM FOR PROPOSALS TO DRILL OR TO DEEPEN OR PLUG BACK TO A DIFFERENT RESERVOIR. USE "APPLICATION FOR PERMIT" (FORM C-101) FOR SUCH PROPOSALS.)

1. Type of Well: Oil Well ☐ Gas Well ☒ Other

2. Name of Operator  
PATINA SAN JUAN, INC

3. Address of Operator  
5802 U.S. HIGHWAY 64 FARMINGTON, NEW MEXICO 87401

4. Well Location

Unit Letter H : 1955 Feet from the NORTH line and 975 feet from the EAST line  
Section 35 Township 31N Range 13W NMPM SAN JUAN County

11. Elevation (Show whether DR, RKB, RT, GR, etc.)  
5975' GL

Pit or Below-grade Tank Application ☒ or Closure ☐

Pit type Drilling Depth to Groundwater >100' Distance from nearest fresh water well >1000' Distance from nearest surface water >1000'

Pit Liner Thickness: 12 mil Below-Grade Tank: Volume bbls; Construction Material SYNTHETIC

12. Check Appropriate Box to Indicate Nature of Notice, Report or Other Data

NOTICE OF INTENTION TO:

PERFORM REMEDIAL WORK ☐ PLUG AND ABANDON ☐  
TEMPORARILY ABANDON ☐ CHANGE PLANS ☐  
PULL OR ALTER CASING ☐ MULTIPLE COMPL ☐

OTHER: APPLICATION FOR DRILLING PIT PERMIT ☒

SUBSEQUENT REPORT OF:

REMEDIAL WORK ☐ ALTERING CASING ☐  
COMMENCE DRILLING OPNS. ☐ P AND A ☐  
CASING/CEMENT JOB ☐

OTHER: ☐

13. Describe proposed or completed operations. (Clearly state all pertinent details, and give pertinent dates, including estimated date of starting any proposed work). SEE RULE 1103. For Multiple Completions: Attach wellbore diagram of proposed completion or recompletion.

PROPOSED: LINED DRILLING PIT WITH UNLINED VENT/FLARE/BLOW PIT FOR THE DRILLING OF A NATURAL GAS WELL.

SEE ATTACHED CROSS SECTION AND DRILLING PAD WITH PIT DIAGRAM

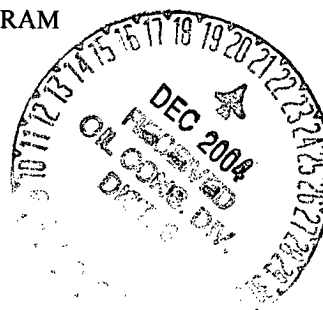

I hereby certify that the information above is true and complete to the best of my knowledge and belief. I further certify that any pit or below-grade tank has been/will be constructed or closed according to NMOCD guidelines ☒, a general permit ☐ or an (attached) alternative OCD-approved plan ☐.

SIGNATURE [Signature] TITLE Regulatory/Production Technician DATE 12/14/04

Type or print name  
For State Use Only

E-mail address:

Telephone No.

APPROVED BY: [Signature] TITLE DEPUTY OIL & GAS INSPECTOR, DIST. IV  
Conditions of Approval (if any):

DATE DEC 21 2004

OH POW - LINE (2-WIRE)

EDGE OF EXISTING WELLPAD

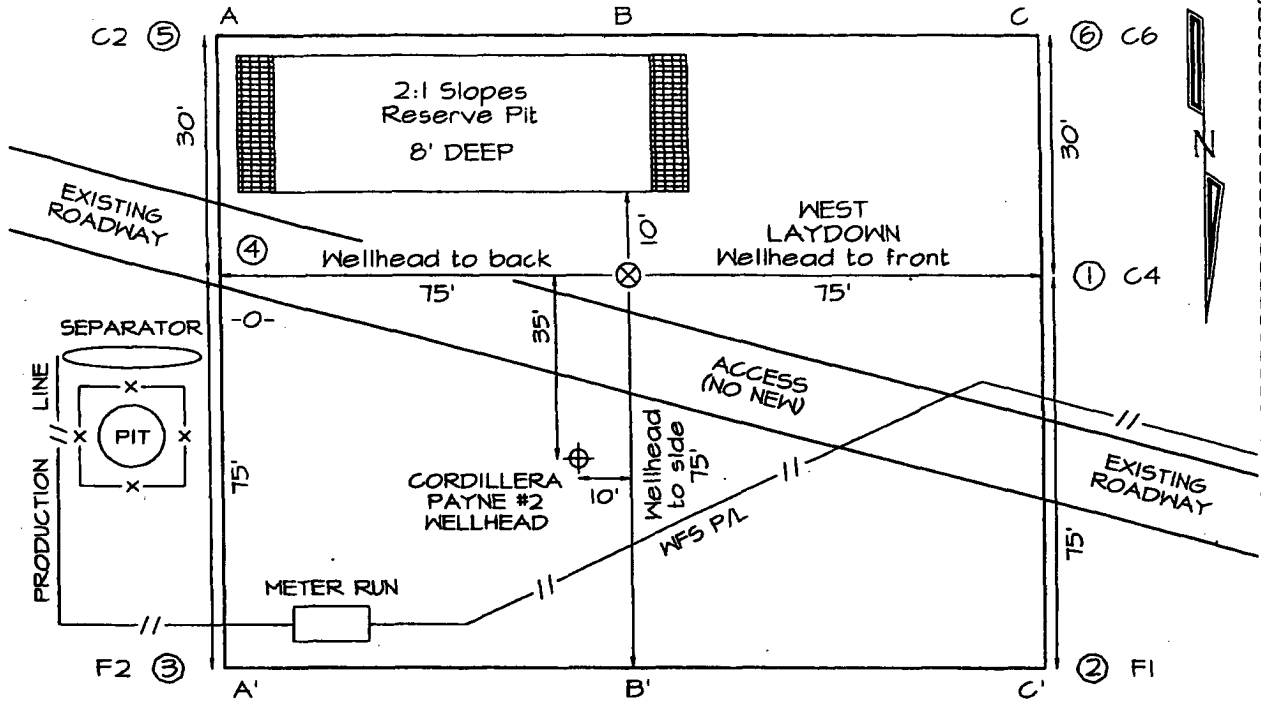

LATITUDE: 36°51'30"  
 LONGITUDE: 108°10'03"  
 DATUM: NAD1927

PLAT NOTE:

\*SURFACE OWNER\*  
 Bureau of Land  
 Management

EDGE OF EXISTING WELLPAD

A-A'						
5985'						
5975'						
5965'						

B-B'						
5985'						
5975'						
5965'						

C-C'						
5985'						
5975'						
5965'						

Note: Contractor should call One-Call for location of any marked or unmarked buried pipelines or cables on well pad and/or access road at least two (2) working days prior to construction