

Submit 3 Copies To Appropriate District
Office
District I
1625 N. French Dr., Hobbs, NM 88240
District II
1301 W. Grand Ave., Artesia, NM 88210
District III
1000 Rio Brazos Rd., Aztec, NM 87410
District IV
1220 S. St. Francis Dr., Santa Fe, NM
87505

State of New Mexico
Energy, Minerals and Natural Resources

Form C-103
March 4, 2004

OIL CONSERVATION DIVISION
1220 South St. Francis Dr.
Santa Fe, NM 87505

WELL API NO. 30-045-32490
5. Indicate Type of Lease STATE <input type="checkbox"/> FEE <input type="checkbox"/>
6. State Oil & Gas Lease No.
7. Lease Name or Unit Agreement Name Schwerdtfeger A (APD filed with BLM NMSF 079319)
8. Well Number 2 N
9. OGRID Number
10. Pool name or Wildcat Basin Dakota & Blanco Mesaverde

SUNDRY NOTICES AND REPORTS ON WELLS
(DO NOT USE THIS FORM FOR PROPOSALS TO DRILL OR TO DEEPEN OR PLUG BACK TO A
DIFFERENT RESERVOIR. USE "APPLICATION FOR PERMIT" (FORM C-101) FOR SUCH
PROPOSALS.)

1. Type of Well:
Oil Well ☐ Gas Well ☒ Other ☐

2. Name of Operator
BP AMERICA PRODUCTION CO

3. Address of Operator
P.O. BOX 3092 HOUSTON, TX 77079-2064

4. Well Location

Unit Letter **N** : **1020** feet from the **South** line and **1790** feet from the **West** line

Section **31** Township **28N** Range **08W** NMPM **SAN JUAN** County

11. Elevation (Show whether DR, RKB, RT, GR, etc.)
6417'

Pit or Below-grade Tank Application (For pit or below-grade tank closures, a form C-144 must be attached)

Pit Location: UL **N** Sect **31** Twp **28N** Rng **08W** Pit type **Drilling** Depth to Groundwater **>100'** Distance from nearest fresh water well **>1000'**
Distance from nearest surface water **>1000'** Below-grade Tank Location UL **N** Sect **31** Twp **28N** Rng **08W** ;
1070 feet from the **South** line and **1805** feet from the **West** line PLEASE SEE ATTACHED PAD LAYOUT

12. Check Appropriate Box to Indicate Nature of Notice, Report or Other Data

NOTICE OF INTENTION TO:

PERFORM REMEDIAL WORK ☐ PLUG AND ABANDON ☐

TEMPORARILY ABANDON ☐ CHANGE PLANS ☐

PULL OR ALTER CASING ☐ MULTIPLE COMPLETION ☐

OTHER: Lined Drilling PIT PERMIT ☒

SUBSEQUENT REPORT OF:

REMEDIAL WORK ☐ ALTERING CASING ☐

COMMENCE DRILLING OPNS. ☐ PLUG AND ABANDONMENT ☐

CASING TEST AND CEMENT JOB ☐

OTHER: ☐

13. Describe proposed or completed operations. (Clearly state all pertinent details, and give pertinent dates, including estimated date of starting any proposed work). SEE RULE 1103. For Multiple Completions: Attach wellbore diagram of proposed completion or recompletion.

BP America will construct a lined drilling pit per BP San Juan Basin Drilling/Workover Pit Construction Plan issue date of 04/15/2004. Pit will be closed according to closure plan on file.

I hereby certify that the information above is true and complete to the best of my knowledge and belief. I further certify that any pit or below-grade tank has been/will be constructed or closed according to NMOCD guidelines ☐, a general permit ☐ or an (attached) alternative OCD-approved plan ☐.

SIGNATURE Cherry Hlava TITLE Regulatory Analyst DATE 12/17/04

Type or print name Cherry Hlava E-mail address: hlavac@bp.com Telephone No. 281-366-4081

(This space for State use)

APPROVED BY [Signature] TITLE SENIOR OIL & GAS INSPECTOR, DIST. 33 DATE DEC 21 2004
Conditions of approval, if any:

PAD LAYOUT PLAN & PROFILE
BP AMERICA PRODUCTION COMPANY
 Schwerdtfeger A # 2N
 1020' F/SL 1790' F/WL
 SEC. 31, T8N, R8W, N.M.P.M.
 SAN JUAN COUNTY, NEW MEXICO

Lat: 36°36'51"
 Long: 107°43'29"

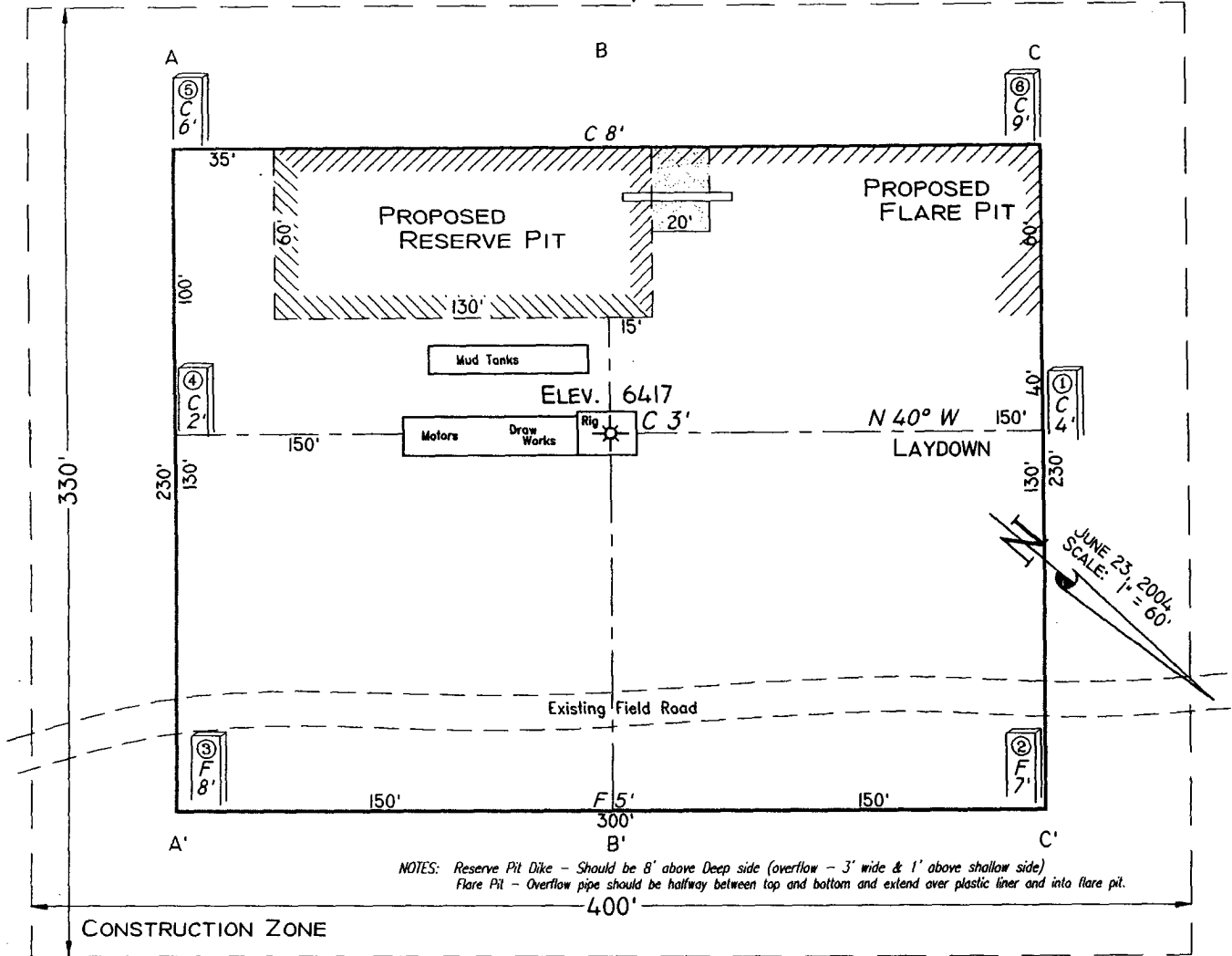

Area of Construction Zone - 330'x400' or 3.03 acres, more or less.

SCALE: 1"=60'-HORIZ.
 1"=40'-VERT.

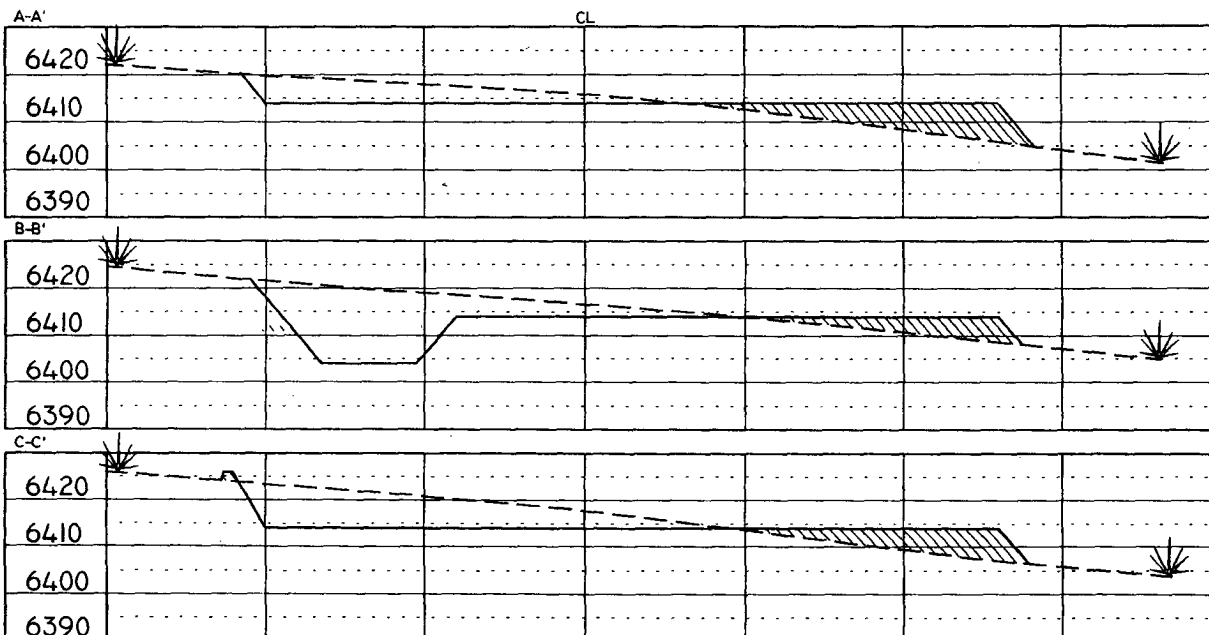

NOTE: Contractor should call One-Call for location of any marked or unmarked buried pipelines or cables on well pad and/or access road at least two (2) working days prior to construction.

Cuts and fills shown are approximate - final finished elevation is to be adjusted so earthwork will balance. Corner stakes are approximate and do not include additional areas needed for sideslopes and drainages. Final Pad Dimensions are to be verified by Contractor.

VANN SURVEYS
 P. O. Box 1306
 Farmington, NM