

District I
1625 N. French Dr., Hobbs, NM 88240
District II
1301 W. Grand Avenue, Artesia, NM 88210
District III
1000 Rio Brazos Road, Aztec, NM 87410
District IV
1220 S. St. Francis Dr., Santa Fe, NM 87505

State of New Mexico
Energy Minerals and Natural Resources

Form C-144
June 1, 2004

Oil Conservation Division
1220 South St. Francis Dr.
Santa Fe, NM 87505

For drilling and production facilities, submit to appropriate NMOCD District Office.
For downstream facilities, submit to Santa Fe office.

Pit or Below-Grade Tank Registration or Closure

Is pit or below-grade tank covered by a "general plan"? Yes ☐ No ☒
Type of action: Registration of a pit or below-grade tank ☐ Closure of a pit or below-grade tank ☒

Operator: Dugan Production Corp. Telephone: (505)325-1821 e-mail address: martyfoutz@duganproduction.com
Address: P. O. Box 420, Farmington, NM 87499-0420
Facility or well name: Salge Federal A #94S API #: 30-045-31349 U/L or Qtr/Qtr J Sec 34 T 26N R 13W
County: San Juan Latitude 36.44138 Longitude 108.20305 NAD: 1927 ☒ 1983 ☐ Surface Owner Federal ☒ State ☐ Private ☐ Indian ☐

Pit

Type: Drilling ☒ Production ☐ Disposal ☐
Workover ☐ Emergency ☐

Lined ☒ Unlined ☐

Liner type: Synthetic ☒ Thickness 6 mil Clay ☐

Pit Volume ±975 bbl

Below-grade tank

Volume: bbl Type of fluid:

Construction material:

Double-walled, with leak detection? Yes ☐ If not, explain why not.

Depth to ground water (vertical distance from bottom of pit to seasonal high water elevation of ground water.)

Less than 50 feet	(20 points)
50 feet or more, but less than 100 feet	(10 points)
100 feet or more	(0 points) 0

Wellhead protection area: (Less than 200 feet from a private domestic water source, or less than 1000 feet from all other water sources.)

Yes	(20 points)
No	(0 points) 0

Distance to surface water: (horizontal distance to all wetlands, playas, irrigation canals, ditches, and perennial and ephemeral watercourses.)

Less than 200 feet	(20 points)
200 feet or more, but less than 1000 feet	(10 points)
1000 feet or more	(0 points) 0

Ranking Score (Total Points)	0
------------------------------	---

If this is a pit closure: (1) attach a diagram of the facility showing the pit's relationship to other equipment and tanks. (2) Indicate disposal location: (check the onsite box if you are burying in place) onsite ☒ offsite ☐ If offsite, name of facility . (3) Attach a general description of remedial action taken including remediation start date and end date. (4) Groundwater encountered: No ☒ Yes ☐ If yes, show depth below ground surface ft. and attach sample results. (5) Attach soil sample results and a diagram of sample locations and excavations.

Facility diagram, description of remedial action and alternative to NMOCD guidelines are presented on attached page.

I hereby certify that the information above is true and complete to the best of my knowledge and belief. I further certify that the above-described pit or below-grade tank has been/will be constructed or closed according to NMOCD guidelines ☐, a general permit ☐, or an (attached) alternative OCD-approved plan ☒.

Date: February 22, 2005

Printed Name/Title Marty Foutz, Production Foreman

Signature [Signature]

Your certification and NMOCD approval of this application/closure does not relieve the operator of liability should the contents of the pit or tank contaminate ground water or otherwise endanger public health or the environment. Nor does it relieve the operator of its responsibility for compliance with any other federal, state, or local laws and/or regulations.

Approval: DEPUTY OIL & GAS INSPECTOR, DIST. 6

Printed Name/Title

Signature [Signature]

Date: FEB 24 2005

SUPPLEMENTAL INFORMATION
NMOCD FORM C-144 DATED 2-22-05
DUGAN PRODUCTION CORP.'S SALGE FEDERAL A #94S

1. Facility Diagram (not drawn to scale)

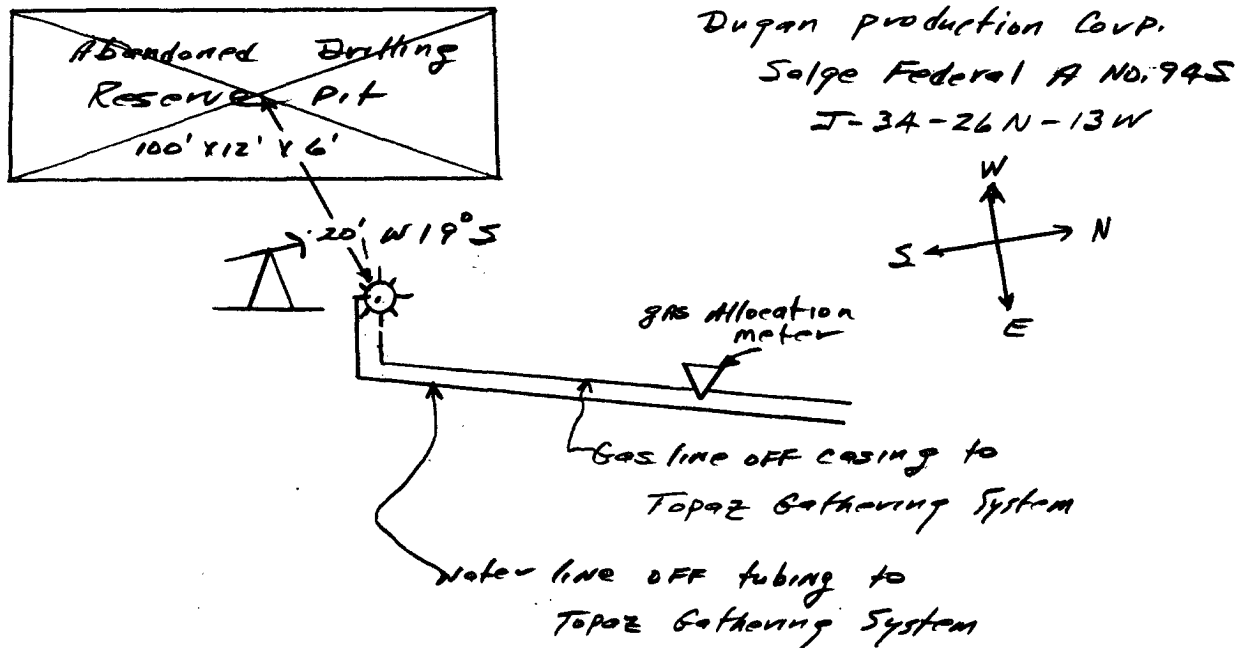

2. Remedial Action – The reserve pit liner was intact and no salt zones were encountered while drilling. Completion fluids were produced into the reserve pit during testing, however all fluid was removed for disposal prior to covering the pit. On 1-10-05, the reserve pit was fairly dry. The pit liner was cut at the mud line and the recovered liner disposed of at Waste Management's Crouch Mesa landfill. The pit area was covered with stockpiled top soil to a depth of at least 3'. The surface was contoured and will be seeded in early spring.
3. Alternative to NMOCD Guidelines – The Salge Federal A #94S is located upon Federal Lease SF-078156 and until a general permit is prepared and approved, Dugan Production Corp. intends to follow NMOCD guidelines modified only as necessary to comply with stipulations imposed by the Bureau of Land Management.