

UNITED STATES  
DEPARTMENT OF THE INTERIOR  
BUREAU OF LAND MANAGEMENT

APPLICATION FOR PERMIT TO DRILL, DEEPEN, OR PLUG BACK

1a. Type of Work DRILL	2005 JUN 18 PM 2:50 RECEIVED OTO FARMINGTON NM	5. Lease Number NMSF-080712A Unit Reporting Number
1b. Type of Well GAS		6. If Indian, All. or Tribe
2. Operator <b>BURLINGTON</b> RESOURCES OIL & GAS COMPANY LP		7. Unit Agreement Name San Juan 30-6 Unit
3. Address & Phone No. of Operator PO Box 4289, Farmington, NM 87499 (505) 326-9700		8. Farm or Lease Name San Juan 30-6 Unit 9. Well Number 479S
4. Location of Well 1760' FNL, 1875' FWL, Latitude 36° 47.1620, Longitude 107° 29.2965		10. Field, Pool, Wildcat Basin Fruitland Coal 11. Sec., Twn, Rge, Mer. (NMPM) F Sec. 29, T-30-N, R-6-W API # 30-039-29412
14. Distance in Miles from Nearest Town 11 miles from Gobernador	12. County Rio Arriba	13. State NM
15. Distance from Proposed Location to Nearest Property or Lease Line 1760'		
16. Acres in Lease	17. Acres Assigned to Well 320 W/2	
18. Distance from Proposed Location to Nearest Well, Drig, Compl, or Applied for on this Lease 50'		
19. Proposed Depth 3334'	20. Rotary or Cable Tools Rotary	
21. Elevations (DF, FT, GR, Etc.) 6307' GR	22. Approx. Date Work will Start	
23. Proposed Casing and Cementing Program See Operations Plan attached		
24. Authorized by: <u>Nancy Olthmann</u> Senior Staff Regulatory Specialist	<u>12-30-04</u> Date	

PERMIT NO.

APPROVAL DATE

APPROVED BY [Signature]

TITLE AFM

DATE 2-16-05

Archaeological Report attached

Threatened and Endangered Species Report attached

NOTE: This format is issued in lieu of U.S. BLM Form 3160-3

Title 18 U.S.C. Section 1001, makes it a crime for any person knowingly and willfully to make to any department or agency of the United States any false, fictitious or fraudulent statements or presentations as to any matter within its jurisdiction.

This action is subject to technical and procedural review pursuant to 43 CFR 3165.3 and appeal pursuant to 43 CFR 3165.4

NMOC

DRILLING OPERATIONS AUTHORIZED ARE  
SUBJECT TO COMPLIANCE WITH ATTACHED  
"GENERAL REQUIREMENTS".

District I  
PO Box 1980, Hobbs, NM 88241-1980

District II  
PO Drawer DD, Artesia, NM 88211-0719

District III  
1000 Rio Brazos Rd., Aztec, NM 87410

District IV  
PO Box 2088, Santa Fe, NM 87504-2088

State of New Mexico  
Energy, Minerals & Natural Resources Department

OIL CONSERVATION DIVISION  
PO Box 2088  
Santa Fe, NM 87504-2088

Form C-102  
Revised February 21, 1994  
Instructions on back  
Submit to Appropriate District Office  
State Lease - 4 Copies  
Fee Lease - 3 Copies

☐ AMENDED REPORT

WELL LOCATION AND ACREAGE DEDICATION PLAT

*API Number 30-039- <b>29412</b>	*Pool Code 71629	*Pool Name Basin Fruitland Coal
*Property Code 7469	*Property Name SAN JUAN 30-6 UNIT	*Well Number 479S
*GRID No. 14538	*Operator Name BURLINGTON RESOURCES OIL & GAS COMPANY, LP	*Elevation 6307'

<sup>10</sup> Surface Location

UL or lot no.	Section	Township	Range	Lot Idn	Feet from the	North/South line	Feet from the	East/West line	County
F	29	30N	6W		1760	NORTH	1875	WEST	RIO ARriba

<sup>11</sup> Bottom Hole Location If Different From Surface

UL or lot no.	Section	Township	Range	Lot Idn	Feet from the	North/South line	Feet from the	East/West line	County
F									

<sup>12</sup> Dedicated Acres 320 acres W/2	<sup>13</sup> Joint or Infill	<sup>14</sup> Consolidation Code	<sup>15</sup> Order No.
--	-------------------------------	----------------------------------	-------------------------

NO ALLOWABLE WILL BE ASSIGNED TO THIS COMPLETION UNTIL ALL INTERESTS HAVE BEEN CONSOLIDATED OR A NON-STANDARD UNIT HAS BEEN APPROVED BY THE DIVISION

<div><p><sup>16</sup></p><p>5272.08'</p><p>1760'</p><p>1875'</p><p>760'</p><p>5280.00'</p><p>5281.32'</p><p>29</p><p>LEASE NM SF-080712-A</p><p>LAT: 36°47.1620' N LONG: 107°29.2965' W DATUM: NAD27</p><p>FEB 2005 RECEIVED OIL CON. DIV. DIST. 8</p></div>	<div><p><sup>17</sup> OPERATOR CERTIFICATION</p><p>I hereby certify that the information contained herein is true and complete to the best of my knowledge and belief</p><p><i>Patsy Clugston</i></p><p>Signature</p><p>Patsy Clugston</p><p>Printed Name</p><p>Sr. Regulatory Specialist</p><p>Title</p><p>11-12-04</p><p>Date</p></div> <div><p><sup>18</sup> SURVEYOR CERTIFICATION</p><p>I hereby certify that the well location shown on this plat was plotted from field notes of actual surveys made by me or under my supervision, and that the same is true and correct to the best of my belief.</p><p>Survey Date: OCTOBER 15, 2004</p><p>Signature and Seal of Professional Surveyor</p><p>JASON C. EDWARDS</p><p>Certificate Number 15269</p></div>
--	--

Office

Energy, Minerals and Natural Resources

May 27, 2004

District I

1625 N. French Dr., Hobbs, NM 88240

District II

1301 W. Grand Ave., Artesia, NM 88210

District III

1000 Rio Brazos Rd., Aztec, NM 87410

District IV

1220 S. St. Francis Dr., Santa Fe, NM 87505

## OIL CONSERVATION DIVISION

1220 South St. Francis Dr.

Santa Fe, NM 87505

WELL API NO.

30-039-

5. Indicate Type of Lease

STATE ☐FEE ☐

6. State Oil &amp; Gas Lease No.

Federal Lease NMSF-80712A

7. Lease Name or Unit Agreement Name

San Juan 30-6 Unit

8. Well Number

479S

9. OGRID Number

14538

10. Pool name or Wildcat

Basin Fruitland Coal

**SUNDRY NOTICES AND REPORTS ON WELLS**  
(DO NOT USE THIS FORM FOR PROPOSALS TO DRILL OR TO DEEPEN OR PLUG BACK TO A DIFFERENT RESERVOIR. USE "APPLICATION FOR PERMIT" (FORM C-101) FOR SUCH PROPOSALS.)

1. Type of Well:

Oil Well ☐Gas Well ☒

Other

2. Name of Operator

BURLINGTON RESOURCES OIL &amp; GAS COMPANY LP

3. Address of Operator

3401 E. 30TH STREET, FARMINGTON, NM 87402

4. Well Location

Unit Letter F : 1760' feet from the North line and 1875' feet from the West lineSection 29 Township 30N Range 6W NMPM County Rio Arriba

11. Elevation (Show whether DR, RKB, RT, GR, etc.)

Pit or Below-grade Tank Application

☐ or ClosurePit type New Drill Depth to Groundwater >100' Distance from nearest fresh water well>1000' Distance from nearest surface water >1000'

Pit Liner Thickness:

na

mil

Below-Grade Tank:

Volume

bbls;

Construction Material

## 12. Check Appropriate Box to Indicate Nature of Notice, Report or Other Data

## NOTICE OF INTENTION TO:

PERFORM REMEDIAL WORK ☐TEMPORARILY ABANDON ☐PULL OR ALTER CASING ☐PLUG AND ABANDON ☐CHANGE PLANS ☐MULTIPLE COMPL ☐

OTHER:

New Drill ☒

## SUBSEQUENT REPORT OF:

REMEDIAL WORK ☐COMMENCE DRILLING OPNS. ☐CASING/CEMENT JOB ☐ALTERING CASING ☐P AND A ☐OTHER: ☐

13. Describe proposed or completed operations. (Clearly state all pertinent details, and give pertinent dates, including estimated date of starting any proposed work). SEE RULE 1103. For Multiple Completions: Attach wellbore diagram of proposed completion or recompletion.

Burlington Resources proposes to construct a new drilling pit and an associated blow/flare pit. Based on Burlington's interpretation of the Ecosphere's risk ranking criteria, the new drilling pit and blow/flare pit will be an unlined pit as detailed in Burlington's Revised Drilling / Workover Pit Construction / Operation Procedures dated November 11, 2004 on file at the NMOCD office. A portion of the blow/flare pit will be designed to manage fluids, and that portion will be unlined, as per the risk ranking criteria. Burlington Resources anticipates closing these pits according to the Drilling / Workover Pit Closure Procedure dated August 2, 2004 on file at the NMOCD office.

I hereby certify that the information above is true and complete to the best of my knowledge and belief. I further certify that any pit or below-grade tank has been/will be constructed or closed according to NMOCD guidelines ☐, a general permit ☒ or an (attached) alternative OCD-approved plan ☐.

SIGNATURE

*Nancy Oltmanns*

TITLE

Senior Staff Regulatory Specialist

DATE

1/12/2004

Type or print name

Nancy Oltmanns

E-mail address:

noltmanns@br-inc.com

Telephone No.

505-326-9891

For State Use Only

DEPUTY OIL &amp; GAS INSPECTOR, DIST. 65

FEB 22 2005

APPROVED BY

TITLE

DATE

Conditions of Approval (if any):

LATITUDE: 36°47'10"  
LONGITUDE: 107°29'18"

50' CONSTRUCTION ZONE

DUKE PL

F2

⑥

2:1 Slopes  
10' DEEP

Dike

Reserve Pit  
8' DEEP

60'

15'

20'

INSTALL DRAIN  
ON FRUITLAND  
FORMATIONS  
6' DEEP

Blow Pit  
3' DEEP

40'

70'

95'

523°E  
LAYDOWN  
Wellhead to front

①

120'

120'

Wellhead to back

15'

50'

35'

TANK

PIT

SEPARATOR

Wellhead to side

110'

B' 110'

BURLINGTON  
SAN JUAN 30-6  
#53A WELLHEAD

TELEMETRY  
STATION

METER RUN

A' CATHODIC PROTECTION STATION

EDGE EXISTING WELLPAD

C2

A-A'						
6317'						
6307'						
6297'						

B-B'						
6317'						
6307'						
6297'						

C-C'						
6317'						
6307'						
6297'						

Note: Contractor should call One-Call for location of any marked or unmarked buried pipelines or cables on well pad and/or access road at least two (2) working days prior to construction

## OPERATIONS PLAN

**Well Name:** San Juan 30-6 Unit #479S

**Location:** 1760'FNL, 1875'FWL, Section 29, T-30-N, R-6-W  
Rio Arriba County, NM

Latitude 36° 47.1620'N, Longitude 107° 29.2965'W

**Formation:** Basin Fruitland Coal

**Total Depth:** 3334'

**Burlington Resources is requesting a sump on this well.**

**Logging Program:** See San Juan 30-6 Unit Wells Master Operations Plan

**Mud Program:** See San Juan 30-6 Unit Wells Master Operations Plan

**Casing Program (as listed, the equivalent, or better):** \_\_\_\_\_

Hole Size	Depth Interval	Csg	Wt.	Grade	Cement	
12 1/4	0' - 120	9.625"	32.3#	H-40	113	cu.ft
8 3/4	0' - 3028	7"	20.0#	J-55	677	cu.ft
6 1/4	2978 - 3334	5 1/2"	15.5#	J-55	uncemented	

**Tubing Program:** See San Juan 30-6 Unit Wells Master Operations Plan

- \* The Fruitland Coal formation will be completed.
- \* The west half of Section 29 is dedicated to the Fruitland Coal formation in this well.
- \* Gas is dedicated.

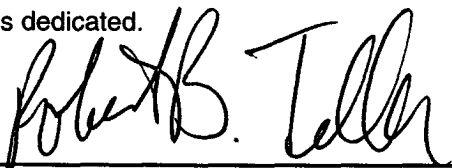
  
\_\_\_\_\_  
Drilling Engineer

1-5-05  
\_\_\_\_\_  
Date

# **BURLINGTON**

## **RESOURCES**

San Juan Division

January 31, 2005

(Certified Mail – Return Receipt Requested)

Re: San Juan 30-6 Unit #479S  
Basin Fruitland Coal  
1760' FNL & 1875' FWL, Section 29, T30N, R6W  
Rio Arriba County, New Mexico

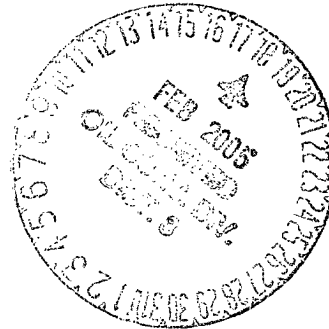

To the Affected Persons:

Burlington Resources Oil & Gas Company LP is submitting the enclosed Application for Permit to Drill to the appropriate regulatory agency(s) for approval. This well is located inside the High Productivity Area of the Basin-Fruitland Coal Pool as indicated on the attached plat. Notice is being made pursuant to New Mexico Oil Conservation Commission Order R-8768-F dated July 17, 2003.

The affected parties have twenty (20) days from receipt of this notice in which to file with the District Office of the New Mexico Oil Conservation Division written objection to the proposed Application for Permit to Drill.

Sincerely,

Patsy Clugston  
Sr. Regulatory Specialist

Legend

Current Operator

● BURLINGTON RESOURCES O&G CO LP

▨ pa-fruitleland

□ Spacing Units

BURLINGTON  
RESOURCES



1:30,255 - 1" equals 2,521'  
GCS North American 1927

BURLINGTON RESOURCES

San Juan

SAN JUAN 30-6 UNIT 479S HPA  
SEC 29, T30N, R06W  
RIO ARriba COUNTY, NEW MEXICO

Prepared By: Michelle Dillon Date: 1/25/2005  
File Number: 1/25/2005  
File Name: C:\data\mof\proj\San Juan Basin\mof\San Juan Basin.mof

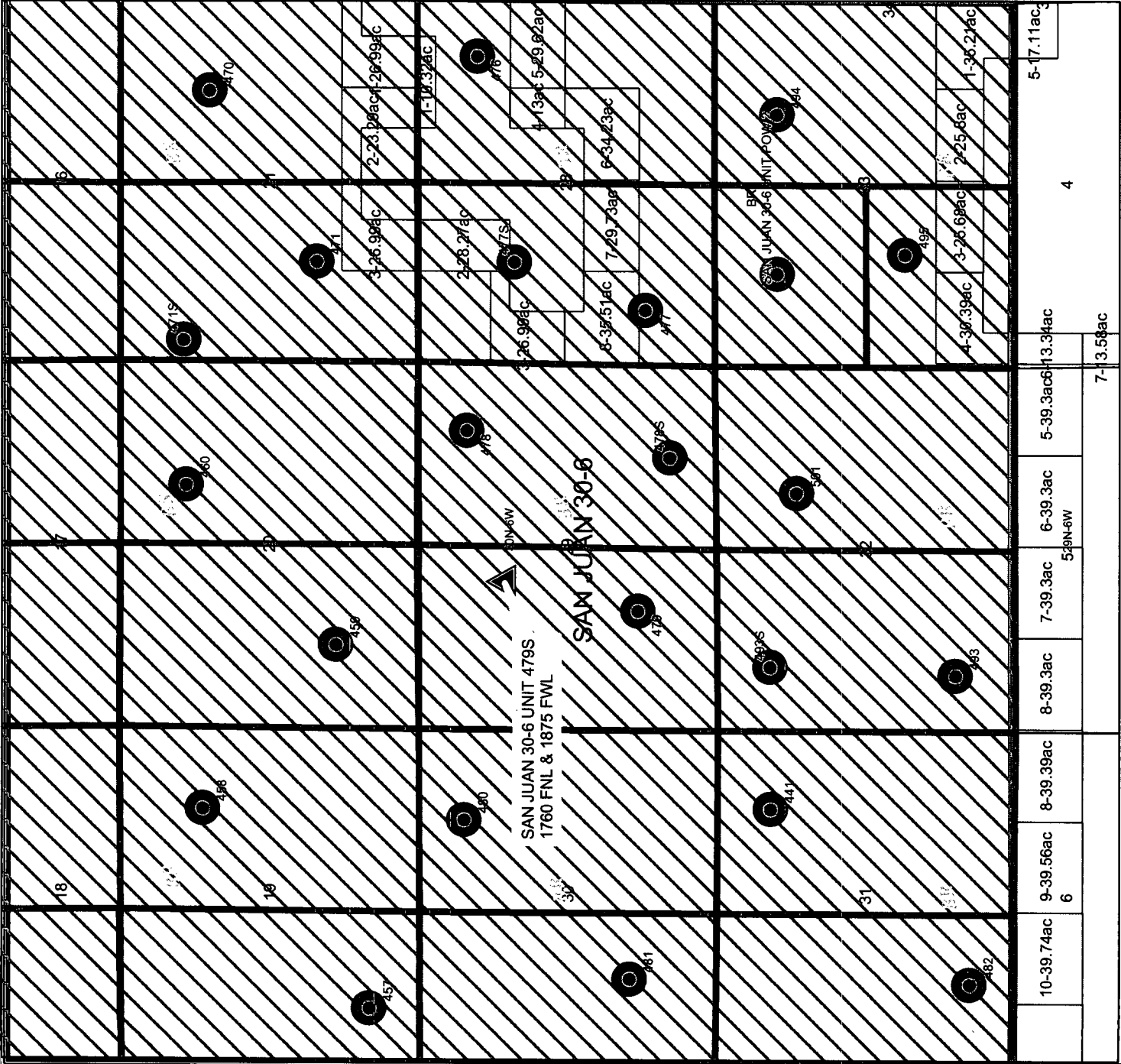

Legend

Current Operator

BURLINGTON RESOURCES O&G CO LP

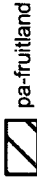

pa-fruitland



Spacing Units



BURLINGTON  
RESOURCES



1:30,255 - 1" equals 2,521'  
GCS North American 1927

BURLINGTON RESOURCES

San Juan

SAN JUAN 30-6 UNIT 479S HPA  
SEC 29, T30N, R06W  
RIO ARriba COUNTY, NEW MEXICO

Prepared By: Michelle Dillon Date: 1/25/2005  
File Number: Revised Date: 1/25/2005  
File Name: C:\atland\Procs\San Juan Basin\template\San Juan Basin template.mxd

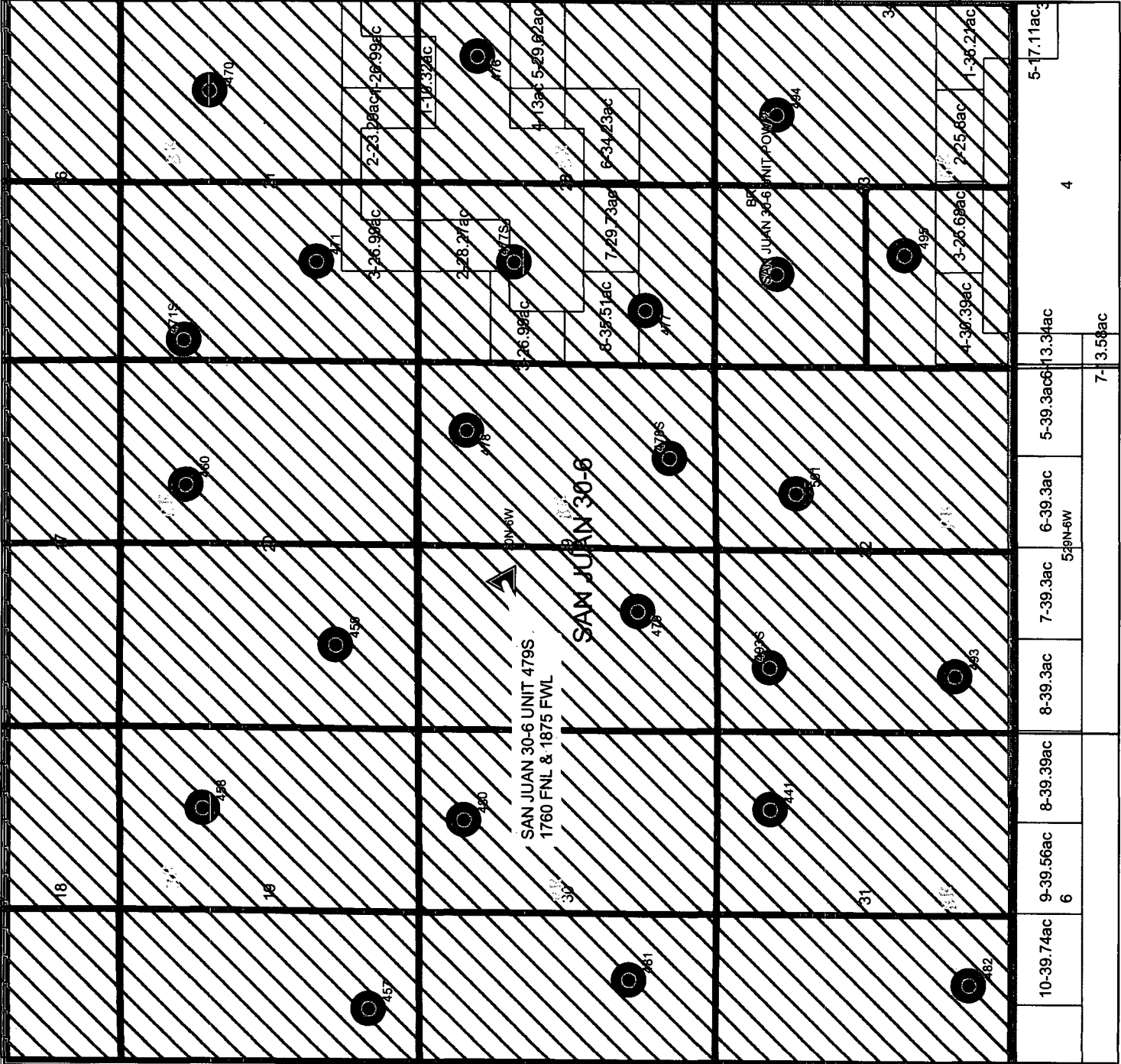



## Current Operator

BURLINGTON RESOURCES O&amp;G COLP



**pa-fruitland**



## Spacing Units

**BURLINGTON**  
**RESOURCES**

1:30,255 - 1" equals 2,521'  
GCS North American 1927

**BURLINGTON RESOURCES**

**San Juan**

SAN JUAN 30-6 UNIT 479S HPA  
SEC 29, T30N, R06W  
RIO ARriba COUNTY, NEW MEXICO

Prepared By: Michelle Dillon Date: 1/25/2005

Michelle Dillon

Date: \_\_\_\_\_

1/25/2005

**File Number:**

Revised Date: 1/25/2005

**File Name:** c:\plattmvd\Proiecta\San Juan Basin template\San Juan Basin template.mxd

