

Submit 1 Copy To Appropriate District Office
District I – (575) 393-6161
1625 N. French Dr., Hobbs, NM 88240
District II – (575) 748-1283
811 S. First St., Artesia, NM 88210
District III – (505) 334-6178
1000 Rio Brazos Rd., Aztec, NM 87410
District IV – (505) 476-3460
1220 S. St. Francis Dr., Santa Fe, NM 87505

State of New Mexico
Energy, Minerals and Natural Resources

OIL CONSERVATION DIVISION
1220 South St. Francis Dr.
Santa Fe, NM 87505

Form C-103
Revised July 18, 2013

SUNDRY NOTICES AND REPORTS ON WELLS (DO NOT USE THIS FORM FOR PROPOSALS TO DRILL OR TO DEEPEN OR PLUG BACK TO A DIFFERENT RESERVOIR. USE "APPLICATION FOR PERMIT" (FORM C-101) FOR SUCH PROPOSALS.)		WELL API NO. 30-045-07797
1. Type of Well: Oil Well <input type="checkbox"/> Gas Well <input checked="" type="checkbox"/> Other		5. Indicate Type of Lease STATE <input type="checkbox"/> FEE <input checked="" type="checkbox"/>
2. Name of Operator Hilcorp Energy Company		6. State Oil & Gas Lease No.
3. Address of Operator 382 Road 3100, Aztec, NM 87410		7. Lease Name or Unit Agreement Name Keys Gas Com D
4. Well Location Unit Letter <u>N</u> : <u>1170</u> feet from the <u>South</u> line and <u>1590</u> feet from the <u>West</u> line Section <u>29</u> Township <u>29N</u> Range <u>10W</u> NMPM County <u>San Juan</u>		8. Well Number <u>1</u>
11. Elevation (Show whether DR, RKB, RT, GR, etc.) 5557' GL		9. OGRID Number 372171
		10. Pool name or Wildcat Blanco Mesaverde / Basin Dakota

12. Check Appropriate Box to Indicate Nature of Notice, Report or Other Data

NOTICE OF INTENTION TO:

PERFORM REMEDIAL WORK ☐ PLUG AND ABANDON ☐
TEMPORARILY ABANDON ☐ CHANGE PLANS ☐
PULL OR ALTER CASING ☐ MULTIPLE COMPL ☐
DOWNHOLE COMMINGLE ☒
CLOSED-LOOP SYSTEM ☐
OTHER: ☐

SUBSEQUENT REPORT OF:

REMEDIAL WORK ☐ ALTERING CASING ☐
COMMENCE DRILLING OPNS. ☐ P AND A ☐
CASING/CEMENT JOB ☐
OTHER: ☐

13. Describe proposed or completed operations. (Clearly state all pertinent details, and give pertinent dates, including estimated date of starting any proposed work). SEE RULE 19.15.7.14 NMAC. For Multiple Completions: Attach wellbore diagram of proposed completion or recompletion.

It is intended to recomplete the subject well in the Blanco Mesaverde (Pool 72319) and downhole commingle with the existing Basin Dakota (Pool 71599). The production will be commingled per Oil Conservation Division Order Number 11363. Allocation and methodology will be provided after the well is completed. Commingling will not reduce the value of the production.

Proposed perforations are: MV: 3350' - 4590' and DK: 6202' - 6304'. These perforations are in TMD.

Interest is common. Notification to all interest owners is not required.

DHC #5039

Received by fee portal
7/29/2019

Spud Date:

Rig Release Date:

I hereby certify that the information above is true and complete to the best of my knowledge and belief.

SIGNATURE Cherylene Weston TITLE: Operations/Regulatory Technician-Sr. DATE 7-24-19

Type or print name Cherylene Weston E-mail address: cweston@hilcorp.com PHONE: 505-564-0779

For State Use Only

APPROVED BY: [Signature] TITLE District III Geologist DATE 8/1/2019

Conditions of Approval (if any):

District I

1625 N. French Dr., Hobbs, NM 88240
Phone:(575) 393-6161 Fax:(575) 393-0720

District II

811 S. First St., Artesia, NM 88210
Phone:(575) 748-1283 Fax:(575) 748-9720

District III

1000 Rio Brazos Rd., Aztec, NM 87410
Phone:(505) 334-6178 Fax:(505) 334-6170

District IV

1220 S. St Francis Dr., Santa Fe, NM 87505
Phone:(505) 476-3470 Fax:(505) 476-3462

State of New Mexico
Energy, Minerals and Natural
Resources
Oil Conservation Division
1220 S. St Francis Dr.
Santa Fe, NM 87505

Form C-102
August 1, 2011

Permit 270229

WELL LOCATION AND ACREAGE DEDICATION PLAT

1. API Number 30-045-07797	2. Pool Code 72319	3. Pool Name BLANCO-MESAVERDE (PRORATED GAS)
4. Property Code 321791	5. Property Name KEYS GAS COM D	6. Well No. 001
7. OGRID No. 372171	8. Operator Name HILCORP ENERGY COMPANY	9. Elevation 5557

10. Surface Location

UL - Lot N	Section 29	Township 29N	Range 10W	Lot Idn	Feet From 1170	N/S Line S	Feet From 1590	E/W Line W	County SAN JUAN
---------------	---------------	-----------------	--------------	---------	-------------------	---------------	-------------------	---------------	--------------------

11. Bottom Hole Location If Different From Surface

UL - Lot	Section	Township	Range	Lot Idn	Feet From	N/S Line	Feet From	E/W Line	County
12. Dedicated Acres 320.00 - S/2			13. Joint or Infill		14. Consolidation Code			15. Order No.	

NO ALLOWABLE WILL BE ASSIGNED TO THIS COMPLETION UNTIL ALL INTERESTS HAVE BEEN CONSOLIDATED OR A NON-STANDARD UNIT HAS BEEN APPROVED BY THE DIVISION

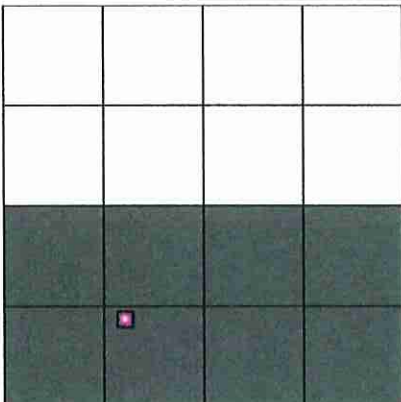
	<p style="text-align: center;">OPERATOR CERTIFICATION</p> <p><i>I hereby certify that the information contained herein is true and complete to the best of my knowledge and belief, and that this organization either owns a working interest or unleased mineral interest in the land including the proposed bottom hole location(s) or has a right to drill this well at this location pursuant to a contract with an owner of such a mineral or working interest, or to a voluntary pooling agreement or a compulsory pooling order heretofore entered by the division.</i></p> <p>E-Signed By: <i>Cherylene Weston</i> Title: Cherylene Weston, Operations/Regulatory Tech-Sr. Date: 07/24/2019</p> <hr/> <p style="text-align: center;">SURVEYOR CERTIFICATION</p> <p><i>I hereby certify that the well location shown on this plat was plotted from field notes of actual surveys made by me or under my supervision, and that the same is true and correct to the best of my belief.</i></p> <p>Surveyed By: JAMES P. LEESE Date of Survey: 4/29/1964 Certificate Number: 1463</p>
---	---

7/24/2019

Well No. 1190, Approved 19 April 1961

Section 29

RECEIVED 27, 1961

Operator: PAN AMERICAN PETROLEUM CORPORATION
 Well No. 1 Unit better 29 Section 29 T10N R1E Line NMPM
 Located 1190 feet From the SOUTH Line 1590 the Line
 County 29 T10N R1E G. I. Elevator REPORT LATER Paid 152. Acres
 Name of Producing Formation DAKOTA BASIN DAKOTA

1. Is the Operator the sole owner in the territory covered by this plat?
 Yes
2. If the answer to question one is "No", give the names of all the owners and the nature of their interest in the territory covered by this plat.
 Yes. X. If answer to question one is "No", give the names of all the owners and the nature of their interest in the territory covered by this plat.
 Communication Agreements being prepared.
3. If the answer to question one is "No", give the names of all the owners and the nature of their interest in the territory covered by this plat.
 Answer

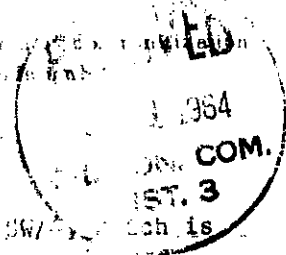

Pan American owns all acreage in S/2 Section 29 except the NE/4 of the SW/4 which is owned by Texas Eastern Transmission Corporation, who has agreed to join in the drilling of this well.

Section 29

Section 29 distances may be from corner to corner

This is to certify that the information in Section 29 is true and complete to the best of my knowledge and belief.

PAN AMERICAN PETROLEUM CORPORATION

F. H. Hollingworth
 F. H. Hollingworth

P. O. Box 432

Farmington, New Mexico

Ref: GPO plat dated 19 April 1961

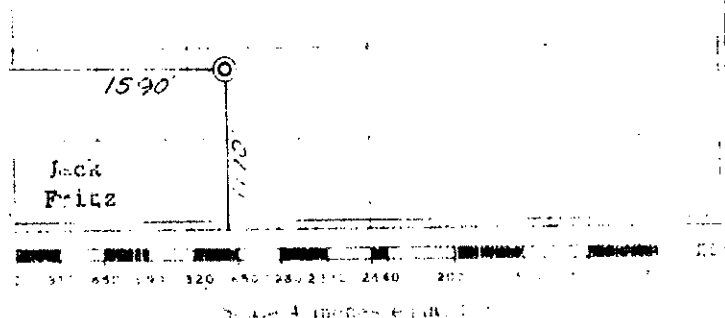

This is to certify that the above plat was prepared from the best of my knowledge and belief.

Date Surveyed 19 April 1961

James P. Lease
 James P. Lease, Surveyor
 1463