

**UNITED STATES
DEPARTMENT OF THE INTERIOR
BUREAU OF LAND MANAGEMENT**

RECEIVED**AUG 17 2011**

Sundry Notices and Reports on Wells

Farmington Field Office

Bureau of Land Management

Lease Number
SF-0795276. If Indian, All. or
Tribe Name7. Unit Agreement Name
San Juan 27-4 Unit8. Well Name & Number
San Juan 27-4 Unit 35C

9. API Well No.

30-039-30413

10. Field and Pool
Blanco MV/Basin DK11. County and State
Rio Arriba, NM1. Type of Well
GAS2. Name of Operator
BURLINGTON
RESOURCES OIL & GAS COMPANY LP

3. Address & Phone No. of Operator

PO Box 4289, Farmington, NM 87499 (505) 326-9700

4. Location of Well, Footage, Sec., T, R, M

Surface: Unit D (NWNW), 1080' FNL & 1025' FWL, Section 26, T27N, R4W, NMPM

BH : Unit C (NENW), 715' FNL & 2010' FWL, Section 26, T27N, R4W, NMPM

12. CHECK APPROPRIATE BOX TO INDICATE NATURE OF NOTICE, REPORT, OTHER DATA

Type of Submission

Type of Action

☐ Notice of Intent☐ Abandonment☐ Change of Plans☒ Other - ☐ Cathodic☒ Subsequent Report☐ Recompletion☐ New Construction☐ Plugging☐ Non-Routine Fracturing☐ Final Abandonment☐ Casing Repair☐ Water Shut off☐ Altering Casing☐ Conversion to Injection**13. Describe Proposed or Completed Operations**

Attached is a drawing for the placement of the cathodic ground, rectifier and cable for the subject well.

14. I hereby certify that the foregoing is true and correct.Signed Denise Journey Denise JourneyTitle: Staff Regulatory TechnicianDate 8-16-11

(This space for Federal or State Office use)

APPROVED BY _____ Title _____ Date _____

CONDITION OF APPROVAL, if any:

Title 18 U.S.C. Section 1001, makes it a crime for any person knowingly and willfully to make any department or agency of the United States any false, fictitious or fraudulent statements or representations as to any matter within its jurisdiction

ACCEPTED FOR RECORD**AUG 18 2011****NMOCD** *AV***FARMINGTON FIELD OFFICE**
BY *MR**pc*



WELL NAME ST 27-4 # 35C LEGALS D-26-27-4 COUNTY Rio Arriba

PURPOSED C.P. SYSYTEM: Relocate existing solar to SW corner of location. Trench approx 150' of positive from G1 to solar. Trench approx 200' of #8 neg from proposed well to solar. Trench approx 250' of #8 neg from existing well #35A to solar.

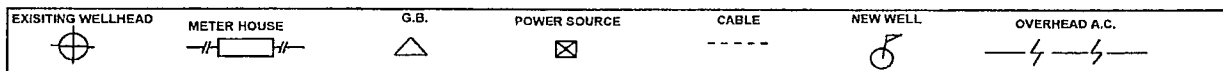
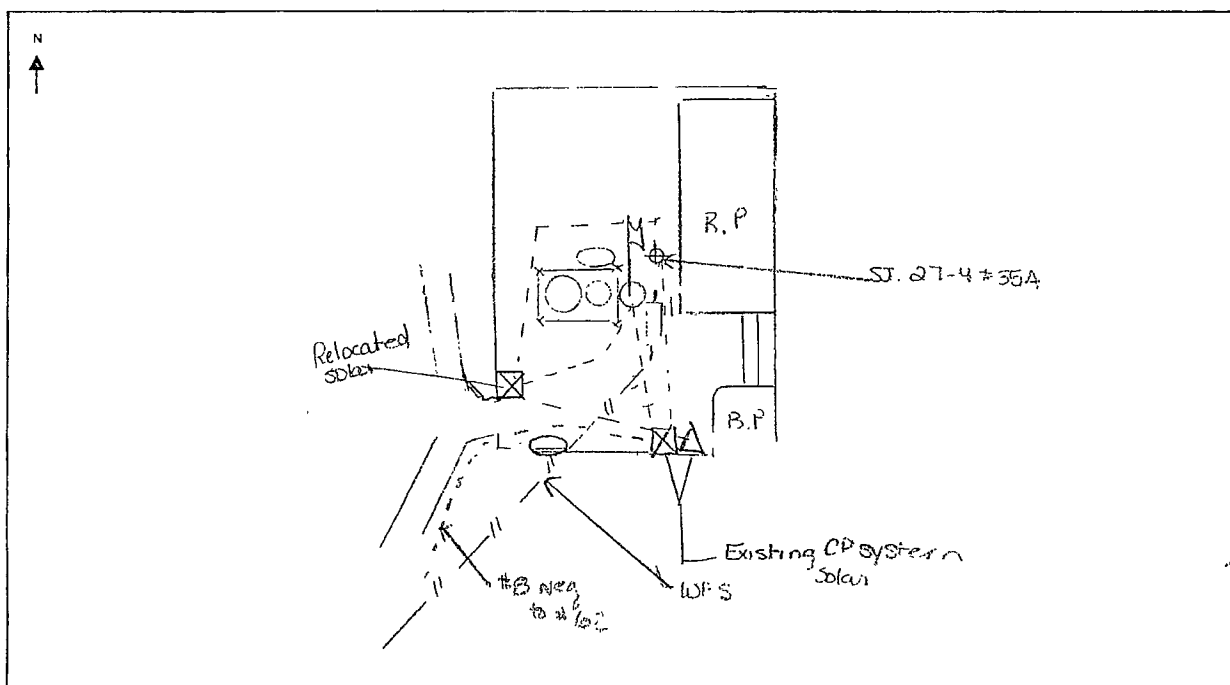

COMMENTS: Actual stakes and drawing differ / drawn according to actual in location
stakes / 3.4 v / 5.3 a = .6 ohm G.B 2 wells attached after beam

NEAREST POWER SOURCE N/A DISTANCE: _____
PIPELINES IN AREA: WFS P/L

TECHNICIAN: Hall/Hogson DATE: 8/16/2007

6 CR 5412 BLOOMFIELD, N.M. 87413
OFFICE: 505-634-0271 CELL: 505-793-6953