

RECEIVED

**UNITED STATES
DEPARTMENT OF THE INTERIOR
BUREAU OF LAND MANAGEMENT**

SEP 27 2011

Sundry Notices and Reports on Wells

Farmington Field Office
Bureau of Land Management

1. Type of Well
GAS

5. Lease Number
SF-077833A
6. If Indian, All. or
Tribe Name
7. Unit Agreement Name

2. Name of Operator
BURLINGTON
RESOURCES OIL & GAS COMPANY LP

3. Address & Phone No. of Operator

PO Box 4289, Farmington, NM 87499 (505) 326-9700

8. Well Name & Number
MANSFIELD #2R

9. API Well No.

30-045-28513

4. Location of Well, Footage, Sec., T, R, M

Surface: Unit N (SESW), 945' FSL & 830' FWL, Section 19, T30N, R9W, NMPM

10. Field and Pool
Blanco Mesaverde

11. County and State
San Juan, NM

12. CHECK APPROPRIATE BOX TO INDICATE NATURE OF NOTICE, REPORT, OTHER DATA

Type of Submission

Type of Action

☐ Notice of Intent

☐ Abandonment

☐ Change of Plans

☒ Other -- ☐ Cathodic

☒ Subsequent Report

☐ Recompletion

☐ New Construction

☐ Plugging

☐ Non-Routine Fracturing

☐ Casing Repair

☐ Water Shut off

☐ Final Abandonment

☐ Altering Casing

☐ Conversion to Injection

13. Describe Proposed or Completed Operations

Attached is a drawing for the **UPGRADE**/ placement of the cathodic ground, rectifier and cable for the subject well.

ACCEPTED FOR RECORD**SEP 28 2011**

FARMINGTON FIELD OFFICE
BY Denise Journey

14. I hereby certify that the foregoing is true and correct.

Signed Denise Journey Denise Journey

Title: Staff Regulatory Technician

Date 9-21-11

(This space for Federal or State Office use)

APPROVED BY _____ Title _____ Date _____

CONDITION OF APPROVAL, if any:

Title 18 U.S.C. Section 1001, makes it a crime for any person knowingly and willfully to make any department or agency of the United States any false, fictitious or fraudulent statements or representations as to any matter within its jurisdiction

NMOC

pc

Mansfield #2R

Section 09, T30N, R09W, N.M.P.M., San Juan County, NM

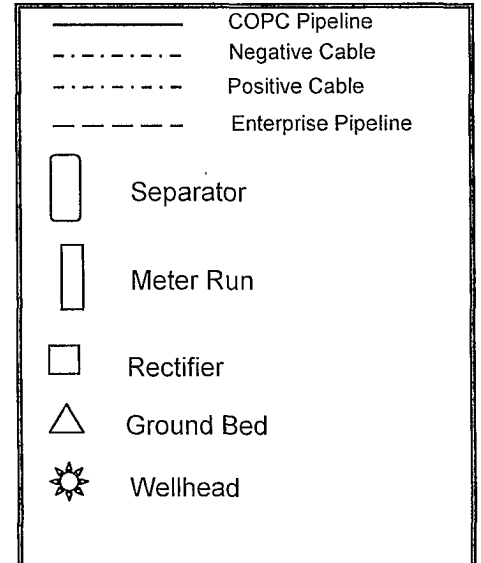
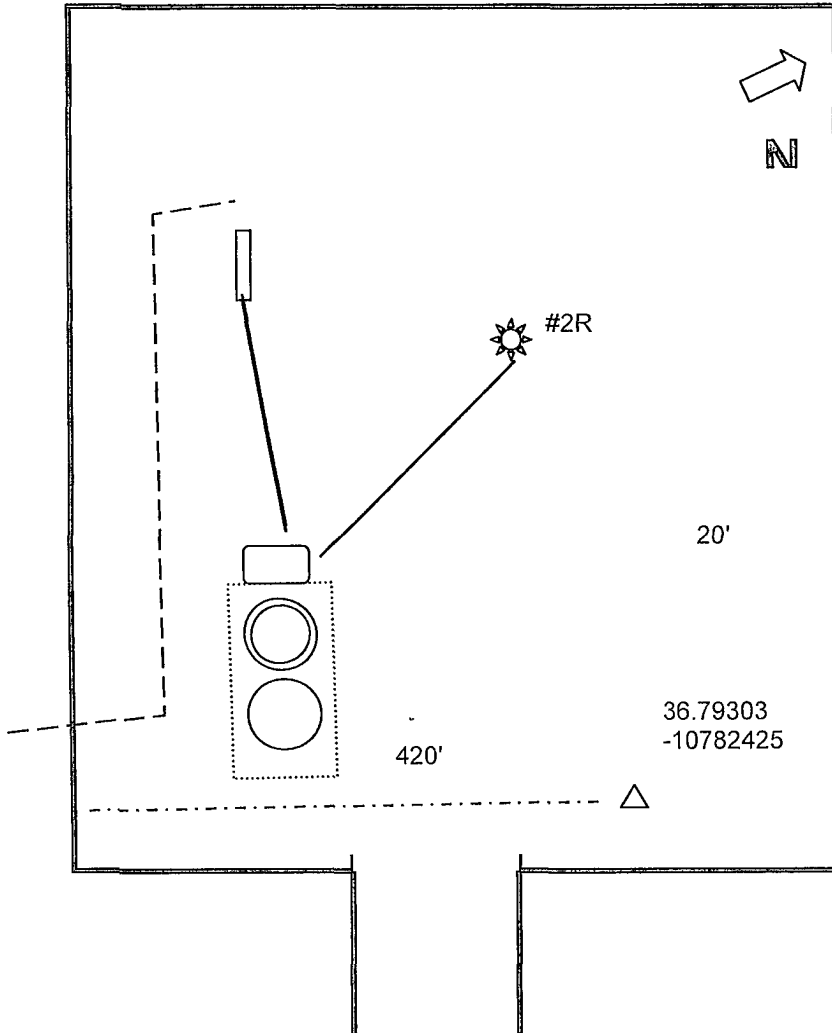

Drill ground bed approximately 105' east of #2R wellhead at staked location. Replace existing rectifier with a 40-16 rectifier at meter pole approx 420' southwest at bottom of cliff. Trench positive cable to base of cliff, then encase in PVC to top of cliff (approx 105' of PVC required) where cable must again be trenched to new groundbed. Reconnect existing negative cable and repair as needed.

#2R Cables:

Positive: 420'

Total Ditch: 315'