

UNITED STATES
DEPARTMENT OF THE INTERIOR
BUREAU OF LAND MANAGEMENT

FORM APPROVED
OMB NO 1004-0137
Expires July 31, 2010

RECEIVED

SUNDRY NOTICES AND REPORTS ON WELLS

Do not use this form for proposals to drill or to re-enter an abandoned well. Use Form 3160-3 (APD) for such proposals.

APR 5 2012

Well Lease Serial No
NM-99003

Indian, Allottee or Tribe Name

SUBMIT IN TRIPLICATE - Other instructions on page 2

Farmington Field Office
Bureau of Land Management

Unit or CA/Agreement, Name and/or No

1 Type of Well
 Oil Well Gas Well Other

2 Name of Operator
XTO ENERGY INC.

3a Address **382 CR 3100 AZTEC, NM 87410**

3b Phone No (include area code) **505-333-3630**

4 Location of Well (Footage, Sec, T., R., M., or Survey Description)
890' FNL & 909' FWL NWNW SEC. 31 (D) - T30N-R14W

8 Well Name and No
WF FEDERAL 31 #2

9 API Well No
30-045-30726

10. Field and Pool, or Exploratory Area
**TWIN MOUNDS FS PC/
 BASIN FRUITLAND COAL**

11 County or Parish, State
SAN JUAN NM

12. CHECK APPROPRIATE BOX(ES) TO INDICATE NATURE OF NOTICE, REPORT, OR OTHER DATA

TYPE OF SUBMISSION	TYPE OF ACTION
<input type="checkbox"/> Notice of Intent	<input type="checkbox"/> Acidize <input type="checkbox"/> Deepen <input type="checkbox"/> Production (Start/Resume) <input type="checkbox"/> Water Shut-Off
<input checked="" type="checkbox"/> Subsequent Report	<input type="checkbox"/> Alter Casing <input type="checkbox"/> Fracture Treat <input type="checkbox"/> Reclamation <input type="checkbox"/> Well Integrity
<input type="checkbox"/> Final Abandonment Notice <i>BP</i>	<input type="checkbox"/> Casing Repair <input type="checkbox"/> New Construction <input type="checkbox"/> Recomplete <input checked="" type="checkbox"/> Other BELOW GRADE
	<input type="checkbox"/> Change Plans <input type="checkbox"/> Plug and Abandon <input type="checkbox"/> Temporarily Abandon MARKER
	<input type="checkbox"/> Convert to Injection <input type="checkbox"/> Plug Back <input type="checkbox"/> Water Disposal

13 Describe Proposed or Completed Operation (clearly state all pertinent details, including estimated starting date of any proposed work and approximate duration thereof. If the proposal is to deepen directionally or recomplete horizontally, give subsurface locations and measured and true vertical depths of all pertinent markers and zones. Attach the Bond under which the work will be performed or provide the Bond No. on file with BLM/BIA. Required subsequent reports shall be filed within 30 days following completion of the involved operations. If the operation results in a multiple completion or recompletion in a new interval, a Form 3160-4 shall be filed once testing has been completed. Final Abandonment Notices shall be filed only after all requirements, including reclamation, have been completed, and the operator has determined that the final site is ready for final inspection.)

XTO Energy Inc. has set an underground plate instead of a 4" above ground marker to prevent stray electrical currents from entering the underground coal mine. Please find the attached certified survey dated 3/13/12.

RCVD APR 17 '12
OIL CONS. DIV.
DIST. 3

14 I hereby certify that the foregoing is true and correct
 Name (Printed/Typed) **SHERRY J. MORROW** Title **REGULATORY ANALYST**

Signature *Sherry J. Morrow* Date **4/2/2012**

THIS SPACE FOR FEDERAL OR STATE OFFICE USE

Approved by *Mark Kelly* Title **ENVIRONMENTAL COMPLIANCE TEAM LEAD** Date **4-10-12**

Conditions of approval, if any, are attached. Approval of this notice does not warrant or certify that the applicant holds legal or equitable title to those rights in the subject lease which would entitle the applicant to conduct operations thereon

Title 18 U.S.C. Section 1001, and Title 43 U.S.C. Section 1212, makes it a crime for any person knowingly and willfully to make to any department or agency of the United States any false, fictitious or fraudulent statements or representations as to any matter within its jurisdiction

NMOCD

AV

P & A WELL SURVEY
XTO WF FED. 31-2 WELL LOCATED IN THE
NW/4 NW/4 SECTION 31, T.30N., R.14W.,
N.M.P.M., SAN JUAN COUNTY, NEW MEXICO.

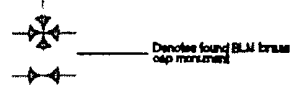
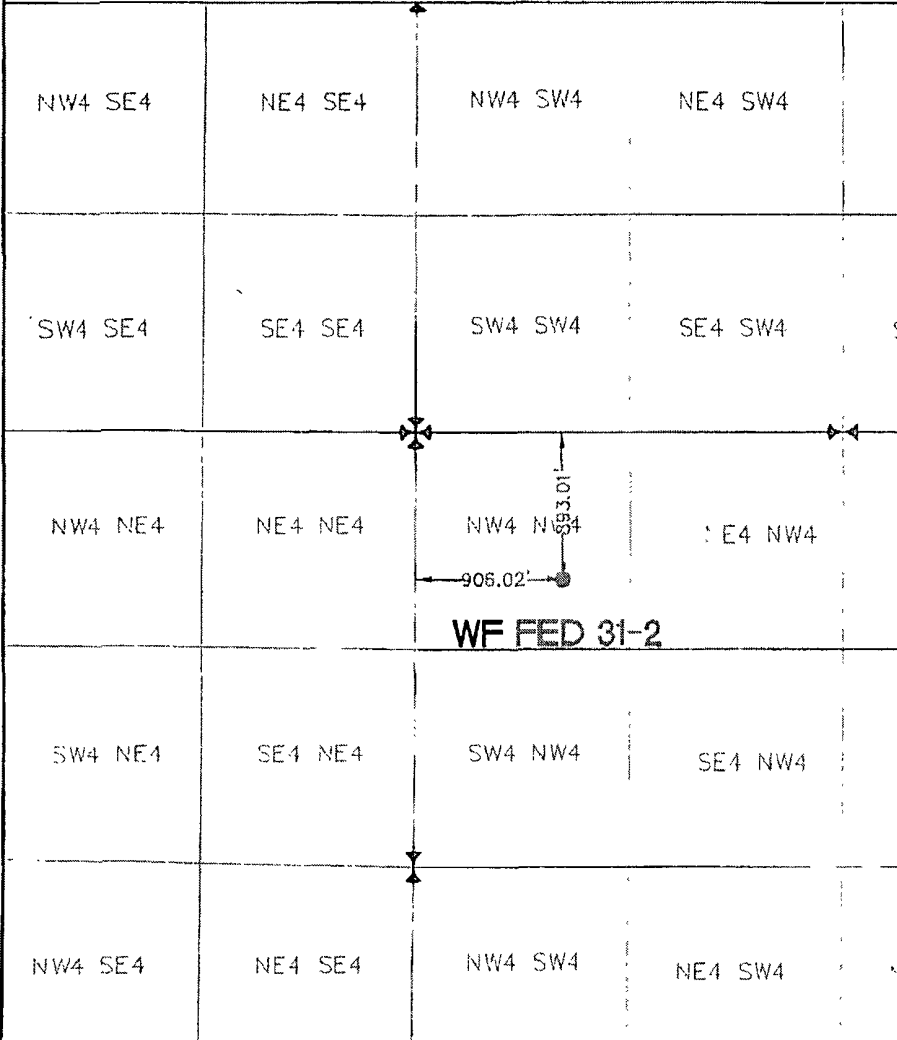

NAD 1927 NEW MEXICO WEST

**N:210196108
 E:346962.45
 EL 5355**

**Lat 38 48 31.83952
 Long 108 21 23.42735**



SCALE: 1"=500'

BASIS OF BEARING:
 STATIC C.P.S. SURVEY SOLUTIONS
 OBTAINED FROM SATELLITES TRACKED
 APRIL, 2003. REFERENCE H.A.R.N.
 NETWORK POINTS FMN 0 AND E42.
 BEARING N 86°57'34" W (NAD83
 NEW MEXICO WEST) SCALE FACTOR
 = 0.99968810

I, Peter Epp, a Registered Professional Surveyor under the laws of the State of New Mexico, hereby certify that this plat was prepared from the field notes of a actual survey meeting the minimum requirements of the standards for easement surveys and is true and correct to the best of my knowledge and belief.



Peter Epp P.L.S. New Mexico # 15612

Date: 13 MAR 12

CHECKED BY PR

DRAWN BY RC



EPP & ASSOCIATES, INC.
PROFESSIONAL LAND SURVEYORS

433 4th Avenue West
 P.O. Box 837
 Craig, CO 81625

Phone (970) 824-8216
 Fax (970) 824-5227

Prepared for:
 State of New Mexico
 Oil Conservation Commission