

UNITED STATES
DEPARTMENT OF THE INTERIOR
BUREAU OF LAND MANAGEMENT

RECEIVED

FORM APPROVED
OMB NO 1004-0137
Expires July 31, 2010

SUNDRY NOTICES AND REPORTS ON WELLS

APR 20 2012

Do not use this form for proposals to drill or to re-enter an abandoned well. Use Form 3160-3 (APD) for such proposals.
Burlington Field Office
Bureau of Land Management

SUBMIT IN TRIPLICATE - Other instructions on page 2

1. Type of Well

☐ Oil Well ☒ Gas Well ☐ Other

2. Name of Operator

XTO ENERGY INC.

3a. Address

382 CR 3100 AZTEC, NM 87410

3b. Phone No (include area code)

505-333-3630

4. Location of Well (Footage, Sec, T, R, M, or Survey Description)

732' FNL & 928' FWL NWNW SEC.30 (D) -T30N-R14W N.M.P.M.

5. Lease Serial No.

NMM-99003

6. If Indian, Allottee or Tribe Name

7. If Unit or CA/Agreement, Name and/or No

8. Well Name and No

WF FEDERAL 30 #4

9. API Well No

30-045-30725

10. Field and Pool, or Exploratory Area

BASIN FRUITLAND COAL/
TWIN MOUNDS PC

11. County or Parish, State

SAN JUAN NM

12. CHECK APPROPRIATE BOX(ES) TO INDICATE NATURE OF NOTICE, REPORT, OR OTHER DATA

TYPE OF SUBMISSION

☐ Notice of Intent

☒ Subsequent Report

☐ Final Abandonment Notice

TYPE OF ACTION

☐ Acidize

☐ Alter Casing

☐ Casing Repair

☐ Change Plans

☐ Convert to Injection

☐ Deepen

☐ Fracture Treat

☐ New Construction

☒ Plug and Abandon

☐ Plug Back

☐ Production (Start/Resume)

☐ Reclamation

☐ Recomplete

☐ Temporarily Abandon

☐ Water Disposal

☐ Water Shut-Off

☐ Well Integrity

☒ Other BELOW GRADE

MARKER

13. Describe Proposed or Completed Operation (clearly state all pertinent details, including estimated starting date of any proposed work and approximate duration thereof. If the proposal is to deepen directionally or recompleat horizontally, give subsurface locations and measured and true vertical depths of all pertinent markers and zones. Attach the Bond under which the work will be performed or provide the Bond No. on file with BLM/BIA. Required subsequent reports shall be filed within 30 days following completion of the involved operations. If the operation results in a multiple completion or recompleat in a new interval, a Form 3160-4 shall be filed once testing has been completed. Final Abandonment Notices shall be filed only after all requirements, including reclamation, have been completed, and the operator has determined that the final site is ready for final inspection.)

XTO Energy Inc. has plugged and abandoned this well per the attached summary report.

XTO Energy Inc. has set an underground plate instead of a 4" above ground marker to prevent stray electrical currents from entering the underground coal mine. Please find the attached certified survey dated 3/12/12.

RCVD APR 25 '12
OIL CONS. DIV.

DIST. 3

14. I hereby certify that the foregoing is true and correct
Name (Printed/Typed)

SHERRY J. MORROW

Title REGULATORY ANALYST

Signature

Sherry J. Morrow

Date 4/19/2012

ACCEPTED FOR RECORD

THIS SPACE FOR FEDERAL OR STATE OFFICE USE

Approved by

Title

APR 23 2012

Conditions of approval, if any, are attached. Approval of this notice does not warrant or certify that the applicant holds legal or equitable title to those rights in the subject lease which would entitle the applicant to conduct operations thereon.

Office

BURLINGTON FIELD OFFICE
BY *SM*

Title 18 U.S.C. Section 1001, and Title 43 U.S.C. Section 1212, makes it a crime for any person knowingly and willfully to make to any department or agency of the United States any false, fictitious or fraudulent statements or representations as to any matter within its jurisdiction.

NMOCD

WF Federal 30 #4

4/4/2012 MIRU. TOH rods & pmp. TOH 2-3/8" tbg.

4/5/2012 Plug #1 w/50 sx Type B cmt (mixed @ 15.6 ppg, 1.18 cu ft/sx). Cmt plg fr/1,028' - 370'. Sqz 1/2 bbl cmt into perms. Joe Ruybalid w/BLM on loc. Mill depths OK'd fr/908' - 932' by Brandon Powell w/NMOCD & Joe Ruybalid w/BLM.

4/12/2012 Ran GR/Caliber log fr/946' - 800'. Logged showed ml section fr/908' - 932' completely remvd. RIH w/csg gun & perfd sqz holes @ 866' & 816' w/3 JSPF, 6 holes. Plug #2 w/62 sx Type B cmt (mixed @ 15.6 ppg, 1.18cu ft/sx). Cmt plg fr/946' - 129' Sqz 1/2 bbl cmt Joe Ruybalid w/BLM on loc.

4/13/2012 Plug #3 w/26 sx Type B cmt (mixed @ 15.6 ppg, 1.18 cu ft/sx). Circ gd cmt fr/csg vlv. Cmt plg fr/297' - surf. Dug out fr/WH. Cut off WH. Topped off 4-1/2" csg & set below grade DH marker w/12 sx Type B cmt (mixed @ 15.6 ppg, 1.18 cu ft/sx) RDMO.

P & A WELL SURVEY
XTO WF FED. 30-4 WELL LOCATED IN THE
NW/4 NW/4 SECTION 30, T.30N., R.14W.,
N.M.P.M., SAN JUAN COUNTY, NEW MEXICO.

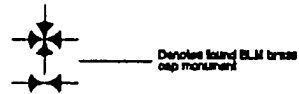
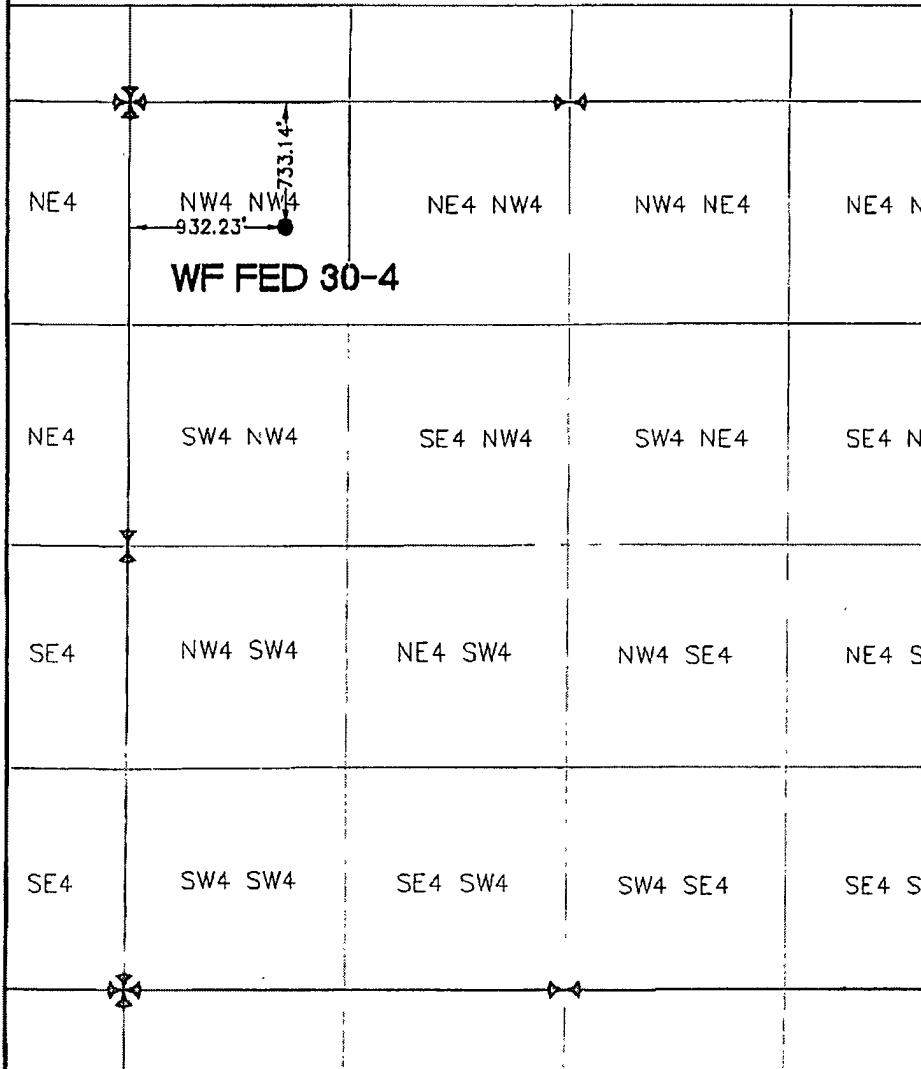

**NAD 1927 NEW
MEXICO WEST**

**N210737158
E347015.75
El. 5492**

**Lat 36 47 25.84284
Long 108 21 23.13828**

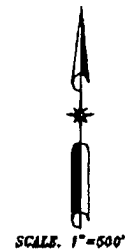

BASIS OF BEARING:
STATIC C.P.S. SURVEY SOLUTIONS
OBTAINED FROM SATELLITES TRACKED
APRIL, 2003. REFERENCE N.A.S.N.
NETWORK POINTS FMN 0 AND E432.
BEARING N 86°57'84" W (NAD83
NEW MEXICO WEST) SCALE FACTOR
= 0.99984910

I, Peter Epp, a Registered Professional Surveyor under the laws of the State of New Mexico, hereby certify that this plat was prepared from the field notes of a actual survey meeting the minimum requirements of the standards for easement surveys and is true and correct to the best of my knowledge and belief.



Peter Epp P.L.S. New Mexico L.S. # 15512

Date: 12 MAR 12

CHECKED BY PE

DRAWN BY RC



EPP & ASSOCIATES, INC.
PROFESSIONAL LAND SURVEYORS

433 4th Avenue West
P.O. Box 837
Craig, CO 81625

Phone (970) 824-8236
Fax (970) 824-5227

Prepared for:
State of New Mexico
Oil Conservation Commission