

submitted in lieu of Form 3160-5

UNITED STATES
DEPARTMENT OF THE INTERIOR
BUREAU OF LAND MANAGEMENT
Sundry Notices and Reports on Wells

1. Type of Well	X – Gas	___ Oil	5. Lease Number	NMNM-27024
2. Name of Operator	ConocoPhillips c/o BHP Billiton San Juan Coal		6. If Indian, All. or Tribe Name	
3. Address & Phone No. of Operator	PO Box 561, Waterflow, NM 87421 (505) 598-2000		7. Unit Agreement Name	
Location of Well, Footage, Sec., T, R, M	1825' FSL & 990' FWL, Section 30, T-30-N, R-14-W,		8. Well Name & Number	Twin Mounds 30 #2
			9. API Well No.	30-045-25816
			10. Field and Pool	Basin Dakota Gallup
			11. County & State	San Juan County, NM

12. CHECK APPROPRIATE BOX TO INDICATE NATURE OF NOTICE, REPORT, OTHER DATA

Type of Submission

Type of Action

___ Notice of Intent

___ Abandonment

___ Change of Plans

X Subsequent Report

___ Recompletion

___ New Construction

___ Plugging Back

___ Non-Routine Fracturing

___ Casing Repair

___ Water Shut off

___ Final Abandonment

___ Altering Casing

___ Conversion to Injection

X Other – Below Grade Marker

RCVD AUG 3 '12

OIL CONS. DIV.

DIST. 3

13. Describe Proposed or Completed Operations

BHP – San Juan Coal for ConocoPhillips has set an underground plate instead of a 4" above ground marker to prevent stray electrical currents from entering the underground coal mine. Please find the attached certified survey.

14. I hereby certify that the foregoing is true and correct.

Signed William Clark Title _____ Contractor _____ Date July 10, 2012
William Clark

Type or print name _____ E-mail address: billc@apluswell.com PHONE: (505)325-2627

(This space for Federal or State Office use)

APPROVED BY Brie Innes Title Branch Chief Environmental Date 7/16/12
CONDITION OF APPROVAL, if any.

Title 18 U.S.C. Section 1001, makes it a crime for any person knowingly to make to any department or agency of the United States any false, fictitious or fraudulent statements or representations as to any matter within its jurisdiction.

NMOCD

P & A WELL SURVEY
CONOCO MESA TWIN NO. 30-2 WELL LOCATED IN THE
NW/4 SW/4 SECTION 30, T.30N., R.14W.,
N.M.P.M., SAN JUAN COUNTY, NEW MEXICO.

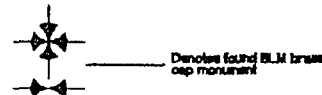
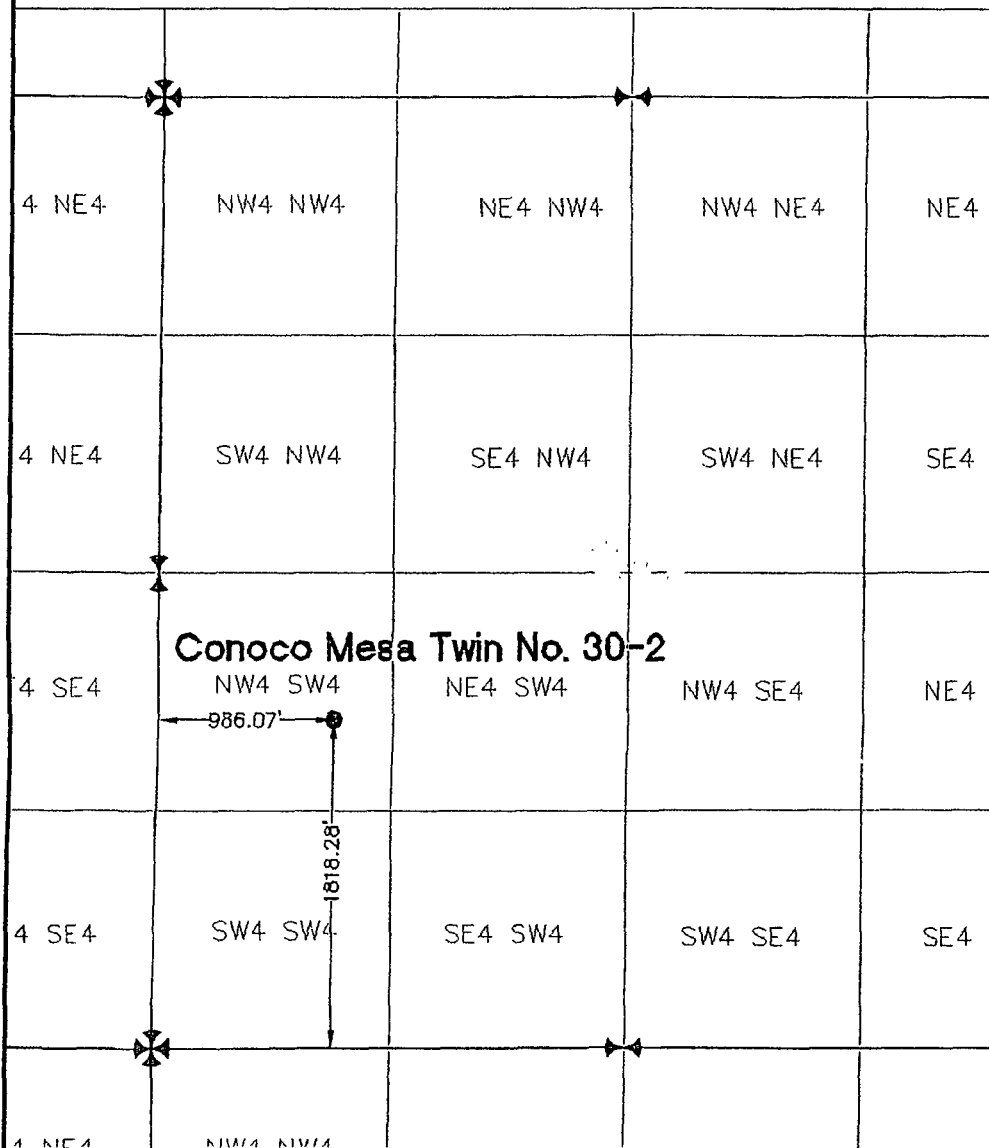

**NAD 1927 NEW
MEXICO WEST**

**N2104672.47
E347057.48
El. 5406**

**Lat 36 46 58.65569
Long: 108 21 22.44198**



SCALE: 1"=500'

BASIS OF BEARING:
STATIC C.F.S. SURVEY SOLUTIONS
OBTAINED FROM SATELLITES TRACKED
APRIL, 2003. REFERENCE N.A.S.N.
NETWORK POINTS FMN 0 AND E492.
BEARING N 86°37'34" W (NAD27
NEW MEXICO WEST) SCALE FACTOR
= 0.99968910

I, Peter Epp, a Registered Professional Surveyor under the laws of the State of New Mexico, hereby certify that this plat was prepared from the field notes of a actual survey meeting the minimum requirements of the standards for easement surveys and is true and correct to the best of my knowledge and belief.

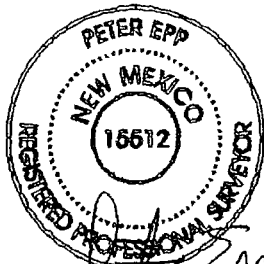

Peter Epp P.L.S. New Mexico L.S. # 15512

Date:

12 MAR 12

CHECKED BY PH

DRAWN BY RC



EPP & ASSOCIATES, INC.
PROFESSIONAL LAND SURVEYORS

433 4th Avenue West
P.O. Box 837
Craig, CO 81625

Phone (970) 824-8236
Fax (970) 824-5227

Prepared for:
State of New Mexico
Oil Conservation Commission