

2005 MAY 19 PM 2 04

UNITED STATES
DEPARTMENT OF THE INTERIOR
BUREAU OF LAND MANAGEMENT

APPLICATION FOR PERMIT TO DRILL OR REENTER

1a. Type of work: <input checked="" type="checkbox"/> DRILL <input type="checkbox"/> REENTER		5. Lease Serial No. NM 03358
1b. Type of Well: <input type="checkbox"/> Oil Well <input checked="" type="checkbox"/> Gas Well <input type="checkbox"/> Other <input type="checkbox"/> Single Zone <input type="checkbox"/> Multiple Zone		6. If Indian, Allottee or Tribe Name
2. Name of Operator Devon Energy Production Company, L.P.		7. If Unit or CA Agreement, Name and No. Northeast Blanco Unit
3a. Address PO Box 6459 Farmington, NM 87419		8. Lease Name and Well No. NEBU 492A
3b. Phone No. (include area code) 505-632-0244		9. API Well No. 30-045-33099
4. Location of Well (Report location clearly and in accordance with any State requirements.)* At surface SE SE, Unit P, 1,030' FSL & 1,165 FEL At proposed prod. zone Same		10. Field and Pool, or Exploratory Basin Fruitland Coal
14. Distance in miles and direction from nearest town or post office* Approximately 10.8 miles		11. Sec., T. R. M. or Blk. and Survey or Area P Sec. 12, T31N, 7W
15. Distance from proposed* location to nearest property or lease line, ft. (Also to nearest drig. unit line, if any) 1,030'		12. County or Parish San Juan
16. No. of acres in lease 2396		13. State NM
17. Spacing Unit dedicated to this well 320 Acres E2		
18. Distance from proposed location* to nearest well, drilling, completed, applied for, on this lease, ft. 3458 ft		20. BLM/BIA Bond No. on file
21. Elevations (Show whether DF, KDB, RT, GL, etc.) GR 6,526'		22. Approximate date work will start* 07/17/2005
		23. Estimated duration Unknown

24. Attachments

The following, completed in accordance with the requirements of Onshore Oil and Gas Order No.1, shall be attached to this form:

- Well plat certified by a registered surveyor.
- A Drilling Plan.
- A Surface Use Plan (if the location is on National Forest System Lands, the SUPO shall be filed with the appropriate Forest Service Office).
- Bond to cover the operations unless covered by an existing bond on file (see Item 20 above).
- Operator certification
- Such other site specific information and/or plans as may be required by the authorized officer.

25. Signature <i>M.S. Z...</i>	Name (Printed/Typed) Melisa Zimmerman	Date 5-17-05
Title Senior Operations Technician		
Approved by (Signature) <i>[Signature]</i>	Name (Printed/Typed) FPO	Date 6-2-05
Title AFM	Office FPO	

Application approval does not warrant or certify that the applicant holds legal or equitable title to those rights in the subject lease which would entitle the applicant to conduct operations thereon.
Conditions of approval, if any, are attached.

Title 18 U.S.C. Section 1001 and Title 43 U.S.C. Section 1212, make it a crime for any person knowingly and willfully to make to any department or agency of the United States any false, fictitious or fraudulent statements or representations as to any matter within its jurisdiction.

*(Instructions on page 2)

District I
 PO Box 1980, Hobbs NM 88241-1980
 District II
 PO Drawer KK, Artesia, NM 87211-0719
 District III
 1000 Rio Brazos Rd., Aztec, NM 87410
 District IV
 PO Box 2088, Santa Fe, NM 87504-2088

State of New Mexico
 Energy, Minerals & Natural Resources Department

OIL CONSERVATION DIVISION
 PO Box 2088
 Santa Fe, NM 87504-2088

Form C-102
 Revised February 21, 1994
 Instructions on back
 Submit to Appropriate District Office
 State Lease - 4 Copies
 Fee Lease - 3 Copies

AMENDED REPORT

WELL LOCATION AND ACREAGE DEDICATION PLAT

1 API Number 30-045-33099		2 Pool Code 76219		3 Pool Name Basin Fruitland Coal	
4 Property Code 19641		5 Property Name NEBU			6 Well Number # 492A
7 OGRID No.		8 Operator Name Devon Energy Production Company, L.P.			9 Elevation 6526

10 Surface Location

UL or Lot No.	Section	Township	Range	Lot Idn	Feet from the	North/South line	Feet from the	East/West line	County
P	12	31 N	7 W		1030	SOUTH	1165	EAST	SAN JUAN

11 Bottom Hole Location If Different From Surface

7 UL or lot no.	Section	Township	Range	Lot Idn	Feet from the	North/South line	Feet from the	East/West line	County

12 Dedicated Acres: 3.0
 13 Joint or Infill:
 14 Consolidation Code:
 15 Order No.:

NO ALLOWABLE WILL BE ASSIGNED TO THIS COMPLETION UNTIL ALL INTERESTS HAVE BEEN CONSOLIDATED OR A NON-STANDARD UNIT HAS BEEN APPROVED BY THE DIVISION

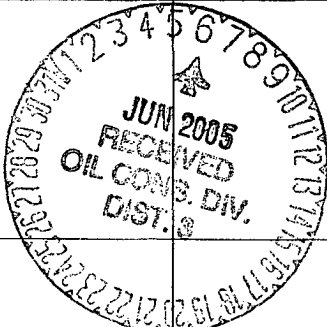
16	5276 (R)		12	5276 (R)		17 OPERATOR CERTIFICATION I hereby certify that the information contained herein is true and complete to the best of my knowledge and belief. Signature: <i>M.S. Zimm</i> Printed Name: Melisa Zimmerman Title: Sr. Operations Tech. Date: 5-17-05	
	5280 (R)					5280 (R)	

Submit 3 Copies To Appropriate District Office
 District I
 1625 N. French Dr., Hobbs, NM 88240
 District II
 1301 W. Grand Ave., Artesia, NM 88210
 District III
 1000 Rio Brazos Rd., Aztec, NM 87410
 District IV
 1220 S. St. Francis Dr., Santa Fe, NM 87505

State of New Mexico
 Energy, Minerals and Natural Resources
OIL CONSERVATION DIVISION
 1220 South St. Francis Dr.
 Santa Fe, NM 87505

Form C-103
 March 4, 2004

SUNDRY NOTICES AND REPORTS ON WELLS (DO NOT USE THIS FORM FOR PROPOSALS TO DRILL OR TO DEEPEN OR PLUG BACK TO A DIFFERENT RESERVOIR. USE "APPLICATION FOR PERMIT" (FORM C-101) FOR SUCH PROPOSALS.)		WELL API NO.
1. Type of Well: Oil Well <input type="checkbox"/> Gas Well <input checked="" type="checkbox"/> Other		5. Indicate Type of Lease STATE <input type="checkbox"/> FEE <input type="checkbox"/>
2. Name of Operator Devon Energy Production Company, L.P.		6. State Oil & Gas Lease No. NM 03358
3. Address of Operator PO Box 6459, Navajo Dam, NM 87419		7. Lease Name or Unit Agreement Name NORTHEAST BLANCO UNIT
4. Well Location Unit Letter <u>P</u> : <u>1,030'</u> feet from the <u>South</u> line and <u>1,165'</u> feet from the <u>East</u> line Section <u>12</u> Township <u>31N</u> Range <u>7W</u> NMPM County - <u>SAN JUAN</u>		8. Well Number 492A
11. Elevation (Show whether DR, RKB, RT, GR, etc.) GR 6,526'		9. OGRID Number 6137
Pit or Below-grade Tank Application (For pit or below-grade tank closures, a form C-144 must be attached)		
Pit Location: UL <u>P</u> Sect <u>12</u> Twp <u>31N</u> Rng <u>7W</u> Pit type <u>Drilling</u> Depth to Groundwater <u>>100'</u> Distance from nearest fresh water well <u>>1000'</u> Distance from nearest surface water <u>>1000'</u> Below-grade Tank Location UL _____ Sect _____ Twp _____ Rng _____ ; _____ feet from the _____ line and _____ feet from the _____ line		

12. Check Appropriate Box to Indicate Nature of Notice, Report or Other Data

NOTICE OF INTENTION TO: PERFORM REMEDIAL WORK <input type="checkbox"/> PLUG AND ABANDON <input type="checkbox"/> TEMPORARILY ABANDON <input type="checkbox"/> CHANGE PLANS <input type="checkbox"/> PULL OR ALTER CASING <input type="checkbox"/> MULTIPLE COMPLETION <input type="checkbox"/> OTHER: CONSTRUCT DRILLING PIT <input checked="" type="checkbox"/>		SUBSEQUENT REPORT OF: REMEDIAL WORK <input type="checkbox"/> ALTERING CASING <input type="checkbox"/> COMMENCE DRILLING OPNS. <input type="checkbox"/> PLUG AND ABANDONMENT <input type="checkbox"/> CASING TEST AND CEMENT JOB <input type="checkbox"/> OTHER: <input type="checkbox"/>	
--	--	---	--

13. Describe proposed or completed operations. (Clearly state all pertinent details, and give pertinent dates, including estimated date of starting any proposed work). SEE RULE 1103. For Multiple Completions: Attach wellbore diagram of proposed completion or recompletion.

14. **Devon Energy will be constructing a lined drilling pit. The closure of said pit will be in accordance with the NMOCD regulations with the cutting of the liner applying to the BLM rules.**

I hereby certify that the information above is true and complete to the best of my knowledge and belief. I further certify that any pit or below-grade tank has been/will be constructed or closed according to NMOCD guidelines , a general permit or an (attached) alternative OCD-approved plan .

SIGNATURE M.S. Zi TITLE Sr. Operations Technician DATE 5-17-05

Type or print name Melisa Zimmerman E-mail address: Melisa.zimmerman@dvn.com Telephone No. 405-552-7917

(This space for State use)

APPROVED BY [Signature] TITLE DEPUTY OIL & GAS INSPECTOR, DIST. #3 DATE JUN - 6 2005
 Conditions of approval, if any: _____

PAD LAYOUT PLAN & PROFILE
DEVON ENERGY PRODUCTION COMPANY, L.P.
 Nebu # 492A
 1030' F/SL 1165' F/EL
 SEC. 12, T31N, R7W, N.M.P.M.
 SAN JUAN COUNTY, NEW MEXICO

Lat: 36°54'35"
 Long: 107°31'02"

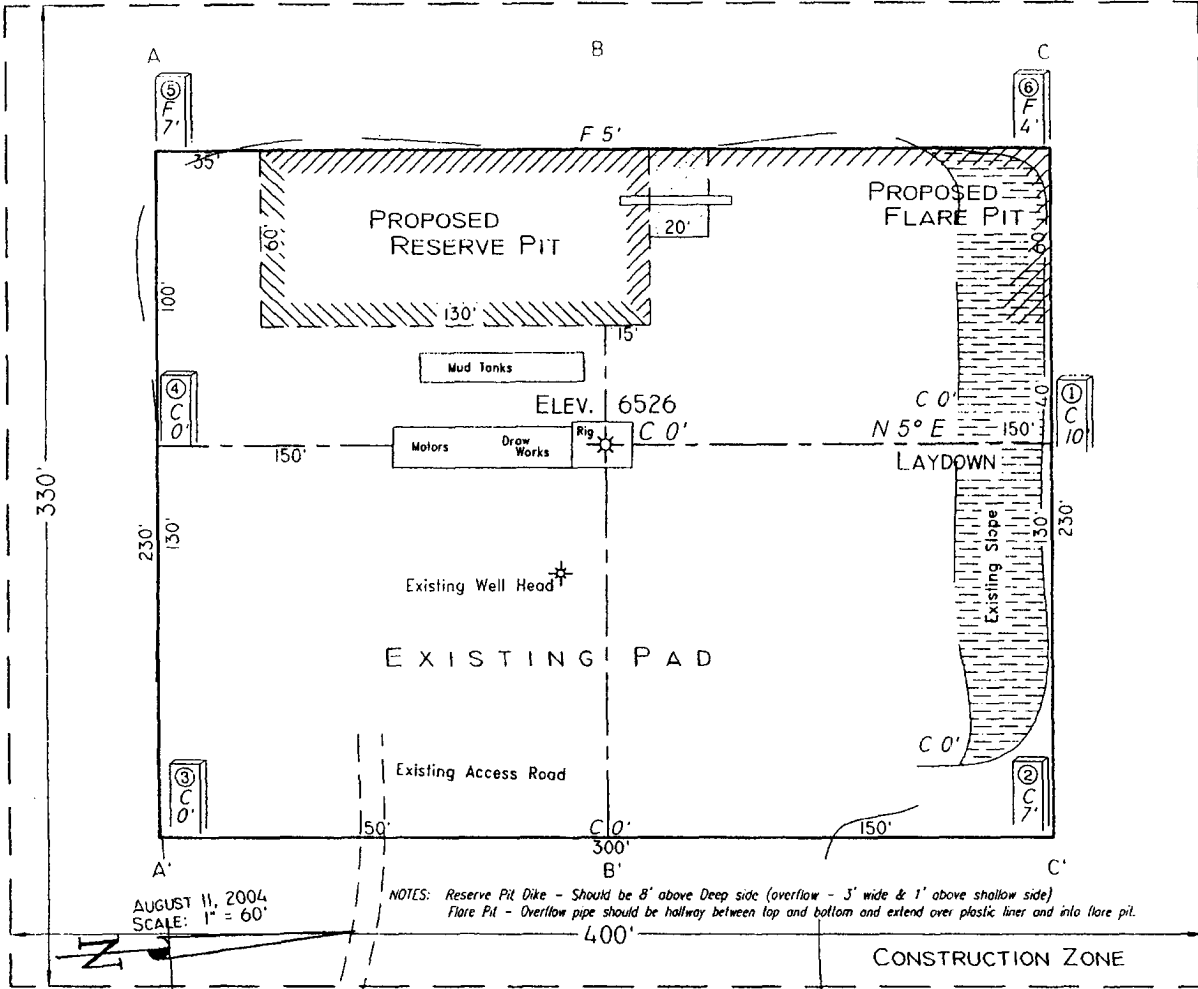

AUGUST 11, 2004
 SCALE: 1" = 60'

NOTES: Reserve Pit Dike - Should be 8' above Deep side (overflow - 3' wide & 1' above shallow side)
 Flare Pit - Overflow pipe should be halfway between top and bottom and extend over plastic liner and into flare pit.

Area of Construction Zone - 330'x400' or 3.03 acres, more or less.

SCALE: 1"=60'-HORIZ.
 1"=40'-VERT.

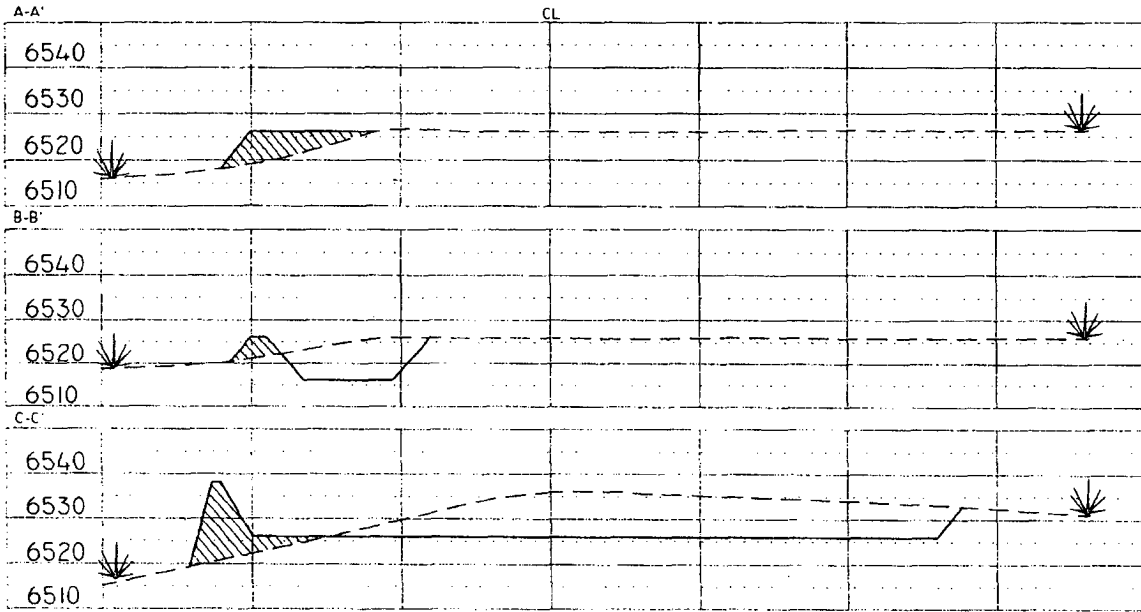

NOTE: Contractor should call One-Call for location of any marked or unmarked buried pipelines or cables on well pad and/or access road at least two (2) working days prior to construction.

Cuts and fills shown are approximate - final finished elevation is to be adjusted so earthwork will balance. Corner stakes are approximate and do not include additional areas needed for sideslopes and drainages. Final Pad Dimensions are to be verified by Contractor.

VANN SURVEYS
 P. O. Box 1306
 Farmington, NM

NEBU 492A

The referenced well is located inside the High Productivity Area of the Basin Fruitland Coal Pool. The subject well is in the participating area of the Northeast Blanco Unit. No notification is required per R-8768-F.

**NEBU 492A
Unit P 12-31N-7W
San Juan Co., NM**

DRILLING PLAN

1. ESTIMATED TOPS OF IMPORTANT GEOLOGIC MARKERS & ANTICIPATED WATER, OIL, GAS OR MINERAL FORMATIONS:

Formation	TVD (ft)	Hydrocarbon/Water Bearing Zones
San Jose	Surface	
Ojo Alamo	2407	Aquifer
Kirtland	2524	
Fruitland	2991	Gas
Pictured Cliffs Tongue	3335	
Pictured Cliffs Main	3458	Gas
PTD	3558	

All shows of fresh water and minerals will be adequately protected and reported. A 100' sump will be drilled into the Picture cliffs. A mud logger will be on location collecting samples and measuring gas levels. Should the Picture Cliffs interval appear to be productive the sump will be filled with cuttings and abandoned

2. PRESSURE CONTROL EQUIPMENT:

All well control equipment shall be in accordance with Onshore Order #2 for 2M systems.

The minimum specifications for pressure control equipment that will be provided are included on the attached schematic diagram, which shows the size, and pressure ratings.

- 2000# BOP With Pipe Rams and 2000# BOP With Blind Rams

Auxiliary equipment to be used:

- Upper kelly cock with handle available.

The manifold includes appropriate valves and adjustable chokes. The kill line will have one check valve. Ram type preventers will be pressure tested to full working pressure (utilizing a test plug) or 70% of the internal yield pressure (without a test plug) at:

- Initial installation
- Whenever any seal subject to test pressure is broken
- Following related repairs

UNITED STATES
DEPARTMENT OF THE INTERIOR
BUREAU OF LAND MANAGEMENT

FORM APPROVED
OMB No. 1004-0137
Expires: March 31, 2007

SUNDRY NOTICES AND REPORTS ON WELLS

Do not use this form for proposals to drill or to re-enter an abandoned well. Use Form 3160-3 (APD) for such proposals.

5. Lease Serial No.
NM 03358

6. If Indian, Allottee or Tribe Name

7. If Unit or CA/Agreement, Name and/or No.
Northeast Blanco Unit

8. Well Name and No.
NEBU 492A

9. API Well No.
3004533099

10. Field and Pool, or Exploratory Area
Basin Fruitland Coal

11. County or Parish, State
San Juan, NM

SUBMIT IN TRIPLICATE- Other instructions on reverse side.

1. Type of Well
 Oil Well Gas Well Other

2. Name of Operator
Devon Energy Production Company, L.P.

3a. Address
PO Box 6459, Farmington, NM 87419

3b. Phone No. (include area code)
505-632-0244

4. Location of Well (Footage, Sec., T., R., M., or Survey Description)
SE SE, Unit P, 1,030' FSL & 1,165 FEL, Sec. 12, T31N, R7W

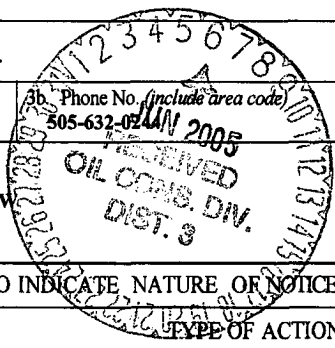

12. CHECK APPROPRIATE BOX(ES) TO INDICATE NATURE OF NOTICE, REPORT, OR OTHER DATA

TYPE OF SUBMISSION	TYPE OF ACTION		
<input checked="" type="checkbox"/> Notice of Intent	<input type="checkbox"/> Acidize	<input type="checkbox"/> Deepen	<input type="checkbox"/> Production (Start/Resume)
<input type="checkbox"/> Subsequent Report	<input type="checkbox"/> Alter Casing	<input type="checkbox"/> Fracture Treat	<input type="checkbox"/> Reclamation
<input type="checkbox"/> Final Abandonment Notice	<input type="checkbox"/> Casing Repair	<input type="checkbox"/> New Construction	<input type="checkbox"/> Recomplete
	<input type="checkbox"/> Change Plans	<input type="checkbox"/> Plug and Abandon	<input type="checkbox"/> Temporarily Abandon
	<input type="checkbox"/> Convert to Injection	<input type="checkbox"/> Plug Back	<input type="checkbox"/> Water Disposal
			<input type="checkbox"/> Water Shut-Off
			<input type="checkbox"/> Well Integrity
			<input checked="" type="checkbox"/> Other Depth Change

13. Describe Proposed or Completed Operation (clearly state all pertinent details, including estimated starting date of any proposed work and approximate duration thereof. If the proposal is to deepen directionally or recomplete horizontally, give subsurface locations and measured and true vertical depths of all pertinent markers and zones. Attach the Bond under which the work will be performed or provide the Bond No. on file with BLM/BIA. Required subsequent reports shall be filed within 30 days following completion of the involved operations. If the operation results in a multiple completion or recompletion in a new interval, a Form 3160-4 shall be filed once testing has been completed. Final Abandonment Notices shall be filed only after all requirements, including reclamation, have been completed, and the operator has determined that the site is ready for final inspection.)

Devon Energy Production Company, L.P. requests permission to shorten the depth of the NEBU 492A. It was originally re-vented to drill to a depth of 3,558'. Please be advised the new depth for said well will be 3,458'.

The 7" casing will be set in the Fruitland Coal Top at 2,991' instead of at 2,524' as stated in the original APD.

14. I hereby certify that the foregoing is true and correct

Name (Printed/Typed) **Melisa Zimmerman** Title **Senior Operations Technician**

Signature *M.S. Zimmerman* Date **5-23-05**

THIS SPACE FOR FEDERAL OR STATE OFFICE USE

Approved by *[Signature]* Title **APM** Date **6-2-05**

Conditions of approval, if any, are attached. Approval of this notice does not warrant or certify that the applicant holds legal or equitable title to those rights in the subject lease which would entitle the applicant to conduct operations thereon.

Office **FPO**

Title 18 U.S.C. Section 1001 and Title 43 U.S.C. Section 1212, make it a crime for any person knowingly and willfully to make to any department or agency of the United States any false, fictitious or fraudulent statements or representations as to any matter within its jurisdiction.

(Instructions on page 2)

- At 30 day intervals

Pipe and blind rams shall be activated each trip.

A BOPE pit level drill will be conducted weekly for each drilling crew.
All tests and drills will be recorded in the drilling log.

The accumulator will have sufficient capacity to close all rams and retain 200 psi above pre-charge pressure without the use of closing unit pumps.

Master controls will be at the accumulator. Anticipated bottom hole pressure is 300 psi.

3. CASING & CEMENTING PROGRAM:

A. The proposed casing program will be as follows:

TVD	Hole Size	Size	Grade	Weight	Thread	Condition
0-285	12-1/4"	9-5/8"	H-40	32#	STC	New
0- 2524 ²⁹⁹¹	8-3/4"	7"	J-55	23#	LTC	New
0- TD	6-1/4"	5-1/2"*	J-55	15.5 #	LTC	New

The 9-5/8" surface pipe will be tested to 750 psi. All casing strings below the surface shoe shall be pressure tested to 0.22 psi/ft. of casing string length or 1500 psi, whichever is greater, but not to exceed 70% minimum internal yield.

Surface: The bottom three joints of the surface casing will have a minimum of one centralizer per joint and one centralizer every joint thereafter (Total 5 centralizers estimated)

7" Casing: The bottom three joints of the 7" casing will have a minimum of one centralizer per joint and one centralizer every fifth joint thereafter to above Ojo Alamo with turbolizers below and throughout the Ojo Alamo. (Total 12 centralizers, 3 turbolizers estimated).

B. The proposed cementing program will be as follows:

Surface String: 9-5/8" Surface cemented in a 12-1/4" hole at 285'.
32.3# H-40 ST&C 8 Rnd
Saw tooth guide shoe
Cemented with 200 sacks Class B mixed at 15.6 ppg w/.25 pps
Celloflake, 2% calcium chloride. Yeild 1.19 ft3/sx ,cement
Designed to circulate to surface.

Production String: 7" Production casing cemented in an 8-3/4" hole
23# J-55 LT&C 8 Rnd

Float collar
 Joint
 Float Shoe
 Cement with 500 sacks Class B 50/50 POZ, 3% gel, 5# gilsonite, 1/4"# Flocele, .1% CFR 3, .2% Halad 344, yield 1.47 ft3/sx. *
 Cement designed to circulate to surface.
 Pending hole conditions, cement baskets may be installed above TD

* *Minor variations possible due to existing hole conditions.*

Liner: 5-1/2" liner*
 15.5# J-55 LT&C 8 Rnd
 Shoe
 Not Cemented

* May not be run pending hole conditions.
 If well does not respond to proposed to completion, the 5 1/2 " liner will be cemented using class B 50/50 POZ, 3% gel, 5# gilsonite, 1/4"# Flocele, .1% CFR 3, .2% Halad 344, yield 1.47 ft3/sx. **

** *Minor variations possible due to existing hole conditions*

4. DRILLING FLUIDS PROGRAM:

TVD	Type	Weight (ppg)	Viscosity	pH	Water Loss	Remarks
0-285	Spud	8.4-9.0	29-70	8.0	NC	FW gel,
285- ²⁹⁴¹ 2824	LSND	8.4-9.0	29-70	8.0	10-12	LCM as needed
²⁹⁴¹ 2824 -TD	Air					Foam as needed

NC = no control

Sufficient quantities of mud material will be maintained on site or be readily accessible for the purpose of assuring well control. SPR will be recorded on daily drilling report after mudding up. Visual mud monitoring will be conducted during operations.

5. EVALUATION PROGRAM:

Wireline Logs: None

Mud Logs: mud logging in Fruitland Coal.

Survey: Deviation surveys will be taken every 500' from 0-TD of 8 3/4" hole or first succeeding bit change.

Cores: None anticipated.

DST's: None anticipated.

6. ABNORMAL CONDITIONS:

The Fruitland Coal will be encountered within the 8 ¾" hole. Estimated formation pressure is 300 psi. No other abnormal pressures and/or temperatures are expected. No hydrogen sulfide should be present.

7. OTHER INFORMATION:

The anticipated starting date and duration of the operation will be as follows:

Starting Date:	Upon Approval
Duration:	20 days

If the well is completed as a dry hole or as a producer, Well Completion or Recompletion Report and Log (Form 3160-4) will be submitted within 30 days after completion of the well or after completion of operations being performed, in accordance with 43 CFR 3160. Copies of all logs, core descriptions, core analyses, well test data, geologic summaries, sample descriptions, daily drilling reports, daily completion reports, and all other surveys or data obtained and compiled during the drilling, completion, and/or workover operations, will be submitted directly to the Authorized Officer or filed with Form 3160-4.

Well Control Equipment 2,000 psi Configuration

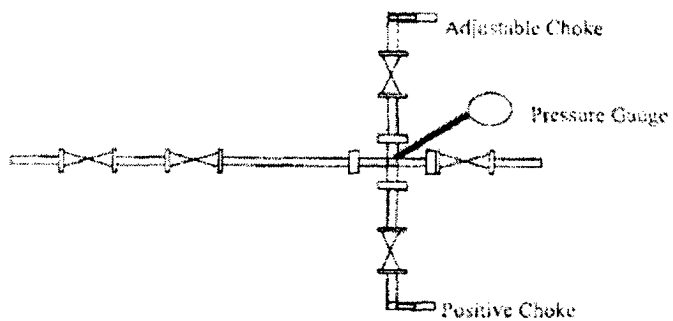
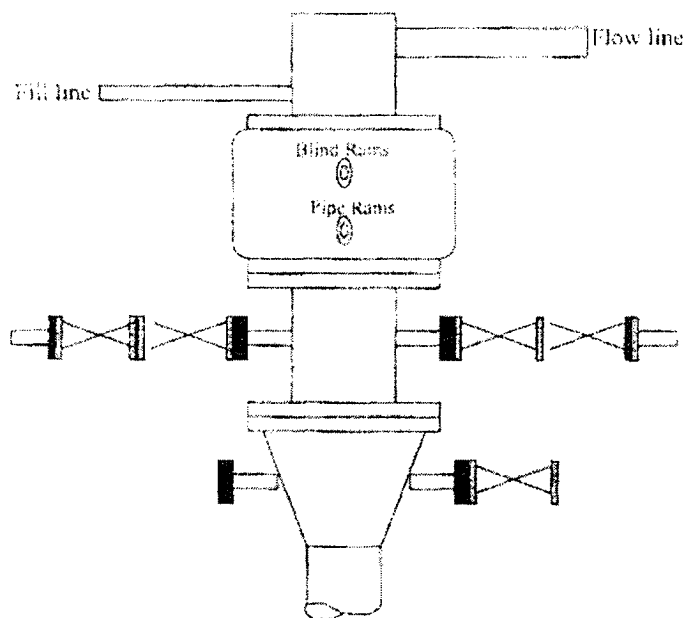

All well control equipment designed to meet or exceed the Onshore Oil and Gas Order No. 2, BLM 43 CTR 3160 requirements for 2M systems.