

26

UNITED STATES
DEPARTMENT OF THE INTERIOR
BUREAU OF LAND MANAGEMENT

APPLICATION FOR PERMIT TO DRILL, DEEPEN, OR PLUG BACK

1a.	Type of Work DRILL	5. Lease Number NMSF-080516-A Unit Reporting Number MV-8910010510 DK-891001051B
2005 JUN 17 PM 2 41 RECEIVED 070 FARMINGTON NM		6. If Indian, All. or Tribe
1b.	Type of Well GAS	7. Unit Agreement Name San Juan 28-5 Unit
2.	Operator BURLINGTON RESOURCES Oil & Gas Company	8. Farm or Lease Name San Juan 28-5 Unit
3.	Address & Phone No. of Operator PO Box 4289, Farmington, NM 87499 (505) 326-9700	9. Well Number #35N
4.	Location of Well 440' FSL, 620' FEL Latitude 36° 38.4426'N, Longitude 107° 23.5824'W	10. Field, Pool, Wildcat Blanco Mesaverde/Basin Dakota
		11. Sec., Twn, Rge, Mer. (NMPM) Sec. 19, T28N, R05W API # 30-039- 29570
14.	Distance in Miles from Nearest Town 31.5 miles to Blanco, NM Post Office	12. County Rio Arriba
		13. State NM
15.	Distance from Proposed Location to Nearest Property or Lease Line 440'	
16.	Acres in Lease	17. Acres Assigned to Well 320 S/2 - MV/DK
18.	Distance from Proposed Location to Nearest Well, Drlg, Compl, or Applied for on this Lease 1845'	
19.	Proposed Depth 7880'	20. Rotary or Cable Tools Rotary
21.	Elevations (DF, FT, GR, Etc.) 6631' GR	22. Approx. Date Work will Start
23.	Proposed Casing and Cementing Program See Operations Plan attached	
24.	Authorized by: <u>Joni Clark</u> Regulatory Specialist	Date <u>6/16/05</u>

PERMIT NO. _____

APPROVAL DATE _____

APPROVED BY BJ Montoya

TITLE AFM

DATE 8-16-05

Archaeological Report attached

Threatened and Endangered Species Report attached

NOTE: This format is issued in lieu of U.S. BLM Form 3160-3

Title 18 U.S.C. Section 1001, makes it a crime for any person knowingly and willfully to make to any department or agency of the United States any false, fictitious or fraudulent statements or presentations as to any matter within its jurisdiction.

This form is subject to technical and procedural review pursuant to 43 CFR 3165.3 and appeal pursuant to 43 CFR 3165.4

NMOC

DRILLING OPERATIONS AUTHORIZED ARE
SUBJECT TO COMPLIANCE WITH ATTACHED
"GENERAL REQUIREMENTS".

DISTRICT II
811 South First, Artesia, N.M. 88210

DISTRICT III
1000 Rio Brazos Rd., Aztec, N.M. 87410

DISTRICT IV
2040 South Pacheco, Santa Fe, NM 87505

OIL CONSERVATION DIVISION

**2040 South Pacheco
Santa Fe, NM 87505**

Submit to Appropriate District Office
State Lease - 4 Copies
Fee Lease - 3 Copies

2005 JUN 17 PM 2:41 AMENDED REPORT

WELL LOCATION AND ACREAGE DEDICATION PLAT RECEIVED

*API Number 30-039- 39570		*Pool Code 72319/71599	070 *Pool Name Blanco Mesaverde/Basin Dakota
*Property Code 7460	*Property Name SAN JUAN 28-5 UNIT		*Well Number 35N
*OGRD No. 14538	*Operator Name BURLINGTON RESOURCES OIL AND GAS COMPANY LP		*Elevation 6631'

¹⁰ Surface Location

UL or lot no.	Section	Township	Range	Lot Idn	Feet from the	North/South line	Feet from the	East/West line	County
P	19	28-N	5-W		440'	SOUTH	620'	EAST	RIO ARriba

¹¹ Bottom Hole Location If Different From Surface

UL or lot no.	Section	Township	Range	Lot Idn	Feet from the	North/South line	Feet from the	East/West line	County
22 Dedicated Acres 320 MV/DK S/2		23 Joint or Infill		24 Consolidation Code		25 Order No.		AUG 2005 RECEIVED OIL CONS. DIV. DIST. 2	

**NO ALLOWABLE WILL BE ASSIGNED TO THIS COMPLETION UNTIL ALL INTERESTS HAVE BEEN CONSOLIDATED
OR A NON-STANDARD UNIT HAS BEEN APPROVED BY THE DIVISION**

16					
		Dm		D	
		m		Dm	
19					
NM SF-080505-B		Dm		NM SF-080516-A	
Dm		LAT: 36°38.4426' N. LONG: 107°23.5824' W. NAD 1927		N 0°-05'-23" W 2635.07'	
		S 89°-49'-56" W 2639.35'		620'	
		440'			

17 OPERATOR CERTIFICATION

I hereby certify that the information contained herein is true and complete to the best of my knowledge and belief

Frances Bond
Signature

Frances Bond
Printed Name

Regulatory Specialist
Title

6/16/05
Date

18 SURVEYOR CERTIFICATION

I hereby certify that the well location shown on this plan was plotted from field notes of actual surveys made by me or under my supervision, and that the same is true and correct to the best of my belief.

Date of Survey 5-17-05

Signature and Seal of Professional Surveyor:
[Signature]
GLN MEXICO
NEW MEXICO
15703
LICENSED PROFESSIONAL SURVEYOR

Certificate Number 15703

Office

Energy, Minerals and Natural Resources

May 27, 2004

District I

1625 N. French Dr., Hobbs, NM 88240

District II

1301 W. Grand Ave., Artesia, NM 88210

District III

1000 Rio Brazos Rd., Aztec, NM 87410

District IV

1220 S. St. Francis Dr., Santa Fe, NM 87505

OIL CONSERVATION DIVISION

1220 South St. Francis Dr.

Santa Fe, NM 87505

WELL API NO.

30-039-

5. Indicate Type of Lease

STATE ☐FEE ☐

6. State Oil & Gas Lease No.

SF-080516-A

7. Lease Name or Unit Agreement Name

San Juan 28-5 Unit

8. Well Number

35N

9. OGRID Number

14538

10. Pool name or Wildcat

Blanco Mesaverde/Basin Dakota

SUNDRY NOTICES AND REPORTS ON WELLS
(DO NOT USE THIS FORM FOR PROPOSALS TO DRILL OR TO DEEPEN OR PLUG BACK TO A
DIFFERENT RESERVOIR. USE "APPLICATION FOR PERMIT" (FORM C-101) FOR SUCH
PROPOSALS.)

1. Type of Well:

Oil Well ☐Gas Well ☒Other ☐

2. Name of Operator

BURLINGTON RESOURCES OIL & GAS COMPANY LP

3. Address of Operator

3401 E. 30TH STREET, FARMINGTON, NM 87402

4. Well Location

Unit Letter P : 440 feet from the South line and 620 feet from the East line
Section 19 Township 28N Range 5W NMPM County Rio Arriba

11. Elevation (Show whether DR, RKB, RT, GR, etc.)

Pit or Below-grade Tank Application

☐ or Closure ☐

Pit type New Drill Depth to Groundwater >100' Distance from nearest fresh water well >1000' Distance from nearest surface water >1000'

Pit Liner Thickness: na mil Below-Grade Tank: Volume bbls; Construction Material

12. Check Appropriate Box to Indicate Nature of Notice, Report or Other Data

NOTICE OF INTENTION TO:

PERFORM REMEDIAL WORK ☐
TEMPORARILY ABANDON ☐
PULL OR ALTER CASING ☐

PLUG AND ABANDON ☐
CHANGE PLANS ☐
MULTIPLE COMPL ☐

OTHER:

New Drill ☒

SUBSEQUENT REPORT OF:

REMEDIAL WORK ☐
COMMENCE DRILLING OPNS. ☐
CASING/CEMENT JOB ☐

ALTERING CASING ☐
P AND A ☐

OTHER: ☐

13. Describe proposed or completed operations. (Clearly state all pertinent details, and give pertinent dates, including estimated date of starting any proposed work). SEE RULE 1103. For Multiple Completions: Attach wellbore diagram of proposed completion or recompletion.

Burlington Resources proposes to construct a new drilling pit and an associated blow/flare pit. Based on Burlington's interpretation of the OCD's risk ranking criteria, the new drilling pit and blow/flare pit will be an unlined pit as detailed in Burlington's Drilling / Workover Pit Construction / Operation Procedures dated April 26, 2004 on file at the NMOCD office. A portion of the blow/flare pit will be designed to manage fluids, and that portion will be unlined, as per the risk ranking criteria. Burlington Resources anticipates closing these pits according to the Drilling / Workover Pit Closure Procedure dated August 2, 2004 on file at the NMOCD office.

I hereby certify that the information above is true and complete to the best of my knowledge and belief. I further certify that any pit or below-grade tank has been/will be constructed or closed according to NMOCD guidelines ☐, a general permit ☒ or an (attached) alternative OCD-approved plan ☐.

SIGNATURE

TITLE

Regulatory Specialist

DATE

6/16/2005

Type or print name
For State Use Only

Joni Clark

E-mail address:

jclark@br-inc.com

Telephone No.

505-326-9701

APPROVED BY

TITLE

DEPUTY OIL & GAS INSPECTOR, DIST. 3

DATE

AUG 18 2005

Conditions of Approval (if any):

BURLINGTON RESOURCES OIL & GAS COMPANY LP SAN JUAN 28-5 UNIT #35N, 440' FSL & 620' FEL SECTION 19, T-28-N, R-5-W, NMPM, RIO ARriba COUNTY, NM GROUND ELEVATION: 6631', DATE: APRIL 29, 2005

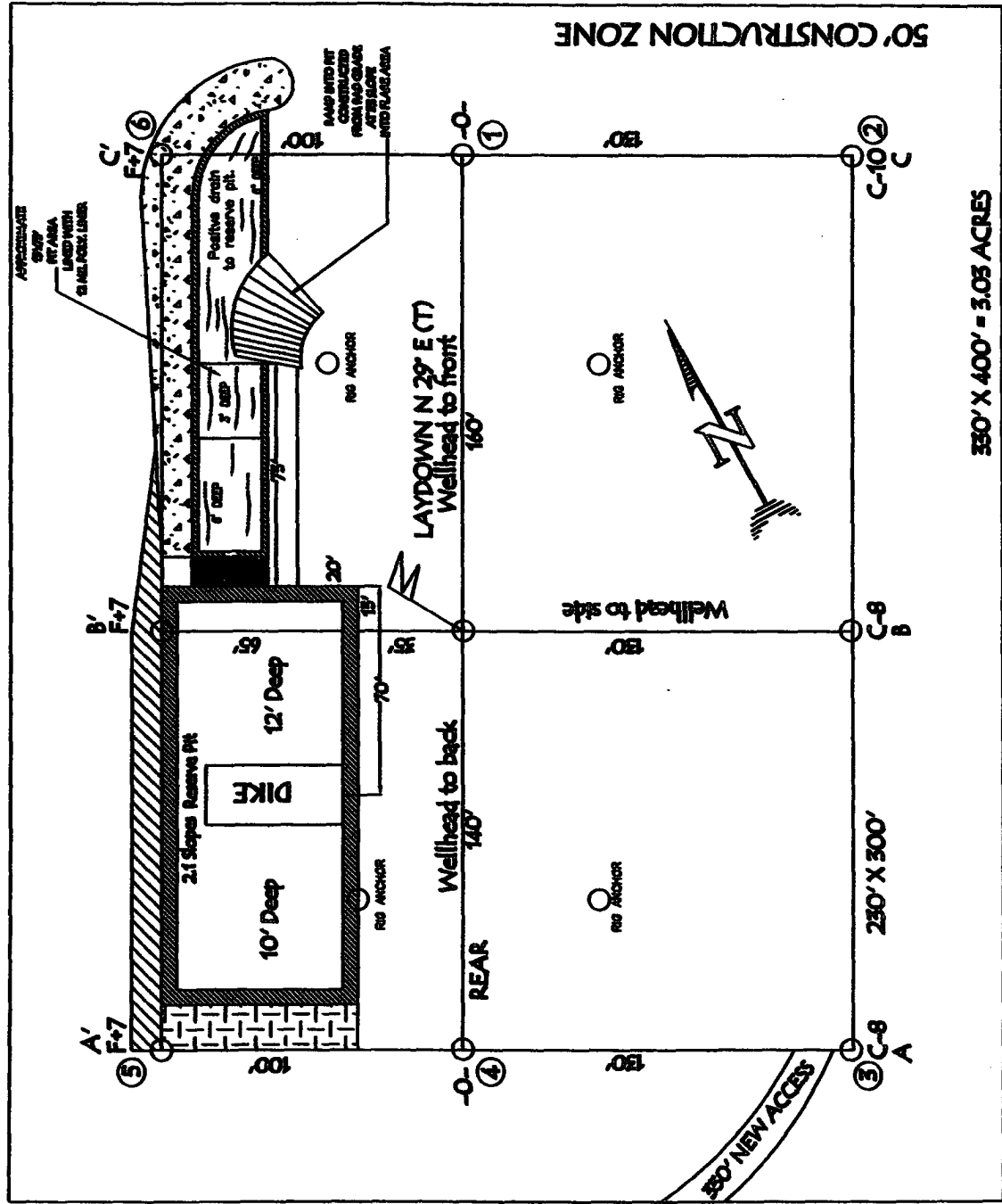

RESERVE PIT DIKE: TO BE 8' ABOVE DEEP SIDE (OVERFLOW - 3' WIDE AND 1' ABOVE SHALLOW SIDE).

NOTE: VECTOR SURVEYS IS NOT LIABLE FOR UNDERGROUND UTILITIES OR PIPELINES.
 CONTRACTOR SHOULD CALL ONE-CALL FOR LOCATION OF ANY MARKED OR UNMARKED BURIED
 PIPELINES OR CABLES ON WELL PAD AND/OR ACCESS ROAD AT LEAST TWO (2) WORKING DAYS PRIOR TO CONSTRUCTION.

LATITUDE: 36° 38.4426' LONGITUDE: 107° 23.5824' NAD27

ELEV. A'-A	CL
6650	
6640	
6630	
6620	

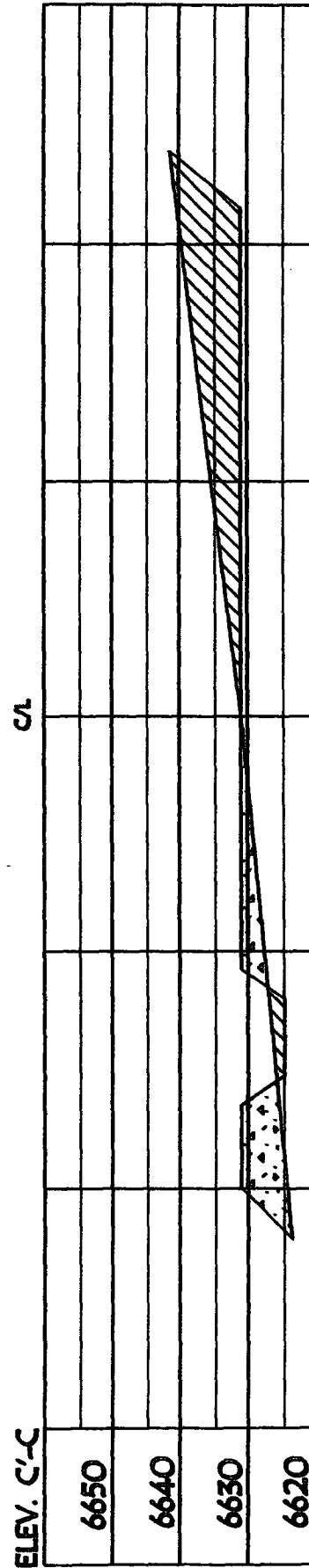
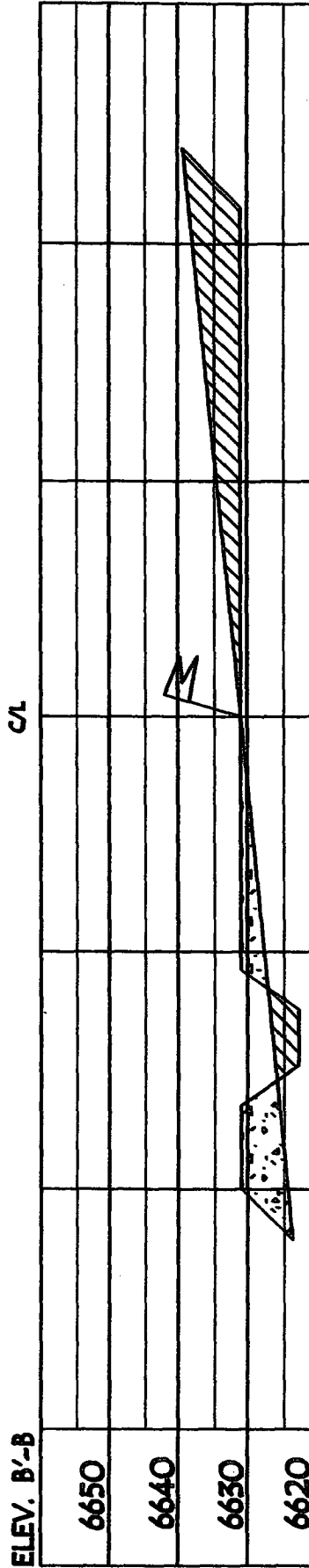

NOTE: VECTOR SURVEYS IS NOT LIABLE FOR UNDERGROUND UTILITIES OR PIPELINES. CONTRACTOR SHOULD CALL ONE-CALL FOR LOCATION OF ANY MARKED OR UNMARKED BURIED PIPELINES OR CABLES ON WELL PAD AND OR ACCESS ROAD AT LEAST TWO (2) WORKING DAYS PRIOR TO CONSTRUCTION.

OPERATIONS PLAN

Well Name: San Juan 28-5 Unit 35N

Location: 440' FSL, 620' FEL, Sec 19, T-28-N, R-5-W
Rio Arriba County, NM

Latitude 36° 38.4426'N, Longitude 107° 23.5824'W

Formation: Blanco Mesaverde/Basin Dakota

Total Depth: 7880

Logging Program: See San Juan 28-5 Unit Master Operations Plan

Mud Program: See San Juan 28-5 Unit Master Operations Plan

Casing Program (as listed, the equivalent, or better):

Hole Size	Depth Interval	Csg	Wt.	Grade	Cement	
12 1/4	0' -	120	9.625"	32.3#	H-40	113 cu.ft
8 3/4	0' -	3733	7"	20.0#	J-55	836 cu.ft
6 1/4	0' -	7880	4.5" **	10.5#	J-55	565 cu.ft

* Note - Will use 7", 23#, L-80 7" casing from 4000' to intermediate TD

** Note - Will use 4.5# 11.6#, N-80 casing from 7800' to TD

Tubing Program: See San Juan 28-5 Unit Master Operations Plan

- * The Mesaverde and Dakota formations will be completed and commingled.
- * The south half of section 19 is dedicated to the Mesaverde and the Dakota formation in this well.
Gas is dedicated.

Drilling Engineer

6/16/05
Date

*Assumption
Lewis 100