

**UNITED STATES
DEPARTMENT OF THE INTERIOR
BUREAU OF LAND MANAGEMENT**

5. Lease

NMSF-079186

SUNDRY NOTICES AND REPORTS ON WELLS

(Do not use this form for proposals to drill or to deepen or plug back to a different reservoir. Use "APPLICATION FOR PERMIT--" for such proposals)

6. If Indian, Allottee or Tribe Name

7. Unit Agreement Name

PM 2 15 N.M. 13167

1. Oil Well Gas Well Other
GAS WELL

RECEIVED

8. Well Name and No.

BREECH "E" 850

2. Name of Operator:

Caulkins Oil Company

070 FARMINGTON, NM

9. API Well No.

30-039-27676-00S1

3. Address of Operator:

(505) 334-4323

1409 W. Aztec Blvd. Ste B7, Aztec, NM 87410

10. Field and Pool, Exploratory Area

BASIN DAKOTA

4. Location of Well (Footage, Sec., Twp., Rge.)

705' F/N 2270' F/W

SEC. 5-26N-6W

11. Country or Parish, State

Rio Arriba Co., New Mexico

12. CHECK APPROPRIATE BOX(S) TO INDICATE NATURE OF NOTICE, REPORT, OR OTHER DATA

TYPE OF SUBMISSION

TYPE OF ACTION

Notice of Intent

Abandonment

Change of Plans

Subsequent Report

Recompletion

New Construction

Final Abandonment Notice

Plugging Back

Non-Routine Fracturing

Casing Repair

Water Shut-Off

Altering Casing

Conversion to Injection

Other Downhole Commingle

Dispose Water

17. Describe Proposed or Completed Operations:

8-05

Rig up.

T. O. H. with 2 3/8" tubing from 7521'.

Run wireline set retrievable bridge plug to 6950'.

Run gas spectrum log through Tocito and Gallup formations, 6900' to 6500'.

Perforate Tocito zone, 6845' to 6834' with 4 shots per foot.

Frac Tocito zone with 20,000# 20/40 sand and N₂ foam.

T. I. H. with 2 3/8" tubing and retrieving head.

Swab in and test Tocito.

Clean out to retrievable bridge plug at 6950'.

T. O. H. with retrievable bridge plug.

T. I. H. with 2 3/8" production tubing.

Land tubing on doughnut at approximately 7500'.

No new surface will be disturbed, location area will be cleaned up following operations.

Estimated starting date, September 12, 2005.



CONDITIONS OF APPROVAL
Adhere to previously issued approvals

NOTE: The format is issued in lieu of U.S. BLM Form 3160-5

18. I HEREBY CERTIFY THE FOREGOING IS TRUE AND CORRECT

SIGNED: Robert L. Verquer TITLE: Superintendent DATE: August 4, 2005
ROBERT L. VERQUER

APPROVED BY: [Signature] TITLE: Petr. Eng. DATE: 8/22/05
CONDITIONS OF APPROVAL, IF ANY

District I
 PO Box 1980, Hobbs, NM 88241-1980
 District II
 811 South First, Artesia, NM 88210

District III
 1000 Rio Brazos Rd., Aztec, NM 87410

District IV
 2040 South Pacheco, Santa Fe, NM 87505

State of New Mexico
 Energy, Minerals & Natural Resources Department

OIL CONSERVATION DIVISION

1220 South St. Francis Drive
 Santa Fe, NM 87504

Form C-102

Revised October 18, 1994
 Instructions on back
 Submit to Appropriate District Office

State Lease - 4 Copies
 Fee Lease - 3 Copies

RECEIVED

076 FARMINGTON NM

AMENDED REPORT

WELL LOCATION AND ACREAGE DEDICATION PLAT

¹ API Number 30-039-27676		² Pool Code 06460		³ Pool Name SOUTH BLANCO TOCITO	
⁴ Property Code 2459		⁵ Property Name BREECH "E"		⁶ Well Number 850	
⁷ OGRID No. 003824		⁸ Operator Name Caulkins Oil Company		⁹ Elevation 6640'	

¹⁰ Surface Location

UL or lot no.	Section	Township	Range	Lot Idn	Feet from the	North/South line	Feet from the	East/West line	County
C	5	26N	6W		705'	NORTH	2270'	WEST	Rio Arriba

¹¹ Bottom Hole Location If Different From Surface

UL or lot no.	Section	Township	Range	Lot Idn	Feet from the	North/South line	Feet from the	East/West line	County

¹² Dedicated Acres 80	¹³ Joint or Infill	¹⁴ Consolidation Code	¹⁵ Order No.
-------------------------------------	-------------------------------	----------------------------------	-------------------------

NO ALLOWABLE WILL BE ASSIGNED TO THIS COMPLETION UNTIL ALL INTERESTS HAVE BEEN CONSOLIDATED OR A NON-STANDARD UNIT HAS BEEN APPROVED BY THE DIVISION

¹⁶ 	¹⁷ OPERATOR CERTIFICATION <i>I hereby certify that the information contained herein is true and complete to the best of my knowledge and belief</i> Signature Printed Name Robert L. Verquer Title Superintendent Date August 4, 2005
	¹⁸ SURVEYOR CERTIFICATION <i>I hereby certify that the well location shown on this plat was plotted from field notes of actual surveys made by me or under my supervision, and that the same is true and correct to the best of my knowledge and belief.</i> Date of Survey Signature and Seal of Professional Surveyor: Certificate Number

District I

PO Box 1980, Hobbs, NM 88241-1980

District II

811 South First, Artesia, NM 88210

District III

1000 Rio Brazos Rd., Aztec, NM 87410

District IV

2040 South Pacheco, Santa Fe, NM 87505

State of New Mexico

Energy, Minerals & Natural Resources Department

OIL CONSERVATION DIVISION

1220 South St. Francis Drive

Santa Fe, NM 87504

Form C-102

Revised October 18, 1994

Instructions on back

Submit to Appropriate District Office

State Lease - 4 Copies

Fee Lease - 3 Copies

2005 AUG 8 PM 2 15

RECEIVED

070 FARMINGTON NM

AMENDED REPORT

WELL LOCATION AND ACREAGE DEDICATION PLAT

¹ API Number		² Pool Code 71599		³ Pool Name BASIN DAKOTA	
⁴ Property Code 2459		⁵ Property Name BREECH "E"			⁶ Well Number 850
⁷ OGRID No. 003824		⁸ Operator Name Caulkins Oil Company			⁹ Elevation 6640'

¹⁰ Surface Location

UL or lot no.	Section	Township	Range	Lot Idn	Feet from the	North/South line	Feet from the	East/West line	County
C	5	26N	6W		705'	NORTH	2270'	WEST	Rio Arriba

¹¹ Bottom Hole Location If Different From Surface

UL or lot no.	Section	Township	Range	Lot Idn	Feet from the	North/South line	Feet from the	East/West line	County

¹² Dedicated Acres 320 80 designated	¹³ Joint or Infill	¹⁴ Consolidation Code	¹⁵ Order No.
-------------------------------------------------------	-------------------------------	----------------------------------	-------------------------

NO ALLOWABLE WILL BE ASSIGNED TO THIS COMPLETION UNTIL ALL INTERESTS HAVE BEEN CONSOLIDATED OR A NON-STANDARD UNIT HAS BEEN APPROVED BY THE DIVISION

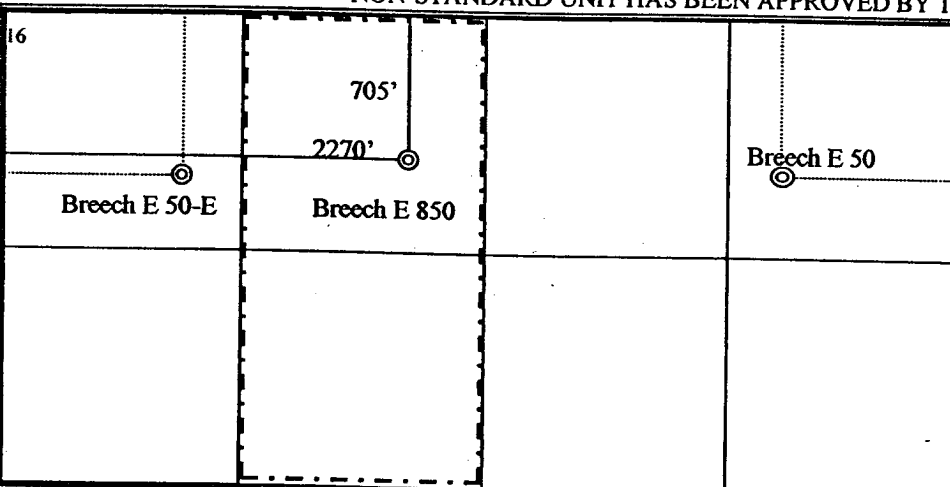

¹⁷ OPERATOR CERTIFICATION

I hereby certify that the information contained herein is true and complete to the best of my knowledge and

Robert L. Verquer
Signature

Printed Name Robert L. Verquer

Title Superintendent

Date March 16, 2004

¹⁸ SURVEYOR CERTIFICATION

I hereby certify that the well location shown on this plat was plotted from field notes of actual surveys made by my supervision, and that the same is true and correct to the best of my knowledge and belief.

Date of Survey

Signature and Seal of Professional Surveyor:



Certificate Number