

**UNITED STATES  
DEPARTMENT OF THE INTERIOR  
BUREAU OF LAND MANAGEMENT**

**APPLICATION FOR PERMIT TO DRILL, DEEPEN, OR PLUG BACK**

1a. <b>Type of Work</b> DRILL	2005 JUL 7 PM 4 15	5. <b>Lease Number</b> NMNM-12014
	RECEIVED	<b>Unit Reporting Number</b>
1b. <b>Type of Well</b> GAS	070 FARMINGTON NM	6. <b>If Indian, All. or Tribe</b>
2. <b>Operator</b> <b>BURLINGTON</b> RESOURCES Oil & Gas Company LP		7. <b>Unit Agreement Name</b>
3. <b>Address &amp; Phone No. of Operator</b> PO Box 4289, Farmington, NM 87499  (505) 326-9700		8. <b>Farm or Lease Name</b> EPNG B
		9. <b>Well Number</b> #100S
4. <b>Location of Well</b> 1180' FSL, 1730' FEL  Latitude 36° 56.8267'N, Longitude 107° 27.6223'W		10. <b>Field, Pool, Wildcat</b> Basin Fruitland Coal
		11. <b>Sec., Twn, Rge, Mer. (NMPM)</b> Unit 0, Sec. 28, T32N, R06W
		<b>API # 30-045- 33221</b>
14. <b>Distance in Miles from Nearest Town</b> 21.4 Miles	12. <b>County</b> San Juan	13. <b>State</b> NM
15. <b>Distance from Proposed Location to Nearest Property or Lease Line</b> 1180'		
16. <b>Acres in Lease</b>	17. <b>Acres Assigned to Well</b> 320 E/2 FC	
18. <b>Distance from Proposed Location to Nearest Well, Drig, Compl, or Applied for on this Lease</b> 53'		
19. <b>Proposed Depth</b> 3230'	20. <b>Rotary or Cable Tools</b> Rotary	
21. <b>Elevations (DF, FT, GR, Etc.)</b> 6408' GR	22. <b>Approx. Date Work will Start</b>	
23. <b>Proposed Casing and Cementing Program</b> See Operations Plan attached		
24. <b>Authorized by:</b> <u><i>Richard Thompson</i></u> Regulatory Associate II	<u>6/7/2005</u> Date	

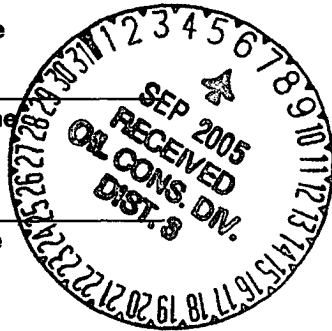

*H*

PERMIT NO. \_\_\_\_\_ APPROVAL DATE \_\_\_\_\_  
 APPROVED BY *Wayne Courson* TITLE *Acting AFM* DATE *9/1/05*

Archaeological Report attached  
 Threatened and Endangered Species Report attached  
 NOTE: This format is issued in lieu of U.S. BLM Form 3160-3  
 Title 18 U.S.C. Section 1001, makes it a crime for any person knowingly and willfully to make to any department or agency of the United States any false, fictitious or fraudulent statements or presentations as to any matter within its jurisdiction.  
**NOT AN HPA/FC WELL**

NMOCDC

DISTRICT I  
1625 N. French Dr., Hobbs, N.M. 88240

DISTRICT II  
1301 W. Grand Ave., Artesia, N.M. 88210

DISTRICT III  
1000 Rio Brazos Rd., Aztec, N.M. 87410

DISTRICT IV  
1220 South St. Francis Dr., Santa Fe, NM 87505

State of New Mexico  
Energy, Minerals & Natural Resources Department

OIL CONSERVATION DIVISION  
1220 South St. Francis Dr.  
Santa Fe, NM 87505

Form C-102  
Revised June 10, 2003

Submit to Appropriate District Office  
State Lease - 4 Copies  
Fee Lease - 3 Copies

AMENDED REPORT

WELL LOCATION AND ACREAGE DEDICATION PLAT

<sup>1</sup> API Number 30-		<sup>2</sup> Pool Code 71629		<sup>3</sup> Pool Name Basin Fruitland Coal	
<sup>4</sup> Property Code 6977		<sup>5</sup> Property Name EPNG B		<sup>6</sup> Well Number 100S	
<sup>7</sup> OGRID No. 14538		<sup>8</sup> Operator Name BURLINGTON RESOURCES OIL & GAS COMPANY LP		<sup>9</sup> Elevation 6408	

<sup>10</sup> Surface Location

UL or lot no.	Section	Township	Range	Lot Idn	Feet from the	North/South line	Feet from the	East/West line	County
0	28	32-N	6-W		1180	SOUTH	1730	EAST	SAN JUAN

<sup>11</sup> Bottom Hole Location If Different From Surface

UL or lot no.	Section	Township	Range	Lot Idn	Feet from the	North/South line	Feet from the	East/West line	County
<sup>12</sup> Dedicated Acres E/2 320		<sup>13</sup> Joint or Infill		<sup>14</sup> Consolidation Code		<sup>15</sup> Order No.			

NO ALLOWABLE WILL BE ASSIGNED TO THIS COMPLETION UNTIL ALL INTERESTS HAVE BEEN CONSOLIDATED OR A NON-STANDARD UNIT HAS BEEN APPROVED BY THE DIVISION

16

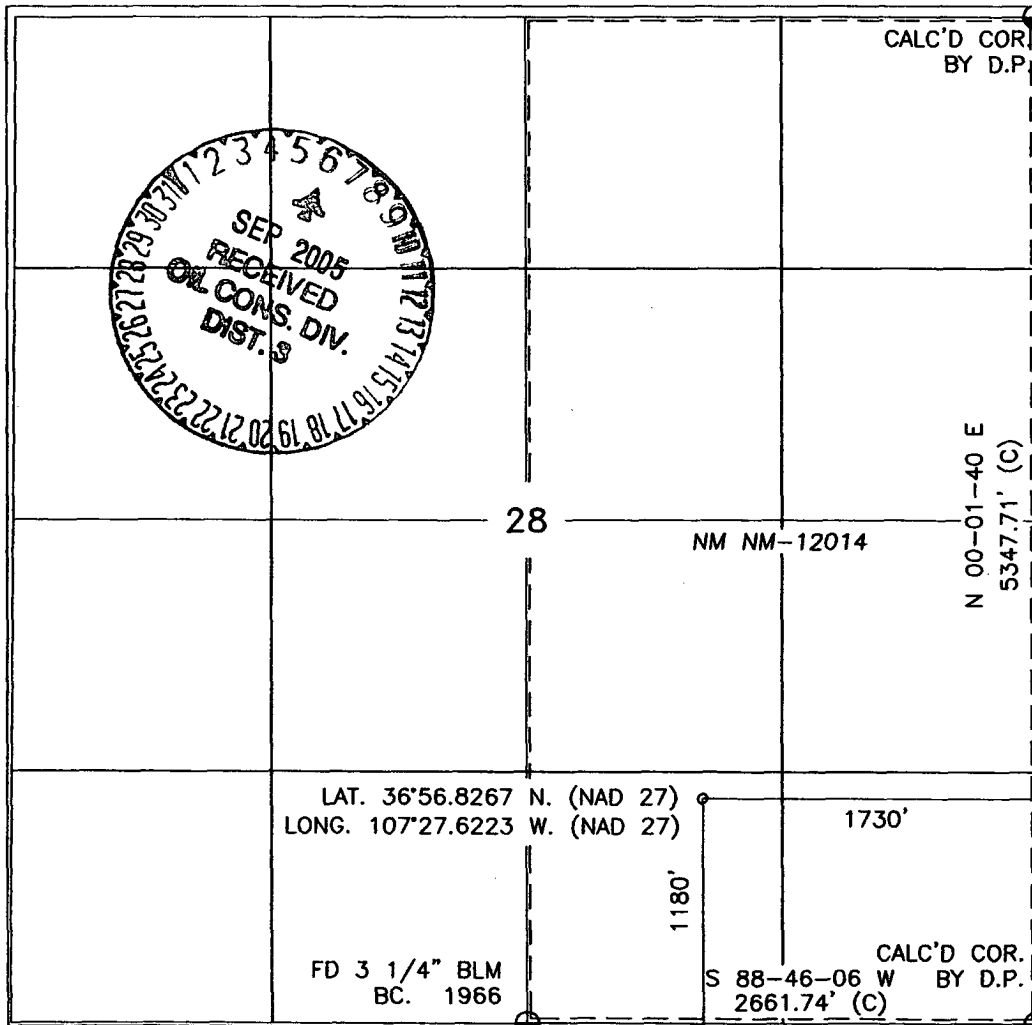

17 OPERATOR CERTIFICATION

I hereby certify that the information contained herein is true and complete to the best of my knowledge and belief.

*Philana Thompson*  
Signature

Philana Thompson  
Printed Name

Regulatory Associate II  
Title

June 8, 2005  
Date

Date

18 SURVEYOR CERTIFICATION

I hereby certify that the well location shown on this plat was plotted from field notes of actual surveys made by me or under my supervision, and that the same is true and correct to the best of my belief.

APPROVED  
Date  
Signature  
Professional Surveyor

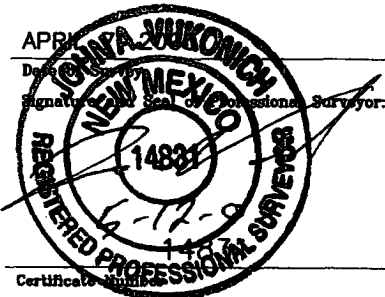

Certificate No.

District I  
1625 N. French Dr., Hobbs, NM 88240

Energy, Minerals and Natural Resources

May 27, 2004

District II  
1301 W. Grand Ave., Artesia, NM 88210

**OIL CONSERVATION DIVISION**

1220 South St. Francis Dr.

Santa Fe, NM 87505

District IV  
1000 Rio Brazos Rd., Aztec, NM 87410

1220 S. St. Francis Dr., Santa Fe, NM 87505

WELL API NO.	<b>30-045-</b>
5. Indicate Type of Lease	STATE <input type="checkbox"/> FEE <input type="checkbox"/>
6. State Oil & Gas Lease No.	Federal Lease NMNM-12014
7. Lease Name or Unit Agreement Name	<b>EPNG B</b>
8. Well Number	<b>#100S</b>
9. OGRID Number	<b>14538</b>
10. Pool name or Wildcat	<b>Basin Fruitland Coal</b>

**SUNDRY NOTICES AND REPORTS ON WELLS**  
(DO NOT USE THIS FORM FOR PROPOSALS TO DRILL OR TO DEEPEN OR PLUG BACK TO A DIFFERENT RESERVOIR. USE "APPLICATION FOR PERMIT" (FORM C-101) FOR SUCH PROPOSALS.)

1. Type of Well:  
Oil Well  Gas Well  Other

2. Name of Operator  
**BURLINGTON RESOURCES OIL & GAS COMPANY LP**

3. Address of Operator  
**3401 E. 30TH STREET, FARMINGTON, NM 87402**

4. Well Location  
Unit Letter **O** : **1180** feet from the **South** line and **1730** feet from the **East** line  
Section **28** Township **32N** Range **6W** NMPM County **San Juan**

11. Elevation (Show whether DR, RKB, RT, GR, etc.)  
**6408' GR**

Pit or Below-grade Tank Application  or Closure

Pit type **New Drill** Depth to Groundwater **<50'** Distance from nearest fresh water well **>1000'** Distance from nearest surface water **<1000'**

Pit Liner Thickness: **12** mil Below-Grade Tank: Volume \_\_\_\_\_ bbls; Construction Material \_\_\_\_\_

12. Check Appropriate Box to Indicate Nature of Notice, Report or Other Data

**NOTICE OF INTENTION TO:**

PERFORM REMEDIAL WORK  PLUG AND ABANDON   
 TEMPORARILY ABANDON  CHANGE PLANS   
 PULL OR ALTER CASING  MULTIPLE COMPL

**SUBSEQUENT REPORT OF:**

REMEDIAL WORK  ALTERING CASING   
 COMMENCE DRILLING OPNS.  P AND A   
 CASING/CEMENT JOB

OTHER: **New Drill Pit**

OTHER:

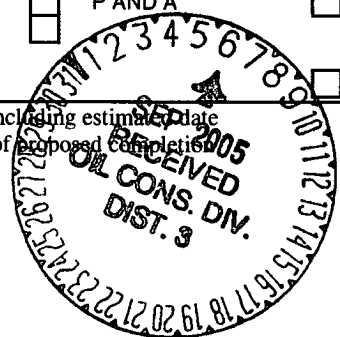

13. Describe proposed or completed operations. (Clearly state all pertinent details, and give pertinent dates, including estimated date of starting any proposed work). SEE RULE 1103. For Multiple Completions: Attach wellbore diagram of proposed completions or recompletion.

New Drill, Lined:

Burlington Resources proposes to construct a new drilling pit and an associated vent/flare pit. Based on Burlington's interpretation of the Ecosphere's risk ranking criteria, the new drilling pit will be a lined pit as detailed in Burlington's Revised Drilling / Workover Pit Construction / Operation Procedures dated November 11, 2004 on file at the NMOCD office. A portion of the vent/flare pit will be designed to manage fluids and that portion will be lined as per the risk ranking criteria. Burlington Resources anticipates closing these pits according to the Drilling / Workover Pit Closure Procedure dated August 2, 2004 on file at the NMOCD office.

I hereby certify that the information above is true and complete to the best of my knowledge and belief. I further certify that any pit or below-grade tank has been/will be constructed or closed according to NMOCD guidelines , a general permit  or an (attached) alternative OCD-approved plan .

SIGNATURE Philana Thompson TITLE **Regulatory Associate II** DATE **6/8/2005**

Type or print name **Philana Thompson** E-mail address: **PThompson@br-inc.com** Telephone No. **505-326-9530**

For State Use Only

APPROVED BY [Signature] TITLE **DEPUTY OIL & GAS INSPECTOR, DIST. 3** DATE **SEP 06 2005**

Conditions of Approval (if any):

**BURLINGTON RESOURCES OIL & GAS COMPANY LP**  
**EPNG B No. 100S, 1180 FSL 1730 FEL**  
**SECTION 28, T-32-N, R-6-W, N.M.P.M., SAN JUAN COUNTY, NEW MEXICO**  
**GROUND ELEVATION: 6408, DATE: APRIL 7, 2005**

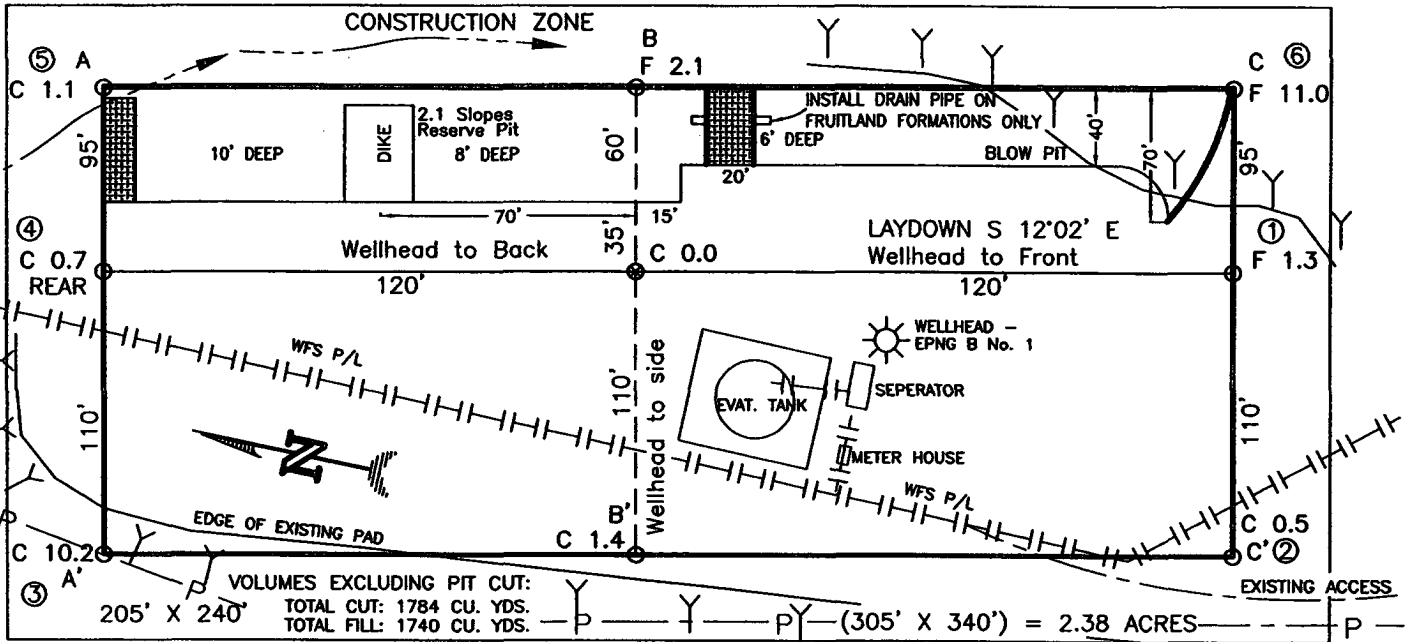

RESERVE PIT DIKE: TO BE 8' ABOVE DEEP SIDE (OVERFLOW - 3' WIDE AND 1' ABOVE SHALLOW SIDE).  
 BLOW PIT: OVERFLOW PIPE HALFWAY BETWEEN TOP AND BOTTOM AND TO EXTEND OVER PLASTIC LINER AND INTO BLOW PIT.

NOTE: DAGGETT ENTERPRISES, INC. IS NOT LIABLE FOR UNDERGROUND UTILITIES OR PIPELINES. NEW MEXICO ONE CALL TO BE NOTIFIED 48 HOURS PRIOR TO EXCAVATION OR CONSTRUCTION.

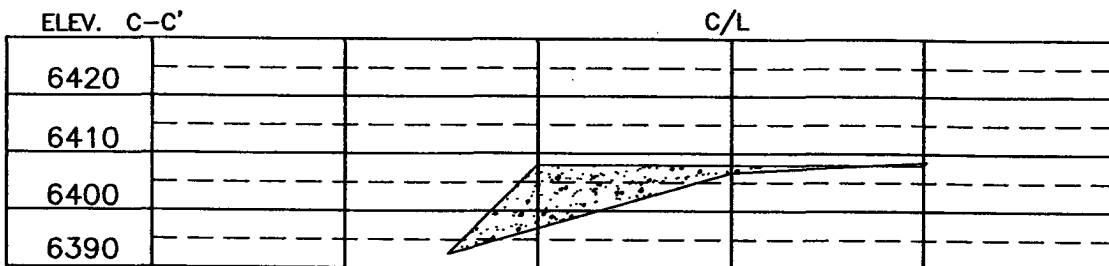
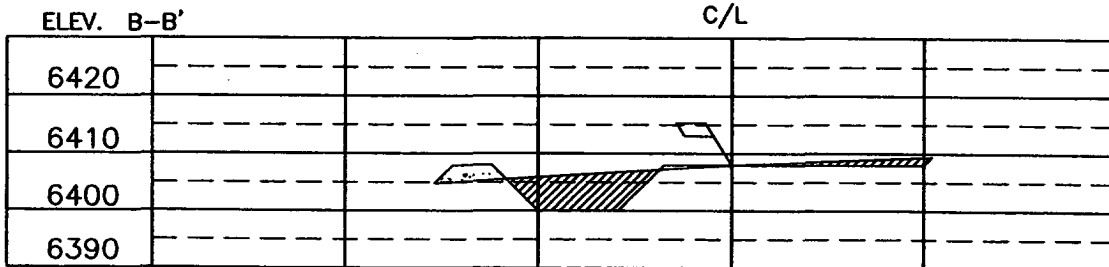
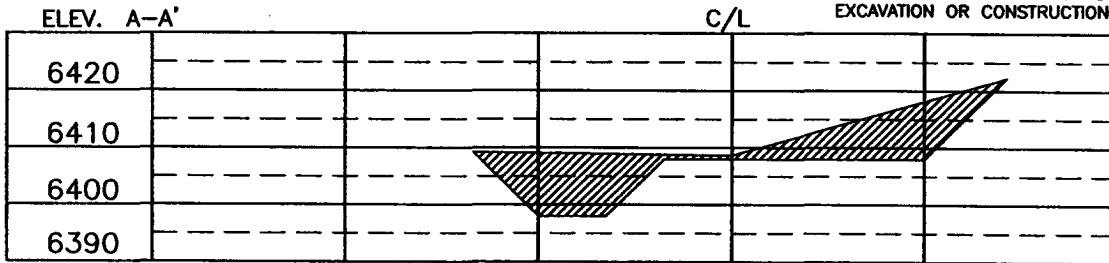

NOTE: CONTRACTOR SHOULD CALL ONE-CALL FOR LOCATION OF ANY MARKED OR UNMARKED BURIED PIPELINES OR CABLES ON WELL PAD AND OR ACCESS ROAD AT LEAST TWO (2) WORKING DAYS PRIOR TO CONSTRUCTION.

REVISIONS	DATE	REVISION BY

**Daggett Enterprises, Inc.**  
 Surveying and Oil Field Services  
 P. O. Box 15088 • Farmington, NM 87401  
 Phone (505) 328-1772 • Fax (505) 328-6019  
 NEW MEXICO L.S. No. 14831  
 SURVEIL: BR568CF8  
 DATE: 04/28/05

DRAWN BY: A.G.  
 CHECKED: BR568

## OPERATIONS PLAN

**Well Name:** EPNG B #100S  
**Location:** Unit O (SWSE), 1180' FSL & 1730' FEL, Section 28, T32N, R6W  
 San Juan County, New Mexico  
 Latitude 36° 56.8267'N; Longitude 107° 27.6223'W  
**Formation:** Basin Fruitland Coal  
**Elevation:** 6408' GR

Formation:	Top	Bottom	Contents
Surface	San Jose		
Ojo Alamo	2317'	2443'	
Kirtland	2443'	3062'	gas
<b>Intermediate TD</b>	<b>3032'</b>		
T/Fruitland	3062'		gas
B/Fruitland	3145'		gas
T/Pictured Cliffs	3151'		gas
<b>Total Depth</b>	<b>3230'</b>		

Burlington Resources wishes to utilize a sump on this well.

Logging Program:

Mudlog from intermediate to TD  
 Cores - none

Mud Program:

<u>Interval</u>	<u>Type</u>	<u>Weight</u>	<u>Vis.</u>	<u>Fluid Loss</u>
0- 120'	Spud Mud/Air/Air Mist	8.4-9.0	40-50	no control
120'- 3032'	LSND/Clear Water	8.4-9.0	30-60	no control
3032' - 3230'	Starch-Polymer/Air/Mist			

Circulating media will be contractor dependent

Alternate Mud Program:

<u>Interval</u>	<u>Type</u>	<u>Weight</u>	<u>Vis.</u>	<u>Fluid Loss</u>
0- 120'	Spud Mud/Air/Air Mist	8.4-9.0	40-50	no control
120' - 3032'	LSND/Clear Water	8.4-9.0	30-60	no control
3032' -3230'	Air/Mist			

Circulating media will be contractor dependent.

Pit levels will be visually monitored to detect gain or loss of fluid control.

Casing Program (as listed, the equivalent, or better):

<u>Hole Size</u>	<u>Depth Interval</u>	<u>Csg.Size</u>	<u>Wt.</u>	<u>Grade</u>
12 1/4"	0' - 120'	9 5/8"	32.3#	H-40
8 3/4"	0' - 3032'	7"	20.0#/23#	J-55/N-80
6 1/4"	2992' - 3230'	5 1/2"	15.5#	J-55/N-80

**BOP and tests:**

Surface to intermediate TD - 11" 2000 psi (minimum) double gate BOP stack Reference Figure #1). Prior to drilling out surface casing, test BOPE to 600 psi for 30 min.

Intermediate TD to Total Depth - 7 1/6" 2000 psi (minimum) completion BOP stack Reference Figure #2). Prior to drilling out intermediate casing, test BOPE and casing to 1500 psi for 30 minutes.

From surface to 7" TD - a choke manifold will be installed in accordance with Onshore Order No. 2 (Reference Figure #3). When the cavitation completion rig drills the production hole, the completion rig configuration will be used (Reference Figure #4). ~~\_\_\_\_\_~~  
~~\_\_\_\_\_~~

**General -**

- Pipe rams will be actuated once each day and blind rams will be actuated once each trip to test proper functioning.
- An upper kelly cock valve with handle available and drill string valves to fit each drill string will be available on the rig floors at all times.
- BOP pit level drill will be conducted weekly for each drilling crew.
- All BOP tests and drills will be recorded in daily drilling reports.
- Blind and pipe rams will be equipped with extension hand wheels.

**Wellhead Equipment:** 9 5/8" x 7" x 2 3/8" x 11" 2000 psi xmas tree assembly.

**Cementing:****9 5/8" surface casing Pre-Set Drilled -**

Cement with Type I, II cement with 20% flyash mixed at 14.5 ppg, 1.61 cu ft per sack yield. (Bring cement to surface). Wait on cement for 24 hours for pre-set holes before pressure testing or drilling out from under surface.

**9 5/8" surface casing Conventionally Drilled -**

Cement with - 88 sx ( 113 cf of slurry @ 1.28 yield) Type III cement with 0.25 pps Celloflake, 3% calcium chloride. (200% excess, bring cement to surface). Wait on cement appropriate time until cement achieves 250 psi compressive strength at 60 degrees F. prior to nipple up of BOPE. Wait on cement for 8 hrs for conventionally set holes before pressure testing or drilling out from under surface. Test casing to 600 psi for 30 minutes.

Saw tooth guide shoe on bottom. Bowspring centralizers will be run in accordance with Onshore Order #2.

**7" intermediate casing -** Cement with 259 sx ( 553 cu ft of slurry @ 2.13 yield) Premium Lite with 3% calcium chloride, 5 pps LCM-1, and 1/4#/sack celloflake, 0.4% FL-52, & 0.4% SMS. Tail with 90 sacks (124 cu ft of slurry @ 1.38 yield) Type III cmt with 1% calcium chloride, 1/4#/sack Celloflake and 0.2% FL-52. Total of 677 cf - 50% excess to circulate to surface.

Cement nose guide shoe on bottom with float collar spaced on top of shoe joint. Bowspring centralizers spaced every other joint off bottom, to the base of the Ojo Alamo 2443'. Two turbolating centralizers at the base of the Ojo Alamo @ 2443'. Bowspring centralizers spaced every fourth joint from the base of the Ojo Alamo to the base of the surface casing.

5 1/2" liner - will not be cemented if run.

**Note:**

- If open hole logs are run, cement volumes will be based on 25% excess over caliper volumes.
- If hole conditions permit, an adequate water spacer will be pumped ahead of each cement job to prevent cement/mud contamination or cement hydration.

**Additional information:**

- The Fruitland Coal formation will be completed.
- No abnormal temperatures or hazards are anticipated.
- Anticipated pore pressure for the Fruitland is less than 500 psi.
- This gas is dedicated.
- The E/2 of the section is dedicated to this well.
- This is not an HPA well.

  
Drilling Engineer

June 8, 2005  
Date

**BURLINGTON RESOURCES**

**Completion/Workover Rig  
BOP Configuration  
2,000 psi System**

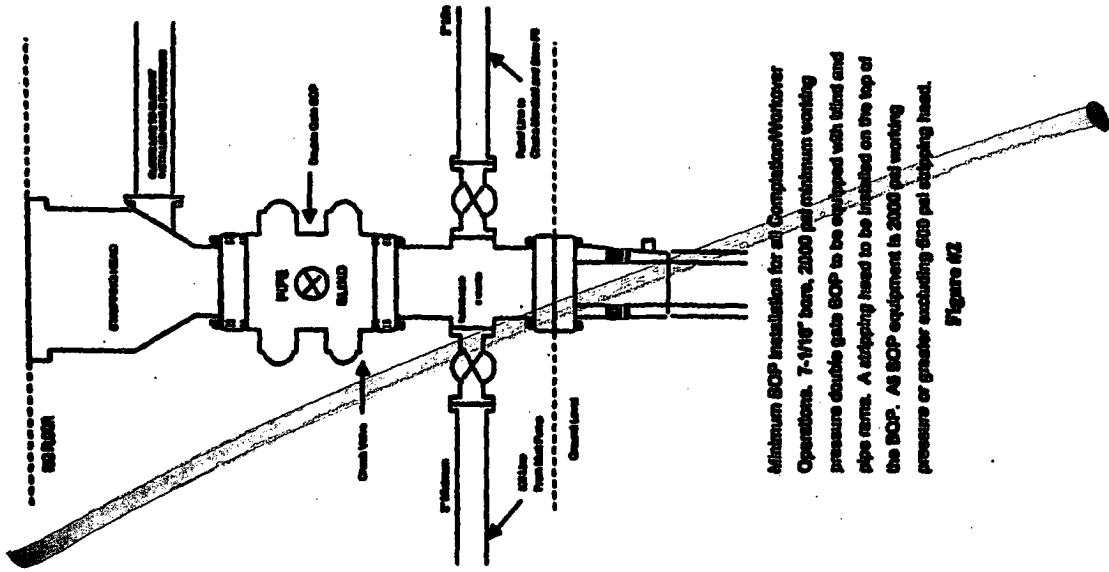

Minimum BOP installation for all Completion/Workover Operations. 7-1/8" bore, 2000 psi minimum working pressure double gate BOP to be equipped with blind and pipe rams. A stopping head to be installed on the top of the BOP. All BOP equipment is 2000 psi working pressure or greater excluding 500 psi stopping head.

Figure #2

4-30-01

**Drilling Rig  
Cheche Manifold Configuration  
2000 psi System**

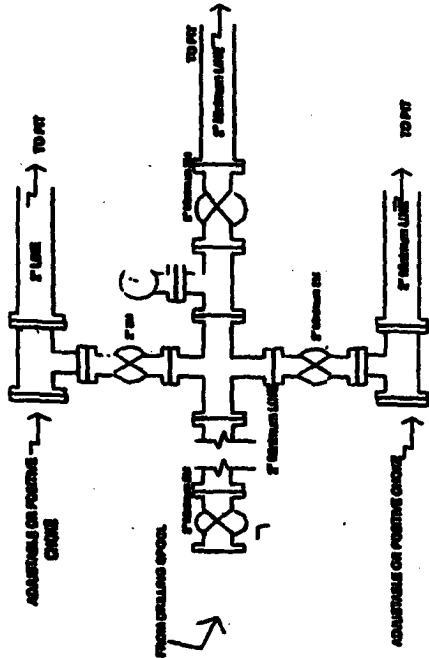

Cheche manifold installation from Surface Casing Point to Total Depth. 2,000psi working pressure equipment with two check.

Figure #3

4-20-01

**Burlington Resources**

**Drilling Rig  
2000 psi System**

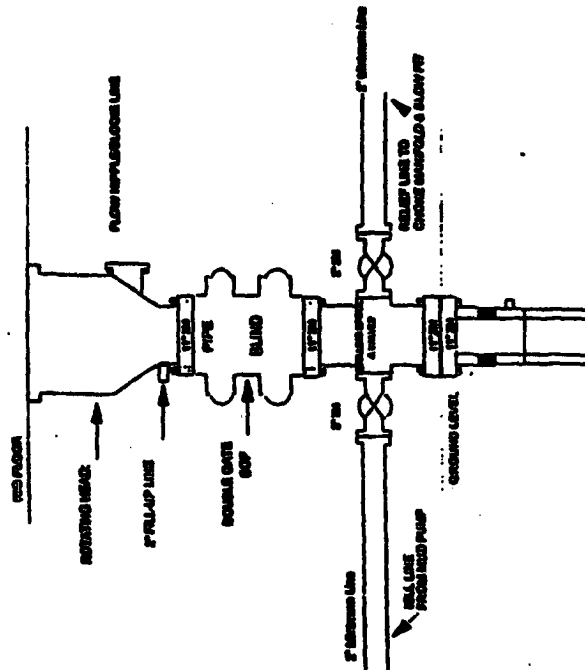

BOP installation from Surface Casing Point to Total Depth. 11" Bore 10" Mandrel, 2000 psi working pressure double gate BOP to be equipped with blind rams and pipe rams. A 500 psi stopping head on top of ram preventer. All BOP equipment is 2,000 psi working pressure.

Figure #4



# BURLINGTON RESOURCES

Figure #4  
Cavitation Rig  
BOP Configuration  
2,000 psi Minimum System

2005 JUL 12 PM 2 59

RECEIVED  
070 FARMINGTON NM

