

District I
1625 N. French Dr., Hobbs, NM 88240
District II
1301 W. Grand Avenue, Artesia, NM 88210
District III
1000 Rio Brazos Road, Aztec, NM 87410
District IV
1220 S. St. Francis Dr., Santa Fe, NM 87505

State of New Mexico
Energy Minerals and Natural Resources

Oil Conservation Division
1220 South St. Francis Dr.
Santa Fe, NM 87505

Form C-141
Revised August 8, 2011

Submit 1 Copy to appropriate District Office to
accordance with 19.15.29 NMAC.

Release Notification and Corrective Action

OPERATOR

☐ Initial Report ☒ Final Report

Name of Company ConocoPhillips Company	Contact Ashley Maxwell
Address 3401 East 30th St, Farmington, NM	Telephone No. (505) 324-5169
Facility Name: Lindrith B Unit 5	Facility Type: Gas Well SF-078913

Surface Owner Federal	Mineral Owner Federal	API No. 3003922384
------------------------------	------------------------------	---------------------------

LOCATION OF RELEASE

Unit Letter E	Section 21	Township 24N	Range 3W	Feet from the 1921	North/South Line North	Feet from the 861	East/West Line West	County Rio Arriba
-------------------------	----------------------	------------------------	--------------------	------------------------------	----------------------------------	-----------------------------	-------------------------------	-----------------------------

Latitude 36.297821 Longitude 107.16739

NATURE OF RELEASE

Type of Release Produced Fluids	Volume of Release 546 yds3	Volume Recovered 546 yds3
Source of Release Unknown Production Equipment, near former line drip	Date and Hour of Occurrence 7/24/2012	Date and Hour of Discovery
Was Immediate Notice Given? <input type="checkbox"/> Yes <input type="checkbox"/> No <input checked="" type="checkbox"/> Not Required	If YES, To Whom? RCVD NOV 16 '12	
By Whom?	Date and Hour OIL CONS. DIV.	
Was a Watercourse Reached? <input type="checkbox"/> Yes <input checked="" type="checkbox"/> No	If YES, Volume Impacting the Watercourse. DIST. 3	

If a Watercourse was Impacted, Describe Fully.*
N/A

Describe Cause of Problem and Remedial Action Taken.*

Discovery of historical hydrocarbon impacted soil.

Describe Area Affected and Cleanup Action Taken.*

Excavation was required based on NMOCD Guidelines for Remediation of Leaks, Spills and Releases. The excavation was 30'X45'X10' and 546 yds³ of soil was transported to a third party land farm. Excavation and confirmation sampling occurred. Analytical results were below the regulatory standards set forth in the NMOCD Guidelines for Remediation of Leaks, Spills and Releases; therefore no further action is needed.

I hereby certify that the information given above is true and complete to the best of my knowledge and understand that pursuant to NMOCD rules and regulations all operators are required to report and/or file certain release notifications and perform corrective actions for releases which may endanger public health or the environment. The acceptance of a C-141 report by the NMOCD marked as "Final Report" does not relieve the operator of liability should their operations have failed to adequately investigate and remediate contamination that pose a threat to ground water, surface water, human health or the environment. In addition, NMOCD acceptance of a C-141 report does not relieve the operator of responsibility for compliance with any other federal, state, or local laws and/or regulations.

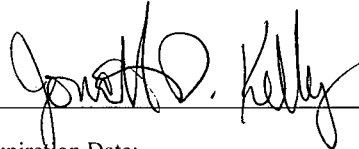
Signature: 		OIL CONSERVATION DIVISION	
Printed Name: Ashley Maxwell		Approved by Environmental Specialist: 	
Title: Field Environmental Specialist		Approval Date: <u>11/27/2012</u> Expiration Date:	
E-mail Address: ashley.p.wethington@conocophillips.com		Conditions of Approval:	
Date: November 12, 2012 Phone: 505-324-5169		Attached <input type="checkbox"/>	

* Attach Additional Sheets If Necessary

NSK 1233254810

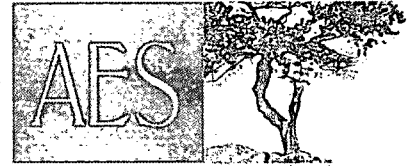

Animas Environmental Services, LLC

www.animasenvironmental.com

624 E. Comanche
Farmington, NM 87401
505-564-2281

Durango, Colorado
970-403-3274

November 5, 2012

Ashley Maxwell
ConocoPhillips
San Juan Business Unit
Office 216-2
5525 Hwy 64
Farmington, New Mexico 87401

**RE: Final Excavation Report
Lindrith B #5
Rio Arriba County, New Mexico**

Dear Ms. Maxwell:

On July 25, 2012, Animas Environmental Services, LLC (AES) completed an environmental clearance of the final excavation limits at the ConocoPhillips (CoP) Lindrith B #5, located in Rio Arriba County, New Mexico. The final excavation was completed by contractors prior to AES' arrival to the location on July 25, 2012. The historical release was located near the former line drip.

1.0 Site Information

1.1 Location

Location - SW¼ NW¼, Section 21, T24N, R3W, Rio Arriba County, New Mexico
Well Head Latitude/Longitude - N36.29789 and W107.16797, respectively
Release Location Latitude/Longitude – N36.29786 and W107.16773, respectively
Land Jurisdiction – Private

Figure 1. Topographic Site Location Map

Figure 2. Aerial Site Map, July 2012

1.2 NMOCD Ranking

Prior to site work, the New Mexico Oil Conservation Division (NMOCD) database was reviewed. No prior ranking information was located, and no other ranking information was located. The New Mexico Office of the State Engineer (NMOSE) database was reviewed for nearby water wells, and no registered water wells were reported to be located within 1,000 feet of the location. Additionally, Google Earth and the New Mexico Tech Petroleum Recovery Research Center online mapping tool (<http://ford.nmt.edu/react/project.html>) were accessed to aid in the identification of downgradient surface water.

Once on site, AES personnel further assessed the ranking using topographical interpretation, Global Positioning System (GPS) elevation readings, and visual reconnaissance. AES personnel concluded that depth to groundwater at the site was greater than 100 feet below ground surface (bgs). The site is located approximately 430 feet west-southwest of an unnamed tributary to Medio Wash. Based on this information, the location was assessed a ranking score of 10 per the *NMOCD Guidelines for Leaks, Spills, and Releases* (August 1993).

1.3 Assessment

AES was initially contacted by Eric Smith, a CoP contractor, on July 24, 2012, and on July 25, 2012, Deborah Watson of AES completed the final excavation field work. The assessment included collection and field screening of five 5-point composite samples from each wall and the base of the excavation. The final excavation was approximately 1,040 ft² by 10 feet deep. Sample locations and excavation extents are shown on Figure 3.

2.0 Soil Sampling

A total of five 5-point composite soil samples were collected from the four walls (SC-1 through SC-4) and the base (SC-5) of the excavation during the assessment. All soil samples were field screened for volatile organic compounds (VOCs) and were also analyzed for total petroleum hydrocarbons (TPH). Three of the collected soil samples (SC-2, SC-3, and SC-5) were submitted for confirmation laboratory analysis.

2.1 Field Screening

2.1.1 Volatile Organic Compounds

Field screening for VOC vapors was conducted with a photo-ionization detector (PID) organic vapor meter (OVM). Before beginning field screening, the PID-OVM was first calibrated with 100 parts per million (ppm) isobutylene gas.

2.1.2 Total Petroleum Hydrocarbons

Field TPH samples were analyzed per USEPA Method 418.1 using a Buck Scientific Model HC-404 Total Hydrocarbon Analyzer Infrared Spectrometer (Buck). A 3-point calibration was completed prior to conducting soil analyses. Field analytical protocol followed AES's *Standard Operating Procedure: Field Analysis Total Petroleum Hydrocarbons per EPA Method 418.1*.

2.2 Laboratory Analyses

The soil samples collected for laboratory analysis (SC-2, SC-3, and SC-5) were placed into new, clean, laboratory-supplied containers, which were then labeled, placed on ice, and logged onto a sample chain of custody record. Samples were maintained on ice until delivery to the analytical laboratory, Hall Environmental Analysis Laboratory (Hall) in Albuquerque, New Mexico. Soil samples were laboratory analyzed for:

- Benzene, toluene, ethylbenzene, and xylene (BTEX) per U.S. Environmental Protection Agency (USEPA) Method 8021B

2.3 Field Screening and Laboratory Analytical Results

Excavation field screening readings for VOCs via OVM ranged from 35.8 ppm in SC-4 up to 750 ppm in SC-3. Field TPH concentrations ranged from 37.8 mg/kg in SC-4 up to 528 mg/kg in SC-3. Results are included below in Table 1 and on Figure 3. The AES field screening report is attached.

Table 1. Soil Field Screening VOCs and TPH Results
Lindrith B #5 Final Excavation, July 2012

<i>Sample ID</i>	<i>Date Sampled</i>	<i>Sample Depth (ft bgs)</i>	<i>Sample Location</i>	<i>VOCs via OVM (ppm)</i>	<i>Field TPH (mg/kg)</i>
<i>NMOCD Action Level*</i>				<i>100</i>	<i>1,000</i>
SC-1	7/25/12	1 to 10	North Wall	73.5	78.2
SC-2	7/25/12	1 to 10	East Wall	144	113
SC-3	7/25/12	1 to 10	South Wall	750	528
SC-4	7/25/12	1 to 10	West Wall	35.8	37.8
SC-5	7/25/12	10	Base	147	43.9

*Action level determined by the NMOCD ranking score per *NMOCD Guidelines for Leaks, Spills, and Releases* (August 1993)

Laboratory analytical results for SC-2, SC-3 and SC-5 were used to confirm field screening results from the final excavation. Results showed reported benzene and total BTEX concentrations below laboratory detection limits of 0.050 mg/kg and 0.25 mg/kg, respectively, for all samples. Results are presented in Table 2 and on Figure 3. The laboratory analytical report is attached.

Table 2. Laboratory Analytical Results – Benzene, BTEX and TPH
Lindrith B #5 Final Excavation, July 2012

Sample ID	Date Sampled	Sample Depth (ft bgs)	Sample Locations	Benzene (mg/kg)	Total BTEX (mg/kg)
NMOCD Action Level*				10	50
SC-2	7/25/12	1 to 10	East Wall	<0.050	<0.25
SC-3	7/25/12	1 to 10	South Wall	<0.050	<0.25
SC-5	7/25/12	10	Base	<0.050	<0.25

*Action level determined by the NMOCD ranking score per *NMOCD Guidelines for Leaks, Spills, and Releases* (August 1993)

3.0 Conclusions and Recommendations

On July 25, 2012, AES conducted an environmental clearance of the final excavation limits associated with a historical release located near the former line drip at the Lindrith B #5, located in Rio Arriba County, New Mexico. Field screening VOC readings were above the NMOCD action level of 100 ppm in SC-2 (144 ppm), SC-3 (750 ppm), and SC-5 (147 ppm); however, laboratory analytical results for benzene and total BTEX concentrations for SC-2, SC-3, and SC-5 were below laboratory detection limits. Based on field screening and laboratory analytical results for the excavation of petroleum contaminated soils at the Lindrith B #5, benzene, total BTEX, and TPH concentrations were below applicable NMOCD action levels. No further work is recommended.

If you have any questions about this report or site conditions, please do not hesitate to contact Deborah Watson at (505) 564-2281.

Sincerely,



Kelsey Christiansen
Environmental Scientist

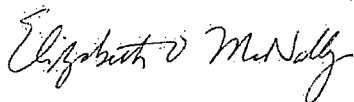

Elizabeth McNally, PE

Attachments:

Figure 1. Topographic Site Location Map

Figure 2. Aerial Site Map, July 2012

Figure 3. Excavation Soil Sample Locations and Results, July 2012

AES Field Screening Report 072512

Hall Laboratory Analytical Report 1207B43

R:\Animas 2000\2012 Projects\Conoco Phillips\Lindrith B #5 july\CoP Lindrith B5 Final Excavation Report
110512.docx

BILLY RICE CANYON QUADRANGLE
NEW MEXICO - RIO ARriba COUNTY
1963

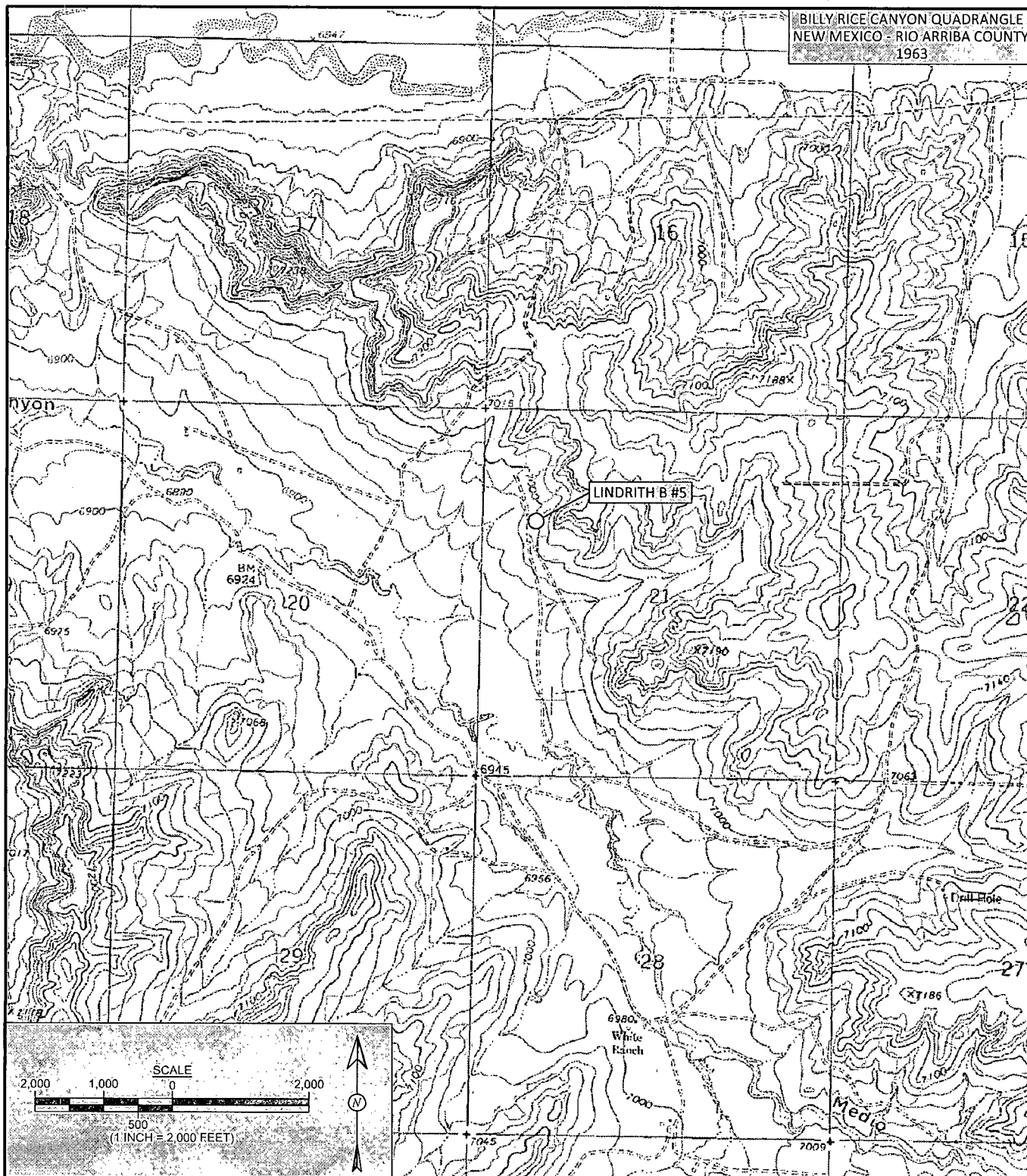

Animas Environmental Services, LLC

DRAWN BY:

C. Lameman

DATE DRAWN:

July 30, 2012

REVISIONS BY:

C. Lameman

DATE REVISED:

July 30, 2012

CHECKED BY:

D. Watson

DATE CHECKED:

July 30, 2012

APPROVED BY:

E. McNally

DATE APPROVED:

April 25, 2012

FIGURE 1

TOPOGRAPHIC SITE LOCATION MAP

ConocoPhillips
Lindrith B #5
RIO ARriba COUNTY, NEW MEXICO
SW¼, NW¼, SECTION 21, T24N, R3W
N36.29789, W107.16797

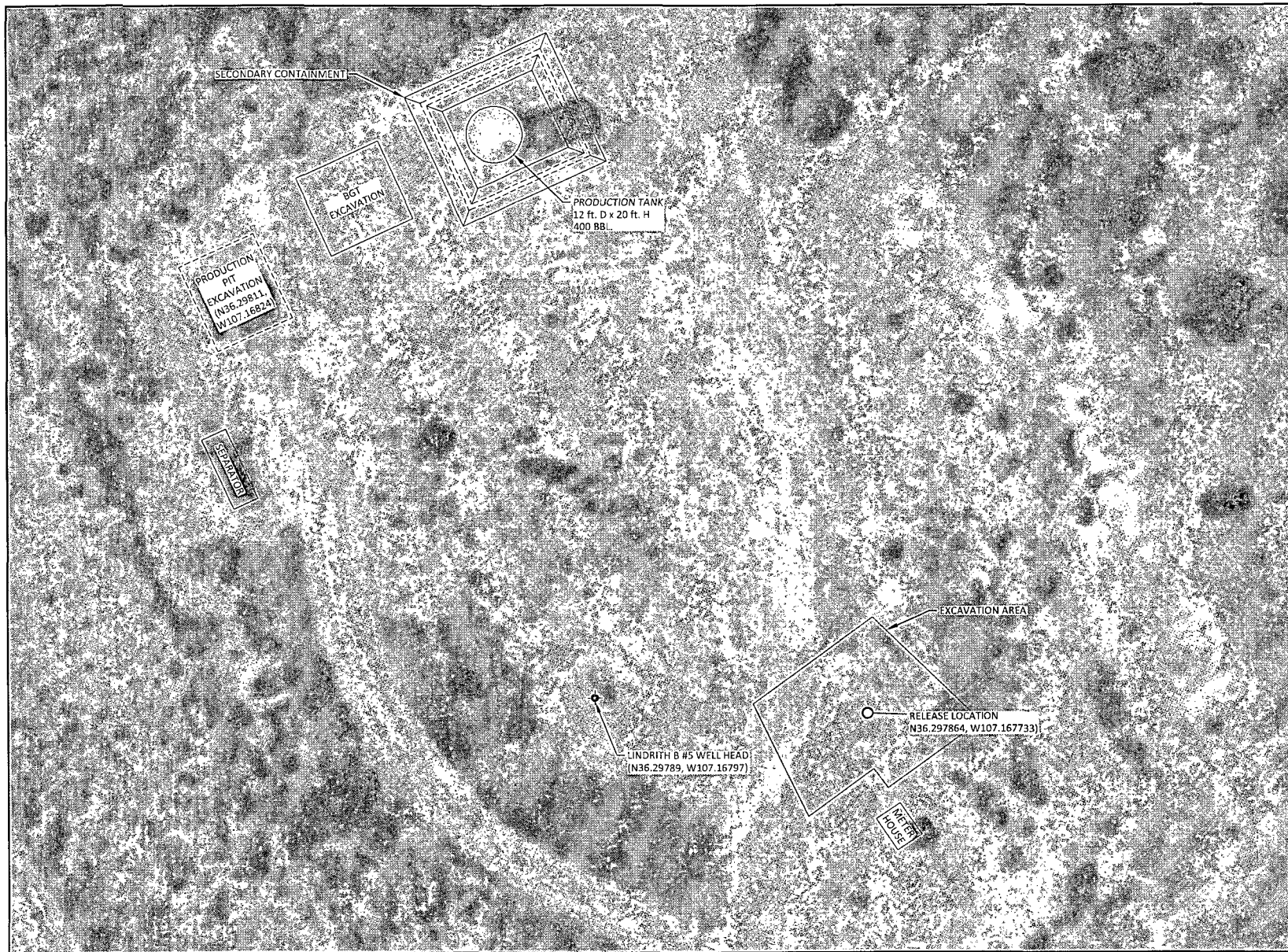

FIGURE 2

AERIAL SITE MAP

ConocoPhillips
Lindrith B #5
RIO ARriba COUNTY, NEW MEXICO
SW¼, NW¼, SECTION 21, T24N, R3W
N36.29789, W107.16797



Aminas Environmental Services, LLC

DRAWN BY: N. Willis	DATE DRAWN: April 27, 2012
REVISIONS BY: C. Lameman	DATE REVISED: July 6, 2012
CHECKED BY: H. Woods	DATE CHECKED: July 6, 2012
APPROVED BY: E. McNally	DATE APPROVED: July 6, 2012

LEGEND

----- SECONDARY CONTAINMENT

AERIAL SOURCE: (c) 2012 MICROSOFT CORPORATION- AVAILABLE EXCLUSIVELY BY DIGITALGLOBE

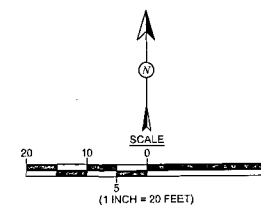

Field Screening Results				
Sample ID	Date	Depth (ft)	OVM-PID (ppm)	TPH (mg/kg)
NMOCD ACTION LEVEL			100	1,000
SC-1	7/25/12	1 to 10	73.5	78.2
SC-2	7/25/12	1 to 10	144	113
SC-3	7/25/12	1 to 10	750	528
SC-4	7/25/12	1 to 10	35.8	37.8
SC-5	7/25/12	10	147	43.9

Laboratory Analytical Results				
Sample ID	Date	Depth (ft)	Benzene (mg/kg)	Total BTEX (mg/kg)
NMOCD ACTION LEVEL			10	50
SC-2	7/25/12	1 to 10	<0.050	<0.25
SC-3	7/25/12	1 to 10	<0.050	<0.25
SC-5	7/25/12	10	<0.050	<0.25

NOTE: ALL SAMPLES WERE ANALYZED PER EPA METHOD 8021B.

LINDRITH B #5
WELL HEAD
(N36.29789, W107.16797)

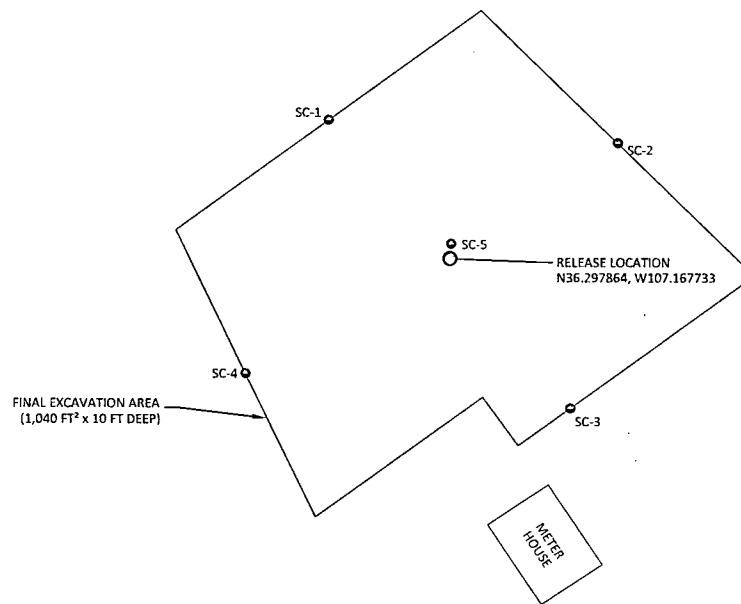

FIGURE 3

**CONFIRMATION SOIL SAMPLING
LOCATIONS AND RESULTS
JULY 2012**
ConocoPhillips
Lindrith B #5
RIO ARriba COUNTY, NEW MEXICO
SW¼, NW¼, SECTION 21, T24N, R3W
N36.29789, W107.16797



Animas Environmental Services, LLC

DRAWN BY:
C. Lamean

DATE DRAWN:
July 30, 2012

REVISIONS BY:
C. Lamean

DATE REVISED:
July 30, 2012

CHECKED BY:
D. Watson

DATE CHECKED:
July 30, 2012

APPROVED BY:
E. McNally

DATE APPROVED:
November 5, 2012

LEGEND

- 5-POINT COMPOSITE SAMPLE LOCATIONS

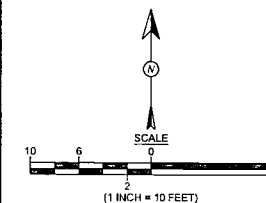

AES Field Screening Report

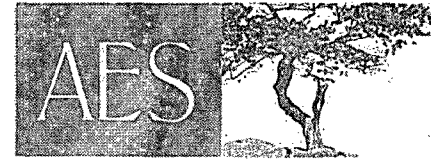

Animas Environmental Services, LLC

www.animasenvironmental.com

624 E. Comanche
Farmington, NM 87401
505-564-2281

Durango, Colorado
970-403-3274

Client: ConocoPhillips

Project Location: Lindrith B #5

Date: 7/25/2012

Matrix: Soil

Sample ID	Collection Date	Time of Sample Collection	Sample Location	OVM (ppm)	Field TPH Analysis Time	Field TPH* (mg/kg)	TPH PQL (mg/kg)	DF	TPH Analysts Initials
SC-1	7/25/2012	10:47	North	73.5	11:55	78.2	20.0	1	DAW
SC-2	7/25/2012	10:45	East	144	11:59	113	20.0	1	DAW
SC-3	7/25/2012	10:40	South	750	12:02	528	20.0	1	DAW
SC-4	7/25/2012	10:54	West	35.8	12:05	37.8	20.0	1	DAW
SC-5	7/25/2012	10:50	Base	147	12:08	43.9	20.0	1	DAW

PQL Practical Quantitation Limit

ND Not Detected at the Reporting Limit

DF Dilution Factor

*Field TPH concentrations recorded may be below PQL.

Total Petroleum Hydrocarbons - USEPA 418.1

Analyst:

Debrah Wata



Hall Environmental Analysis Laboratory
4901 Hawkins NE
Albuquerque, NM 87109
TEL: 505-345-3975 FAX: 505-345-4107
Website: www.hallenvironmental.com

August 02, 2012

Debbie Watson

Animas Environmental Services

624 East Comanche

Farmington, NM 87401

TEL: (505) 486-4071

FAX

RE: COP Lindrith B #5

OrderNo.: 1207B43

Dear Debbie Watson:

Hall Environmental Analysis Laboratory received 3 sample(s) on 7/26/2012 for the analyses presented in the following report.

These were analyzed according to EPA procedures or equivalent. To access our accredited tests please go to www.hallenvironmental.com or the state specific web sites. See the sample checklist and/or the Chain of Custody for information regarding the sample receipt temperature and preservation. Data qualifiers or a narrative will be provided if the sample analysis or analytical quality control parameters require a flag. All samples are reported as received unless otherwise indicated. Lab measurement of analytes considered field parameters that require analysis within 15 minutes of sampling such as pH and residual chlorine are qualified as being analyzed outside of the recommended holding time.

Please don't hesitate to contact HEAL for any additional information or clarifications.

Sincerely,

A handwritten signature in black ink, appearing to read "Andy Freeman", with a stylized flourish at the end.

Andy Freeman

Laboratory Manager

4901 Hawkins NE

Albuquerque, NM 87109

Analytical Report

Lab Order 1207B43

Date Reported: 8/2/2012

Hall Environmental Analysis Laboratory, Inc.**CLIENT:** Animas Environmental Services**Client Sample ID:** SC-2**Project:** COP Lindrith B #5**Collection Date:** 7/25/2012 10:45:00 AM**Lab ID:** 1207B43-001**Matrix:** MEOH (SOIL)**Received Date:** 7/26/2012 9:59:00 AM

Analyses	Result	RL	Qual	Units	DF	Date Analyzed
EPA METHOD 8021B: VOLATILES						Analyst: NSB
Benzene	ND	0.050		mg/Kg	1	7/26/2012 12:40:06 PM
Toluene	ND	0.050		mg/Kg	1	7/26/2012 12:40:06 PM
Ethylbenzene	ND	0.050		mg/Kg	1	7/26/2012 12:40:06 PM
Xylenes, Total	ND	0.10		mg/Kg	1	7/26/2012 12:40:06 PM
Surr: 4-Bromofluorobenzene	107	80-120		%REC	1	7/26/2012 12:40:06 PM

Qualifiers: *X Value exceeds Maximum Contaminant Level.
E Value above quantitation range
J Analyte detected below quantitation limits
R RPD outside accepted recovery limits
S Spike Recovery outside accepted recovery limits

B Analyte detected in the associated Method Blank
H Holding times for preparation or analysis exceeded
ND Not Detected at the Reporting Limit
RL Reporting Detection Limit
U Samples with CalcVal < MDL

Analytical Report

Lab Order 1207B43

Date Reported: 8/2/2012

Hall Environmental Analysis Laboratory, Inc.**CLIENT:** Animas Environmental Services**Client Sample ID:** SC-3**Project:** COP Lindrith B #5**Collection Date:** 7/25/2012 10:40:00 AM**Lab ID:** 1207B43-002**Matrix:** MEOH (SOIL)**Received Date:** 7/26/2012 9:59:00 AM

Analyses	Result	RL	Qual	Units	DF	Date Analyzed
EPA METHOD 8021B: VOLATILES						Analyst: NSB
Benzene	ND	0.050		mg/Kg	1	7/26/2012 1:08:50 PM
Toluene	ND	0.050		mg/Kg	1	7/26/2012 1:08:50 PM
Ethylbenzene	ND	0.050		mg/Kg	1	7/26/2012 1:08:50 PM
Xylenes, Total	ND	0.10		mg/Kg	1	7/26/2012 1:08:50 PM
Surr: 4-Bromofluorobenzene	118	80-120		%REC	1	7/26/2012 1:08:50 PM

Qualifiers:

- *X Value exceeds Maximum Contaminant Level.
- E Value above quantitation range
- J Analyte detected below quantitation limits
- R RPD outside accepted recovery limits
- S Spike Recovery outside accepted recovery limits

- B Analyte detected in the associated Method Blank
- H Holding times for preparation or analysis exceeded
- ND Not Detected at the Reporting Limit
- RL Reporting Detection Limit
- U Samples with CalcVal < MDL

Analytical Report

Lab Order 1207B43

Date Reported: 8/2/2012

Hall Environmental Analysis Laboratory, Inc.**CLIENT:** Animas Environmental Services**Client Sample ID:** SC-5**Project:** COP Lindrith B #5**Collection Date:** 7/25/2012 10:50:00 AM**Lab ID:** 1207B43-003**Matrix:** MEOH (SOIL)**Received Date:** 7/26/2012 9:59:00 AM

Analyses	Result	RL	Qual	Units	DF	Date Analyzed
EPA METHOD 8021B: VOLATILES						Analyst: NSB
Benzene	ND	0.050		mg/Kg	1	7/26/2012 1:37:35 PM
Toluene	ND	0.050		mg/Kg	1	7/26/2012 1:37:35 PM
Ethylbenzene	ND	0.050		mg/Kg	1	7/26/2012 1:37:35 PM
Xylenes, Total	ND	0.10		mg/Kg	1	7/26/2012 1:37:35 PM
Surr: 4-Bromofluorobenzene	110	80-120		%REC	1	7/26/2012 1:37:35 PM

Qualifiers:

- * / X Value exceeds Maximum Contaminant Level.
- E Value above quantitation range
- J Analyte detected below quantitation limits
- R RPD outside accepted recovery limits
- S Spike Recovery outside accepted recovery limits

- B Analyte detected in the associated Method Blank
- H Holding times for preparation or analysis exceeded
- ND Not Detected at the Reporting Limit
- RL Reporting Detection Limit
- U Samples with CalcVal < MDL

QC SUMMARY REPORT

Hall Environmental Analysis Laboratory, Inc.

WO#: 1207B43

02-Aug-12

Client: Animas Environmental Services

Project: COP Lindrith B #5

Sample ID	MB-3010		SampType:	MBLK		TestCode:	EPA Method 8021B: Volatiles			
Client ID:	PBS		Batch ID:	3010		RunNo:	4444			
Prep Date:	7/24/2012		Analysis Date:	7/26/2012		SeqNo:	124745		Units: mg/Kg	
Analyte	Result	PQL	SPK value	SPK Ref Val	%REC	LowLimit	HighLimit	%RPD	RPDLimit	Qual
Benzene	ND	0.050								
Toluene	ND	0.050								
Ethylbenzene	ND	0.050								
Xylenes, Total	ND	0.10								
Surr: 4-Bromofluorobenzene	1.0		1.000		104	.80	120			

Sample ID	LCS-3010		SampType:	LCS		TestCode:	EPA Method 8021B: Volatiles			
Client ID:	LCSS		Batch ID:	3010		RunNo:	4444			
Prep Date:	7/24/2012		Analysis Date:	7/26/2012		SeqNo:	124746		Units: mg/Kg	
Analyte	Result	PQL	SPK value	SPK Ref Val	%REC	LowLimit	HighLimit	%RPD	RPDLimit	Qual
Benzene	0.98	0.050	1.000	0	97.8	76.3	117			
Toluene	1.0	0.050	1.000	0	99.9	80	120			
Ethylbenzene	1.0	0.050	1.000	0	104	77	116			
Xylenes, Total	3.2	0.10	3.000	0	105	76.7	117			
Surr: 4-Bromofluorobenzene	1.1		1.000		112	80	120			

Sample ID	1207A32-001AMS		SampType:	MS		TestCode:	EPA Method 8021B: Volatiles			
Client ID:	BatchQC		Batch ID:	3010		RunNo:	4444			
Prep Date:	7/24/2012		Analysis Date:	7/27/2012		SeqNo:	124752		Units: mg/Kg	
Analyte	Result	PQL	SPK value	SPK Ref Val	%REC	LowLimit	HighLimit	%RPD	RPDLimit	Qual
Benzene	0.92	0.047	0.9398	0	98.3	67.2	113			
Toluene	0.94	0.047	0.9398	0	101	62.1	116			
Ethylbenzene	0.97	0.047	0.9398	0.003234	103	67.9	127			
Xylenes, Total	3.0	0.094	2.820	0	107	60.6	134			
Surr: 4-Bromofluorobenzene	1.0		0.9398		111	80	120			

Sample ID	1207A32-001AMSD		SampType:	MSD		TestCode:	EPA Method 8021B: Volatiles			
Client ID:	BatchQC		Batch ID:	3010		RunNo:	4444			
Prep Date:	7/24/2012		Analysis Date:	7/27/2012		SeqNo:	124753		Units: mg/Kg	
Analyte	Result	PQL	SPK value	SPK Ref Val	%REC	LowLimit	HighLimit	%RPD	RPDLimit	Qual
Benzene	0.92	0.047	0.9355	0	98.4	67.2	113	0.459	14.3	
Toluene	0.95	0.047	0.9355	0	101	62.1	116	0.477	15.9	
Ethylbenzene	0.98	0.047	0.9355	0.003234	104	67.9	127	0.601	14.4	
Xylenes, Total	3.0	0.094	2.806	0	106	60.6	134	1.24	12.6	
Surr: 4-Bromofluorobenzene	1.1		0.9355		115	80	120	0	0	

Qualifiers:

*X Value exceeds Maximum Contaminant Level.
E Value above quantitation range
J Analyte detected below quantitation limits
R RPD outside accepted recovery limits

B Analyte detected in the associated Method Blank
H Holding times for preparation or analysis exceeded
ND Not Detected at the Reporting Limit
RL Reporting Detection Limit

Sample Log-In Check List

Client Name: Animas Environmental	Work Order Number: 1207B43
Received by/date: <u>[Signature]</u> 07/26/12	
Logged By: Ashley Gallegos	7/26/2012 9:59:00 AM <u>[Signature]</u>
Completed By: Ashley Gallegos	7/26/2012 10:02:21 AM <u>[Signature]</u>
Reviewed By: <u>MG</u>	07/26/12

Chain of Custody

1. Were seals intact? Yes ☐ No ☐ Not Present ☒
2. Is Chain of Custody complete? Yes ☒ No ☐ Not Present ☐
3. How was the sample delivered? Courier

Log In

4. Coolers are present? (see 19. for cooler specific information) Yes ☒ No ☐ NA ☐
5. Was an attempt made to cool the samples? Yes ☒ No ☐ NA ☐
6. Were all samples received at a temperature of >0° C to 6.0°C Yes ☒ No ☐ NA ☐
7. Sample(s) in proper container(s)? Yes ☒ No ☐
8. Sufficient sample volume for indicated test(s)? Yes ☒ No ☐
9. Are samples (except VOA and ONG) properly preserved? Yes ☒ No ☐
10. Was preservative added to bottles? Yes ☐ No ☒ NA ☐
11. VOA vials have zero headspace? Yes ☐ No ☐ No VOA Vials ☒
12. Were any sample containers received broken? Yes ☐ No ☒
13. Does paperwork match bottle labels?
(Note discrepancies on chain of custody) Yes ☒ No ☐
14. Are matrices correctly identified on Chain of Custody? Yes ☒ No ☐
15. Is it clear what analyses were requested? Yes ☒ No ☐
16. Were all holding times able to be met?
(If no, notify customer for authorization.) Yes ☒ No ☐

of preserved bottles checked for pH: _____
(<2 or >12 unless noted)

Adjusted? _____

Checked by: _____

Special Handling (if applicable)

17. Was client notified of all discrepancies with this order? Yes ☐ No ☐ NA ☒

Person Notified: _____	Date: _____
By Whom: _____	Via: <input type="checkbox"/> eMail <input type="checkbox"/> Phone <input type="checkbox"/> Fax <input type="checkbox"/> In Person
Regarding: _____	
Client Instructions: _____	

18. Additional remarks:

19. Cooler Information

Cooler No	Temp °C	Condition	Seal Intact	Seal No	Seal Date	Signed By
1	1.0	Good	Yes			

Chain-of-Custody Record		Turn-Around Time:
Client: <u>Annmas Environmental Services LLC</u>	<input type="checkbox"/> Standard	<input checked="" type="checkbox"/> Rush <u>Same day</u>
Mailing Address: <u>624 E Comanche Farmington NM 87401</u>	Project Name: <u>CoP Lindrith B#5</u>	
Phone #: <u>505 564 2281</u>	Project #:	
email or Fax#:	Project Manager:	
QA/QC Package:	<u>D. Watson</u>	
<input checked="" type="checkbox"/> Standard	<input type="checkbox"/> Level 4 (Full Validation)	
Accreditation	Sampler: <u>D Watson</u>	
<input type="checkbox"/> NELAP	<input type="checkbox"/> Other _____	
<input type="checkbox"/> EDD (Type) _____	Office: <input checked="" type="checkbox"/> Yes <input type="checkbox"/> No	
	Sample Temperature: <u>10</u>	

☐ Standard ☒ Rush Same day

C.P. Lindrith B#5

Project Manager:

D. Watson

Sampler: D Watson

Office: ☒ Yes ☐ No

Sample Temperature: 100

Container Type and #	Material	Volume	Weight	Notes
1
2
3
4
5
6
7
8
9
10
11
12
13
14
15
16
17
18
19
20
21
22
23
24
25
26
27
28
29
30
31
32
33
34
35
36
37
38
39
40
41
42
43
44
45
46
47
48
49
50
51
52
53
54
55
56
57
58
59
60
61
62
63
64
65
66
67
68
69
70
71
72
73
74
75
76
77
78
79
80
81
82
83
84
85
86
87
88
89
90
91
92
93
94
95
96
97
98
99
100

Preservative Type	Concentration (%)	Shelf Life (Months)	Stability Index
Sodium Benzoate	0.1	6	98
Potassium Sorbate	0.05	12	95
Natural Preservatives	Varies	3-6	90-95

HEALING

130724/3

7-25-12	1045	Soil	SC-2	4oz glass	met	met	-001
	1040	Soil	SC-3				-002
	1050	Soil	SC-5				-003

www.hallenvironmental.com

4901 Hawkins NE - Albuquerque, NM 87109

Tel. 505-345-3975 Fax 505-345-4107

Analysis Request

[illegible]

11-10-1964

Date:	Time:	Relinquished by:
4/25/12	1643	Debrah Watson
Date:	Time:	Relinquished by:
4/25/12	1714	Christine J. Watson

Received by:	Date	Time
Christine Waeten	4/25/12	1643
Received by:	Date	Time
	07/26/12	0955

Remarks: Bill to ConocoPhillips
WO: 9079364
Area: 26
Super: Kendal Bassing

user id: KATLW
act. code: D150
ordered by: Eric Smith

If necessary, samples submitted to Hall Environmental may be subcontracted to other ~~companies~~ laboratories.