

UNITED STATES
DEPARTMENT OF THE INTERIOR
BUREAU OF LAND MANAGEMENTFORM APPROVED
OMB No. 1004-0137
Expires: July 31, 2010

DEC 06 2012

SUNDRY NOTICES AND REPORTS ON WELLS

~~Do not use this form for proposals to drill or to re-enter an abandoned well. Use Form 3160-3 (APD) for such proposals.~~

SUBMIT IN TRIPLICATE - Other instructions on page 2.

1. Type of Well

☐

Oil Well

☒

Gas Well

☐

Other

2. Name of Operator

Burlington Resources Oil & Gas Company LP

3a. Address

PO Box 4289, Farmington, NM 87499

3b. Phone No. (include area code)

(505) 326-9700

5. Lease Serial No.

SF-078138

6. If Indian, Allottee or Tribe Name

7. If Unit of CA/Agreement, Name and/or No.

8. Well Name and No.

Hartman 23 #1P

9. API Well No.

30-045-35323

10. Field and Pool or Exploratory Area

4. Location of Well (Footage, Sec., T., R., M., or Survey Description)

Surface UNIT K (NESW), 1930' FSL & 2091' FWL, Sec. 23, T30N, R11W

Bottomhole UNIT K (NESW), 1695' FSL & 1910' FWL, Sec. 23, T30N, R11W

11. Country or Parish, State

San Juan

New Mexico

12. CHECK THE APPROPRIATE BOX(ES) TO INDICATE NATURE OF NOTICE, REPORT OR OTHER DATA

TYPE OF SUBMISSION	TYPE OF ACTION			
<input type="checkbox"/> Notice of Intent	<input type="checkbox"/> Acidize	<input type="checkbox"/> Deepen	<input type="checkbox"/> Production (Start/Resume)	<input type="checkbox"/> Water Shut-Off
<input checked="" type="checkbox"/> Subsequent Report	<input type="checkbox"/> Alter Casing	<input type="checkbox"/> Fracture Treat	<input type="checkbox"/> Reclamation	<input type="checkbox"/> Well Integrity
<input type="checkbox"/> Final Abandonment Notice	<input type="checkbox"/> Casing Repair	<input type="checkbox"/> New Construction	<input type="checkbox"/> Recomplete	<input checked="" type="checkbox"/> Other Cathodic
	<input type="checkbox"/> Change Plans	<input type="checkbox"/> Plug and Abandon	<input type="checkbox"/> Temporarily Abandon	Sundry
	<input type="checkbox"/> Convert to Injection	<input type="checkbox"/> Plug Back	<input type="checkbox"/> Water Disposal	

13. Describe Proposed or Completed Operation: Clearly state all pertinent details, including estimated starting date of any proposed work and approximate duration thereof.

If the proposal is to deepen directionally or recompleat horizontally, give subsurface locations and measured and true vertical depths of all pertinent markers and zones. Attach the bond under which the work will be performed or provide the Bond No. on file with BLM/BIA. Required subsequent reports must be filed within 30 days following completion of the involved operations. If the operation results in a multiple completion or recompleat in a new interval, a Form 3160-4 must be filed once Testing has been completed. Final Abandonment Notices must be filed only after all requirements, including reclamation, have been completed and the operator has determined that the site is ready for final inspection.)

Attached is a drawing for the placement of the cathodic ground, rectifier and cable for the subject well.

RCVD DEC 11 '12
OIL CONS. DIV.
DIST. 3

14. I hereby certify that the foregoing is true and correct. Name (Printed/Typed)

DENISE JOURNEY

Title

REGULATORY TECHNICIAN

Signature

Date

12/6/2012

THIS SPACE FOR FEDERAL OR STATE OFFICE USE

Approved by

ACCEPTED FOR RECORD

Title

Date

Conditions of approval, if any, are attached. Approval of this notice does not warrant or certify that the applicant holds legal or equitable title to those rights in the subject lease which would entitle the applicant to conduct operations thereon.

Office

DEC - 7 2012

Title 18 U.S.C. Section 1001 and Title 43 U.S.C. Section 1212, make it a crime for any person knowingly and willfully to make to any department or agency of the United States any false, fictitious or fraudulent statements or representations as to any matter within its jurisdiction.

(Instruction on page 2)

APPROVED BY ca

Hartman 23 #1P

Section 23, T30N, R11W, San Juan County, NM

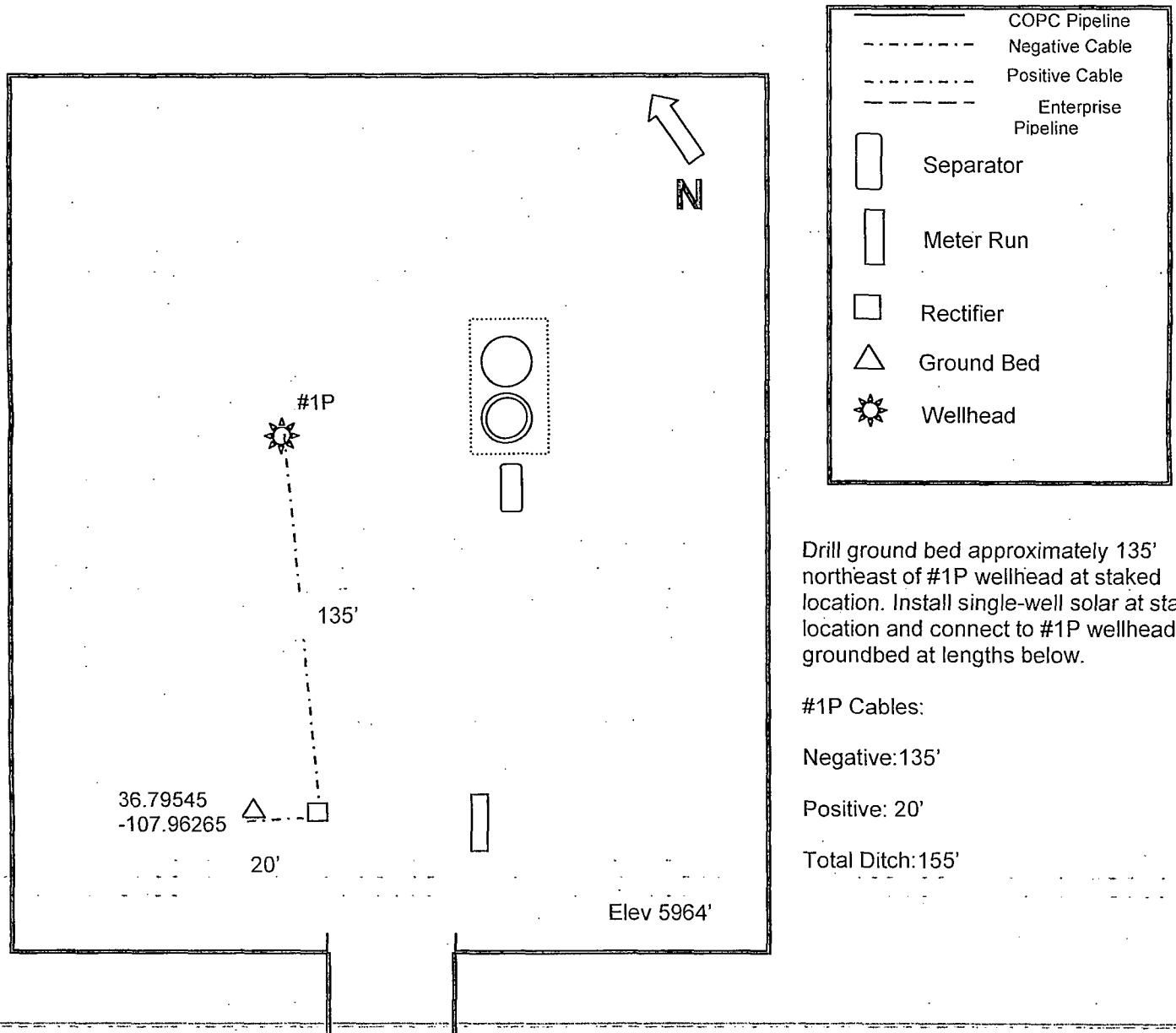

Drill ground bed approximately 135' northeast of #1P wellhead at staked location. Install single-well solar at staked location and connect to #1P wellhead and groundbed at lengths below.

#1P Cables:

Negative: 135'

Positive: 20'

Total Ditch: 155'