

# RECEIVED

Form 3160-5  
(March 2012)

UNITED STATES  
DEPARTMENT OF THE INTERIOR  
BUREAU OF LAND MANAGEMENT

AUG 15 2013

FORM APPROVED  
OMB No. 1004-0137  
Expires: October 31, 2014

**SUNDRY NOTICES AND REPORTS ON WELLS**  
*Do not use this form for proposals to drill or to re-enter an abandoned well. Use Form 3160-3 (APD) for such proposals.*

5. Lease Serial No.  
Jicarilla Contract 155  
6. If Indian, Allottee or Tribe Name  
Jicarilla Apache Tribe

**SUBMIT IN TRIPLICATE** - Other instructions on page 2.

1. Type of Well

☐ Oil Well ☒ Gas Well ☐ Other

2. Name of Operator  
EnerVest Operating, L.L.C.

3a. Address  
1001 Fannin St., Suite 800  
Houston, TX 77002

3b. Phone No. (include area code)  
713-659-3500

7. If Unit of CA/Agreement, Name and/or No.

8. Well Name and No.  
Jicarilla Contract 155 #13N

9. API Well No.  
30-039-29936

10. Field and Pool or Exploratory Area  
Blanco Mesaverde/Basin Dakota

4. Location of Well (Footage, Sec., T., R., M., or Survey Description)  
SHL: 1550' FSL & 1810' FWL (UL K), Sec. 30 T26N R05W  
BHL: 1484' FSL & 1803' FWL (UL K), Sec. 30 T26N R05W

11. County or Parish, State  
Rio Arriba, NM

12. CHECK THE APPROPRIATE BOX(ES) TO INDICATE NATURE OF NOTICE, REPORT OR OTHER DATA

TYPE OF SUBMISSION	TYPE OF ACTION			
<input type="checkbox"/> Notice of Intent	<input type="checkbox"/> Acidize	<input type="checkbox"/> Deepen	<input checked="" type="checkbox"/> Production (Start/Resume)	<input type="checkbox"/> Water Shut-Off
<input checked="" type="checkbox"/> Subsequent Report	<input type="checkbox"/> Alter Casing	<input type="checkbox"/> Fracture Treat	<input type="checkbox"/> Reclamation	<input type="checkbox"/> Well Integrity
<input type="checkbox"/> Final Abandonment Notice	<input type="checkbox"/> Casing Repair	<input type="checkbox"/> New Construction	<input type="checkbox"/> Recomplete	<input type="checkbox"/> Other _____
	<input type="checkbox"/> Change Plans	<input type="checkbox"/> Plug and Abandon	<input type="checkbox"/> Temporarily Abandon	<u>First Delivery/Test</u>
	<input type="checkbox"/> Convert to Injection	<input type="checkbox"/> Plug Back	<input type="checkbox"/> Water Disposal	

13. Describe Proposed or Completed Operation: Clearly state all pertinent details, including estimated starting date of any proposed work and approximate duration thereof. If the proposal is to deepen directionally or recompleate horizontally, give subsurface locations and measured and true vertical depths of all pertinent markers and zones. Attach the Bond under which the work will be performed or provide the Bond No. on file with BLM/BIA. Required subsequent reports must be filed within 30 days following completion of the involved operations. If the operation results in a multiple completion or recompleation in a new interval, a Form 3160-4 must be filed once testing has been completed. Final Abandonment Notices must be filed only after all requirements, including reclamation, have been completed and the operator has determined that the site is ready for final inspection.)

1st Delivery Notice

July 31, 2013: 1st production utilizing a C-104 Test Allowable and "Green Completion"  
August 6, 2013: 8 hr Dakota/Mesaverde test: Gas = 255.16 mcf Water = 66 bbls Oil = 1 bbl

Well producing as a Dakota/Mesaverde dual as authorized by DHC #3796AZ. Production allocation determined by offset well production:

Basin Dakota: Gas = 451.63 mcf (59%) Water = 110.88 bbls (56%) Oil = 2.34 bbls (78%)  
Blanco Mesaverde: Gas = 313.85 mcf (41%) Water = 87.12 bbls (44%) Oil = 0.66 bbls (22%)

Attached: Table w/Offset Well Production Data used to determine production allocation, Map of Offset Dakota/Mesaverde wells.

14. I hereby certify that the foregoing is true and correct. Name (Printed/Typed)

Bart Trevino

Title Regulatory Analyst

Signature

*Bart Trevino*

Date 08/15/2013

**THIS SPACE FOR FEDERAL OR STATE OFFICE USE**

Approved by

Title

Office

Conditions of approval, if any, are attached. Approval of this notice does not warrant or certify that the applicant holds legal or equitable title to those rights in the subject lease which would entitle the applicant to conduct operations thereon.

Title 18 U.S.C. Section 1001 and Title 43 U.S.C. Section 1212, make it a crime for any person knowingly and willfully to make to any department or agency of the United States any false, fictitious or fraudulent statements or representations as to any matter within its jurisdiction.

(Instructions on page 2)

ACCEPTED FOR RECORD

Date

AUG 19 2013

FARMINGTON FIELD OFFICE  
BY *cy*

NMOCDF

RCVD AUG 21 '13  
OIL CONS. DIV.  
DIST. 3

**DHC Application**  
**Jicarilla Contract 155 No. 13N**  
**Offset Well Production**

<b>Offset Well Name &amp; Number</b>	<b>Well Location</b>	<b>2013 Avg. Mesaverde Oil Production</b>	<b>2013 Avg. Mesaverde Gas Production</b>	<b>2013 Avg. Mesaverde H2O Prod.</b>	<b>2013 Avg. Dakota Oil Production</b>	<b>2013 Avg. Dakota Gas Production</b>	<b>2013 Avg. Dakota H2O Prod.</b>
Jicarilla Contract 155 # 16M	C-30-26N-5W	0.0 BOPD	167 MCFG/D	5.5 BWPD	10 BOPD	131 MCFG/D	5.5 BWPD
Jicarilla A # 5E	J-20-26N-5W	1.0 BOPD	88 MCFG/D	0.44 BWPD	0.20 BOPD	43 MCFG/D	0.7 BWPD
Jicarilla Contract 155 # 20	N-29-26N-5W	0.18 BOPD	8.5 MCFG/D	0.53 BWPD	0.30 BOPD	55 MCFG/D	0.93 BWPD
Jicarilla Contract 155 # 22	I-31-26N-5W	0.0 BOPD	23 MCFG/D	0.01 BWPD	0.0 BOPD	97 MCFG/D	0.02 BWPD
Sanchez # 8	F-24-26N-6W	0.25 BOPD	30 MCFG/D	0.46 BWPD	0.11 BOPD	30 MCFG/D	0.46 BWPD
Sanchez # 6	K-25-26N-6W	0.93 BOPD	47 MCFG/D	0.10 BWPD	0.40 BOPD	127 MCFG/D	0.26 BWPD
Jicarilla A # 4M	L-19-26N-5W	1.62 BOPD	151 MCFG/D	0.0 BWPD	5.0 BOPD	263 MCFG/D	0.0 BWPD
Jicarilla Contract 155 # 29	F-32-26N-5W	0.5 BOPD	43 MCFG/D	0.22 BWPD	N/A	N/A	N/A
Jicarilla Gas Com B # 1E	D-31-26N-5W	N/A	N/A	N/A	0.25 BOPD	50 MCFG/D	1.4 BWPD
<b>Well Average</b>		<b>0.56 BOPD</b>	<b>70 MCFG/D</b>	<b>0.91 BWPD</b>	<b>2.03 BOPD</b>	<b>99 MCFG/D</b>	<b>1.16 BWPD</b>
<b>Recommended Allocation</b>		<b>22%</b>	<b>41%</b>	<b>44%</b>	<b>78%</b>	<b>59%</b>	<b>56%</b>

**6 West**

**5 West**

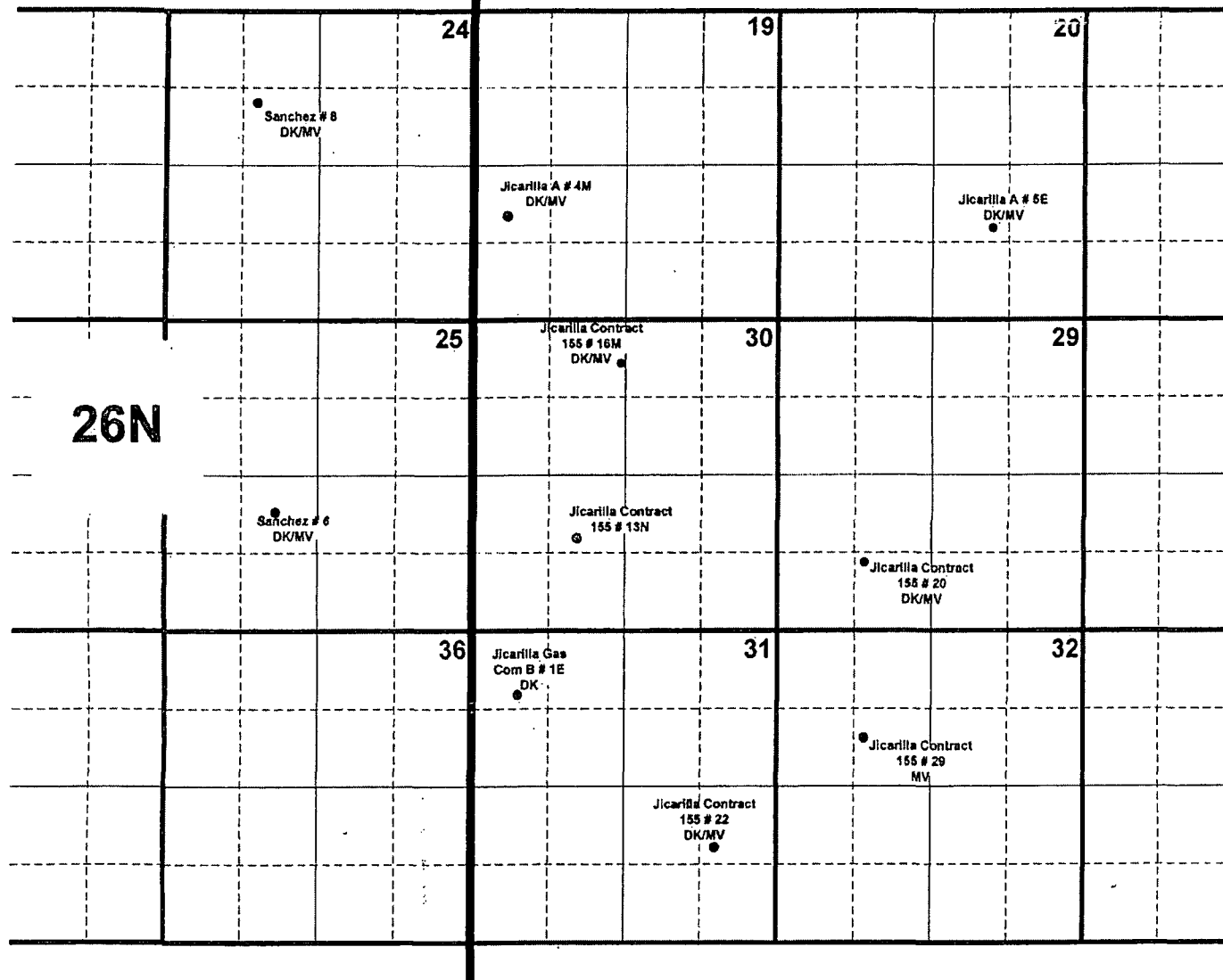

**DHC Application**  
**Jicarilla Contract 155 No. 13N**  
**Offset Dakota/Mesaverde Wells**