

UNITED STATES  
DEPARTMENT OF THE INTERIOR  
BUREAU OF LAND MANAGEMENT

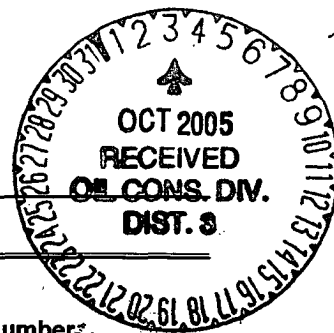

APPLICATION FOR PERMIT TO DRILL, DEEPEN, OR PLUG BACK

2005 AUG 26 PM 8 49

1a. Type of Work DRILL	5. Lease Number NMSF-078945 Unit Reporting Number
1b. Type of Well GAS	6. If Indian, All. or Tribe
2. Operator <b>BURLINGTON</b> RESOURCES Oil & Gas Company	7. Unit Agreement Name San Juan 29-7 Unit
3. Address & Phone No. of Operator PO Box 4289, Farmington, NM 87499 (505) 326-9700	8. Farm or Lease Name San Juan 29-7 Unit 9. Well Number #38B
4. Location of Well 1765' FSL, 2275' FEL Latitude 36° 44.2660'N, Longitude 107° 31.2273'W	10. Field, Pool, Wildcat Blanco Mesaverde/Basin Dakota 11. Sec., Twn, Rge, Mer. (NMPM) Sec. 12, T29N, R07W API # 30-039-29639
14. Distance in Miles from Nearest Town 23 miles to Blanco, NM Post Office	12. County Rio Arriba 13. State NM
15. Distance from Proposed Location to Nearest Property or Lease Line 1765'	
16. Acres in Lease	17. Acres Assigned to Well 320 E/2 MV & DK
18. Distance from Proposed Location to Nearest Well, Drig, Compl, or Applied for on this Lease 957'	
19. Proposed Depth 7668'	20. Rotary or Cable Tools Rotary
21. Elevations (DF, FT, GR, Etc.) 6318' GR	22. Approx. Date Work will Start
23. Proposed Casing and Cementing Program See Operations Plan attached	
24. Authorized by: <u>Joni Clark</u> Regulatory Specialist	<u>8-25-05</u> Date

PERMIT NO.

APPROVAL DATE

APPROVED BY [Signature]

TITLE AFM

DATE 9/29/05

Archaeological Report attached

Threatened and Endangered Species Report attached

NOTE: This format is issued in lieu of U.S. BLM Form 3160-3

Title 18 U.S.C. Section 1001, makes it a crime for any person knowingly and willfully to make to any department or agency of the United States any false, fictitious or fraudulent statements or presentations as to any matter within its jurisdiction.

HOLD COPY FOR NSL in Dakota

NMOCD

DRILLING OPERATIONS AUTHORIZED ARE  
SUBJECT TO COMPLIANCE WITH ATTACHED  
"GENERAL REQUIREMENTS".

This action is subject to technical and  
procedural review pursuant to 43 CFR 3165.3  
and appeal pursuant to 43 CFR 3165.4

**DISTRICT II**  
**811 South First, Artesia, N.M. 88210**

**DISTRICT III**  
**1000 Rio Brazos Rd., Aztec, N.M. 87410**

**DISTRICT IV**  
**2040 South Pacheco, Santa Fe, NM 87505**

## OIL CONSERVATION DIVISION

2040 South Pacheco  
Santa Fe, NM 87505

**Submit to Appropriate District Office**  
**State Lease - 4 Copies**  
**Fee Lease - 3 Copies**

☐ AMENDED REPORT

WELL LOCATION AND ACREAGE DEDICATION PLAT

<sup>1</sup> API Number 30-039- 29639		<sup>2</sup> Pool Code 72319/71599	<sup>3</sup> Pool Name Blanco Mesaverde/Basin Dakota
<sup>4</sup> Property Code 7465	<sup>5</sup> Property Name SAN JUAN 29-7 UNIT		<sup>6</sup> Well Number 38B
<sup>7</sup> OGRID No. 14538	<sup>8</sup> Operator Name BURLINGTON RESOURCES OIL AND GAS COMPANY LP		<sup>9</sup> Elevation 6318'

## <sup>10</sup> Surface Location

UL or lot no.	Section	Township	Range	Lot Idn	Feet from the	North/South line	Feet from the	East/West line	County
J	12	29-N	7-W		1765'	SOUTH	2275'	EAST	RIO ARRIBA

<sup>11</sup> Bottom Hole Location If Different From Surface

UL or lot no.	Section	Township	Range	Lot Idn	Feet from the	North/South line	Feet from the	East/West line	County
<sup>12</sup> Dedicated Acres 320 E/2			<sup>13</sup> Joint or Infill		<sup>14</sup> Consolidation Code		<sup>15</sup> Order No.		

NO ALLOWABLE WILL BE ASSIGNED TO THIS COMPLETION UNTIL ALL INTERESTS HAVE BEEN CONSOLIDATED  
OR A NON-STANDARD UNIT HAS BEEN APPROVED BY THE DIVISION

This is a cadastral map of a portion of the NMSF-078945 concession. The map is divided into several rectangular parcels by solid lines. A dashed line runs vertically through the center-right of the map, and another dashed line runs horizontally across the middle. A small circle is located at the intersection of a vertical solid line and a horizontal solid line. The map includes the following text and features:

- Top Left:** The number "16" is in the top left corner.
- Top Center:** The text "NMSF-078945" is centered near the top.
- Middle Right:** The text "MCCARTY, C W" and "SOENS, A ET UX" is located in the upper right quadrant.
- Center:** The number "12" is centered in the middle.
- Bottom Center:** The text "LAT: 36°44.2660' N," "LONG: 107°31.2273' W," and "NAD 1927" is located in the lower center.
- Bottom Left:** The text "1765'" is written vertically along the left side of the bottom-left parcel.
- Bottom Right:** The text "2275'" is written horizontally along the right side of the bottom-right parcel.
- Far Right:** The text "N 00-08-43 E" and "2841.77'" is written vertically along the right edge.
- Bottom Right (Survey Data):** The text "N 89-46-29 W" and "2636.53'" is located at the bottom right corner.

## 17 OPERATOR CERTIFICATION

**I hereby certify that the information contained herein is true and complete to the best of my knowledge and belief**

Frances Bond  
Signature

Frances Bond  
Printed Name  
Regulatory Specialist  
Title

Date 8-25-05

## 18 SURVEYOR CERTIFICATION

I hereby certify that the well location shown on this plat was plotted from field notes of actual surveys made by me or under my supervision, and that the same is true and correct to the best of my belief.

Date of Survey: 6-11-05

Signature and Seal of Professional Surveyor

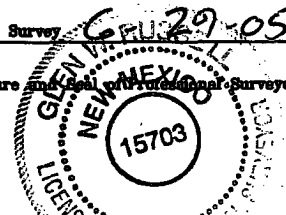

Certificate Number 15703

Office

Energy, Minerals and Natural Resources

May 27, 2004

District I

1625 N. French Dr., Hobbs, NM 88240

District II

1301 W. Grand Ave., Artesia, NM 88210

District III

1000 Rio Brazos Rd., Aztec, NM 87410

District IV

1220 S. St. Francis Dr., Santa Fe, NM 87505

## OIL CONSERVATION DIVISION

1220 South St. Francis Dr.

Santa Fe, NM 87505

WELL API NO.

30-039-29639

5. Indicate Type of Lease

STATE ☐FEE ☐

6. State Oil &amp; Gas Lease No.

NMSF-078945

7. Lease Name or Unit Agreement Name

San Juan 29-7 Unit

8. Well Number

38B

9. OGRID Number

14538

10. Pool name or Wildcat

Blanco Mesaverde/Basin Dakota

-- SUNDRY NOTICES AND REPORTS ON WELLS  
(DO NOT USE THIS FORM FOR PROPOSALS TO DRILL OR TO DEEPEN OR PLUG BACK TO A  
DIFFERENT RESERVOIR. USE "APPLICATION FOR PERMIT" (FORM C-101) FOR SUCH  
PROPOSALS.)

1. Type of Well:

Oil Well ☐Gas Well ☒

Other

2. Name of Operator

BURLINGTON RESOURCES OIL &amp; GAS COMPANY LP

3. Address of Operator

3401 E. 30TH STREET, FARMINGTON, NM 87402

4. Well Location

Unit Letter J : 1765 feet from the South line and 2275 feet from the East lineSection 12 Township 29N Range 7W NMPM County Rio Arriba

11. Elevation (Show whether DR, RKB, RT, GR, etc.)

6353' GR

Pit or Below-grade Tank Application

☒ or ClosurePit type New Drill Depth to Groundwater 280'

Distance from nearest fresh water well

&gt;1000'

Distance from nearest surface water

Pit Liner Thickness:

12

mil

Below-Grade Tank:

Volume

bbls;

Construction Material

## 12. Check Appropriate Box to Indicate Nature of Notice, Report or Other Data

## NOTICE OF INTENTION TO:

PERFORM REMEDIAL WORK ☐TEMPORARILY ABANDON ☐PULL OR ALTER CASING ☐PLUG AND ABANDON ☐CHANGE PLANS ☐MULTIPLE COMPL ☐

OTHER:

New Drill Pit ☒

## SUBSEQUENT REPORT OF:

REMEDIAL WORK ☐COMMENCE DRILLING OPNS. ☐CASING/CEMENT JOB ☐ALTERING CASING ☐P AND A ☐OTHER: ☐

13. Describe proposed or completed operations. (Clearly state all pertinent details, and give pertinent dates, including estimated date of starting any proposed work). SEE RULE 1103. For Multiple Completions: Attach wellbore diagram of proposed completion or recompletion.

Burlington Resources proposes to construct a new drilling pit and an associated vent/flare pit. Based on Burlington's interpretation of the Ecosphere's risk ranking criteria, the new drilling pit will be a lined pit as detailed in Burlington's Revised Drilling / Workover Pit Construction / Operation Procedures dated November 11, 2004 on file at the NMOCD office. A portion of the vent/flare pit will be designed to manage fluids and that portion will be lined as per the risk ranking criteria. Burlington Resources anticipates closing these pits according to the Drilling / Workover Pit Closure Procedure dated August 2, 2004 on file at the NMOCD office.

I hereby certify that the information above is true and complete to the best of my knowledge and belief. I further certify that any pit or below-grade tank has been/will be constructed or closed according to NMOCD guidelines ☐, a general permit ☒ or an (attached) alternative OCD-approved plan ☐.

SIGNATURE

TITLE

Regulatory Specialist

DATE

7/26/2005

Type or print name

Joni Clark

E-mail address:

jclark@br-inc.com

Telephone No.

505-326-9700

For State Use Only

APPROVED BY

TITLE

DEPUTY OIL &amp; GAS INSPECTOR, DIST. 3

DATE

OCT 03 2005

Conditions of Approval (if any):

**BURLINGTON RESOURCES OIL & GAS COMPANY LP**  
**SAN JUAN 29-7 UNIT #38B, 1765' FSL & 2275' FEL**  
**SECTION 12, T-29-N, R-7-W, NMPM, RIO ARriba COUNTY, NM**  
**GROUND ELEVATION: 6318', DATE: JUNE 14, 2005**

ELEV. A'-A

C/L

6330									
6320									
6310									
6300									

ELEV. B'-B

C/L

6330									
6320									
6310									
6300									

ELEV. C'-C

C/L

6330									
6320									
6310									
6300									

NOTE: VECTOR SURVEYS IS NOT LIABLE FOR UNDERGROUND UTILITIES OR PIPELINES.  
 CONTRACTOR SHOULD CALL ONE-CALL FOR LOCATION OF ANY MARKED OR UNMARKED BURIED  
 PIPELINES OR CABLES ON WELL PAD AND OR ACCESS ROAD AT LEAST TWO (2) WORKING DAYS PRIOR TO CONSTRUCTION.

**BURLINGTON RESOURCES OIL & GAS COMPANY LP**  
**SAN JUAN 29-7 UNIT #38B, 1765' FSL & 2275' FEL**  
**SECTION 12, T-29-N, R-7-W, NMPM, RIO ARKIBIA COUNTY, NM**  
**GROUND ELEVATION: 6318', DATE: JUNE 14, 2005**

RESERVE PIT DIKE: TO BE 8' ABOVE DEEP SIDE (OVERFLOW - 3' WIDE AND 1' ABOVE SHALLOW SIDE).

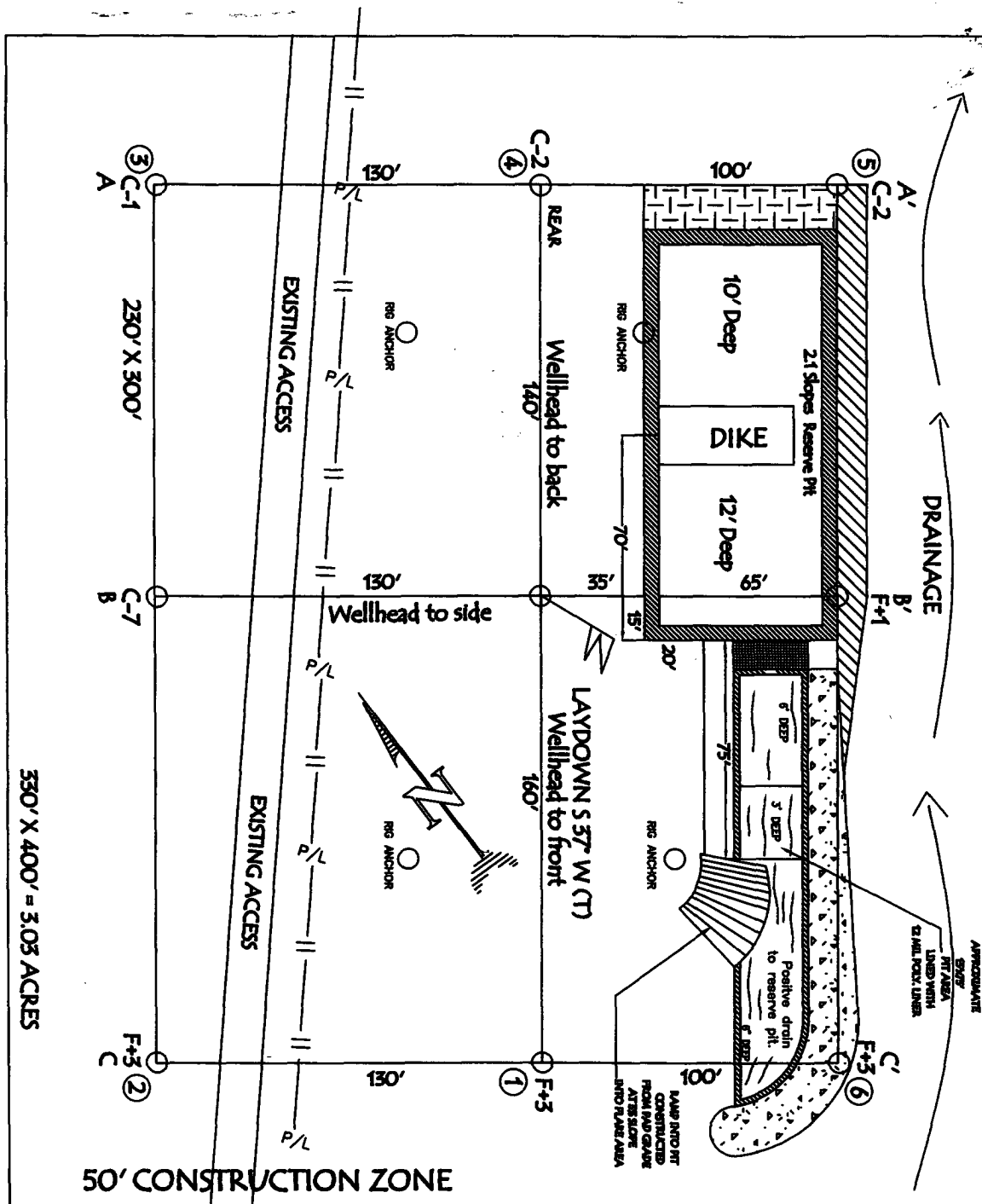

NOTE: VECTOR SURVEYS IS NOT LIABLE FOR UNDERGROUND UTILITIES OR PIPELINES.  
 CONTRACTOR SHOULD CALL ONE-CALL FOR LOCATION OF ANY MARKED OR UNMARKED BURIED  
 PIPELINES OR CABLES ON WELL PAD AND OR ACCESS ROAD AT LEAST TWO (2) WORKING DAYS PRIOR TO CONSTRUCTION.

LATITUDE: 36° 44.2660' LONGITUDE: 107° 31.2273' NAD27

## OPERATIONS PLAN

**Well Name:** San Juan 29-7 Unit #38B  
**Location:** 1765' FSL, 2275' FEL, Sec 12, T29N, R7W  
Rio Arriba County, NM  
Latitude 36° 44.2660'N, Longitude 107° 31.2273'W  
**Formation:** Blanco Mesaverde/Basin Dakota  
**Total Depth:** 7668'

**Logging Program:** See San Juan 29-7 Unit Master Operations Plan

**Mud Program:** See San Juan 29-7 Unit Master Operations Plan

**Casing Program (as listed, the equivalent, or better):**

Hole Size	Depth Interval	Csg	Wt.	Grade	Cement	
12 1/4	0' - 120'	9.625"	32.3#	H-40	<del>478</del>	cu.ft
8 3/4	0' - 3492'	7"	20.0#	J-55	781	cu.ft
6 1/4	0' - 7668'	4.5"	10.5/11.6#	J-55	569	cu.ft

**Tubing Program:** See San Juan 29-7 Unit Master Operations Plan

- \* The Mesaverde and Dakota formations will be completed and commingled.
- \* The east half of Section 12 is dedicated to the Mesaverde and the Dakota formation in this well.
- \* Gas is dedicated.

Stephen M. Williams  
Drilling Engineer

7/26/05  
Date

C. HARRADEN/ August 30, 2005 *CH*

BURLINGTON RESOURCES/ San Juan 29-7 Unit #38B APD

STIPULATION/CONDITION OF APPROVAL

This well is located within a 'vulnerable area'. In order to protect the integrity of the alluvium aquifer, a minimum surface csg. depth of 200' is stipulated as a condition of approval for this APD.

**MULTI-POINT SURFACE USE PLAN**

San Juan 29-7 Unit #38B

- \* Anticipated pipeline facilities as shown on the attached plat from El Paso Field Services
- \* No new access road will be needed.
- \* Water supply from the San Juan 29-6 Water Well #1 in located in SW/4 Section 28, T-29-N, R-6-W New Mexico.
- \* Surface ownership: Fee, William Dawson/Richard Hodgeson
- \* Build diversion ditch to north - draining east and west.
- \* Top Soil: 6 inches
- \* Slopes: 3 to 1
- \* Archaeological Resources: See Archaeological Survey technical report # from Western Archeological Services.

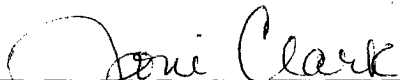
  
\_\_\_\_\_  
Regulatory Specialist

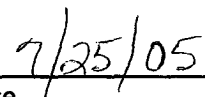
  
\_\_\_\_\_  
Date