

UNITED STATES
DEPARTMENT OF THE INTERIOR
BUREAU OF LAND MANAGEMENT
APPLICATION FOR PERMIT TO DRILL OR REENTER

FORM APPROVED
OMB No. 1004-0136
Expires November 30, 2000

5. Lease Serial No. **SF - 078385**

6. If Indian, Allottee or tribe Name

7. If Unit or CA Agreement, Name and No

8. Lease Name and Well No.

Thompson LS 3S

9. API Well No.

30-045-33203

10. Field and Pool, or Exploratory
Basin Fruitland Coal

11. Sec., T., R., M., or Blk, and survey or Area
SECTION 34 T30N & R08W
E

12. County or Parish
SAN JUAN

13. State
NEW MEXICO

1b. Type of Well: ☐ Oil Well ☒ Gas Well Gas ☐ Other ☐ Single Zone ☐ Multiple Zone

2. Name of Operator
BP AMERICA PRODUCTION COMPANY

3a. Address
P.O. BOX 3092 HOUSTON, TX 77079-2064

3b. Phone No. (include area code)
281-366-4081

4. Location of Well (Report location clearly and in accordance with any State requirements. *)

At surface **1500' FNL & 800' FWL SWNW**

At proposed prod. Zone **1500' FNL & 800' FWL SWNW**

14. Distance in miles and direction from nearest town or post office*
20 MILES N/E FROM Bloomfield, NM

15. Distance from proposed*
Location to nearest
Property or lease line, ft.
(Also to nearest drig. Ujnit line, if any) **800'**

16. No. of Acres in lease
320

17. Spacing Unit dedicated to this well
320 w/p

18. Distance from proposed location*
to nearest well, drilling, completed,
applied for, on this lease, ft. **400'**

19. Proposed Depth
3134' MD

20. BLM/BIA Bond No. on file
WY2924

21. Elevations (show whether DF, KDB., RT, GL, etc.)
6342' GL

22. Approximate date work will start*
08/10/05

23. Estimated duration
3 DAYS

24. Attachments

The following, completed in accordance with the requirements of Onshore Oil and Gas Order No. 1, shall be attached to this form:

1. Well plat certified by a registered surveyor.
2. A Drilling Plan.
3. A Surface Use Plan (if the location is on National forest System Lands, the SUPO shall be filed with the appropriate Forest Service Office).
4. Bond to cover the operations unless covered by an existing bond on file (see Item 20 above).
5. Operator certification.
6. Such other site specific information and/or plans as may be required by the authorized officer.

25. Signature: **Cherry Hlava** Name (Printed/typed): **Cherry Hlava** Date: **06/28/2005**

Title

Regulatory Analyst

Approved by (Signature): **[Signature]** Name (Printed/Typed): **[Signature]** Date: **9/20/05**

Title

Office

Application approval does not warrant or certify the applicant holds legal or equitable title to those rights in the subject lease which would entitle the applicant to conduct Operations thereon.

Conditions of approval, if any, are attached.

Title 18 U.S.C. Section 1001 and title 43 U.S.C. Section 1212, make it a crime for any person knowingly and willfully to make to any department or agency of the United States any false, fictitious or fraudulent statements or representations as to any matter within its jurisdiction.

*(Instructions on reverse)

NMOCD

This action is subject to technical and procedural review pursuant to 43 CFR 3165.3 and appeal pursuant to 43 CFR 3165.4

DRILLING OPERATIONS AUTHORIZED ARE SUBJECT TO COMPLIANCE WITH ATTACHED "GENERAL REQUIREMENTS".

District I
PO Box 1980, Hobbs NM 88241-1980
District II
PO Drawer KK, Artesia, NM 87211-0719
District III
1000 Rio Brazos Rd., Aztec, NM 87410
District IV
PO Box 2088, Santa Fe, NM 87504-2088

State of New Mexico
Energy, Minerals & Natural Resources Department

OIL CONSERVATION DIVISION
PO Box 2088
Santa Fe, NM 87504-2088

Form C-102
Revised February 21, 1994
Instructions on back
Submit to Appropriate District Office
State Lease - 4 Copies
Fee Lease - 3 Copies

☐ AMENDED REPORT

WELL LOCATION AND ACREAGE DEDICATION PLAT

¹ API Number 30-045-33203	² Pool Code 71629	³ Pool Name Basin Fruitland Coal
⁴ Property Code 001166	⁵ Property Name Thompson LS	⁶ Well Number # 3S
⁷ OGRID No. 778	⁸ Operator Name BP AMERICA PRODUCTION COMPANY	⁹ Elevation 6342

¹⁰ Surface Location

UL or Lot No. E	Section 34	Township 30 N	Range 8 W	Lot Idn	Feet from the 1500	North/South line NORTH	Feet from the 800	East/West line WEST	County SAN JUAN
---------------------------	----------------------	-------------------------	---------------------	---------	------------------------------	----------------------------------	-----------------------------	-------------------------------	---------------------------

¹¹ Bottom Hole Location If Different From Surface

¹² UL or lot no.	Section	Township	Range	Lot Idn	Feet from the	North/South line	Feet from the	East/West line	County
320									
¹³ Dedicated Acres	¹⁴ Joint or Infill	¹⁵ Consolidation Code	¹⁶ Order No.						

NO ALLOWABLE WILL BE ASSIGNED TO THIS COMPLETION UNTIL ALL INTERESTS HAVE BEEN CONSOLIDATED
OR A NON-STANDARD UNIT HAS BEEN APPROVED BY THE DIVISION

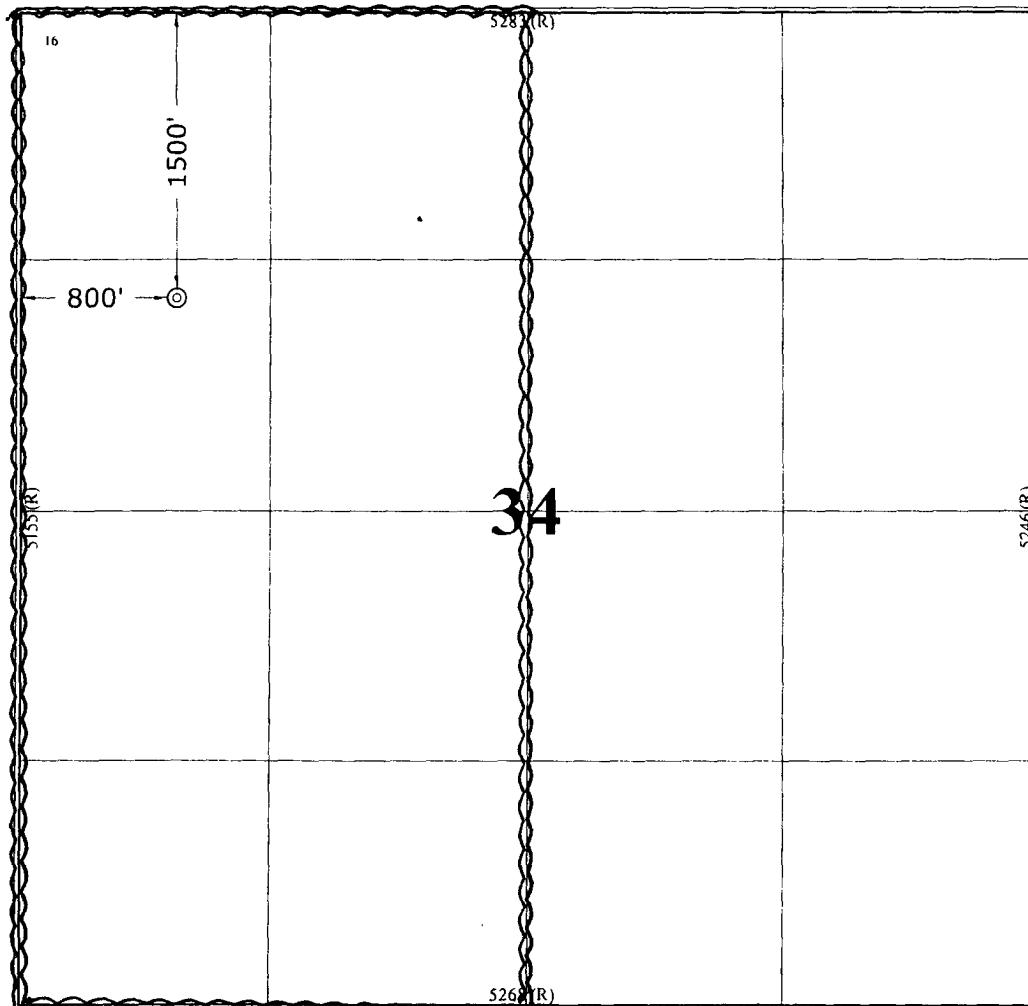

¹⁷ OPERATOR CERTIFICATION

I hereby certify that the information contained herein is true and complete to the best of my knowledge and belief.

Cherry Hlava
Signature
Cherry Hlava
Printed Name
Regulatory Analyst
Title
4-28-05
Date

¹⁸ SURVEYOR CERTIFICATION

I hereby certify that the well location shown on this plat was plotted from field notes of actual surveys made by me or under my supervision, and that the same is true and correct to the best of my belief.

April 12, 2005
Date of Survey

Signature and Seal of Professional Surveyor

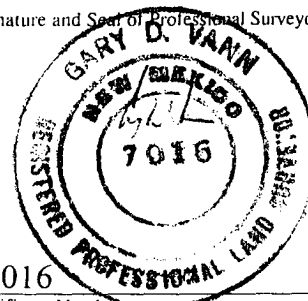

7016
Certificate Number

PAD LAYOUT PLAN & PROFILE
 BP AMERICA PRODUCTION COMPANY
 Thompson LS # 3S
 1500' F/NL 800' F/WL
 SEC. 34, T30N, R8W, N.M.P.M.
 SAN JUAN COUNTY, NEW MEXICO

Lat: 36.7717°
 Long: 107.6692°
 Lat: 36°46'18"
 Long: 107°40'09"

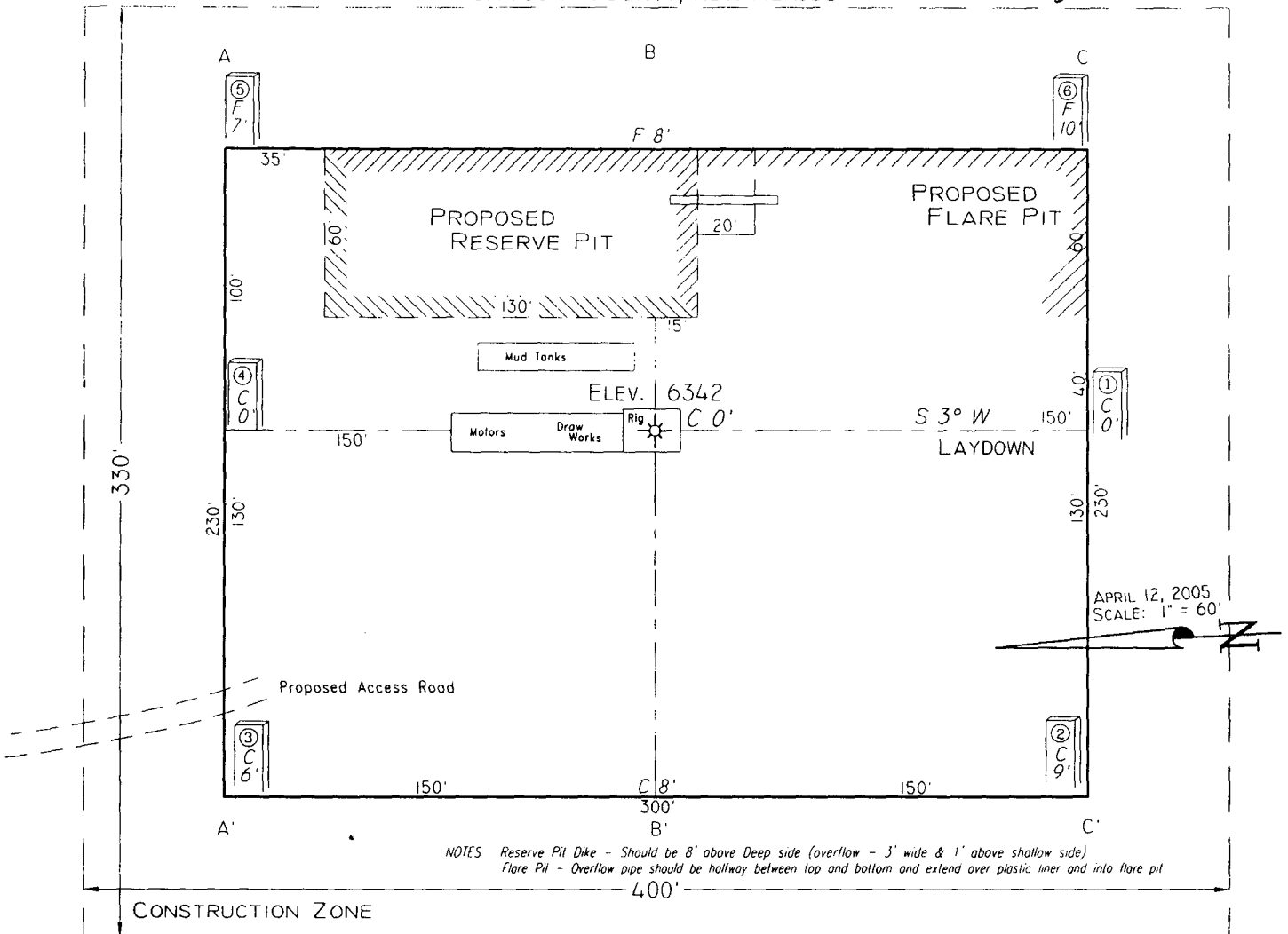

Area of Construction Zone - 330'x400' or 3.93 acres, more or less

SCALE: 1"=60'-HORIZ.
 1"=40'-VERT.

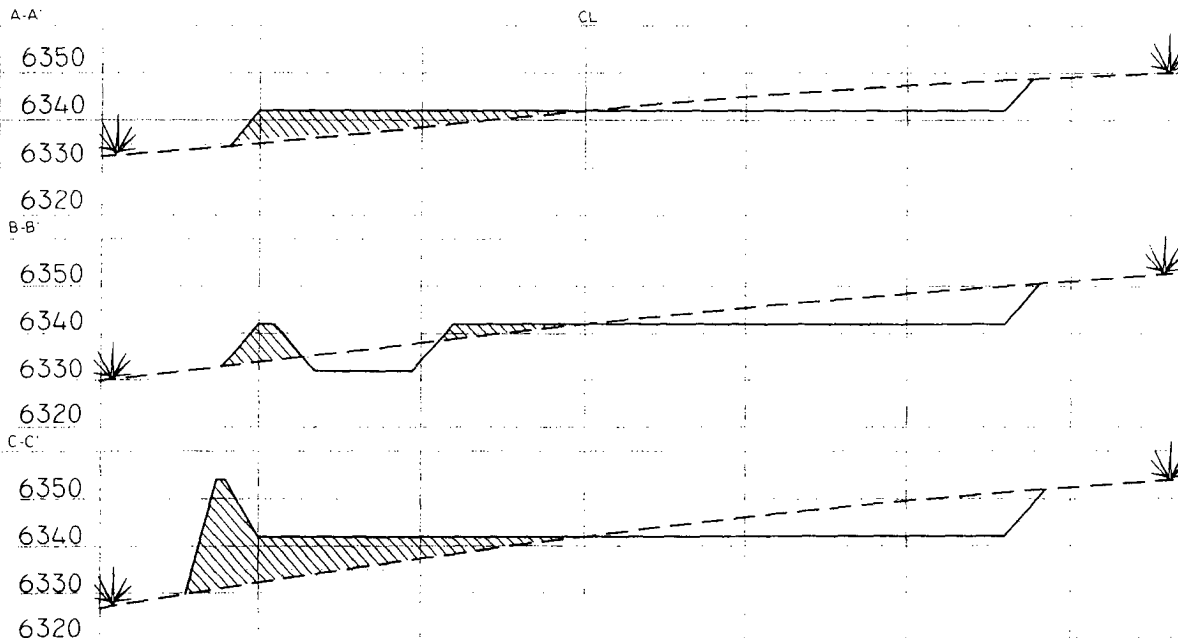

NOTE: Contractor should call One-Call for location of any marked or unmarked buried pipelines or cables on well pad and/or access road at least two (2) working days prior to construction

Cuts and fills shown are approximate - final finished elevation is to be adjusted so earthwork will balance. Corner slopes are approximate and do not include additional areas needed for sideslopes and drainages. Final Pad Dimensions are to be verified by Contractor

VANN SURVEYS
 P. O. Box 1306
 Farmington, NM

DRILLING AND COMPLETION PROGRAM

Lease:	Thompson LS	Well Name & No.	Thompson LS #35	Field:	Basin Fruitland Coal
County:	San Juan, New Mexico	Surface Location:	NW 1/4, S34, T30N, R08W : 1500' FNL, 800' FWL		
Minerals:		Surface:	Lat: 36.7717 Long:-107.6692		
Log :	Aztec 507	BH Location:	NW 1/4, S34, T30N, R08W : 1500' FNL, 800' FWL		

OBJECTIVE:	Drill to TD, set and cement 5.5" casing, perf and frac the Fruitland Coal interval.
-------------------	---

[illegible]

Cementing Program

Well Name: Thompson LS #3S	
Location: Sec 34 - 30N - 08W, 1500' FNL, 800' FWL	API No.
County: San Juan	Well Flac
State: New Mexico	Formation: Fruitland Coal
	KB Elev (est) 6353
	GL Elev. (est) 6342

Casing Program:

Casing String	Est. Depth (ft.)	Hole Size (in.)	Casing Size (in.)	Thread	TOC (ft.)
Surface	200	12.5	8 5/8	8rd	Surface
Production -	3134	7.875	5 1/2	8rd	Surface

Casing Properties: (No Safety Factor Included)

Casing String	Size (in.)	Weight (lb/ft)	Grade
Surface	8 5/8	20	H-40
Production -	5 1/2	15.5	J-55

Mud Program

Apx. Interval (ft.)	Mud Type	Mud Weight	Recommended Mud Properties Prio Cementing:
			PV <20
			YP <10
0 - SCP	Water/Spud	8.6-9.2	Fluid Los <6
SCP - TD	Water/LSND	8.6-9.2	

Cementing Program:

	Surface	Production
Excess %, Lead	100	40
Excess %, Tail	NA	40
BHST (est deg. F)	75	120
Special Instructions	1,6	2,4,6

1. Do not wash pumps and lines.
2. Wash pumps and lines.
3. Reverse out
4. Run Blend Test on Cement
5. Record Rate, Pressure, and Density on 3.5" disk
6. Confirm densitometer with pressurized mud scales

Surface:

Preflush	20 bbl.	FreshWater	
Slurry 1	141 sx Class C Cement		179 cuft
TOC@Surface	+ 2% CaCl2 (accelerator)		
			0.4465 cuft/ft OH

Slurry Properties:	Density (lb/gal)	Yield (ft ³ /sk)	Water (gal/sk)
Slurry 1	15.2	1.27	5.8

Casing Equipment:

- 8-5/8", 8R, ST&C
- 1 Guide Shoe
- 1 Top Wooden Plug
- 1 Autofill insert float valve
- Centralizers, as needed
- 1 Stop Ring
- 1 Thread Lock Compound

Production:

Fresh Water	10 bbl	CW100
-------------	--------	-------

**SAN JUAN BASIN
Basin Fruitland Coal Formation
Pressure Control Equipment**

Background

The objective Fruitland formation maximum surface pressure is anticipated to be less than 1000 psi, based on shut-in surface pressures from adjacent wells. Pressure control equipment working pressure minimum requirements are therefore 2000 psi. Equipment to be used will conform to API RP-53 (Figure 2.C.2) for a 2000 psi system per Federal Onshore Order No. 2. Due to available conventional equipment within the area, 3000 psi rated pressure control equipment will typically be utilized in a single ram type arrangement. Regional drilling rights to be utilized have substructure height limitations which exclude the use of annular preventers; therefore a rotating head will be installed above these rams. This pressure control equipment will be utilized for conventional drilling below conductor to total depth in the Basin Fruitland Coal. No abnormal temperature, pressure, or H₂S anticipated.

Equipment Specification

Interval

BOP Equipment

Below conductor casing to total depth 11" nominal or 7 1/16", 2000 psi Single ram preventer with 3000 psi annular preventer and rotating head.

All ram type and annular preventers as well as related control equipment will be hydraulically tested to 250 psi (low pressure) and 1500 psi (high pressure), upon installation, following any repairs or equipment replacements, or at 30 day intervals. Accessories to BOP equipment will include kelly cock, upper kelly cock with a handle available, floor safety valves and choke manifold which will also be tested to equivalent pressure.

BP American Production Company

Well Control Equipment Schematic

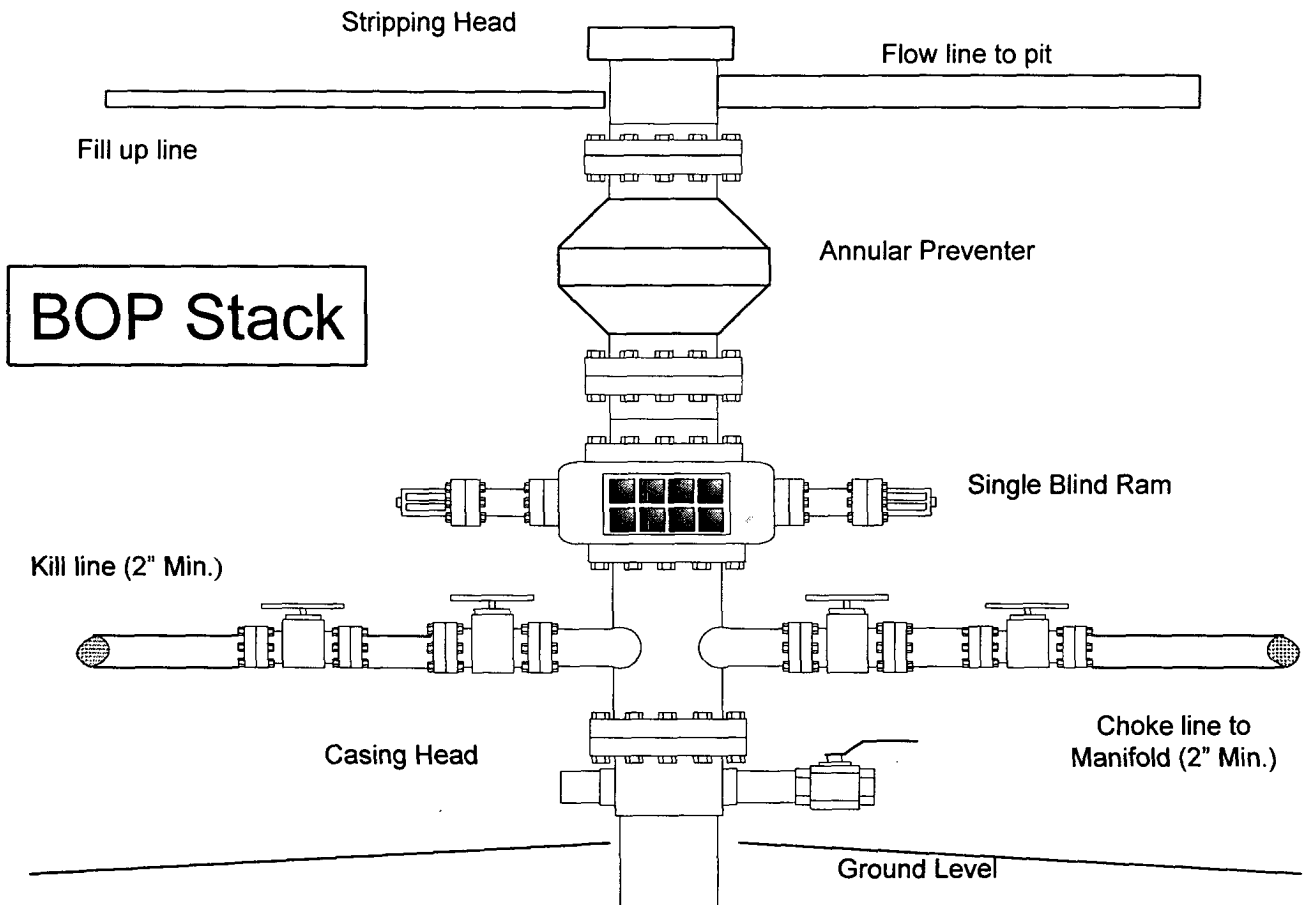

Choke & Kill Manifold

