

District I  
1625 N. French Dr., Hobbs, NM 88240  
District II  
1301 W. Grand Avenue, Artesia, NM 88210  
District III  
1000 Rio Brazos Road, Aztec, NM 87410  
District IV  
1220 S. St. Francis Dr., Santa Fe, NM 87505

State of New Mexico  
Energy Minerals and Natural Resources

Oil Conservation Division  
1220 South St. Francis Dr.  
Santa Fe, NM 87505

Form C-141  
Revised October 10, 2003

Submit 2 Copies to appropriate  
District Office in accordance  
with Rule 116 on back  
side of form

Release Notification and Corrective Action

OPERATOR

☐ Initial Report ☒ Final Report

Name of Company: XTO Energy, Inc.	Contact: James McDaniel	
Address: 382 Road 3100, Aztec, New Mexico 87410	Telephone No.: (505) 333-3701	
Facility Name: Rowland Gas COM #1 (30-045-09129) 3-045-09129 JK10/24/2013	Facility Type: Gas Well	
Surface Owner: Private	Mineral Owner:	Lease No.:

LOCATION OF RELEASE

Unit Letter P	Section 25	Township 30N	Range 12W	Feet from the 1030	North/South Line FSL	Feet from the 910	East/West Line FEL	County San Juan
------------------	---------------	-----------------	--------------	-----------------------	-------------------------	----------------------	-----------------------	--------------------

Latitude: 36.7789 Longitude: -108.0439

NATURE OF RELEASE

Type of Release: Historical	Volume of Release: Unknown	Volume Recovered: Unknown
Source of Release: Historical Earthen Pit	Date and Hour of Occurrence: NA	Date and Hour of Discovery: NA 4/25/2013 3P 10/24/2013
Was Immediate Notice Given? <input type="checkbox"/> Yes <input type="checkbox"/> No <input checked="" type="checkbox"/> Not Required	If YES, To Whom?	RCVD MAY 28 '13
By Whom?	Date and Hour:	OIL CONS. DIV.
Was a Watercourse Reached? <input type="checkbox"/> Yes <input checked="" type="checkbox"/> No	If YES, Volume Impacting the Watercourse.	DIST. 3

If a Watercourse was Impacted, Describe Fully.\*

Describe Cause of Problem and Remedial Action Taken.\*

The Rowland Gas COM #1 well site is the site of an active groundwater site, NMOCD #3RP-124. Due to elevated benzene levels found during quarterly groundwater monitoring, XTO Energy performed a subsurface investigation of the area around the impacted monitoring well, and discovered impacted soil beneath the surface. Management decided to excavate the impacted source material, hoping to alleviate groundwater impacts. The site was ranks a 60 due to a depth to groundwater of less than 50 feet, distance to an irrigation ditch of less than 200 feet, and an estimated distance to a water well of less than 1,000 feet. This set the closure standard to 100 ppm TPH, 10 ppm benzene and 50 ppm total BTEX.

Describe Area Affected and Cleanup Action Taken.\*

All remediation efforts are outlined in the attached LT Environmental Excavation Report. All samples, including a water sample, returned results below the regulatory standards determined for this site.

I hereby certify that the information given above is true and complete to the best of my knowledge and understand that pursuant to NMOCD rules and regulations all operators are required to report and/or file certain release notifications and perform corrective actions for releases which may endanger public health or the environment. The acceptance of a C-141 report by the NMOCD marked as "Final Report" does not relieve the operator of liability should their operations have failed to adequately investigate and remediate contamination that pose a threat to ground water, surface water, human health or the environment. In addition, NMOCD acceptance of a C-141 report does not relieve the operator of responsibility for compliance with any other federal, state, or local laws and/or regulations.

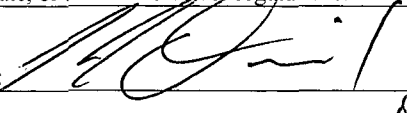
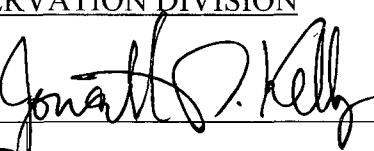
Signature: 	OIL CONSERVATION DIVISION	
Printed Name: James McDaniel, CHMM #15676	Approved by District Supervisor: 	
Title: EH&S Supervisor	Approval Date: 10/24/2013 Expiration Date:	
E-mail Address: james_mcdaniel@xtoenergy.com	Conditions of Approval:	Attached <input type="checkbox"/>
Date: May 23, 2013 Phone: 505-333-3701		

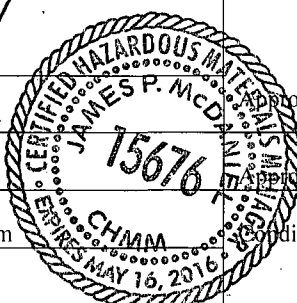

WJK1329743151



May 10, 2013

Mr. James McDaniel  
XTO Energy, Inc.  
382 County Road 3100  
Aztec, New Mexico 87410

**RE: Report of Excavation Activities  
XTO Energy, Inc.  
Rowland Gas Com #1**

Dear Mr. McDaniel:

LT Environmental, Inc. (LTE) is pleased to present to XTO Energy, Inc. (XTO) this letter summarizing the results of excavation activities at the Rowland Gas Com #1 natural gas production well located in Unit P of Section 25 in Township 30N, Range 12W of San Juan County, New Mexico (Site; Figure 1). The purpose of the excavation was to remove the historical source of petroleum hydrocarbons impacting groundwater in existing monitoring well MW-5.

### **Background**

On August 2, 1993, the previous operator, Amoco Production Company (Amoco), excavated soil impacted by petroleum hydrocarbons during historical operations of two unlined production pits at the Site (Figure 2). To address impacts to groundwater, Amoco installed monitoring wells MW-1, MW-2, MW-3, MW-4, and MW-5 in May of 1996 and MW-6 in June of 1997. Groundwater from MW-4 and MW-5 contained benzene, toluene, ethylbenzene, and total xylenes (BTEX) concentrations exceeding New Mexico Water Quality Control Commission (NMWQCC) standards. Groundwater analytical results from samples collected from MW-1, MW-2, MW-3, and MW-6 did not exceed the NMWQCC standards for BTEX; therefore, Amoco discontinued sampling of these wells. In 1998, MW-4 was damaged during equipment upgrades and replaced with MW-4R. BTEX concentrations were last detected in groundwater sampled from MW-4R in May of 1999 and sampling of MW-4R was discontinued in February 2002. Groundwater sampled from MW-5 has consistently contained elevated BTEX concentrations. Since 2009, the benzene concentrations have varied seasonally, but exhibited an overall net increase. Based on a limited subsurface investigation indicating the lateral extent of impacted soil was limited, XTO decided to remove the historical source impacting groundwater in MW-5.

### **Excavation Activities**

During the period from April 26, 2013 to May 1, 2013, XTO contractors removed impacted soil from the Site. An LTE geologist noted visual evidence of soil impact beginning at 7 feet to 13 feet below the ground surface (bgs) and extending to an average depth of 17 feet bgs. The final dimensions of the excavation were approximately 90 feet long by 45 feet wide and the total



depth of the excavation ranged from 15 feet to 19 feet bgs. A total estimated volume of 2,187 cubic yards were excavated, 1,365 cubic yards of which was transported to the Industrial Ecosystems Inc. Landfarm near Aztec, New Mexico. The remainder was clean overburden that was stockpiled on site and used to backfill the excavation. Groundwater monitoring well MW-5 was removed during the excavation.

As soil was removed, LTE personnel conducted field screening of organic vapor concentrations with a photoionization detector (PID) according to New Mexico Oil Conservation Division (NMOCD) headspace techniques to determine if additional excavation was required. Once PID measurements indicated impacted soil had been removed, LTE collected confirmation samples of the sidewalls and floor of the excavation in locations depicted on Figure 3 by depositing five aliquots of soil into plastic bags, thoroughly mixing the contents and sampling into four ounce glass jars. Soil samples were stored on ice and delivered to Envirotech Laboratory (Envirotech) in Bloomfield, New Mexico following strict chain-of-custody procedures. The soil samples were analyzed for BTEX by United States Environmental Protection Agency (USEPA) Method 8021B and total petroleum hydrocarbons (TPH) by USEPA Method 8015B.

LTE sampled groundwater that pooled in excavation by collecting a grab sample in a decontaminated pitcher or bailer and immediately filling three pre-cleaned and pre-preserved 40 milliliter (ml) glass vials with zero headspace to prevent degradation of the sample. Envirotech analyzed the sample for BTEX according to USEPA Method 8021B.

## **Results**

Laboratory analytical results indicate BTEX and TPH concentrations in soil on the sidewalls and the floor of the excavation did not exceed NMOCD standards for sites where groundwater is less than 50 feet deep. Laboratory analytical results are listed on Table 1 and depicted in Figure 3. The complete laboratory reports are included in Attachment A.

Groundwater was encountered at approximately 15 feet bgs. No BTEX concentrations were detected in the groundwater sample. Laboratory analytical results from groundwater samples are shown in Table 2 and depicted in Figure 3. The complete laboratory analytical report is included in Attachment A.

## **Conclusions**

From April 26, 2013 through May 1, 2013, XTO removed a total of 1,365 cubic yards of impacted soil from the Site. Laboratory analytical results of soil samples collected from the sidewalls and floor of the excavation confirm all impacted soil was removed. A groundwater sample collected from within the excavation did not contain detectable concentrations of BTEX indicating the historical source of petroleum hydrocarbons affecting groundwater at former monitoring well MW-5 has been addressed. Upon receipt of the confirmation sample results, XTO backfilled the excavation.



LTE appreciates the opportunity to provide environmental services to XTO. If you have any questions regarding this report, please contact us at (970) 385-1096.

Sincerely,

LT ENVIRONMENTAL, INC.

A handwritten signature in black ink, appearing to read 'Devin Hencmann', written in a cursive style.

Devin Hencmann  
Staff Geologist

A handwritten signature in black ink, appearing to read 'Ashley L. Ager', written in a cursive style.

Ashley L. Ager  
Senior Geologist/Office Manager

Attachments (6)

Figure 1 – Site Location Map

Figure 2 – Site Map

Figure 3 – Excavation Site Map

Table 1 – Soil Analytical Results

Table 2 – Groundwater Analytical Results

Attachment A – Analytical Laboratory Reports

## FIGURES



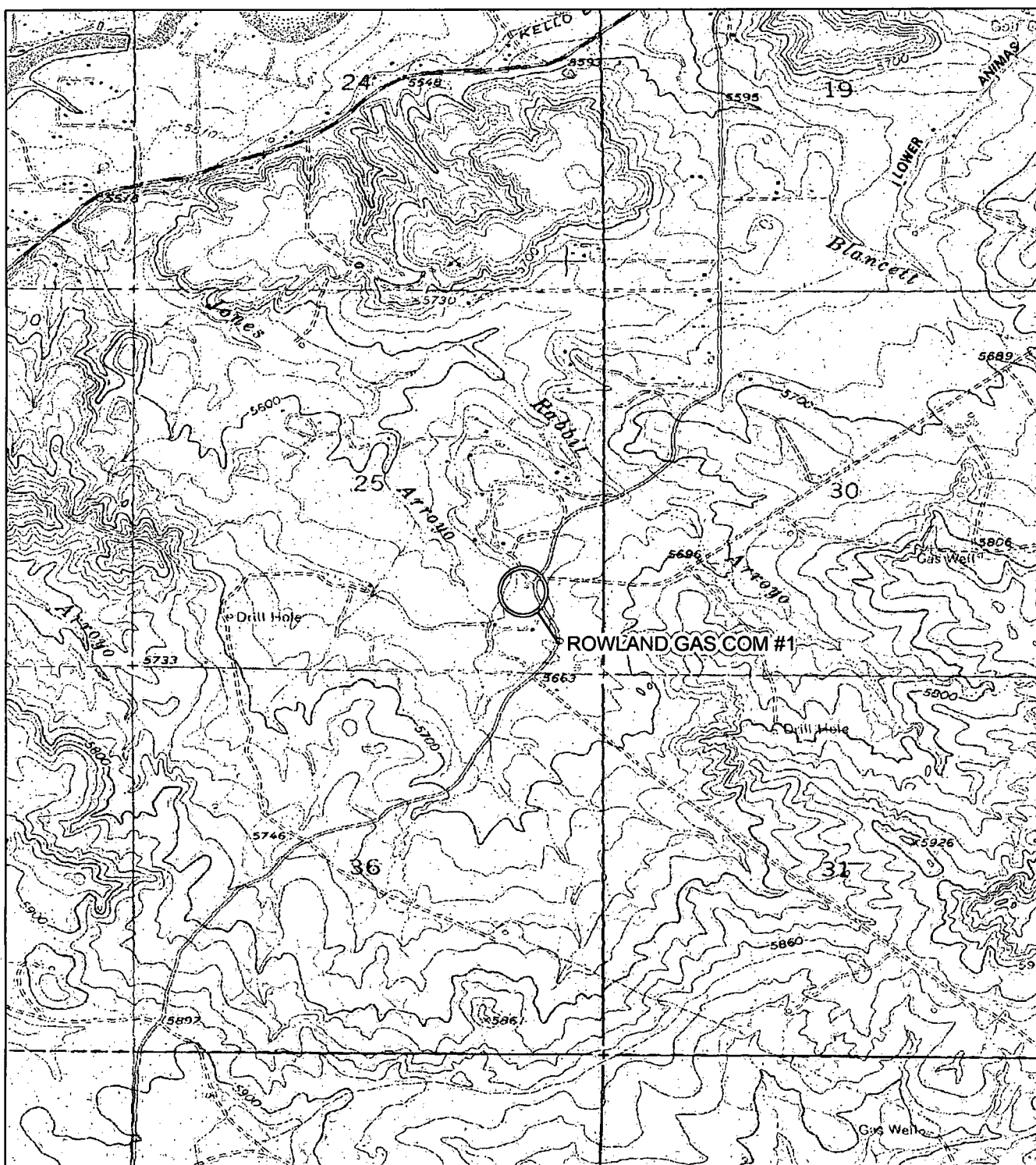

IMAGE COURTESY OF USDA/NRCS, VARIOUS DATES

# LEGEND



SITE LOCATION



FIGURE 1  
 SITE LOCATION MAP  
 ROWLAND GAS COM #1  
 SESE SEC 25 T30N R12W  
 SAN JUAN COUNTY, NEW MEXICO  
 XTO ENERGY, INC.



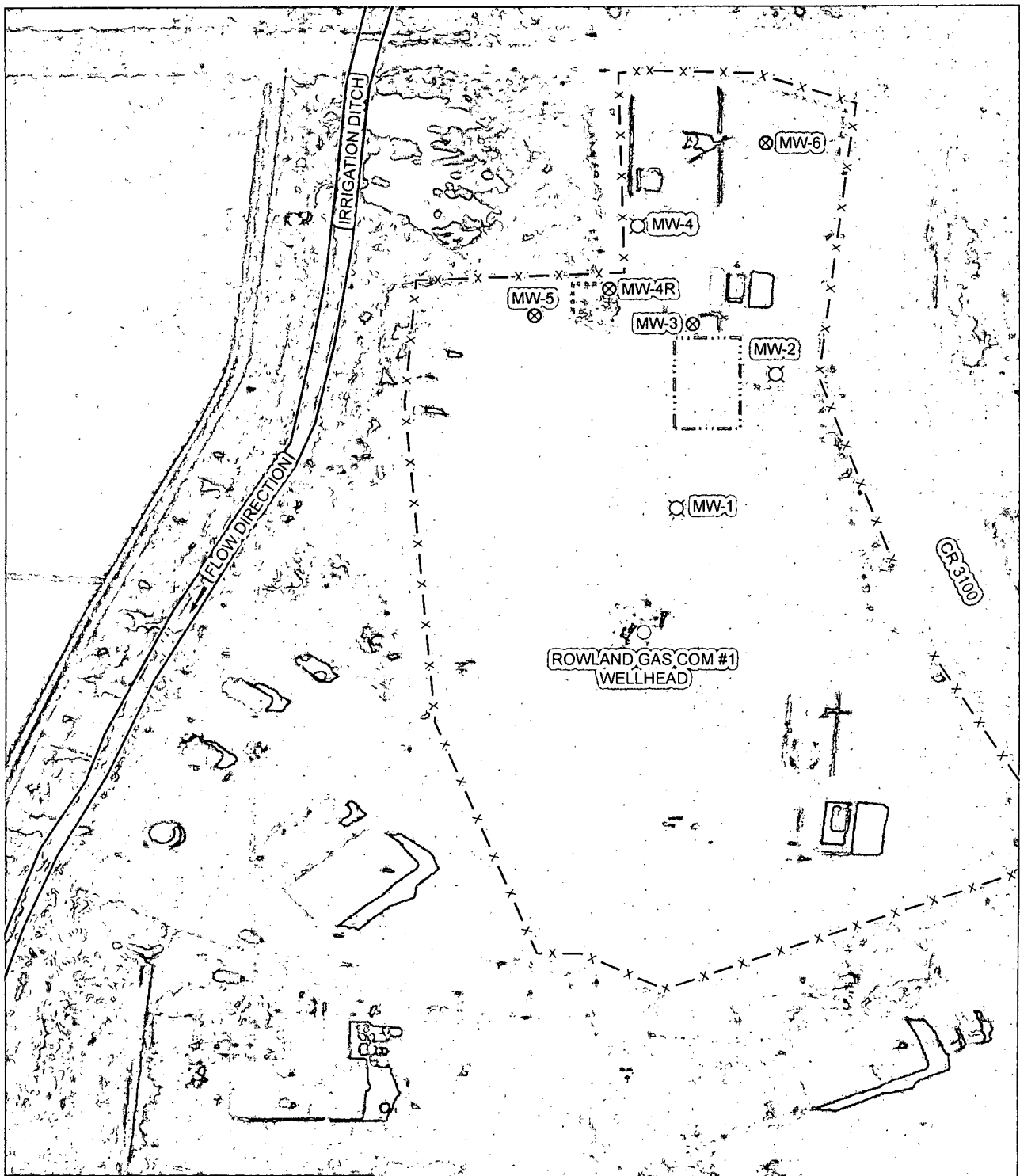

# LEGEND

- ⊗ MONITORING WELL
- ⊗ DESTROYED MONITORING WELL
- WELLHEAD
- - - - - FORMER SEPARATOR PIT EXCAVATION
- ..... FORMER TANK PIT EXCAVATION
- BERM
- x — x FENCE

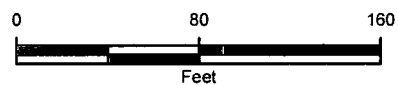
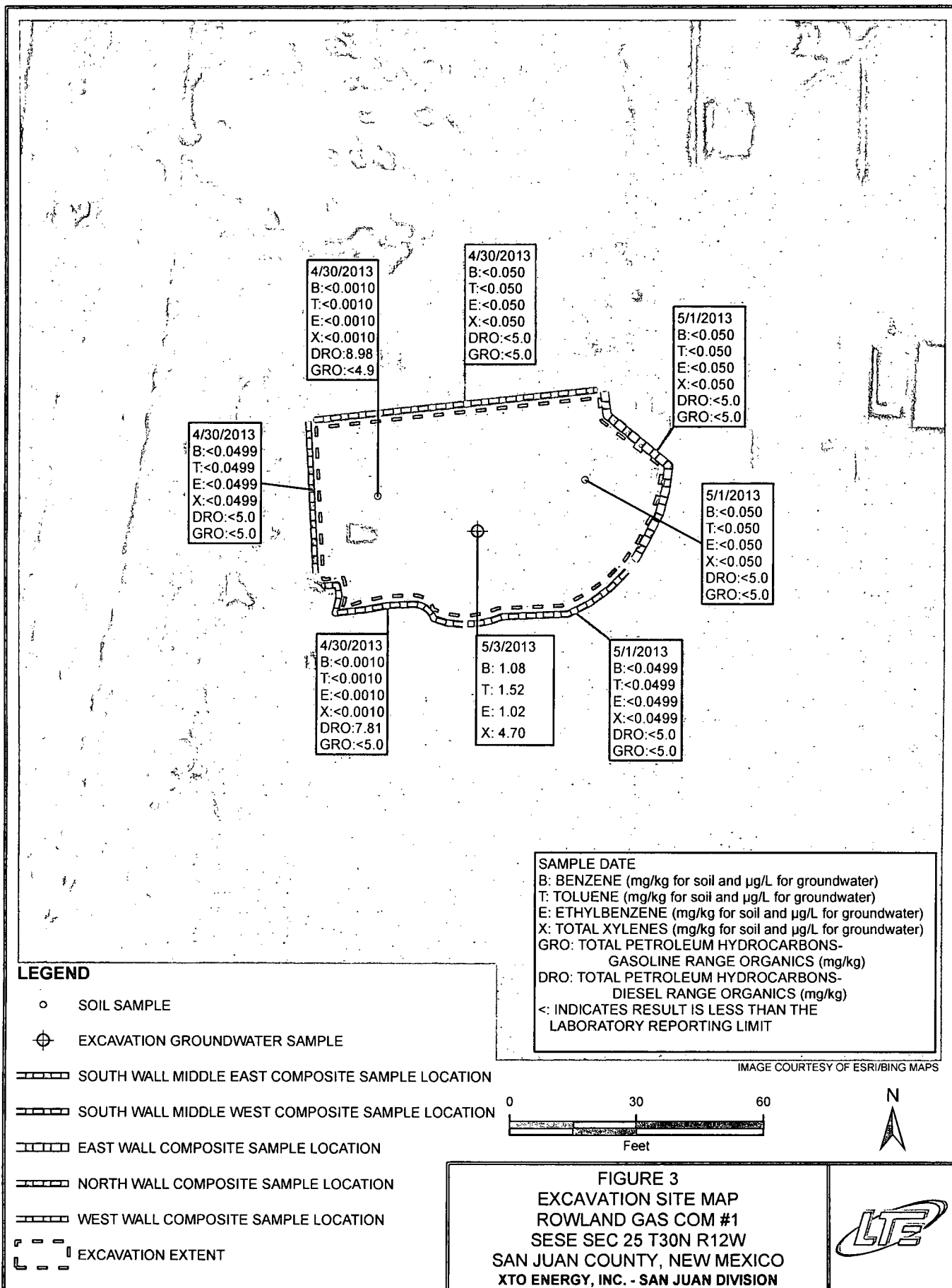

FIGURE 2  
SITE MAP  
ROWLAND GAS COM #1  
SESE SEC 25 T30N R12W  
SAN JUAN COUNTY, NEW MEXICO



XTO ENERGY, INC.





## TABLES

**TABLE 1**  
**SOIL ANALYTICAL RESULTS**  
**ROWLAND GAS COM #1**  
**XTO ENERGY, INC.**

Sample ID	Date Sampled	Field Headspace Reading (ppm)	Benzene (mg/kg)	Toluene (mg/kg)	Ethylbenzene (mg/kg)	Total Xylenes (mg/kg)	DRO (mg/kg)	GRO (mg/kg)
North Wall Comp.	4/30/2013	0.0	<0.050	<0.050	<0.050	<0.050	<5.0	<5.0
West Wall Comp.	4/30/2013	97.8	<0.0499	<0.0499	<0.0499	<0.0499	<5.0	<5.0
East Wall Comp.	5/1/2013	2.3	<0.0010	<0.0010	<0.0010	<0.0010	7.81	<5.0
South Wall Middle East Comp.	5/1/2013	0.0	<0.0499	<0.0499	<0.0499	<0.0499	<5.0	<5.0
South Wall Middle West Comp.	4/30/2013	0.0	<0.050	<0.050	<0.050	<0.050	<5.0	<5.0
Floor Comp.	4/30/2013	0.0	<0.050	<0.050	<0.050	<0.050	<5.0	<5.0
East Floor Comp.	5/1/2013	1.7	<0.0010	<0.0010	<0.0010	<0.0010	8.98	<4.9
<b>NMOCD Standard</b>			<b>10</b>			<b>50</b>	<b>Combined to 100</b>	

**Notes:**

GRO - Gasoline Range Organics

DRO - Diesel Range Organics

mg/kg - milligrams per kilogram

NMOCD - New Mexico Oil Conservation Commission

ppm - parts per million

< indicates result is less than the stated laboratory method detection limit



**TABLE 2**

**GROUNDWATER ANALYTICAL RESULTS  
ROWLAND GAS COM #1  
XTO ENERGY, INC.**

<b>Sample ID</b>	<b>Date Sampled</b>	<b>Benzene (µg/L)</b>	<b>Toluene (µg/L)</b>	<b>Ethylbenzene (µg/L)</b>	<b>Total Xylenes (µg/L)</b>
Excavation GW	5/3/2013	1.08	1.52	1.02	4.70
<b>NMWQCC Standard</b>		<b>10</b>	<b>750</b>	<b>750</b>	<b>650</b>

**Notes:**

BTEX - benzene, toluene, ethylbenzene, and total xylenes

NMWQCC - New Mexico Water Quality Control Commission

µg/L - micrograms per liter

< indicates result is less than the stated laboratory method detection limit

**ATTACHMENT A**  
**LABORTORY ANALTYICAL REPORTS**





## Analytical Report

### Report Summary

Client: XTO Energy Inc.

Chain Of Custody Number: 15475

Samples Received: 4/30/2013 4:23:00PM

Job Number: 98031-0528

Work Order: P304096

Project Name/Location: Rowland Gas Com #1

Entire Report Reviewed By:

A handwritten signature in black ink, appearing to read 'Tim Cain', is written over a horizontal line.

Date: 5/1/13

Tim Cain, Laboratory Manager

The results in this report apply to the samples submitted to Envirotech's Analytical Laboratory and were analyzed in accordance with the chain of custody document supplied by you, the client, and as such are for your exclusive use only. The results in this report are based on the sample as received unless otherwise noted. Partial or incomplete reproduction of this report is prohibited, unless approved by Envirotech, Inc. If you have any questions regarding this analytical report, please don't hesitate to contact Envirotech's Laboratory Staff.

XTO Energy Inc.  
382 CR 3100  
Aztec NM, 87410

Project Name: Rowland Gas Com #1  
Project Number: 98031-0528  
Project Manager: James McDaniel

**Reported:**  
01-May-13 14:26

### Analytical Report for Samples

Client Sample ID	Lab Sample ID	Matrix	Sampled	Received	Container
South wall middle-west comp	P304096-01A	Solid	04/30/13	04/30/13	Glass Jar, 4 oz.
West wall comp	P304096-02A	Solid	04/30/13	04/30/13	Glass Jar, 4 oz.
Floor comp	P304096-03A	Solid	04/30/13	04/30/13	Glass Jar, 4 oz.
North wall comp	P304096-04A	Solid	04/30/13	04/30/13	Glass Jar, 4 oz.

Partial or incomplete reproduction of this report is prohibited, unless approved by Envirotech, Inc.

5796 US Highway 64, Farmington, NM 87401

Three Springs • 65 Mercado Street, Suite 115, Durango, CO 81301

Ph (505) 632-0615 Fx (505) 632-1865

Ph (970) 259-0615 Fr (800) 362-1879





XTO Energy Inc. 382 CR 3100 Aztec NM, 87410	Project Name: Rowland Gas Com #1 Project Number: 98031-0528 Project Manager: James McDaniel	Reported: 01-May-13 14:26
---	---	------------------------------

**South wall middle-west comp  
P304096-01 (Solid)**

Analyte	Result	Reporting Limit	Units	Dilution	Batch	Prepared	Analyzed	Method	Notes
<b>Volatile Organics by EPA 8021</b>									
Benzene	ND	50.0	ug/kg	I	1318015	01-May-13	01-May-13	EPA 8021B	
Toluene	ND	50.0	ug/kg	I	1318015	01-May-13	01-May-13	EPA 8021B	
Ethylbenzene	ND	50.0	ug/kg	I	1318015	01-May-13	01-May-13	EPA 8021B	
p,m-Xylene	ND	50.0	ug/kg	I	1318015	01-May-13	01-May-13	EPA 8021B	
o-Xylene	ND	50.0	ug/kg	I	1318015	01-May-13	01-May-13	EPA 8021B	
Total BTEX	ND	50.0	ug/kg	I	1318015	01-May-13	01-May-13	EPA 8021B	
Surrogate: Bromochlorobenzene		90.5 %	80-120		1318015	01-May-13	01-May-13	EPA 8021B	
Surrogate: 1,4-Difluorobenzene		91.9 %	80-120		1318015	01-May-13	01-May-13	EPA 8021B	
Surrogate: Fluorobenzene		91.3 %	80-120		1318015	01-May-13	01-May-13	EPA 8021B	
<b>Nonhalogenated Organics by 8015</b>									
Gasoline Range Organics (C6-C10)	ND	5.00	mg/kg	I	1318016	01-May-13	01-May-13	EPA 8015D	
Diesel Range Organics (C10-C28)	ND	5.00	mg/kg	I	1318016	01-May-13	01-May-13	EPA 8015D	
GRO and DRO Combined Fractions	ND	5.00	mg/kg	I	1318016	01-May-13	01-May-13	EPA 8015D	

Partial or incomplete reproduction of this report is prohibited, unless approved by Envirotech, Inc.

5796 US Highway 64, Farmington, NM 87401

Three Springs • 65 Mercado Street, Suite 115, Durango, CO 81301

Ph (505) 632-0615 Fx (505) 632-1865

Ph (970) 259-0615 Fr (800) 362-1879



XTO Energy Inc.  
 382 CR 3100  
 Aztec NM, 87410

 Project Name: Rowland Gas Com #1  
 Project Number: 98031-0528  
 Project Manager: James McDaniel

**Reported:**  
 01-May-13 14:26

**West wall comp**  
**P304096-02 (Solid)**

Analyte	Result	Reporting Limit	Units	Dilution	Batch	Prepared	Analyzed	Method	Notes
<b>Volatile Organics by EPA 8021</b>									
Benzene	ND	49.9	ug/kg	1	1318015	01-May-13	01-May-13	EPA 8021B	
Toluene	ND	49.9	ug/kg	1	1318015	01-May-13	01-May-13	EPA 8021B	
Ethylbenzene	ND	49.9	ug/kg	1	1318015	01-May-13	01-May-13	EPA 8021B	
p,m-Xylene	ND	49.9	ug/kg	1	1318015	01-May-13	01-May-13	EPA 8021B	
o-Xylene	ND	49.9	ug/kg	1	1318015	01-May-13	01-May-13	EPA 8021B	
Total BTEX	ND	49.9	ug/kg	1	1318015	01-May-13	01-May-13	EPA 8021B	
Surrogate: Bromochlorobenzene		92.2 %	80-120		1318015	01-May-13	01-May-13	EPA 8021B	
Surrogate: 1,4-Difluorobenzene		96.6 %	80-120		1318015	01-May-13	01-May-13	EPA 8021B	
Surrogate: Fluorobenzene		95.9 %	80-120		1318015	01-May-13	01-May-13	EPA 8021B	
<b>Nonhalogenated Organics by 8015</b>									
Gasoline Range Organics (C6-C10)	ND	5.00	mg/kg	1	1318016	01-May-13	01-May-13	EPA 8015D	
Diesel Range Organics (C10-C28)	ND	5.00	mg/kg	1	1318016	01-May-13	01-May-13	EPA 8015D	
GRO and DRO Combined Fractions	ND	5.00	mg/kg	1	1318016	01-May-13	01-May-13	EPA 8015D	

Partial or incomplete reproduction of this report is prohibited, unless approved by Envirotech, Inc.

5796 US Highway 64, Farmington, NM 87401

Ph (505) 632-0615 Fx (505) 632-1865

Three Springs • 65 Mercado Street, Suite 115, Durango, CO 81301

Ph (970) 259-0615 Fr (800) 362-1879





XTO Energy Inc.  
 382 CR 3100  
 Aztec NM, 87410

 Project Name: Rowland Gas Com #1  
 Project Number: 98031-0528  
 Project Manager: James McDaniel

**Reported:**  
 01-May-13 14:26

**Floor comp**  
**P304096-03 (Solid)**

Analyte	Result	Reporting		Units	Dilution	Batch	Prepared	Analyzed	Method	Notes
		Limit								
Volatile Organics by EPA 8021										
Benzene	ND	50.0	ug/kg	1	1318015	01-May-13	01-May-13	01-May-13	EPA 8021B	
Toluene	ND	50.0	ug/kg	1	1318015	01-May-13	01-May-13	01-May-13	EPA 8021B	
Ethylbenzene	ND	50.0	ug/kg	1	1318015	01-May-13	01-May-13	01-May-13	EPA 8021B	
p,m-Xylene	ND	50.0	ug/kg	1	1318015	01-May-13	01-May-13	01-May-13	EPA 8021B	
o-Xylene	ND	50.0	ug/kg	1	1318015	01-May-13	01-May-13	01-May-13	EPA 8021B	
Total BTEX	ND	50.0	ug/kg	1	1318015	01-May-13	01-May-13	01-May-13	EPA 8021B	
Surrogate: Bromochlorobenzene		91.0 %		80-120	1318015	01-May-13	01-May-13	01-May-13	EPA 8021B	
Surrogate: 1,4-Difluorobenzene		88.1 %		80-120	1318015	01-May-13	01-May-13	01-May-13	EPA 8021B	
Surrogate: Fluorobenzene		87.6 %		80-120	1318015	01-May-13	01-May-13	01-May-13	EPA 8021B	
Nonhalogenated Organics by 8015										
Gasoline Range Organics (C6-C10)	ND	5.00	mg/kg	1	1318016	01-May-13	01-May-13	01-May-13	EPA 8015D	
Diesel Range Organics (C10-C28)	ND	5.00	mg/kg	1	1318016	01-May-13	01-May-13	01-May-13	EPA 8015D	
GRO and DRO Combined Fractions	ND	5.00	mg/kg	1	1318016	01-May-13	01-May-13	01-May-13	EPA 8015D	

Partial or incomplete reproduction of this report is prohibited, unless approved by Envirotech, Inc.

5796 US Highway 64, Farmington, NM 87401

Ph (505) 632-0615 Fx (505) 632-1865

Three Springs • 65 Mercado Street, Suite 115, Durango, CO 81301

Ph (970) 259-0615 Fr (800) 362-1879



XTO Energy Inc.  
382 CR 3100  
Aztec NM, 87410

Project Name: Rowland Gas Com #1  
Project Number: 98031-0528  
Project Manager: James McDaniel

**Reported:**  
01-May-13 14:26

**North wall comp  
P304096-04 (Solid)**

Analyte	Result	Reporting		Units	Dilution	Batch	Prepared	Analyzed	Method	Notes
		Limit								
Volatile Organics by EPA 8021										
Benzene	ND	50.0	ug/kg	1	1318015	01-May-13	01-May-13	01-May-13	EPA 8021B	
Toluene	ND	50.0	ug/kg	1	1318015	01-May-13	01-May-13	01-May-13	EPA 8021B	
Ethylbenzene	ND	50.0	ug/kg	1	1318015	01-May-13	01-May-13	01-May-13	EPA 8021B	
p,m-Xylene	ND	50.0	ug/kg	1	1318015	01-May-13	01-May-13	01-May-13	EPA 8021B	
o-Xylene	ND	50.0	ug/kg	1	1318015	01-May-13	01-May-13	01-May-13	EPA 8021B	
Total BTEX	ND	50.0	ug/kg	1	1318015	01-May-13	01-May-13	01-May-13	EPA 8021B	
Surrogate: Bromochlorobenzene		90.6 %		80-120	1318015	01-May-13	01-May-13	01-May-13	EPA 8021B	
Surrogate: 1,4-Difluorobenzene		91.5 %		80-120	1318015	01-May-13	01-May-13	01-May-13	EPA 8021B	
Surrogate: Fluorobenzene		91.3 %		80-120	1318015	01-May-13	01-May-13	01-May-13	EPA 8021B	
Nonhalogenated Organics by 8015										
Gasoline Range Organics (C6-C10)	ND	5.00	mg/kg	1	1318016	01-May-13	01-May-13	01-May-13	EPA 8015D	
Diesel Range Organics (C10-C28)	ND	5.00	mg/kg	1	1318016	01-May-13	01-May-13	01-May-13	EPA 8015D	
GRO and DRO Combined Fractions	ND	5.00	mg/kg	1	1318016	01-May-13	01-May-13	01-May-13	EPA 8015D	

Partial or incomplete reproduction of this report is prohibited, unless approved by Envirotech, Inc.



XTO Energy Inc. 382 CR 3100 Aztec NM, 87410	Project Name: Rowland Gas Com #1 Project Number: 98031-0528 Project Manager: James McDaniel	Reported: 01-May-13 14:26
---	---	------------------------------

**Volatile Organics by EPA 8021 - Quality Control**  
**Envirotech Analytical Laboratory**

Analyte	Result	Reporting Limit	Units	Spike Level	Source Result	%REC	%REC Limits	RPD	RPD Limit	Notes
---------	--------	-----------------	-------	-------------	---------------	------	-------------	-----	-----------	-------

**Batch 1318015 - Purge and Trap EPA 5030A**

<b>Blank (1318015-BLK1)</b>			Prepared: 30-Apr-13 Analyzed: 01-May-13							
Benzene	ND	50.0	ug/kg							
Toluene	ND	50.0	"							
Ethylbenzene	ND	50.0	"							
p,m-Xylene	ND	50.0	"							
o-Xylene	ND	50.0	"							
Total BTEX	ND	50.0	"							
Surrogate: Bromochlorobenzene	45.1		ug/L	50.0		90.2	80-120			
Surrogate: 1,4-Difluorobenzene	47.9		"	50.0		95.7	80-120			
Surrogate: Fluorobenzene	46.8		"	50.0		93.7	80-120			
<b>Duplicate (1318015-DUP1)</b>			Source: P304089-01		Prepared: 30-Apr-13 Analyzed: 01-May-13					
Benzene	ND	50.0	ug/kg		ND				30	
Toluene	ND	50.0	"		ND				30	
Ethylbenzene	ND	50.0	"		ND				30	
p,m-Xylene	ND	50.0	"		ND				30	
o-Xylene	ND	50.0	"		ND				30	
Surrogate: Bromochlorobenzene	50.2		ug/L	50.0		100	80-120			
Surrogate: 1,4-Difluorobenzene	52.1		"	50.0		104	80-120			
Surrogate: Fluorobenzene	51.7		"	50.0		103	80-120			

<b>Matrix Spike (1318015-MS1)</b>			Source: P304089-01		Prepared: 30-Apr-13 Analyzed: 01-May-13					
Benzene	51.6		ug/L	50.0	0.27	103	39-150			
Toluene	51.8		"	50.0	0.51	103	46-148			
Ethylbenzene	51.6		"	50.0	0.26	103	32-160			
p,m-Xylene	103		"	100	0.74	103	46-148			
o-Xylene	51.6		"	50.0	0.60	102	46-148			
Surrogate: Bromochlorobenzene	47.8		"	50.0		95.5	80-120			
Surrogate: 1,4-Difluorobenzene	51.1		"	50.0		102	80-120			
Surrogate: Fluorobenzene	51.0		"	50.0		102	80-120			

Partial or incomplete reproduction of this report is prohibited, unless approved by Envirotech, Inc.

5796 US Highway 64, Farmington, NM 87401

Ph (505) 632-0615 Fx (505) 632-1865

Three Springs - 65 Mercado Street, Suite 115, Durango, CO 81301

Ph (970) 259-0615 Fr (800) 362-1879





XTO Energy Inc. 382 CR 3100 Aztec NM, 87410	Project Name: Rowland Gas Com #1 Project Number: 98031-0528 Project Manager: James McDaniel	Reported: 01-May-13 14:26
---	---	------------------------------

**Nonhalogenated Organics by 8015 - Quality Control**  
**Envirotech Analytical Laboratory**

Analyte	Result	Reporting Limit	Units	Spike Level	Source Result	%REC	%REC Limits	RPD	RPD Limit	Notes
---------	--------	--------------------	-------	----------------	------------------	------	----------------	-----	--------------	-------

**Batch 1318016 - GRO/DRO Extraction EPA 3550C**

<b>Blank (1318016-BLK1)</b>		Prepared: 30-Apr-13 Analyzed: 01-May-13								
Gasoline Range Organics (C6-C10)	ND	4.99	mg/kg							
Diesel Range Organics (C10-C28)	ND	4.99	"							
GRO and DRO Combined Fractions	ND	4.99	"							
<b>Duplicate (1318016-DUP1)</b>		<b>Source: P304089-01</b>		Prepared: 30-Apr-13 Analyzed: 01-May-13						
Gasoline Range Organics (C6-C10)	ND	5.00	mg/kg		ND				30	
Diesel Range Organics (C10-C28)	ND	5.00	"		ND				30	
<b>Matrix Spike (1318016-MS1)</b>		<b>Source: P304089-01</b>		Prepared: 30-Apr-13 Analyzed: 01-May-13						
Gasoline Range Organics (C6-C10)	268	5.26	mg/kg	263	ND	102	75-125			
Diesel Range Organics (C10-C28)	266	5.26	"	263	ND	101	75-125			

Partial or incomplete reproduction of this report is prohibited, unless approved by Envirotech, Inc.

5796 US Highway 64, Farmington, NM 87401

Ph (505) 632-0615 Fx (505) 632-1865

Three Springs • 65 Mercado Street, Suite 115, Durango, CO 81301

Ph (970) 259-0615 Fr (800) 362-1879





XTO Energy Inc.  
382 CR 3100  
Aztec NM, 87410

Project Name: Rowland Gas Com #1  
Project Number: 98031-0528  
Project Manager: James McDaniel

**Reported:**  
01-May-13 14:26

#### Notes and Definitions

DET Analyte DETECTED  
ND Analyte NOT DETECTED at or above the reporting limit  
NR Not Reported  
dry Sample results reported on a dry weight basis  
RPD Relative Percent Difference

Partial or incomplete reproduction of this report is prohibited, unless approved by Envirotech, Inc.

5796 US Highway 64, Farmington, NM 87401

Three Springs • 65 Mercado Street, Suite 115, Durango, CO 81301

Ph (505) 632-0615 Fx (505) 632-1865

Ph (970) 259-0615 Fr (800) 362-1879



# CHAIN OF CUSTODY RECORD

15475

Page 10 of 10

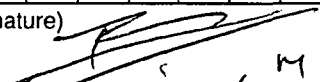
Client: <b>XTO Energy, Inc.</b>		Project Name / Location: <b>Rowland Gas Com #1</b>		ANALYSIS / PARAMETERS																
Email results to: <b>James.medaniel@xtoenergy.com</b>		Sampler Name: <b>Dev'n Heermann</b>		<div style="display: flex; flex-direction: row-reverse; justify-content: space-between; padding: 0 5px;"> <div>TPH (Method 8015)</div> <div>BTEX (Method 8021)</div> <div>VOC (Method 8260)</div> <div>RCRA 8 Metals</div> <div>Cation / Anion</div> <div>RCI</div> <div>TCLP with H/P</div> <div>CO Table 910-1</div> <div>TPH (418.1)</div> <div>CHLORIDE</div> <div>TPH 8015 NO MRO</div> <div>Sample Cool</div> <div>Sample Intact</div> </div>																
Client Phone No.: <b>505-787-0519</b>		Client No.: <b>98031-0528</b>																		
Sample No. / Identification	Sample Date	Sample Time	Lab No.	No./Volume of Containers	Preservative			TPH (Method 8015)	BTEX (Method 8021)	VOC (Method 8260)	RCRA 8 Metals	Cation / Anion	RCI	TCLP with H/P	CO Table 910-1	TPH (418.1)	CHLORIDE	TPH 8015 NO MRO	Sample Cool	Sample Intact
					HgCl <sub>2</sub>	HCl	None													
South wall Middle-west comp	4/30/13	1340	P3040916-01	1 x 4.2			X	X										X	X	X
West wall comp	4/30/13	1210	P3040916-02	1 x 4.2			X	X										X	X	X
Floor comp	4/30/13	1010	P3040916-03	1 x 4.2			X	X										X	X	X
North wall comp	4/29/13	1415	P3040916-04	1 x 4.2			X	X										X	X	X
Relinquished by: (Signature) 					Date 4/30/13	Time 1623	Received by: (Signature) 					Date 4/30/13	Time 1623							
Relinquished by: (Signature)							Received by: (Signature)													
Sample Matrix Soil <input checked="" type="checkbox"/> Solid <input type="checkbox"/> Sludge <input type="checkbox"/> Aqueous <input type="checkbox"/> Other <input type="checkbox"/>																				
<input type="checkbox"/> Sample(s) dropped off after hours to secure drop off area. <div style="font-size: 2em; font-weight: bold; margin-left: 50px;">RUSH</div>																				



5795 US Highway 64 • Farmington, NM 87401 • 505-632-0615 • Three Springs • 65 Mercado Street, Suite 115, Durango, CO 81301 • laboratory@envirotech-inc.com



## Analytical Report

### Report Summary

Client: XTO Energy Inc.

Chain Of Custody Number: 15477

Samples Received: 5/1/2013 5:00:00PM

Job Number: 98031-0528

Work Order: P305001

Project Name/Location: Rowland Gas Com #1

Entire Report Reviewed By:

A handwritten signature in black ink, appearing to read 'Tim Cain', is written over a horizontal line.

Date: 5/3/13

Tim Cain, Laboratory Manager

The results in this report apply to the samples submitted to Envirotech's Analytical Laboratory and were analyzed in accordance with the chain of custody document supplied by you, the client, and as such are for your exclusive use only. The results in this report are based on the sample as received unless otherwise noted. Partial or incomplete reproduction of this report is prohibited, unless approved by Envirotech, Inc. If you have any questions regarding this analytical report, please don't hesitate to contact Envirotech's Laboratory Staff.

XTO Energy Inc.  
 382 CR 3100  
 Aztec NM, 87410

Project Name: Rowland Gas Com #1  
 Project Number: 98031-0528  
 Project Manager: James McDaniel

**Reported:**  
 03-May-13 14:55

### Analytical Report for Samples

Client Sample ID	Lab Sample ID	Matrix	Sampled	Received	Container
South Wall Middle East Composite	P305001-01A	Soil	05/01/13	05/01/13	Glass Jar, 4 oz.
East Floor Comp.	P305001-02A	Soil	05/01/13	05/01/13	Glass Jar, 4 oz.
East Wall Comp.	P305001-03A	Soil	05/01/13	05/01/13	Glass Jar, 4 oz.

Partial or incomplete reproduction of this report is prohibited, unless approved by Envirotech, Inc.

5796 US Highway 64, Farmington, NM 87401

Three Springs • 65 Mercado Street, Suite 115, Durango, CO 81301

Ph (505) 632-0615 Fx (505) 632-1865

Ph (970) 259-0615 Fr (800) 362-1879

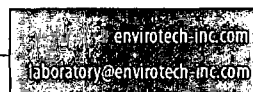





XTO Energy Inc. 382 CR 3100 Aztec NM, 87410	Project Name: Rowland Gas Com #1 Project Number: 98031-0528 Project Manager: James McDaniel	Reported: 03-May-13 14:55
---	---	------------------------------

**South Wall Middle East Composite  
P305001-01 (Solid)**

Analyte	Result	Reporting Limit	Units	Dilution	Batch	Prepared	Analyzed	Method	Notes
<b>Volatile Organics by EPA 8021</b>									
Benzene	ND	49.9	ug/kg	1	1318027	02-May-13	02-May-13	EPA 8021B	
Toluene	ND	49.9	ug/kg	1	1318027	02-May-13	02-May-13	EPA 8021B	
Ethylbenzene	ND	49.9	ug/kg	1	1318027	02-May-13	02-May-13	EPA 8021B	
p,m-Xylene	ND	49.9	ug/kg	1	1318027	02-May-13	02-May-13	EPA 8021B	
o-Xylene	ND	49.9	ug/kg	1	1318027	02-May-13	02-May-13	EPA 8021B	
Total BTEX	ND	49.9	ug/kg	1	1318027	02-May-13	02-May-13	EPA 8021B	
Surrogate: Bromochlorobenzene		99.8 %	80-120		1318027	02-May-13	02-May-13	EPA 8021B	
Surrogate: 1,4-Difluorobenzene		103 %	80-120		1318027	02-May-13	02-May-13	EPA 8021B	
Surrogate: Fluorobenzene		101 %	80-120		1318027	02-May-13	02-May-13	EPA 8021B	
<b>Nonhalogenated Organics by 8015</b>									
Gasoline Range Organics (C6-C10)	ND	5.00	mg/kg	1	1318028	02-May-13	02-May-13	EPA 8015D	
Diesel Range Organics (C10-C28)	ND	5.00	mg/kg	1	1318028	02-May-13	02-May-13	EPA 8015D	
GRO and DRO Combined Fractions	ND	5.00	mg/kg	1	1318028	02-May-13	02-May-13	EPA 8015D	

Partial or incomplete reproduction of this report is prohibited, unless approved by Envirotech, Inc.

5796 US Highway 64, Farmington, NM 87401

Ph (505) 632-0615 Fx (505) 632-1865

Three Springs - 65 Mercado Street, Suite 115, Durango, CO 81301

Ph (970) 259-0615 Fr (800) 362-1879



XTO Energy Inc.  
 382 CR 3100  
 Aztec NM, 87410

 Project Name: Rowland Gas Com #1  
 Project Number: 98031-0528  
 Project Manager: James McDaniel

**Reported:**  
 03-May-13 14:55

**East Floor Comp.**  
**P305001-02 (Solid)**

Analyte	Result	Reporting Limit	Units	Dilution	Batch	Prepared	Analyzed	Method	Notes
<b>Volatile Organics by EPA 8021</b>									
Benzene	ND	1.00	ug/kg	0.02	1318027	02-May-13	02-May-13	EPA 8021B	
Toluene	ND	1.00	ug/kg	0.02	1318027	02-May-13	02-May-13	EPA 8021B	
Ethylbenzene	ND	1.00	ug/kg	0.02	1318027	02-May-13	02-May-13	EPA 8021B	
p,m-Xylene	ND	1.00	ug/kg	0.02	1318027	02-May-13	02-May-13	EPA 8021B	
o-Xylene	ND	1.00	ug/kg	0.02	1318027	02-May-13	02-May-13	EPA 8021B	
Total BTEX	ND	1.00	ug/kg	0.02	1318027	02-May-13	02-May-13	EPA 8021B	
Surrogate: Bromochlorobenzene		94.0 %	80-120		1318027	02-May-13	02-May-13	EPA 8021B	
Surrogate: 1,4-Difluorobenzene		94.2 %	80-120		1318027	02-May-13	02-May-13	EPA 8021B	
Surrogate: Fluorobenzene		93.7 %	80-120		1318027	02-May-13	02-May-13	EPA 8021B	
<b>Nonhalogenated Organics by 8015</b>									
Gasoline Range Organics (C6-C10)	ND	4.99	mg/kg	1	1318028	02-May-13	02-May-13	EPA 8015D	
Diesel Range Organics (C10-C28)	8.98	4.99	mg/kg	1	1318028	02-May-13	02-May-13	EPA 8015D	
GRO and DRO Combined Fractions	8.98	4.99	mg/kg	1	1318028	02-May-13	02-May-13	EPA 8015D	

Partial or incomplete reproduction of this report is prohibited, unless approved by Envirotech, Inc.

5796 US Highway 64, Farmington, NM 87401

Three Springs • 65 Mercado Street, Suite 115, Durango, CO 81301

Ph (505) 632-0615 Fx (505) 632-1865

Ph (970) 259-0615 Fr (800) 362-1879





XTO Energy Inc.  
382 CR 3100  
Aztec NM, 87410

Project Name: Rowland Gas Com #1  
Project Number: 98031-0528  
Project Manager: James McDaniel

Reported:  
03-May-13 14:55

**East Wall Comp.**  
**P305001-03 (Solid)**

Analyte	Result	Reporting		Units	Dilution	Batch	Prepared	Analyzed	Method	Notes
		Limit								
Volatile Organics by EPA 8021										
Benzene	ND	1.00	ug/kg	0.02	1318027	02-May-13	02-May-13	02-May-13	EPA 8021B	
Toluene	ND	1.00	ug/kg	0.02	1318027	02-May-13	02-May-13	02-May-13	EPA 8021B	
Ethylbenzene	ND	1.00	ug/kg	0.02	1318027	02-May-13	02-May-13	02-May-13	EPA 8021B	
p,m-Xylene	ND	1.00	ug/kg	0.02	1318027	02-May-13	02-May-13	02-May-13	EPA 8021B	
o-Xylene	ND	1.00	ug/kg	0.02	1318027	02-May-13	02-May-13	02-May-13	EPA 8021B	
Total BTEX	ND	1.00	ug/kg	0.02	1318027	02-May-13	02-May-13	02-May-13	EPA 8021B	
Surrogate: Bromochlorobenzene		93.4 %	80-120		1318027	02-May-13	02-May-13	02-May-13	EPA 8021B	
Surrogate: 1,4-Difluorobenzene		96.5 %	80-120		1318027	02-May-13	02-May-13	02-May-13	EPA 8021B	
Surrogate: Fluorobenzene		96.0 %	80-120		1318027	02-May-13	02-May-13	02-May-13	EPA 8021B	
Nonhalogenated Organics by 8015										
Gasoline Range Organics (C6-C10)	ND	5.00	mg/kg	1	1318028	02-May-13	02-May-13	02-May-13	EPA 8015D	
Diesel Range Organics (C10-C28)	7.81	5.00	mg/kg	1	1318028	02-May-13	02-May-13	02-May-13	EPA 8015D	
GRO and DRO Combined Fractions	7.81	5.00	mg/kg	1	1318028	02-May-13	02-May-13	02-May-13	EPA 8015D	

Partial or incomplete reproduction of this report is prohibited, unless approved by Envirotech, Inc.

5796 US Highway 64, Farmington, NM 87401

Three Springs • 65 Mercado Street, Suite 115, Durango, CO 81301

Ph (505) 632-0615 Fx (505) 632-1865

Ph (970) 259-0615 Fr (800) 362-1879





XTO Energy Inc. 382 CR 3100 Aztec NM, 87410	Project Name: Rowland Gas Com #1 Project Number: 98031-0528 Project Manager: James McDaniel	Reported: 03-May-13 14:55
---	---	------------------------------

**Volatile Organics by EPA 8021 - Quality Control**  
**Envirotech Analytical Laboratory**

Analyte	Result	Reporting Limit	Units	Spike Level	Source Result	%REC	%REC Limits	RPD	RPD Limit	Notes
---------	--------	-----------------	-------	-------------	---------------	------	-------------	-----	-----------	-------

**Batch 1318027 - Purge and Trap EPA 5030A**

<b>Blank (1318027-BLK1)</b>				Prepared & Analyzed: 02-May-13						
Benzene	ND	50.0	ug/kg							
Toluene	ND	50.0	"							
Ethylbenzene	ND	50.0	"							
p,m-Xylene	ND	50.0	"							
o-Xylene	ND	50.0	"							
Total BTEX	ND	50.0	"							
Surrogate: Bromochlorobenzene	46.8		ug/L	50.0		93.5	80-120			
Surrogate: 1,4-Difluorobenzene	51.3		"	50.0		103	80-120			
Surrogate: Fluorobenzene	50.2		"	50.0		100	80-120			

<b>Duplicate (1318027-DUP1)</b>				Source: P305001-01		Prepared & Analyzed: 02-May-13				
Benzene	ND	49.9	ug/kg		ND				30	
Toluene	ND	49.9	"		ND				30	
Ethylbenzene	ND	49.9	"		ND				30	
p,m-Xylene	ND	49.9	"		ND				30	
o-Xylene	ND	49.9	"		ND				30	
Surrogate: Bromochlorobenzene	49.7		ug/L	50.0		99.4	80-120			
Surrogate: 1,4-Difluorobenzene	50.4		"	50.0		101	80-120			
Surrogate: Fluorobenzene	50.2		"	50.0		100	80-120			

<b>Matrix Spike (1318027-MS1)</b>				Source: P305001-01		Prepared & Analyzed: 02-May-13				
Benzene	51.5		ug/L	50.0	0.26	102	39-150			
Toluene	51.3		"	50.0	0.49	102	46-148			
Ethylbenzene	51.2		"	50.0	0.22	102	32-160			
p,m-Xylene	102		"	100	0.73	101	46-148			
o-Xylene	51.1		"	50.0	0.54	101	46-148			
Surrogate: Bromochlorobenzene	49.9		"	50.0		99.8	80-120			
Surrogate: 1,4-Difluorobenzene	51.5		"	50.0		103	80-120			
Surrogate: Fluorobenzene	51.7		"	50.0		103	80-120			

Partial or incomplete reproduction of this report is prohibited, unless approved by Envirotech, Inc.

5796 US Highway 64, Farmington, NM 87401

Ph (505) 632-0615 Fx (505) 632-1865

Three Springs • 65 Mercado Street, Suite 115, Durango, CO 81301

Ph (970) 259-0615 Fr (800) 362-1879



XTO Energy Inc.  
 382 CR 3100  
 Aztec NM, 87410

 Project Name: Rowland Gas Com #1  
 Project Number: 98031-0528  
 Project Manager: James McDaniel

**Reported:**  
 03-May-13 14:55

**Nonhalogenated Organics by 8015 - Quality Control**
**Envirotech Analytical Laboratory**

Analyte	Result	Reporting Limit	Units	Spike Level	Source Result	%REC	%REC Limits	RPD	RPD Limit	Notes
---------	--------	--------------------	-------	----------------	------------------	------	----------------	-----	--------------	-------

**Batch 1318028 - GRO/DRO Extraction EPA 3550C**
**Blank (1318028-BLK1)**

Prepared &amp; Analyzed: 02-May-13

Gasoline Range Organics (C6-C10)	ND	4.99	mg/kg
Diesel Range Organics (C10-C28)	ND	4.99	"
GRO and DRO Combined Fractions	ND	4.99	"

**Duplicate (1318028-DUP1)**

Source: P305001-01

Prepared &amp; Analyzed: 02-May-13

Gasoline Range Organics (C6-C10)	ND	5.00	mg/kg	ND	30
Diesel Range Organics (C10-C28)	ND	5.00	"	ND	30

**Matrix Spike (1318028-MS1)**

Source: P305001-01

Prepared &amp; Analyzed: 02-May-13

Gasoline Range Organics (C6-C10)	264	5.26	mg/kg	263	ND	100	75-125
Diesel Range Organics (C10-C28)	272	5.26	"	263	ND	103	75-125

Partial or incomplete reproduction of this report is prohibited, unless approved by Envirotech, Inc.

5796 US Highway 64, Farmington, NM 87401

Ph (505) 632-0615 Fx (505) 632-1865

Three Springs • 65 Mercado Street, Suite 115, Durango, CO 81301

Ph (970) 259-0615 Fr (800) 362-1879





XTO Energy Inc.  
382 CR 3100  
Aztec NM, 87410

Project Name: Rowland Gas Com #1  
Project Number: 98031-0528  
Project Manager: James McDaniel

**Reported:**  
03-May-13 14:55

#### Notes and Definitions

DET Analyte DETECTED  
ND Analyte NOT DETECTED at or above the reporting limit  
NR Not Reported  
dry Sample results reported on a dry weight basis  
RPD Relative Percent Difference

Partial or incomplete reproduction of this report is prohibited, unless approved by Envirotech, Inc.

5796 US Highway 64, Farmington, NM 87401

Three Springs • 65 Mercado Street, Suite 115, Durango, CO 81301

Ph (505) 632-0615 Fx (505) 632-1865



Ph (970) 259-0615 Fr (800) 362-1879



# CHAIN OF CUSTODY RECORD

15477

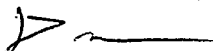
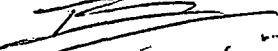
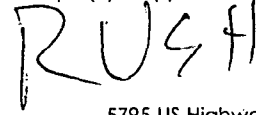
Page 9 of 9

Client: <b>XTO energy Inc.</b>		Project Name / Location: <b>Rowland GC #1</b>			ANALYSIS / PARAMETERS													
Email results to: <b>James.Medanic@xtoenergy.com</b>		Sampler Name: <b>Devin Henemann</b>			TPH (Method 8015)	BTEX (Method 8021)	VOC (Method 8260)	RCRA 8 Metals	Cation / Anion	RCI	TCLP with H/P	CO Table 910-1	TPH (418.1)	CHLORIDE			Sample Cool	Sample Intact
Client Phone No.: <b>505-787-0519</b>		Client No.: <b>94031-0528</b>																
Sample No./ Identification	Sample Date	Sample Time	Lab No.	No./Volume of Containers	Preservative													
					HgCl <sub>2</sub>	HCl												
South wall middle East composite	5/1/13	1620	P305001-01	1 x 4oz				X	X								Y	X
East Floor comp.	5/1/13	1345	P305001-02	1 x 4oz				X	X								X	X
East wall comp.	5/1/13	1350	P305001-03	1 x 4oz				X	X									
Relinquished by: (Signature) 					Date	Time	Received by: (Signature) 					Date	Time					
					5/1/13	1700						5/1/13	1700					
Relinquished by: (Signature)							Received by: (Signature)											
Sample Matrix																		
Soil <input checked="" type="checkbox"/> Solid <input type="checkbox"/> Sludge <input type="checkbox"/> Aqueous <input type="checkbox"/> Other <input type="checkbox"/>																		
<input type="checkbox"/> Sample(s) dropped off after hours to secure drop off area. 																		
5795 US Highway 64 • Farmington, NM 87401 • 505-632-0615 • Three Springs • 65 Mercado Street, Suite 115, Durango, CO 81301 • laboratory@envirotech-inc.com																		



## Analytical Report

### Report Summary

Client: XTO Energy Inc.

Chain Of Custody Number: 15478

Samples Received: 5/1/2013 5:00:00PM

Job Number: 98031-0528

Work Order: P305002

Project Name/Location: Rowland Gas Com #1

Entire Report Reviewed By:

A handwritten signature in black ink, appearing to read 'Tim Cain', is written over a horizontal line.

Date: 5/3/13

Tim Cain, Laboratory Manager

The results in this report apply to the samples submitted to Envirotech's Analytical Laboratory and were analyzed in accordance with the chain of custody document supplied by you, the client, and as such are for your exclusive use only. The results in this report are based on the sample as received unless otherwise noted. Partial or incomplete reproduction of this report is prohibited, unless approved by Envirotech, Inc. If you have any questions regarding this analytical report, please don't hesitate to contact Envirotech's Laboratory Staff.





XTO Energy Inc.  
382 CR 3100  
Aztec NM, 87410

Project Name: Rowland Gas Com #1  
Project Number: 98031-0528  
Project Manager: James McDaniel

**Reported:**  
03-May-13 15:03

### Analytical Report for Samples

Client Sample ID	Lab Sample ID	Matrix	Sampled	Received	Container
Excavation GW	P305002-01A	Water	05/01/13	05/01/13	Voa vial, 40mL, HCl
	P305002-01B	Water	05/01/13	05/01/13	Voa vial, 40mL, HCl
	P305002-01C	Water	05/01/13	05/01/13	Voa vial, 40mL, HCl

Partial or incomplete reproduction of this report is prohibited, unless approved by Envirotech, Inc.

5796 US Highway 64, Farmington, NM 87401

Three Springs • 65 Mercado Street, Suite 115, Durango, CO 81301

Ph (505) 632-0615 Fx (505) 632-1865

Ph (970) 259-0615 Fr (800) 362-1879





XTO Energy Inc. 382 CR 3100 Aztec NM, 87410	Project Name: Rowland Gas Com #1 Project Number: 98031-0528 Project Manager: James McDaniel	Reported: 03-May-13 15:03
---	---	------------------------------

**Excavation GW  
P305002-01 (Water)**

Analyte	Result	Reporting Limit	Units	Dilution	Batch	Prepared	Analyzed	Method	Notes
<b>Volatile Organics by EPA 8021</b>									
<b>Benzene</b>	<b>1.08</b>	1.00	ug/L	1	1318029	02-May-13	02-May-13	EPA 8021B	
<b>Toluene</b>	<b>1.52</b>	1.00	ug/L	1	1318029	02-May-13	02-May-13	EPA 8021B	
<b>Ethylbenzene</b>	<b>1.02</b>	1.00	ug/L	1	1318029	02-May-13	02-May-13	EPA 8021B	
<b>p,m-Xylene</b>	<b>3.63</b>	1.00	ug/L	1	1318029	02-May-13	02-May-13	EPA 8021B	
<b>o-Xylene</b>	<b>1.07</b>	1.00	ug/L	1	1318029	02-May-13	02-May-13	EPA 8021B	
<b>Total BTEX</b>	<b>8.33</b>	1.00	ug/L	1	1318029	02-May-13	02-May-13	EPA 8021B	
<i>Surrogate: Bromochlorobenzene</i>		102 %		80-120	1318029	02-May-13	02-May-13	EPA 8021B	
<i>Surrogate: 1,4-Difluorobenzene</i>		99.3 %		80-120	1318029	02-May-13	02-May-13	EPA 8021B	
<i>Surrogate: Fluorobenzene</i>		100 %		80-120	1318029	02-May-13	02-May-13	EPA 8021B	

Partial or incomplete reproduction of this report is prohibited, unless approved by Envirotech, Inc.

5796 US Highway 64, Farmington, NM 87401

Ph (505) 632-0615 Fx (505) 632-1865

Three Springs • 65 Mercado Street, Suite 115, Durango, CO 81301

Ph (970) 259-0615 Fr (800) 362-1879





XTO Energy Inc. 382 CR 3100 Aztec NM, 87410	Project Name: Rowland Gas Com #1 Project Number: 98031-0528 Project Manager: James McDaniel	Reported: 03-May-13 15:03
---	---	------------------------------

### Volatile Organics by EPA 8021 - Quality Control

#### Envirotech Analytical Laboratory

Analyte	Result	Reporting Limit	Units	Spike Level	Source Result	%REC	%REC Limits	RPD	RPD Limit	Notes
---------	--------	-----------------	-------	-------------	---------------	------	-------------	-----	-----------	-------

#### Batch 1318029 - Purge and Trap EPA 5030A

<b>Blank (1318029-BLK1)</b>				Prepared & Analyzed: 02-May-13						
Benzene	ND	50.0	ug/L							
Toluene	ND	50.0	"							
Ethylbenzene	ND	50.0	"							
p,m-Xylene	ND	50.0	"							
o-Xylene	ND	50.0	"							
Total BTEX	ND	50.0	"							
Surrogate: Bromochlorobenzene	47.6		"	50.0		95.3	80-120			
Surrogate: 1,4-Difluorobenzene	48.1		"	50.0		96.3	80-120			
Surrogate: Fluorobenzene	48.4		"	50.0		96.8	80-120			

<b>Duplicate (1318029-DUP1)</b>				Source: P305002-01		Prepared & Analyzed: 02-May-13				
Benzene	1.10	1.00	ug/L		1.08			1.83	30	
Toluene	1.68	1.00	"		1.52			9.99	30	
Ethylbenzene	1.09	1.00	"		1.02			6.43	30	
p,m-Xylene	3.76	1.00	"		3.63			3.44	30	
o-Xylene	1.06	1.00	"		1.07			0.376	30	
Surrogate: Bromochlorobenzene	45.7		"	50.0		91.4	80-120			
Surrogate: 1,4-Difluorobenzene	48.2		"	50.0		96.5	80-120			
Surrogate: Fluorobenzene	48.6		"	50.0		97.2	80-120			

<b>Matrix Spike (1318029-MS1)</b>				Source: P305002-01		Prepared & Analyzed: 02-May-13				
Benzene	2480	50.0	ug/L	2500	1.08	99.0	39-150			
Toluene	2510	50.0	"	2500	1.52	100	46-148			
Ethylbenzene	2540	50.0	"	2500	1.02	101	32-160			
p,m-Xylene	5020	50.0	"	5000	3.63	100	46-148			
o-Xylene	2510	50.0	"	2500	1.07	100	46-148			
Surrogate: Bromochlorobenzene	51.3		"	50.0		103	80-120			
Surrogate: 1,4-Difluorobenzene	47.4		"	50.0		94.7	80-120			
Surrogate: Fluorobenzene	47.8		"	50.0		95.5	80-120			

Partial or incomplete reproduction of this report is prohibited, unless approved by Envirotech, Inc.

5796 US Highway 64, Farmington, NM 87401

Ph (505) 632-0615 Fx (505) 632-1865

Three Springs • 65 Mercado Street, Suite 115, Durango, CO 81301

Ph (970) 259-0615 Fr (800) 362-1879





XTO Energy Inc.  
382 CR 3100  
Aztec NM, 87410

Project Name: Rowland Gas Com #1  
Project Number: 98031-0528  
Project Manager: James McDaniel

**Reported:**  
03-May-13 15:03

#### Notes and Definitions

DET Analyte DETECTED  
ND Analyte NOT DETECTED at or above the reporting limit  
NR Not Reported  
dry Sample results reported on a dry weight basis  
RPD Relative Percent Difference

Partial or incomplete reproduction of this report is prohibited, unless approved by Envirotech, Inc.

5796 US Highway 64, Farmington, NM 87401

Three Springs - 65 Mercado Street, Suite 115, Durango, CO 81301

Ph (505) 632-0615 Fx (505) 632-1865

Ph (970) 259-0615 Fr (800) 362-1879



# CHAIN OF CUSTODY RECORD

15478

Page 6 of 6

Client: <b>XTO energy Inc</b>			Project Name / Location: <b>Rowland GL #1</b>			ANALYSIS / PARAMETERS													
Email results to: <b>James.Mednick@xtoenergy.com</b>			Sampler Name: <b>Devin Hennemann</b>			TPH (Method 8015)	BTEX (Method 8021)	VOC (Method 8260)	RCRA 8 Metals	Cation / Anion	RCI	TCLP with H/P	CO Table 910-1	TPH (418.1)	CHLORIDE			Sample Cool	Sample Intact
Client Phone No.: <b>505-787-0519</b>			Client No.: <b>98031-8528</b>																
Sample No./ Identification	Sample Date	Sample Time	Lab No.	No./Volume of Containers	Preservative														
					HgCl <sub>2</sub>	HCl													
<b>Excavation GW</b>	<b>5/1/13</b>	<b>1537</b>		<b>3X 40mL</b>		<b>X</b>			<b>X</b>									<b>X</b>	<b>X</b>
Relinquished by: (Signature) <b>[Signature]</b>					Date <b>5/1/13</b>	Time <b>1700</b>	Received by: (Signature) <b>[Signature]</b>										Date <b>5/1/13</b>	Time <b>1700</b>	
Relinquished by: (Signature)							Received by: (Signature)												
Sample Matrix Soil <input type="checkbox"/> Solid <input type="checkbox"/> Sludge <input type="checkbox"/> Aqueous <input checked="" type="checkbox"/> Other <input type="checkbox"/>																			
<input type="checkbox"/> Sample(s) dropped off after hours to secure drop off area. <b>RUS #</b> <div style="text-align: right;">  </div>																			