

District I
1625 N. French Dr., Hobbs, NM 88240
District II
1301 W. Grand Avenue, Artesia, NM 88210
District III
1000 Rio Brazos Road, Aztec, NM 87410
District IV
1220 S. St. Francis Dr., Santa Fe, NM 87505

State of New Mexico
Energy Minerals and Natural Resources

Oil Conservation Division
1220 South St. Francis Dr.
Santa Fe, NM 87505

Form C-141
Revised August 8, 2011

Submit 1 Copy to appropriate District Office to
accordance with 19.15.29 NMAC.

Release Notification and Corrective Action

OPERATOR

☐ Initial Report ☒ Final Report

Name of Company Burlington Resources Oil & Gas Company	Contact Crystal Tafoya
Address 3401 East 30th St, Farmington, NM	Telephone No. (505) 326-9837
Facility Name: Lawson 1A	Facility Type: Gas Well
Surface Owner BLM	Mineral Owner BLM (NM-079269)
API No. 30-045-22124	

LOCATION OF RELEASE

Unit Letter D	Section 12	Township 31N	Range 11W	Feet from the 990	North/South Line North	Feet from the 970	East/West Line West	County San Juan
-------------------------	----------------------	------------------------	---------------------	-----------------------------	----------------------------------	-----------------------------	-------------------------------	---------------------------

Latitude 36.91746 Longitude -107.94764

NATURE OF RELEASE

Type of Release Produced Fluids	Volume of Release Unknown	Volume Recovered 322 cu. yds.
Source of Release Production Tank	Date and Hour of Occurrence Unknown	Date and Hour of Discovery 2/6/2014
Was Immediate Notice Given? <input type="checkbox"/> Yes <input type="checkbox"/> No <input checked="" type="checkbox"/> Not Required	If YES, To Whom?	
By Whom?	Date and Hour	
Was a Watercourse Reached? <input type="checkbox"/> Yes <input checked="" type="checkbox"/> No	If YES, Volume Impacting the Watercourse.	

If a Watercourse was Impacted, Describe Fully.*
N/A

OIL CONS. DIV DIST. 3

Describe Cause of Problem and Remedial Action Taken.*
Facility re-set

JUL 02 2014

Describe Area Affected and Cleanup Action Taken.*

Historical hydrocarbon impacted soil was found during a facility re-set for the subject well. The excavation was 30'x 40' x 5' and 322 cu. yds of soil was transported to IEI landfarm and 322 yds of clean soil was transported from Aztec Machine and placed in the excavation site. The soil sampling report is attached for review.

I hereby certify that the information given above is true and complete to the best of my knowledge and understand that pursuant to NMOCD rules and regulations all operators are required to report and/or file certain release notifications and perform corrective actions for releases which may endanger public health or the environment. The acceptance of a C-141 report by the NMOCD marked as "Final Report" does not relieve the operator of liability should their operations have failed to adequately investigate and remediate contamination that pose a threat to ground water, surface water, human health or the environment. In addition, NMOCD acceptance of a C-141 report does not relieve the operator of responsibility for compliance with any other federal, state, or local laws and/or regulations.

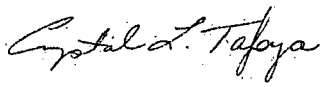
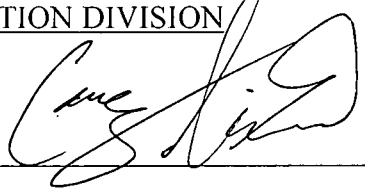
Signature: 		OIL CONSERVATION DIVISION	
Printed Name: Crystal Tafoya		Approved by Environmental Specialist: 	
Title: Field Environmental Specialist		Approval Date: 7/7/14	Expiration Date:
E-mail Address: crystal.tafoya@conocophillips.com		Conditions of Approval:	Attached <input type="checkbox"/>
Date: 7/1/2014 Phone: (505) 326-9837			

* Attach Additional Sheets If Necessary

#NCS 141 8828 224



Animas Environmental Services, LLC

www.animasenvironmental.com

624 E. Comanche
Farmington, NM 87401
505-564-2281

Durango, Colorado
970-403-3084

June 28, 2014

Crystal Tafoya
ConocoPhillips
San Juan Business Unit
Office 214-05
5525 Hwy 64
Farmington, New Mexico 87401

Via electronic mail to:
SJBUE-Team@ConocoPhillips.com

**RE: Initial Release Assessment and Final Excavation Report
Lawson #1A
San Juan County, New Mexico**

Dear Ms. Tafoya:

On February 6 and May 29, 2014, Animas Environmental Services, LLC (AES) completed an initial release assessment and environmental clearance of the final excavation limits at the ConocoPhillips (CoP) Lawson #1A, located in San Juan County, New Mexico. The release consisted of an unknown quantity of condensate next to the production tank at the location. The initial release assessment was completed by AES on February 6, 2014, and the final excavation was completed by CoP contractors prior to AES' arrival at the location on May 29, 2014.

1.0 Site Information

1.1 Location

Site Name – Lawson #1A

Location – NW¼ NW¼, Section 12, T31N, R11W, San Juan County, New Mexico

Well Head Latitude/Longitude – N36.91746 and W107.94764, respectively

Release Location Latitude/Longitude – N36.91724 and W107.94756, respectively

Land Jurisdiction – Bureau of Land Management (BLM)

Figure 1. Topographic Site Location Map

Figure 2. Aerial Site Map, February 2014

1.2 NMOCD Ranking

In accordance with New Mexico Oil Conservation Division (NMOCD) release protocols, action levels were established per NMOCD *Guidelines for Remediation of Leaks, Spills, and Releases* (August 1993) prior to site work. The release was given a ranking score of 10 based on the following factors:

- **Depth to Groundwater:** A cathodic protection report form dated January 1994 for the Lawson #1A reported the depth to groundwater at 100 feet below ground surface (bgs). (0 points)
- **Wellhead Protection Area:** The release location is not within a wellhead protection area. (0 points)
- **Distance to Surface Water Body:** An unnamed wash which discharges to the wash in Kitten Canyon is located approximately 540 feet northwest of the location. (10 points)

1.3 Assessment

AES was initially contacted by Crystal Tafoya of CoP on February 3, 2014, and on February 6, 2014, Ross Kennemer and Emilee Skyles of AES completed the release assessment field work. The assessment included collection and field sampling of 8 soil samples from 6 borings in and around the release area. Soil borings were terminated on sandstone between 2 and 2.75 feet. Based on the field sampling results, AES recommended excavation of the release area. Sample locations are shown on Figure 3.

On May 29, 2014, AES returned to the location to collect confirmation soil samples of the excavation. The field sampling activities included collection of five confirmation soil samples from the walls and base of the excavation. The area of the final excavation measured approximately 30 feet by 41 feet by 3 to 5 feet in depth. Sample locations and final excavation extents are presented on Figure 4.

2.0 Soil Sampling

A total of 8 soil samples from 6 borings (SB-1 through SB-6) and 5 composite samples (SC-1 through SC-5) were collected during the assessments. All soil samples were field screened for volatile organic compounds (VOCs), and selected samples were also analyzed for total petroleum hydrocarbons (TPH). Five composite samples (SC-1 through SC-5) collected during the excavation clearance were submitted for confirmation laboratory analysis.

2.1 *Field Sampling*

2.1.1 Volatile Organic Compounds

Field screening for VOC vapors was conducted with a photo-ionization detector (PID) organic vapor meter (OVM). Before beginning field screening, the PID-OVM was first calibrated with 100 parts per million (ppm) isobutylene gas.

2.1.2 Total Petroleum Hydrocarbons

Field TPH samples were analyzed per U.S. Environmental Protection Agency (USEPA) Method 418.1 using a Buck Scientific Model HC-404 Total Hydrocarbon Analyzer Infrared Spectrometer (Buck). A 3-point calibration was completed prior to conducting soil analyses. Field analytical protocol followed AES's *Standard Operating Procedure: Field Analysis Total Petroleum Hydrocarbons per EPA Method 418.1*.

2.2 *Laboratory Analyses*

The soil samples collected for laboratory analysis were placed into new, clean, laboratory-supplied containers, which were then labeled, placed on ice, and logged onto a sample chain of custody record. Samples were maintained on ice until delivery to the analytical laboratory, Hall Environmental Analysis Laboratory (Hall) in Albuquerque, New Mexico. All soil samples were laboratory analyzed for:

- TPH for gasoline range organics (GRO) and diesel range organics (DRO) per USEPA Method 8015D.

In addition, soil samples SC-2 and SC-4 were laboratory analyzed for:

- Benzene, toluene, ethylbenzene, and xylene (BTEX) per USEPA Method 8021B.

2.3 *Field and Laboratory Analytical Results*

On February 6, 2014, initial assessment field screening results for VOCs via OVM showed concentrations ranging from 1.1 ppm in SB-5 up to 3,063 ppm in SB-6. Field TPH concentrations ranged from less than 20.0 mg/kg in SB-4 and SB-5 up to 13,400 mg/kg in SB-1.

On May 29, 2014, final excavation field screening results for VOCs via OVM ranged from 1.1 ppm in SC-1 up to 1,802 ppm in SC-4. Field TPH concentrations ranged from 36.8 mg/kg in SC-3 up to 666 mg/kg in SC-2. Results are included below in Table 1 and on Figures 3 and 4. The AES Field Sampling Reports are attached.

Table 1. Field Sampling VOCs and TPH Results
Lawson #1A Initial Release Assessment and Final Excavation
February and May 2014

Sample ID	Date Sampled	Sample Depth (ft bgs)	VOCs via OVM (ppm)	TPH 418.1 (mg/kg)
<i>NMOCD Action Level*</i>			100	1,000
SB-1	2/6/14	1	1,941	13,400
SB-2	2/6/14	1	2,521	4,280
		2	111	137
SB-3	2/6/14	1	2,712	NA
		2.5	2,149	538
SB-4	2/6/14	1.5	1.4	<20.0
SB-5	2/6/14	2.75	1.1	<20.0
SB-6	2/6/14	2	3,063	1,500
SC-1	5/29/14	1 to 5	1.1	38.1
SC-2	5/29/14	1 to 5	274	666
SC-3	5/29/14	1 to 5	7.8	36.8
SC-4	5/29/14	1 to 5	1,802	241
SC-5	5/29/14	5	81.7	144

NA – not analyzed

*Action level determined by the NMOCD ranking score per *NMOCD Guidelines for Remediation of Leaks, Spills, and Releases* (August 1993)

Laboratory analyses for SC-1 through SC-5 were used to confirm field sampling results from the final excavation. Benzene concentrations in SC-2 and SC-4 were reported below the laboratory detection limits of 0.035 mg/kg and 0.033 mg/kg, respectively. Total BTEX concentrations were reported at 0.86 mg/kg in SC-2 and at 4.4 mg/kg in SC-4. TPH concentrations as GRO/DRO were reported above laboratory detection in SC-2 (91 mg/kg), SC-4 (81 mg/kg), and SC-5 (10 mg/kg). Results are presented in Table 2 and on Figure 4. The laboratory analytical reports are attached.

Table 2. Laboratory Analytical Results – Benzene, Total BTEX, and TPH
 Lawson #1A Final Excavation, May 2014

<i>Sample ID</i>	<i>Date Sampled</i>	<i>Sample Depth (ft bgs)</i>	<i>Benzene (mg/kg)</i>	<i>Total BTEX (mg/kg)</i>	<i>GRO (mg/kg)</i>	<i>DRO (mg/kg)</i>
<i>NMOCD Action Level*</i>			<i>10</i>	<i>50</i>	<i>1,000</i>	
SC-1	5/29/14	0 to 5	NA	NA	<4.9	<9.9
SC-2	5/29/14	0 to 5	<0.035	0.86	12	79
SC-3	5/29/14	0 to 5	NA	NA	<4.8	<10
SC-4	5/29/14	0 to 5	<0.033	4.4	41	40
SC-5	5/29/14	5	NA	NA	<4.8	10

NA – not analyzed

*Action level determined by the NMOCD ranking score per *NMOCD Guidelines for Remediation of Leaks, Spills, and Releases* (August 1993)

3.0 Conclusions and Recommendations

On February 6, 2014, AES conducted an initial assessment of petroleum contaminated soils associated with a release of condensate at the Lawson #1A. Action levels for releases are determined by the NMOCD ranking score per *NMOCD Guidelines for Remediation of Leaks, Spills, and Releases* (August 1993), and the site was assigned a rank of 10.

Initial assessment field sampling results above the NMOCD action level of 100 ppm VOCs and 1,000 mg/kg TPH were reported in SB-1, SB-2, SB-3 and SB-6. The highest VOC concentration was reported in SB-6 with 3,063 ppm, and the highest TPH concentration was reported in SB-1 with 13,400 mg/kg.

On May 29, 2014, final clearance of the excavation area was completed. Field sampling results of the excavation extents showed that VOC concentrations were below applicable NMOCD action levels for the final walls and base of the excavation, except for SC-2 (south wall) and SC-4 (west wall), which had VOC concentrations of 274 and 1,802 ppm, respectively. Field TPH concentrations were below the applicable NMOCD action level of 1,000 mg/kg for the final walls and base of the excavation. Laboratory analytical results from May 29, 2014, reported benzene and total BTEX concentrations in SC-2 and SC-4 below NMOCD action levels, and TPH concentrations as GRO/DRO were reported below the applicable NMOCD action level in SC-1 through SC-5.

Based on final field sampling and laboratory analytical results of the excavation of petroleum contaminated soils at the Lawson #1A, VOCs, benzene, total BTEX, and TPH concentrations were below applicable NMOCD action levels for each of the sidewalls and base of the excavation. No further work is recommended.

If you have any questions about this report or site conditions, please do not hesitate to contact Deborah Watson at (505) 564-2281.

Sincerely,



Emilee Skyles
Staff Geologist

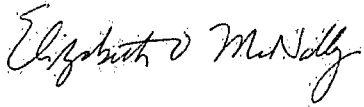

Elizabeth McNally, PE

Attachments:

- Figure 1. Topographic Site Location Map
- Figure 2. Aerial Site Map, February 2014
- Figure 3. Initial Assessment Sample Locations and Results, February 2014
- Figure 4. Final Excavation Sample Locations and Results, May 2014
- AES Field Sampling Report 020614
- AES Field Sampling Report 052914
- Hall Laboratory Analytical Report 1405C85
- Hall Laboratory Analytical Report 1405D01

SVRMAIN2\Shared\Animas 2000\Dropbox (Animas Environmental)\0000 Animas Server Dropbox
EM\2014 Projects\ConocoPhillips\Lawson #1A\Lawson #1A Release and Final Excavation Report
062814.docx

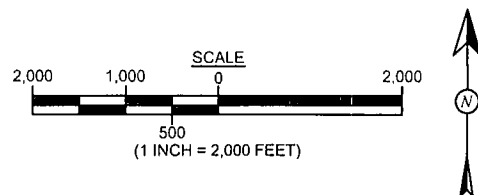
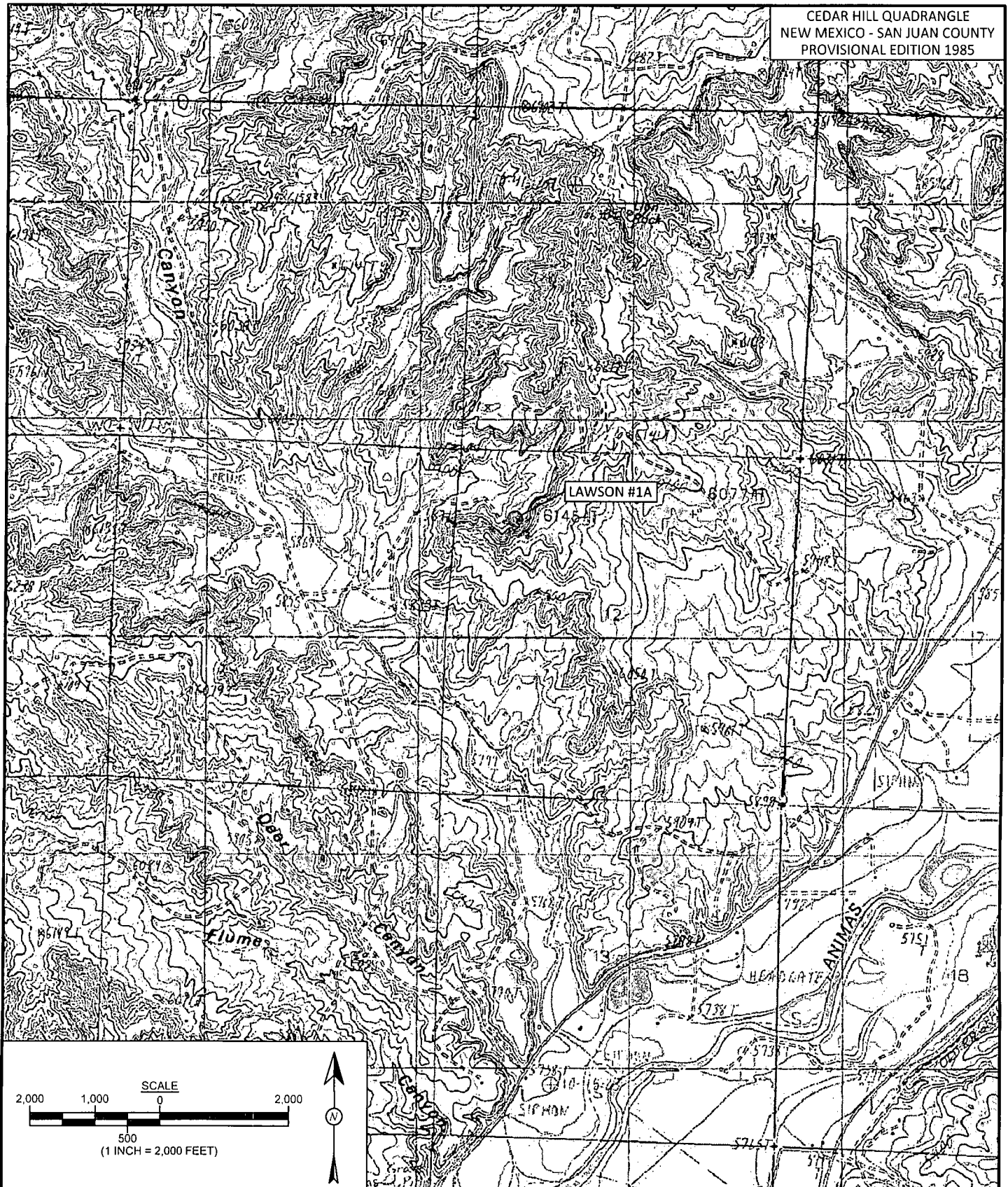

Animas Environmental Services, LLC

DRAWN BY:
C. Lameman

DATE DRAWN:
February 11, 2014

REVISIONS BY:
C. Lameman

DATE REVISED:
June 4, 2014

CHECKED BY:
D. Watson

DATE CHECKED:
June 4, 2014

APPROVED BY:
E. McNally

DATE APPROVED:
June 4, 2014

FIGURE 1

TOPOGRAPHIC SITE LOCATION MAP

ConocoPhillips
LAWSON #1A
NW¼ NW¼, SECTION 12, T31N, R11W
SAN JUAN COUNTY, NEW MEXICO
N36.91746, W107.94764

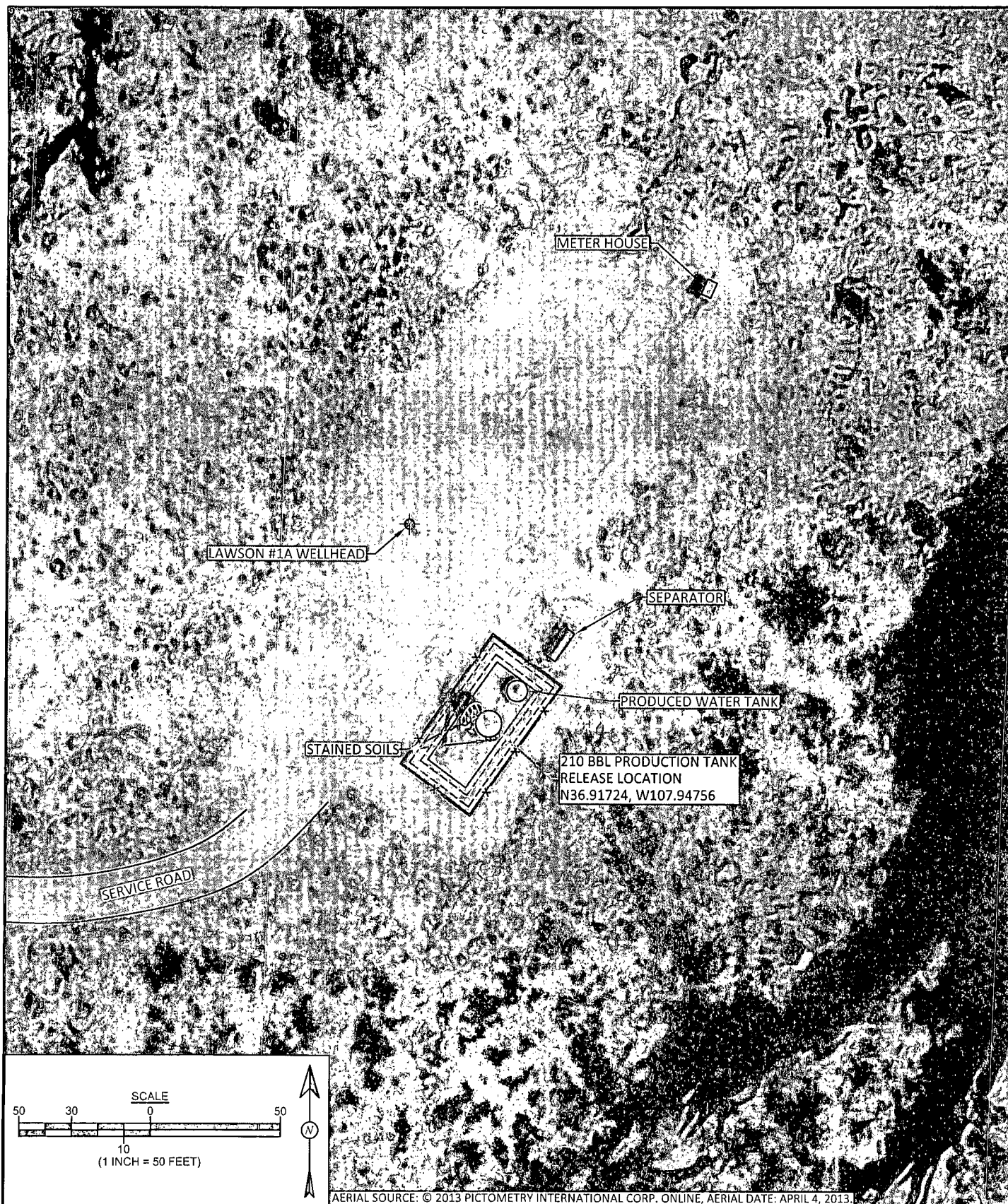

DRAWN BY: C. Lameman	DATE DRAWN: February 11, 2014
REVISIONS BY: C. Lameman	DATE REVISED: June 4, 2014
CHECKED BY: D. Watson	DATE CHECKED: June 4, 2014
APPROVED BY: E. McNally	DATE APPROVED: June 4, 2014

FIGURE 2

**AERIAL SITE MAP
FEBRUARY 2014**

ConocoPhillips
LAWSON #1A
NW¼ NW¼, SECTION 12, T31N, R11W
SAN JUAN COUNTY, NEW MEXICO
N36.91746, W107.94764

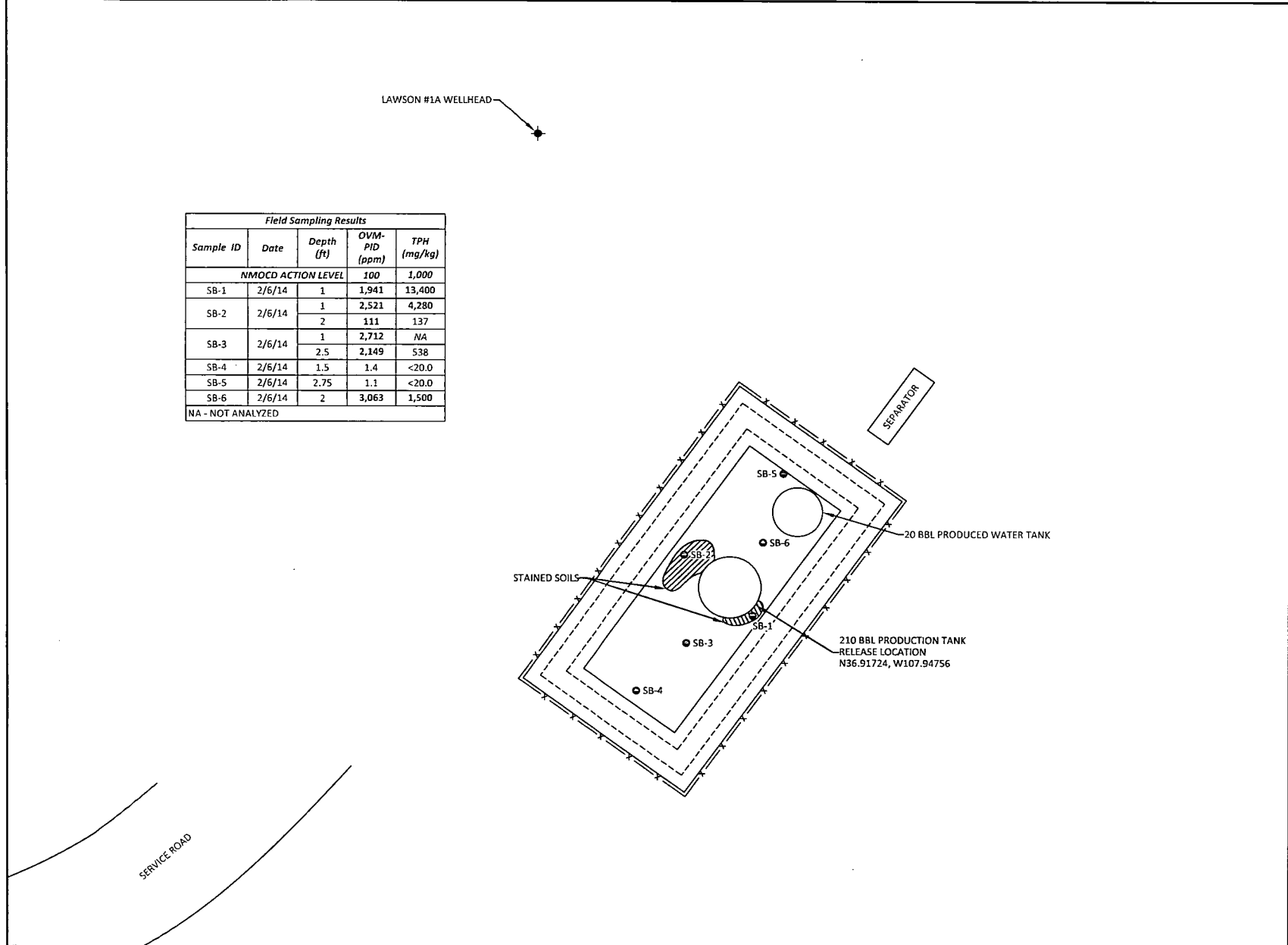

Field Sampling Results

Sample ID	Date	Depth (ft)	OVM-PID (ppm)	TPH (mg/kg)
NMOC ACTION LEVEL			100	1,000
SB-1	2/6/14	1	1,941	13,400
SB-2	2/6/14	1	2,521	4,280
		2	111	137
SB-3	2/6/14	1	2,712	NA
		2.5	2,149	538
SB-4	2/6/14	1.5	1.4	<20.0
SB-5	2/6/14	2.75	1.1	<20.0
SB-6	2/6/14	2	3,063	1,500

NA - NOT ANALYZED

FIGURE 3

INITIAL ASSESSMENT SAMPLE LOCATIONS AND RESULTS

FEBRUARY 2014

ConocoPhillips
LAWSON #1A

NW¼ NW¼, SECTION 12, T31N, R11W
SAN JUAN COUNTY, NEW MEXICO
N36.91746, W107.94764

AES

Animas Environmental Services, LLC

DRAWN BY: C. Lameman	DATE DRAWN: February 11, 2014
REVISIONS BY: C. Lameman	DATE REVISED: June 4, 2014
CHECKED BY: D. Watson	DATE CHECKED: June 4, 2014
APPROVED BY: E. McNally	DATE APPROVED: June 4, 2014

LEGEND

- SAMPLE LOCATIONS
- ===== SECONDARY CONTAINMENT BERM
- x— FENCE

SCALE

15 9 0 15

(1 INCH = 15 FEET)

LAWSON #1A WELLHEAD

Field Sampling Results				
Sample ID	Date	Depth (ft)	OVM-PID (ppm)	TPH (mg/kg)
NMOCD ACTION LEVEL			100	1,000
SC-1	5/29/14	1 to 5	1.1	38.1
SC-2	5/29/14	1 to 5	274	666
SC-3	5/29/14	1 to 5	7.8	36.8
SC-4	5/29/14	1 to 5	1,802	241
SC-5	5/29/14	5	81.7	144

ALL SAMPLES WERE COMPOSITE SAMPLES.

Laboratory Analytical Results						
Sample ID	Date	Depth (ft)	Benzene (mg/kg)	Total BTEX (mg/kg)	TPH - GRO (mg/kg)	TPH - DRO (mg/kg)
NMOCD ACTION LEVEL			10	50	1,000	
SC-1	5/29/14	1 to 5	NA	NA	<4.9	<9.9
SC-2	5/29/14	1 to 5	<0.035	0.86	12	79
SC-3	5/29/14	1 to 5	NA	NA	<4.8	<10
SC-4	5/29/14	1 to 5	<0.033	4.4	41	40
SC-5	5/29/14	5	NA	NA	<4.8	10

ALL SAMPLES WERE ANALYZED PER EPA METHOD 8021B AND/OR 8015D.

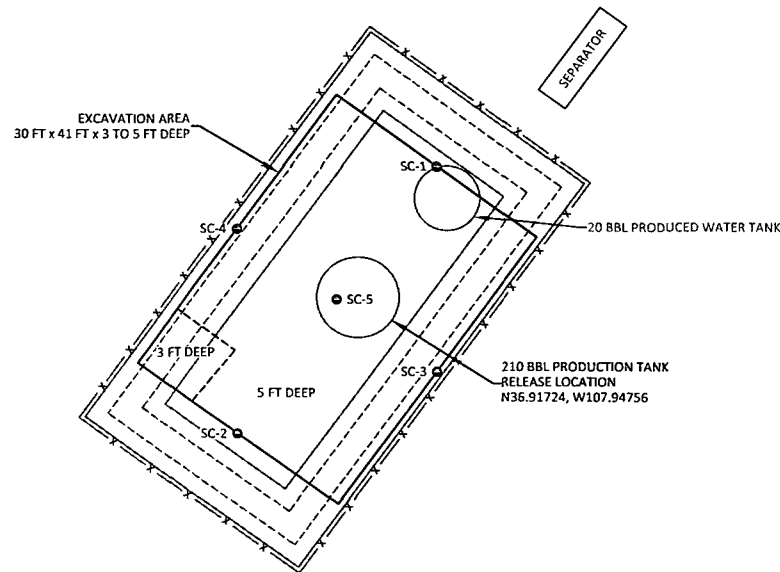

FIGURE 4

FINAL EXCAVATION SAMPLE
LOCATIONS AND RESULTS
MAY 2014
ConocoPhillips
LAWSON #1A
NW¼, NW¼, SECTION 12, T31N, R11W
SAN JUAN COUNTY, NEW MEXICO
N36.91746, W107.94764



Animas Environmental Services, LLC

DRAWN BY: C. Lameman	DATE DRAWN: June 4, 2014
REVISIONS BY: C. Lameman	DATE REVISED: June 4, 2014
CHECKED BY: D. Watson	DATE CHECKED: June 4, 2014
APPROVED BY: E. McNally	DATE APPROVED: June 4, 2014

LEGEND

- SAMPLE LOCATIONS
- ===== SECONDARY CONTAINMENT BERM
- x — FENCE

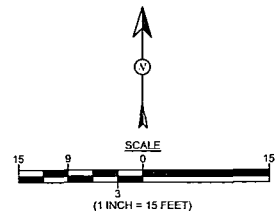

AES Field Sampling Report



Animas Environmental Services, LLC

www.animasenvironmental.com

Client: ConocoPhillips

Project Location: Lawson #1A

Date: 2/6/2014

Matrix: Soil

624 E. Comanche
Farmington, NM 87401
505-564-2281

Durango, Colorado
970-403-3084

Sample ID	Collection Date	Collection Time	OVM (ppm)	TPH* (mg/kg)	TPH Analysis Time	TPH PQL (mg/kg)	DF	TPH Analysts Initials
SB-1 @ 1'	2/6/2014	10:44	1,941	13,400	11:22	200	10	EMS
SB-2 @ 1'	2/6/2014	10:50	2,521	4,280	11:48	200	10	EMS
SB-2 @ 2'	2/6/2014	11:00	111	137	12:10	20.0	1	EMS
SB-3 @ 1'	2/6/2014	12:01	2,712	Not Analyzed for TPH.				
SB-3 @ 2.5'	2/6/2014	12:07	2,149	538	12:30	20.0	1	EMS
SB-4 @ 1.5'	2/6/2014	12:12	1.4	3.2	12:41	20.0	1	EMS
SB-5 @ 2.75'	2/6/2014	12:25	1.1	8.4	12:47	20.0	1	EMS
SB-6 @ 2'	2/6/2014	12:44	3,063	1,500	13:00	20.0	1	EMS

DF Dilution Factor

NA Not Analyzed

ND Not Detected at the Reporting Limit

PQL Practical Quantitation Limit

* TPH concentrations recorded may be below PQL.

Total Petroleum Hydrocarbons - USEPA 418.1

Analyst:

Erin Skelton

AES Field Sampling Report



Animas Environmental Services, LLC

www.animasenvironmental.com

624 E. Comanche
Farmington, NM 87401
505-564-2281

Durango, Colorado
970-403-3084

Client: ConocoPhillips

Project Location: Lawson #1A

Date: 5/29/2014

Matrix: Soil

Sample ID	Collection Date	Time of Sample Collection	Sample Location	OVM (ppm)	TPH Analysis Time	TPH* (mg/kg)	TPH PQL (mg/kg)	DF	TPH Analysts Initials
SC-1	5/29/2014	9:55	North Wall	1.1	10:34	38.1	20.0	1	EMS
SC-2	5/29/2014	9:43	South Wall	274	10:37	666	20.0	1	EMS
SC-3	5/29/2014	9:40	East Wall	7.8	10:39	36.8	20.0	1	EMS
SC-4	5/29/2014	9:47	West Wall	1,802	10:41	241	20.0	1	EMS
SC-5	5/29/2014	9:52	Base	81.7	10:44	144	20.0	1	EMS

DF Dilution Factor

NA Not Analyzed

ND Not Detected at the Reporting Limit

PQL Practical Quantitation Limit

*TPH concentrations recorded may be below PQL.

Total Petroleum Hydrocarbons - USEPA 418.1

Analyst: *Emil Syl*

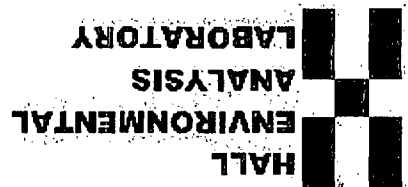

Hall Environmental Analysis Laboratory
4901 Hawkins NE
Albuquerque, NM 87109
TEL: 505-345-3975 FAX: 505-345-4107
Website: www.hallenvironmental.com

June 02, 2014

Debbie Watson

Animas Environmental
624 East Comanche

Farmington, NM 87401
TEL: (505) 486-4071

FAX

RE: COP Lawson 1A

OrderNo.: 1405C85

Dear Debbie Watson:

Hall Environmental Analysis Laboratory received 2 sample(s) on 5/30/2014 for the analyses presented in the following report.

These were analyzed according to EPA procedures or equivalent. To access our accredited tests please go to www.hallenvironmental.com or the state specific web sites. In order to properly interpret your results it is imperative that you review this report in its entirety. See the sample checklist and/or the Chain of Custody for information regarding the sample receipt temperature and preservation. Data qualifiers or a narrative will be provided if the sample analysis or analytical quality control parameters require a flag. When necessary, data qualifiers are provided on both the sample analysis report and the QC summary report, both sections should be reviewed. All samples are reported, as received, unless otherwise indicated. Lab measurement of analytes considered field parameters that require analysis within 15 minutes of sampling such as pH and residual chlorine are qualified as being analyzed outside of the recommended holding time.

Please don't hesitate to contact HEAL for any additional information or clarifications.

ADHS Cert #AZ0682 -- NMED-DWB Cert #NM9425 -- NMED-Micro Cert #NM0190

Sincerely,

A handwritten signature in black ink, appearing to read 'Andy Freeman'.

Andy Freeman

Laboratory Manager

4901 Hawkins NE

Albuquerque, NM 87109

Analytical Report

Lab Order 1405C85

Date Reported: 6/2/2014

Hall Environmental Analysis Laboratory, Inc.**CLIENT:** Animas Environmental**Client Sample ID:** SC-2**Project:** COP Lawson 1A**Collection Date:** 5/29/2014 9:43:00 AM**Lab ID:** 1405C85-001**Matrix:** MEOH (SOIL)**Received Date:** 5/30/2014 11:12:00 AM

Analyses	Result	RL	Qual	Units	DF	Date Analyzed	Batch
EPA METHOD 8021B: VOLATILES							Analyst: NSB
Benzene	ND	0.035		mg/Kg	1	5/30/2014 12:37:48 PM	R18953
Toluene	0.070	0.035		mg/Kg	1	5/30/2014 12:37:48 PM	R18953
Ethylbenzene	0.054	0.035		mg/Kg	1	5/30/2014 12:37:48 PM	R18953
Xylenes, Total	0.74	0.070		mg/Kg	1	5/30/2014 12:37:48 PM	R18953
Surr: 4-Bromofluorobenzene	116	80-120		%REC	1	5/30/2014 12:37:48 PM	R18953

Refer to the QC Summary report and sample login checklist for flagged QC data and preservation information.

Qualifiers:	*	Value exceeds Maximum Contaminant Level.	B	Analyte detected in the associated Method Blank
	E	Value above quantitation range	H	Holding times for preparation or analysis exceeded
	J	Analyte detected below quantitation limits	ND	Not Detected at the Reporting Limit
	O	RSD is greater than RSDlimit	P	Sample pH greater than 2.
	R	RPD outside accepted recovery limits	RL	Reporting Detection Limit
	S	Spike Recovery outside accepted recovery limits		

Hall Environmental Analysis Laboratory, Inc.

Analytical Report

Lab Order 1405C85

Date Reported: 6/2/2014

CLIENT: Animas Environmental

Client Sample ID: SC-4

Project: COP Lawson 1A

Collection Date: 5/29/2014 9:47:00 AM

Lab ID: 1405C85-002

Matrix: MEOH (SOIL)

Received Date: 5/30/2014 11:12:00 AM

Analyses	Result	RL	Qual	Units	DF	Date Analyzed	Batch
EPA METHOD 8021B: VOLATILES							Analyst: NSB
Benzene	ND	0.033		mg/Kg	1	5/30/2014 1:06:20 PM	R18953
Toluene	0.27	0.033		mg/Kg	1	5/30/2014 1:06:20 PM	R18953
Ethylbenzene	0.34	0.033		mg/Kg	1	5/30/2014 1:06:20 PM	R18953
Xylenes, Total	3.8	0.066		mg/Kg	1	5/30/2014 1:06:20 PM	R18953
Surr: 4-Bromofluorobenzene	145	80-120	S	%REC	1	5/30/2014 1:06:20 PM	R18953

Refer to the QC Summary report and sample login checklist for flagged QC data and preservation information.

Qualifiers:	*	Value exceeds Maximum Contaminant Level.	B	Analyte detected in the associated Method Blank
	E	Value above quantitation range	H	Holding times for preparation or analysis exceeded
	J	Analyte detected below quantitation limits	ND	Not Detected at the Reporting Limit
	O	RSD is greater than RSDlimit	P	Sample pH greater than 2.
	R	RPD outside accepted recovery limits	RL	Reporting Detection Limit
	S	Spike Recovery outside accepted recovery limits		

QC SUMMARY REPORT

Hall Environmental Analysis Laboratory, Inc.

WO#: 1405C85

02-Jun-14

Client: Animas Environmental

Project: COP Lawson 1A

Sample ID	MB-13425 MK		SampType:	MBLK		TestCode:	EPA Method 8021B: Volatiles			
Client ID:	PBS		Batch ID:	R18953		RunNo:	18953			
Prep Date:			Analysis Date:	5/30/2014		SeqNo:	547848		Units: mg/Kg	
Analyte	Result	PQL	SPK value	SPK Ref Val	%REC	LowLimit	HighLimit	%RPD	RPDLimit	Qual
Benzene	ND	0.050								
Toluene	ND	0.050								
Ethylbenzene	ND	0.050								
Xylenes, Total	ND	0.10								
Surr: 4-Bromofluorobenzene	1.0		1.000		101	80	120			

Sample ID	LCS-13425 MK		SampType:	LCS		TestCode:	EPA Method 8021B: Volatiles			
Client ID:	LCSS		Batch ID:	R18953		RunNo:	18953			
Prep Date:			Analysis Date:	5/30/2014		SeqNo:	547849		Units: mg/Kg	
Analyte	Result	PQL	SPK value	SPK Ref Val	%REC	LowLimit	HighLimit	%RPD	RPDLimit	Qual
Benzene	1.1	0.050	1.000	0	114	80	120			
Toluene	1.1	0.050	1.000	0	106	80	120			
Ethylbenzene	1.1	0.050	1.000	0	105	80	120			
Xylenes, Total	3.1	0.10	3.000	0	103	80	120			
Surr: 4-Bromofluorobenzene	1.1		1.000		114	80	120			

Qualifiers:

* Value exceeds Maximum Contaminant Level.
E Value above quantitation range
J Analyte detected below quantitation limits
O RSD is greater than RSDlimit
R RPD outside accepted recovery limits
S Spike Recovery outside accepted recovery limits

B Analyte detected in the associated Method Blank
H Holding times for preparation or analysis exceeded
ND Not Detected at the Reporting Limit
P Sample pH greater than 2.
RL Reporting Detection Limit

Sample Log-In Check List

Client Name: Animas Environmental

Work Order Number: 1405C85

RcptNo: 1

Received by/date:

C.S.

05/30/14

Logged By: Ashley Gallegos

5/30/2014 11:12:00 AM

Ag

Completed By: Ashley Gallegos

5/30/2014 11:23:27 AM

Ag

Reviewed By:

Ag

05/30/14

Chain of Custody

1. Custody seals intact on sample bottles? Yes ☐ No ☐ Not Present ☒
2. Is Chain of Custody complete? Yes ☒ No ☐ Not Present ☐
3. How was the sample delivered? Courier

Log In

4. Was an attempt made to cool the samples? Yes ☒ No ☐ NA ☐
5. Were all samples received at a temperature of $>0^{\circ}\text{C}$ to 6.0°C ? Yes ☒ No ☐ NA ☐
6. Sample(s) in proper container(s)? Yes ☒ No ☐
7. Sufficient sample volume for indicated test(s)? Yes ☒ No ☐
8. Are samples (except VOA and ONG) properly preserved? Yes ☒ No ☐
9. Was preservative added to bottles? Yes ☐ No ☒ NA ☐
10. VOA vials have zero headspace? Yes ☐ No ☐ No VOA Vials ☒
11. Were any sample containers received broken? Yes ☐ No ☒
12. Does paperwork match bottle labels?
(Note discrepancies on chain of custody) Yes ☒ No ☐
13. Are matrices correctly identified on Chain of Custody? Yes ☒ No ☐
14. Is it clear what analyses were requested? Yes ☒ No ☐
15. Were all holding times able to be met?
(If no, notify customer for authorization.) Yes ☒ No ☐
- # of preserved bottles checked for pH:
(<2 or >12 unless noted)
- Adjusted?
- Checked by:

Special Handling (If applicable)

16. Was client notified of all discrepancies with this order? Yes ☐ No ☐ NA ☒

Person Notified:

Date:

By Whom:

Via:

☐ eMail

☐ Phone

☐ Fax

☐ In Person

Regarding:

Client Instructions:

17. Additional remarks:

18. Cooler Information

Cooler No	Temp. $^{\circ}\text{C}$	Condition	Seal Intact	Seal No	Seal Date	Signed By
1	2.1	Good	Yes			

Chain-of-Custody Record		Turn-Around Time:
Client: Animas Environmental Services, LLC	<input type="checkbox"/> Standard	<input checked="" type="checkbox"/> Rush <u>SAME DAY</u>
Mailing Address: 624 E. Comanche	Project Name: C.P. LAWSON 1A	
FARMINGTON, NM 87401	Project #:	
Phone #: 505-564-2281	Project Manager: D. WATSON	
email or Fax#:	Sampler: E. Skyles	
QA/QC Package:	On Ice: <input checked="" type="checkbox"/> Yes <input type="checkbox"/> No	
<input checked="" type="checkbox"/> Standard <input type="checkbox"/> Level 4 (Full Validation)	Sample Temperature: 27°	
Accreditation		
<input type="checkbox"/> NELAP <input type="checkbox"/> Other _____		
<input type="checkbox"/> EDD (Type) _____		

☐ Standard

☒ Rush, SAME DAY

Project Name:

C.P. LAWSON 1A

Project #:

Project Manager:

D. WATSON

Sampler: E. Sky & S

On Ice ☒ Yes ☐ No

Sample Temperature 27°C

[illegible]

Date:	Time:	Relinquished by:
5/29/14	1724	SLSHL

Received by: Christine White Date 5/29/14 Time 1724

Date:	Time:	Relinquished by:
5/29/14	1747	Christine Walker

Received by: Celine Sima Date/Time 05/30/14 11:12

Remarks: Bill to Conaco Phillips
WD: 20032899 SUPER: Mike Smith
Area: 2 USER: KGARCIA
Act. Code: D150 Ordered by: Eric Smith

If necessary, samples submitted to Hail Environmental may be subcontracted to other accredited laboratories. This serves as notice of this possibility. Any sub-contracted data will be ly notated on the analytical report.

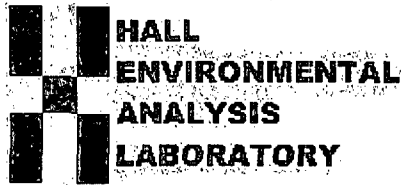

Hall Environmental Analysis Laboratory
4901 Hawkins NE
Albuquerque, NM 87109
TEL: 505-345-3975 FAX: 505-345-4107
Website: www.hallenvironmental.com

June 04, 2014

Debbie Watson
Animas Environmental
624 East Comanche
Farmington, NM 87401
TEL: (505) 486-4071
FAX

RE: CoP Lawson 1A

OrderNo.: 1405D01

Dear Debbie Watson:

Hall Environmental Analysis Laboratory received 5 sample(s) on 5/30/2014 for the analyses presented in the following report.

These were analyzed according to EPA procedures or equivalent. To access our accredited tests please go to www.hallenvironmental.com or the state specific web sites. In order to properly interpret your results it is imperative that you review this report in its entirety. See the sample checklist and/or the Chain of Custody for information regarding the sample receipt temperature and preservation. Data qualifiers or a narrative will be provided if the sample analysis or analytical quality control parameters require a flag. When necessary, data qualifiers are provided on both the sample analysis report and the QC summary report, both sections should be reviewed. All samples are reported, as received, unless otherwise indicated. Lab measurement of analytes considered field parameters that require analysis within 15 minutes of sampling such as pH and residual chlorine are qualified as being analyzed outside of the recommended holding time.

Please don't hesitate to contact HEAL for any additional information or clarifications.

ADHS Cert #AZ0682 -- NMED-DWB Cert #NM9425 -- NMED-Micro Cert #NM0190

Sincerely,

A handwritten signature in black ink, appearing to read "Andy Freeman", with a stylized flourish at the end.

Andy Freeman
Laboratory Manager
4901 Hawkins NE
Albuquerque, NM 87109

Hall Environmental Analysis Laboratory, Inc.

Analytical Report

Lab Order 1405D01

Date Reported: 6/4/2014

CLIENT: Animas Environmental

Client Sample ID: SC-1

Project: CoP Lawson 1A

Collection Date: 5/29/2014 9:55:00 AM

Lab ID: 1405D01-001

Matrix: SOIL

Received Date: 5/30/2014 11:12:00 AM

Analyses	Result	RL	Qual	Units	DF	Date Analyzed	Batch
EPA METHOD 8015D: DIESEL RANGE ORGANICS							Analyst: BCN
Diesel Range Organics (DRO)	ND	9.9		mg/Kg	1	6/3/2014 3:44:16 PM	13463
Surr: DNOP	93.1	57.9-140		%REC	1	6/3/2014 3:44:16 PM	13463
EPA METHOD 8015D: GASOLINE RANGE							Analyst: NSB
Gasoline Range Organics (GRO)	ND	4.9		mg/Kg	1	6/2/2014 1:20:03 PM	13451
Surr: BFB	84.5	80-120		%REC	1	6/2/2014 1:20:03 PM	13451

Refer to the QC Summary report and sample login checklist for flagged QC data and preservation information.

Qualifiers:	*	Value exceeds Maximum Contaminant Level.	B	Analyte detected in the associated Method Blank
	E	Value above quantitation range	H	Holding times for preparation or analysis exceeded
	J	Analyte detected below quantitation limits	ND	Not Detected at the Reporting Limit
	O	RSD is greater than RSDlimit	P	Sample pH greater than 2.
	R	RPD outside accepted recovery limits	RL	Reporting Detection Limit
	S	Spike Recovery outside accepted recovery limits		

Hall Environmental Analysis Laboratory, Inc.

Analytical Report

Lab Order 1405D01

Date Reported: 6/4/2014

CLIENT: Animas Environmental

Client Sample ID: SC-2

Project: CoP Lawson 1A

Collection Date: 5/29/2014 9:43:00 AM

Lab ID: 1405D01-002

Matrix: SOIL

Received Date: 5/30/2014 11:12:00 AM

Analyses	Result	RL	Qual	Units	DF	Date Analyzed	Batch
EPA METHOD 8015D: DIESEL RANGE ORGANICS							Analyst: BCN
Diesel Range Organics (DRO)	79	9.9		mg/Kg	1	6/3/2014 4:07:06 PM	13463
Surr: DNOP	99.4	57.9-140		%REC	1	6/3/2014 4:07:06 PM	13463
EPA METHOD 8015D: GASOLINE RANGE							Analyst: NSB
Gasoline Range Organics (GRO)	12	4.7		mg/Kg	1	6/2/2014 7:03:31 PM	13451
Surr: BFB	155	80-120	S	%REC	1	6/2/2014 7:03:31 PM	13451

Refer to the QC Summary report and sample login checklist for flagged QC data and preservation information.

Qualifiers:	*	Value exceeds Maximum Contaminant Level.	B	Analyte detected in the associated Method Blank
	E	Value above quantitation range	H	Holding times for preparation or analysis exceeded
	J	Analyte detected below quantitation limits	ND	Not Detected at the Reporting Limit
	O	RSD is greater than RSDlimit	P	Sample pH greater than 2.
	R	RPD outside accepted recovery limits	RL	Reporting Detection Limit
	S	Spike Recovery outside accepted recovery limits		

Hall Environmental Analysis Laboratory, Inc.

Analytical Report

Lab Order **1405D01**

Date Reported: **6/4/2014**

CLIENT: Animas Environmental

Client Sample ID: SC-3

Project: CoP Lawson 1A

Collection Date: 5/29/2014 9:40:00 AM

Lab ID: 1405D01-003

Matrix: SOIL

Received Date: 5/30/2014 11:12:00 AM

Analyses	Result	RL	Qual	Units	DF	Date Analyzed	Batch
EPA METHOD 8015D: DIESEL RANGE ORGANICS							Analyst: BCN
Diesel Range Organics (DRO)	ND	10		mg/Kg	1	6/3/2014 4:30:14 PM	13463
Surr: DNOP	91.3	57.9-140		%REC	1	6/3/2014 4:30:14 PM	13463
EPA METHOD 8015D: GASOLINE RANGE							Analyst: NSB
Gasoline Range Organics (GRO)	ND	4.8		mg/Kg	1	6/2/2014 2:45:56 PM	13451
Surr: BFB	85.3	80-120		%REC	1	6/2/2014 2:45:56 PM	13451

Refer to the QC Summary report and sample login checklist for flagged QC data and preservation information.

Qualifiers:	*	Value exceeds Maximum Contaminant Level.	B	Analyte detected in the associated Method Blank
	E	Value above quantitation range	H	Holding times for preparation or analysis exceeded
	J	Analyte detected below quantitation limits	ND	Not Detected at the Reporting Limit
	O	RSD is greater than RSDlimit	P	Sample pH greater than 2.
	R	RPD outside accepted recovery limits	RL	Reporting Detection Limit
	S	Spike Recovery outside accepted recovery limits		

Hall Environmental Analysis Laboratory, Inc.

Analytical Report

Lab Order 1405D01

Date Reported: 6/4/2014

CLIENT: Animas Environmental

Client Sample ID: SC-4

Project: CoP Lawson IA

Collection Date: 5/29/2014 9:47:00 AM

Lab ID: 1405D01-004

Matrix: SOIL

Received Date: 5/30/2014 11:12:00 AM

Analyses	Result	RL	Qual	Units	DF	Date Analyzed	Batch
EPA METHOD 8015D: DIESEL RANGE ORGANICS							Analyst: BCN
Diesel Range Organics (DRO)	40	10		mg/Kg	1	6/3/2014 4:53:27 PM	13463
Surr: DNOP	85.2	57.9-140		%REC	1	6/3/2014 4:53:27 PM	13463
EPA METHOD 8015D: GASOLINE RANGE							Analyst: NSB
Gasoline Range Organics (GRO)	41	4.8		mg/Kg	1	6/2/2014 3:14:35 PM	13451
Surr: BFB	234	80-120	S	%REC	1	6/2/2014 3:14:35 PM	13451

Refer to the QC Summary report and sample login checklist for flagged QC data and preservation information.

Qualifiers:	*	Value exceeds Maximum Contaminant Level.	B	Analyte detected in the associated Method Blank
	E	Value above quantitation range	H	Holding times for preparation or analysis exceeded
	J	Analyte detected below quantitation limits	ND	Not Detected at the Reporting Limit
	O	RSD is greater than RSDlimit	P	Sample pH greater than 2.
	R	RPD outside accepted recovery limits	RL	Reporting Detection Limit
	S	Spike Recovery outside accepted recovery limits		

Hall Environmental Analysis Laboratory, Inc.

Analytical Report

Lab Order 1405D01

Date Reported: 6/4/2014

CLIENT: Animas Environmental

Client Sample ID: SC-5

Project: CoP Lawson 1A

Collection Date: 5/29/2014 9:52:00 AM

Lab ID: 1405D01-005

Matrix: SOIL

Received Date: 5/30/2014 11:12:00 AM

Analyses	Result	RL	Qual	Units	DF	Date Analyzed	Batch
EPA METHOD 8015D: DIESEL RANGE ORGANICS							Analyst: BCN
Diesel Range Organics (DRO)	10	10		mg/Kg	1	6/3/2014 5:16:34 PM	13463
Surr: DNOP	83.5	57.9-140		%REC	1	6/3/2014 5:16:34 PM	13463
EPA METHOD 8015D: GASOLINE RANGE							Analyst: NSB
Gasoline Range Organics (GRO)	ND	4.8		mg/Kg	1	6/2/2014 7:32:03 PM	13451
Surr: BFB	106	80-120		%REC	1	6/2/2014 7:32:03 PM	13451

Refer to the QC Summary report and sample login checklist for flagged QC data and preservation information.

Qualifiers:

- * Value exceeds Maximum Contaminant Level.
- E Value above quantitation range
- J Analyte detected below quantitation limits
- O RSD is greater than RSDlimit
- R RPD outside accepted recovery limits
- S Spike Recovery outside accepted recovery limits

- B Analyte detected in the associated Method Blank
- H Holding times for preparation or analysis exceeded
- ND Not Detected at the Reporting Limit
- P Sample pH greater than 2.
- RL Reporting Detection Limit

QC SUMMARY REPORT

Hall Environmental Analysis Laboratory, Inc.

WO#: 1405D01

04-Jun-14

Client: Animas Environmental

Project: CoP Lawson IA

Sample ID	MB-13451	SampType:	MBLK	TestCode:	EPA Method 8015D: Gasoline Range					
Client ID:	PBS	Batch ID:	13451	RunNo:	18991					
Prep Date:	5/30/2014	Analysis Date:	6/2/2014	SeqNo:	548681	Units:	mg/Kg			
Analyte	Result	PQL	SPK value	SPK Ref Val	%REC	LowLimit	HighLimit	%RPD	RPDLimit	Qual
Gasoline Range Organics (GRO)	ND	5.0								
Surr: BFB	850		1000		84.6	80	120			

Sample ID	LCS-13451	SampType:	LCS	TestCode:	EPA Method 8015D: Gasoline Range					
Client ID:	LCSS	Batch ID:	13451	RunNo:	18991					
Prep Date:	5/30/2014	Analysis Date:	6/2/2014	SeqNo:	548682	Units:	mg/Kg			
Analyte	Result	PQL	SPK value	SPK Ref Val	%REC	LowLimit	HighLimit	%RPD	RPDLimit	Qual
Gasoline Range Organics (GRO)	24	5.0	25.00	0	97.4	71.7	134			
Surr: BFB	930		1000		93.2	80	120			

Sample ID	1405D01-001AMS	SampType:	MS	TestCode:	EPA Method 8015D: Gasoline Range					
Client ID:	SC-1	Batch ID:	13451	RunNo:	18991					
Prep Date:	5/30/2014	Analysis Date:	6/2/2014	SeqNo:	548721	Units:	mg/Kg			
Analyte	Result	PQL	SPK value	SPK Ref Val	%REC	LowLimit	HighLimit	%RPD	RPDLimit	Qual
Gasoline Range Organics (GRO)	23	4.9	24.37	0	92.7	69.5	145			
Surr: BFB	900		974.7		92.6	80	120			

Sample ID	1405D01-001AMSD	SampType:	MSD	TestCode:	EPA Method 8015D: Gasoline Range					
Client ID:	SC-1	Batch ID:	13451	RunNo:	18991					
Prep Date:	5/30/2014	Analysis Date:	6/2/2014	SeqNo:	548723	Units:	mg/Kg			
Analyte	Result	PQL	SPK value	SPK Ref Val	%REC	LowLimit	HighLimit	%RPD	RPDLimit	Qual
Gasoline Range Organics (GRO)	23	4.8	24.20	0	93.6	69.5	145	0.307	20	
Surr: BFB	900		968.1		93.5	80	120	0	0	

Qualifiers:

- | | |
|---|--|
| * Value exceeds Maximum Contaminant Level. | B Analyte detected in the associated Method Blank |
| E Value above quantitation range | H Holding times for preparation or analysis exceeded |
| J Analyte detected below quantitation limits | ND Not Detected at the Reporting Limit |
| O RSD is greater than RSDlimit | P Sample pH greater than 2. |
| R RPD outside accepted recovery limits | RL Reporting Detection Limit |
| S Spike Recovery outside accepted recovery limits | |

Sample Log-In Check List

Client Name: Animas Environmental

Work Order Number: 1405D01

RcptNo: 1

Received by/date: CS 05/30/14

Logged By: **Lindsay Mangin** 5/30/2014 11:12:00 AM *[Signature]*

Completed By: **Lindsay Mangin** 5/30/2014 1:34:07 PM *[Signature]*

Reviewed By: *[Signature]* CS 05/30/14

Chain of Custody

1. Custody seals intact on sample bottles? Yes ☐ No ☐ Not Present ☒
2. Is Chain of Custody complete? Yes ☒ No ☐ Not Present ☐
3. How was the sample delivered? Client

Log In

4. Was an attempt made to cool the samples? Yes ☒ No ☐ NA ☐
5. Were all samples received at a temperature of >0° C to 6.0°C Yes ☒ No ☐ NA ☐
6. Sample(s) in proper container(s)? Yes ☒ No ☐
7. Sufficient sample volume for indicated test(s)? Yes ☒ No ☐
8. Are samples (except VOA and ONG) properly preserved? Yes ☒ No ☐
9. Was preservative added to bottles? Yes ☐ No ☒ NA ☐
10. VOA vials have zero headspace? Yes ☐ No ☐ No VOA Vials ☒
11. Were any sample containers received broken? Yes ☐ No ☒
12. Does paperwork match bottle labels?
(Note discrepancies on chain of custody) Yes ☒ No ☐
13. Are matrices correctly identified on Chain of Custody? Yes ☒ No ☐
14. Is it clear what analyses were requested? Yes ☒ No ☐
15. Were all holding times able to be met?
(If no, notify customer for authorization.) Yes ☒ No ☐

of preserved
bottles checked
for pH: _____
(<2 or >12 unless noted)
Adjusted? _____
Checked by: _____

Special Handling (If applicable)

16. Was client notified of all discrepancies with this order? Yes ☐ No ☐ NA ☒

Person Notified:	_____	Date:	_____
By Whom:	_____	Via:	<input type="checkbox"/> eMail <input type="checkbox"/> Phone <input type="checkbox"/> Fax <input type="checkbox"/> In Person
Regarding:	_____		
Client Instructions:	_____		

17. Additional remarks:

18. Cooler Information

Cooler No	Temp °C	Condition	Seal Intact	Seal No	Seal Date	Signed By
1	2.1	Good	Not Present			

Multi-Around Time:

☒ Standard ☐ Rush

Project #:

Project Manager:
D. WATSON

On Ice: ☒ Yes ☐ No

Container Type and #	Preservative Type
-------------------------	----------------------

1-402.	Geo
--------	-----

1-407.	call
--------	------

1-407	1-407
-------	-------

1-407.	Coal
--------	------

1-407E.	Coal
---------	------

[illegible]

--	--

--	--

[illegible]

--	--

--	--

--	--

Received by:

Received by: Muster

Received by: _____

Contracted to other accredited

www.hallenvironmental.com

Tel. 505-345-3975 Fax 505-345-4107

Analysis Request

BTEX + MTBE + TMB's (8021)

BTEX + MTBE + TPH (Gas only)

TPH 8015B (GRO / DRO / ~~WRC~~)

TPH (Method 418.1)

EDB (Method 504.1)

PAH's (8310 or 8270 SIMS)

RCRA 8 Metals

Anions (F, Cl, NO₃, NO₂, PO₄, SO₄)

8081 Pesticides / 8082 PCB's

8260B (VOA)

8270 (Semi-VOA)

Air Bubbles (Y or N)

Date:	Time:	Relinquished by:
12/29/14	1724	Sgt. S. L.

Date:	Time:	Relinquished by:
9/14	1747	Christie W. Jones

Remarks: Bill to ConocoPhillips

WD: 20032899 SUPER: Mike Smith
AREA: 2 USER: KGARCIA
ACT. CODE: D150 ORDERED BY: ERIC SMITH

If necessary, samples submitted to Hall Environmental may be subcontracted to other accredited laboratories. This serves as notice of this possibility. Any sub-contracted data will be clearly notated on the analytical report.