

**UNITED STATES
DEPARTMENT OF THE INTERIOR
BUREAU OF LAND MANAGEMENT**

APPLICATION FOR PERMIT TO DRILL, DEEPEN, OR PLUG BACK

1a. TYPE OF WORK **DRILL** ☒ **DEEPEN** ☐

1b. TYPE OF WELL

OIL ☐
WELL

GAS ☒
WELL

OTHER ☐

SINGLE ☒
ZONE

MULTIPLE ☐
ZONE

2. NAME OF OPERATOR

Burlington Resources Oil & Gas, LP

3. ADDRESS OF OPERATOR *Williams Exploration & Production Co.*

P.O. Box 316 - Ignacio, CO 81137 - (970) 563-3308

4. LOCATION OF WELL (Report location clearly and in accordance with any State requirements.)*

At Surface *2500' FNL and 2600' FWL*

At proposed Prod. Zone

From 2445' FNL & 2440' FWL to 2065' FNL & 140' FWL

14. DISTANCE IN MILES AND DIRECTION FROM NEAREST TOWN OR POST OFFICE*

20 miles SE of Blanco, NM

15. DISTANCE FROM PROPOSED* LOCATION TO NEAREST PROPERTY OR LEASE LINE, FT. (Also to nearest drlg. unit line, if any)

140

16. NO. OF ACRES IN LEASE

2080.00

17. NO. OF ACRES ASSIGNED TO THIS WELL

320 W/2

18. DISTANCE FROM PROPOSED LOCATION* TO NEAREST WELL, DRILLING, COMPLETED, OR APPLIED FOR ON THIS LEASE, FT.

735'

19. PROPOSED DEPTH

5394' (measured depth)

20. ROTARY OR CABLE TOOLS

Rotary

21. ELEVATIONS (Show whether DF, RT, GR, etc.)

6326'

22. APPROX. DATE WORK WILL START*

January 1, 2005

23. PROPOSED CASING AND CEMENTING PROGRAM

SIZE OF HOLE	SIZE OF CASING	WEIGHT/FOOT	SETTING DEPTH	QUANTITY OF CEMENT
<i>12-1/4"</i>	<i>9-5/8"</i>	<i>36.0#</i>	<i>+/- 300'</i>	<i>~206 cu.ft. Type III with 2% CaCl₂</i>
<i>8-3/4"</i>	<i>7"</i>	<i>20.0#</i>	<i>+/- 3357'</i>	<i>~731 cu.ft. 65/35 poz & ~139 cu.ft. Type III</i>
<i>6-1/4"</i>	<i>4-1/2" perf</i>	<i>10.5#</i>	<i>+/- 3000' - 5364'</i>	<i>no cement liner Open hole completion - no cement</i>

Williams Production Company, as an agent for Burlington Resources, proposes to drill a horizontal well to develop the Fruitland Coal formation at the above described location in accordance with the attached drilling and surface use plans. After drilling and completion will be produced and operated by Burlington Resources.

This location has been archaeologically surveyed by LaPlata Archaeological Consultants. Copies of their report have been submitted directly to your office.

This well will require approximately 150 ft of new road.

IN ABOVE SPACE DESCRIBE PROPOSED PROGRAM: If proposal is to deepen or plug back, give data on present productive zone and proposed new productive zone. If proposal is to drill or deepen directionally, give pertinent data on subsurface locations and measured and true vertical depths. Give blowout preventer program, if any.

24.

SIGNED

Larry Higgins

TITLE *Larry Higgins, Agent*

DATE

11/29/2004

(This space for Federal or State office use)

PERMIT NO.

APPROVAL DATE

Application approval does not warrant or certify that the applicant holds legal or equitable title to those rights in the subject lease which would entitle the applicant to conduct operations thereon.

CONDITIONS OF APPROVAL, IF ANY:

APPROVED BY

[Signature]

TITLE

AFM

DATE

10/19/05

***See Instructions On Reverse Side**

Title 18 U.S.C. Section 1001, makes it a crime for any person knowingly and willfully to make to any department or agency of the United States any false, fictitious or fraudulent statements or representations as to any matter within its jurisdiction.

DRILLING OPERATIONS AUTHORIZED ARE
SUBJECT TO COMPLIANCE WITH ATTACHED
"GENERAL REQUIREMENTS".

NMOCD

This action is subject to technical and
procedural review pursuant to 43 CFR 3165.3
and appeal pursuant to 43 CFR 3165.4

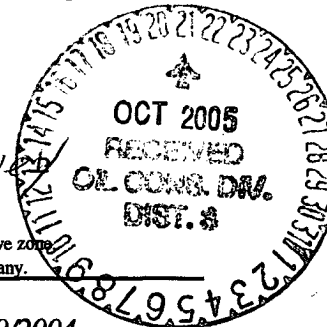

HOLD FOR Directional Survey

District II
PC Drawer DD, Artesia, NM 88211-0719

OIL CONSERVATION DIVISION
PO Box 2088
Santa Fe, NM 87504-2088

District III
1000 Rio Brazos Rd., Aztec, NM 87410

District IV
PO Box 2068, Santa Fe, NM 87504-2086

☐ AMENDED REPORT

WELL LOCATION AND ACREAGE DEDICATION PLAT

'API Number 30-039-29368	'Pool Code 71629	'Pool Name BASIN FRUITLAND COAL
'Property Code 7465	'Property Name SAN JUAN 29-7 UNIT	'Well Number 565S
'OGRID No. 14538	'Operator Name BURLINGTON RESOURCES OIL & GAS COMPANY, LP	'Elevation 5326'

¹⁰ Surface Location

U. or lot no.	Section	Township	Range	Lot	Feet from the	North/South line	Feet from the	East/West line	County
F	25	29N	7W		2500	NORTH	2600	WEST	RIO ARriba

¹⁴ Bottom Hole Location If Different From Surface

U. S. lot no.	Section	Township	Range	Lot 1 or 2	Feet from the	North/South line	Feet from the	East/West line	County
E	25	29N	7W		2065	NORTH	140	WEST	RIO ARriba

12 Dedicated Acres	13 Joint or Infill	14 Consolidation Acres	15 Order No.
320.0 Acres - (W/2)			

NO ALLOWABLE WILL BE ASSIGNED TO THIS COMPLETION UNTIL ALL INTERESTS HAVE BEEN CONSOLIDATED
OR A NON-STANDARD UNIT HAS BEEN APPROVED BY THE DIVISION

Submit 3 Copies To Appropriate District Office
District I
1625 N. French Dr., Hobbs, NM 88240
District II
1301 W. Grand Ave., Artesia, NM 88210
District III
1000 Rio Brazos Rd., Aztec, NM 87410
District IV
1220 S. St. Francis Dr., Santa Fe, NM 87505

State of New Mexico
Energy, Minerals and Natural Resources

Form C-103
May 27, 2004

OIL CONSERVATION DIVISION
1220 South St. Francis Dr.
Santa Fe, NM 87505

WELL API NO. <u>30-039-29368</u>	
5. Indicate Type of Lease FEDERAL <input checked="" type="checkbox"/> STATE <input type="checkbox"/> FEE <input type="checkbox"/>	
6. State Oil & Gas Lease No. Federal NMSF-0078425	
7. Lease Name or Unit Agreement Name San Juan 29-7 Unit	
8. Well Number	565S
9. OGRID Number	14538
10. Pool name or Wildcat Basin Fruitland Coal	

11. Elevation (Show whether DR, RKB, RT, GR, etc.)
6,326' GR

Pit or Below-grade Tank Application ☒ or Closure ☐

Pit type production Depth to Groundwater >100' Distance from nearest fresh water well >1,000' Distance from nearest surface water >1,000'

Pit Liner Thickness: 12 mil Below-Grade Tank: Volume _____ bbls; Construction Material _____

SUNDRY NOTICES AND REPORTS ON WELLS
(DO NOT USE THIS FORM FOR PROPOSALS TO DRILL OR TO DEEPEEN OR PLUG BACK TO A DIFFERENT RESERVOIR. USE "APPLICATION FOR PERMIT" (FORM C-101) FOR SUCH PROPOSALS.)

1. Type of Well: Oil Well ☐ Gas Well ☒ Other ☐

2. Name of Operator
Burlington Resources Oil and Gas Company

3. Address of Operator
C/O Williams Exploration and Production Co., P.O. Box 316, Ignacio, CO 81137

4. Well Location
Unit Letter F: 2500 feet from the north line and 2600 feet from the west line
Section 26 Township 29N Range 7W NMPM County Rio Arriba

12. Check Appropriate Box to Indicate Nature of Notice, Report or Other Data

NOTICE OF INTENTION TO:		SUBSEQUENT REPORT OF:	
PERFORM REMEDIAL WORK <input type="checkbox"/>	PLUG AND ABANDON <input type="checkbox"/>	REMEDIAL WORK <input type="checkbox"/>	ALTERING CASING <input type="checkbox"/>
TEMPORARILY ABANDON <input type="checkbox"/>	CHANGE PLANS <input type="checkbox"/>	COMMENCE DRILLING OPNS. <input type="checkbox"/>	P AND A <input type="checkbox"/>
PULL OR ALTER CASING <input type="checkbox"/>	MULTIPLE COMPL <input type="checkbox"/>	CASING/CEMENT JOB <input type="checkbox"/>	
OTHER: <input type="checkbox"/>		OTHER: <input type="checkbox"/>	

13. Describe proposed or completed operations. (Clearly state all pertinent details, and give pertinent dates, including estimated date of starting any proposed work). SEE RULE 1103. For Multiple Completions: Attach wellbore diagram of proposed completion or recompletion.

Reserve pit to be constructed in accordance with NMOCD Interim Pit and Below-grade Tank Guidelines

Production pit to be located approximately 50 feet south of the well head.

Reserve pit to be located approximately 30 feet north of the well head, in the northwest corner.

I hereby certify that the information above is true and complete to the best of my knowledge and belief. I further certify that any pit or below-grade tank has been/will be constructed or closed according to NMOCD guidelines ☒, a general permit ☐ or an (attached) alternative OCD-approved plan ☐.

SIGNATURE Larry Higgins TITLE Drilling COM DATE 11-29-2004

Type or print name Larry Higgins E-mail address: larry.higgins@williams.com Telephone No. (970) 563-3308

For State Use Only

APPROVED BY: [Signature] TITLE DEPUTY OIL & GAS INSPECTOR, DIST. 4 DATE OCT 21 2005
Conditions of Approval (if any):

Submit 3 Copies To Appropriate District
Office
District I
1625 N. French Dr., Hobbs, NM 88240
District II
1301 W. Grand Ave., Artesia, NM 88210
District III
1000 Rio Brazos Rd., Aztec, NM 87410
District IV
1220 S. St. Francis Dr., Santa Fe, NM
87505

State of New Mexico
Energy, Minerals and Natural Resources

Form C-103
May 27, 2004

OIL CONSERVATION DIVISION
1220 South St. Francis Dr.
Santa Fe, NM 87505

WELL API NO.
5. Indicate Type of Lease FEDERAL X STATE <input type="checkbox"/> FEE <input type="checkbox"/>
6. State Oil & Gas Lease No. Federal NMSF-0078425
7. Lease Name or Unit Agreement Name San Juan 29-7 Unit
8. Well Number 565S
9. OGRID Number 14538
10. Pool name or Wildcat Basin Fruitland Coal

Pit or Below-grade Tank Application ☒ or Closure ☐

Pit type drilling Depth to Groundwater >100' Distance from nearest fresh water well >1,000' Distance from nearest surface water <200'

Pit Liner Thickness: 12 mil Below-Grade Tank: Volume _____ bbls; Construction Material _____

SUNDRY NOTICES AND REPORTS ON WELLS
(DO NOT USE THIS FORM FOR PROPOSALS TO DRILL OR TO DEEPEN OR PLUG BACK TO A
DIFFERENT RESERVOIR. USE "APPLICATION FOR PERMIT" (FORM C-101) FOR SUCH
PROPOSALS.)

1. Type of Well: Oil Well ☐ Gas Well ☒ Other

2. Name of Operator
Burlington Resources Oil and Gas Company

3. Address of Operator
C/O Williams Exploration and Production Co., P.O. Box 316, Ignacio, CO 81137

4. Well Location
Unit Letter F: 2500 feet from the north line and 2600 feet from the west line
Section 26 Township 29N Range 7W NMPM County Rio Arriba

11. Elevation (Show whether DR, RKB, RT, GR, etc.)
6,326' GR

12. Check Appropriate Box to Indicate Nature of Notice, Report or Other Data

NOTICE OF INTENTION TO:	SUBSEQUENT REPORT OF:
PERFORM REMEDIAL WORK <input type="checkbox"/>	REMEDIAL WORK <input type="checkbox"/>
TEMPORARILY ABANDON <input type="checkbox"/>	ALTERING CASING <input type="checkbox"/>
PULL OR ALTER CASING <input type="checkbox"/>	COMMENCE DRILLING OPNS. <input type="checkbox"/>
PLUG AND ABANDON <input type="checkbox"/>	P AND A <input type="checkbox"/>
CHANGE PLANS <input type="checkbox"/>	CASING/CEMENT JOB <input type="checkbox"/>
MULTIPLE COMPL <input type="checkbox"/>	
OTHER: <input type="checkbox"/>	OTHER: <input type="checkbox"/>

13. Describe proposed or completed operations. (Clearly state all pertinent details, and give pertinent dates, including estimated date of starting any proposed work). SEE RULE 1103. For Multiple Completions: Attach wellbore diagram of proposed completion or recompletion.

Below-grade Tank to be constructed in accordance with NMOCD Interim Pit and Below-grade Tank Guidelines

Production pit to be located approximately 50 feet south of the well head.

Reserve pit to be located approximately 30 feet north of the well head, in the northwest corner.

I hereby certify that the information above is true and complete to the best of my knowledge and belief. I further certify that any pit or below-grade tank has been/will be constructed or closed according to NMOCD guidelines ☒, a general permit ☐ or an (attached) alternative OCD-approved plan ☐.

SIGNATURE Larry Higgins TITLE Drilling COM DATE 11-29-2004

Type or print name Larry Higgins E-mail address: larry.higgins@williams.com Telephone No. (970) 563-3308

For State Use Only
Original Signed by STEVEN N. HAYDEN

DEPUTY OIL & GAS INSPECTOR, DIST. 1

OCT 31 2005

APPROVED BY: _____ TITLE _____ DATE _____

Conditions of Approval (if any):

DORRINGTON RESOURCES OIL & GAS COMPANY, LP
SAN JUAN 29-7 UNIT #565S, 2500' FNL & 2600' FWL
SECTION 26, T29N, R7W, NMPM, RIO ARriba COUNTY, NM
GROUND ELEVATION: 6326' DATE: JUNE 21, 2004

Plat #2 Location Layout

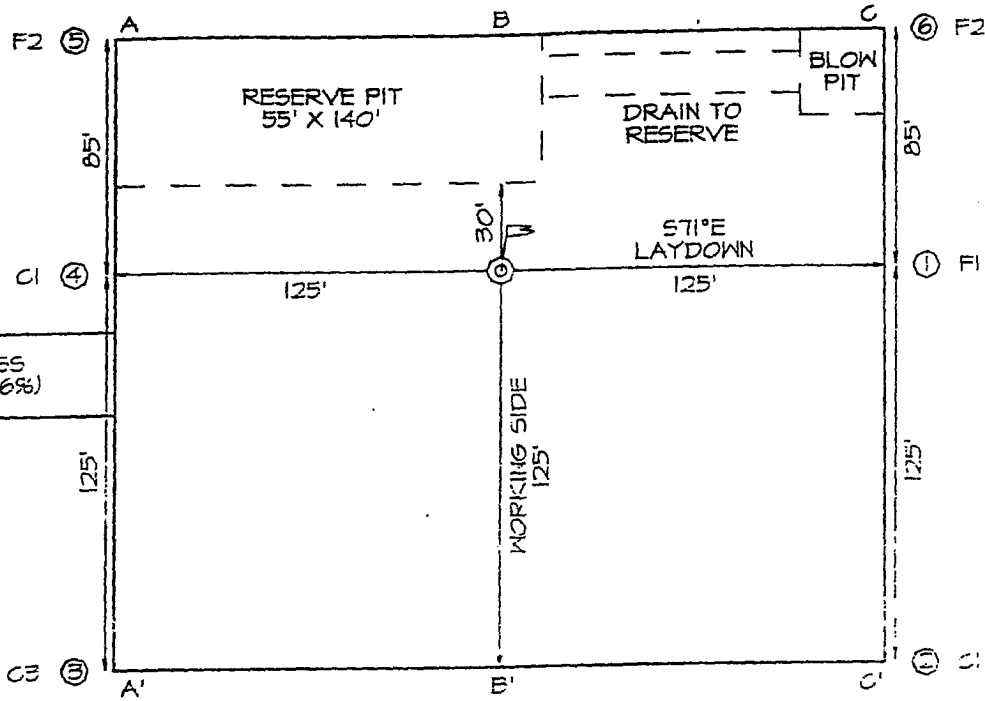
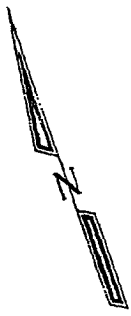

LATITUDE: 36°41'50"
LONGITUDE: 107°32'23"
 DATUM: NAD1927

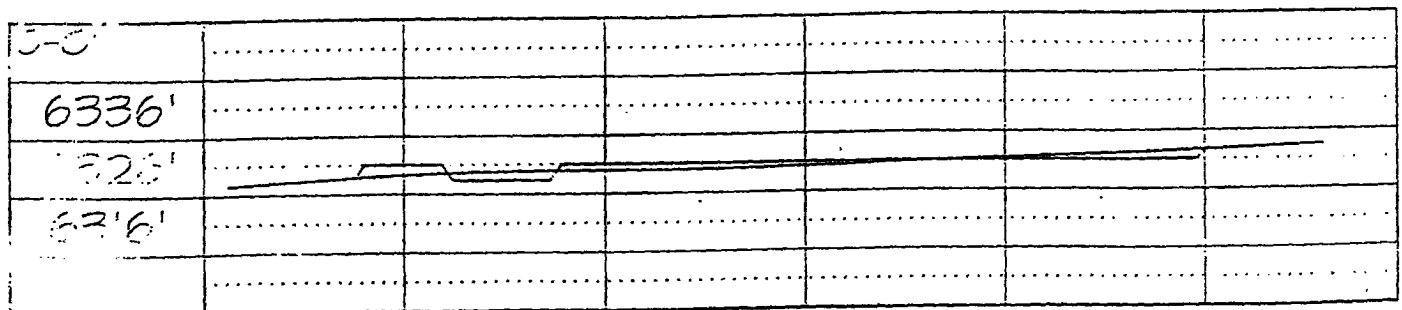
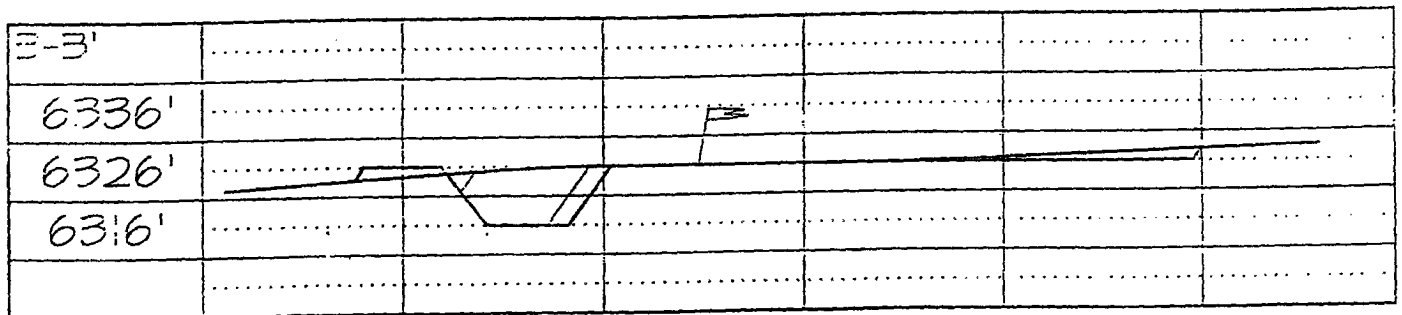
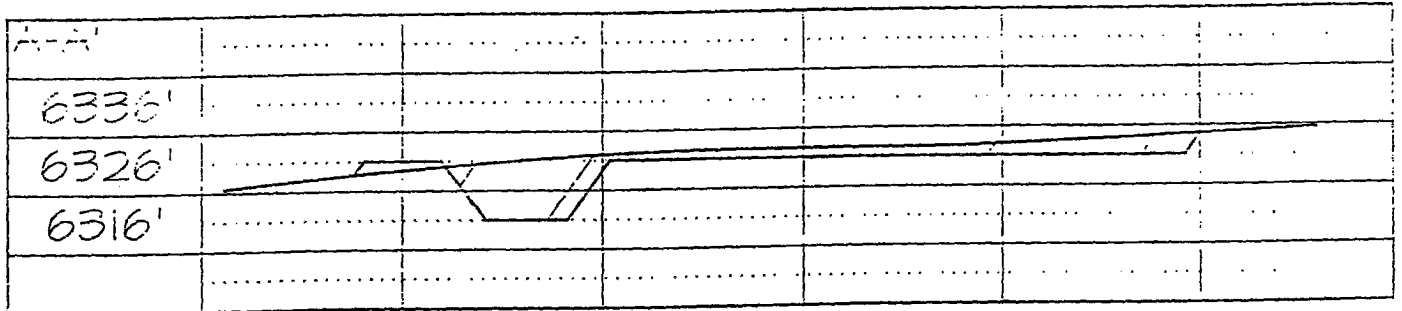



WILLIAMS PRODUCTION COMPANY

Operations Plan

(Note: This procedure will be adjusted on site based upon actual conditions)

DATE: 11/22/2004

WELLNAME: San Juan 29-7 #565S **FIELD:** Basin Fruitland Coal

SURF LOCATION: SENW Sec. 26-T29N-R7W **SURFACE:** FEE
Rio Arriba, NM

BH LOCATION SWNW Sec 26-29N-7W

ELEVATION: 6,326' GR **MINERALS:** Fee/Federal

TOTAL DEPTH: 5,394' **LEASE #** SF-0078425

I. GEOLOGY: Surface formation - San Jose

A. FORMATION TOPS: (KB)

		Pilot Hole	Horizontal Section			Pilot Hole	Horizontal Section
		TVD	MD			TVD	MD
San Jose		Surface	Surface		Top Coal	2,896	2,913
Nancimiento		901	901		Top Target Coal	3,101	3,357
Ojo Alomo		2,161	2,161		Bottom Target Coal	3,121	
Kirtland		2,341	2,341		Base Coal	3,121	
Fruitland		2,846	2,854		Picture Cliffs	3,121	
					TD	3,221	5,394

- **NOTE:** Well will be vertically drilled to 100' into Picture Cliff, logged through the PC, plug back the PC and 8-3/4" hole to 200 ft. above adjusted KOP. Dress / Kick-off cement plug and horizontally drill through the coal.

B. LOGGING PROGRAM: High Resolution Induction/ GR and Density/ Neutron log from surface casing to TD of pilot hole. Onsite geologist will pick Density/ Neutron log intervals on both logging runs.

C. NATURAL GAUGES: Gauge any noticeable increases in gas flow. Record all gauges in Tour book and on morning reports.

D. SURVEYING: Run Single Shot surveys every 500 ft. while drilling the Pilot Hole to 3,469 ft. (MD).

II. DRILLING

A. MUD PROGRAM: Clear water with benex to 7" casing point. Treat for lost circulation as necessary. Expect 100% returns prior to cementing. Notify Engineering of any mud losses. If coal is detected before 2,846' DO NOT drill deeper until Engineering is contacted.

B. Drilling Fluid: Horizontal section will be drilled with Calcium Chloride water.

C. MUD LOGGING PRORAM: Mud logger will be on location from 1,961 to TD of pilot hole then from drill out of intermediate casing to TD..

D. BOP TESTING: While drill pipe is in use, the pipe rams and the blind rams will be function tested once each trip. The anticipated reservoir is expected to be less than 1300 psi, so the rams will be tested to 1500 psi. The surface and intermediate casing strings will be pressure tested to 1500 psi in conjunction with the BOP test before drilling out cement. The drum brakes will be inspected and tested each tour. All tests, inspections and SPR's will be recorded in the tour book as to time and results.

III. MATERIALS

A. CASING PROGRAM:

<u>CASING TYPE</u>	<u>HOLE SIZE</u>	<u>DEPTH</u>	<u>CASING SIZE</u>	<u>WT. & GRADE</u>
Surface	12-1/4"	+/- 300'	9-5/8"	36# K-55
Intermediate	8-3/4"	+/- 3,357'	7"	20# K-55
Prod. Liner	6-1/4"	+/- 3,000-5,364'	4-1/2" perfed	10.5# K-55

***Note: All casing depths are measured depths.**

B. FLOAT EQUIPMENT:

1. **SURFACE CASING:** 9-5/8" notched regular pattern guide shoe. Run (1) standard centralizer on each of the bottom (4) joints of Surface Casing.
2. **INTERMEDIATE CASING:** 7" cement nose guide shoe with a self-fill insert float. Place float collar one joint above the shoe. Install (1) Turbulent centralizer on each of the bottom (3) joints and one standard centralizer every (3) joints to 2,500 ft. Run (1) Turbulent centralizer at 2,700 ft., 2,500 ft., 2,300ft., 2,000ft., 1,500 ft., and 1,000 ft. (NTL-FRA 90-1).
3. **PRODUCTION LINER:** 4-1/2" perforated liner with guide shoe on bottom.

C. CEMENTING:

(Note: Volumes may be adjusted onsite due to actual conditions)

1. SURFACE: Use 155 sx (206 cu.ft.) of "Type III" with 2% CaCl_2 and 1/4# of cello-flake/sk (Yield = 1.41 cu.ft./sk, Weight = 14.5 #/gal.). Use **100% excess** to circulate the surface. WOC 12 hours. Total volume = 206 cu.ft. Test to 1500#.
2. INTERMEDIATE: Lead - 350 sx (731 cu.ft.) of "Type III" 65/35 poz with 8% gel, 1% CaCl_2 and 1/4# cello-flake/sk (Yield = 2.09 cu.ft./sk, Weight = 12.1 #/gal.). Tail - 100 sx (139cu.ft.) of "Type III" with 1/4# cello-flake/sk, and 1% CaCl_2 (Yield = 1.4 cu.ft./sk, Weight = 14.5#/gal.). Use **120% excess in Lead Slurry** to circulate to surface. **No excess in Tail Slurry.** Total volume = 870 cu.ft. Bump Plug to 1,500 psi. Notify engineering if cement is not circulated to surface.
3. PRODUCTION LINER: Open hole completion. No cement.

IV COMPLETION

A. PRESSURE TEST

Pressure test 7" casing to 3300# for 15 minutes.

B. STIMULATION

None

C. RUNNING TUBING

1. Fruitland Coal: Run 2-3/8", 4.7#, J-55, EUE tubing with a SN (1.375" ID) on top of bottom joint. Land tubing at approximately 3,730'.

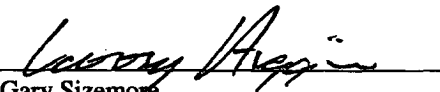
FOR 
Gary Sizemore
Sr. Drilling Engineer



New Mexico
Rio Arriba County, NM
Sec. 26 T29N R7W
San Juan 29-7 Unit #565S

San Juan 29-7 Unit #565S Surface Location

RKB Elevation: 6341.00ft above Mean Sea Level
RKB (6326' + 15' est)
Ref. Global Coordinates: 2073174.96 N, 586077.77 E
Ref. Geographical Coordinates: 36° 41' 50.0000" N, 107° 32' 23.0000" W

Version 1 Bottom Hole Location

Ref. RKB (6326' + 15' est): 3111.00ft
Ref. Mean Sea Level: -3230.00ft
Ref. Wellhead: 435.00 N, 2460.00 W
Ref. Global Coordinates: 2073609.98 N, 583617.77 E
Ref. Geographical Coordinates: 36° 41' 54.3751" N, 107° 32' 53.1916" W

Northings

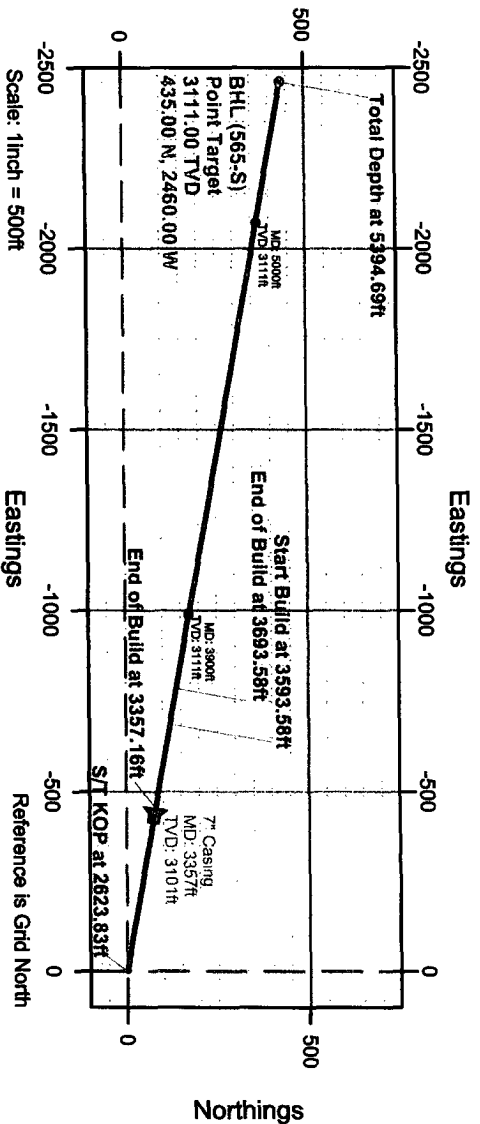

Version 1 Proposal Data

Coordinate System : NAD27 New Mexico State Planes, Western Zone (need to double check)									
Measured Depth	Incl.	Azim.	Vertical Depth	Northings	Eastings	Vertical Section	Dogleg Rate		
KOP	2623.83	0.000	0.000	2623.83	0.00 N	0.00 E	0.00		
7" Casing	3357.16	88.000	280.028	3101.00	80.24 N	453.76 W	460.80		
Start Build	3593.58	88.000	280.028	3109.25	121.38 N	686.43 W	697.08		
End Build	3693.58	90.000	280.028	3111.00	138.79 N	784.88 W	797.06		
Total Depth	5394.69	90.000	280.028	3111.00	435.00 N	2460.00 W	2498.16		

Vertical Depth

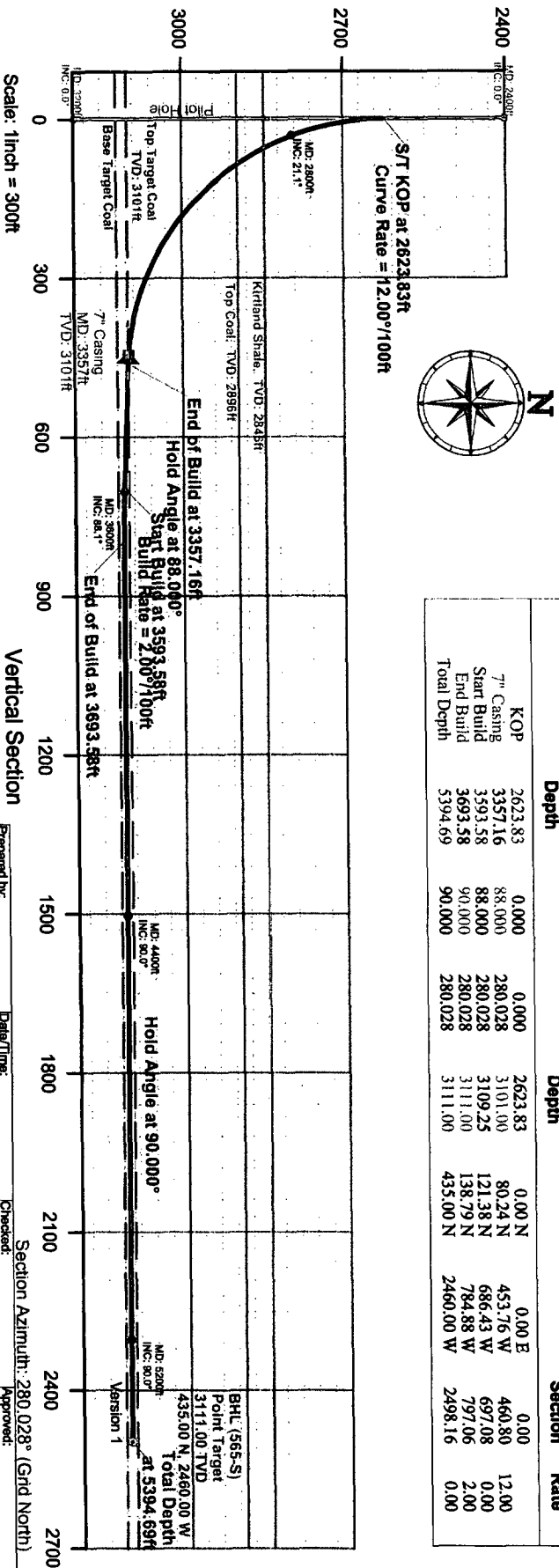

Scale: 1inch = 300ft

Vertical Section

Prepared by: Brad McClung
Date/Time: 23 September, 2004 - 17:08
Checked: Section Azimuth: 280.028° (Grid North)
Approved:

Williams Production Company, LLC

Well Control Equipment Schematic for 2M Service

Attachment to Drilling Technical Program

Typical BOP setup

Location: San Juan Basin, New Mexico

Date: August 20, 2001

By: John Thompson (Walsh E&P)

BOP Stack

Rotating Head (optional)

Fill Line

Mud Flow to Pit

Double Ram Preventer

Drilling Spool

Kill line (2" Min)

Choke line to Manifold (2" Min)

Ground Level

Casing Head

Bull Plug

Ball Valve 2000 psi WP

Surface Casing

Production Casing

Choke & Kill Manifold

Positive Choke

2" Minimum Size

Bypass to
Steel Pit
(Optional)

From BOP
Stack

2" Minimum Size

Pressure Gauge

2" Minimum Size

Straight-thru
to Tank or Pit

Working Pressure for all equipment
is 2,000 psi or greater

2" Minimum Size

To Tank or Pit

Adjustable
Choke

