

Well Location and Acreage Dedication Plat

Section A.

30.045-07113

Date MAY 4, 1962

Operator EL PASO NATURAL GAS COMPANY Lease HANCOCK "B" SF077107-A
 Well No. 9 Unit Letter P Section 28 Township 28-N Range 9-W NMIPM
 Located 950 Feet From SOUTH Line 1148 Feet From EAST Line
 County SAN JUAN G. L. Elevation 6840 Dedicated Acreage 160 Acres
 Name of Producing Formation PICTURED CLIFFS Pool AZTEC P.C.

1. Is the Operator the only owner in the dedicated acreage outlined on the plat below?
 Yes X No _____
2. If the answer to question one is "no", have the interests of all the owners been consolidated by communitization agreement or otherwise? Yes _____ No _____. If answer is "yes", Type of Consolidation _____
3. If the answer to question two is "no", list all the owners and their respective interests below:

Owner

Land Description

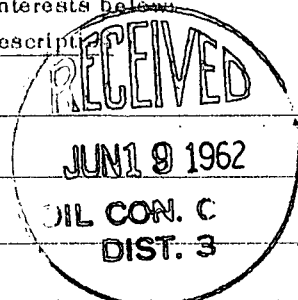

Section B.

Note: All distances must be from outer boundaries of section.

This is to certify that the information in Section A above is true and complete to the best of my knowledge and belief.

El Paso Natural Gas Company

(Operator)

Original Signed D. W. Meehan

(Representative)

Box 990

(Address)

Farmington, New Mexico

NOTE

THIS PLAT REISSUED TO SHOW
 CORRECTED ELEVATION 6-1-62

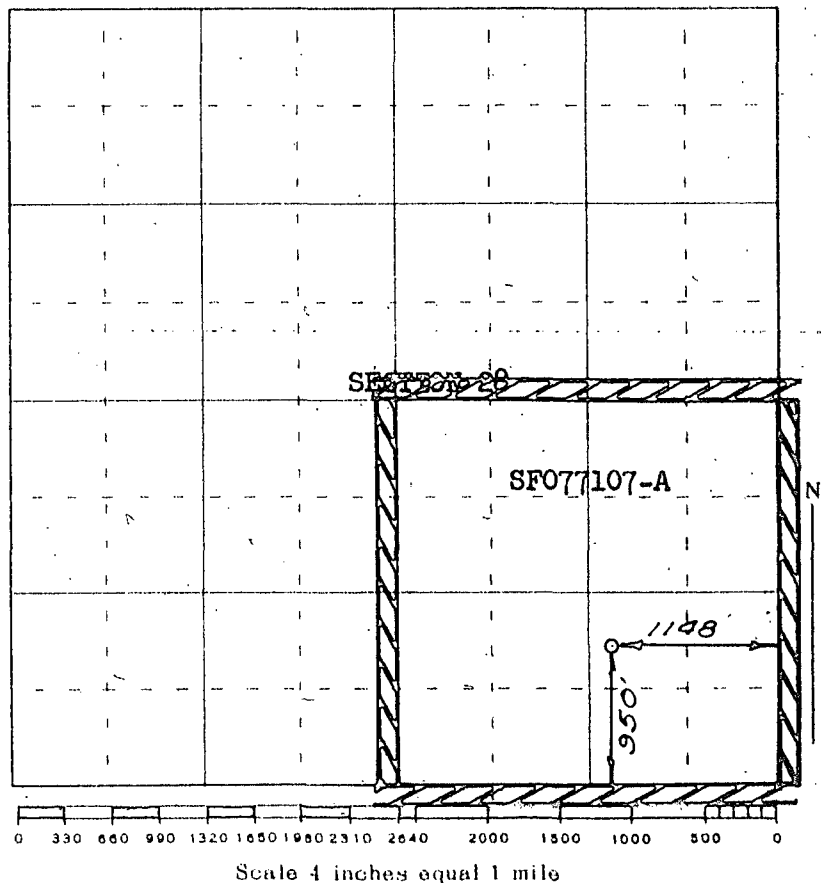

This is to certify that the above plat was prepared from field notes of actual surveys made by me or under my supervision and that the same are true and correct to the best of my knowledge and belief.

(Seal)

Date Surveyed MAY 1, 1962

David A. Kilmer
 Registered Professional Engineer and/or Land Surveyor

Farmington, New Mexico