

District I

1625 N. French Dr., Hobbs, NM 88240

District II

1301 W. Grand Ave., Artesia, NM 88210

District III

1000 Rio Brazos Rd., Aztec, NM 87410

District IV

1220 S. St. Francis Dr., Santa Fe, NM 87505

State of New Mexico
Energy, Minerals and Natural Resources

OIL CONSERVATION DIVISION
1220 South St. Francis Dr.
Santa Fe, NM 87505

<p>SUNDRY NOTICES AND REPORTS ON WELLS (DO NOT USE THIS FORM FOR PROPOSALS TO DRILL OR TO DEEPEN OR PLUG BACK TO A DIFFERENT RESERVOIR. USE "APPLICATION FOR PERMIT" (FORM C-101) FOR SUCH PROPOSALS.)</p>		<p>WELL API NO. 30-045-32875</p>
<p>1. Type of Well: Oil Well <input type="checkbox"/> Gas Well <input checked="" type="checkbox"/> Other <input type="checkbox"/></p>		<p>5. Indicate Type of Lease STATE <input type="checkbox"/> FEE <input type="checkbox"/></p>
<p>2. Name of Operator BP AMERICA PRODUCTION COMPANY</p>		<p>6. State Oil & Gas Lease No.</p>
<p>3. Address of Operator P.O. BOX 3092 HOUSTON, TX 77079-2064</p>		<p>7. Lease Name or Unit Agreement Name Atlantic LS (APD filed with BLM NMNM 013688)</p>
<p>4. Well Location Unit Letter <u>I</u> : <u>1765</u> feet from the <u>South</u> line and <u>1045</u> feet from the <u>East</u> line Section <u>25</u> Township <u>31N</u> Range <u>10W</u> NMPM <u>SAN JUAN</u> County</p>		<p>8. Well Number 1 M</p>
<p>11. Elevation (Show whether DR, RKB, RT, GR, etc.) 6631'</p>		<p>9. OGRID Number 000778</p>
<p>Pit or Below-grade Tank Application <input checked="" type="checkbox"/> or Closure <input type="checkbox"/></p>		<p>10. Pool name or Wildcat Basin Dakota & Blanco Mesaverde</p>
<p>Pit type <u>DRILLING</u> Depth to Groundwater <u>>100'</u> Distance from nearest fresh water well <u>>1000'</u> Distance from nearest surface water <u>>1000'</u> Pit Liner Thickness: <u>12</u> mil Below-Grade Tank: Volume _____ bbls; Construction Material _____</p>		

12. Check Appropriate Box to Indicate Nature of Notice, Report or Other Data

<p>NOTICE OF INTENTION TO:</p> <p>PERFORM REMEDIAL WORK <input type="checkbox"/> PLUG AND ABANDON <input type="checkbox"/> TEMPORARILY ABANDON <input type="checkbox"/> CHANGE PLANS <input type="checkbox"/> PULL OR ALTER CASING <input type="checkbox"/> MULTIPLE COMPL <input type="checkbox"/></p>		<p>SUBSEQUENT REPORT OF:</p> <p>REMEDIAL WORK <input type="checkbox"/> ALTERING CASING <input type="checkbox"/> COMMENCE DRILLING OPNS. <input type="checkbox"/> P AND A <input type="checkbox"/> CASING/CEMENT JOB <input type="checkbox"/></p>	
<p>OTHER: LINED DRILLING PIT <input checked="" type="checkbox"/></p>		<p>OTHER: <input type="checkbox"/></p>	

13. Describe proposed or completed operations. (Clearly state all pertinent details, and give pertinent dates, including estimated date of starting any proposed work). SEE RULE 1103. For Multiple Completions: Attach wellbore diagram of proposed completion or recompletion.

Construct a lined drilling pit per BP America – San Juan Basin Drilling/ Workover Pit Construction Plan issued date of 11/17/2004. Pit will be closed according to closure plan on file.

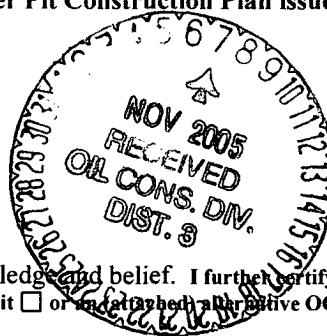

I hereby certify that the information above is true and complete to the best of my knowledge and belief. I further certify that any pit or below-grade tank has been/will be constructed or closed according to NMOCD guidelines ☒, a general permit ☐ or an attached alternative OCD-approved plan ☐.

SIGNATURE Cherry Hlava TITLE Regulatory Analyst DATE 11/02/2005

Type or print name Cherry Hlava E-mail address: hlavacl@bp.com Telephone No. 281-366-4081

For State Use Only

APPROVED BY: Denny Zeeb TITLE DEPUTY OIL & GAS INSPECTOR, DIST. 3 DATE NOV 07 2005
 Conditions of Approval (if any): _____

PAD LAYOUT PLAN & PROFILE
BP AMERICA PRODUCTION COMPANY
 Atlantic LS # 1M
 1765' F/SL 1045' F/EL
 SEC. 25, T31N, R10W, N.M.P.M.
 SAN JUAN COUNTY, NEW MEXICO

Lat: 36°52'02"
 Long: 107°49'52"

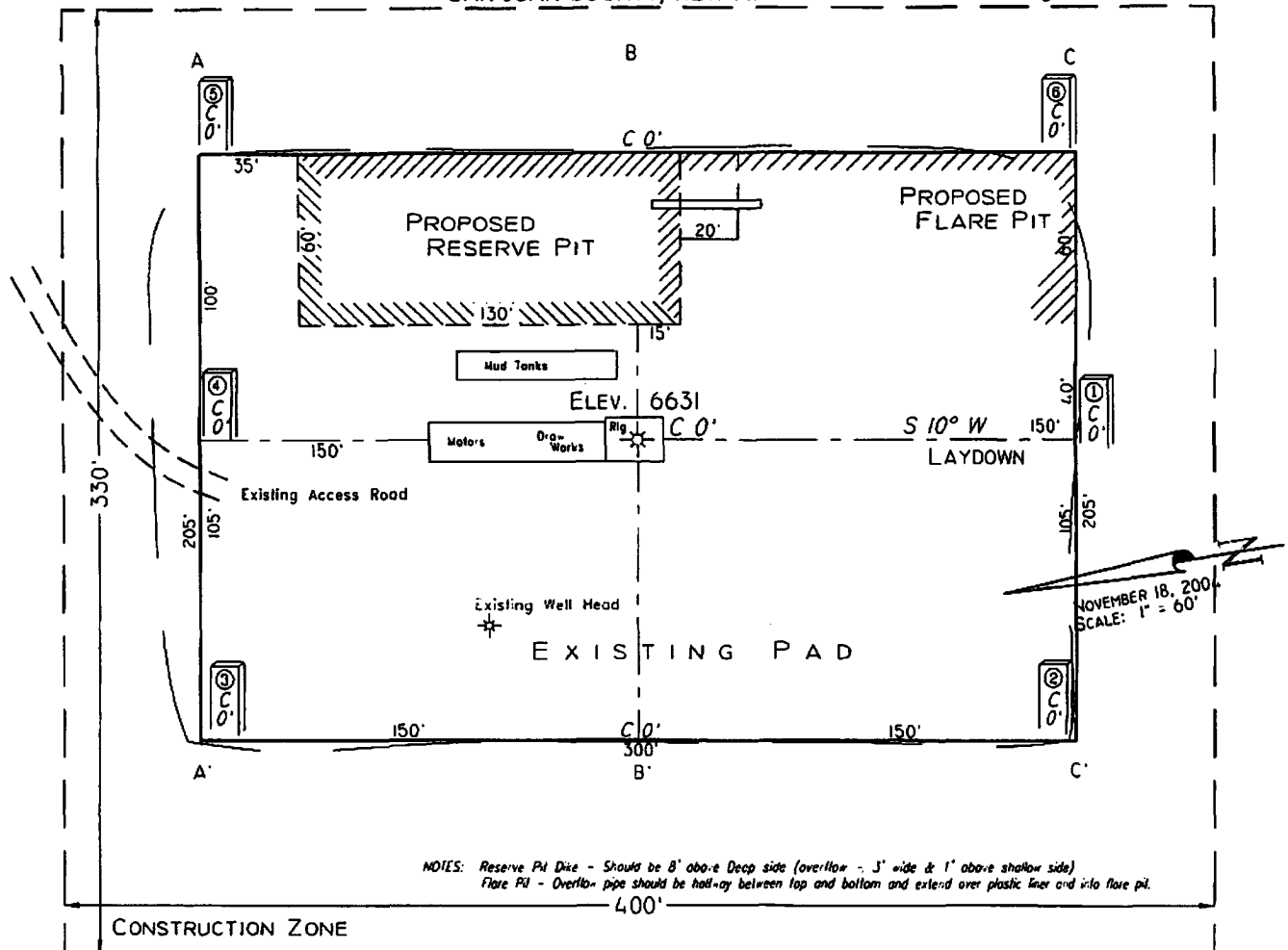

Area of Construction Zone - 330' x 400' or 3.03 acres, more or less.

SCALE: 1" = 60' HORIZ.
 1" = 40' VERT.

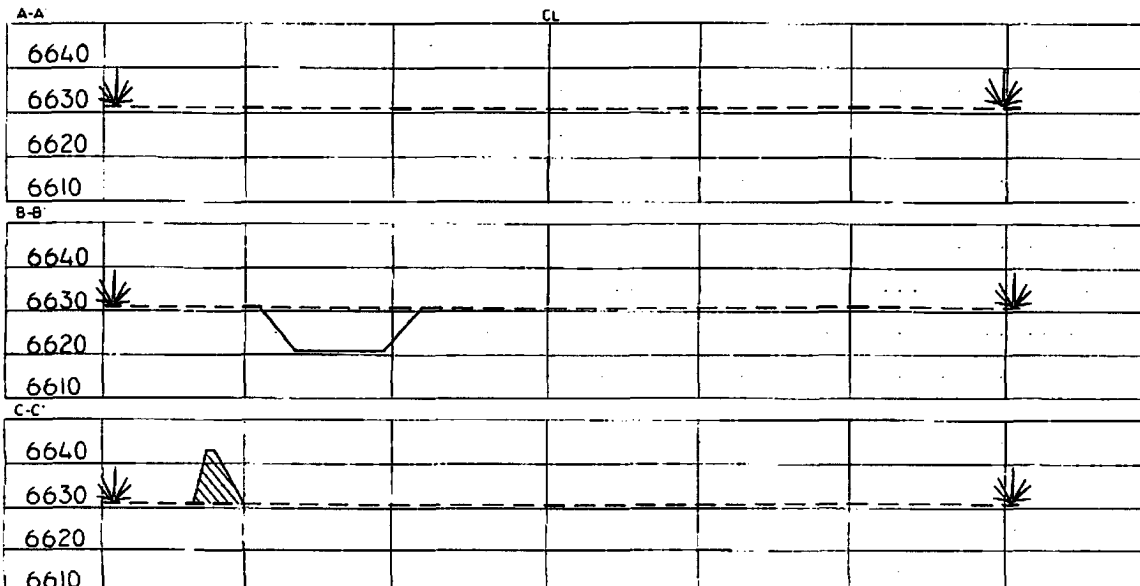

NOTE: Contractor should call One-Call for location of any marked or unmarked buried pipelines or cables on well pad and/or access road at least two (2) working days prior to construction.

Cuts and fills shown are approximate - final finished elevation is to be adjusted so earthwork will balance. Corner stakes are approximate and do not include additional areas needed for side slopes and drainages. Final Pad Dimensions are to be verified by Contractor.

VANN SURVEYS
 P. O. Box 1306
 Farmington, NM