

UNITED STATES
DEPARTMENT OF THE INTERIOR
BUREAU OF LAND MANAGEMENT

2005 APR 7 PM 12 49

RECEIVED

FORM APPROVED
OMB No. 1004-0137
Expires March 31, 2007

APPLICATION FOR PERMIT TO DRILL OR REENTER

1a. Type of work: <input checked="" type="checkbox"/> DRILL <input type="checkbox"/> REENTER		5. Lease Serial No. SF-080379-A
1b. Type of Well: <input type="checkbox"/> Oil Well <input checked="" type="checkbox"/> Gas Well <input type="checkbox"/> Other <input type="checkbox"/> Single Zone <input type="checkbox"/> Multiple Zone		6. If Indian, Allottee or Tribe Name
2. Name of Operator ConocoPhillips Company		7. If Unit or CA Agreement, Name and No. SAN JUAN 29-6 UNIT
3a. Address 4001 Penbrook, Odessa, TX 79762		8. Lease Name and Well No. 20B
3b. Phone No. (include area code) 432-368-1352		9. API Well No. 30-039-29522
4. Location of Well (Report location clearly and in accordance with any State requirements, *) At surface 2600 FNL - 400 FWL At proposed prod. zone		10. Field and Pool, or Exploratory BLANCO MESAVERDE
14. Distance in miles and direction from nearest town or post office*		11. Sec., T. R. M. or Blk. and Survey or Area E SECTION 8, T29N, R6W
15. Distance from proposed* location to nearest property or lease line, ft. (Also to nearest drig. unit line, if any)		12. County or Parish Rio Arriba
16. No. of acres in lease 1438.6		13. State NM
17. Spacing Unit dedicated to this well W/2 - 320.0 ACRES		
18. Distance from proposed location* to nearest well, drilling, completed, applied for, on this lease, ft.		20. BLM/BIA Bond No. on file
19. Proposed Depth 6186'		
21. Elevations (Show whether DF, KDB, RT, GL, etc.) 6803' GL		22. Approximate date work will start*
23. Estimated duration		

24. Attachments

The following, completed in accordance with the requirements of Onshore Oil and Gas Order No. 1, must be attached to this form:

1. Well plat certified by a registered surveyor.
2. A Drilling Plan.
3. A Surface Use Plan (if the location is on National Forest System Lands, the SUPO must be filed with the appropriate Forest Service office).
4. Bond to cover the operations unless covered by an existing bond on file (see Item 20 above).
5. Operator certification
6. Such other site specific information and/or plans as may be required by the BLM-

25. Signature Vicke Westby (pf)	Name (Printed/Typed) Vicki Westby	Date 4/5/05
Title Staff Agent		

Approved by (Signature) [Signature]	Name (Printed/Typed) [Signature]	Date 11/4/05
Title AFM	Office PFO	

Application approval does not warrant or certify that the applicant holds legal or equitable title to those rights in the subject lease which would entitle the applicant to conduct operations thereon.
Conditions of approval, if any, are attached.

Title 18 U.S.C. Section 1001 and Title 43 U.S.C. Section 1212, make it a crime for any person knowingly and willfully to make to any department or agency of the United States any false, fictitious or fraudulent statements or representations as to any matter within its jurisdiction.

*(Instructions on page 2)

ConocoPhillips Company proposes to drill a vertical wellbore to the Blanco Mesaverde formation. This well will be drilled and equipped in accordance with the attachments submitted herewith.

This application is for APD / ROW.

NMOCD



District I
PO Box 1980, Hobbs, NM 88241-1980

District II
PO Drawer 00, Artesia, NM 88211-0719

District III
1000 Rio Brazos Rd., Aztec, NM 87410

District IV
PO Box 2088, Santa Fe, NM 87504-2088

State of New Mexico
Energy, Minerals & Natural Resources Department

OIL CONSERVATION DIVISION
PO Box 2088
Santa Fe, NM 87504-2088

Form C-102

Revised February 21, 1994

Instructions on back
Submit to Appropriate District Office
State Lease - 4 Copies
Fee Lease - 3 Copies

☐ AMENDED REPORT

WELL LOCATION AND ACREAGE DEDICATION PLAT

*API Number 30-039-29522	*Pool Code 72319	*Pool Name BLANCO MESAVERDE
*Property Code 31326	*Property Name SAN JUAN 29-6 UNIT	*Well Number 208
*GRID No. 217817	*Operator Name CONOCOPHILLIPS COMPANY	*Elevation 6803'

10 Surface Location

UL or lot no. E	Section 8	Township 29N	Range 6W	Lot Idn	Feet from the 2600	North/South line NORTH	Feet from the 400	East/West line WEST	County RIO ARriba
--------------------	--------------	-----------------	-------------	---------	-----------------------	---------------------------	----------------------	------------------------	----------------------

11 Bottom Hole Location If Different From Surface

UL or lot no.	Section	Township	Range	Lot Idn	Feet from the	North/South line	Feet from the	East/West line	County
12 Dedicated Acres 320.0 Acres - W/2					13 Joint or Infill	14 Consolidation Code	15 Order No.		

NO ALLOWABLE WILL BE ASSIGNED TO THIS COMPLETION UNTIL ALL INTERESTS HAVE BEEN CONSOLIDATED
OR A NON-STANDARD UNIT HAS BEEN APPROVED BY THE DIVISION

	16	5295.84'	17 OPERATOR CERTIFICATION I hereby certify that the information contained herein is true and complete to the best of my knowledge and belief <i>Vicki Westby</i> Signature Vicki R. Westby Printed Name Staff Agent Title <i>April 4, 2005</i> Date
	2640.00'	2600'	400'

Submit 3 Copies To Appropriate District Office

District I

1625 N. French Dr., Hobbs, NM 88240

District II

1301 W. Grand Ave., Artesia, NM 88210

District III

1000 Rio Brazos Rd., Aztec, NM 87410

District IV

1220 S. St. Francis Dr., Santa Fe, NM

87505

State of New Mexico
Energy, Minerals and Natural Resources

OIL CONSERVATION DIVISION

1220 South St. Francis Dr.

Santa Fe, NM 87505

Form C-103

May 27, 2004

WELL API NO.

30-039-29522

5. Indicate Type of Lease

STATE ☐ FEE ☐

6. State Oil & Gas Lease No.

7. Lease Name or Unit Agreement Name

SAN JUAN 29-6 UNIT

8. Well Number

20B

9. OGRID Number

217817

10. Pool name or Wildcat

BLANCO MESA VERDE

SUNDRY NOTICES AND REPORTS ON WELLS

(DO NOT USE THIS FORM FOR PROPOSALS TO DRILL OR TO DEEPEN OR PLUG BACK TO A DIFFERENT RESERVOIR. USE 'APPLICATION FOR PERMIT' (FORM C-101) FOR SUCH PROPOSALS)

1. Type of Well: Oil Well ☐ Gas Well ☒ Other

2. Name of Operator

ConocoPhillips Company

3. Address of Operator

4001 Penbrook, Odessa, TX 79762

4. Well Location

Unit Letter E 2600 feet from the North line and 400 feet from the West line
Section 8 Township 29N Range 6W NMPM Rio Arriba County

1. Elevation (Show whether DR, RKB, RT, GR, etc.)
6803 GL

Pit or Below-grade Tank Application ☒ Closure ☐

Pit type DRILL Depth to Groundwater 160' Distance from nearest fresh water well <1 MILE Distance from nearest surface water 250'

Liner Thickness: mil Below-Grade Tank: Volume bbbs; Construction Material

12. Check Appropriate Box to Indicate Nature of Notice, Report or Other Data

NOTICE OF INTENTION TO:

PERFORM REMEDIAL WORK ☐ PLUG AND ABANDON ☐
TEMPORARILY ABANDON ☐ CHANGE PLANS ☐
PULL OR ALTER CASING ☐ MULTIPLE COMPL ☐

OTHER: ☐

SUBSEQUENT REPORT OF:

REMEDIAL WORK ☐ ALTERING CASING ☐
COMMENCE DRILLING OPNS. ☐ P AND A ☐
CASING/CEMENT JOB ☐

OTHER: ☐

13. Describe proposed or completed operations. (Clearly state all pertinent details, and give pertinent dates, including estimated date of starting any proposed work). SEE RULE 1103. For Multiple Completions: Attach wellbore diagram of proposed completion or recompletion.

The pit will be constructed and closed in accordance with Rule 50 and as per the Nov. 1, 2004 Guidelines. See the attached diagram that details the location of the pit in reference to the proposed wellhead. The drill pit will be lined. The drill pit will be closed after the well has been completed.

I hereby certify that the information above is true and complete to the best of my knowledge and belief. I further certify that any pit or below-grade tank has been/will be constructed or closed according to NMOCD guidelines ☒ a general permit ☐ or an (attached) alternative OCD-approved plan ☐

SIGNATURE Vicki Westby

TITLE Staff Agent

DATE 4/5/05

Type or print name

E-mail address:

Telephone No.

For State Use Only

APPROVED BY: [Signature]

TITLE DEPUTY OIL & GAS INSPECTOR, DIST. IV

DATE

NOV 03 2005

Conditions of Approval (if any):

CONOCOPHILLIPS COMPANY SAN JUAN 29-6 UNIT #20B
2600' FNL & 400' FWL, SECTION 8, T29N, R6W, NMPM
RIO ARriba COUNTY, NEW MEXICO ELEVATION: 6803'

LATITUDE: 36.74029° N
LONGITUDE: 107.49337° W
 DATUM: NAD1927

PLAT NOTE:

SURFACE OWNER
 FEE Land: Pat Smith

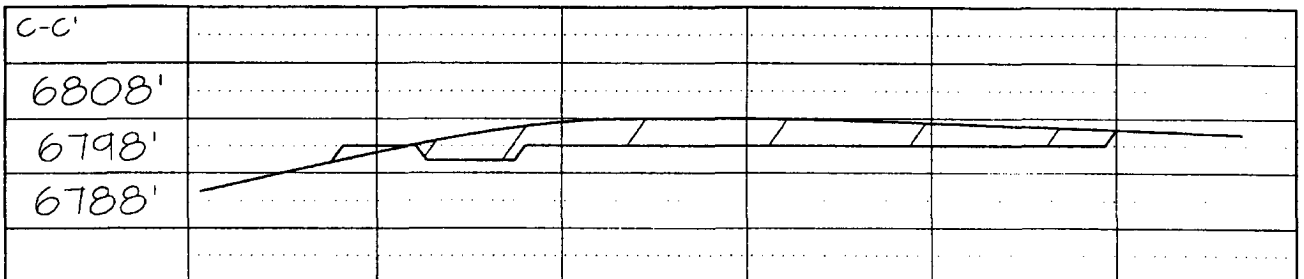
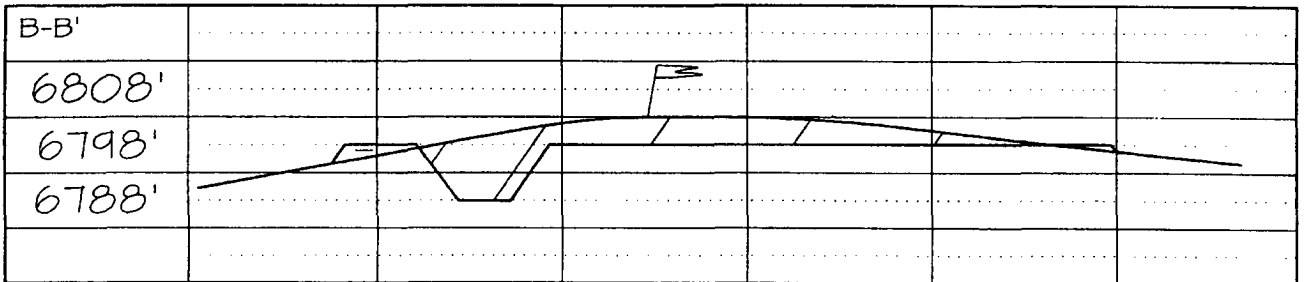
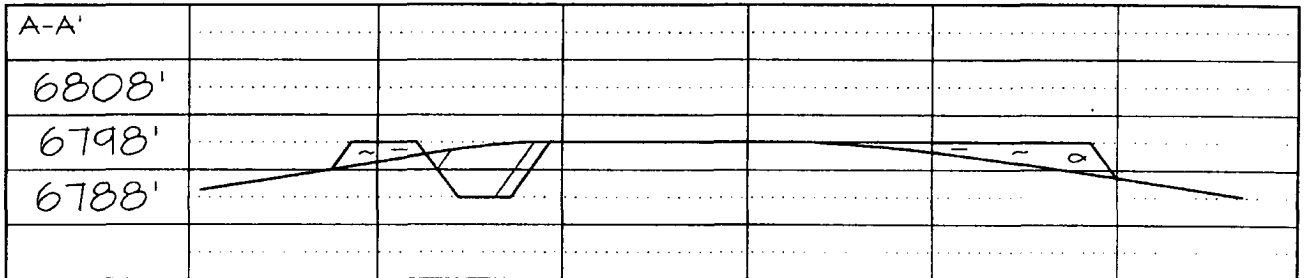
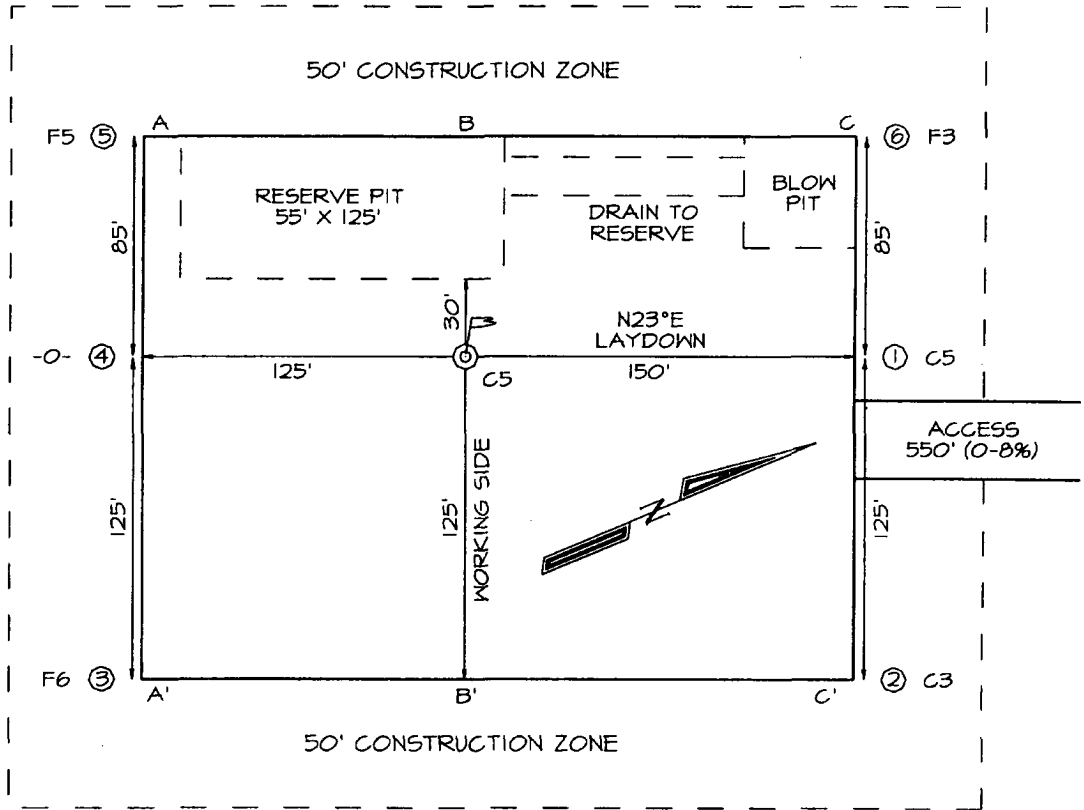

PROJECT PROPOSAL - New Drill / Sidetrack

SAN JUAN 29-6 20B

Lease:		AFE #:		AFE \$:	
Field Name: hPHILLIPS 29-6		Rig:		State: NM	County: RIO ARRIBA
Geoscientist: Glaser, Terry J		Phone: (832)486-2332	Prod. Engineer: Moody, Craig E.		Phone: 486-2334
Res. Engineer: Johnson, Tom B.		Phone: (832)-486-2347	Proj. Field Lead: Fransen, Eric E.		Phone:

Primary Objective (Zones):

Zone	Zone Name
RON	BLANCO MESAVERDE (PRORATED GAS)

Location: Surface

Straight Hole

Latitude: 36.74 Longitude: -107.49 X: Y: Section: 8 Range: 6W

Footage X: 400 FWL Footage Y: 2600 FNL Elevation: 6803 (FT) Township: 29N

Tolerance:

Location Type: Year Round Start Date (Est.): Completion Date: Date In Operation:

Formation Data: Assume KB = 6816 Units = FT

Formation Call & Casing Points	Depth (TVD in Ft)	SS (Ft)	Depletion (Yes/No)	BHP (PSIG)	BHT	Remarks
Surface Casing	200	6616	<input type="checkbox"/>			Possible lost circulation. 12 1/4" Hole. 9 5/8", 32.3 ppf, JH-40, STC casing. Circulate cement to surface.
NCMT	1666	5150	<input type="checkbox"/>			
OJAM	2771	4045	<input type="checkbox"/>			Possible water flows.
KRLD	2946	3870	<input type="checkbox"/>			
FRLD	3441	3375	<input type="checkbox"/>			Possible gas.
PCCF	3706	3110	<input type="checkbox"/>			
LEWS	3906	2910	<input type="checkbox"/>			
Intermediate Casing	4006	2810	<input type="checkbox"/>			8 3/4" Hole. 7", 20 ppf, J-55, STC Casing. Circulate cement to surface.
CHRA	4691	2125	<input type="checkbox"/>			
CLFH	5481	1335	<input type="checkbox"/>	1300		Gas; possibly wet
MENF	5556	1260	<input type="checkbox"/>			Gas.
PTLK	5836	980	<input type="checkbox"/>			Gas.
MNCS	6086	730	<input type="checkbox"/>			
Total Depth	6186	630	<input type="checkbox"/>			6 1/4" Hole. 4 1/2", 10.5 ppf, J-55, STC casing. Circulate cement a minimum of 100' inside the previous casing string. No open hole logs. Cased hole TDT with GR to surface.

Reference Wells:

Reference Type	Well Name	Comments
----------------	-----------	----------

Logging Program:

Intermediate Logs: ☐ Log only if show ☐ GR/ILD ☐ Triple Combo

TD Logs: ☐ Triple Combo ☐ Dipmeter ☐ RFT ☐ Sonic ☐ VSP ☒ TDT

Additional Information:

Log Type	Stage	From (Ft)	To (Ft)	Tool Type/Name	Remarks
----------	-------	-----------	---------	----------------	---------

San Juan 29-6 # 20B
Halliburton Cementing Program

SURFACE CASING :

Drill Bit Diameter	12.25"	
Casing Outside Diameter	9.625"	Casing Inside Diam. 9.001"
Casing Weight	32.3	ppf
Casing Grade	H-40	
Shoe Depth	230'	
Cement Yield	1.21	cuft/sk
Cement Density	15.6	lb/gal
Excess Cement	125	%
Cement Required	142	sx

SHOE 230 ', 9.625 ", 32.3 ppf, H-40 STC

INTERMEDIATE CASING :

Drill Bit Diameter	8.75"	
Casing Outside Diameter	7"	Casing Inside Diam. 6.456"
Casing Weight	20	ppf
Casing Grade	J-55	
Shoe Depth	4006'	
Lead Cement Yield	2.88	cuft/sk
Lead Cement Density	11.5	lb/gal
Lead Cement Excess	150	%
Lead Cement Required	402	sx
Tail Cement Length	801.2'	
Tail Cement Yield	1.33	cuft/sk
Tail Cement Density	13.5	lb/gal
Tail Cement Excess	150	%
Tail Cement Required	234	sx

SHOE 4006 ', 7 ", 20 ppf, J-55 STC

PRODUCTION CASING :

Drill Bit Diameter	6.25"	
Casing Outside Diameter	4.5"	Casing Inside Diam. 4.052"
Casing Weight	10.5	ppf
Casing Grade	J-55	
Top of Cement	3806'	200' inside intermediate casing
Shoe Depth	6186'	
Cement Yield	1.45	cuft/sk
Cement Density	13.1	lb/gal
Cement Excess	50	%
Cement Required	248	sx

SHOE 6186 ', 4.5 ", 10.5 ppf, J-55 STC

BLOWOUT PREVENTER ARRANGEMENT & PROGRAM

For Drilling to Intermediate Casing Point & Setting 7" Intermediate Casing

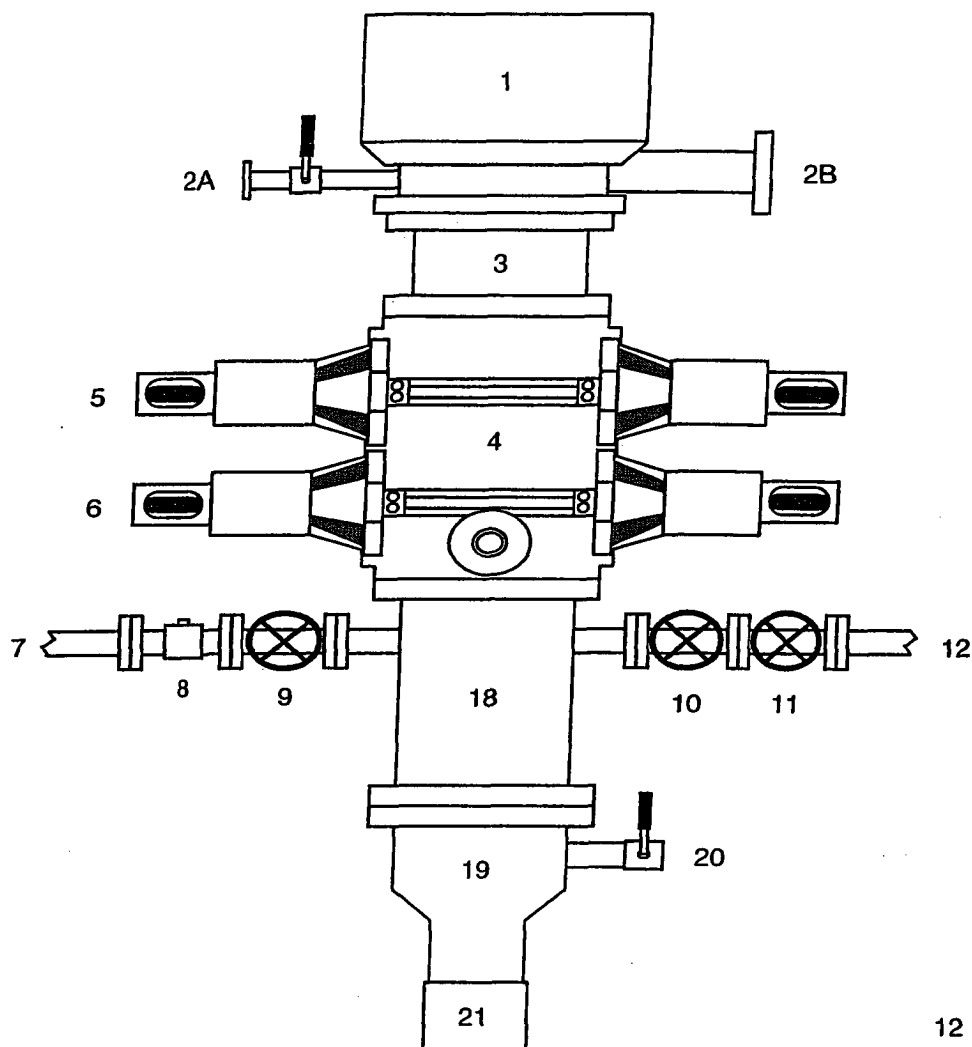

1. Rotating Head
- 2A. Fill-up Line & valve
- 2B. Flowline
3. Spacer Spool
4. Double Ram BOP (11", 3000 psi)
5. Pipe Rams
6. Blind Rams
7. Kill Line
8. Kill Line Check Valve
9. Kill Line Valve
10. Inner Choke Line Valve (3")
11. Outer Choke Line Valve (3")
12. Choke Line (3")
13. Variable Choke
14. Choke Line Valve (2")
15. Panic Line Valve (3")
16. Choke Manifold Pressure Gauge
17. Choke Line (2")
18. Mud Cross Spacer Spool
19. Casing Head "A" Section
20. Casing Head "A" Section 2" Valve
21. 9 5/8" Casing Collar

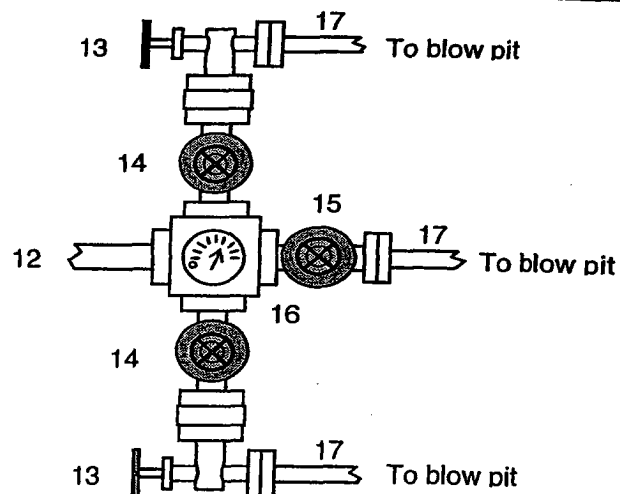

A 12-1/4" hole will be drilled to approximately 220' and the 9-5/8" surface casing will be run and cemented. The Casing Head "A" Section will be screwed onto the 9-5/8" surface casing stub. The BOP will be installed on the Casing Head "A" Section. A test plug will be set in the wellhead and the pipe rams and choke manifold will be tested to 200 psi to 300 psi (low pressure test) for 10 minutes and to 1000 psi (high pressure test) for 10 minutes. Then the test plug will be removed, and the 9-5/8" casing will be pressure tested against closed blind rams to 200 psi to 300 psi for 10 minutes and to 1000 psi for 30 minutes (this value is one 44% of the minimum internal yield pressure of the 9-5/8" casing). (Note: per regulatory requirements we will wait on cement at least 8 hrs after placement before testing the 9-5/8" surface casing). Then an 8-3/4" hole will be drilled to intermediate casing point and 7" intermediate casing will be run and cemented.

In addition to the equipment in the above diagram the following equipment will comprise the BOP system:

1. Upper Kelly cock Valve with handle
2. Stab-in TIW valve for all drillstrings in use

BLOWOUT PREVENTER ARRANGEMENT & PROGRAM

For Drilling to TD and Setting 4.5 inch Casing

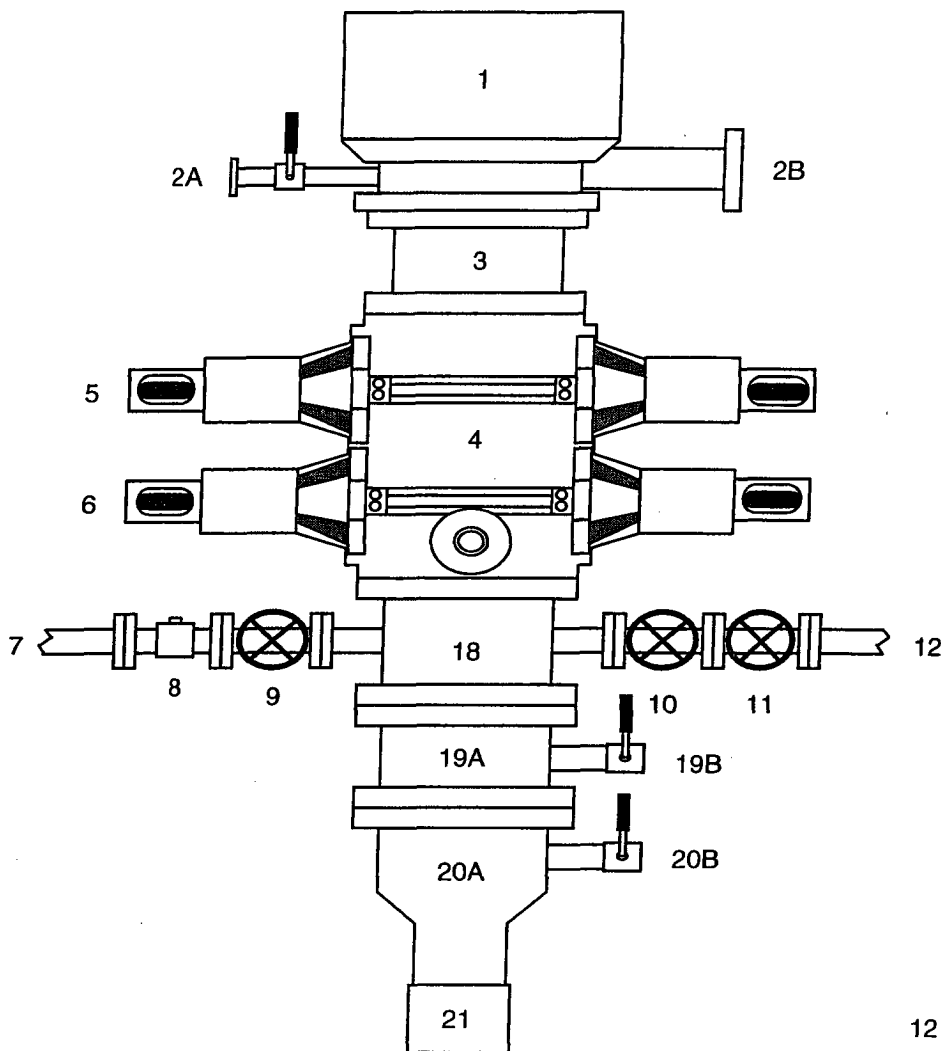

1. Rotating Head
- 2A. Fill-up Line & valve
- 2B. Blooie Line (for Air Drilling)
3. Spacer Spool
4. Double Ram BOP (11", 3000 psi)
5. Pipe Rams
6. Blind Rams
7. Kill Line
8. Kill Line Check Valve
9. Kill Line Valve
10. Inner Choke Line Valve (3")
11. Outer Choke Line Valve (3")
12. Choke Line (3")
13. Variable Choke
14. Choke Line Valve (2")
15. Panic Line Valve (3")
16. Choke Manifold Pressure Gauge
17. Choke Line (2")
18. Mud Cross Spacer Spool
- 19A Csg Spool "B" Section (11", 3M)
- 19B "B" Section Csg Valve (2", 3M)
- 20A Csg Head "A" Section (11", 3M)
- 20B "A" Section Csg Valve (2", 3M)
21. 9 5/8" Casing Collar

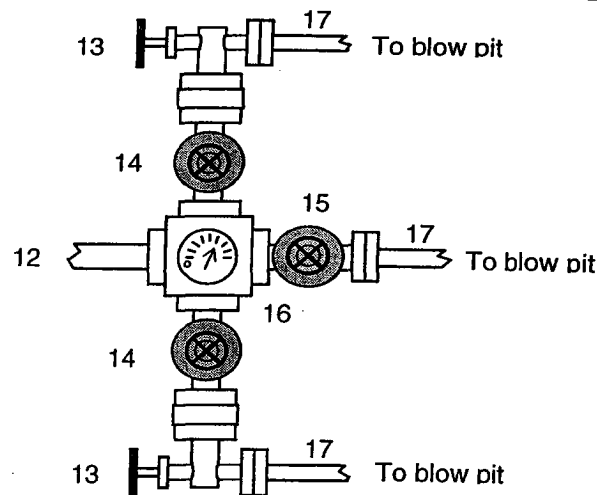

After the 7" intermediate casing has been run and cemented, the Casing Spool ("B" Section) will be installed on the wellhead ("A" Section) and the BOP will be installed on the Casing Spool. A test plug will be set in the wellhead and the pipe rams, blind rams, and choke manifold will be tested to 200 psi to 300 psi (low pressure test) for 10 minutes and to 3000 psi (high pressure test) for 10 minutes. Then the test plug will be removed and the 7" casing will be pressure tested against closed blind rams to 200 psi to 300 psi for 10 minutes and to 1800 psi for 30 minutes - this test pressure is 48% of the minimum internal yield strength of 3740 psi for the 7", 20#, J-55, STC casing. Then we will air drill the 6-1/4" hole to TD and run and cement the 4-1/2" casing.

In addition to the equipment in the above diagram the following equipment will comprise the BOP system:

1. Upper Kelly cock Valve with handle
2. Stab-in TIW valve for all drillstrings in use

Property : SAN JUAN 29-6 UNIT Well #: 20B

Surface Location:

Unit: E Section: 8 Township: 29N Range: 6W

County: Rio Arriba State: New Mexico

Footage: 2600 from the North line, 400 from the West line.

CATHODIC PROTECTION

ConocoPhillips (COP) proposes to drill a cathodic protection deep well groundbed for the subject well. COP will drill a hole vertically at the surface large enough to accommodate 20 feet of 8 inch diameter PVC pipe for surface casing to assist in further drilling and loading. Casing may be cemented in place for stability if needed. COP will drill a 6-7/8" hole to an anticipated minimum depth of 300' (maximum depth of 500'). Cement plugs will not be used unless more than one water zone is encountered. Prior drilling history for the area indicates only one zone to that depth. If more than one water zone is encountered, notification will be made and details of cement and casing will be provided.

All drilling activity will remain on the existing well pad and a Farmington based company will be doing the drilling for ConocoPhillips.