

UNITED STATES
DEPARTMENT OF THE INTERIOR
BUREAU OF LAND MANAGEMENT

APPLICATION FOR PERMIT TO DRILL OR REENTER

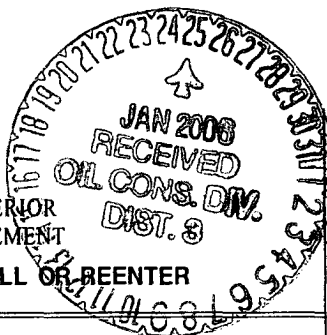

FORM APPROVED
OMB No. 1004-0137
Expires March 31, 2007

1a. Type of work: <input checked="" type="checkbox"/> DRILL <input type="checkbox"/> REENTER		5. Lease Serial No. NMNM-025445
1b. Type of Well: <input type="checkbox"/> Oil Well <input checked="" type="checkbox"/> Gas Well <input type="checkbox"/> Other <input checked="" type="checkbox"/> Single Zone <input type="checkbox"/> Multiple Zone		6. If Indian, Allottee or Tribe Name N/A
2. Name of Operator ELM RIDGE EXPLORATION COMPANY, LLC 149052		7. If Unit or CA Agreement, Name and No. N/A
3a. Address P. O. BOX 156 BLOOMFIELD, NM 87413	3b. Phone No. (include area code) (505) 632-3476	8. Lease Name and Well No. BISTI COAL 17 COM 2-T 27202
4. Location of Well (Report location clearly and in accordance with any State requirements.) At surface 2210 FNL & 1740 FWL At proposed prod. zone SAME		9. API Well No. 30-045-33166
14. Distance in miles and direction from nearest town or post office* 23 AIR MILES S OF FARMINGTON		10. Field and Pool, or Exploratory BASIN FRUITLAND COAL 71629
15. Distance from proposed* location to nearest property or lease line, ft. (Also to nearest drig. unit line, if any) 430'		11. Sec., T. R. M. or Blk. and Survey or Area F 17-25N-12W NMPM
16. No. of acres in lease 360		12. County or Parish SAN JUAN
17. Spacing Unit dedicated to this well W2 320		13. State NM
18. Distance from proposed location* to nearest well, drilling, completed, applied for, on this lease, ft. 1,443' (17-2)		19. Proposed Depth 1,350'
20. BLM/BIA Bond No. on file BLM STATE WIDE 886201C		
21. Elevations (Show whether DF, KDB, RT, GL, etc.) 6,292' GL		22. Approximate date work will start* 11/01/2005
		23. Estimated duration 2 WEEKS

24. Attachments

The following, completed in accordance with the requirements of Onshore Oil and Gas Order No.1, shall be attached to this form:

1. Well plat certified by a registered surveyor.
2. A Drilling Plan.
3. A Surface Use Plan (if the location is on National Forest System Lands, the SUPO shall be filed with the appropriate Forest Service Office).
4. Bond to cover the operations unless covered by an existing bond on file (see Item 20 above).
5. Operator certification
6. Such other site specific information and/or plans as may be required by the authorized officer.

25. Signature	Name (Printed/Typed) BRIAN WOOD	Date 06/12/2005
---------------	------------------------------------	--------------------

Title CONSULTANT	PHONE: (505) 466-8120	FAX: (505) 466-9682
---------------------	-----------------------	---------------------

Approved by (Signature)	Name (Printed/Typed)	Date 1/23/06
Title Acting AFM	Office	

Application approval does not warrant or certify that the applicant holds legal or equitable title to those rights in the subject lease which would entitle the applicant to conduct operations thereon.
Conditions of approval, if any, are attached.

Title 18 U.S.C. Section 1001 and Title 43 U.S.C. Section 1212, make it a crime for any person knowingly and willfully to make to any department or agency of the United States any false, fictitious or fraudulent statements or representations as to any matter within its jurisdiction.

*(Instructions on page 2)

This action is subject to technical and procedural review pursuant to 43 CFR 3165.3 and appeal pursuant to 43 CFR 3165.4

DRILLING OPERATIONS AUTHORIZED ARE
SUBJECT TO COMPLIANCE WITH ATTACHED
"GENERAL REQUIREMENTS".

NMOCDD

2006 JUN 14 AM 11 50
RECEIVED
OTO FARMINGTON NM

State of New Mexico
Energy, Minerals & Mining Resources Department
OIL CONSERVATION DIVISION
2040 South Pacheco
Santa Fe, NM 87505

Form C - 102

☐ AMENDED REPORT

WELL LOCATION AND ACREAGE DEDICATION PLAT

APA Number 30-045-33166	Pool Code 71629 ✓	Pool Name BASIN FRUITLAND COAL
Property Code 27202 ✓	Property Name BISTI COAL 17 COM ✓	Well Number 2 T ✓
OGRD No. 149052 ✓	Operator Name ELM RIDGE RESOURCES ✓	Elevation 6292'

Surface Location									
UL or Lot	Sec.	Twp.	Rge.	Lot Idn.	Feet from >	North/South	Feet from >	East/West	County
F	17	25 N.	12 W.		2210'	NORTH	1740'	WEST	SAN JUAN

Bottom Hole Location If Different From Surface									
UL or Lot	Sec.	Twp.	Rge.	Lot Idn.	Feet from >	North/South	Feet from >	East/West	County

Dedication 820	Joint ? C	Consolidation .	Order No. .
--------------------------	---------------------	---------------------------	-----------------------

NO ALLOWABLE WILL ASSIGNED TO THIS COMPLETION UNTIL ALL INTERESTS HAVE BEEN CONSOLIDATED
OR A NON-STANDARD UNIT HAS BEEN APPROVED BY THE DIVISION

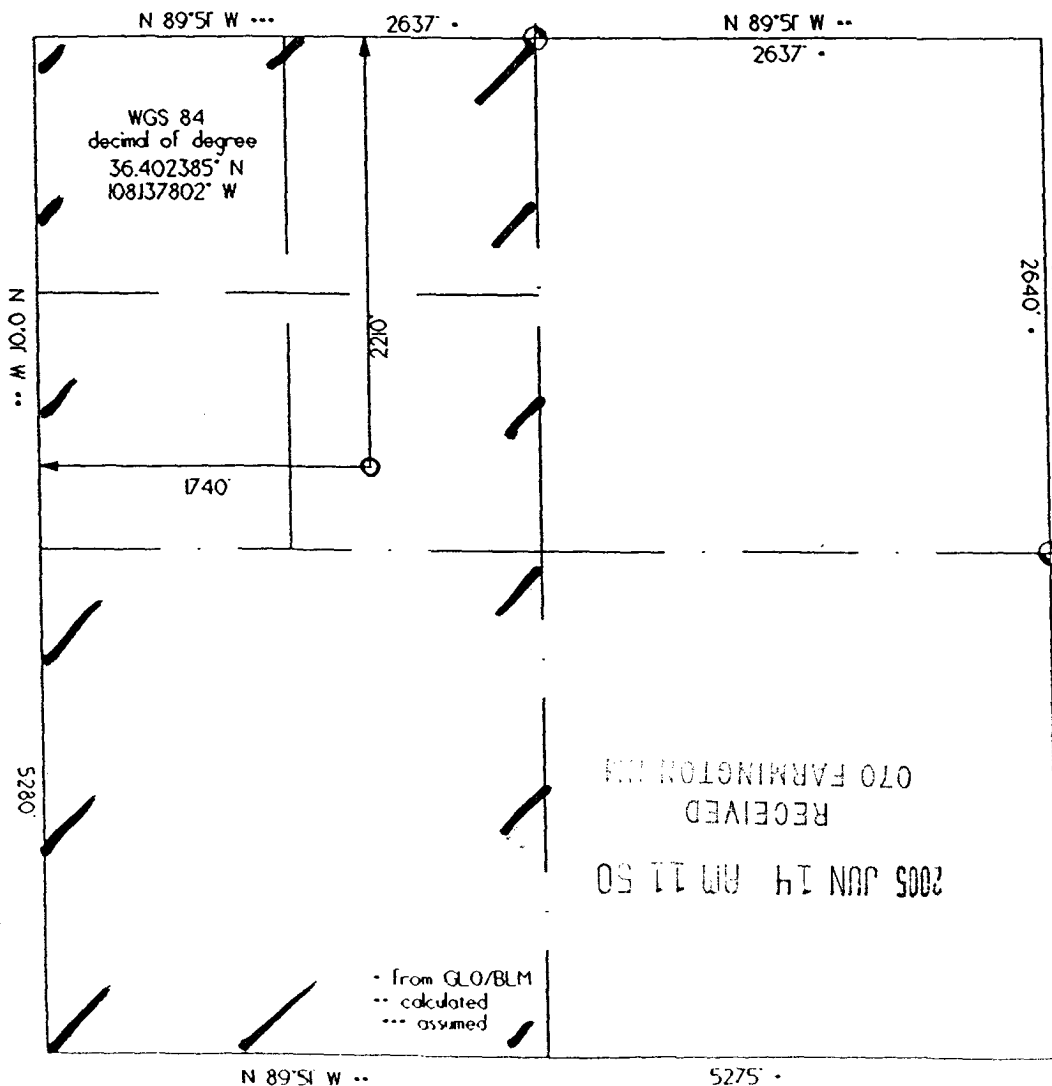

OPERATOR CERTIFICATION
I hereby certify that the information contained herein is true and complete to the best of my knowledge and belief.

Signature

Brian Wood

Printed Name **BRIAN WOOD**

Title **CONSULTANT**

Date **JUNE 11, 2005**

SURVEYOR CERTIFICATION

I hereby certify that the well location on this plat was plotted from field notes of actual surveys made by me or under my supervision, and that the same is true and correct to the best of my belief.

Date of Survey

rev: 12/23/04

Signature and Seal of Professional Surveyor



Submit 3 Copies To Appropriate District Office
District I
1625 N. French Dr., Hobbs, NM 88240
District II
1301 W. Grand Ave., Artesia, NM 88210
District III
1000 Rio Brazos Rd., Aztec, NM 87410
District IV
1220 S. St. Francis Dr., Santa Fe, NM 87505

State of New Mexico
Energy, Minerals and Natural Resources

Form C-103
May 27, 2004

OIL CONSERVATION DIVISION
1220 South St. Francis Dr.
Santa Fe, NM 87505

SUNDRY NOTICES AND REPORTS ON WELLS (DO NOT USE THIS FORM FOR PROPOSALS TO DRILL OR TO DEEPEN OR PLUG BACK TO A DIFFERENT RESERVOIR. USE "APPLICATION FOR PERMIT" (FORM C-101) FOR SUCH PROPOSALS.)		WELL API NO. 30-045-33166
1. Type of Well: Oil Well <input type="checkbox"/> Gas Well <input checked="" type="checkbox"/> Other		5. Indicate Type of Lease STATE <input type="checkbox"/> FEE <input type="checkbox"/>
2. Name of Operator ELM RIDGE EXPLORATION COMPANY, LLC		6. State Oil & Gas Lease No. NMNM-025445
3. Address of Operator P.O. BOX 156, BLOOMFIELD, NM 87413		7. Lease Name or Unit Agreement Name BISTI COAL 17 COM
4. Well Location Unit Letter F : 2210 feet from the NORTH line and 1740 feet from the WEST line Section 17 Township 25N Range 12W NMPM County SAN JUAN		8. Well Number 2-T
11. Elevation (Show whether DR, RKB, RT, GR, etc.) 6,292' GL		9. OGRID Number 149052
Pit or Below-grade Tank Application <input checked="" type="checkbox"/> or Closure <input type="checkbox"/>		10. Pool name or Wildcat BASIN FRUITLAND COAL
Pit type DRILLING Depth to Groundwater >100' Distance from nearest fresh water well 3,280' Distance from nearest surface water ~150'		
Pit Liner Thickness: mil Below-Grade Tank: Volume bbls Construction Material		

12. Check Appropriate Box to Indicate Nature of Notice, Report or Other Data

NOTICE OF INTENTION TO:

PERFORM REMEDIAL WORK ☐ PLUG AND ABANDON ☐
TEMPORARILY ABANDON ☐ CHANGE PLANS ☐
PULL OR ALTER CASING ☐ MULTIPLE COMPL ☐

SUBSEQUENT REPORT OF:

REMEDIAL WORK ☐ ALTERING CASING ☐
COMMENCE DRILLING OPNS. ☐ P AND A ☐
CASING/CEMENT JOB ☐

OTHER: DRILLING PIT ☒

OTHER: ☐

13. Describe proposed or completed operations. (Clearly state all pertinent details, and give pertinent dates, including estimated date of starting any proposed work). SEE RULE 1103. For Multiple Completions: Attach wellbore diagram of proposed completion or recompletion.

I hereby certify that the information above is true and complete to the best of my knowledge and belief. I further certify that any pit or below-grade tank has been/will be constructed & closed according to NMOCD guidelines ☒, a general permit ☐ or an (attached) alternative OCD-approved plan ☐.

SIGNATURE Brian Wood TITLE CONSULTANT DATE JUNE 12, 2005

Type or print name BRIAN WOOD
For State Use Only

E-mail address: brian@permitswest.com Telephone No. (505) 466-8120

APPROVED BY: [Signature]
Conditions of Approval (if any):

TITLE DEPUTY OIL & GAS INSPECTOR, DIST. 4 DATE JAN 25 2006

Elm Ridge Exploration Company, LLC
Bisti Coal 17 Com 2-T
2210' FNL & 1740' FWL
Sec. 17, T. 25 N., R. 12 W.
San Juan County, New Mexico

PAGE 1

Drilling Program

1. ESTIMATED FORMATION TOPS

<u>Formation Name</u>	<u>GL Depth</u>	<u>KB Depth</u>	<u>Sub Sea Elevatio</u>
Nacimiento	000'	5'	+6,292'
Basal Fruitland Coal	1,142'	1,147'	+5,150'
Pictured Cliffs	1,192'	1,197'	+5,100'
Lewis Shale	1,342'	1,347'	+4,950'
Total Depth (TD)	1,350'	1,355'	+4,942'

2. NOTABLE ZONES

<u>Oil & Gas Zones</u>	<u>Water Zones</u>	<u>Coal Zones</u>
Fruitland Coal	Nacimiento	Fruitland
Pictured Cliffs		

Water zones will be protected with casing, cement, and weighted mud. Fresh water encountered during drilling will be recorded by depth, cased, and cemented. Oil and gas shows will be tested for commercial potential based on the well site geologist's recommendations.

3. PRESSURE CONTROL

The exact drill rig and BOP model to be used are not yet known. (A typical 2,000 psi model is on PAGE 3.) BOP and choke manifold system will be installed and tested to 500 psi before drilling surface casing plug. It will remain in use until the well is completed or abandoned. A safety valve and sub with a full opening valve to fit the drill pipe and collars will be available on the rig floor in the open position at all times for use when kelly is not in use.

Elm Ridge Exploration Company, LLC
Bisti Coal 17 Com 2-T
2210' FNL & 1740' FWL
Sec. 17, T. 25 N., R. 12 W.
San Juan County, New Mexico

PAGE 2

All BOP mechanical and pressure tests will be recorded on the driller's log. BOPs will be inspected and opened and closed at least daily to assure good mechanical working order. Inspections will be recorded on the daily drilling report. Pressure tests will be conducted before drilling out from under all casing strings which are set and cemented in place.

4. CASING & CEMENT

<u>Hole Size</u>	<u>O. D.</u>	<u>Weight (lb/ft)</u>	<u>Grade</u>	<u>Type</u>	<u>Age</u>	<u>GL Setting Depth</u>
8-5/8"	7"	20	K-55	ST & C	New	120'
6-3/4"	4-1/2"	10.5	J-55	ST & C ST	New	1,350'

Surface casing will be cemented to the surface with ≈ 35 cubic feet (≈ 30 sacks) Class B + 1/4 pound per sack cello flake + 2% CaCl_2 . Yield = 1.18 cubic feet per sack. Weight = 15.2 pounds per gallon. Volume = 100% excess. Two centralizers will be run. Thread lock guide shoe and bottom of float collar.

Production casing hole will be cleaned of rock chips by circulating $\geq 150\%$ of the hole volume with mud to the surface. Thirty-five barrels of fresh water will then be circulated. Lead with ≈ 215 cubic feet (≈ 105 sacks) of Class B with 2% metasilicate (yield = 2.06 cubic feet per sack and weight = 12.5 pounds per gallon). Tail with ≈ 125 cubic feet (≈ 105 sacks) of Class B with 2% CaCl_2 (yield = 1.18 cubic feet per sack and weight = 15.2 pounds per gallon). Total cement volume is ~~240~~ 340 cubic feet based on 75% excess and circulating to surface.

5. MUD PROGRAM

A 9 pound polymer and fresh water mud system with a viscosity of ≈ 35 will be used. Sufficient material to maintain mud properties, control lost circulation, and contain a blowout will be available at the well while drilling.

2,000 PSI BOP SYSTEM

Note: 1. An upper Kelly cock valve will be utilized during drilling. Handle will be available for easy access.

2. Safety valves and necessary subs to fit all drill string in use will be available.

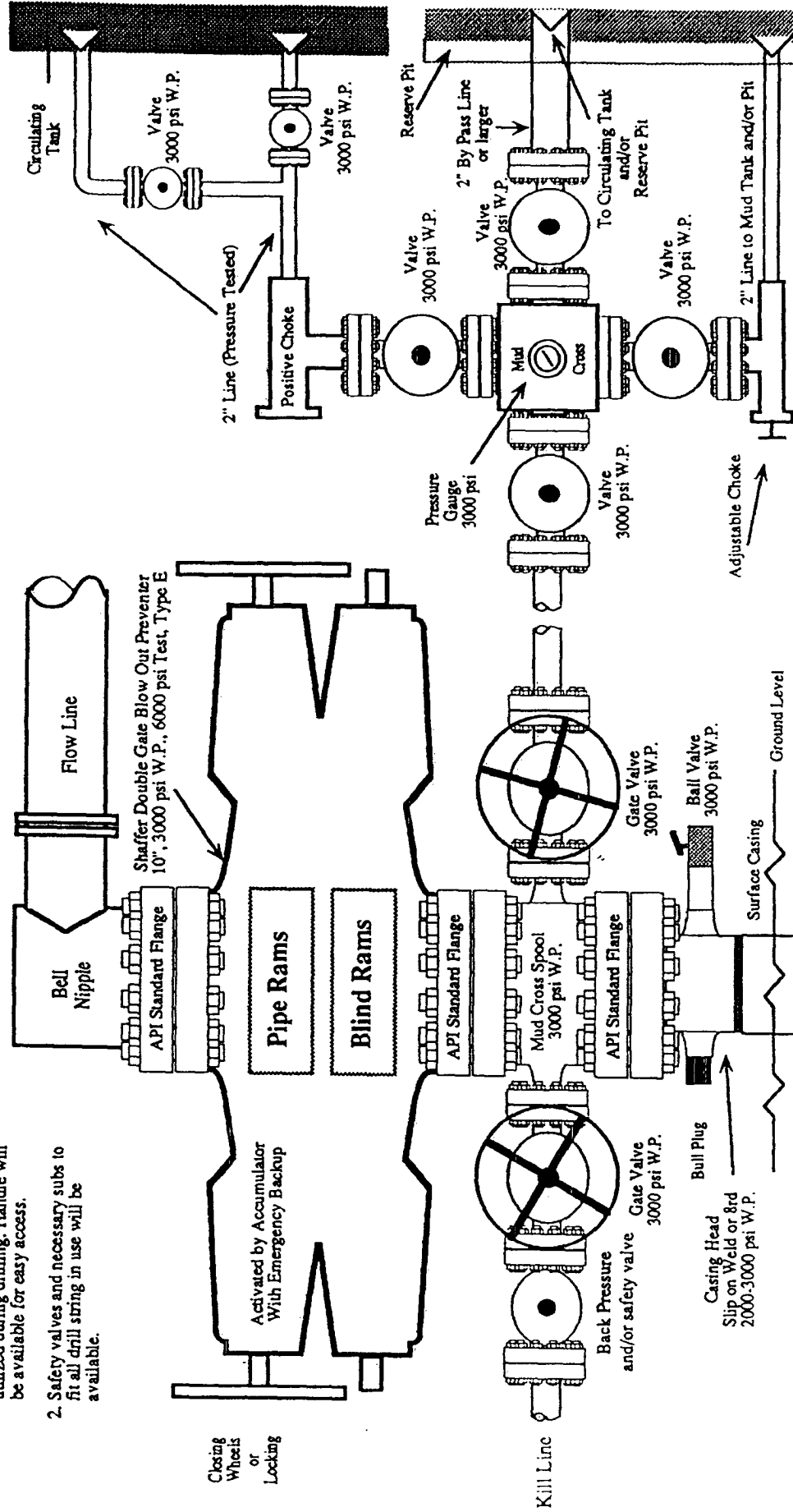

Note: This equipment is designed to meet requirements for a 2-M rating standard per 43 CFR part 3160 (amended). Proper operation and testing of equipment will be carried out per standard. 2,000 psi equipment can be substituted in the drawing to meet minimum requirements per standard.

Elm Ridge Exploration Company, LLC
Bisti Coal 17 Com 2-T
2210' FNL & 1740' FWL
Sec. 17, T. 25 N., R. 12 W.
San Juan County, New Mexico

PAGE 13

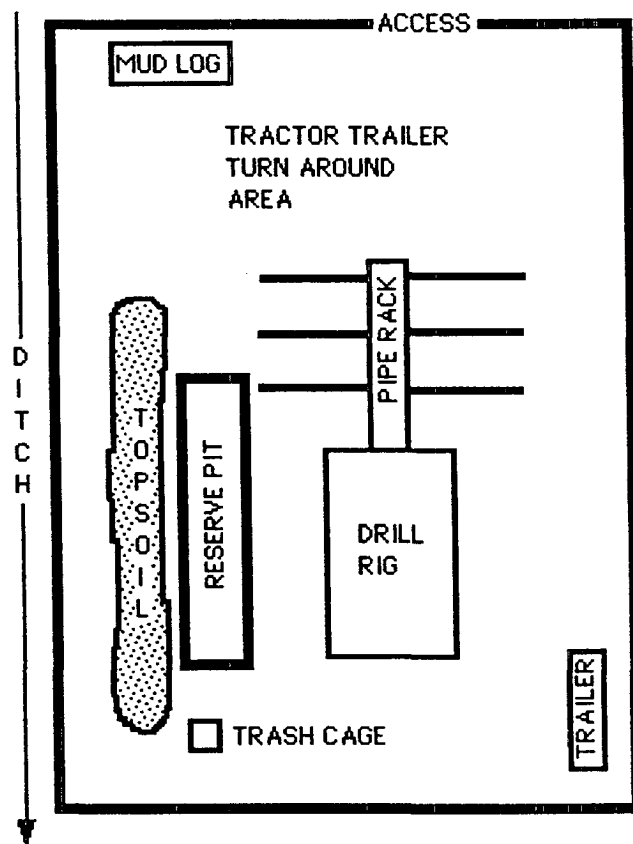

Bisti Coal 17 COM # 2 T

well pad and section

Proposed Road & Gas Pipeline

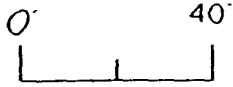

Scale 1" = 40'

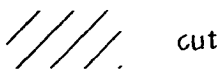

cut



fill

□ set stake & pin flag

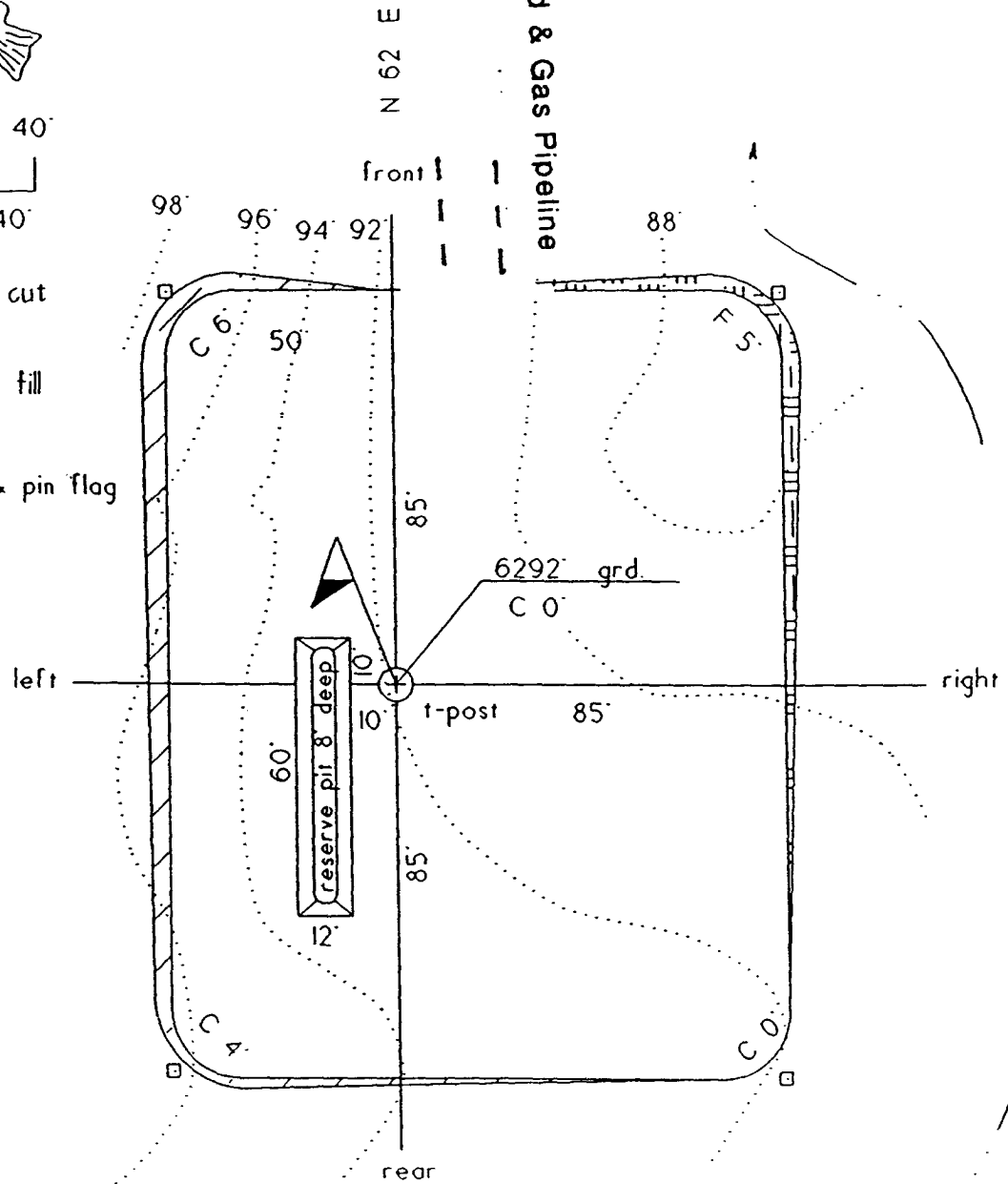

section