

District I
1625 N. French Dr., Hobbs, NM 88240
District II
1301 W. Grand Avenue, Artesia, NM 88210
District III
1000 Rio Brazos Road, Aztec, NM 87410
District IV
1220 S. St. Francis Dr., Santa Fe, NM 87505

State of New Mexico
Energy Minerals and Natural Resources

Form C-144
June 1, 2004

Oil Conservation Division
1220 South St. Francis Dr.
Santa Fe, NM 87505

For drilling and production facilities, submit to appropriate NMOCD District Office.
For downstream facilities, submit to Santa Fe office

Pit or Below-Grade Tank Registration or Closure

Is pit or below-grade tank covered by a "general plan"? Yes ☐ No ☒

Type of action: Registration of a pit or below-grade tank ☐ Closure of a pit or below-grade tank ☒

Operator: Robert L. Bayless Producer LLC Telephone: 505-326-2659 e-mail address: trm@rlbayless.com
Address: PO Box 168, Farmington, NM 87499
Facility or well name: Trinity #1 API #: 30 045 32493 U/L or Qtr/Qtr NWNW Sec 14 T 30N R 12W
County: San Juan Latitude _____ Longitude _____ NAD: 1927 ☐ 1983 ☐
Surface Owner: Federal ☐ State ☐ Private ☒ Indian ☐

Pit	Below-grade tank	
Type: Drilling <input checked="" type="checkbox"/> Production <input type="checkbox"/> Disposal <input type="checkbox"/> Workover <input type="checkbox"/> Emergency <input type="checkbox"/> Lined <input checked="" type="checkbox"/> Unlined <input type="checkbox"/> Liner type: Synthetic <input checked="" type="checkbox"/> Thickness <u>12</u> mil Clay <input type="checkbox"/> Pit Volume <u>1900</u> bbl	Volume: _____ bbl Type of fluid: _____ Construction material: _____ Double-walled, with leak detection? Yes <input type="checkbox"/> If not, explain why not: _____	
Depth to ground water (vertical distance from bottom of pit to seasonal high water elevation of ground water.)	Less than 50 feet	(20 points)
	50 feet or more, but less than 100 feet xxx	(10 points)
	100 feet or more	(0 points)
Wellhead protection area: (Less than 200 feet from a private domestic water source, or less than 1000 feet from all other water sources.)	Yes	(20 points)
	No XXX	(0 points)
Distance to surface water: (horizontal distance to all wetlands, playas, irrigation canals, ditches, and perennial and ephemeral watercourses.)	Less than 200 feet	(20 points)
	200 feet or more, but less than 1000 feet	(10 points)
	1000 feet or more XXX	(0 points)
Ranking Score (Total Points)		

If this is a pit closure: (1) Attach a diagram of the facility showing the pit's relationship to other equipment and tanks. (2) Indicate disposal location: (check the onsite box if you are burying in place) onsite ☒ offsite ☐ If offsite, name of facility _____. (3) Attach a general description of remedial action taken including remediation start date and end date. (4) Groundwater encountered: No ☐ Yes ☐ If yes, show depth below ground surface _____ ft. and attach sample results. (5) Attach soil sample results and a diagram of sample locations and excavations.

Additional Comments: Fruitland coal well drilled with fresh water.

I hereby certify that the information above is true and complete to the best of my knowledge and belief. I further certify that the above-described pit or below-grade tank has been/will be constructed or closed according to NMOCD guidelines XX, a general permit ☐, or an (attached) alternative/OCD-approved plan ☐.

Date: 1/12/2006

Printed Name/Title Tom McCarthy

Signature Tom McCarthy

Your certification and NMOCD approval of this application/closure does not relieve the operator of liability should the contents of the pit or tank contaminate ground water or otherwise endanger public health or the environment. Nor does it relieve the operator of its responsibility for compliance with any other federal, state, or local laws and/or regulations.

Approval: DEPUTY OIL & GAS INSPECTOR, DIST. 4

Printed Name/Title _____

Signature Denny Foy

Date: JAN 13 2006

ROBERT L. BAYLESS, PRODUCER LLC
 TRINITY #1
 700' FNL & 1000' FWL
 Sec. 14, T30N, R12W, NMPM
 San Juan Co., NM



200522318 12/05/2005 02:13P
 4 of 5 B1423 P435 R 17.00 D 0.00
 San Juan County, NM Clerk FRAN HANHARDT

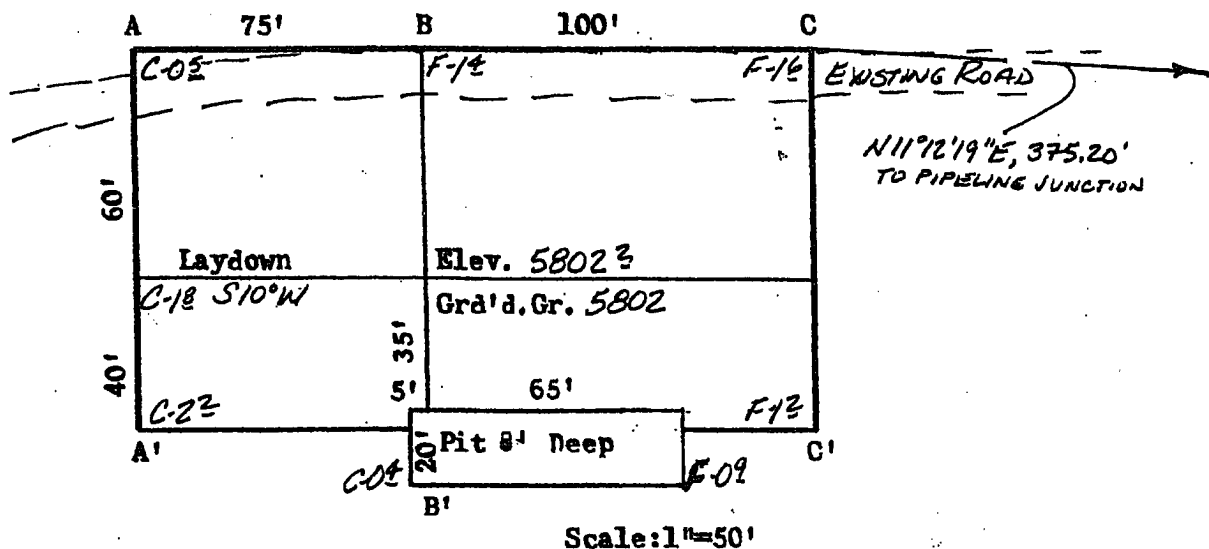

Scale: 1" = 50'



A-A'	Vert.: 1" = 30'	Horiz.: 1" = 50'	C/L
5800	---	---	---
5790	---	---	---
	---	---	---

B-B'	Vert.: 1" = 30'	Horiz.: 1" = 50'	C/L
5800	---	---	---
5790	---	---	---
	---	---	---

C-C'	Vert.: 1" = 30'	Horiz.: 1" = 50'	C/L
5800	---	---	---
5790	---	---	---
	---	---	---