

UNITED STATES
DEPARTMENT OF THE INTERIOR
BUREAU OF LAND MANAGEMENTFORM APPROVED
OMB NO. 1004-0135
Expires: July 31, 2010**SUNDRY NOTICES AND REPORTS ON WELLS**
*Do not use this form for proposals to drill or to re-enter an abandoned well. Use form 3160-3 (APD) for such proposals.***SUBMIT IN TRIPLICATE - Other instructions on reverse side.**

1. Type of Well <input type="checkbox"/> Oil Well <input checked="" type="checkbox"/> Gas Well <input type="checkbox"/> Other	8. Well Name and No. TAPP 3
2. Name of Operator BP AMERICA PRODUCTION COMPANY Contact: TOYA COLVIN Email: Toya.Colvin@bp.com	9. API Well No. 30-045-23816-00-C1
3a. Address 501 WESTLAKE PARK BLVD. THREE ELDRIGE PLACE HOUSTON, TX 77079	10. Field and Pool, or Exploratory BASIN DAKOTA BLANCO MESAVERDE
3b. Phone No. (include area code) Ph: 281-366-7148	11. County or Parish, and State SAN JUAN COUNTY, NM
4. Location of Well (Footage, Sec., T., R., M., or Survey Description) Sec 22 T28N R8W SWNE 1850FNL 1640FEL 36.648972 N Lat, 107.664261 W Lon	

12. CHECK APPROPRIATE BOX(ES) TO INDICATE NATURE OF NOTICE, REPORT, OR OTHER DATA

TYPE OF SUBMISSION	TYPE OF ACTION			
<input checked="" type="checkbox"/> Notice of Intent	<input type="checkbox"/> Acidize	<input type="checkbox"/> Deepen	<input type="checkbox"/> Production (Start/Resume)	<input type="checkbox"/> Water Shut-Off
<input type="checkbox"/> Subsequent Report	<input type="checkbox"/> Alter Casing	<input type="checkbox"/> Fracture Treat	<input type="checkbox"/> Reclamation	<input type="checkbox"/> Well Integrity
<input type="checkbox"/> Final Abandonment Notice	<input type="checkbox"/> Casing Repair	<input type="checkbox"/> New Construction	<input type="checkbox"/> Recomplete	<input checked="" type="checkbox"/> Other
	<input type="checkbox"/> Change Plans	<input type="checkbox"/> Plug and Abandon	<input type="checkbox"/> Temporarily Abandon	Workover Operations
	<input type="checkbox"/> Convert to Injection	<input type="checkbox"/> Plug Back	<input type="checkbox"/> Water Disposal	

13. Describe Proposed or Completed Operation (clearly state all pertinent details, including estimated starting date of any proposed work and approximate duration thereof. If the proposal is to deepen directionally or recompleat horizontally, give subsurface locations and measured and true vertical depths of all pertinent markers and zones. Attach the Bond under which the work will be performed or provide the Bond No. on file with BLM/BIA. Required subsequent reports shall be filed within 30 days following completion of the involved operations. If the operation results in a multiple completion or recompleat in a new interval, a Form 3160-4 shall be filed once testing has been completed. Final Abandonment Notices shall be filed only after all requirements, including reclamation, have been completed, and the operator has determined that the site is ready for final inspection.)

BP submitted & received approval to re-perforate the subject well November 2015 from the BLM and NMOCD. BP would like to update the procedure of our re-perf operations.

Please see the attached updated procedure including wellbore diagrams and C-102 plats.

DHC 2153

In accordance with NMOCD Pit Rule 19.15.17.9 NMAC, BP will use a closed-loop system during operations.

OIL CONS. DIV DIST. 3**AUG 17 2016**

14. I hereby certify that the foregoing is true and correct. Electronic Submission #347649 verified by the BLM Well Information System For BP AMERICA PRODUCTION COMPANY, sent to the Farmington Committed to AFMSS for processing by WILLIAM TAMBEKOU on 08/12/2016 (16WMT0408SE)	
Name (Printed/Typed) TOYA COLVIN	Title REGULATORY ANALYST
Signature (Electronic Submission)	Date 08/11/2016

THIS SPACE FOR FEDERAL OR STATE OFFICE USE

Approved By <u>WILLIAM TAMBEKOU</u>	Title <u>PETROLEUM ENGINEER</u>	Date <u>08/12/2016</u>
Conditions of approval, if any, are attached. Approval of this notice does not warrant or certify that the applicant holds legal or equitable title to those rights in the subject lease which would entitle the applicant to conduct operations thereon.		
Office Farmington		

Title 18 U.S.C. Section 1001 and Title 43 U.S.C. Section 1212, make it a crime for any person knowingly and willfully to make to any department or agency of the United States any false, fictitious or fraudulent statements or representations as to any matter within its jurisdiction.

**** BLM REVISED ** BLM REVISED ** BLM REVISED ** BLM REVISED ** BLM REVISED ******NMOCD**

TAPP 003-MV/DK

API # 30-045-23816-00

Location: Unit G - Sec 22 - T28N - R08W

San Juan County, New Mexico

Reason/Background for Job

The proposed work is to pull the current completion, set a plug above the active Mesaverde perforations, recomplete to the Cliffhouse interval of the Mesaverde, and downhole comingle with the existing Mesaverde and Dakota formations.

Basic job procedure

1. Pull tubing
2. Set 4-1/2" composite plug @ +/- 4100' KB
3. Cement squeeze 4-1/2" liner @ +/- 3950' KB
4. Perforate Cliffhouse formation (+/- 3865'-4100'KB gross interval)
5. Fracture stimulate Cliffhouse formation
6. Drill out/Clean out to PBTD
7. Run production tubing and downhole comingle Mesaverde & Dakota
8. Land tubing @ +/- 6625' KB
9. Return well to production



Current WBD

GL: 5872'
KB: 11'

TAPP 003-MV/DK

Mesaverde/Dakota
API # 300452381600
SEC 22, T28N, R8W
NEW MEXICO

Deviation Survey:

234	0.5
711	0.75
1211	1
1304	1.5
1804	1.25
2308	1.5
3186	1
3400	0.75
3914	1
4318	1
5191	1.25
5688	1
6181	1.75
6524	5.75
6874	6.5

Formation Tops

Cliffhouse	3988
Menefee	4090
Pt. Lookout	5690
Graneros Ss	6620
Dakota	6680

Tubing Details

2-3/8", 4.7#, J-55 @ 6775'
(tbg is normalized)

Nipple Data

Stop in X-nipple @ 6771 w/m 8/26/13
X-Nipple @ 6771
F-Nipple @ 6776'

End of Tubing
6775'

Updated 9/23/15

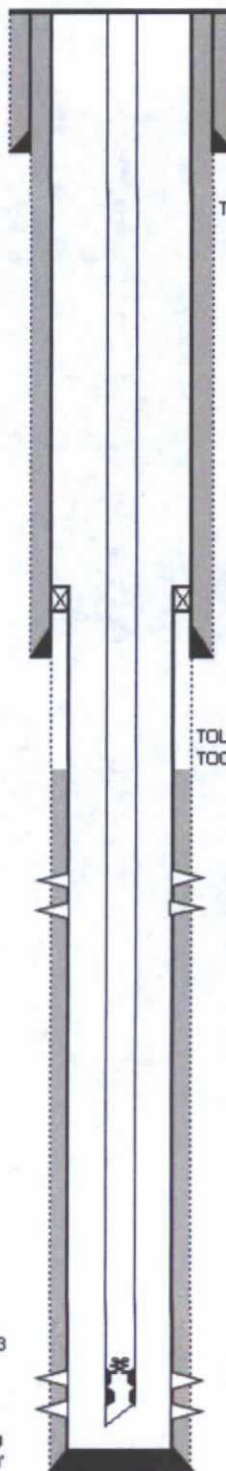

TOC: Surface (circ. 8 bbls)

Surface Casing Data

12-1/4" Hole
9-5/8", 36#, K-55 @ 233'
225 sxs cls B cmt

TOC: Surface (circ.)

Production Casing Data

8-3/4" Hole
7", 23#, K-55 ST&C @ 3400'
500 sxs 50/50 poz, tail w/ 150 sxs cls B cmt

TOL: 3254' (TIW)

TOC: est. @ 4000' (CBL 4/14/06)

Mesaverde Completion

4254'-4438' gross (2spf), frac w/ 234,451# sand & N2 foam
4530'-4734' gross (2spf), frac w/ 183,656# 16/30 Brady sand & N2 foam

Dakota Completion

6620'-6838' gross (2spf)
frac w/ 80k# 20/40 & 25k# 10/20, 30# X-L gel

Production Liner Data

6-1/4" Hole
4-1/2", 10.5#, K-55 @ 3254'-6890'
260 sxs 50/50 poz, tail w/ 100 sxs cls B cmt

PBTD: 6869'
Total Depth: 6900'



Proposed WBD

GL: 5872'
KB: 11'

TAPP 003-MV/DK

Mesaverde/Dakota
API # 300452381600
SEC 22, T28N, R8W
NEW MEXICO

Deviation Survey:

234	0.5
711	0.75
1211	1
1304	1.5
1804	1.25
2308	1.5
3186	1
3400	0.75
3914	1
4318	1
5191	1.25
5698	1
6181	1.75
6524	5.75
6874	6.5

Formation Tops

Cliffhouse	3988
Menefee	4090
Pt. Lookout	5690
Graneros Ss	6620
Dakota	6680

Tubing Details

2-3/8", 4.7#, J-55 @ 6625' KB

Nipple Data

1.90" FSV (notch up) on top of F-nipple
F-Nipple @ +/- 6622' KB

End of Tubing
6625' KB

PBTD: 6869'
Total Depth: 6900'

TOC: Surface (circ. 8 bbls)

Surface Casing Data

12-1/4" Hole
9-5/8", 36#, K-55 @ 233'
225 sxs cls B omt

TOC: Surface (circ.)

Production Casing Data

8-3/4" Hole
7", 23#, K-55 ST&C @ 3400'
500 sxs 50/50 poz, tail w/ 150 sxs cls B omt

TOL: 3254' (TIW)

TOC: est. @ 4000' (CBL 4/14/06)

Sqz holes @ +/- 3950' KB

Mesaverde Completion

Cliffhouse: +/- 3865'-4100' KB gross
4254'-4438' gross (2spf), frao w/ 234,451# sand & N2 foam
4590'-4734' gross (2spf), frao w/ 183,656# 16/30 Brady sand & N2 foam

Dakota Completion

6620'-6838' gross (2spf)
frao w/ 80k# 20/40 & 25k# 10/20, 30# X-L gel

Production Liner Data

6-1/4" Hole
4-1/2", 10.5#, K-55 @ 3254'-6890'
260sxs 50/50 poz, tail w/ 100 sxs cls B omt

Updated 8/4/16

District I
1625 N. French Dr., Hobbs, NM 88240
District II
1301 W. Grand Avenue, Artesia, NM 88210
District III
1000 Rio Brazos Rd., Aztec, NM 87410
District IV
1220 S. St. Francis Dr., Santa Fe, NM 87505

State of New Mexico
Energy, Minerals & Natural Resources Department
OIL CONSERVATION DIVISION
1220 South St. Francis Dr.
Santa Fe, NM 87505

Form C-102
Revised July 16, 2010
Submit one copy to appropriate
District Office
☐ AMENDED REPORT

WELL LOCATION AND ACREAGE DEDICATION PLAT

¹ API Number 30-045-23816	² Pool Code 71599	³ Pool Name Basin Dakota
⁴ Property Code 001159	⁵ Property Name Tapp	⁶ Well Number 3
⁷ OGRID No. 000778	⁸ Operator Name BP America Production Company	⁹ Elevation 5872

¹⁰ Surface Location

UL or lot no. G	Section 22	Township 28N	Range 08W	Lot Idn	Feet from the 1850	North/South line North	Feet from the 1640	East/West line East	County San Juan
--------------------	---------------	-----------------	--------------	---------	-----------------------	---------------------------	-----------------------	------------------------	--------------------

¹¹ Bottom Hole Location If Different From Surface

UL or lot no.	Section	Township	Range	Lot Idn	Feet from the	North/South line	Feet from the	East/West line	County
¹² Dedicated Acres 320	¹³ Joint or Infill	¹⁴ Consolidation Code	¹⁵ Order No. R-11363						

No allowable will be assigned to this completion until all interests have been consolidated or a non-standard unit has been approved by the division.

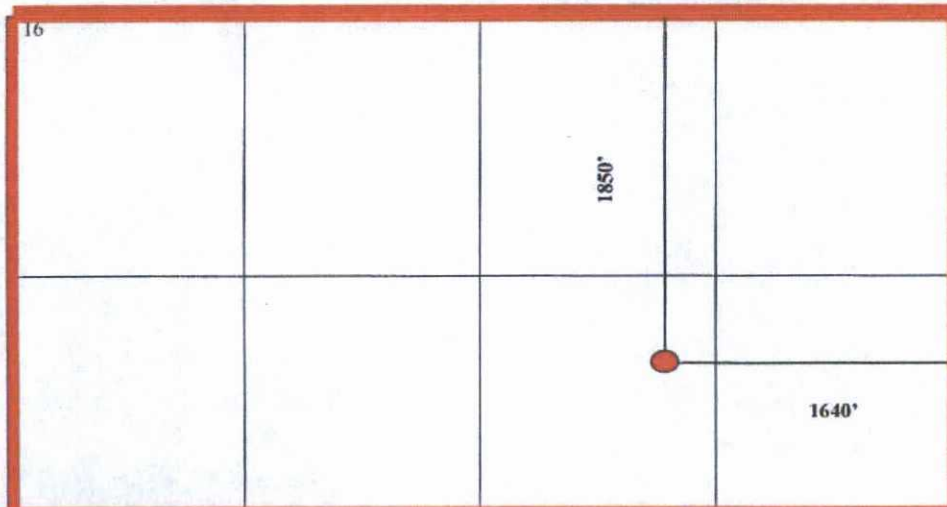

¹⁷ **OPERATOR CERTIFICATION**

I hereby certify that the information contained herein is true and complete to the best of my knowledge and belief, and that this organization either owns a working interest or unleased mineral interest in the land including the proposed bottom hole location or has a right to drill this well at this location pursuant to a contract with an owner of such a mineral or working interest, or to a voluntary pooling agreement or a compulsory pooling order heretofore entered by the division.

Tova Colvin 11/16/15
Signature Date

Tova Colvin
Printed Name

Tova.Colvin@bp.com
E-mail Address

¹⁸ **SURVEYOR CERTIFICATION**

I hereby certify that the well location shown on this plat was plotted from field notes of actual surveys made by me or under my supervision, and that the same is true and correct to the best of my belief.

Date of Survey
Signature and Seal of Professional Surveyor:

Previously Filed

Certificate Number

District I
1625 N. French Dr., Hobbs, NM 88240
District II
1301 W. Grand Avenue, Artesia, NM 88210
District III
1000 Rio Brazos Rd., Aztec, NM 87410
District IV
1220 S. St. Francis Dr., Santa Fe, NM 87505

State of New Mexico
Energy, Minerals & Natural Resources Department
OIL CONSERVATION DIVISION
1220 South St. Francis Dr.
Santa Fe, NM 87505

Form C-102
Revised July 16, 2010
Submit one copy to appropriate
District Office

☐ AMENDED REPORT

WELL LOCATION AND ACREAGE DEDICATION PLAT

¹ API Number 30-045-23816	² Pool Code 72319	³ Pool Name Blanco-Mesaverde
⁴ Property Code 001159	⁵ Property Name Tapp	⁶ Well Number 3
⁷ OGRID No. 000778	⁸ Operator Name BP America Production Company	⁹ Elevation 5872

¹⁰ Surface Location

UL or lot no. G	Section 22	Township 28N	Range 08W	Lot Idn	Feet from the 1850	North/South line North	Feet from the 1640	East/West line East	County San Juan
--------------------	---------------	-----------------	--------------	---------	-----------------------	---------------------------	-----------------------	------------------------	--------------------

¹¹ Bottom Hole Location If Different From Surface

UL or lot no.	Section	Township	Range	Lot Idn	Feet from the	North/South line	Feet from the	East/West line	County
---------------	---------	----------	-------	---------	---------------	------------------	---------------	----------------	--------

¹² Dedicated Acres 320	¹³ Joint or Infill	¹⁴ Consolidation Code	¹⁵ Order No. R-11363
--------------------------------------	-------------------------------	----------------------------------	------------------------------------

No allowable will be assigned to this completion until all interests have been consolidated or a non-standard unit has been approved by the division.

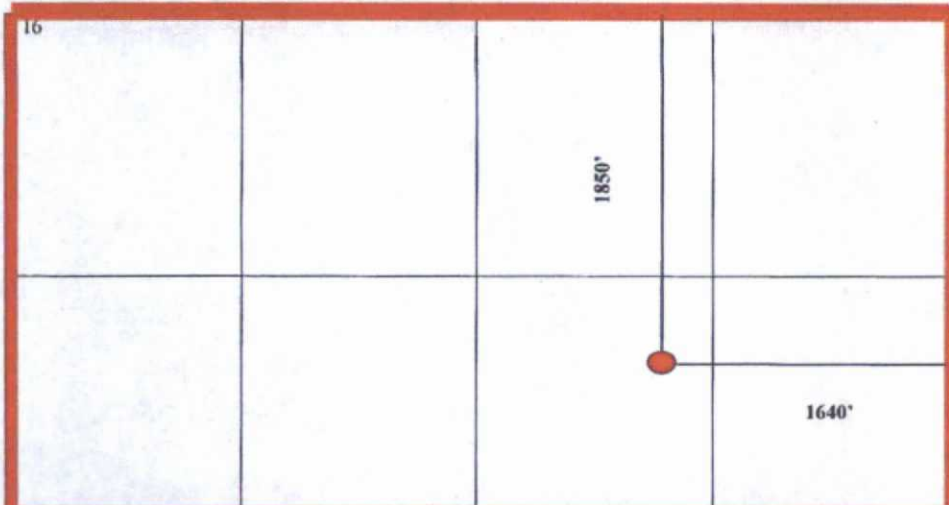

¹⁷ OPERATOR CERTIFICATION

I hereby certify that the information contained herein is true and complete to the best of my knowledge and belief, and that this organization either owns a working interest or unleased mineral interest in the land including the proposed bottom hole location or has a right to drill this well at this location pursuant to a contract with an owner of such a mineral or working interest, or to a voluntary pooling agreement or a compulsory pooling order heretofore entered by the division.

Toya Colvin 11/16/15
Signature Date

Toya Colvin
Printed Name

Toya.Colvin@bp.com
E-mail Address

¹⁸ SURVEYOR CERTIFICATION

I hereby certify that the well location shown on this plat was plotted from field notes of actual surveys made by me or under my supervision, and that the same is true and correct to the best of my belief.

Date of Survey

Signature and Seal of Professional Surveyor:

Previously Filed

Certificate Number