

UNITED STATES
DEPARTMENT OF THE INTERIOR
BUREAU OF LAND MANAGEMENT

RECEIVED

JAN 30 2017

FORM APPROVED
OMB No. 1004-0137
Expires: July 31, 2010

Farmington Field Office
Bureau of Land Management

SF-080724-A

SUNDRY NOTICES AND REPORTS ON WELLS
Do not use this form for proposals to drill or to re-enter an abandoned well. Use Form 3160-3 (APD) for such proposals.

SUBMIT IN TRIPLICATE - Other instructions on page 2.

1. Type of Well

☐ Oil Well ☒ Gas Well ☐ Other

2. Name of Operator

Burlington Resources Oil & Gas Company LP

3a. Address

PO Box 4289, Farmington, NM 87499

3b. Phone No. (include area code)

(505) 326-9700

4. Location of Well (Footage, Sec., T., R., M., or Survey Description)

Surface Unit K (NESW), 1800' FSL & 1845' FWL, Sec. 12, T28N, R10W

5. Lease Serial No.

NMNM-110594

8. Well Name and No.

Zachry 38

9. API Well No.

30-045-25464

10. Field and Pool or Exploratory Area

Armenta Gallup

11. Country or Parish, State

San Juan, New Mexico

12. CHECK THE APPROPRIATE BOX(ES) TO INDICATE NATURE OF NOTICE, REPORT OR OTHER DATA

TYPE OF SUBMISSION

☒ Notice of Intent

☐ Subsequent Report

☐ Final Abandonment Notice

TYPE OF ACTION

☐ Acidize

☐ Alter Casing

☐ Casing Repair

☐ Change Plans

☐ Convert to Injection

☐ Deepen

☐ Fracture Treat

☐ New Construction

☐ Plug and Abandon

☐ Plug Back

☐ Production (Start/Resume)

☐ Reclamation

☒ Recomplete

☐ Temporarily Abandon

☐ Water Disposal

☐ Water Shut-Off

☐ Well Integrity

☐ Other

13. Describe Proposed or Completed Operation: Clearly state all pertinent details, including estimated starting date of any proposed work and approximate duration thereof. If the proposal is to deepen directionally or recompleat horizontally, give subsurface locations and measured and true vertical depths of all pertinent markers and zones. Attach the bond under which the work will be performed or provide the Bond No. on file with BLM/BIA. Required subsequent reports must be filed within 30 days following completion of the involved operations. If the operation results in a multiple completion or recompleat in a new interval, a Form 3160-4 must be filed once Testing has been completed. Final Abandonment Notices must be filed only after all requirements, including reclamation, have been completed and the operator has determined that the site is ready for final inspection.)

Plans are to recompleat the subject well in the Mesaverde formation and downhole commingle the existing Gallup with the Mesaverde. Attached is the MV plat, procedure and current wellbore schematic. The DHC application will be submitted and approved before the work proceeds. A Closed Loop system will be utilized.

OIL CONS. DIV DIST. 3

FEB 06 2017

BLM'S APPROVAL OR ACCEPTANCE OF THIS ACTION DOES NOT RELIEVE THE LESSEE AND OPERATOR FROM OBTAINING ANY OTHER AUTHORIZATION REQUIRED FOR OPERATIONS ON FEDERAL AND INDIAN LANDS

14. I hereby certify that the foregoing is true and correct. Name (Printed/Typed)

Dollie L. Busse

Title Regulatory Technician

Signature

Date

11/31/2017

THIS SPACE FOR FEDERAL OR STATE OFFICE USE

Approved by

William Tambekou

Title Petroleum Engineer

Date

2/1/2017

Conditions of approval, if any, are attached. Approval of this notice does not warrant or certify that the applicant holds legal or equitable title to those rights in the subject lease which would entitle the applicant to conduct operations thereon.

Office

FFO

Title 18 U.S.C. Section 1001 and Title 43 U.S.C. Section 1212, make it a crime for any person knowingly and willfully to make to any department or agency of the United States any false, fictitious or fraudulent statements or representations as to any matter within its jurisdiction.

(Instruction on page 2)

NMOCD HOLD C104 FOR DHC

District I1625 N. French Dr., Hobbs, NM 88240
Phone:(575) 393-6161 Fax:(575) 393-0720**District II**811 S. First St., Artesia, NM 88210
Phone:(575) 748-1283 Fax:(575) 748-9720**District III**1000 Rio Brazos Rd., Aztec, NM 87410
Phone:(505) 334-6178 Fax:(505) 334-6170**District IV**1220 S. St Francis Dr., Santa Fe, NM 87505
Phone:(505) 476-3470 Fax:(505) 476-3462

State of New Mexico
Energy, Minerals and Natural
Resources
Oil Conservation Division
1220 S. St Francis Dr.
Santa Fe, NM 87505

Form C-102
August 1, 2011

Permit 230728

WELL LOCATION AND ACREAGE DEDICATION PLAT

1. API Number 30-045-25464	2. Pool Code 72319	3. Pool Name BLANCO-MESAVERDE (PRORATED GAS)
4. Property Code 7654	5. Property Name ZACHRY	6. Well No. 038
7. OGRID No. 14538	8. Operator Name BURLINGTON RESOURCES OIL & GAS COMPANY LP	9. Elevation 5664

10. Surface Location

UL - Lot K	Section 12	Township 28N	Range 10W	Lot Idn	Feet From 1800	N/S Line S	Feet From 1845	E/W Line W	County SAN JUAN
---------------	---------------	-----------------	--------------	---------	-------------------	---------------	-------------------	---------------	--------------------

11. Bottom Hole Location If Different From Surface

UL - Lot	Section	Township	Range	Lot Idn	Feet From	N/S Line	Feet From	E/W Line	County
12. Dedicated Acres 270.11			13. Joint or Infill		14. Consolidation Code			15. Order No.	

NO ALLOWABLE WILL BE ASSIGNED TO THIS COMPLETION UNTIL ALL INTERESTS HAVE BEEN CONSOLIDATED OR A NON-STANDARD UNIT HAS BEEN APPROVED BY THE DIVISION

SEE ATTACHED	<p align="center">OPERATOR CERTIFICATION</p> <p><i>I hereby certify that the information contained herein is true and complete to the best of my knowledge and belief, and that this organization either owns a working interest or unleased mineral interest in the land including the proposed bottom hole location(s) or has a right to drill this well at this location pursuant to a contract with an owner of such a mineral or working interest, or to a voluntary pooling agreement or a compulsory pooling order heretofore entered by the division.</i></p> <p>E-Signed By: Dollie L. Busse </p> <p>Title: Regulatory Technician</p> <p>Date: 1/12/2017</p>
	<p align="center">SURVEYOR CERTIFICATION</p> <p><i>I hereby certify that the well location shown on this plat was plotted from field notes of actual surveys made by me or under my supervision, and that the same is true and correct to the best of my belief.</i></p> <p>Surveyed By: James P. Leese</p> <p>Date of Survey: 7/28/1982</p> <p>Certificate Number: 1463</p>

Zachry 38 – Mesaverde

Non-standard spacing

T28N-R10W-Sec. 12: Lot 1 (NESE – 27.29 ac), Lot 2 (NWSE – 28.46 ac), Lot 3 (NESW – 27.88 ac), Lot 4 (NWSW – 26.48 ac) and S/2S/2

Total acres: 270.11

Federal lease NMNM01772A (427082000) – Lot 1 (NESE)

Federal lease NMSF080724A (419789000) – Lots 2 (NWSE), Lot 3 (NESW), Lot 4 (NWSW) and S/2S/2

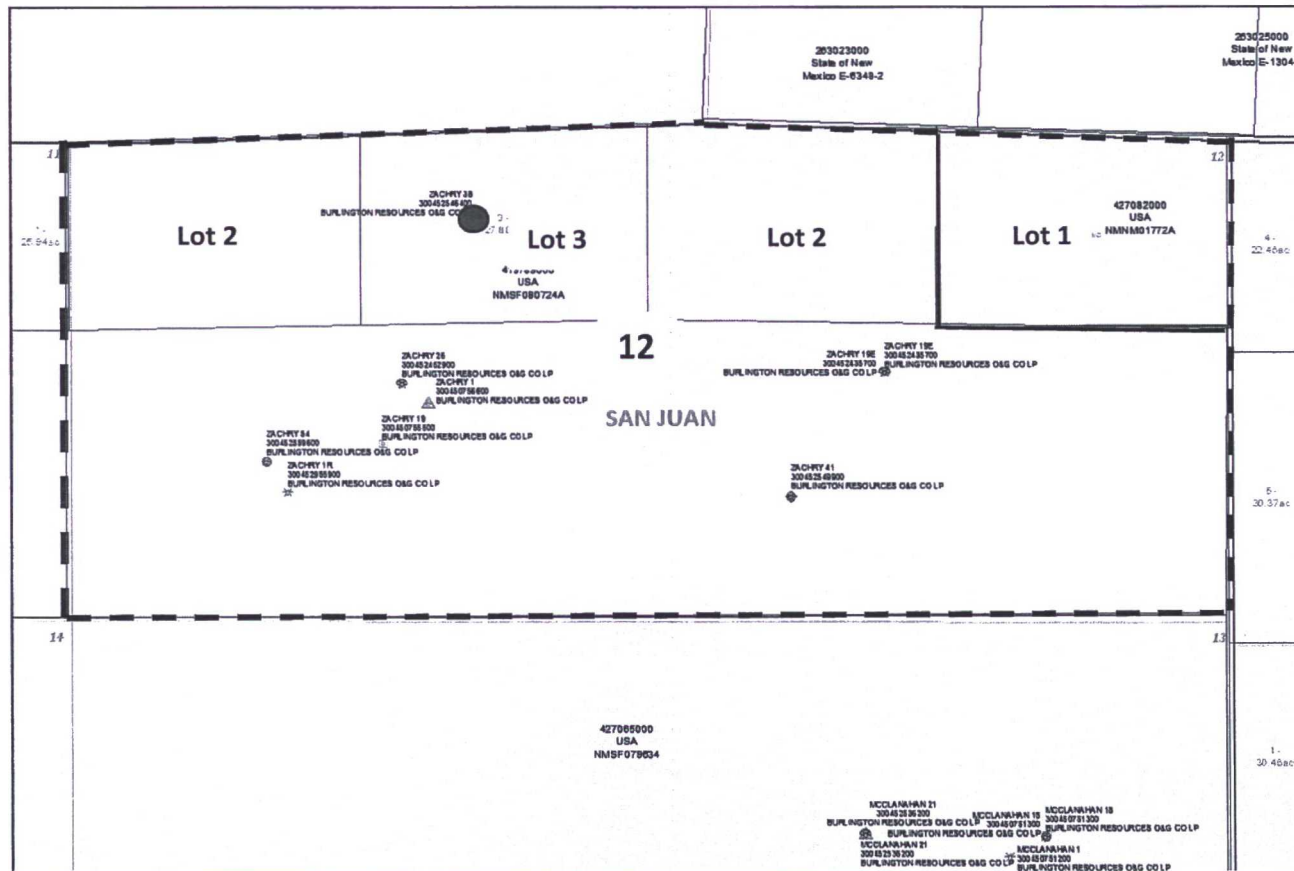

Zachry #38

Sec 12-T28N-R10W, Unit K

API# 3004525464

Mesaverde Recompletion Sundry

1/10/2017

Procedure:

1. MIRU service rig and associated equipment; test BOP.
2. TOOH with 2 3/8" tubing set at 6,014'.
3. Set a 7-5/8" composite bridge plug at +/- 4,650' to isolate the Gallup.
4. Load the hole and pressure test the casing to frac pressure.
5. MIRU wireline truck and run a CBL from the CBP at +/- 4,650' to surface.
6. N/D BOP, N/U frac stack and pressure test.
7. Perforate and frac the Mesaverde in two stages (Point Lookout and Menefee).
8. Isolate frac stages with a composite bridge plug.
9. Nipple down frac stack, nipple up BOP and test.
10. TIH with a mill and drill out top isolation plug and Mesaverde frac plug.
11. Clean out to Gallup isolation plug and, when water and sand rates are acceptable, flow test the Mesaverde.
12. Drill out Gallup isolation plug and cleanout to PBTD of 6,107'. TOOH.
13. TIH and land production tubing. Get a commingled Gallup / Mesaverde flow rate.
14. Release service rig and turn well over to production.



Schematic - Current

ZACHRY #38

District NORTH	Field Name ARMENTA GALLUP	API / UWI 3004525464	County SAN JUAN	State/Province NEW MEXICO
Original Spud Date 11/3/1982	Surface Legal Location 012-028N-010W-K	East/West Distance (ft) 1,485.00	East/West Reference FWL	North/South Distance (ft) 1,800.00
		North/South Reference FSL		

Original Hole, 1/10/2017 8:18:32 AM

MD (ftKB)	Vertical schematic (actual)	Formation Tops
12.1	Casing; Surface; 10 3/4 in; 40.50 lb/ft; J-55; 12.0 ftKB; 307.5 ftKB	
306.4	Surface Casing Cement; 12.0-307.5; 11/4/1982; Cemented w/ 275 sks Class B poz w/ 3% CaCl ₂ , 1/4# flocele/sk	
307.4		
318.9	Circulate 12 BBLs cmt to surface	
1,029.9	Stage Tool @ 2233'	OJO ALAMO
1,092.8	Intermediate Casing Cement; 12.0-2,232.6; 11/11/1982; Cemented w/ 575 sks 65/35 poz Class B 12% gel, 1/4# Flocele/sk 12% gilsonite/sk and 2% CaCl ₂ . Circulate cmt to surface	KIRTLAND
1,825.1		FRUITLAND
2,060.0		PICTURED CLIFFS
2,232.6	Top of TIW Liner Hanger @ 4665'	
2,235.6	Cement Squeeze; 4,665.0-4,675.0; 12/23/1982; Pressure test liner hanger - did not hold - squeeze w/ 100 sks Class B cmt w/ .6% FLA & 2% CaCl ₂ . Tested csg - OK	CHACRA
2,671.9		CLIFF HOUSE
3,634.8	Intermediate Casing Cement; 2,232.6-4,800.0; 11/11/1982; Cemented w/ 500 sks Class B 6% gel, 1/4# flocele/sk & 12 1/2# gilsonite/sk tail w/ 100 sks Class B 2% CaCl ₂ TOC @ 2234' Top of Liner - Good Circulation.	POINT LOOKOUT
4,359.9		
4,665.0		
4,674.9		
4,675.2		
4,754.6		
4,756.6	Casing; Intermediate 1; 7 5/8 in; 26.40 lb/ft; K-55; 12.0 ftKB; 4,800.0 ftKB	
4,798.9		
4,799.9	12/10/82 Perf squeeze hole @ 5890' squeeze w/ 100 sks Class B w/ .6% FLA, & 2% CaCl ₂ Cement bond ok f; 5,540.0-5,564.0; 12/9/1982;	
5,470.1	12/12/82 Squeeze w/ 100 sks (118 cu.ft.) Class B w/ .6% FLA, & 2% CaCl ₂ TOC @ 5440' (CBL 12/13/82)	GALLUP
5,540.0		
5,560.0	12/10/82 Perf squeeze hole @ 5890' squeeze w/ 100 sks Class B w/ .6% FLA, & 2% CaCl ₂ Cement bond ok f; 5,575.0-5,585.0; 12/9/1982;	
5,562.0	Squeeze w/ 200 sks (238 cu.ft.) Class B w/ .6% FLA & 2% CaCl ₂ Cement bond ok from T.D. to 5575'	
5,564.0		
5,575.1		
5,585.0		
5,741.1	Cement Squeeze; 5,585.0-5,890.0; 12/9/1982; 12/10/82 Squeeze w/ 100 sks (119 cu.ft.) Class B w/ .6% FLA, & 2% CaCl ₂ Cement bond ok from T.D. to 5575'	
5,777.9		
5,876.0		
5,890.1		
5,943.9		
5,981.0		
5,982.0		
6,013.5	PBTD; 6,107.0	
6,014.1	Auto cement plug; 6,113.0-6,160.1; 11/23/1982; Automatically created cement plug from the casing cement because it had a tagged depth.	
6,088.9		
6,107.0	Casing; Production 1; 5 1/2 in; 15.50 lb/ft; K-55; 4,665.1 ftKB; 6,160.1 ftKB	
6,112.9	Production Casing Cement; 5,470.0-6,160.1; 11/23/1982; Cemented w/ 200 sks 50/50 Poz w/ 2% gel, 10% salt	
6,113.8		
6,159.1		
6,160.1	TOC @ 5470' (CBL 12/8/82)	