

UNITED STATES
DEPARTMENT OF THE INTERIOR
BUREAU OF LAND MANAGEMENT

APPLICATION FOR PERMIT TO DRILL OR REENTER

FORM APPROVED
OMB No. 1004-0137
Expires March 31, 2007

5. Lease Serial No.
SF 078988

6. If Indian, Allottee or Tribe Name

1a. Type of work: ☒ DRILL ☐ REENTER

7. If Unit or CA Agreement, Name and No.
Northeast Blanco Unit

1b. Type of Well: ☐ Oil Well ☒ Gas Well ☐ Other ☐ Single Zone ☐ Multiple Zone

8. Lease Name and Well No.
NEBU 225

2. Name of Operator
Devon Energy Production Company, L.P.

9. API Well No.
30-045-33214

3a. Address **PO Box 6459
Farmington, NM 87419**

3b. Phone No. (include area code)
505-632-0244

10. Field and Pool, or Exploratory
Rosa Pictured Cliffs

4. Location of Well (Report location clearly and in accordance with any State requirements.)*

At surface **NW SW, Unit L, 1,750' FSL & 675' FWL**

At proposed prod. zone **SE SW, Unit N, 1,120' FSL & 1,330' FWL**

11. Sec., T. R. M. or Blk. and Survey or Area

Sec. 19, T31N, R6W

14. Distance in miles and direction from nearest town or post office*
Approximately 12.8 miles

12. County or Parish

San Juan

13. State

NM

15. Distance from proposed*
location to nearest
property or lease line, ft.
(Also to nearest drig. unit line, if any) **675'**

16. No. of acres in lease
2560 Acres

17. Spacing Unit dedicated to this well
160 Acres SA

18. Distance from proposed location*
to nearest well, drilling, completed,
applied for, on this lease, ft.

19. Proposed Depth
3,463'

20. BLM/BIA Bond No. on file

21. Elevations (Show whether DF, KDB, RT, GL, etc.)
GR 6,308'

22. Approximate date work will start*
08/30/2005

23. Estimated duration
Unknown

24. Attachments

The following, completed in accordance with the requirements of Onshore Oil and Gas Order No.1, shall be attached to this form:

1. Well plat certified by a registered surveyor.
2. A Drilling Plan.
3. A Surface Use Plan (if the location is on National Forest System Lands, the SUPO shall be filed with the appropriate Forest Service Office).
4. Bond to cover the operations unless covered by an existing bond on file (see Item 20 above).
5. Operator certification
6. Such other site specific information and/or plans as may be required by the authorized officer.

25. Signature *M.S. Zimm*
Title **Senior Operations Technician**

Name (Printed/Typed)
Melisa Zimmerman

Date
6-29-05

Approved by (Signature) *[Signature]*
Title **AFM**

Name (Printed/Typed)

Office **FTO**

Date
4/17/06

Application approval does not warrant or certify that the applicant holds legal or equitable title to those rights in the subject lease which would entitle the applicant to conduct operations thereon.
Conditions of approval, if any, are attached.

Title 18 U.S.C. Section 1001 and Title 43 U.S.C. Section 1212, make it a crime for any person knowingly and willfully to make to any department or agency of the United States any false, fictitious or fraudulent statements or representations as to any matter within its jurisdiction.

*(Instructions on page 2)

HOLD C104 FOR

directional survey

NMOC

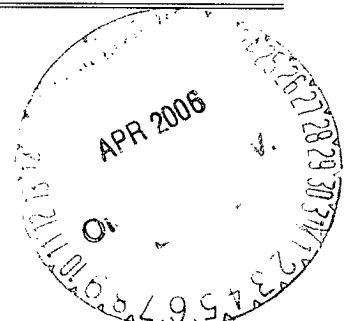

DRILLING OPERATIONS AUTHORIZED ARE
SUBJECT TO COMPLIANCE WITH ATTACHED
"GENERAL REQUIREMENTS".

This action is subject to technical and
procedural review pursuant to 43 CFR 3165.3
and appeal pursuant to 43 CFR 3165.4

District I
PO Box 1980, Hobbs NM 88241-1980
District II
PO Drawer KK, Artesia, NM 87211-0719
District III
1000 Rio Brazos Rd., Aztec, NM 87410
District IV
PO Box 2088, Santa Fe, NM 87504-2088

State of New Mexico
Energy, Minerals & Natural Resources Department

OIL CONSERVATION DIVISION
PO Box 2088
Santa Fe, NM 87504-2088

Form C-102

Revised February 21, 1994

Instructions on back

Submit to Appropriate District Office

State Lease - 4 Copies

Fee Lease - 3 Copies

☐ AMENDED REPORT

WELL LOCATION AND ACREAGE DEDICATION PLAT

1 API Number 30-45-33214		2 Pool Code 96175		3 Pool Name Rosa-Pictured Cliffs		
4 Property Code 19641		5 Property Name NEBU			6 Well Number # 225	
7 OGRID No. 6137		8 Operator Name Devon Energy Production Company, L.P.			9 Elevation 6308	

10 Surface Location

UL or Lot No.	Section	Township	Range	Lot Idn	Feet from the	North/South line	Feet from the	East/West line	County
L	19	31 N	6 W		1750	SOUTH	675	WEST	SAN JUAN

11 Bottom Hole Location If Different From Surface

UL or lot no.	Section	Township	Range	Lot Idn	Feet from the	North/South line	Feet from the	East/West line	County
N	19	31 N	6 W		1120	SOUTH	1330	WEST	SAN JUAN

12 Dedicated Acres 160	13 Joint or Infill	14 Consolidation Code	15 Order No.
----------------------------------	--------------------	-----------------------	--------------

NO ALLOWABLE WILL BE ASSIGNED TO THIS COMPLETION UNTIL ALL INTERESTS HAVE BEEN CONSOLIDATED
OR A NON-STANDARD UNIT HAS BEEN APPROVED BY THE DIVISION

<p>16</p> <p>5280(R)</p> <p>19</p> <p>675'</p> <p>1750'</p> <p>Azimuth - 133°53' 909'</p> <p>Bottom Hole Location 1120' F/SL 1330' F/WL</p> <p>5270(R)</p>	<p>17 OPERATOR CERTIFICATION</p> <p>I hereby certify that the information contained herein is true and complete to the best of my knowledge and belief.</p> <p><i>M.S. 38</i> Signature <i>Melisa E. Zimmerman</i> Printed Name <i>Sr. Operations Technician</i> Title <i>6-29-05</i> Date</p>
	<p>18 SURVEYOR CERTIFICATION</p> <p>I hereby certify that the well location shown on this plat was plotted from field notes of actual surveys made by me or under my supervision, and that the same is true and correct to the best of my belief.</p> <p>Revised Bhl Ftg: April 18, 2005 August 10, 2004</p> <p>Date of Survey Signature and Seal of Professional Surveyor <i>GARY D. VANN</i> 7016 7016 Certificate Number</p>

Submit 3 Copies To Appropriate District Office
District I
1625 N. French Dr., Hobbs, NM 88240
District II
1301 W. Grand Ave., Artesia, NM 88210
District III
1000 Rio Brazos Rd., Aztec, NM 87410
District IV
1220 S. St. Francis Dr., Santa Fe, NM 87505

State of New Mexico
Energy, Minerals and Natural Resources

Form C-103
March 4, 2004

OIL CONSERVATION DIVISION
1220 South St. Francis Dr.
Santa Fe, NM 87505

WELL API NO. 30-015-33214
5. Indicate Type of Lease STATE <input type="checkbox"/> FEE <input type="checkbox"/>
6. State Oil & Gas Lease No. SF 078988
7. Lease Name or Unit Agreement Name NORTHEAST BLANCO UNIT
8. Well Number 2253
9. OGRID Number 6137
10. Pool name or Wildcat Rosa Pictured Cliffs

SUNDRY NOTICES AND REPORTS ON WELLS
(DO NOT USE THIS FORM FOR PROPOSALS TO DRILL OR TO DEEPEN OR PLUG BACK TO A DIFFERENT RESERVOIR. USE "APPLICATION FOR PERMIT" (FORM C-101) FOR SUCH PROPOSALS.)

1. Type of Well:
Oil Well ☐ Gas Well ☒ Other

2. Name of Operator
Devon Energy Production Company, L.P.

3. Address of Operator
PO Box 6459, Navajo Dam, NM 87419

4. Well Location
Unit Letter L: 1,750' feet from the South line and 675' feet from the West line
Section 19 Township 31N Range 6W NMPM County - SAN JUAN

11. Elevation (Show whether DR, RKB, RT, GR, etc.)
GR 6,308'

Pit or Below-grade Tank Application (For pit or below-grade tank closures, a form C-144 must be attached)

Pit Location: UL L Sect 19 Twp 31N Rng 6W Pit type Drilling Depth to Groundwater >100' Distance from nearest fresh water well >1000'
Distance from nearest surface water >1000' Below-grade Tank Location UL L Sect 19 Twp 31N Rng 6W;
feet from the South line and 675' feet from the West line

12. Check Appropriate Box to Indicate Nature of Notice, Report or Other Data	
NOTICE OF INTENTION TO:	SUBSEQUENT REPORT OF:
PERFORM REMEDIAL WORK <input type="checkbox"/> PLUG AND ABANDON <input type="checkbox"/>	REMEDIAL WORK <input type="checkbox"/> ALTERING CASING <input type="checkbox"/>
TEMPORARILY ABANDON <input type="checkbox"/> CHANGE PLANS <input type="checkbox"/>	COMMENCE DRILLING OPNS. <input type="checkbox"/> PLUG AND ABANDONMENT <input type="checkbox"/>
PULL OR ALTER CASING <input type="checkbox"/> MULTIPLE COMPLETION <input type="checkbox"/>	CASING TEST AND CEMENT JOB <input type="checkbox"/>
OTHER: CONSTRUCT DRILLING PIT <input checked="" type="checkbox"/>	OTHER: <input type="checkbox"/>

13. Describe proposed or completed operations. (Clearly state all pertinent details, and give pertinent dates, including estimated date of starting any proposed work). SEE RULE 1103. For Multiple Completions: Attach wellbore diagram of proposed completion or recompletion.

14. **Devon Energy will be constructing a lined drilling pit. The closure of said pit will be in accordance with the NMOCD regulations with the cutting of the liner applying to the BLM rules.**

I hereby certify that the information above is true and complete to the best of my knowledge and belief. I further certify that any pit or below-grade tank has been/will be constructed or closed according to NMOCD guidelines ☒, a general permit ☐ or an (attached) alternative OCD-approved plan ☐.

SIGNATURE M.S. Zimmerman TITLE Sr. Operations Technician DATE 6-29-05

Type or print name Melisa Zimmerman E-mail address: Melisa.zimmerman@dmn.com Telephone No. 405-552-7917

(This space for State use)

APPROVED BY [Signature] TITLE DEPUTY OIL & GAS INSPECTOR, DIST. 43 DATE APR 19 2006
Conditions of approval, if any:

PAD LAYOUT PLAN & PROFILE
DEVON ENERGY PRODUCTION COMPANY, L.P.

Nebu # 225
 1750' F/SL 675' F/WL
 SEC. 19, T31N, R6W, N.M.P.M.
 SAN JUAN COUNTY, NEW MEXICO

Lat: 36°52'57"
 Long: 107°30'39"

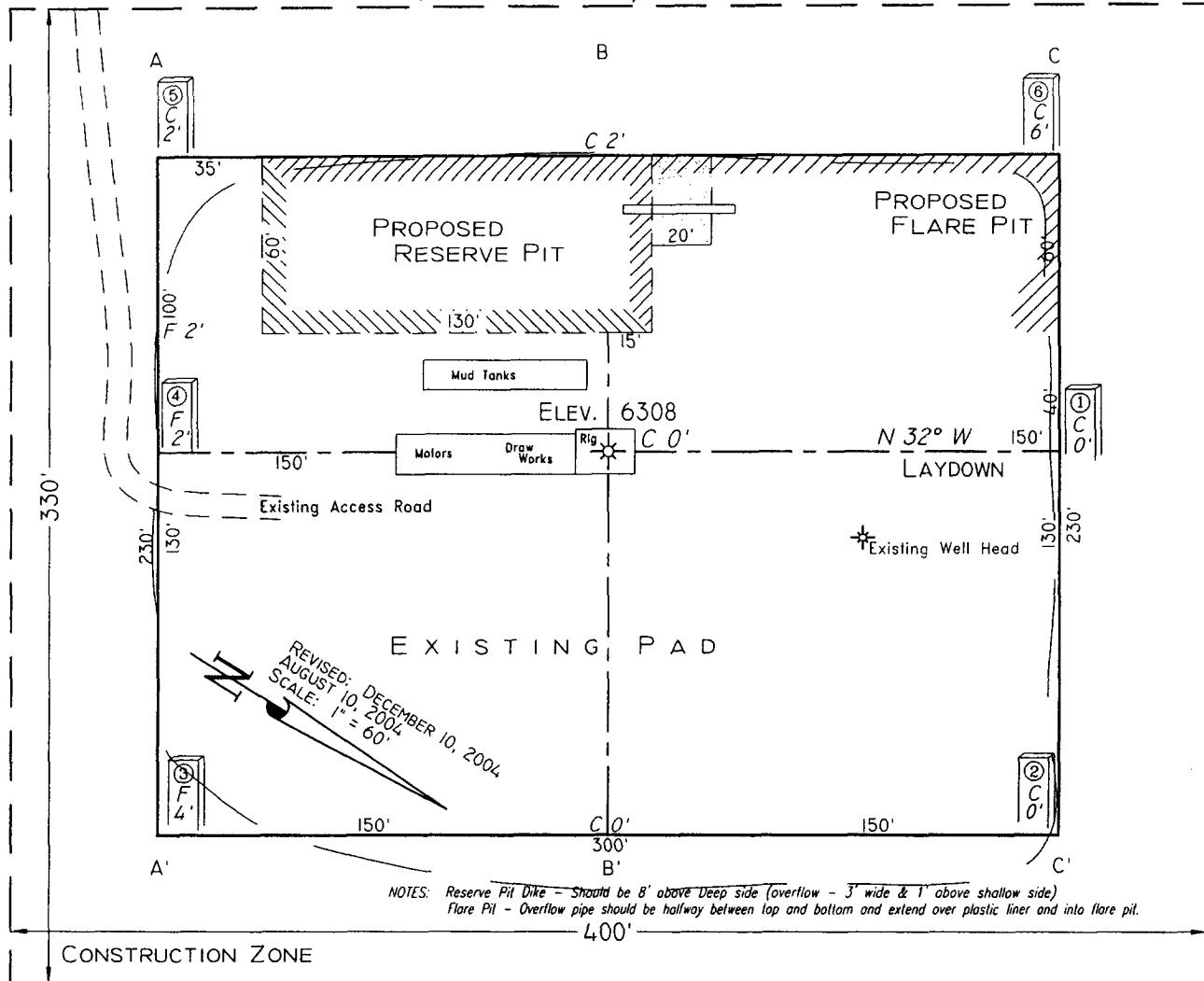

Area of Construction Zone - 330'x400' or 3.03 acres, more or less.

SCALE: 1"=60'-HORIZ.
 1"=40'-VERT.

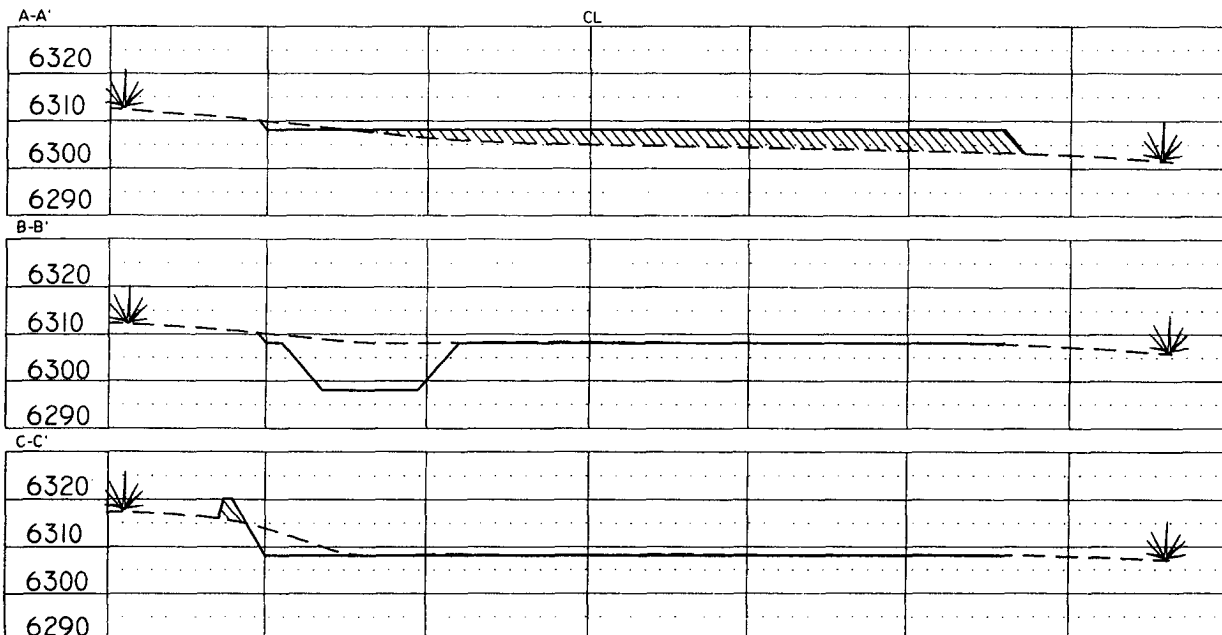

NOTE: Contractor should call One-Call for location of any marked or unmarked buried pipelines or cables on well pad and/or access road at least two (2) working days prior to construction.

Cuts and fills shown are approximate - final finished elevation is to be adjusted so earthwork will balance. Corner stakes are approximate and do not include additional areas needed for sideslopes and drainages. Final Pad Dimensions are to be verified by Contractor.

VANN SURVEYS
 P. O. Box 1306
 Farmington, NM

NEBU 225
Unit L 19-31N-6W
San Juan Co., NM

DRILLING PLAN

1. ESTIMATED TOPS OF IMPORTANT GEOLOGIC MARKERS & ANTICIPATED WATER, OIL, GAS OR MINERAL FORMATIONS:

Formation	TVD (ft)	TMD (FT)	Hydrocarbon/Water Bearing Zones
San Jose	Surface	Surface	
Ojo Alamo	2223	2418	Aquifer
Kirtland	2352	2552	
Fruitland	2806	3010	Gas
Fruitland 1 st Coal	2967	3171	Gas
Pictured Cliffs Tongue	3142	3346	Gas
Pictured Cliffs	3228	3432	Gas
Lewis	3363	3567	
TD	3463	3667	

All shows of fresh water and minerals will be adequately protected and reported.

2. PRESSURE CONTROL EQUIPMENT:

All well control equipment shall be in accordance with Onshore Order #2 for 2M systems.

The minimum specifications for pressure control equipment that will be provided are included on the attached schematic diagram, which shows the size, and pressure ratings.

2000# BOP With Pipe Rams and 2000# BOP With Blind Rams

Auxiliary equipment to be used:

- Upper kelly cock with handle available.

The manifold includes appropriate valves and adjustable chokes. The kill line will have one check valve. Ram type preventers will be pressure tested to full working pressure (utilizing a test plug) or 70% of the internal yield pressure (without a test plug) at:

- Initial installation
- Whenever any seal subject to test pressure is broken
- Following related repairs

- At 30 day intervals

Pipe and blind rams shall be activated each trip.

A BOPE pit level drill will be conducted weekly for each drilling crew.
All tests and drills will be recorded in the drilling log.

The accumulator will have sufficient capacity to close all rams and retain 200 psi above pre-charge pressure without the use of closing unit pumps.

Master controls will be at the accumulator. Anticipated bottom hole pressure is 1500 psi.

3. **CASING & CEMENTING PROGRAM:**

A. The proposed casing program will be as follows:

TVD	Hole Size	Size	Grade	Weight	Thread	Condition
0-285	12-1/4"	9-5/8"	H-40	32#	STC	New
0-TD	6-1/4"	4-1/2"	J-55	11.6#	LTC	New

*TWD
3667'*

The 9-5/8" surface pipe will be tested to 750 psi. All casing strings below the surface shoe shall be pressure tested to 0.22 psi/ft. of casing string length or 1500 psi, whichever is greater, but not to exceed 70% minimum internal yield.

Surface: The bottom three joints of the surface casing will have a minimum of one centralizer per joint and one centralizer every joint thereafter (Total 5 centralizers estimated)

4-1/2" Casing: The bottom three joints of the casing will have a minimum of one centralizer per joint and one centralizer every fifth joint thereafter to above Ojo Alamo with turbolizers below and throughout the Ojo Alamo. (Total 12 centralizers, 3 turbolizers estimated).

B. The proposed cementing program will be as follows:

Surface String:

9-5/8" Surface cemented in a 12-1/4" hole at 285'.
32.3# H-40 ST&C 8 Rnd
Saw tooth guide shoe
Cemented with 200 sx Class B mixed at 15.6 ppg w/.25 pps
Celloflake, 2% calcium chloride. Yield 1.19 ft³/sx, cement
Designed to circulate to surface.

* **Minor variations possible due to existing conditions**

Production String:

4-1/2" Production casing cemented in an 6-1/4" hole
11.6# J-55 LT&C 8 Rnd
Float collar

Joint

Float Shoe

Lead: 500 sx 50/50 Poz, Yield-1.45 ft³/sx, Mixed @ 13ppg
Foamed W/ N₂ Down To 9.0# Additives 2% Gel, 0.2% Versaset,
0.1% Diacel Lwl. *2.18 ft³/sx when foamed*

Tail: 75 sx 50/50 Poz, Yield-1.45 ft³/sx, 13 lb/gal, Additives 2%
Gel, 0.2% Versaset, 0.1% Diacel Lwl.

* *Minor variations possible due to existing conditions*

Actual volumes will be calculated and adjusted with caliper log prior to cementing.

4. DRILLING FLUIDS PROGRAM:

TVD	Type	Weight (ppg)	Viscosity	pH	Water Loss	Remarks
0-285'	Spud	8.4-9.0	29-70	8.0	NC	FW gel,
285-TD	LSND/Air	8.4-9.0	29-70	8.0	10-12	LCM as needed

NC = no control

Sufficient quantities of mud material will be maintained on site or be readily accessible for the purpose of assuring well control. SPR will be recorded on daily drilling report after mudding up. Visual mud monitoring will be conducted during operations.

5. EVALUATION PROGRAM:

Wireline Logs: None

Mud Logs: Possible mud logging in Fruitland Coal & Pictured Cliffs.

Survey: Deviation surveys will be taken every 500' from 0-TD of 6-1/4" hole or first succeeding bit change.

Cores: None anticipated.

DST's: None anticipated.

6. ABNORMAL CONDITIONS:

The Fruitland Coal will be encountered at approximately 3030' TMD. Estimated formation pressure is 300 psi. No other abnormal pressures and/or temperatures are expected. No hydrogen sulfide should be present.

7. OTHER INFORMATION:

Company: Devon Energy
Lease/Well: NEBU 225
Location: San Juan County
State/Country: New Mexico

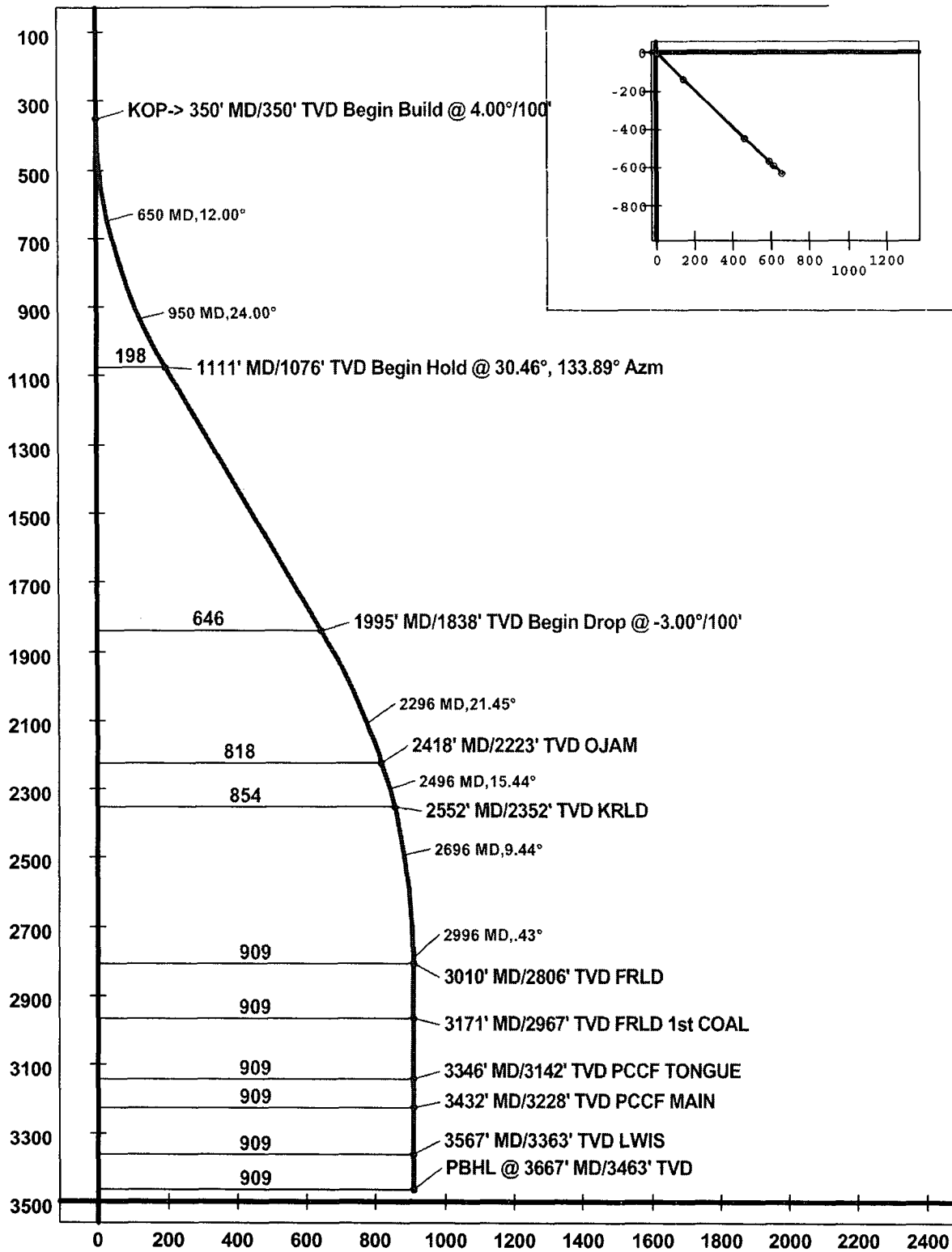

Well Control Equipment 2,000 psi Configuration

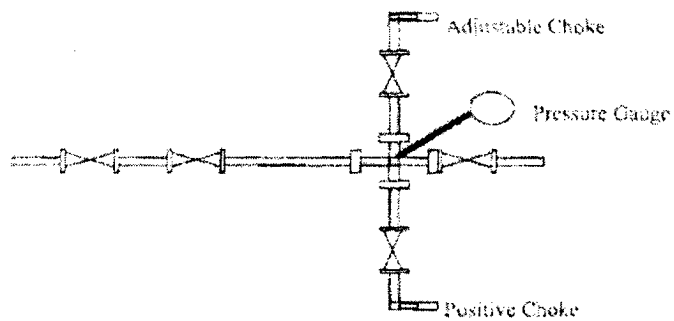
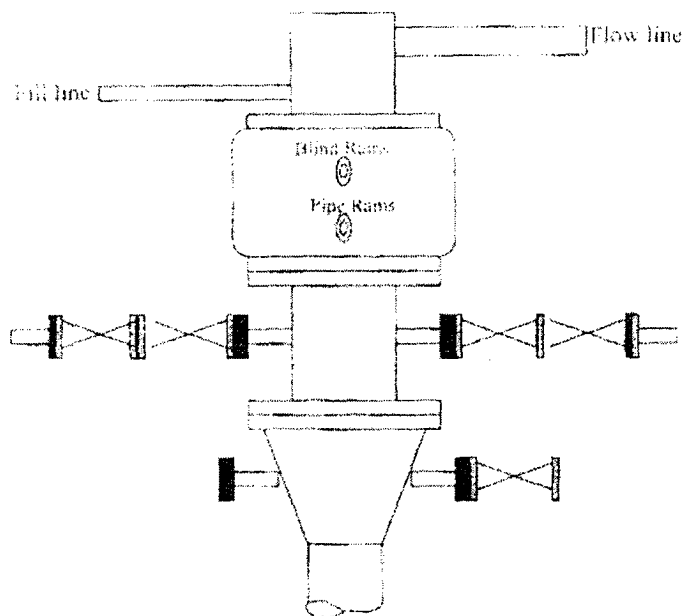

All well control equipment designed to meet or exceed the Onshore Oil and Gas Order No. 2, BLM 43 CTR 3160 requirements for 2M systems.