

UNITED STATES  
DEPARTMENT OF THE INTERIOR  
BUREAU OF LAND MANAGEMENT

FORM APPROVED  
OMB No. 1004-0137  
Expires: March 31, 2007

**SUNDRY NOTICES AND REPORTS ON WELLS**  
***Do not use this form for proposals to drill or to re-enter an abandoned well. Use Form 3160-3 (APD) for such proposals.***

**SUBMIT IN TRIPLICATE – Other instructions on page 2.**

1. Type of Well <input checked="" type="checkbox"/> Oil Well <input type="checkbox"/> Gas Well <input type="checkbox"/> Other		5. Lease Serial No. <b>NO-G-1403-1908</b>
2. Name of Operator <b>WPX Energy Production, LLC</b>		6. If Indian, Allottee or Tribe Name
3a. Address <b>PO Box 640    Aztec, NM 87410</b>	3b. Phone No. (include area code) <b>505-333-1808</b>	7. If Unit of CA/Agreement, Name and/or No. <b>W LYBROOK UNIT / NMNM135216A</b>
4. Location of Well (Footage, Sec., T., R., M., or Survey Description) <b>SHL: 1215' FSL &amp; 1386' FWL, Sec 8, T23N, R8W BHL: 1059' FSL &amp; 2379' FEL, Sec 6 T23N, R8W</b>		8. Well Name and No. <b>W Lybrook Unit 713H</b>
		9. API Well No. <b>30-045-35808</b>
		10. Field and Pool or Exploratory Area <b>LYBROOK MANCOS W</b>
		11. Country or Parish, State <b>SAN JUAN COUNTY, NEW MEXICO</b>

**12. CHECK THE APPROPRIATE BOX(ES) TO INDICATE NATURE OF NOTICE, REPORT OR OTHER DATA**

TYPE OF SUBMISSION	TYPE OF ACTION			
<input checked="" type="checkbox"/> Notice of Intent	<input type="checkbox"/> Acidize	<input type="checkbox"/> Deepen	<input type="checkbox"/> Production (Start/Resume)	<input type="checkbox"/> Water Shut-Off
<input type="checkbox"/> Subsequent Report	<input type="checkbox"/> Alter Casing	<input type="checkbox"/> Fracture Treat	<input type="checkbox"/> Reclamation	<input type="checkbox"/> Well Integrity
<input type="checkbox"/> Final Abandonment Notice	<input type="checkbox"/> Casing Repair	<input type="checkbox"/> New Construction	<input type="checkbox"/> Recomplete	<input checked="" type="checkbox"/> Other <u>Equipment Placement</u>
	<input type="checkbox"/> Change Plans	<input type="checkbox"/> Plug and Abandon	<input type="checkbox"/> Temporarily Abandon	
	<input type="checkbox"/> Convert to Injection	<input type="checkbox"/> Plug Back	<input type="checkbox"/> Water Disposal	

13. Describe Proposed or Completed Operation: Clearly state all pertinent details, including estimated starting date of any proposed work and approximate duration thereof. If the proposal is to deepen directionally or recomplete horizontally, give subsurface locations and measured and true vertical depths of all pertinent markers and zones. Attach the Bond under which the work will be performed or provide the Bond No. on file with BLM/BIA. Required subsequent reports must be filed within 30 days following completion of the involved operations. If the operation results in a multiple completion or recompletion in a new interval, a Form 3160-4 must be filed once testing has been completed. Final Abandonment Notices must be filed only after all requirements, including reclamation, have been completed and the operator has determined that the site is ready for final inspection.)

WPX Energy Production, LLC is requesting to set permanent facilities on the W Lybrook Unit 703H, 704H, 711H, 713H, 743H, and 744H well pad. Permanent facilities on location would consist of two gas lift skids and cathodic protection equipment. A site visit was conducted on March 27, 2017 with Randy McKee to discuss facility layout and placement. Facilities on location would consist of two gas lift skids and cathodic protection equipment. Concurrently, WPX and BLM decided these facilities would be located on the south side of the access road. Please see the attached well pad diagram.

**RECEIVED**

**MAR 31 2017**

Farmington Field Office  
Bureau of Land Management

14. I hereby certify that the foregoing is true and correct. Name (Printed/Typed) <b>Marie Jaramillo</b>		Title <b>Permit Technician III</b>	
Signature 		Date <b>03/31/2017</b>	
<b>THIS SPACE FOR FEDERAL OR STATE OFFICE USE</b>			
Approved by 		Title <b>Supv NPS</b>	Date <b>4/3/12</b>
Conditions of approval, if any, are attached. Approval of this notice does not warrant or certify that the applicant holds legal or equitable title to those rights in the subject lease which would entitle the applicant to conduct operations thereon.		Office <b>FFO</b>	

Title 18 U.S.C. Section 1001 and Title 43 U.S.C. Section 1212, make it a crime for any person knowingly and willfully to make to any department or agency of the United States any false, fictitious or fraudulent statements or representations as to any matter within its jurisdiction.

**NMOCD**



**WPX Energy Production, LLC W Lybrook Unit  
703H, 704H, 711H, 713H, 743H & 744H Well Pad Diagram  
Section 8, T23N, R8W, NMPM San Juan County, New Mexico**

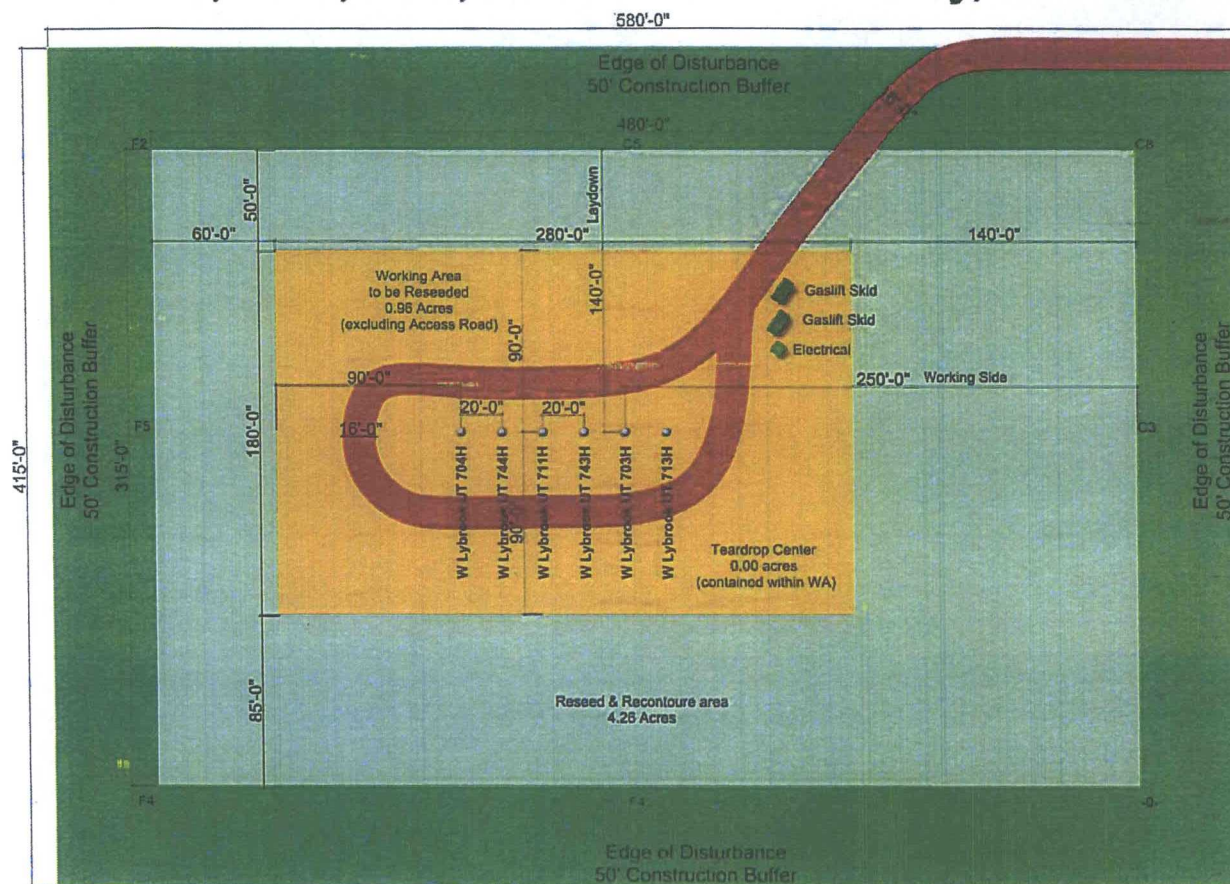

- 1) Long Term Disturbance = 0.31 Acres
  - a. Facilities = 0.00\* Acres
  - b. Access Road (AR) = 0.31 Acres
- 2) Reseed Area Only= 0.96 Acres
  - a. Working Area (WA) = .96 Acres  
(excluding Access Road)
  - b. Teardrop Area  
(contained within WA) = 0.00 Acres
- 3) Reseed & Recontour Area = 4.26 Acres

**Total Disturbance Area = 5.53 Acres**

*\*Production facilities for the  
W Lybrook UT 703H, 704H,  
711H, 713H, 743H & 744H  
are remotely located on  
WLU Remote #1.*



**NORTH**

90'-0"

1" = 90'

**W Lybrook Unit  
NMNM-135216X**

**W Lybrook UT 703H  
1,212' FSL & 1,366' FWL  
API # 30-045-35727**

**W Lybrook UT 704H  
1,199' FSL & 1,287' FWL  
API # 30-045-35728**

**W Lybrook UT 711H  
1,205' FSL & 1,327' FWL  
API # 30-045-35809**

**W Lybrook UT 713H  
1,215' FSL & 1,386' FWL  
API # 30-045-35808**

**W Lybrook UT 743H  
1,209' FSL & 1,346' FWL  
API # 30-045-35729**

**W Lybrook UT 744H  
1,202' FSL & 1,307' FWL  
API # 30-045-35730**