

Submit One Copy To Appropriate District  
Office  
District I  
1625 N. French Dr., Hobbs, NM 88240  
District II  
811 S. First St., Artesia, NM 88210  
District III  
1000 Rio Brazos Rd., Aztec, NM 87410  
District IV  
1220 S. St. Francis Dr., Santa Fe, NM  
87505

State of New Mexico  
Energy, Minerals and Natural Resources

OIL CONSERVATION DIVISION  
1220 South St. Francis Dr.  
Santa Fe, NM 87505

Form C-103  
Revised November 3, 2011

|                                      |  |
|--------------------------------------|--|
| WELL API NO.                         | 30-045-25353   |
| 5. Indicate Type of Lease            | STATE <input type="checkbox"/> FEE <input checked="" type="checkbox"/> |
| 6. State Oil & Gas Lease No.         |  |
| 7. Lease Name or Unit Agreement Name | Sly Slav   |
| 8. Well Number                       | 2  |
| 9. OGRID Number                      |  |
| 10. Pool name or Wildcat             | Basin Dakota   |

SUNDRY NOTICES AND REPORTS ON WELLS  
(DO NOT USE THIS FORM FOR PROPOSALS TO DRILL OR TO DEEPEN OR PLUG BACK TO A DIFFERENT RESERVOIR. USE "APPLICATION FOR PERMIT" (FORM C-101) FOR SUCH PROPOSALS.)

1. Type of Well: ☐ Oil Well ☒ Gas Well ☐ Other

2. Name of Operator

Dugan Production Corp c/o Westmoreland Coal Company

3. Address of Operator

300 CR 6800 Waterflow, NM 87421

4. Well Location

Unit Letter N: 790 feet from the South line and 1700 feet from the West line

Section 13 Township 30N Range 15W NMPM County SAN JUAN

11. Elevation (Show whether DR, RKB, RT, GR, etc.)

5320' GL

12. Check Appropriate Box to Indicate Nature of Notice, Report or Other Data

NOTICE OF INTENTION TO:

PERFORM REMEDIAL WORK ☐ PLUG AND ABANDON ☐

TEMPORARILY ABANDON ☐ CHANGE PLANS ☐

PULL OR ALTER CASING ☐ MULTIPLE COMPL ☐

OTHER: ☐

SUBSEQUENT REPORT OF:

REMEDIAL WORK ☐ ALTERING CASING ☐

COMMENCE DRILLING OPNS. ☐ P AND A ☒

CASING/CEMENT JOB ☐

☒ Location is ready for OCD inspection after P&A

☒ All pits have been remediated in compliance with OCD rules and the terms of the Operator's pit permit and closure plan.

☒ Rat hole and cellar have been filled and leveled. Cathodic protection holes have been properly abandoned.

☐ A steel marker at least 4" in diameter and at least 4' above ground level has been set in concrete. It shows the

on mine, below grade marker per mine regulations

**OPERATOR NAME, LEASE NAME, WELL NUMBER, API NUMBER, QUARTER/QUARTER LOCATION OR UNIT LETTER, SECTION, TOWNSHIP, AND RANGE. ALL INFORMATION HAS BEEN WELDED OR PERMANENTLY STAMPED ON THE MARKER'S SURFACE.**

☒ The location has been leveled as nearly as possible to original ground contour and has been cleared of all junk, trash, flow lines and other production equipment.

☒ Anchors, dead men, tie downs and risers have been cut off at least two feet below ground level.

☐ If this is a one-well lease or last remaining well on lease, the battery and pit location(s) have been remediated in compliance with OCD rules and the terms of the Operator's pit permit and closure plan. All flow lines, production equipment and junk have been removed from lease and well location.

☒ All metal bolts and other materials have been removed. Portable bases have been removed. (Poured onsite concrete bases do not have to be removed.)

☒ All other environmental concerns have been addressed as per OCD rules.

☒ Pipelines and flow lines have been abandoned in accordance with 19.15.35.10 NMAC. All fluids have been removed from non-retrieved flow lines and pipelines.

☐ If this is a one-well lease or last remaining well on lease: all electrical service poles and lines have been removed from lease and well location, except for utility's distribution infrastructure.

When all work has been completed, return this form to the appropriate District office to schedule an inspection.

SIGNATURE Eric D. Herth TITLE Mine Geologist DATE 3/8/18

TYPE OR PRINT NAME Eric D. Herth E-MAIL: ehert@westmoreland.com PHONE: 505.598.2105

For State Use Only

Per 1/31/18 inspection Deputy Oil & Gas Inspector,

APPROVED BY: Bob Red TITLE District #3 DATE 3/22/18

AV

**P & A WELL SURVEY**  
**DUGAN SLY SLAV NO. 2 WELL LOCATED IN THE**  
**SE/4 SW/4 SECTION 13, T.30N., R.15W.,**  
**N.M.P.M., SAN JUAN COUNTY, NEW MEXICO.**

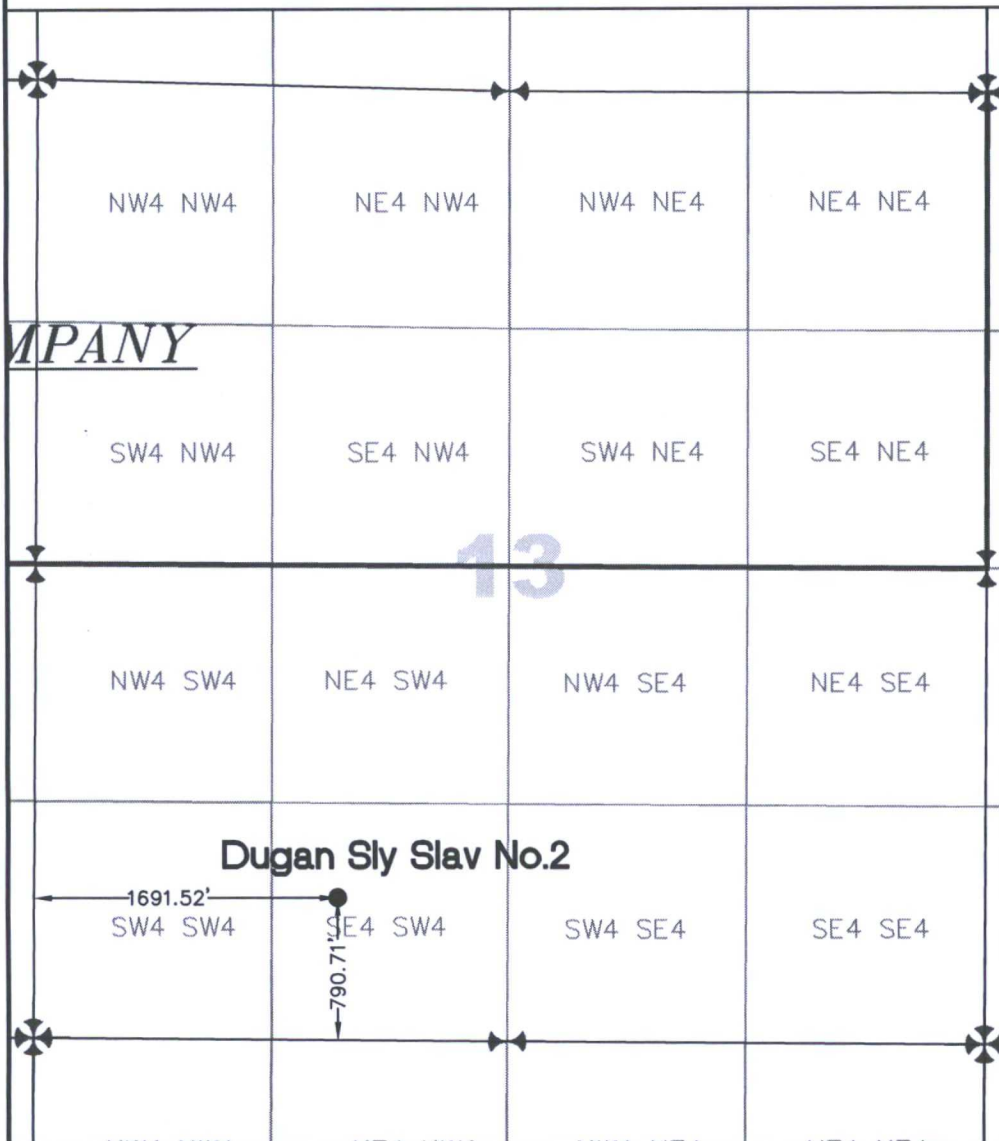

Denotes found BLM brass cap monument

**NAD 1927 NEW MEXICO WEST**

N: 2114181.21  
 E: 342537.49  
 Original Ground El. 5328

Lat: 36°48'32.53849"  
 Long: 108°22'18.72160"

**NAD 83 Conversion**

Lat: 36.80901°  
 Long: -108.37185°



SCALE: 1"=500'

I, Peter Epp, a Registered Professional Surveyor under the laws of the State of New Mexico, hereby certify that this plat was prepared from the field notes of a actual survey meeting the minimum requirements of the standards for oil well surveys and is true and correct to the best of my knowledge and belief.



Peter Epp P.L.S. New Mexico L.S. # 15512 Date: \_\_\_\_\_

**BASIS OF BEARING:**  
 STATIC G.P.S. SURVEY, SOLUTIONS  
 OBTAINED FROM SATELLITES TRACKED  
 APRIL, 2003. REFERENCE H.A.R.N.  
 NETWORK POINTS FMN 0 AND E432.  
 BEARING N 86°37'34" W (NAD27  
 NEW MEXICO WEST) SCALE FACTOR  
 = 0.99968910

CHECKED BY PE

DRAWN BY AS



**EPP & ASSOCIATES, INC.**  
**PROFESSIONAL LAND SURVEYORS**

433 4th Avenue West  
 P.O. Box 837  
 Craig, CO 81625

Phone (970) 824-8236  
 Fax (970) 824-5227

**Prepared for:**  
**State of New Mexico**  
**Oil Conservation Commission**