

UNITED STATES  
DEPARTMENT OF THE INTERIOR  
BUREAU OF LAND MANAGEMENT

RECEIVED

FORM APPROVED  
OMB No. 1004-0135  
Expires July 31, 1996

SUNDRY NOTICES AND REPORTS ON WELLS

Do not use this form for proposals to drill or reenter an abandoned well. Use Form 3160-3 (APD) for such proposals.

SUBMIT IN TRIPLICATE - Other instructions on reverse side

1. Type of Well  
☐ Oil Well ☒ Gas Well ☐ Other

2. Name of Operator  
DJR Operating, LLC

3a. Address  
1600 Broadway, Suite 1960 Denver, CO 80202

3b. Phone No. (include area code)  
(303) 595-7433

4. Location of Well (Footage, Sec., T., R., M., or Survey Description)  
790' FNL X 790' FEL

"A" Sec. 24-T25N-R13W

5. Lease Serial No.

NMNM-58138

6. If Indian, Allottee or Tribe Name

NA

7. If Unit or CA/Agreement, Name and/or No.

NMNM 85786

8. Well Name and No.

West Bisti Coal 24-1

9. API Well No.

30-045-28515

10. Field and Pool, or Exploratory Area

Basin Fruitland Coal

11. County or Parish, State

San Juan County, NM

12. CHECK APPROPRIATE BOX(ES) TO INDICATE NATURE OF NOTICE, REPORT, OR OTHER DATA

TYPE OF SUBMISSION	TYPE OF ACTION
<input checked="" type="checkbox"/> Notice of Intent	<input type="checkbox"/> Acidize <input type="checkbox"/> Deepen <input type="checkbox"/> Production (Start/Resume) <input type="checkbox"/> Water Shut-Off
<input type="checkbox"/> Subsequent Report	<input type="checkbox"/> Alter Casing <input type="checkbox"/> Fracture Treat <input type="checkbox"/> Reclamation <input type="checkbox"/> Well Integrity
<input type="checkbox"/> Final Abandonment Notice	<input type="checkbox"/> Casing Repair <input type="checkbox"/> New Construction <input type="checkbox"/> Recomplete <input checked="" type="checkbox"/> Other Well Name Change
	<input type="checkbox"/> Change Plans <input type="checkbox"/> Plug and Abandon <input type="checkbox"/> Temporarily Abandon
	<input type="checkbox"/> Convert to Injection <input type="checkbox"/> Plug Back <input type="checkbox"/> Water Disposal

13. Describe Proposed or Completed Operations (clearly state all pertinent details, including estimated starting date of any proposed work and approximate duration thereof. If the proposal is to deepen directionally or recomple horizontally, give subsurface locations and measured and true vertical depths of all pertinent markers and zones. Attach the Bond under which the work will be performed or provide the Bond No. on file with BLM/BIA. Required subsequent reports shall be filed within 30 days following completion of the involved operations. If the operation results in a multiple completion or recomple in a new interval, a Form 3160-4 shall be filed once Testing has been completed. Final Abandonment Notices shall be filed only after all requirements, including reclamation, have been completed, and the operator has determined that the site is ready for final inspection.)

DJR Operating, LLC would like to change the name of this well from ~~Champlin Federal #1~~ to West Bisti Coal 24 #1 to West Bisti Coal Com #1 **Champlin Federal COM 1**.

OIL CONS. DIV DIST. 3

JUN 29 2017

14. I hereby certify that the foregoing is true and correct  
Name (Printed/Typed)

Amy Archuleta

Title

Regulatory Supervisor

Signature

Date

June 21, 2017

THIS SPACE FOR FEDERAL OR STATE USE

Approved by

Dave Mankiewicz

Title

AFM-Min

Date

6/26/17

Conditions of approval, if any, are attached. Approval of this notice does not warrant or certify that the applicant holds legal or equitable title to those rights in the subject lease which would entitle the applicant to conduct operations thereon.

Office

BLM-FFO

Title 18 U.S.C. Section 1001, makes it a crime for any person knowingly and willfully to make to any department or agency of the United States any false, fictitious or fraudulent statements or representations as to any matter within its jurisdiction.

(Instructions on reverse)

NMOCDAV

3

District I  
1625 N. French Dr., Hobbs, NM 88240  
Phone: (575) 393-6161 Fax: (575) 393-0720  
District II  
811 S. First St., Artesia, NM 88210  
Phone: (575) 748-1283 Fax: (575) 748-9720  
District III  
1000 Rio Brazos Road, Aztec, NM 87410  
Phone: (505) 334-6178 Fax: (505) 334-6170  
District IV  
1220 S. St. Francis Dr., Santa Fe, NM 87505  
Phone: (505) 476-3460 Fax: (505) 476-3462

State of New Mexico  
Energy, Minerals & Natural Resources Department  
OIL CONSERVATION DIVISION  
1220 South St. Francis Dr.  
Santa Fe, NM 87505

Form C-102  
Revised August 1, 2011  
Submit one copy to appropriate  
District Office

☐ AMENDED REPORT

WELL LOCATION AND ACREAGE DEDICATION PLAT

<sup>1</sup> API Number <b>30-045-28515</b>		<sup>2</sup> Pool Code <b>71629</b>	<sup>3</sup> Pool Name <b>Basin Fruitland Coal (Gas)</b>
<sup>4</sup> Property Code <b>320337</b>	<sup>5</sup> Property Name <b>West Bisti Coal 24 COM</b>		<sup>6</sup> Well Number <b>001</b>
<sup>7</sup> OGRID No. <b>371838</b>	<sup>8</sup> Operator Name <b>DJR Operating, LLC</b>		<sup>9</sup> Elevation <b>6435' GL</b>

<sup>10</sup> Surface Location

UL or lot no. "A"	Section <b>24</b>	Township <b>25N</b>	Range <b>13W</b>	Lot Idn	Feet from the <b>790'</b>	North/South line <b>North</b>	Feet from the <b>790'</b>	East/West line <b>East</b>	County <b>San Juan</b>
----------------------	----------------------	------------------------	---------------------	---------	------------------------------	----------------------------------	------------------------------	-------------------------------	---------------------------

<sup>11</sup> Bottom Hole Location If Different From Surface

UL or lot no.	Section	Township	Range	Lot Idn	Feet from the	North/South line	Feet from the	East/West line	County
---------------	---------	----------	-------	---------	---------------	------------------	---------------	----------------	--------

<sup>12</sup> Dedicated Acres <b>320</b>	<sup>13</sup> Joint or Infill	<sup>14</sup> Consolidation Code	<sup>15</sup> Order No.
---	-------------------------------	----------------------------------	-------------------------

No allowable will be assigned to this completion until all interests have been consolidated or a non-standard unit has been approved by the division.

<sup>16</sup>				<sup>17</sup> <b>OPERATOR CERTIFICATION</b> I hereby certify that the information contained herein is true and complete to the best of my knowledge and belief, and that this organization either owns a working interest or unleased mineral interest in the land including the proposed bottom hole location or has a right to drill this well at this location pursuant to a contract with an owner of such a mineral or working interest, or to a voluntary pooling agreement or a compulsory pooling order heretofore entered by the division. Signature:  Date: <b>3-26-2018</b> Printed Name: <b>Amy Archuleta</b> E-mail Address: <b>aarchuleta@djrlc.com</b>	
<sup>18</sup> <b>SURVEYOR CERTIFICATION</b> I hereby certify that the well location shown on this plat was plotted from field notes of actual surveys made by me or under my supervision, and that the same is true and correct to the best of my belief. *See Attached Original Date of Survey: <b>MAR 27 2018</b> Signature and Seal of Professional Surveyor: <b>NMOC DISTRICT III</b> Certificate Number:					



Submit to Appropriate  
District Office  
State Lease - 4 copies  
Fee Lease - 3 copies

State of New Mexico  
Energy, Minerals and Natural Resources Department

Form C-102  
Revised 1-1-89

OIL CONSERVATION DIVISION

P.O. Box 2088  
Santa Fe, New Mexico 87504-2088

DISTRICT I  
P.O. Box 1980, Hobbs, NM 88240

DISTRICT II  
P.O. Drawer DD, Artesia, NM 88210

DISTRICT III  
1000 Rio Brazos Rd., Aztec, NM 87410

WELL LOCATION AND ACREAGE DEDICATION PLAT

All Distances must be from the outer boundaries of the section

30-045-28515

Operator Giant Exploration & Production Company			Lease West Bisti Coal 24		Well No. 1
Unit Letter A	Section 24	Township 25 North	Range 13 West	County San Juan	NMPM
Actual Footage Location of Well: 790 feet from the North line and 790 feet from the East line					
Ground level Elev. 6435	Producing Formation Fruitland		Pool Basin Fruitland Coal	Dedicated Acreage: 320 Acres	

1. Outline the acreage dedicated to the subject well by colored pencil or hatchure marks on the plat below.

2. If more than one lease is dedicated to the well, outline each and identify the ownership thereof (both as to working interest and royalty).

3. If more than one lease of different ownership is dedicated to the well, have the interest of all owners been consolidated by communitization, unitization, force-pooling, etc.?

☐ Yes ☐ No If answer is "yes" type of consolidation

If answer is "no" list the owners and tract descriptions which have actually been consolidated. (Use reverse side of this form if necessary.)

No allowable will be assigned to the well until all interests have been consolidated (by communitization, unitization, forced-pooling, or otherwise) or until a non-standard unit, eliminating such interest, has been approved by the Division.

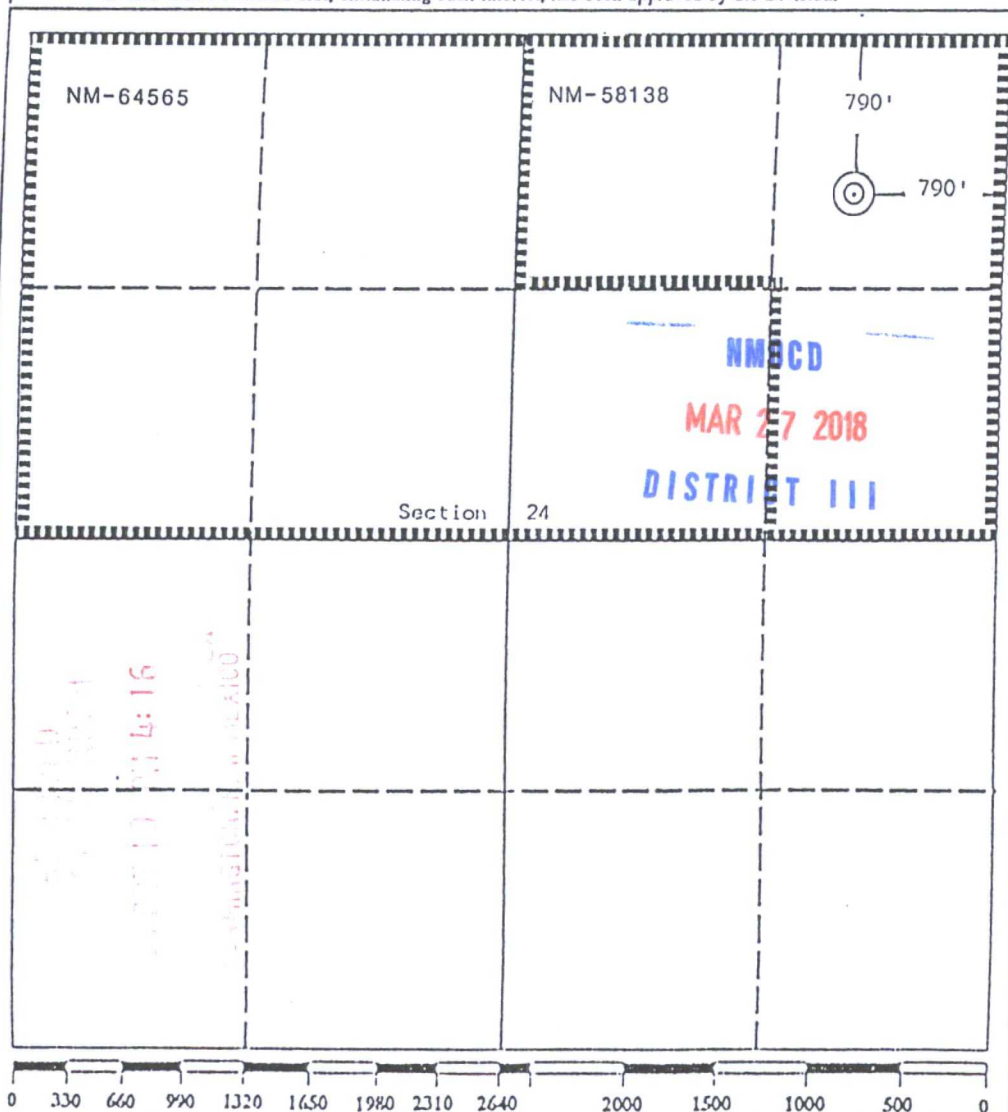

OPERATOR CERTIFICATION

I hereby certify that the information contained herein is true and complete to the best of my knowledge and belief.

Signature

Printed Name

John C. Corbett

Position

Vice President - Exploration

Company

Giant Exploration & Production Co.

Date

September 17, 1990

SURVEYOR CERTIFICATION

I hereby certify that the well location shown on this plat was plotted from field notes of actual surveys made by me or under my supervision, and that the same is true and correct to the best of my knowledge and belief.

Date Surveyed

September 12, 1990

Signature & Seal of Professional Surveyor

Certificate No. 5979

Edgar L. Risenhoover, P.